

119 HUDSON PARADE, CLAREVILLE
#2025/25 - **SW1** 30/6/25

**Law &
Dawson** Pty
Ltd
Consulting Structural
& Civil Engineers
A.C.N. 003 543 913
A.B.N. 97003 543 913

GENERAL NOTES - STORM WATER

- SW1 All S.W. pipework to be carried out in U.P.V.C. to AS 1260 CLASS SH.
- SW2 All D.P. to be carried out in U.P.V.C. to AS 1415 parts 1-5 CLASS SWV.
- SW3 All S.W. pipes to grade at 1% min. U.N.O.
- SW4 All S.W. pipework to be 100Ømm U.N.O.
- SW5 All gutters to be as noted in schedule.
- SW6 All D.P'S to be as noted.
- SW7 All grated pits to be 300x300 precast concrete U.N.O.
- SW8 All covered pits to be 600x600 precast concrete U.N.O.
- SW9
- SW10 All covers, grates & frames to be heavy duty where subject to vehicular traffic.
- SW11 All covers, grates & frames to be medium duty where subject to pedestrian traffic or landscaped areas.
- SW12 All drainage to maintain a min. cover of 100mm.
- SW13 For exact location of buildings, levels, walls, d.p.'s etc. refer to architectural detail drawings.
- SW14 The contractor shall submit to the builder for approval, samples of the nominated equipment, fittings and fixtures to be used for the project. This also applies and must be strictly adhered to when offering alternatives to specified items.
- SW15 Any discrepancy or variations of design shall be referred to 'The Principle' for decision prior to the commencement of any such work.
- SW16 The contractor shall be responsible for the set out and placement of all core holes, wall, floor and beam penetrations. All penetrations shall be approved prior placement, seal holes and repair chases in walls after installation of pipework.
- SW17 All floor and wall penetrations shall be fire rated to comply with the requirements of the Building Code of Australia.
- SW18 The drawings documented hereafter do not purport to show all architectural, structural or hydraulic services details. They are a guide only, and it shall be the contractors responsibility to allow for all necessary fittings, pipes, penetrations, droppers, risers and ancillary items for a complete and compliant installation.

- SW19 The contractor shall test all installed services to the requirements and satisfaction of the relevant authorities and superintendent.
- SW20 Provide fail safe overflow spitters no less than 50mm diameter for all balconies and terraces.
- SW21 All drainage pipes less than 300mm in diameter shall be sewer grade U.P.V.C. with solvent welded joints (U.N.O.) All pipe junctions and tapers shall be via proprietary made fittings.
- SW22 Final location of rainwater downpipes shall be co-ordinated on-site with the builder, to the approval of the architect and engineer and in accordance with AS3500, AS4198 and AR&R97.
- SW23 All box gutters and rainwater heads shall be fitted with failsafe overflows sized and installed to AS3500.
- SW24 All drainpipes located in noise sensitive areas as deemed by the architect, acoustic engineer or equivalent persons, shall be acoustically insulated using a system no less in standard than 'SOUNDLAGG 4525C' installed to the manufacturers recommendations.

SUBSOIL DRAINAGE

- SS1 Subsoil drainage shall be consistent with the structural engineers details and subject to the findings of the geotechnical report.
- SS2 Subsoil drains shall be slotted flexible U.P.V.C. 100mm diameter fitted with geo-fabric filter sock.
- SS3 Subsoil drainage shall be laid at a minimum grade of 0.5% U.N.O.
- SS4 Subsoil drainage should be installed on the upstream end of any proposed paved areas and connected to the piped drainage system or watercourse.
- SS5 Additional subsoil drainage shall be laid to suit site conditions and groundwater presence as directed.
- SS6 Inspection openings are to be provided at each end and regular intervals for clean-out purposes.

119 HUDSON PARADE, CLAREVILLE
2025/25 - **SW2** 30/6/25

Law & Dawson Pty Ltd
Consulting Structural
& Civil Engineers
A.C.N. 003 543 913
A.B.N. 97003 543 913

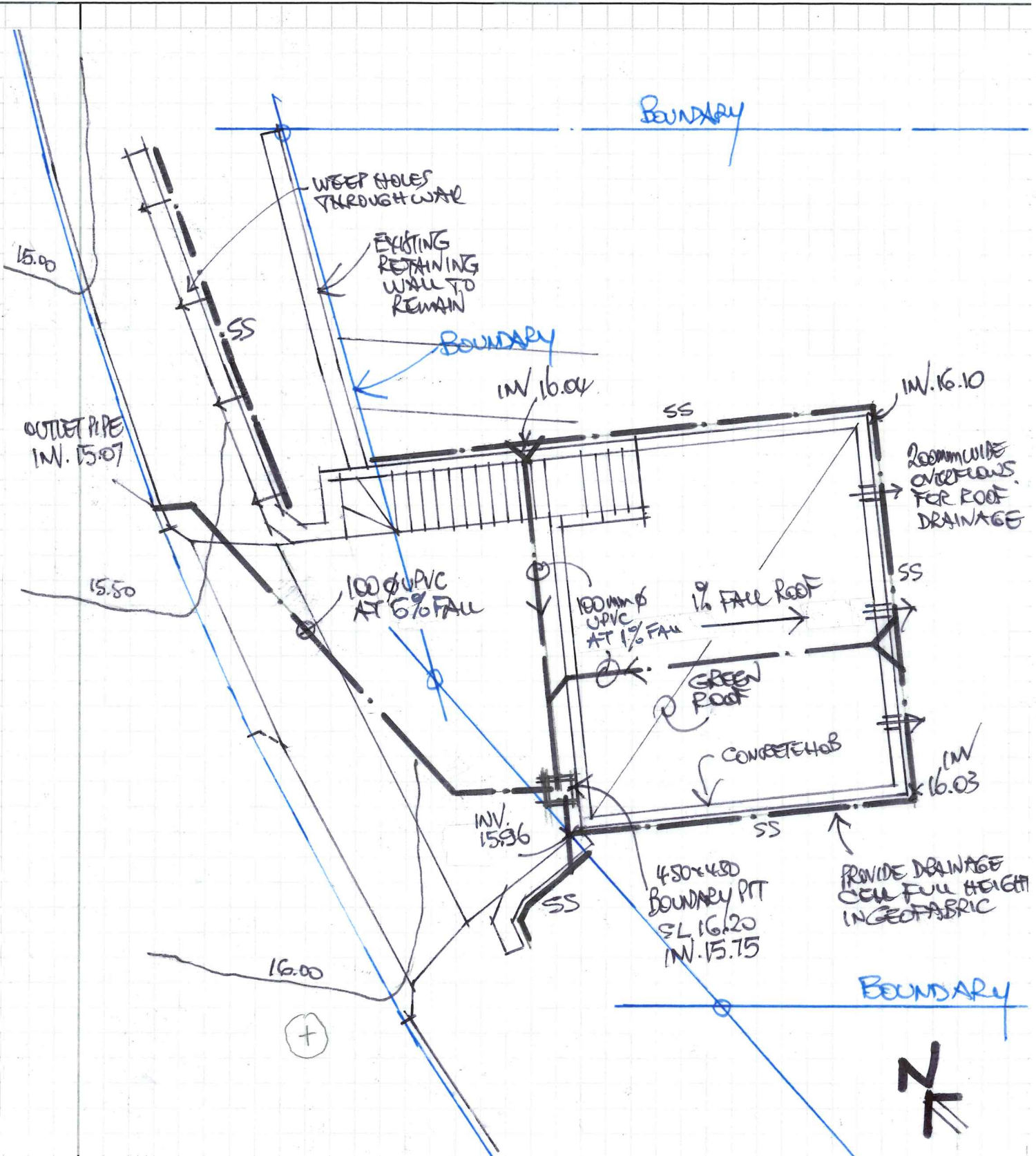

PROPOSED NEW GARAGE - STORMWATER PLAN 1:100

119 HUDSON PARADE, CLAREVILLE

#2025/25 -

SW3

30/6/25

[Signature]

Law & Dawson Pty Ltd
Consulting Structural
& Civil Engineers
A.C.N. 003 543 913
A.B.N. 97003 543 913

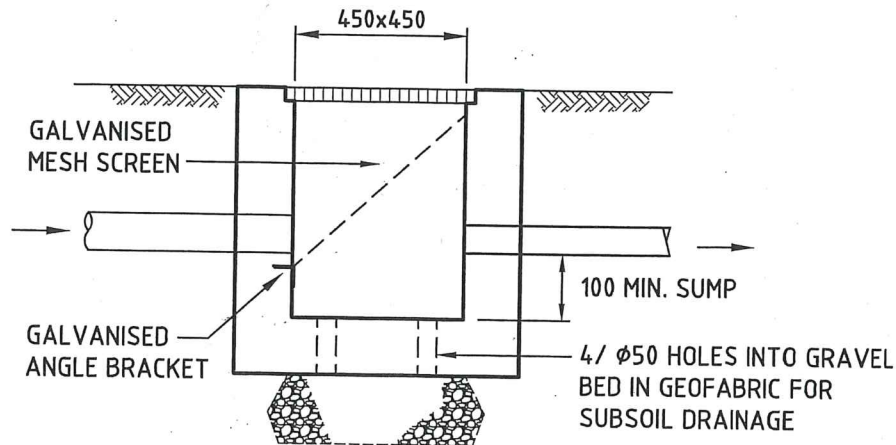

BOUNDARY PIT DETAIL

SCALE 1:20

NORTHERN BEACHES COUNCIL

REGION 1 - NORTHERN CATCHMENTS

- THE ADDITIONAL IMPERVIOUS AREA IS 29 SQ.M WHICH IS < 50 SQ.M, THEREFORE OSD IS NOT REQUIRED.

[Signature]
30/6/25