

SECTION A

THIS PLAN TO BE READ IN CONJUNCTION WITH
MOD2016/0236
NORTHERN BEACHES COUNCIL

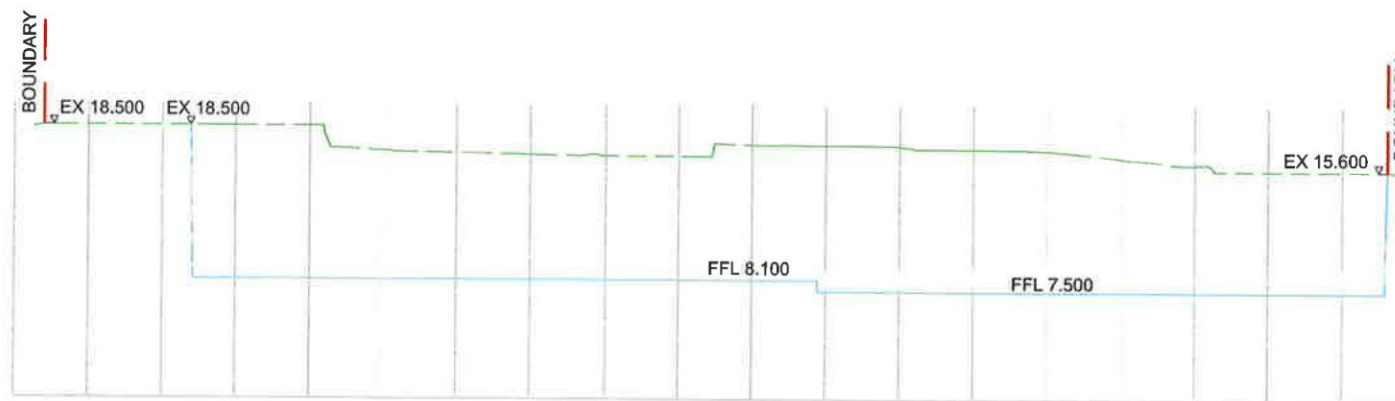

SECTION B

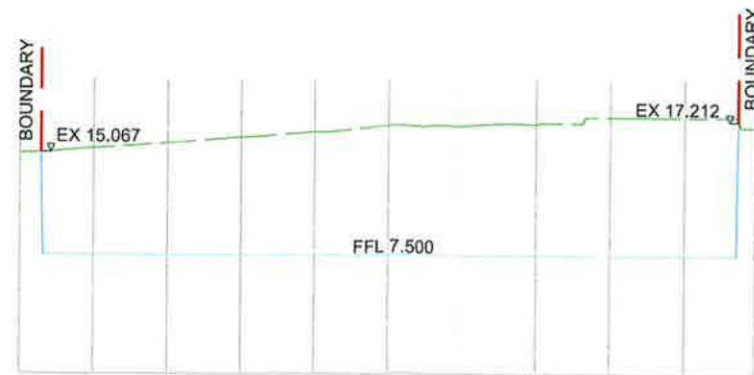

SECTION C

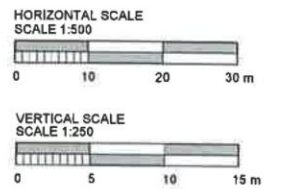

rev	date	description	dm	ch'k
04	15/08/16	ISSUED FOR APPROVAL	AN	AN
03	01/10/15	ISSUED FOR APPROVAL	DC	DC
02	17/09/15	ISSUED FOR APPROVAL	DC	DC
01	25/06/15	ISSUED FOR APPROVAL	IH	IH

enstruct group pty ltd
Level 4, 2 Glen Street
Mills Point NSW 2061
Australia
Telephone (02) 8904 1444
Facsimile (02) 8904 1555
www.enstruct.com.au



project
DEE WHY TOWN CENTRE

drawing title
EARLY WORK
BULK EARTHWORKS
SECTION

status
FOR APPROVAL

scale at A1 AS NOTED	drawn by I. HARRIS	checked I. HARRIS	date JUN-15
-------------------------	-----------------------	----------------------	----------------

project no. 4963	drawing no. CV-0005	rev. 04
---------------------	------------------------	------------

NOT FOR CONSTRUCTION

NOTES:

1. ALL LEVELS ARE IN METRES ABOVE AUSTRALIAN HEIGHT DATUM U.N.O.
2. EARTHWORKS CUT/FILL QUANTITIES TABULATED COMPRISE REGRADING IN THE SHADED AREAS ONLY. COLOURED ISOPACHYTE CONTOURS REPRESENTS EXCAVATION AND FILLING DEPTHS FROM EXISTING GROUND LEVELS TO PROPOSED FORMATION LEVEL.
3. FORMATION LEVEL IS DEFINED AS FOLLOWS:
 - IN EXTERNAL AREAS UNDERSIDE OF PAVEMENT SUB-BASE / CAPPING
 - BENEATH BUILDING SLAB UNDERSIDE OF SLAB
 - IN LANDSCAPED AREAS TAKEN AS FINISHED LEVELS
4. BULK EARTHWORKS LEVELS BELOW BUILDINGS ARE INDICATED BUT MUST BE CHECKED AGAINST ARCHITECTURAL LEVELS AND STRUCTURAL DETAILS. IN THE EVENT OF DISCREPANCIES, REFER TO ARCHITECT FOR CLARIFICATION. LEVELS ARE SUBJECT TO MINOR CHANGES.
5. NO ALLOWANCE HAS BEEN MADE FOR THE EXCAVATION OF FOUNDATIONS, SERVICES TRENCHES OR TANKS
6. EXCAVATION AND FILLING ADJACENT TO RETAINED TREES TO BE IN ACCORDANCE WITH TREE PROTECTION STRATEGY AND ARBORCULTURIST RECOMMENDATIONS.
7. ALL LOCATIONS SHOWN IN THIS DRAWING ARE APPROXIMATE BASED ON THE ORIGINAL SURVEY INFORMATION RECEIVED AND ACTUAL LOCATIONS MUST BE ESTABLISHED ON SITE OR BY FURTHER DETAILED SURVEYING.
8. NO ALLOWANCE HAS BEEN MADE FOR EARTHWORKS BULKING.

CONTINUES ON CV-0001

THIS PLAN TO BE READ IN CONJUNCTION WITH

MOD2016/0236

NORTHERN BEACHES COUNCIL

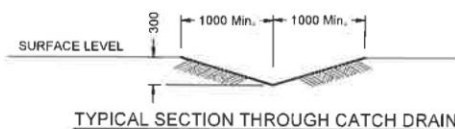

NOTE:
REFER TO PROPOSED CONTOURS FOR EXACT
PROFILE OF CATCH DRAIN REQUIRED IN FINAL STATE

DRAINAGE AREA 0.6ha MAX. - SLOPE GRADIENT 1:2 MAX.
SLOPE LENGTH 60m MAX.

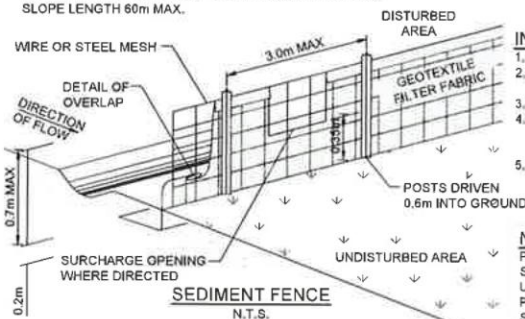

INSTALLATION

1. EXCAVATE A TRENCH 200mm DEEP.
2. DRIVE POSTS 500-700mm INTO GROUND AT A MAXIMUM SPACING OF 3.0m CENTRES.
3. PLACE AND FIX SUPPORT MESH (F52) TO POST.
4. LAY BIDIM GEOTEXTILE (SF 2000) AGAINST THE SUPPORT MESH AND FIX BY TIE WIRE, STAPLES OR HOG RINGS.
5. PLACE BIDIM IN TRENCH AND BACKFILL WITH SOIL.

NOTE:
POSITION OF SEDIMENT FENCE AS DIRECTED BY SUPERINTENDENT. FENCE TO REMAIN IN PLACE UNTIL EXCAVATION IS BELOW FOOTPATH LEVEL. PROVIDE 2m x 2m TURFED AREA ON DOWNSTREAM SIDE OF FENCE AT SURCHARGE OPENINGS.

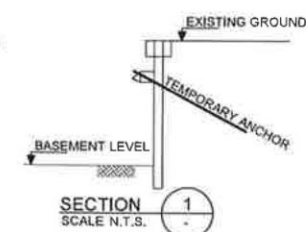
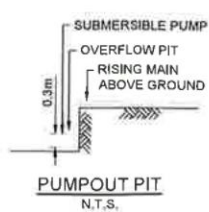
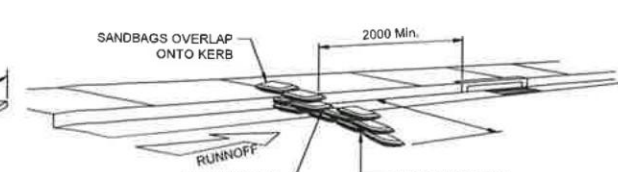
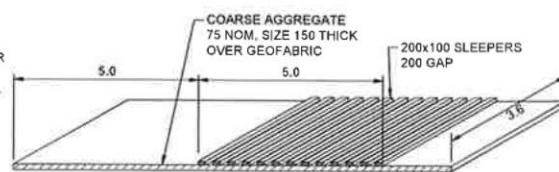

NOT FOR CONSTRUCTION

SCALE 1:250



EROSION AND SEDIMENT LEGEND:

- PROPOSED SEDIMENT FENCE
- PROPOSED SHAKER GRID AND WASH DOWN FACILITY
- PROVIDE TEMPORARY SANDBAGS AROUND PITS:
 1. AFTER PAVEMENT WORKS ARE COMPLETE IF WORKS ARE ONGOING UPSTREAM
 2. TO EXISTING GRATED PITS DOWNSTREAM OF CONSTRUCTION WORKS
- FLOW DIRECTION
- BASEMENT EXTENT
- TEMPORARY CATCH DRAIN
- 750DIA CFA PILE TO ROCK

NOTE:
REFER TO ARCHITECTURAL PLANS FOR DETAILED FINISHED LEVELS.

rev	date	description	dwn	chk
05	15/08/16	ISSUED FOR APPROVAL	AN	AN
04	01/10/15	ISSUED FOR APPROVAL	DC	DC
03	17/09/15	ISSUED FOR APPROVAL	DC	DC
02	22/07/15	ISSUED FOR APPROVAL	CF	DC
01	25/06/15	ISSUED FOR APPROVAL	IH	IH

enstruct group pty ltd

Level 4, 2 Glen Street
Milsom Point NSW 2061
Australia
Telephone (02) 8904 1444
Facsimile (02) 8904 1555
www.enstruct.com.au

enstruct

DEE WHY TOWN CENTRE

EARLY WORKS
BULK EARTHWORKS
SHORING, SEDIMENT &
EROSION CONTROL PLAN

FOR APPROVAL

scale at A1	drawn by	checked	date
AS NOTED	I. HARRIS	I. HARRIS	JUN-15
project no.	drawing no.	rev.	
4963	CV-0002	05	

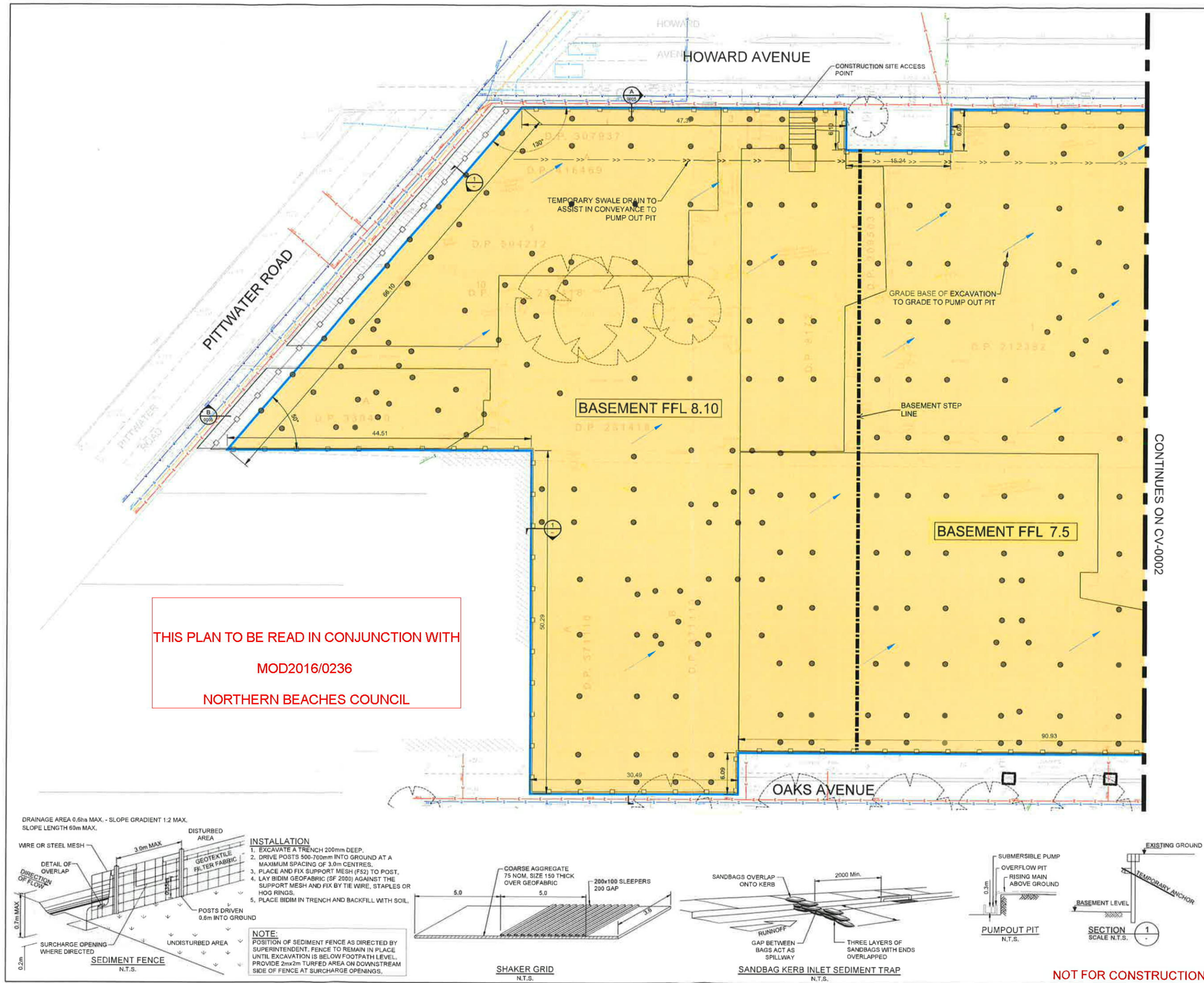

SCALE 1:250
0 5 10 15 m



EROSION AND SEDIMENT LEGEND:

- PROPOSED SEDIMENT FENCE
- PROPOSED SHAKER GRID AND WASH DOWN FACILITY
- PROVIDE TEMPORARY SANDBAGS AROUND PITS:
1. AFTER PAVEMENT WORKS ARE COMPLETE IF WORKS ARE ONGOING UPSTREAM TO EXISTING GRATED PITS
2. TO EXISTING GRATED PITS DOWNSTREAM OF CONSTRUCTION WORKS
- FLOW DIRECTION
- BASEMENT EXTENT
- TEMPORARY CATCH DRAIN
- 750DIA CFA PILE TO ROCK

NOTE:
REFER TO ARCHITECTURAL PLANS FOR DETAILED FINISHED LEVELS.

rev	date	description	dwn	ch'k
07	15/08/16	ISSUED FOR APPROVAL	AN	AN
06	01/10/15	ISSUED FOR APPROVAL	DC	DC
05	17/09/15	ISSUED FOR APPROVAL	DC	DC
04	22/07/15	ISSUED FOR APPROVAL	CF	DC
03	01/07/15	ISSUED FOR APPROVAL	IH	IH
02	30/06/15	ISSUED FOR APPROVAL	IH	IH
01	25/06/15	ISSUED FOR APPROVAL	IH	IH

enstruct group pty ltd

Level 4, 2 Glen Street
Milsoms Point NSW 2061
Australia

Telephone (02) 8904 1444
Facsimile (02) 8904 1555
www.enstruct.com.au

enstruct

project
DEE WHY TOWN CENTRE

drawing title
**EARLY WORKS
BULK EARTHWORKS
SHORING, SEDIMENT &
EROSION CONTROL PLAN**

status
FOR APPROVAL

scale at A1
AS NOTED

drawn by
I. HARRIS

checked
I. HARRIS

date
JUN-15

project no.
4963

drawing no.
CV-0001

rev.
07

NOT FOR CONSTRUCTION

DRAINAGE AREA 0.6ha MAX. - SLOPE GRADIENT 1:2 MAX.
SLOPE LENGTH 60m MAX.

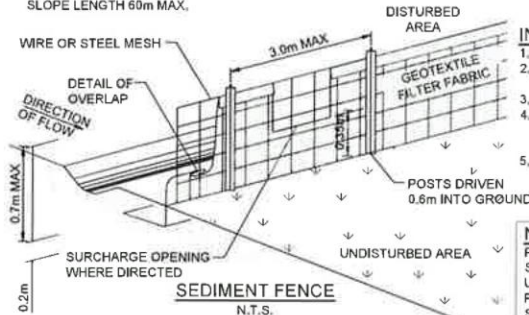

INSTALLATION

1. EXCAVATE A TRENCH 200mm DEEP.
2. DRIVE POSTS 500-700mm INTO GROUND AT A MAXIMUM SPACING OF 3.0m CENTRES.
3. PLACE AND FIX SUPPORT MESH (F52) TO POST.
4. LAY BIDIM GEOTEXTILE (SF 2000) AGAINST THE SUPPORT MESH AND FIX BY TIE WIRE, STAPLES OR HOG RINGS.
5. PLACE BIDIM IN TRENCH AND BACKFILL WITH SOIL.

NOTE:
POSITION OF SEDIMENT FENCE AS DIRECTED BY SUPERINTENDENT. FENCE TO REMAIN IN PLACE UNTIL EXCAVATION IS BELOW FOOTPATH LEVEL. PROVIDE 2m x 2m TURFED AREA ON DOWNSTREAM SIDE OF FENCE AT SURCHARGE OPENINGS.

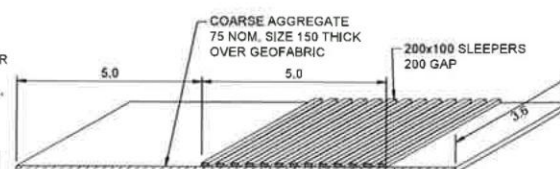

SHAKER GRID
N.T.S.

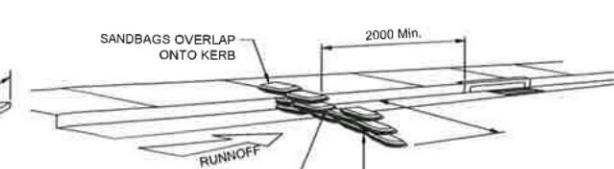

SANDBAG KERB INLET SEDIMENT TRAP
N.T.S.

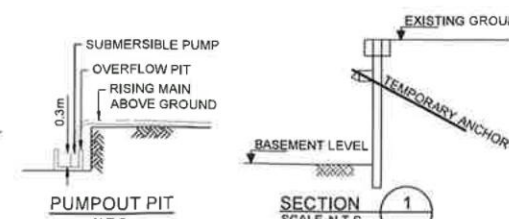

SECTION
SCALE N.T.S.