

EAVES GUTTER SPECIFICATION:

EAVES GUTTER GRADIENTS TO BE 1:500 OR GREATER.

EAVES GUTTER TO HAVE AN EFFECTIVE CROSS SECTIONAL AREA AS PER TABLE ABOVE.

DOWNPIPES CROSS-SECTION TO BE AS PER TABLE ABOVE.

FASCIA TO BE A MINIMUM OF 14mm ABOVE GUTTER OVERFLOW.

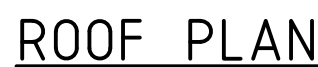

LEGEND
VERTICAL DOWN PIPE = ● DP
HIGH POINT = HP



LEGEND

VERTICAL DOWN PIPE = ●

DOWN PIPE = DP

UNDERGROUND SERVICES
DIAL 1100 BEFORE YOU DIG FOR LOCATION OF UNDERGROUND SERVICES PRIOR TO ANY CONSTRUCTION WORKS.

CONTACT TELSTRA FOR WRITTEN PERMISSION TO MAINTAIN OR RELOCATE ANY EXISTING SERVICE PIT.

ALL SERVICES ARE TO MATCH INTO THE NEW FOOTPATH LEVELS
CONTACT THE RELEVANT AUTHORITY FOR ADJUSTMENT TO SERVICES.

THIS STORMWATER MANAGEMENT PLAN IS SUBJECT TO
COUNCIL APPROVAL

DRAINAGE LINES LOCATIONS ARE INDICATIVE ONLY AND MAY VARY DUE TO SITE CONSTRAINTS. FINAL PIPES LOCATIONS TO BE COORDINATED ON SITE WITH OTHER SERVICES & BUILDERS.

ALL PIPES INCL. DOWN PIPES SHALL BE SEWER GRADE
uPVC WITH SOLVENT WELDED JOINTS (U.N.O.).



ALL PLUMBING WITHIN THE SITE MUST BE CARRIED OUT IN ACCORDANCE WITH
RELEVANT PROVISIONS OF AUSTRALIAN STANDARD AS/NZS 3500.3-2003
PLUMBING AND DRAINAGE - STORMWATER DRAINAGE.

ALL LEVELS ARE TO AUSTRALIAN HEIGHT DATUM. (AHD)

DO NOT SCALE FROM THE DRAWINGS

THE CONTRACTOR MUST VERIFY ALL DIMENSIONS AND EXISTING LEVELS ON SITE PRIOR TO COMMENCEMENT OF WORKS, REPORT ANY DISCREPANCIES TO THE SUPERINTENDENT OR DESIGN ENGINEER.

ALL WORK IS TO BE CARRIED OUT IN ACCORDANCE WITH THE DETAILS SHOWN
ON THE DRAWINGS AND SPECIFICATION.

READ THESE PLANS IN CONJUNCTION WITH APPROVED ARCHITECTURAL,
STRUCTURAL, HYDRAULIC AND MECHANICAL DRAWINGS AND SPECIFICATION.

WHERE NEW WORK ABUTS EXISTING, THE CONTRACTOR SHALL ENSURE THAT A SMOOTH EVEN PROFILE, FREE FROM ABRUPT CHANGES, IS OBTAINED.

DESIGN LEVELS GIVEN ARE TO FINISHED SURFACE LEVEL AND INCLUSIVE OF TOPSOIL. (TOPSOIL DEPTH VARIES).

THE CONTRACTOR SHALL ARRANGE ALL SURVEY SETOUT TO BE CARRIED OUT BY A REGISTERED SURVEYOR.

CARE IS TO BE TAKEN WHEN EXCAVATING NEAR EXISTING SERVICES.
NO MECHANICAL EXCAVATIONS ARE TO BE UNDERTAKEN OVER TELECOM OR
ELECTRICAL SERVICES. HAND EXCAVATE IN THESE AREAS.

ALL BUILDING SURROUND SHOULD BE GRADED TO ENSURE OVERLAND FLOW FROM UPSTREAM AREAS CAN DRAIN AROUND THE FOUNDATIONS, WALLS OF BUILDING.

ALL EXCAVATION SHORING OF EXCAVATION AND STABILITY OF ADJACENT STRUCTURES SHALL BE THE RESPONSIBILITY OF THE CONTRACTOR.

DURING CONSTRUCTION, THE STRUCTURE SHALL BE MAINTAINED IN A STABLE CONDITION AND NO PART SHALL BE OVERSTRESSED.

WORKMANSHIP AND MATERIALS SHALL CONFORM WITH THE REQUIREMENTS OF THE RELEVANT SAA CODES, BCA REQUIREMENTS AND THE SPECIFICATION, BY-LAWS AND ORDINANCIES OF THE RELEVANT AUTHORITIES.

PROPRIETARY PRODUCTS USED SHALL BE INSTALLED TO MANUFACTURERS SPECIFICATION AND TO THE SATISFACTION OF THE SUPERINTENDENT.

ALL ACTIVITIES AND WORKS EXTERNAL TO THE SITE, OR THAT AFFECT PUBLIC ROADS, ARE TO BE CARRIED OUT IN ACCORDANCE WITH COUNCIL'S CODES AND STANDARDS.

PUBLIC FOOTPATHS SHALL BE RECONSTRUCTED TO THE SATISFACTION OF COUNCIL'S DIRECTOR OF ENGINEERING SERVICES. A ROAD OPENING PERMIT SHALL BE OBTAINED FOR ALL WORKS CARRIED OUT IN A PUBLIC OR COUNCIL CONTROLLED LAND. RESTORATION OF LANDSCAPING, ROADS AND PATHS SHALL BE TO COUNCIL'S REQUIREMENTS. ALL OTHER RESTORATION SHALL BE TO THE SATISFACTION OF THE AFFECTED PARTIES.

WHERE WORKS ARE UNDERTAKEN ON PUBLIC ROADS, ADEQUATE TRAFFIC CONTROL AND DIRECTIONS TO MOTORISTS SHALL BE PROVIDED.

PITS DEEPER THAN 1200mm TO BE FITTED WITH STEP IRONS AT 300mm CENTRES AND STAGGERED.

APPROVED PRECAST PITS MAY BE USED

DIAMETER 100mm HOLE FOR SUBSOIL DRAINAGE OUTLET TO BE LOCATED 100mm ABOVE INVERT OF ALL INLET PIPES. DIAMETER 100mm SUBSOIL DRAINAGE TO EXTEND FOR A DISTANCE OF 3.0m UPSTREAM OF PIT (AT EACH INLET PIT) WITH THE UPSTREAM END SEALED.

ALL CONNECTIONS TO THE EXISTING DRAINAGE PITS SHALL BE MADE IN A TRADESMAN LIKE MANNER AND THE INTERNAL WALL OF THE PIT AT THE POINT OF ENTRY SHALL BE CEMENT RENDERED TO ENSURE A SMOOTH FINISH.

PIT GRATES AND SOLID COVERS SHALL BE CLASS 'B' IN NON TRAFFIC AREAS AND CLASS 'D' IN TRAFFIC AREAS IN ACCORDANCE WITH AS 3996.

EXISTING PIPES WHICH FORM NO PART OF THE DRAINAGE SYSTEM SHALL BE REMOVED OR SANDFILLED AS INDICATED ON THE PLANS.

PIPE LENGTHS MEASURED ARE BETWEEN PIT CENTRES.

ALL DRAINAGE PIPES LESS THAN 300mm DIAMETER SHALL BE SEWER GRADE uPVC WITH SOLVENT WELDED JOINTS (U.N.O.). ALL PIPE JUNCTIONS AND TAPERS SHALL BE VIA. PURPOSE MADE FITTINGS.

MINIMUM GRADE TO DRAINAGE PIPES TO BE 1.5% U.N.O.

MINIMUM PIPE SIZE TO BE 150mm DIAMETER U.N.O.

THE CONTRACTOR IS TO SUPPLY AND INSTALL ALL FITTINGS AND SPECIALS INCLUDING VARIOUS PIPE ADAPTORS TO ENSURE PROPER CONNECTION BETWEEN DISSIMILAR PIPEWORK.

I AM A QUALIFIED CIVIL ENGINEER. I HOLD THE FOLLOWING QUALIFICATIONS: EngSc (Civil/Structural), MIEAust. NEER
I HEREBY STATE THAT THESE PLANS OR DETAILS COMPLY WITH THE CONDITIONS OF DEVELOPMENT CONSENT, THE
PROVISIONS OF THE BUILDING CODE OF AUSTRALIA AND/OR RELEVANT AUSTRALIAN INDUSTRY STANDARDS.
DATE: 08/08/25

Michal Korecky

1	ISSUED FOR DA ONLY	08/08/25
No.	AMENDMENT	DATE
COPYRIGHT: ALL PLANS AND DRAWINGS ARE SUBJECT OF COPYRIGHT AND ANY ATTEMPT OR ACTUAL INFRINGEMENT BY USING, REPRODUCING OR COPYING SAME, WHOLLY OR IN PART, WITHOUT PRIOR WRITTEN PERMISSION WILL RESULT IN LEGAL PROCEEDINGS.		

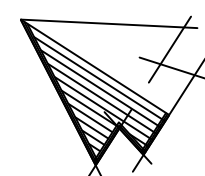

DESIGN BY:
MICHAL KORECKY
21 NALYA ROAD, NARRAWEENA NSW 2099
ABN: 79 393 130 294
Email: koreckym@gmail.com
MOB: 0438148944

PROJECT:
NEW BATTING CAGES
AQUATIC RESERVE
FRENCHS FOREST NSW 2086
CLIENT:
MANLY EAGLES BASEBALL CLUB

DATE: 08/08/25	SCALE: AS NOTED
DRAWN: MK	ISSUE: 1
DRAWING Nr : 25047	SHEET: SW-1