

NOT FOR CONSTRUCTION

1	DEVELOPMENT APPLICATION	AZ	RI	RI	17.12.24
No	Revision	Note: * indicates signatures on original issue of drawing or last revision of drawing	Drawn	Job Manager	Project Director

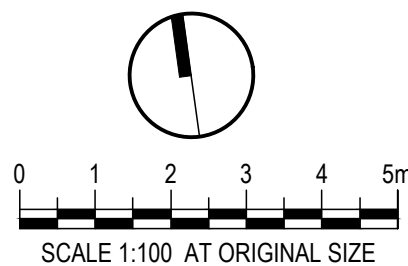

CLIENT

TIME & PLACE

ARCHITECT

smart design studio

LANDSCAPE

LAND AND FORM

DO NOT SCALE

Conditions of Use.
This document may only be used by the client (and any other person who the client has agreed can use this document) for the purpose for which it was prepared and must not be used by any other person or for any other purpose.

Drawn RI

Drafting Check CR
Approved (Project Director) Date

Scale

Designer CR/ RI

Design Check CR

This Drawing must not be used for Construction unless signed as Approved

Client

Project

Title

Original Size

MANLY LAND 101 PTY LTD C/O TIME & PLACE
101 NORTH STEYNE MANLY
GROUND FLOOR & PUBLIC DOMAIN PLAN

A1 Drawing No: LD-DA100

Rev: 1



NOT FOR CONSTRUCTION

[illegible]

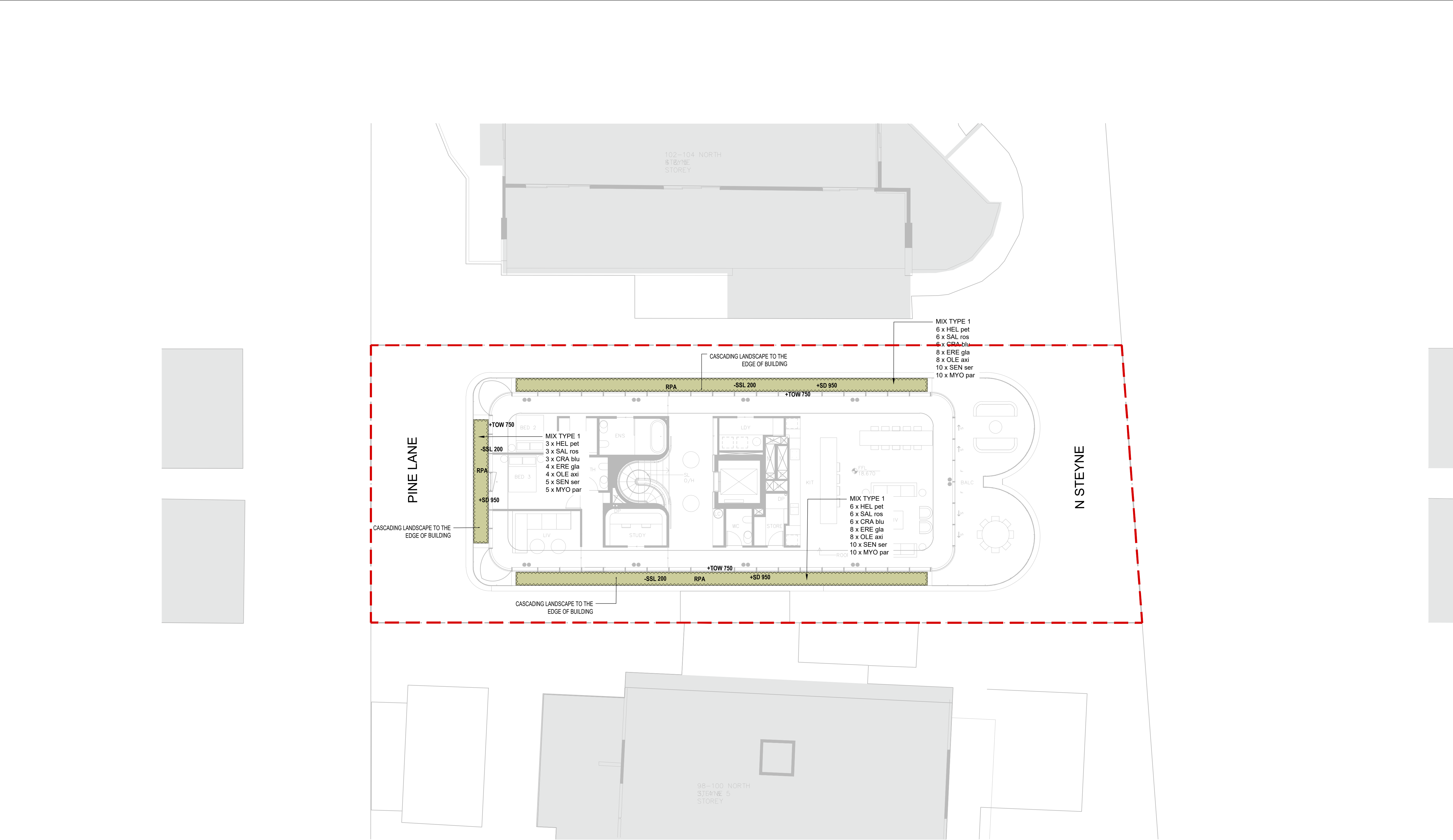

NOT FOR CONSTRUCTION

1	DEVELOPMENT APPLICATION		AZ	RI	RI	17.12.24
No	Revision	Note: * indicates signatures on original issue of drawing or last revision of drawing	Drawn	Job Manager	Project Director	Date

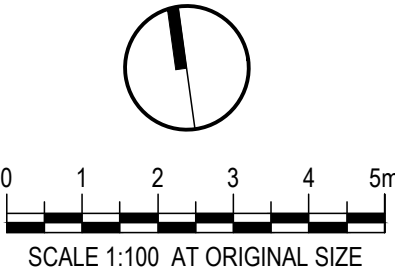

CLIENT



ARCHITECT

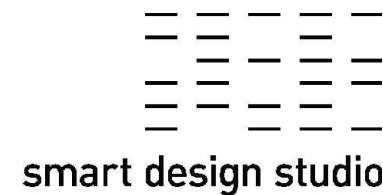

LANDSCAPE



DO NOT SCALE

Conditions of Use.
This document may only be used by the client (and any other person who the client has agreed can use this document) for the purpose for which it was prepared and must not be used by any other person or for any other purpose.

Drawn

RI

Designer

CR/RI

Drafting

CR

Design

CR

Approved
(Project Director)
Date

Scale

1:100

This Drawing must not be used for Construction unless signed as Approved

Client

MANLY LAND 101 PTY LTD C/O TIME & PLACE

Project

101 NORTH STEYNE MANLY

Title

LEVEL 04 PLAN AND PLANTING PLAN

Original Size

A1

Drawing No:

LD-DA120

Rev: 1



01 TYPICAL SECTION AA
1:100

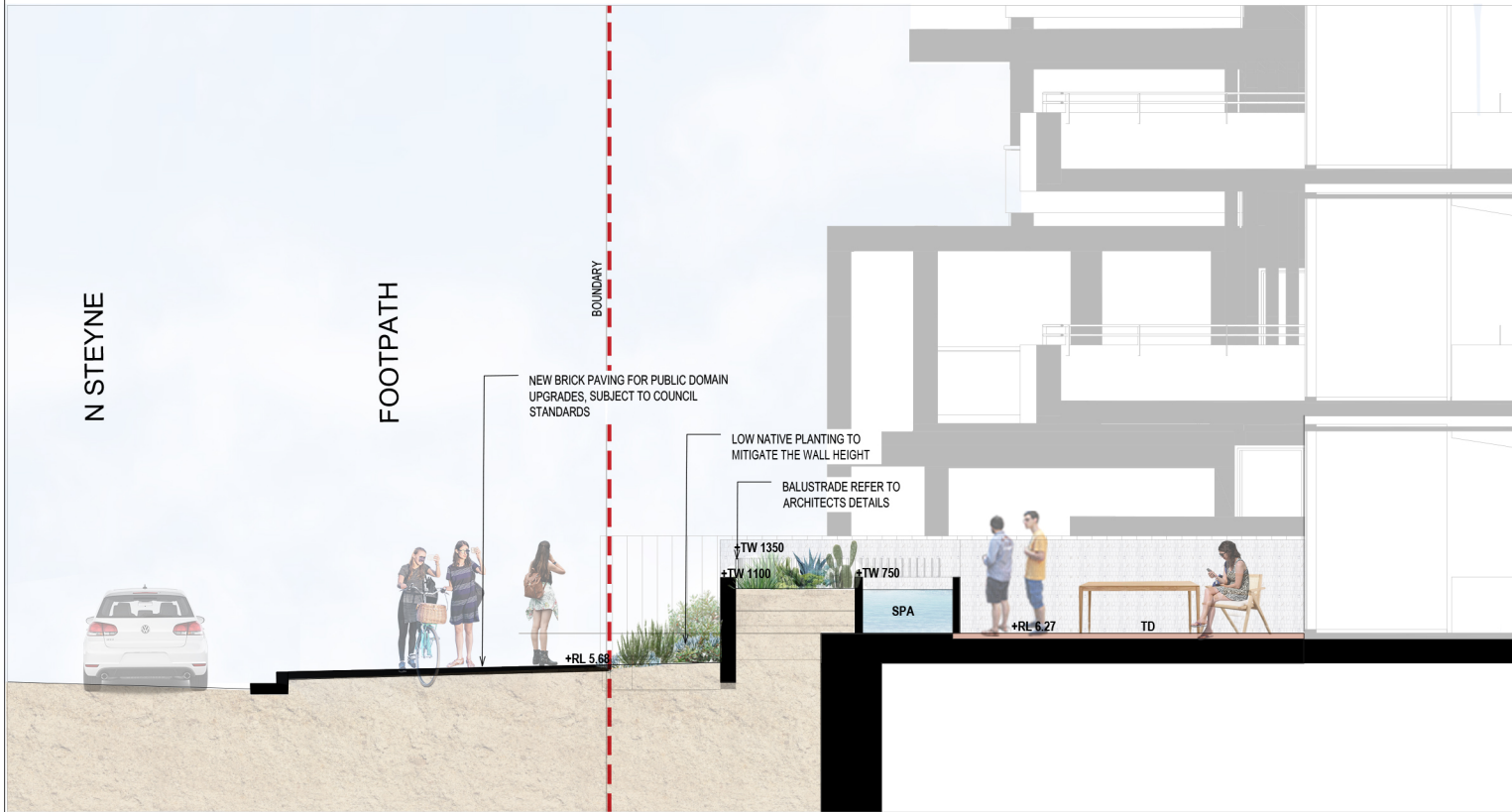

01 DETAIL SECTION 01
1:50

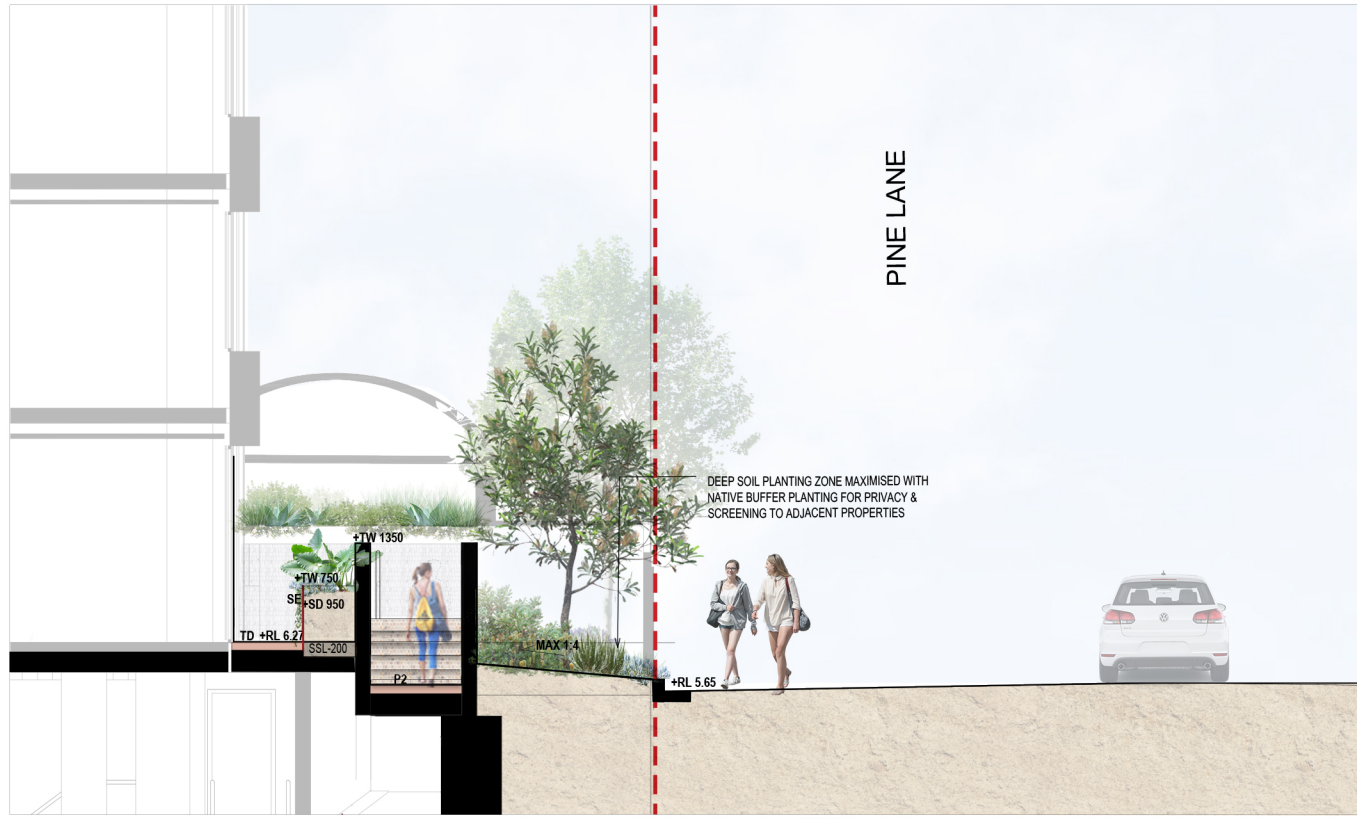

02 DETAIL SECTION 02
1:50

NOT FOR CONSTRUCTION

1	DEVELOPMENT APPLICATION	AZ	RI	RI	17.12.24
No	Revision	Note: * indicates signatures on original issue of drawing or last revision of drawing	Drawn	Job Manager	Project Director

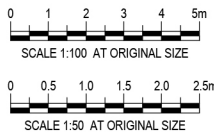

CLIENT



ARCHITECT

smart design studio

LANDSCAPE

LAND AND FORM

DO NOT SCALE

Conditions of Use.
This document may only be used by the client (and any other person who the client has agreed can use this document) for the purpose for which it was prepared and must not be used by any other person or for any other purpose.

Drawn RI

Drafting Check CR
Approved (Project Director)
Date

Scale 1:100

Designer CR/RI

Design Check CR

This Drawing must not be used for Construction unless signed as Approved

Client **MANLY LAND 101 PTY LTD C/O TIME & PLACE**
Project **101 NORTH STEYNE MANLY**
Title **SECTION A**

Original Size **A1** Drawing No: **LD-DA400**

Rev: 1

LANDSCAPE OUTLINE SPECIFICATION NOTES

GENERAL:

Note the following is an outline specification for DA purposes only.

All works are to be performed by suitably qualified and experienced trades persons in landscape works. All works shall be supervised by a qualified superintendent.

SERVICES IDENTIFICATION

The contractor shall verify the position of all services prior to the commencement of works and take all necessary precautions to protect services during implementation works.

SITE ESTABLISHMENT

The contractor shall establish site access and compound in position agreed with the Superintendent and or subject to Council approval. The Contractor shall be totally responsible for protecting the site works during construction and establishment including vegetation, pedestrian and vehicular management. Implement erosion control and site management practices to secure the site and to comply with all statutory requirements.

EARTHWORKS & DRAINAGE

Bulk earthworks are by the civil contractor. The landscape contractor shall allow for minor earth trimming and profiling to prepare landscape areas to accept the nominated treatment. Protect exposed earthworks with temporary erosion measures and coordinate the on-site disposal of excess spoil with the Superintendent.

SUBSOIL AGRICULTURAL DRAINS:

All tree positions shall be free draining with positive drainage to SW outlets or natural drainage systems. Install 100mm diameter agg. drains including 200mm wide column of 10-20mm crushed drainage gravel and geo-textile fabric - Bidum A24. Seek direction from the site superintendent.

PIT LIDS:

The Contractor is to protect all pit lids during earthworks preperation. Retain Telstra concrete oval covers & pit checker plate steel pit covers, and concrete service pits. New pit lids are to be suitable for paver infill.

HARD LANDSCAPE WORKS

PAVEMENTS:

Modular Pavement Systems - Pedestrian: Stone paving product
Pavements systems shall conform to the approved Public Domain Framework and or Council's streetscape guidelines to the extent defined on the landscape plans. Supply and install pavements to the pattern nominated over concrete base including; base preparation, mortar bedding, placement, mechanical cutting, expansion | control joints, grout jointing and finishing to achieve levels and positive drainage.

ROADWORKS: Refer to Engineers drawings for grading, materials and set-out.

FURNITURE & FIXINGS

Supply and install furniture and fixing in the positions nominated on the plans or as agreed on site with the superintendent. All items are to be installed on concrete base slab or in-ground footings strictly in accordance with the manufacturer's specification. Where necessary, allow for cutting of pavements and or core drilling installation method.
The pavements shall comply with Council and Australian Standards

LIGHTING

Refer to the electrical engineer's plans for lighting circuits and installation. The general layout are nominated on the landscape plans.

SOFT LANDSCAPE WORKS

SOIL MIX:

Imported Soil Mix:
All planter areas shall have a minimum soil depth of 300mm and 100mm to turf | grass areas with landscape quality soil that conforms to AS 4419 Soils for Landscaping and Gardens.

Ameliorated site topsoil mix:
The Contractor is to use stockpiled site topsoil adding soil additives and chemicals; lime gypsum and fertiliser nutrients to achieve AS4419.

SAMPLE & TESTING:

Provide 1kg soil mix test sample and data to of imported or modify site soil , clearly

identified and referenced to the test data, prepared by an independent soil laboratory. Submit to the Superintendent for approval prior to supply and placement.

FERTILISER: Apply slow release Organic fertiliser at the time of planting with pellets to advanced tree positions strictly in accordance with the manufacturers specification and with regard to season, soil mix, watering regimes and sub grade conditions.

PLANT MATERIALS:

Refer to the plant schedule. The contractor shall ensure that all plant materials are secured immediately upon award of contract. Failure to do so will not give rise to substitutions or extensions of time. All stock shall be grown in open areas which are exposed to the sun and wind to promote vigorous plant growth and to harden plants off. All plant material shall be pest and disease free. All plant material shall not be root bound or damaged. Plant densities shall reflect accepted industry standards and Councils guidelines for Landscape Works and be sourced from an accredited nursery. The Contractor will be responsible for purchasing and coordination of delivery to satisfy the construction program. It is the Contractor's responsibility to check trees at the supply source and to accept delivery of the trees at site, ensuring that the trees are supplied in accordance with the specification and are in good health. The Contractor shall allow for unloading and placement of all advanced tree materials.

All bag stock shall conform to the specification and must be secured from an Accredited Nursery. The current Natspec Guide "Purchasing Landscape Trees" is a **guide only** for quality tree production. All trees must be able to be planted without the use of tree stakes. Any trees requiring staking to be held vertical shall be rejected.

ADVANCED TREES:

Plant stock shall have a well developed straight stem with tri-branching structure and healthy canopy typical to the species and to the minimum sizes scheduled.

Excavate a hole a minimum 2X wider than the root ball and deep enough to accept a minimum 200mm of topsoil below. Break up the base of the hole to a further depth of 200mm, and loosen compacted sides of the hole as necessary to prevent confinement of root growth to the hole. Loosen sides of root ball to promote growth. Backfill with nominated soil mix, lightly tamp and water to eliminate air pockets. Ensure positive drainage to all tree positions.

Supply and install root barrier as nominated and staking as detailed on plans.

IRRIGATION SYSTEM: Supply and install an automatically controlled system to landscape areas identified on the plans to achieve 25mm/week precipitation rate. This system shall have a rain switch and have backflow prevention devices fitted in accordance with Councils regulations.

MAINTENANCE PERIOD:

General
Planting maintenance period: the planting maintenance period will be 52 weeks and will commence from the date of practical completion. Of each phase of planting works (hereby specified to be a separable part of the works). It is anticipated that planting works will be undertaken in one phase
Planting maintenance program: 2 weeks prior to practical completion, furnish a proposed planting establishment program, and amend it as required. Such proposal should contain details of the types and frequency of maintenance activities involved with the establishment of plants and grassed areas. Comply with the approved program.
Planting maintenance log book: keep a log book recording when and what maintenance work has been done and what materials, including approved toxic materials, have been used. Log book must be signed off by the client's representative after each maintenance visit. Maintain log book in location nominated by superintendent. All entries are to be initialised by person nominated by superintendent. Log book to contain a copy of the approved planting establishment program.
Product warranty: submit the supplier's written statement certifying that plants are true to the required species and type, and are free from diseases, pests and weeds.
Insurance: the contractor is to ensure suitable insurance cover and / or bank guarantee is in place for the theft and / or damage of all works executed under this contract for the plant maintenance period.

All Drawings To Be Read In Conjunction With Structural, Mechanical, Hydraulic and Electrical Engineers' Detail Drawings And Specifications.

*** ALL WORKS WITHIN THE PUBLIC DOMAIN IN ACCORDANCE WITH NORTHERN BEACHES COUNCIL SPECIFICATION AND DETAILS**

All Levels Indicated Taken To Australian Height Datum (AHD)

Refer to Detail Drawings For Typical Details.

Generally All Materials & Construction to Comply To AS 3700

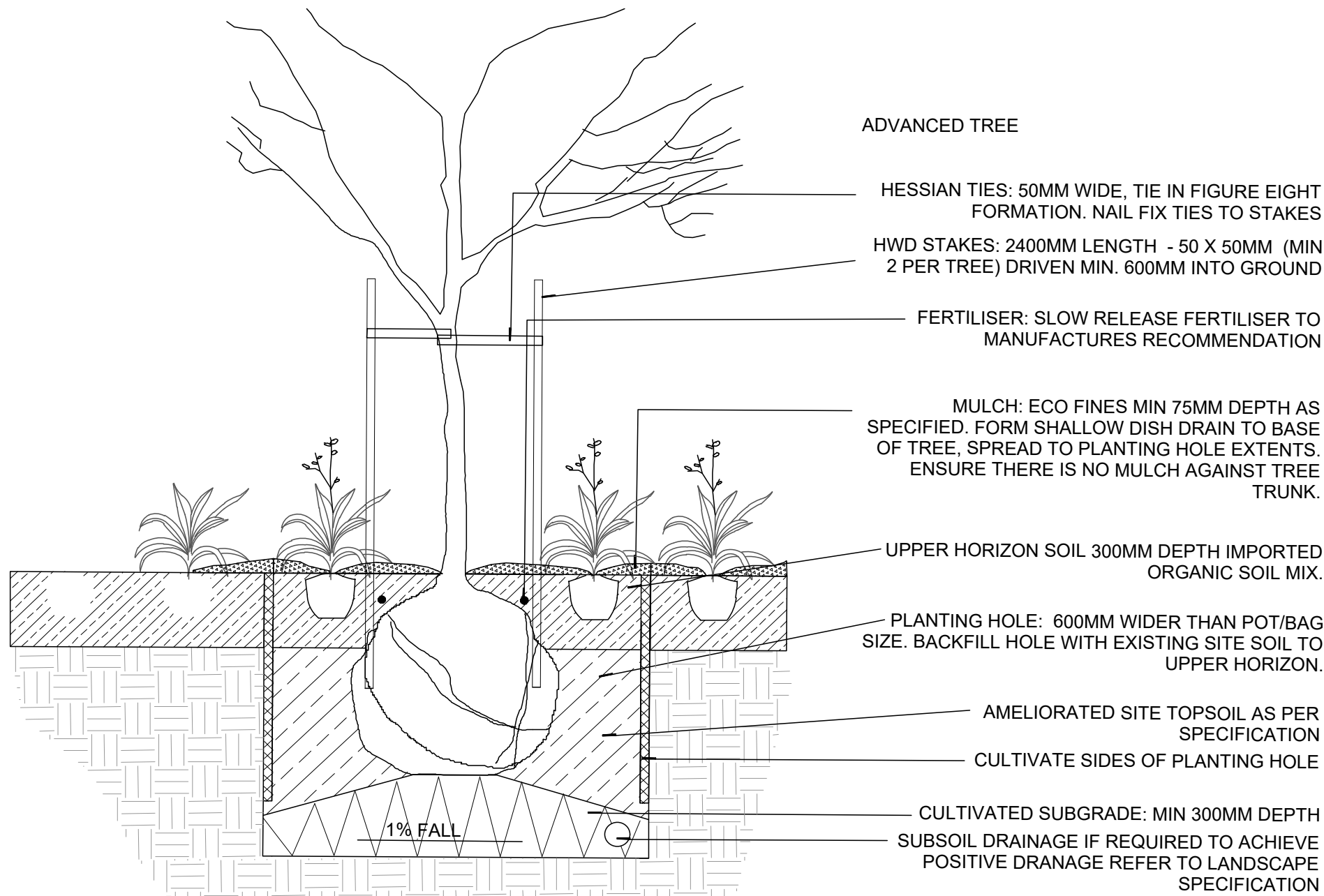

1 TYPICAL TREE DETAIL IN DEEP SOIL
1:20

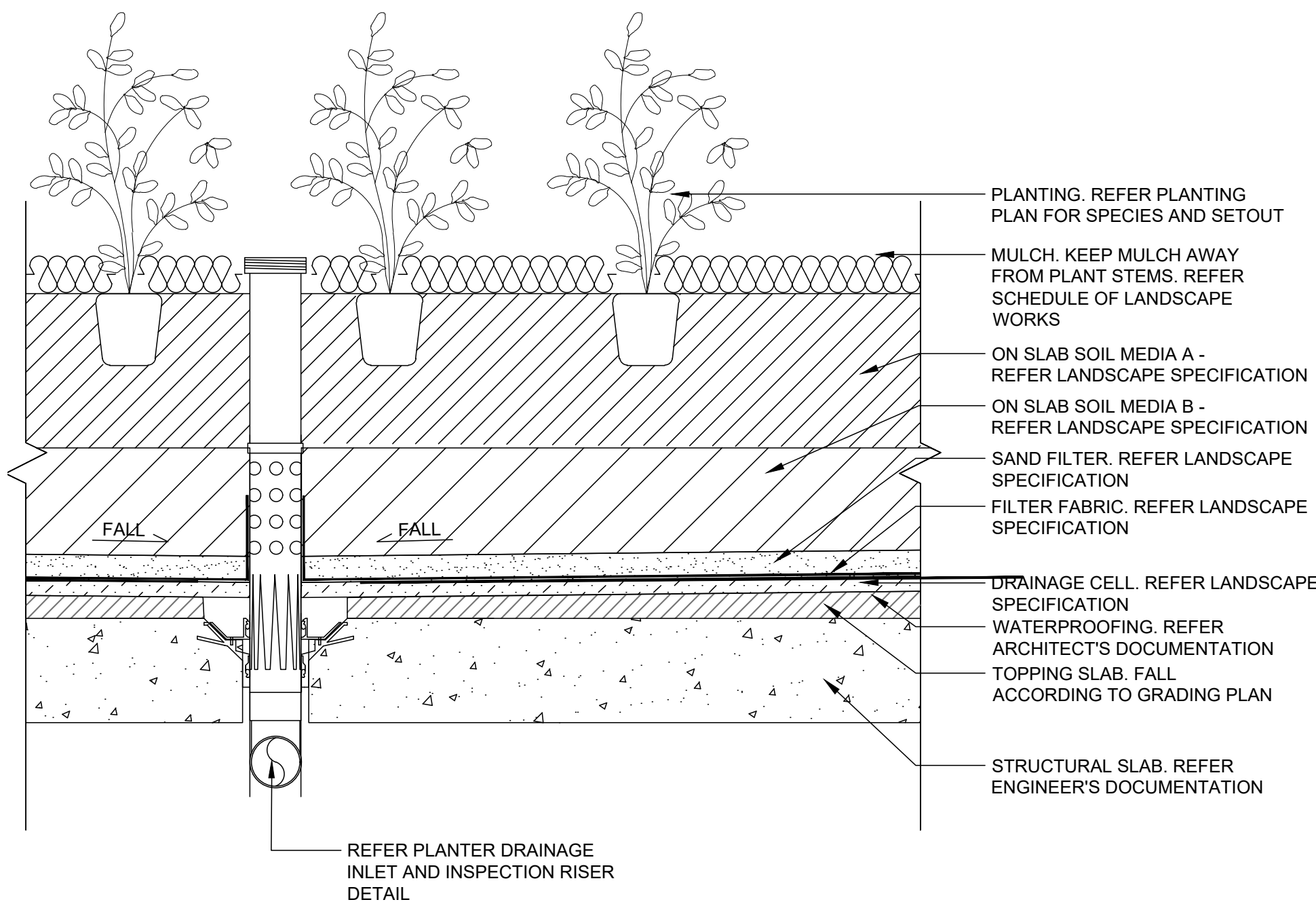

2 TYPICAL DETAIL: PLANTING ON SLAB
1:10

NOT FOR CONSTRUCTION

--	--	--	--	--	--	--	--	--	--	--	--	--	--	--	--	--	--	--	--	--	--	--	--	--	--	--	--	--	--	--	--	--	--	--	--	--	--	--	--	--	--	--	--	--	--	--	--	--	--	--	--	--	--	--	--	--	--	--	--	--	--	--	--	--	--	--	--	--	--	--	--	--	--	--	--	--	--	--	--	--	--	--	--	--	--	--	--	--	--	--	--	--	--	--	--	--	--	--	--	--	--	--	--	--	--	--	--	--	--	--	--	--	--	--	--	--	--	--	--	--	--	--	--	--	--	--	--	--	--	--	--	--	--	--	--	--	--	--	--	--	--	--	--	--	--	--	--	--	--	--	--	--	--	--	--	--	--	--	--	--	--	--	--	--	--	--	--	--	--	--	--	--	--	--	--	--	--	--	--	--	--	--	--	--	--	--	--	--	--	--	--	--	--	--	--	--	--	--	--	--	--	--	--	--	--	--	--	--	--	--	--	--	--	--	--	--	--	--	--	--	--	--	--	--	--	--	--	--	--	--	--	--	--	--	--	--	--	--	--	--	--	--	--	--	--	--	--	--	--	--	--	--	--	--	--	--	--	--	--	--	--	--	--	--	--	--	--	--	--	--	--	--	--	--	--	--	--	--	--	--	--	--	--	--	--	--	--	--	--	--	--	--	--	--	--	--	--	--	--	--	--	--	--	--	--	--	--	--	--	--	--	--	--	--	--	--	--	--	--	--	--	--	--	--	--	--	--	--	--	--	--	--	--	--	--	--	--	--	--	--	--	--	--	--	--	--	--	--	--	--	--	--	--	--	--	--	--	--	--	--	--	--	--	--	--	--	--	--	--	--	--	--	--	--	--	--	--	--	--	--	--	--	--	--	--	--	--	--	--	--	--	--	--	--	--	--	--	--	--	--	--	--	--	--	--	--	--	--	--	--	--	--	--	--	--	--	--	--	--	--	--	--	--	--	--	--	--	--	--	--	--	--	--	--	--	--	--	--	--	--	--	--	--	--	--	--	--	--	--	--	--	--	--	--	--	--	--	--	--	--	--	--	--	--	--	--	--	--	--	--	--	--	--	--	--	--	--	--	--	--	--	--	--	--	--	--	--	--	--	--	--	--	--	--	--	--	--	--	--	--	--	--	--	--	--	--	--	--	--	--	--	--	--	--	--	--	--	--	--	--	--	--	--	--	--	--	--	--	--	--	--	--	--	--	--	--	--	--	--	--	--	--	--	--	--	--	--	--	--	--	--	--	--	--	--	--	--	--	--	--	--	--	--	--	--	--	--	--	--	--	--	--	--	--	--	--	--	--	--	--	--	--	--	--	--	--	--	--	--	--	--	--	--	--	--	--	--	--	--	--	--	--	--	--	--	--	--	--	--	--	--	--	--	--	--	--	--	--	--	--	--	--	--	--	--	--	--	--	--	--	--	--	--	--	--	--	--	--	--	--	--	--	--	--	--	--	--	--	--	--	--	--	--	--	--	--	--	--	--	--	--	--	--	--	--	--	--	--	--	--	--	--	--	--	--	--	--	--	--	--	--	--	--	--	--	--	--	--	--	--	--	--	--	--	--	--	--	--	--	--	--	--	--	--	--	--	--	--	--	--	--	--	--	--	--	--	--	--	--	--	--	--	--	--	--	--	--	--	--	--	--	--	--	--	--	--	--	--	--	--	--	--	--	--	--	--	--	--	--	--	--	--	--	--	--	--	--	--	--	--	--	--	--	--	--	--	--	--	--	--	--	--	--	--	--	--	--	--	--	--	--	--	--	--	--	--	--	--	--	--	--	--	--	--	--	--	--	--	--	--	--	--	--	--	--	--	--	--	--	--	--	--	--	--	--	--	--	--	--	--	--	--	--	--	--	--	--	--	--	--	--	--	--	--	--	--	--	--	--	--	--	--	--	--	--	--	--	--	--	--	--	--	--	--	--	--	--	--	--	--	--	--	--	--	--	--	--	--	--	--	--	--	--	--	--	--	--	--	--	--	--	--	--	--	--	--	--	--	--	--	--	--	--	--	--	--	--	--	--	--	--	--	--	--	--	--	--	--	--	--	--	--	--	--	--	--	--	--	--	--	--	--	--	--	--	--	--	--	--	--	--	--	--	--	--	--	--	--	--	--	--	--	--	--	--	--	--	--	--	--	--	--	--	--	--	--	--	--	--	--	--	--	--	--	--	--	--	--	--	--	--	--	--	--	--	--	--	--	--	--	--	--	--	--	--	--	--	--	--	--	--	--	--	--	--	--	--	--	--	--	--	--	--	--	--	--	--	--	--	--	--	--	--	--	--	--	--	--	--	--	--	--	--	--	--	--	--	--	--	--	--	--	--	--	--	--	--	--	--	--	--	--	--	--	--	--	--	--	--	--	--	--	--	--	--	--	--	--	--	--	--	--	--	--	--	--	--	--	--	--	--	--	--	--	--	--	--	--	--	--	--	--	--	--	--	--	--	--	--	--	--	--	--	--	--	--	--	--	--	--	--	--	--	--	--	--	--	--	--	--	--	--	--	--	--	--	--	--	--	--	--	--	--	--	--	--	--	--	--	--	--	--	--	--	--	--	--	--	--	--	--	--	--	--	--	--	--	--	--	--	--	--	--	--	--	--	--	--	--	--	--	--	--	--	--	--	--	--	--	--	--	--	--	--	--	--	--	--	--	--	--	--	--	--	--	--	--	--	--	--	--	--	--	--	--	--	--	--	--	--	--	--	--	--	--	--	--	--	--	--	--	--	--	--	--	--	--	--	--	--	--	--	--	--	--	--	--	--	--	--	--	--	--	--	--	--	--	--	--	--	--	--	--	--	--	--	--	--	--	--	--	--	--	--	--	--	--	--	--	--	--	--	--	--	--	--	--	--	--	--	--	--	--	--	--	--	--	--	--	--	--	--	--	--	--	--	--	--	--	--	--	--	--	--	--	--	--	--	--	--	--	--	--	--	--	--	--	--	--	--	--	--	--	--	--	--	--	--	--	--	--	--	--	--	--	--	--	--	--	--	--	--	--	--	--	--	--	--	--	--	--	--	--	--	--	--	--	--	--	--	--	--	--	--	--	--	--	--	--	--	--	--	--	--	--	--	--	--	--	--	--	--	--	--	--	--	--	--	--	--	--	--	--	--	--	--	--	--	--	--	--	--	--	--	--	--	--	--	--	--	--	--	--	--	--	--	--	--	--	--	--	--	--	--	--	--	--	--	--	--	--	--	--	--	--	--	--	--	--	--	--	--	--	--	--	--	--	--	--	--	--	--	--	--	--	--	--	--	--	--	--	--	--	--	--	--	--	--	--	--	--	--	--	--	--	--	--	--