

DEVELOPMENT APPLICATION ASSESSMENT REPORT

Application Number:	DA2024/0908
----------------------------	-------------

Responsible Officer:	Michael French
Land to be developed (Address):	Lot 287 DP 235073, 72 Frenchs Forest Road SEAFORTH NSW 2092
Proposed Development:	Demolition works and construction of a dwelling house
Zoning:	Manly LEP2013 - Land zoned R2 Low Density Residential
Development Permissible:	Yes
Existing Use Rights:	No
Consent Authority:	Northern Beaches Council
Land and Environment Court Action:	No
Applicant:	Daniel Lister

Application Lodged:	19/07/2024
Integrated Development:	No
Designated Development:	No
State Reporting Category:	Residential - Single new detached dwelling
Notified:	26/07/2024 to 09/08/2024
Advertised:	Not Advertised
Submissions Received:	0
Clause 4.6 Variation:	4.3 Height of buildings: 7.1%
Recommendation:	Approval

Estimated Cost of Works:	\$ 968,440.00
---------------------------------	---------------

PROPOSED DEVELOPMENT IN DETAIL

The applicant seeks development consent for the following:

The demolition of the existing dwelling and ancillary structures.

The addition of a two (2) storey dwelling that consists of the following:

Ground floor

- entry with an adjoining patio.
- two (2) bedrooms.
- rumpus room.
- bathroom and laundry.
- stairs leading to the first floor.
- attached garage.

- balcony to the rear of the addition.

First floor

- master bedroom adjoining a WIR and an ensuite.
- kitchen adjoining a pantry, dining room and a living room.
- one (1) bathroom.
- patio adjoining the rear with a breezeway along the side.
- stairs leading to the ground floor.

External

- new driveway and vehicle crossover.

ASSESSMENT INTRODUCTION

The application has been assessed in accordance with the requirements of the Environmental Planning and Assessment Act 1979 and the associated Regulations. In this regard:

- An assessment report and recommendation has been prepared (the subject of this report) taking into account all relevant provisions of the Environmental Planning and Assessment Act 1979, and the associated regulations;
- A site inspection was conducted and consideration has been given to the impacts of the development upon the subject site and adjoining, surrounding and nearby properties;
- Notification to adjoining and surrounding properties, advertisement (where required) and referral to relevant internal and external bodies in accordance with the Act, Regulations and relevant Development Control Plan;
- A review and consideration of all submissions made by the public and community interest groups in relation to the application;
- A review and consideration of all documentation provided with the application (up to the time of determination);
- A review and consideration of all referral comments provided by the relevant Council Officers, State Government Authorities/Agencies and Federal Government Authorities/Agencies on the proposal.

SUMMARY OF ASSESSMENT ISSUES

Manly Local Environmental Plan 2013 - Zone R2 Low Density Residential

Manly Local Environmental Plan 2013 - 4.3 Height of buildings

Manly Development Control Plan - 4.1.2 Height of Buildings (Incorporating Wall Height, Number of Storeys & Roof Height)

SITE DESCRIPTION

Property Description:	Lot 287 DP 235073 , 72 Frenchs Forest Road SEAFORTH NSW 2092
Detailed Site Description:	<p>The subject site consists of one (1) allotment located on the northern side of Frenchs Forest Road.</p> <p>The site is regular in shape with a frontage of 13.575m along Frenchs Forest Road and a depth of 39.705m. The</p>

site has a surveyed area of 621.5m².

The site is located within the R2 Low Density Residential zone pursuant to the Manly Local Environmental Plan 2013 and accommodates a two (2) storey dwelling.

The site incorporates a downward slope toward the rear of the site.

The site has a mix of vegetation throughout. There are no details of any threatened species on site.

Detailed Description of Adjoining/Surrounding Development

Adjoining and surrounding development is characterised by a mix of dwellings within an R2 Low Density Residential zone.

Map:



SITE HISTORY

A search of Council's records has revealed that there are no recent or relevant applications for this site.

The land has been used for residential purposes for an extended period of time.

ENVIRONMENTAL PLANNING AND ASSESSMENT ACT, 1979 (EPAA)

The relevant matters for consideration under the Environmental Planning and Assessment Act, 1979, are:

Section 4.15 Matters for Consideration	Comments
Section 4.15 (1) (a)(i) – Provisions of any environmental planning instrument	See discussion on “Environmental Planning Instruments” in this report.
Section 4.15 (1) (a)(ii) – Provisions of any draft environmental planning instrument	There are no current draft environmental planning instruments.
Section 4.15 (1) (a)(iii) – Provisions of any development control plan	Manly Development Control Plan applies to this proposal.
Section 4.15 (1) (a)(iiia) – Provisions of any planning agreement	None applicable.
Section 4.15 (1) (a)(iv) – Provisions of the Environmental Planning and Assessment Regulation 2021 (EP&A Regulation 2021)	<p><u>Part 4, Division 2</u> of the EP&A Regulation 2021 requires the consent authority to consider "Prescribed conditions" of development consent. These matters have been addressed via a condition of consent.</p> <p><u>Clauses 36 and 94</u> of the EP&A Regulation 2021 allow Council to request additional information. Additional information was requested in relation to Landscaping concerns. The amended proposal is considered supportable.</p> <p><u>Clause 61</u> of the EP&A Regulation 2021 requires the consent authority to consider AS 2601 - 1991: The Demolition of Structures. This matter has been addressed via a condition of consent.</p> <p><u>Clause 69</u> of the EP&A Regulation 2021 requires the consent authority to consider insurance requirements under the Home Building Act 1989. This matter has been addressed via a condition of consent.</p> <p><u>Clause 69</u> of the EP&A Regulation 2021 requires the consent authority to consider the provisions of the Building Code of Australia (BCA). This matter has been addressed via a condition of consent.</p>
Section 4.15 (1) (b) – the likely impacts of the development, including environmental impacts on the natural and built environment and social and economic impacts in the locality	<p>(i) Environmental Impact The environmental impacts of the proposed development on the natural and built environment are addressed under the Manly Development Control Plan section in this report.</p> <p>(ii) Social Impact The proposed development will not have a detrimental social impact in the locality considering the character of the proposal.</p> <p>(iii) Economic Impact The proposed development will not have a detrimental economic impact on the locality considering the nature of the existing and proposed land use.</p>

Section 4.15 Matters for Consideration	Comments
Section 4.15 (1) (c) – the suitability of the site for the development	The site is considered suitable for the proposed development.
Section 4.15 (1) (d) – any submissions made in accordance with the EPA Act or EPA Regs	See discussion on “Notification & Submissions Received” in this report.
Section 4.15 (1) (e) – the public interest	No matters have arisen in this assessment that would justify the refusal of the application in the public interest.

EXISTING USE RIGHTS

Existing Use Rights are not applicable to this application.

BUSHFIRE PRONE LAND

The site is not classified as bush fire prone land.

NOTIFICATION & SUBMISSIONS RECEIVED

The subject application has been publicly exhibited from 26/07/2024 to 09/08/2024 in accordance with the Environmental Planning and Assessment Act 1979, Environmental Planning and Assessment Regulation 2021 and the Community Participation Plan.

As a result of the public exhibition of the application Council received no submissions.

REFERRALS

Internal Referral Body	Comments
Environmental Health (Solid Fuel/Oil Heater)	<p>General Comments</p> <p>This application is seeking consent for demolition of existing structures and construction of a two storey house. There is a fireplace proposed in the living area. There is a dual occupancy dwelling located at 74 Frenches Forest Road. The fireplace chimney flue appears to be proposed to extend out through the roof close to the centre of the dwelling. Environmental Health are of the opinion that the chimney flue can comply with the requirements of the current Australian Standards.</p> <p>Environmental Health recommends approval subject to conditions.</p>
Landscape Officer	<p>Council's Landscape Referral section have considered the application against the Manly Local Environment Plan (MLEP), and the following Manly DCP 2013 (MDCP) controls (but not limited to): 3.3.1 Landscaping Design; 3.3.2 Preservation of Trees or Bushland Vegetation; 4.1.5 Open Space and Landscaping, including 4.1.5.2 (c) Minimum Tree Plantings where applicable.</p>

Internal Referral Body	Comments
	<p>Amended Landscape Plans and a Arboricultural Impact Assessment (AIA) report is submitted. The AIA report notes that one exempt tree species (tree 1) shall be removed as no concerns are raised and Council consent for management or removal is not required for exempt species. Existing tree 8 within the property is proposed for retention. All trees within adjoining properties (trees 2, 3, 4, 5, 6 and 7) shall be protected, and preservation is assessed in the AIA report with specific requirements recommended and these shall be imposed as conditions should the application be approved.</p> <p>The amended Landscape Plans includes adequate landscape treatment to satisfy the MDCP landscape controls. It is noted that the amended Landscape Plan includes removal of tree 8 however as this tree is not impacted by the proposed works it shall be retained as there is no arboricultural reason for removal.</p> <p>Subject to imposed conditions, Landscape Referral raise no concerns.</p>
NECC (Development Engineering)	<p>The applicant has provided evidence for the refusal of an easement in accordance with Council's policy. The submitted stormwater management plan including on-site stormwater detention discharging to a level spreader is acceptable. The proposed driveway crossing is also acceptable.</p> <p>Development Engineering support the proposed development, subject to conditions as recommended.</p>

External Referral Body	Comments
Ausgrid - SEPP (Transport and Infrastructure) 2021, s2.48	<p>The proposal was referred to Ausgrid who provided a response stating that the proposal is acceptable subject to compliance with the relevant Ausgrid Network Standards and SafeWork NSW Codes of Practice. These recommendations will be included as a condition of consent.</p>

ENVIRONMENTAL PLANNING INSTRUMENTS (EPIs)*

All, Environmental Planning Instruments (SEPPs and LEPs), Development Controls Plans and Council Policies have been considered in the merit assessment of this application.

In this regard, whilst all provisions of each Environmental Planning Instruments (SEPPs and LEPs), Development Controls Plans and Council Policies have been considered in the assessment, many provisions contained within the document are not relevant or are enacting, definitions and operational provisions which the proposal is considered to be acceptable against.

As such, an assessment is provided against the controls relevant to the merit consideration of the application hereunder.

State Environmental Planning Policies (SEPPs) and State Regional Environmental Plans (SREPs)

SEPP (Sustainable Buildings) 2022

A BASIX certificate has been submitted with the application (see Certificate No.1752289S dated 20 June 2024).

A condition has been included in the recommendation of this report requiring compliance with the commitments indicated in the BASIX Certificate.

SEPP (Transport and Infrastructure) 2021

Ausgrid

Section 2.48 of Chapter 2 requires the Consent Authority to consider any development application (or an application for modification of consent) for any development carried out:

- within or immediately adjacent to an easement for electricity purposes (whether or not the electricity infrastructure exists).
- immediately adjacent to an electricity substation.
- within 5.0m of an overhead power line.
- includes installation of a swimming pool any part of which is: within 30m of a structure supporting an overhead electricity transmission line and/or within 5.0m of an overhead electricity power line.

Comment:

The proposal was referred to Ausgrid who raised no objections.

SEPP (Resilience and Hazards) 2021

Chapter 4 – Remediation of Land

Sub-section 4.6 (1)(a) of Chapter 4 requires the Consent Authority to consider whether land is contaminated. Council records indicate that the subject site has been used for residential purposes for a significant period of time with no prior land uses. In this regard it is considered that the site poses no risk of contamination and therefore, no further consideration is required under sub-section 4.6 (1)(b) and (c) of this Chapter and the land is considered to be suitable for the residential land use.

Manly Local Environmental Plan 2013

Is the development permissible?	Yes
After consideration of the merits of the proposal, is the development consistent with:	
aims of the LEP?	Yes
zone objectives of the LEP?	Yes

Principal Development Standards

Standard	Requirement	Proposed	% Variation	Complies
----------	-------------	----------	-------------	----------

Height of Buildings:	8.5m	9.1m	7.1%	No
Floor Space Ratio	FSR: 0.45:1	FSR: 0.4:1 (245m ²)	N/A	Yes

Compliance Assessment

Clause	Compliance with Requirements
2.7 Demolition requires development consent	Yes
4.3 Height of buildings	No
4.4 Floor space ratio	Yes
4.5 Calculation of floor space ratio and site area	Yes
4.6 Exceptions to development standards	Yes
6.2 Earthworks	Yes
6.4 Stormwater management	Yes
6.12 Essential services	Yes

Detailed Assessment

Zone R2 Low Density Residential

Zone objectives

The underlying objectives of the R2 Low Density Residential zone are:

- To provide for the housing needs of the community within a low density residential environment.

Comment:

The proposal is considered to wholly comply with the above-mentioned objective.

- To enable other land uses that provide facilities or services to meet the day to day needs of residents.

Comment:

The proposal is considered to wholly comply with the above-mentioned objective.

4.3 Height of buildings

Description of non-compliance:

Development standard:	Height of buildings
Requirement:	8.5m
Proposed:	9.1m
Percentage variation to requirement:	7.1%

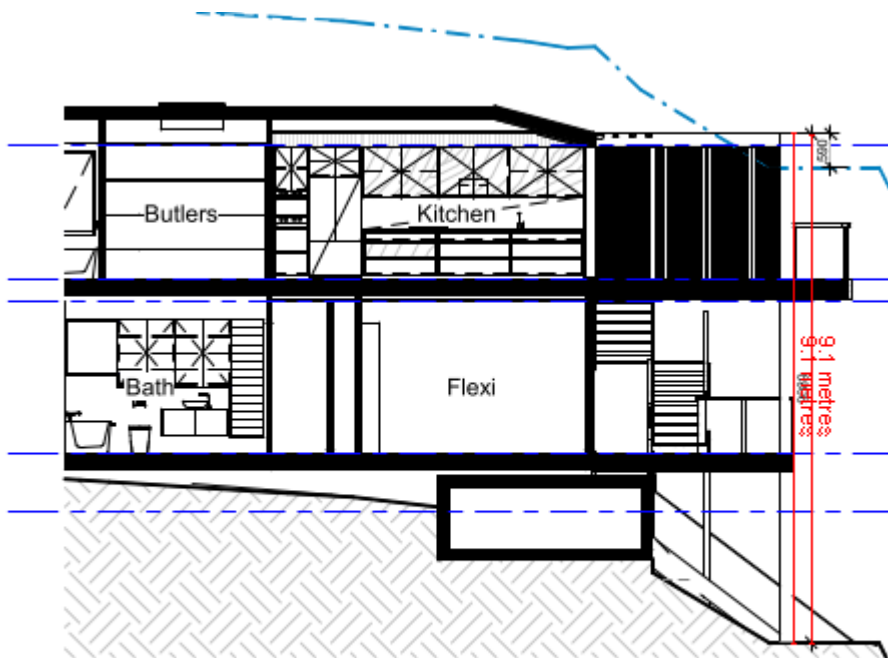

HOB SECTION 1

1 : 100

Figure 1: Section depicting the maximum Height of Building.

Assessment of request to vary a development standard:

The following assessment of the variation to Clause 4.3 – Height of Buildings development standard, has taken into consideration the recent judgement contained within *Initial Action Pty Ltd v Woollahra Municipal Council* [2018] NSWLEC 118, *Baron Corporation Pty Limited v Council of the City of Sydney* [2019] NSWLEC 61, and *RebelMH Neutral Bay Pty Limited v North Sydney Council* [2019] NSWCA 130.

Clause 4.6 Exceptions to development standards:

(1) *The objectives of this clause are as follows:*

- (a) *to provide an appropriate degree of flexibility in applying certain development standards to particular development,*
- (b) *to achieve better outcomes for and from development by allowing flexibility in particular circumstances.*

(2) *Development consent may, subject to this clause, be granted for development even though the development would contravene a development standard imposed by this or any other environmental planning instrument. However, this clause does not apply to a development standard that is expressly excluded from the operation of this clause.*

Comment:

Clause 4.3 – Height of Buildings development standard is not expressly excluded from the operation of this clause.

(3) *Development consent must not be granted for development that contravenes a development standard unless the consent authority has considered a written request from the applicant that seeks to justify the contravention of the development standard by demonstrating:*

(a) that compliance with the development standard is unreasonable or unnecessary in the circumstances of the case, and
(b) that there are sufficient environmental planning grounds to justify contravening the development standard.

(4) Development consent must not be granted for development that contravenes a development standard unless:

(a) the consent authority is satisfied that:

(i) the applicant's written request has adequately addressed the matters required to be demonstrated by subclause (3), and

(ii) the proposed development will be in the public interest because it is consistent with the objectives of the particular standard and the objectives for development within the zone in which the development is proposed to be carried out, and

(b) the concurrence of the Secretary has been obtained.

Clause 4.6 (4)(a)(i) (Justification) assessment:

Clause 4.6 (4)(a)(i) requires the consent authority to be satisfied that the applicant's written request, seeking to justify the contravention of the development standard, has adequately addressed the matters required to be demonstrated by cl 4.6(3). There are two separate matters for consideration contained within cl 4.6(3) and these are addressed as follows:

(a) that compliance with the development standard is unreasonable or unnecessary in the circumstances of the case, and

Comment:

The Applicant's written request has demonstrated that the objectives of the development standard are achieved, notwithstanding the non-compliance with the development standard.

In doing so, the Applicant's written request has adequately demonstrated that compliance with the development standard is unreasonable or unnecessary in the circumstances of this case as required by cl 4.6(3)(a).

(b) that there are sufficient environmental planning grounds to justify contravening the development standard.

Comment:

In the matter of Initial Action Pty Ltd v Woollahra Municipal Council [2018] NSWLEC 118, Preston CJ provides the following guidance (para 23) to inform the consent authority's finding that the applicant's written request has adequately demonstrated that there are sufficient environmental planning grounds to justify contravening the development standard:

'As to the second matter required by cl 4.6(3)(b), the grounds relied on by the applicant in the written request under cl 4.6 must be "environmental planning grounds" by their nature: see Four2Five Pty Ltd v Ashfield Council [2015] NSWLEC 90 at [26]. The adjectival phrase "environmental planning" is not defined, but would refer to grounds that relate to the subject matter, scope and purpose of the EPA Act, including the objects in s 1.3 of the EPA Act.'

s 1.3 of the EPA Act reads as follows:

1.3 Objects of Act(cf previous s 5)

The objects of this Act are as follows:

(a) to promote the social and economic welfare of the community and a better environment by the

*proper management, development and conservation of the State's natural and other resources,
(b) to facilitate ecologically sustainable development by integrating relevant economic, environmental and social considerations in decision-making about environmental planning and assessment,
(c) to promote the orderly and economic use and development of land,
(d) to promote the delivery and maintenance of affordable housing,
(e) to protect the environment, including the conservation of threatened and other species of native animals and plants, ecological communities and their habitats,
(f) to promote the sustainable management of built and cultural heritage (including Aboriginal cultural heritage),
(g) to promote good design and amenity of the built environment,
(h) to promote the proper construction and maintenance of buildings, including the protection of the health and safety of their occupants,
(i) to promote the sharing of the responsibility for environmental planning and assessment between the different levels of government in the State,
(j) to provide increased opportunity for community participation in environmental planning and assessment.*

The applicants written request argues, in part:

- The variation solely relates to a portion of the site that has a sudden drop in topography that is associated with an existing rock outcrop.*
- The non-compliant built form will not adversely impact the amenity of any adjoining sites and cannot be seen from the streetscape.*
- The proposed development meets the objectives of the development standard and the objectives of the R2 Low Density Residential zone.*
- The scale and form of the development is consistent with the existing development within the surrounding locality.*
- There will be no impact to the adjoining sites in terms of views, privacy or overshadowing.*
- The proposal represents a reasonable approach to development of the site based on specific site locality factors and the applicable controls.*

It is agreed that the objectives of the development standard are achieved notwithstanding the non-compliance with the standard. It is considered that the written request has demonstrated consistency with the objectives of the Height of Buildings development standard and zone objectives. It is also considered that the applicant has demonstrated that the proposal adequately responds to the amenity of the built environment. In this regard, the applicants written request has satisfactorily demonstrated that the proposed development satisfies cls 1.3 (c) and (g) of the EPA Act. As such, the applicants written request has adequately demonstrated that there is sufficient environmental planning grounds to justify contravening the development standard as required by cl 4.6 (3)(b).

In this case, strict compliance with the standard is unnecessary as the proposed works do not propose an unreasonable adverse environmental impact. There is no unreasonable extension to the bulk or scale of the dwelling, all works remaining within the building envelope. Therefore, it is considered that there is sufficient environment planning grounds to justify contravening the development standard' under LEP clause 4.6(3).

Therefore, Council is satisfied that the applicant's written request has adequately addressed the matters required to be demonstrated by cl 4.6(3).

Clause 4.6 (4)(a)(ii) (Public Interest) assessment:

cl 4.6 (4)(a)(ii) requires the consent authority to be satisfied that:

(ii) the proposed development will be in the public interest because it is consistent with the objectives of the particular standard and the objectives for development within the zone in which the development is proposed to be carried out

Comment:

In considering whether or not the proposed development will be in the public interest, consideration must be given to the underlying objectives of the Height of Buildings development standard and the objectives of the R2 Low Density Residential zone. An assessment against these objectives is provided below.

Conclusion:

For the reasons detailed above, the proposal is considered to be consistent with the objectives of the R2 Low Density Residential zone.

It is considered on balance, that having regard to the particular circumstances detailed within this assessment, the proposed departure from the development standard is acceptable and it is reasonable that flexibility to the standard be applied.

Exception to Development Standards conclusion

The submitted written Clause 4.6 variation request is considered to be well founded having regard to the circumstances of the development is considered appropriate that flexibility in the application of the development standard Clause 4.3 – ‘Height of buildings’ be applied. In this context the proposal meets the Objects of the Environmental Planning and Assessment Act 1979, contained in Section 1.3, having considered the relevant provisions under s.4.15 of the Act. Consequently, the development is considered to be in the public interest, subject to conditions.

Clause 4.6 (4)(b) (Concurrence of the Secretary) assessment:

cl. 4.6(4)(b) requires the concurrence of the Secretary to be obtained in order for development consent to be granted.

Planning Circular PS20-002 dated 5 May 2020, as issued by the NSW Department of Planning, advises that the concurrence of the Secretary may be assumed for exceptions to development standards under environmental planning instruments that adopt Clause 4.6 of the Standard Instrument. In this regard, given the consistency of the variation to the objectives of the zone, the concurrence of the Secretary for the variation to the Height of buildings Development Standard is assumed by the delegate of Council as the development contravenes a numerical standard by less than or equal to 10%.

Manly Development Control Plan

Built Form Controls

Built Form Controls - Site Area: 621.5m ²	Requirement	Proposed	% Variation*	Complies
4.1.2.1 Wall Height	8m (based on gradient 1:4+) (west)	5.8m	N/A	Yes
	8m (based on gradient 1:4+) (east)	5.8m	N/A	Yes

4.1.2.2 Number of Storeys	2	2	N/A	Yes
4.1.2.3 Roof Height	Height: 2.5m	complies	N/A	Yes
	Pitch: maximum 35 degrees	complies	N/A	Yes
4.1.4.1 Street Front Setbacks	Prevailing building line / 6m	6.1m	N/A	Yes
4.1.4.2 Side Setbacks and Secondary Street Frontages	1.9m (based on wall height) (west)	2.5m	N/A	Yes
	1.9m (based on wall height) (east)	3m	N/A	Yes
	Windows: 3m	1.2m	N/A	Yes
4.1.4.4 Rear Setbacks	8m	10.6m	N/A	Yes
4.1.5.1 Minimum Residential Total Open Space Requirements Residential Open Space Area: OS3	Open space 55% of site area	64.6% (400m ²)	N/A	Yes
	Open space above ground 25% of total open space	complies	N/A	Yes
4.1.5.2 Landscaped Area	Landscaped area 35% of open space	87.5% (350m ²)	N/A	Yes
	3 native trees	complies	N/A	Yes
4.1.5.3 Private Open Space	18sqm per dwelling	complies	N/A	Yes
Schedule 3 Parking and Access	Dwelling 2 spaces	2 spaces	N/A	Yes

Compliance Assessment

Clause	Compliance with Requirements	Consistency Aims/Objectives
3.1 Streetscapes and Townscapes	Yes	Yes
3.1.1 Streetscape (Residential areas)	Yes	Yes
3.3.1 Landscaping Design	Yes	Yes
3.3.2 Preservation of Trees or Bushland Vegetation	Yes	Yes
3.4 Amenity (Views, Overshadowing, Overlooking /Privacy, Noise)	Yes	Yes
3.4.1 Sunlight Access and Overshadowing	Yes	Yes
3.4.2 Privacy and Security	Yes	Yes
3.4.3 Maintenance of Views	Yes	Yes
3.4.4 Other Nuisance (Odour, Fumes etc.)	Yes	Yes
3.5 Sustainability - (Greenhouse Energy Efficiency, Thermal Performance, and Water Sensitive Urban Design)	Yes	Yes
3.5.1 Solar Access	Yes	Yes
3.5.3 Ventilation	Yes	Yes
3.5.5 Landscaping	Yes	Yes
3.5.7 Building Construction and Design	Yes	Yes
3.6 Accessibility	Yes	Yes
3.7 Stormwater Management	Yes	Yes
3.8 Waste Management	Yes	Yes

Clause	Compliance with Requirements	Consistency Aims/Objectives
3.10 Safety and Security	Yes	Yes
4.1 Residential Development Controls	Yes	Yes
4.1.1 Dwelling Density, Dwelling Size and Subdivision	Yes	Yes
4.1.1.1 Residential Density and Dwelling Size	Yes	Yes
4.1.2 Height of Buildings (Incorporating Wall Height, Number of Storeys & Roof Height)	Yes	Yes
4.1.3 Floor Space Ratio (FSR)	Yes	Yes
4.1.4 Setbacks (front, side and rear) and Building Separation	Yes	Yes
4.1.5 Open Space and Landscaping	Yes	Yes
4.1.6 Parking, Vehicular Access and Loading (Including Bicycle Facilities)	Yes	Yes
4.1.7 First Floor and Roof Additions	Yes	Yes
4.1.8 Development on Sloping Sites	Yes	Yes
4.4.1 Demolition	Yes	Yes
Schedule 1 – Maps accompanying the DCP	Yes	Yes

Detailed Assessment

4.1.2 Height of Buildings (Incorporating Wall Height, Number of Storeys & Roof Height)

Objectives of development standard

The underlying objectives of the standard, pursuant to Clause 4.3 – ‘Height of buildings’ of the MLEP 2013 are:

(1) The objectives of this clause are as follows:

a) to provide for building heights and roof forms that are consistent with the topographic landscape, prevailing building height and desired future streetscape character in the locality,

Comment:

The variation in building height is limited to a portion of the site where a sudden topographic drop, associated with an existing rock outcrop, influences the design. Despite this variation, the development remains in harmony with the natural landscape and will not impact the desired streetscape character, as the non-compliant section is not visible from the streetscape.

b) to control the bulk and scale of buildings,

Comment:

The proposed development's scale and form are consistent with surrounding buildings in the locality. The design appropriately respects the controls that maintain adequate bulk and scale, ensuring it integrates well with the existing built environment.

c) to minimise disruption to the following:

- (i) views to nearby residential development from public spaces (including the harbour and foreshores),*
- (ii) views from nearby residential development to public spaces (including the harbour and foreshores),*
- (iii) views between public spaces (including the harbour and foreshores),*

Comment:

The development will not impact views to or from public spaces, nearby residential properties, or between public spaces, as the non-compliant portion is confined to a section that does not obstruct significant view corridors.

d) to provide solar access to public and private open spaces and maintain adequate sunlight access to private open spaces and to habitable rooms of adjacent dwellings,

Comment:

The proposal does not affect sunlight access to adjoining sites, with no adverse impacts on the solar access of private open spaces or habitable rooms. The development maintains adequate sunlight access, supporting amenity for neighboring properties.

e) to ensure the height and bulk of any proposed building or structure in a recreation or environmental protection zone has regard to existing vegetation and topography and any other aspect that might conflict with bushland and surrounding land uses.

Comment:

The development respects the site's natural topography and maintains existing vegetation in areas of environmental sensitivity. The design minimises intrusion into the landscape, ensuring that it aligns with surrounding land uses and does not conflict with nearby bushland areas.

Please refer to *Clause 4.6 Exceptions to development standards* for further discussion.

THREATENED SPECIES, POPULATIONS OR ECOLOGICAL COMMUNITIES

The proposal will not significantly affect threatened species, populations or ecological communities, or their habitats.

CRIME PREVENTION THROUGH ENVIRONMENTAL DESIGN

The proposal is consistent with the principles of Crime Prevention Through Environmental Design.

POLICY CONTROLS

Northern Beaches Section 7.12 Contributions Plan 2024

The proposal is subject to the application of Northern Beaches Section 7.12 Contributions Plan 2024.

A monetary contribution of \$9,684 is required for the provision of new and augmented public infrastructure. The contribution is calculated as 1% of the total development cost of \$968,440.

CONCLUSION

The site has been inspected and the application assessed having regard to all documentation submitted by the applicant and the provisions of:

- Environmental Planning and Assessment Act 1979;
- Environmental Planning and Assessment Regulation 2021;
- All relevant and draft Environmental Planning Instruments;
- Manly Local Environment Plan;
- Manly Development Control Plan; and
- Codes and Policies of Council.

This assessment has taken into consideration the submitted plans, Statement of Environmental Effects, all other documentation supporting the application and public submissions, and does not result in any unreasonable impacts on surrounding, adjoining, adjacent and nearby properties subject to the conditions contained within the recommendation.

In consideration of the proposal and the merit consideration of the development, the proposal is considered to be:

- Consistent with the objectives of the DCP
- Consistent with the zone objectives of the LEP
- Consistent with the aims of the LEP
- Consistent with the objectives of the relevant EPIs
- Consistent with the objects of the Environmental Planning and Assessment Act 1979

Council is satisfied that:

1) The Applicant's written request under Clause 4.6 of the Manly Local Environmental Plan 2013 seeking to justify a contravention of Clause 4.3 Height of Buildings has adequately addressed and demonstrated that:

- a) Compliance with the standard is unreasonable or unnecessary in the circumstances of the case; and
- b) There are sufficient environmental planning grounds to justify the contravention.

2) The proposed development will be in the public interest because it is consistent with the objectives of the standard and the objectives for development within the zone in which the development is proposed to be carried out.

It is considered that the proposed development satisfies the appropriate controls and that all processes and assessments have been satisfactorily addressed.

RECOMMENDATION

That Northern Beaches Council as the consent authority permits a contravention of clause 4.3 Height of Building development standard pursuant to clause 4.6 of the MLEP 2013 as the applicant's written request has adequately addressed the merits required to be demonstrated by subclause (3) and the proposed development will be in the public interest and is consistent with the objectives of the standard and the objectives for development within the zone in which the development is proposed to

be carried out.

Accordingly Council as the consent authority grant Development Consent to DA2024/0908 for Demolition works and construction of a dwelling house on land at Lot 287 DP 235073, 72 Frenchs Forest Road, SEAFORTH, subject to the conditions printed below:

Terms and Reasons for Conditions

Under section 88(1)(c) of the EP&A Regulation, the consent authority must provide the terms of all conditions and reasons for imposing the conditions other than the conditions prescribed under section 4.17(11) of the EP&A Act. The terms of the conditions and reasons are set out below.

GENERAL CONDITIONS

1. Approved Plans and Supporting Documentation

Development must be carried out in accordance with the following approved plans (stamped by Council) and supporting documentation, except where the conditions of this consent expressly require otherwise.

Approved Plans				
Plan Number	Revision Number	Plan Title	Drawn By	Date of Plan
A10	B	Site Plan	dlistter design	3 December 2024
A20	B	Ground Floor	dlistter design	3 December 2024
A21	B	First Floor	dlistter design	3 December 2024
A22	B	Roof Plan	dlistter design	3 December 2024
A30	B	Elevations	dlistter design	3 December 2024
A31	B	Elevations	dlistter design	3 December 2024
A32	B	Elevations	dlistter design	3 December 2024
A34	B	External Finishes	dlistter design	3 December 2024
A40	B	Sections	dlistter design	3 December 2024
DA5	B	Survey Overlay	dlistter design	3 December 2024

Approved Reports and Documentation	
------------------------------------	--

Document Title	Version Number	Prepared By	Date of Document
BASIX Certificate	1752289S	CHAPMAN ENVIRONMENTAL SERVICES PTY LTD	20 June 2024
Acoustic Report	-	Domeniki Tsagaris	4 June 2024
Waste Management Plan	-	Daniel Lister	14 July 2024
Arborist Report	-	Andrew Scales	23 October 2024

In the event of any inconsistency between the approved plans, reports and documentation, the approved plans prevail.

In the event of any inconsistency between the approved plans and a condition of this consent, the condition prevails.

Reason: To ensure all parties are aware of the approved plans and supporting documentation that applies to the development.

2. **Compliance with Other Department, Authority or Service Requirements**

The development must be carried out in compliance with all recommendations and requirements, excluding general advice, within the following:

Other Department, Authority or Service	EDMS Reference	Dated
Ausgrid	Ausgrid Referral Response	undated

(NOTE: For a copy of the above referenced document/s, please see Application Tracking on Council's website www.northernbeaches.nsw.gov.au)

Reason: To ensure the work is carried out in accordance with the determination and the statutory requirements of other departments, authorities or bodies.

3. **Prescribed Conditions**

- (a) All building works must be carried out in accordance with the requirements of the Building Code of Australia (BCA).
- (b) BASIX affected development must comply with the schedule of BASIX commitments specified within the submitted BASIX Certificate (demonstrated compliance upon plans/specifications is required prior to the issue of the Construction Certificate);
- (c) A sign must be erected in a prominent position on any site on which building work, subdivision work or demolition work is being carried out:
 - (i) showing the name, address and telephone number of the Principal Certifier for the work, and
 - (ii) showing the name of the principal contractor (if any) for any building work and a telephone number on which that person may be contacted outside working hours, and
 - (iii) stating that unauthorised entry to the work site is prohibited.

Any such sign is to be maintained while the building work, subdivision work or demolition work is being carried out, but must be removed when the work has been completed.

- (d) Residential building work within the meaning of the Home Building Act 1989 must not be carried out unless the Principal Certifier for the development to which the work relates (not being the Council) has given the Council written notice of the following information:
- (i) in the case of work for which a principal contractor is required to be appointed:
 - A. the name and licence number of the principal contractor, and
 - B. the name of the insurer by which the work is insured under Part 6 of that Act,
 - (ii) in the case of work to be done by an owner-builder:
 - A. the name of the owner-builder, and
 - B. if the owner-builder is required to hold an owner-builder permit under that Act, the number of the owner-builder permit.

If arrangements for doing the residential building work are changed while the work is in progress so that the information notified under becomes out of date, further work must not be carried out unless the Principal Certifier for the development to which the work relates (not being the Council) has given the Council written notice of the updated information.

- (e) Development that involves an excavation that extends below the level of the base of the footings of a building on adjoining land, the person having the benefit of the development consent must, at the person's own expense:
- (i) protect and support the adjoining premises from possible damage from the excavation, and
 - (ii) where necessary, underpin the adjoining premises to prevent any such damage.
 - (iii) must, at least 7 days before excavating below the level of the base of the footings of a building on an adjoining allotment of land, give notice of intention to do so to the owner of the adjoining allotment of land and furnish particulars of the excavation to the owner of the building being erected or demolished.
 - (iv) the owner of the adjoining allotment of land is not liable for any part of the cost of work carried out for the purposes of this clause, whether carried out on the allotment of land being excavated or on the adjoining allotment of land.

In this clause, allotment of land includes a public road and any other public place.

Reason: Legislative requirement.

4. General Requirements

- (a) Unless authorised by Council:
- Building construction and delivery of material hours are restricted to:
- 7.00 am to 5.00 pm inclusive Monday to Friday,
 - 8.00 am to 1.00 pm inclusive on Saturday,
 - No work on Sundays and Public Holidays.

Demolition and excavation works are restricted to:

- 8.00 am to 5.00 pm Monday to Friday only.

- (Excavation work includes the use of any excavation machinery and the use of jackhammers, rock breakers, excavators, loaders and the like, regardless of whether the activities disturb or alter the natural state of the existing ground stratum or are breaking up/removing materials from the site).
- (b) Construction certificate plans are to be in accordance with all finished levels identified on approved plans. Notes attached to plans indicating tolerances to levels are not approved.
 - (c) Should any asbestos be uncovered on site, its demolition and removal must be carried out in accordance with WorkCover requirements and the relevant Australian Standards.
 - (d) At all times after the submission of the Notice of Commencement to Council, a copy of the Development Consent and Construction Certificate is to remain onsite at all times until the issue of an Occupation Certificate. The consent shall be available for perusal of any Authorised Officer.
 - (e) Where demolition works have been completed and new construction works have not commenced within 4 weeks of the completion of the demolition works that area affected by the demolition works shall be fully stabilised and the site must be maintained in a safe and clean state until such time as new construction works commence.
 - (f) Onsite toilet facilities (being either connected to the sewer or an accredited sewer management facility) for workers are to be provided for construction sites at a rate of 1 per 20 persons.
 - (g) Prior to the release of the Construction Certificate, payment of the following is required:
 - i) Long Service Levy - Payment should be made to Service NSW (online or in person) or alternatively to Northern Beaches Council in person at a Customer Service Centre. Payment is not required where the value of the works is less than \$250,000. The Long Service Levy is calculated on 0.25% of the building and construction work. The levy rate and level in which it applies is subject to legislative change. The applicable fee at the time of payment of the Long Service Levy will apply.
 - ii) Section 7.11 or Section 7.12 Contributions Plan – Payment must be made to Northern Beaches Council. Where the subject land to which the development is proposed is subject to either a Section 7.11 or 7.12 Contributions Plan, any contribution to which the development is liable under the respective plan that applies is to be paid to Council. The outstanding contribution will be indexed at time of payment in accordance with the relevant Contributions Plan.
 - iii) Housing and Productivity Contribution - Payment must be made on the NSW Planning Portal for development to which this contribution applies. The amount payable is subject to indexation at the time of payment.
 - (h) The applicant shall bear the cost of all works associated with the development that occurs on Council's property.
 - (i) No skip bins, building materials, demolition or excavation waste of any nature, and no hoist, plant or machinery (crane, concrete pump or lift) shall be placed on Council's footpaths, roadways, parks or grass verges without Council Approval.
 - (j) Demolition materials and builders' wastes are to be removed to approved waste/recycling centres.
 - (k) No trees or native shrubs or understorey vegetation on public property (footpaths, roads, reserves, etc.), on the land to be developed, or within adjoining properties,

shall be removed or damaged during excavation or construction unless specifically approved in this consent including for the erection of any fences, hoardings or other temporary works.

(l) Prior to the commencement of any development onsite for:

- i) Building/s that are to be erected
- ii) Building/s that are situated in the immediate vicinity of a public place and is dangerous to persons or property on or in the public place
- iii) Building/s that are to be demolished
- iv) For any work/s that is to be carried out
- v) For any work/s that is to be demolished

The person responsible for the development site is to erect or install on or around the development area such temporary structures or appliances (wholly within the development site) as are necessary to protect persons or property and to prevent unauthorised access to the site in order for the land or premises to be maintained in a safe or healthy condition. Upon completion of the development, such temporary structures or appliances are to be removed within 7 days.

(m) A "Road Opening Permit" must be obtained from Council, and all appropriate charges paid, prior to commencement of any work on Council property. The owner/applicant shall be responsible for all public utilities and services in the area of the work, shall notify all relevant Authorities, and bear all costs associated with any repairs and/or adjustments as those Authorities may deem necessary.

(n) The works must comply with the relevant Ausgrid Network Standards and SafeWork NSW Codes of Practice.

(o) Requirements for new swimming pools/spas or existing swimming pools/spas affected by building works.

- (1) Child resistant fencing is to be provided to any swimming pool or lockable cover to any spa containing water and is to be consistent with the following;

Relevant legislative requirements and relevant Australian Standards (including but not limited) to:

- (i) Swimming Pools Act 1992
- (ii) Swimming Pools Amendment Act 2009
- (iii) Swimming Pools Regulation 2018
- (iv) Australian Standard AS1926 Swimming Pool Safety
- (v) Australian Standard AS1926.1 Part 1: Safety barriers for swimming pools
- (vi) Australian Standard AS1926.2 Part 2: Location of safety barriers for swimming pools.

- (2) A 'KEEP WATCH' pool safety and aquatic based emergency sign, issued by Royal Life Saving is to be displayed in a prominent position within the pool/spa area.

- (3) Filter backwash waters shall be conveyed to the Sydney Water sewerage system in sewered areas or managed on-site in unsewered areas in a manner that does not cause pollution, erosion or run off, is separate from the irrigation area for any wastewater system and is separate from any onsite stormwater management system.

- (4) Swimming pools and spas must be registered with the Division of Local Government.

Reason: To ensure that works do not interfere with reasonable amenity expectations of residents and the community.

FEES / CHARGES / CONTRIBUTIONS

5. Policy Controls

Northern Beaches Section 7.12 Contributions Plan 2024

A monetary contribution of \$9,684.40 is payable to Northern Beaches Council for the provision of local infrastructure and services pursuant to section 7.12 of the Environmental Planning & Assessment Act 1979 and the Northern Beaches Section 7.12 Contributions Plan (as amended).

The monetary contribution is based on a development cost of \$968,440.00.

The total amount payable will be adjusted at the time the payment is made, in accordance with the provisions of the Northern Beaches Section 7.12 Contributions Plan (as amended).

Details demonstrating compliance, by way of written receipts issued by Council, are to be submitted to the Certifier prior to issue of any Construction Certificate or, if relevant, the Subdivision Certificate (whichever occurs first).

A copy of the Contributions Plan is available for inspection at 725 Pittwater Road, Dee Why or on Council's website at Northern Beaches Council - Development Contributions.

Reason: To provide for contributions in accordance with the Contribution Plan to fund the provision of new or augmented local infrastructure and services.

6. Security Bond

A bond (determined from cost of works) of \$2,000 and an inspection fee in accordance with Council's Fees and Charges paid as security are required to ensure the rectification of any damage that may occur to the Council infrastructure contained within the road reserve adjoining the site as a result of construction or the transportation of materials and equipment to and from the development site.

An inspection fee in accordance with Council adopted fees and charges (at the time of payment) is payable for each kerb inspection as determined by Council (minimum (1) one inspection).

All bonds and fees shall be deposited with Council prior to Construction Certificate or demolition work commencing, and details demonstrating payment are to be submitted to the Certifier prior to the issue of the Construction Certificate.

To process the inspection fee and bond payment a Bond Lodgement Form must be completed with the payments (a copy of the form is attached to this consent and alternatively a copy is located on Council's website at www.northernbeaches.nsw.gov.au).

Reason: To ensure adequate protection of Council's infrastructure.

BUILDING WORK – BEFORE ISSUE OF A CONSTRUCTION CERTIFICATE

7. **On-Site Stormwater Detention Details**

The Applicant is to provide a certification of drainage plans detailing the provision of on-site stormwater detention in accordance with Northern Beaches Council's Water Management for Development Policy, and generally in accordance with the concept drainage plans prepared by Greenview Consulting drawing number 230971 DA C01, C02 and C03 Revision 3, dated 04/06/2024. Detailed drainage plans are to be prepared by a suitably qualified Civil Engineer, who has membership to Engineers Australia, National Engineers Register (NER) or Professionals Australia (RPENG) and registered in the General Area of Practice for civil engineering.

The drainage plans must address the following:

1. The proposed below ground OSD tank is to be clear of the underside of the dwelling to ensure no rising damp issues.
2. Step irons are to be provided at the second access grate.
3. An access lid is to be provided over the orifice plate for future maintenance.

Detailed drainage plans, including engineering certification, are to be submitted to the Certifier for approval prior to the issue of the Construction Certificate.

Reason: To ensure appropriate provision for the disposal of stormwater and stormwater management arising from development.

8. **Traffic Management and Control**

The Applicant is to submit an application for Traffic Management Plan to Council for approval prior to issue of the Construction Certificate. The Traffic Management Plan shall be prepared to TfNSW standards by an appropriately certified person.

Reason: To ensure appropriate measures have been considered for site access, storage and the operation of the site during all phases of the construction process.

9. **Vehicle Crossings Application**

The Applicant is to submit an application with Council for driveway levels to construct one vehicle crossing 3 metres wide in accordance with Northern Beaches Council Standard Drawing Normal High in accordance with Section 138 of the Roads Act 1993.

Note, driveways are to be in plain concrete only. Concurrence from the relevant utility service authority for the construction of the driveway over the existing service pit must be submitted with the application.

The fee associated with the assessment and approval of the application is to be in accordance with Council's Fee and Charges.

A Council approval is to be submitted to the Certifier prior to the issue of the Construction Certificate.

Reason: To facilitate suitable vehicular access to private property.

10. **Installation and Maintenance of Sediment Control**

Prior to any works commencing on site, including demolition, an erosion and sediment control plan must be prepared by a suitably qualified person in accordance with the following documents and provided to the Principal Certifier:

1. Council's relevant development control plan,

2. The guidelines set out in the NSW Department of Housing manual 'Managing Urban Stormwater: Soils and Construction Certificate' (the Blue Book) (as amended from time to time), and
3. The 'Do it Right On-Site, Soil and Water Management for the Construction Industry' (Southern Sydney Regional Organisation of Councils and the Natural Heritage Trust) (as amended from time to time).

Techniques used for erosion and sediment control on site are to be adequately maintained and monitored at all times, particularly after periods of rain, and shall remain in proper operation until all development activities have been completed and the site is sufficiently stabilised with vegetation.

Reason: To ensure no substance other than rainwater enters the stormwater system and waterways.

11. Waste Management Plan

A Waste Management Plan must be prepared for this development. The Plan must be in accordance with the Development Control Plan.

Details demonstrating compliance must be provided to the Certifier prior to the issue of the Construction Certificate.

Reason: To ensure that any demolition and construction waste, including excavated material, is reused, recycled or disposed of in an environmentally friendly manner.

12. Compliance with Standards

The development is required to be carried out in accordance with all relevant Australian Standards.

Details demonstrating compliance with the relevant Australian Standard are to be submitted to the Certifier prior to the issue of the Construction Certificate.

Reason: To ensure the development is constructed in accordance with appropriate standards.

13. External Finishes to Roof

The external finish to the roof shall have a Solar Absorptance (SA) greater than 0.43 in accordance with the requirements of the BASIX Certificate to minimise solar reflections to neighbouring properties. Any roof with a reflective finish is not permitted.

Green roofs and areas where solar panels (PV) are installed are excluded from conforming to the SA range.

Details demonstrating compliance are to be submitted to the Certifier prior to the issue of the construction certificate.

Reason: To ensure that excessive glare or reflectivity nuisance does not occur as a result of the development.

14. Sydney Water "Tap In"

The approved plans must be submitted to the Sydney Water Tap in service, prior to works commencing, to determine whether the development will affect any Sydney Water assets and/or easements. The appropriately stamped plans must then be submitted to the Certifier

demonstrating the works are in compliance with Sydney Water requirements.

Please refer to the website www.sydneywater.com.au for:

- “Tap in” details - see <http://www.sydneywater.com.au/tapin>
- Guidelines for Building Over/Adjacent to Sydney Water Assets.

Or telephone 13 000 TAP IN (1300 082 746).

Reason: To ensure compliance with the statutory requirements of Sydney Water.

DURING BUILDING WORK

15. **Protection of Rock and Sites of Significance**

All rock outcrops outside of the area of approved works are to be preserved and protected at all times during demolition excavation and construction works. Should any Aboriginal sites be uncovered during the carrying out of works, those works are to cease and Council, the NSW Office of Environment and Heritage (OEH) and the Metropolitan Local Aboriginal Land Council (MLALC) are to be contacted.

Reason: Preservation of significant environmental features.

16. **Tree and Vegetation Protection**

a) Existing trees and vegetation shall be retained and protected, including:

- i) all trees within the site not approved for removal, including trees and vegetation nominated for retention on the approved Plans,
- ii) all trees and vegetation located on adjoining properties,
- iii) all trees and vegetation within the road reserve.

b) Tree protection shall be undertaken as follows:

- i) tree protection shall be in accordance with AS4970-2009 Protection of trees on development sites, and any recommendations of an approved Arboricultural Impact Assessment and in particular section 4 and appendix 8 and 9,
- ii) existing ground levels shall be maintained within the tree protection zone of trees to be retained, unless authorised by an Arborist/Project Arborist with minimum AQF Level 5 in arboriculture,
- iii) removal of existing tree roots at or >25mm (Ø) diameter is not permitted without consultation with an Arborist/Project Arborist with minimum AQF Level 5 in arboriculture,
- iv) no excavated material, building material storage, site facilities, nor landscape materials are to be placed within the canopy dripline of trees and other vegetation required to be retained,
- v) structures are to bridge tree roots at or >25mm (Ø) diameter unless directed by an Arborist/Project Arborist with minimum AQF Level 5 in arboriculture on site,
- vi) excavation for stormwater lines and all other utility services is not permitted within the tree protection zone, without consultation with an Arborist/Project Arborist with minimum AQF Level 5 in arboriculture including advice on root protection measures,
- vii) should either or all of v) or vi) occur during site establishment and construction works, an Arborist/Project Arborist with minimum AQF Level 5 in arboriculture shall provide recommendations for tree protection measures. Details including photographic evidence of works undertaken shall be submitted by the Arborist/Project Arborist to the Principal Certifier,
- viii) any temporary access to, or location of scaffolding within the tree protection zone of a protected tree or any other tree to be retained during the construction works is to be undertaken using the protection measures specified in sections 4.5.3 and 4.5.6 of AS4970-2009 Protection of trees on development sites,
- ix) the activities listed in section 4.2 of AS4970-2009 Protection of trees on development sites,

shall not occur within the tree protection zone of any tree on the lot or any tree on an adjoining site,

x) tree pruning from within the site to enable approved works shall not exceed 10% of any tree canopy, and shall be in accordance with AS4373-2007 Pruning of amenity trees,

xi) the tree protection measures specified in this clause must: i) be in place before work commences on the site, and ii) be maintained in good condition during the construction period, and iii) remain in place for the duration of the construction works.

The Principal Certifier must ensure that:

c) The arboricultural works listed in a) and b) are undertaken as complaint to AS4970-2009 Protection of trees on development sites, and any recommendations of an approved Arboricultural Impact Assessment and/or Project Arborist as applicable.

Reason: Tree and vegetation protection.

17. Road Reserve

The applicant shall ensure the public footways and roadways adjacent to the site are maintained in a safe condition at all times during the course of the work.

Reason: Public safety.

18. Survey Certificate

A survey certificate prepared by a Registered Surveyor at the following stages of construction:

(a) Commencement of perimeter walls columns and or other structural elements to ensure the wall or structure, to boundary setbacks are in accordance with the approved details.

(b) At ground level to ensure the finished floor levels are in accordance with the approved levels, prior to concrete slab being poured/flooring being laid.

(c) At completion of the roof frame confirming the finished roof/ridge height is in accordance with levels indicated on the approved plans.

Details demonstrating compliance are to be submitted to the Principal Certifier.

Reason: To determine the height of buildings under construction comply with levels shown on approved plans.

19. Traffic Control During Road Works

Lighting, fencing, traffic control and advanced warning signs shall be provided for the protection of the works and for the safety and convenience of the public and others in accordance with TfNSW Traffic Control At Work Sites Manual and to the satisfaction of the Roads Authority. Traffic movement in both directions on public roads, and vehicular access to private properties is to be maintained at all times during the works.

Reason: Public Safety.

20. Waste Management During Development

The reuse, recycling or disposal of waste during works must be done generally in accordance with the Waste Management Plan for this development.

Details demonstrating compliance must be submitted to the Principal Certifier.

Reason: To ensure demolition and construction waste is recycled or reused and to limit landfill.

BEFORE ISSUE OF THE OCCUPATION CERTIFICATE

21. Installation and certification of solid/fuel burning heater

The solid fuel heater must be certified to comply with Australian Standards 4012 and 4013.

Provide to the Principal Certifier certification that the solid fuel heater has been installed by an appropriately experienced and qualified person, in accordance with the relevant provisions of AS2918 – Domestic Solid Fuel Burning Appliances – Installation.

Reason: To ensure the installation is completed in a legislatively compliant manner.

22. Landscape Completion

Landscape works are to be implemented in accordance with the approved Landscape Plans, and inclusive of the following conditions:

- a) landscape works are to be contained within the legal property boundaries,
- b) tree, shrub and groundcover planting shall be installed as indicated on the approved Landscape Plans, unless otherwise imposed by conditions,
- c) all tree planting shall be a minimum pre-ordered planting size of 75 litres or as otherwise scheduled if greater in size; meet the requirements of Australian Standard AS2303 - Tree Stock for Landscape Use; planted into a prepared planting hole 1m x 1m x 600mm depth generally, backfilled with a sandy loam mix or approved similar, mulched to 75mm depth minimum and maintained, and watered until established; and shall be located at least 3.0 metres from buildings and other trees or more, at least 1.5 metres from common boundaries; and located either within garden bed or within a prepared bed within lawn,
- d) mass planting shall be installed in a garden bed prepared with a suitable free draining soil mix and minimum 75mm depth of mulch,
- e) all proposed tree planting shall be positioned in locations to minimise significant impacts on neighbours in terms of blocking winter sunlight to living rooms, private open space and where the proposed location of trees may otherwise be positioned to minimise any significant loss of views from neighbouring and nearby dwellings and from public spaces.

Prior to the issue of an Occupation Certificate, details (from a landscape architect, landscape designer or qualified horticulturalist) shall be submitted to the Principal Certifier, certifying that the landscape works have been completed in accordance with any conditions of consent.

Reason: Environmental amenity.

23. Condition of Retained Vegetation

Prior to the issue of an Occupation Certificate, a report prepared by an Arborist/Project Arborist with minimum AQF Level 5 in arboriculture shall be submitted to the Principal Certifier, assessing the health and impact on all existing trees required to be retained on the approved Plans or as listed in the Arboricultural Impact Assessment, including the following information:

- a) compliance to any Arborist recommendations for tree protection generally and during excavation works,
- b) extent of damage sustained by vegetation as a result of the construction works,
- c) any subsequent remedial works required to ensure the long term retention of the vegetation.

Reason: Tree and vegetation protection.

24. Positive Covenant and Restriction as to User for On-site Stormwater Disposal Structures

The Applicant shall lodge the Legal Documents Authorisation Application with Council. The application shall include the original completed request forms (NSW Land Registry standard forms 13PC and/or 13RPA) and a copy of the Works-as-Executed plan (details overdrawn on a copy of the approved drainage plan), and Civil Engineers' certification.

The Applicant shall create on the Title a positive covenant in respect to the ongoing maintenance and restriction as to user over the on-site stormwater disposal structures within this development consent. The terms of the positive covenant and restriction as to user are to be prepared to Council's standard requirements at the applicant's expense and endorsed by Northern Beaches Council's delegate prior to lodgment with the NSW Land Registry Services. Northern Beaches Council shall be nominated as the party to release, vary or modify such covenant. A copy of the certificate of title demonstrating the creation of the positive covenant and restriction as to user is to be submitted.

Details demonstrating compliance are to be submitted to the Principal Certifier prior to the issue of an Occupation Certificate.

Reason: To ensure the on-site stormwater disposal system is maintained to an appropriate operational standard.

25. Certification of solid fuel burning heaters

A certificate from an appropriately qualified person indicating the system is compliant with all relevant legislation, Building Code of Australia, Australian Standards, Specifications and manufacturer requirements is to be submitted to Council prior to the operation of the solid fuel heater.

Reason: To ensure the system operates in a legislatively compliant manner.

26. House / Building Number

House/building number is to be affixed to the building to be readily visible from the public domain.

Details demonstrating compliance are to be submitted to the Principal Certifier prior to the issue of an Occupation Certificate.

Reason: Proper identification of buildings.

ON-GOING CONDITIONS THAT MUST BE COMPLIED WITH AT ALL TIMES

27. Landscape Maintenance

If any landscape materials/components or planting under this consent fails, they are to be replaced with similar materials/components. Trees, shrubs and groundcovers required to be planted under this consent are to be mulched, watered and fertilised as required at the time of planting. If any tree, shrub or groundcover required to be planted under this consent fails, they are to be replaced with similar species to maintain the landscape theme and be generally in accordance with the approved Landscape Plans and any conditions of consent

The approved landscape area shall in perpetuity remain as planting under the development consent, and shall not be replaced with any hard paved surfaces or structures.

Reason: To maintain local environmental amenity.

In signing this report, I declare that I do not have a Conflict of Interest.

Signed



Michael French, Planner

The application is determined on 05/12/2024, under the delegated authority of:



Rodney Piggott, Manager Development Assessments