

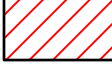

SITE AREA = 607m²
DWELLING = 190m²
OTHER AREAS (deck, driveway, patio, shed etc.) = 160m²
PROPOSED POOL AREA (incl. coping) = 44m²
TOTAL SITE B.U.A. = 394m²
SOFT LANDSCAPED ON ENTIRE LOT = 213m²

LOT WIDTH 18m PLUS 50% L/SCAPE FORWARD OF BUILDING LINE
LOT WIDTH 18m & UNDER 25% L/SCAPE FORWARD OF BUILDING LINE
MINIMUM OF 50% OF LANDSCAPING TO BE LOCATED BEHIND BUILDING LINE
PRIVATE OPEN SPACE AREA REQUIRED FOR SITE $>300m^2 = 24m^2$

A cross-sectional diagram of a retaining wall. The wall is shown in profile, with a vertical section on the right and a sloped section on the left. The wall is constructed from concrete with aggregate visible. Reinforcement includes 3-L11TM bars at the top and 5-L11TM bars along the vertical face. A horizontal line indicates the 'NGL' (Natural Ground Line). The wall is situated on 'STIFF NATURAL GROUND'. A 'POOL' is located to the left of the wall. The area between the wall and the pool is labeled 'FILL MATERIAL'. A 'STRUCTURAL TIE CONNECTION @200crs' is shown at the top right. Dimensions include a top width of 150, a vertical height of 150, and a total height of 'max 500mm'.

SCALE 1:20@A3

	DENOTES SOFT LANDSCAPE 1.5m WIDE & GREATER
	DENOTES SOFT LANDSCAPE LESS THAN 1.5m WIDE
	DENOTES HARDSTAND (CONCRETE, GRAVEL, PAVERS ETC.)
	DENOTES BUILDING STRUCTURES

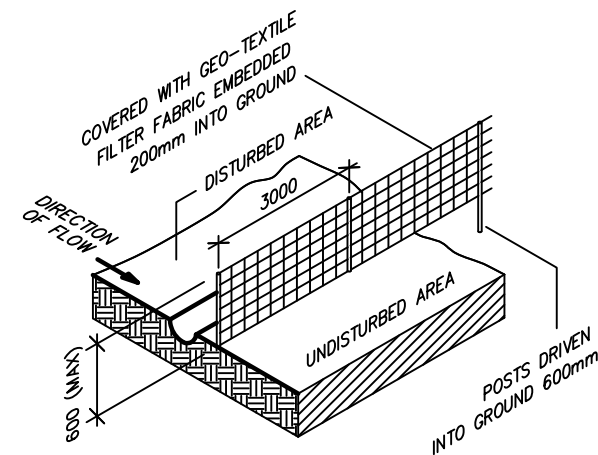

▲ DATUM - TOP OF EXISTING PATH. TOP OF POOL TO BE LEVEL WITH THE DATUM AT 10.0 (ASSUMED)

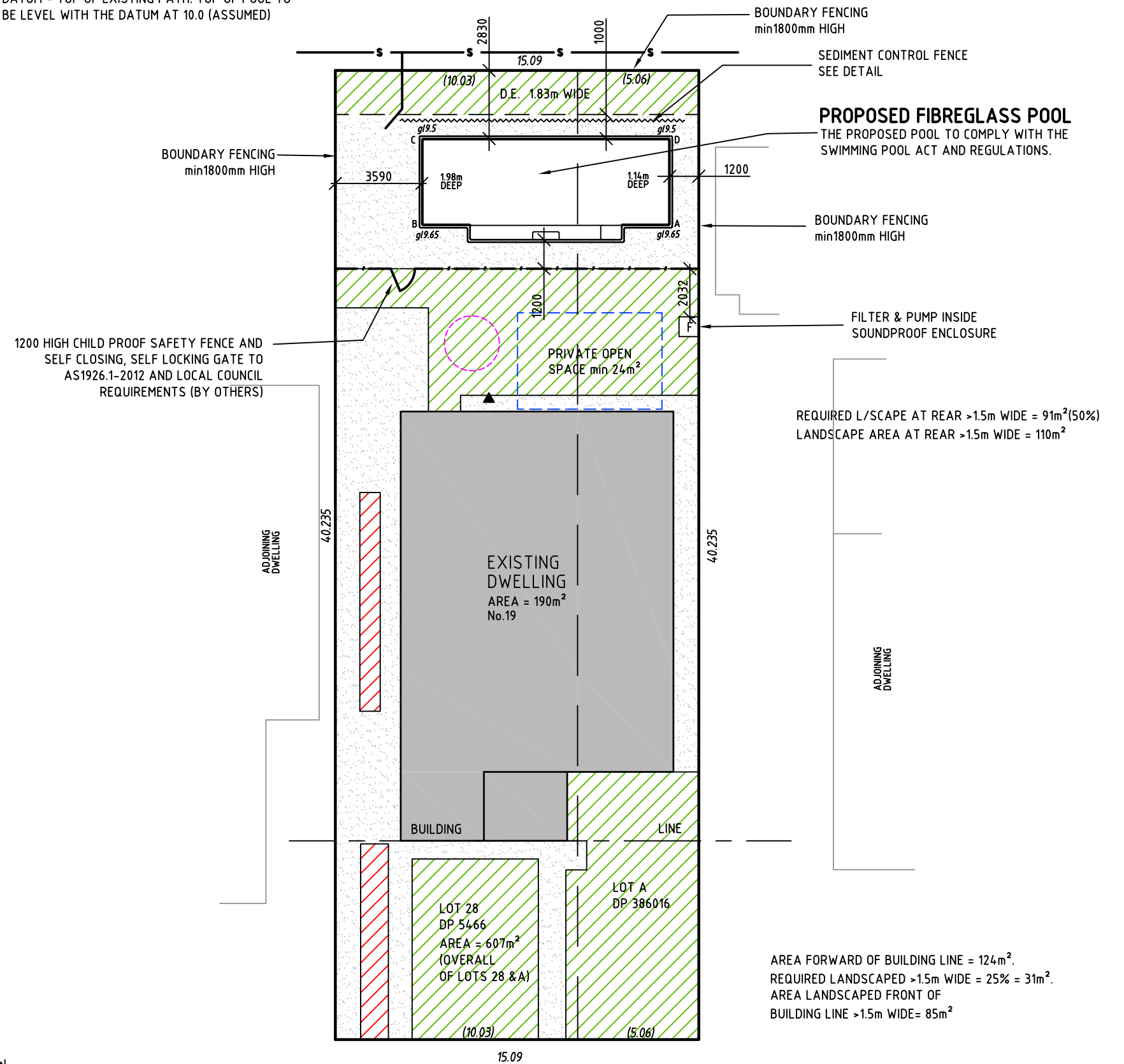

AREA FORWARD OF BUILDING LINE = 124m^2 .
 REQUIRED LANDSCAPED >1.5m WIDE = 25% = 31m^2 .
 AREA LANDSCAPED FRONT OF
 BUILDING LINE >1.5m WIDE= 85m^2

SCALE 1:200@A3

 DESIGNATED AREA FOR WASTE & MATERIAL STOCKPILE. EXCESS WASTE TO BE REMOVED FROM SITE

Sydney City x Central Coast x Illawarra
sales@barrierreefpoolssydney.com.au
www.barrierreefpoolssydney.com.au
ce 3, Suite 3.10, 4 Ilya Ave, Erina NSW 2250 - 0422172781

THE PROPOSED POOL TO COMPLY WITH THE SWIMMING POOL ACT AND REGULATIONS.

KELLY KRIGE
19 SURFERS PARADE
FRESHWATER NSW

ISSUE	DATE	REVISION
A	29/07/19	INITIAL ISSUE

SHEET 1 of 2



SOUTH-ELEVATION
SCALE 1 : 100@A3



NORTH-ELEVATION
SCALE 1 : 100@A3

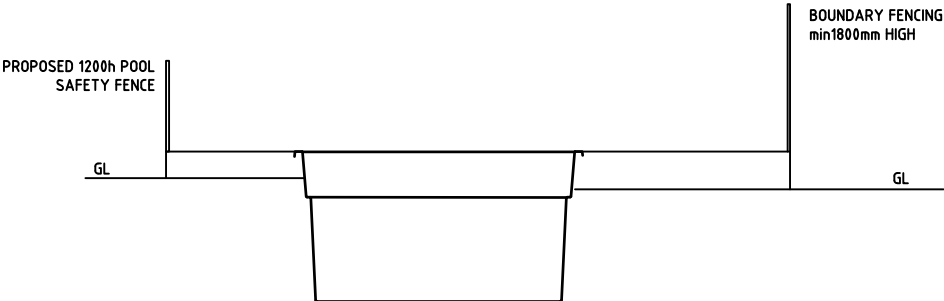

EAST-ELEVATION
SCALE 1 : 100@A3

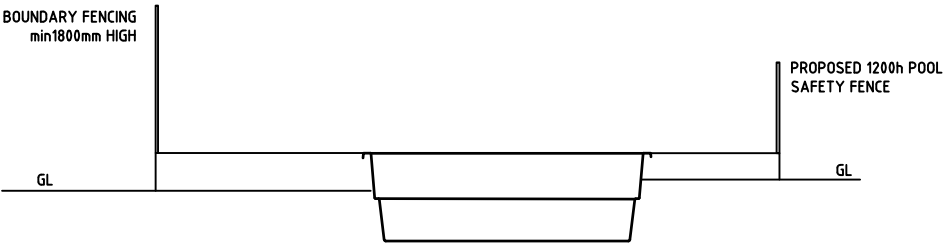

WEST-ELEVATION
SCALE 1 : 100@A3

<div><div>SITE LEVELS</div><div>TOP OF POOL COPING LEVEL +/- FROM EXISTING GROUND LEVEL.</div><div>A: +350</div><div>B: +350</div><div>C: +500</div><div>D: +500</div></div>	<div><div></div><div>DESIGNATED AREA FOR WASTE & MATERIAL STOCKPILE. EXCESS WASTE TO BE REMOVED FROM SITE</div></div>	<div><div>BARRIER REEF POOLS</div><div>Sydney City x Central Coast x Illawarra</div><div>sales@barrierreefpoolssydney.com.au</div><div>www.barrierreefpoolssydney.com.au</div><div>Office 3 , Suite 3,10, 4 Ilya AVE, Erina NSW 2250 – 0422172781</div></div>	<div><div>Pool: VENICE 10.5 x4.4m</div><div>Volume: 44,000 LTRS</div><div>THE PROPOSED POOL TO COMPLY WITH THE SWIMMING POOL ACT AND REGULATIONS.</div></div>	<div>CUSTOMER / ADDRESS</div> <div>KELLY KRIGE</div> <div>19 SURFERS PARADE</div> <div>FRESHWATER NSW</div>		ISSUE	DATE	REVISION
				A	29/07/19	INITIAL ISSUE		
				SHEET		2 of 2		