

KEY

	CAR ENTRY POINT
	BOUNDARY
	CDC 250041 APPROVED DEMOLISHED STRUCTURES
	CDC 250041 APPROVED ADDITIONS
	DEMOLISHED
	PREVAILING WINDS (summer)
	PREVAILING WINDS (winter)
	WINDOW TO LIVING SPACE IN ADJACENT DWELLING
	EXISTING CONTOURS SLOPE OF LAND
	ROAD NOISE
	PROPOSED ADDITIONS
	PROPOSED DRIVEWAY EXTENSION

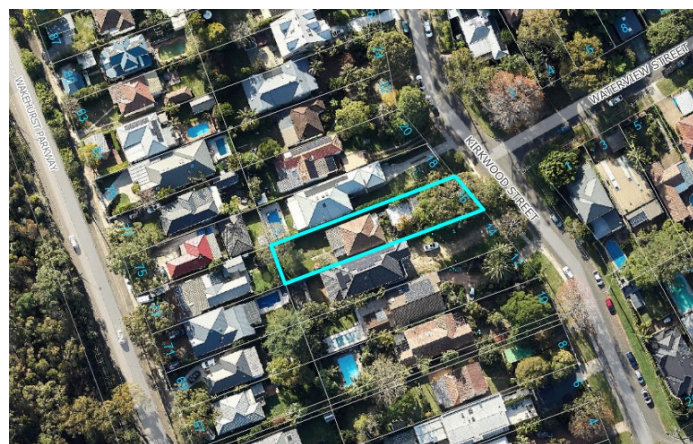

AERIAL VIEW OF 16 KIRKWOOD STREET, SEAFORTH  
SCALE - N.T.S

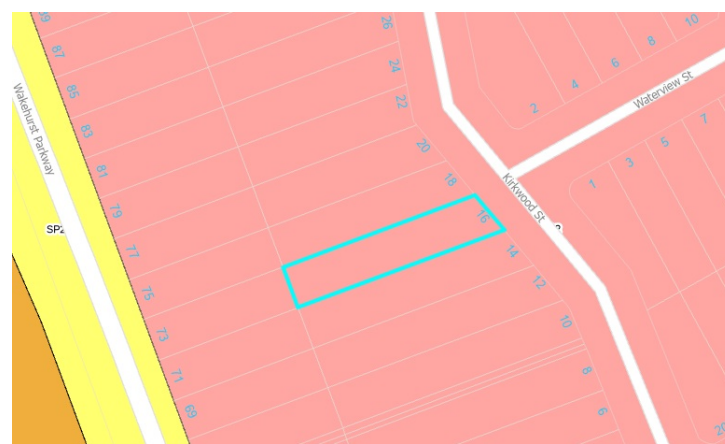

ZONING MAP OF 16 KIRKWOOD STREET, SEAFORTH  
SCALE - N.T.S

SITE CALCULATIONS

	Required	Proposed
Site Area	746.0m2	
Floor Space Ratio	0.45:1	0.32:1
Setbacks -(mm)		
-East (front)	6000 min.	17769
-North (side)	2082	900/2514
-South (side)	2082	1679
<b>EXISTING OPEN SPACE AREA (OS3)</b>	500.6m2	
<b>PROPOSED OPEN SPACE AREA (OS3)</b>	410.3m2	389.2m2
<b>EXISTING LANDSCAPED AREA</b>	424.5m2	
<b>PROPOSED LANDSCAPED AREA</b>	143.6lm2	343.0m2



PROPOSED WORKS

