





Shadow Diagram - June 21st

LEGEND:

-  Existing Shadow Cast by Existing Residence
-  9am Additional Shadow cast by proposed Vergola
-  12pm Additional Shadow cast by proposed Vergola
-  3pm Additional Shadow cast by proposed Vergola

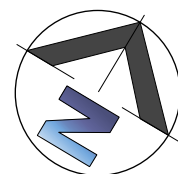

**ALL MEASUREMENTS TO
BE VERIFIED AT C/M**

GENERAL NOTES

All work to be carried out in accordance with the Building Code of Australia, all Local and State Government Ordinances, relevant Australian Standards, Local Electricity and Water Authorities Regulations and all other relevant Authorities concerned.

All timbers to be in accordance with SAA Timber Structure Code AS1720 and SAA Timber Framing Code AS 1684.

All work to be carried out in a professional and workmanlike manner according to the plans and specification.

Do not scale off the drawings unless otherwise stated and use figured dimensions in preference.

All dimensions are to be checked and verified on site before the commencement of any work.

Locate and protect all services prior to construction.



7 TEPKO ROAD TERREY HILLS NSW 2084
TEL: (02) 9450 3300
FAX: (02) 9450 3333

Project:

**PROPOSED VERGOLA
LOUVERED ROOF SYSTEM
AT EXISTING RESIDENCE**

Client:

ROBERT & DANIELLE COTTERILL

Address:



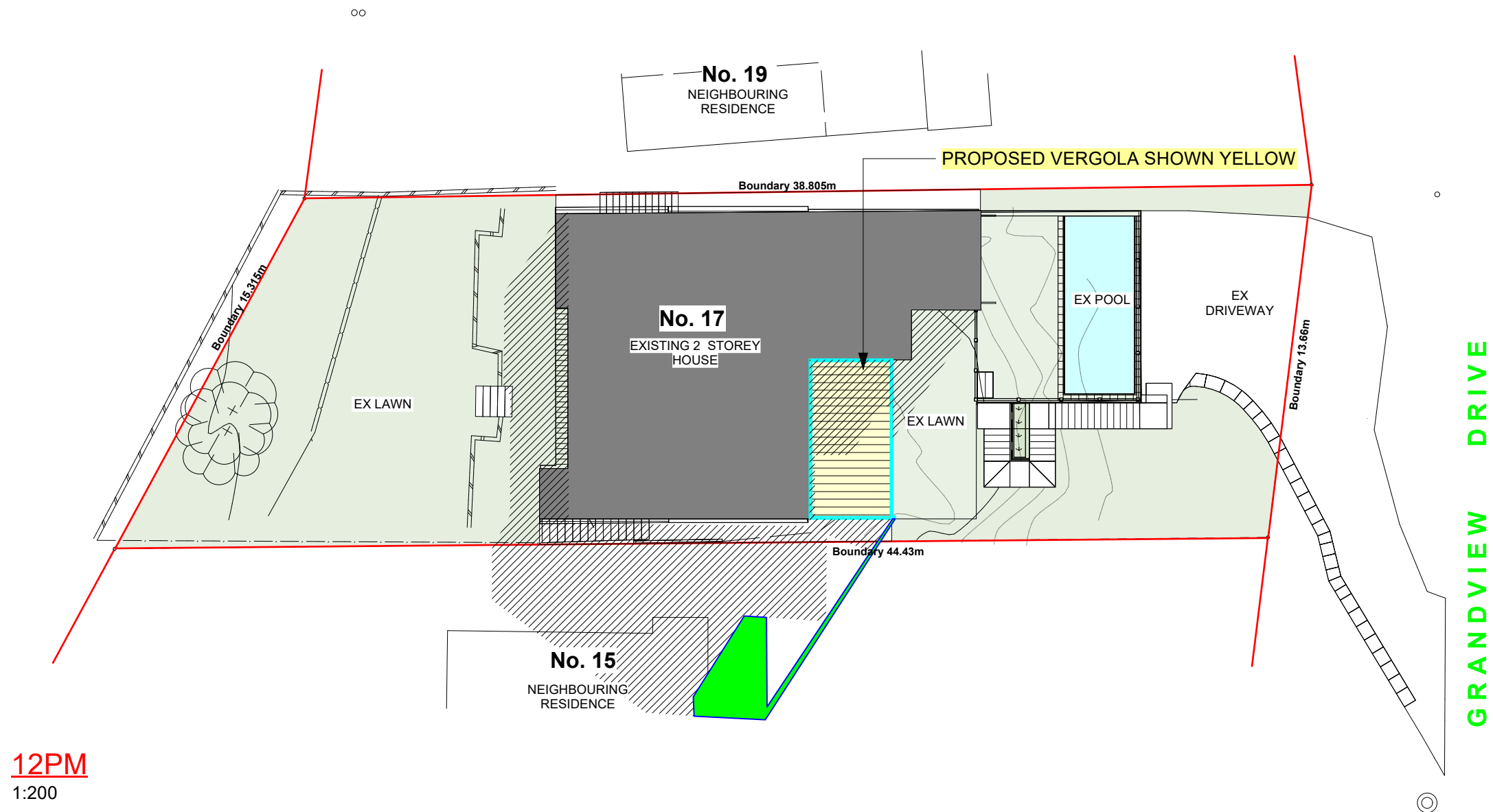

**17 GRANDVIEW DRIVE
NEWPORT - NSW - 2106**

DATE DRAFTED	15-05-25	AMENDED DATE	A -
SALES REP.	M.H.		B -
			C -
DRAWN	JGW	SHEET No.	1 OF 3
DRAWING No.	19791	DATE SIGNED	
SCALE.	AS NOTED @ A3		
CLIENT'S SIGNATURE			



Shadow Diagram - June 21st

LEGEND:

-  Existing Shadow Cast by Existing Residence
-  9am Additional Shadow cast by proposed Vergola
-  12pm Additional Shadow cast by proposed Vergola
-  3pm Additional Shadow cast by proposed Vergola

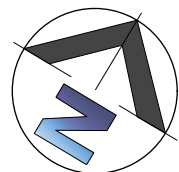

**ALL MEASUREMENTS TO
BE VERIFIED AT C/M**

GENERAL NOTES

All work to be carried out in accordance with the Building Code of Australia, all Local and State Government Ordinances, relevant Australian Standards, Local Electricity and Water Authorities Regulations and all other relevant Authorities concerned.
All timbers to be in accordance with SAA Timber Structure Code AS1720 and SAA Timber Framing Code AS 1684.
All work to be carried out in a professional and workmanlike manner according to the plans and specification.
Do not scale off the drawings unless otherwise stated and use figured dimensions in preference.
All dimensions are to be checked and verified on site before the commencement of any work.
Locate and protect all services prior to construction.



7 TEPKO ROAD TERREY HILLS NSW 2084
TEL: (02) 9450 3300
FAX: (02) 9450 3333

Project:

**PROPOSED VERGOLA
LOUVERED ROOF SYSTEM
AT EXISTING RESIDENCE**
Client:
ROBERT & DANIELLE COTTERILL
Address:
**17 GRANDVIEW DRIVE
NEWPORT - NSW - 2106**



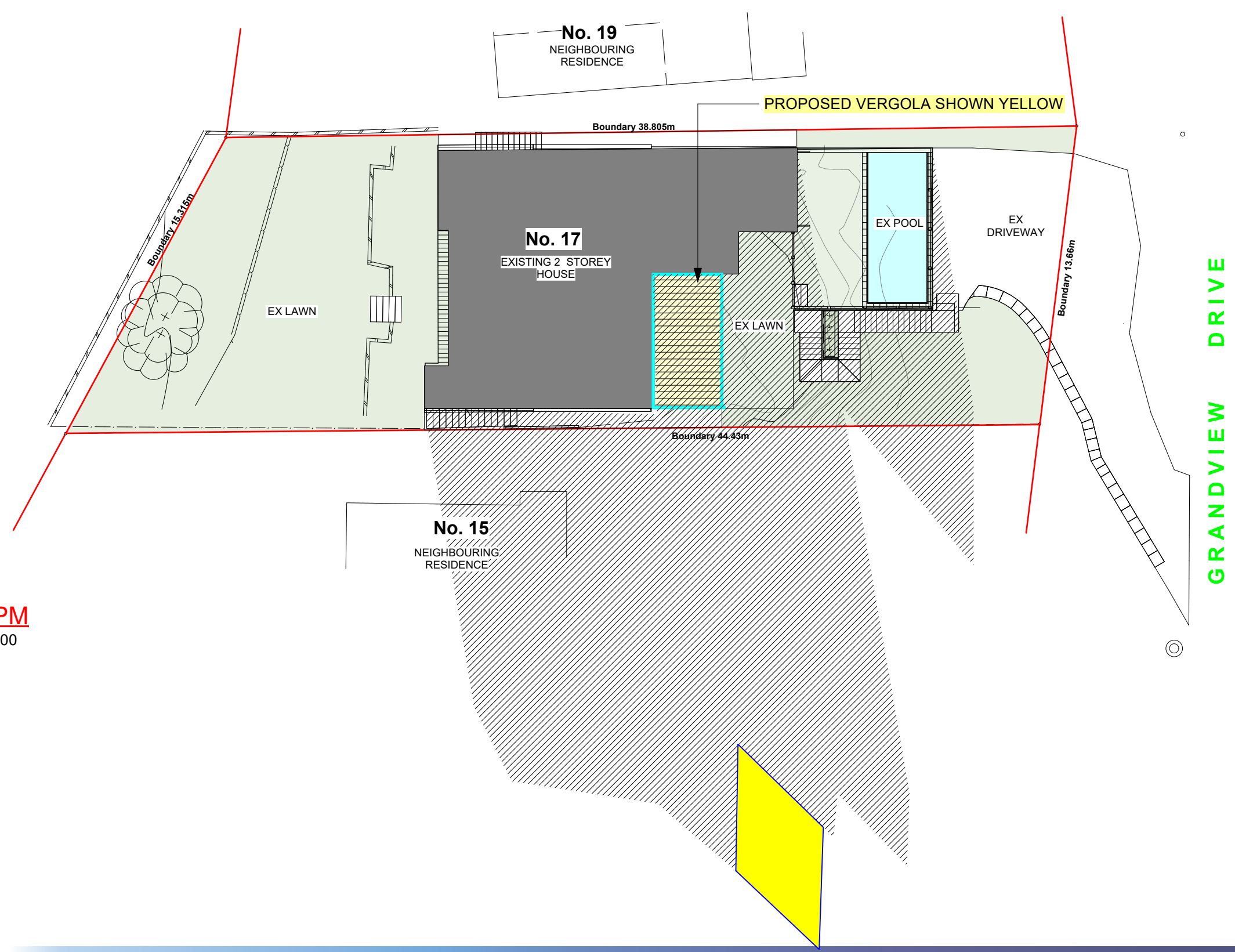

DATE DRAFTED	15-05-25	AMENDED DATE	A -
SALES REP.	M.H.		B -
			C -
DRAWN	JGW	SHEET No.	2 OF 3
DRAWING No.	19791	DATE SIGNED	
SCALE	AS NOTED @ A3		
CLIENT'S SIGNATURE			



3PM
1:200

Shadow Diagram - June 21st

LEGEND:

-  Existing Shadow Cast by Existing Residence
-  9am Additional Shadow cast by proposed Vergola
-  12pm Additional Shadow cast by proposed Vergola
-  3pm Additional Shadow cast by proposed Vergola

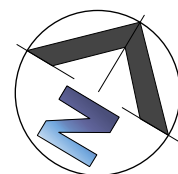

ALL MEASUREMENTS TO
BE VERIFIED AT C/M

GENERAL NOTES

All work to be carried out in accordance with the Building Code of Australia, all Local and State Government Ordinances, relevant Australian Standards, Local Electricity and Water Authorities Regulations and all other relevant Authorities concerned.
All timbers to be in accordance with SAA Timber Structure Code AS1720 and SAA Timber Framing Code AS 1684.
All work to be carried out in a professional and workmanlike manner according to the plans and specification.
Do not scale off the drawings unless otherwise stated and use figured dimensions in preference.
All dimensions are to be checked and verified on site before the commencement of any work.
Locate and protect all services prior to construction.



7 TEPKO ROAD TERREY HILLS NSW 2084
TEL: (02) 9450 3300
FAX: (02) 9450 3333

Project:

**PROPOSED VERGOLA
LOUVERED ROOF SYSTEM
AT EXISTING RESIDENCE**
Client:
ROBERT & DANIELLE COTTERILL
Address:
**17 GRANDVIEW DRIVE
NEWPORT - NSW - 2106**

DATE DRAFTED	15-05-25	AMENDED DATE	A -
SALES REP.	M.H.		B -
			C -
DRAWN	JGW	SHEET No.	3 OF 3
DRAWING No.	19791	DATE SIGNED	
SCALE	AS NOTED @ A3		
CLIENT'S SIGNATURE			