

26  
DP 20771

27  
DP 20771

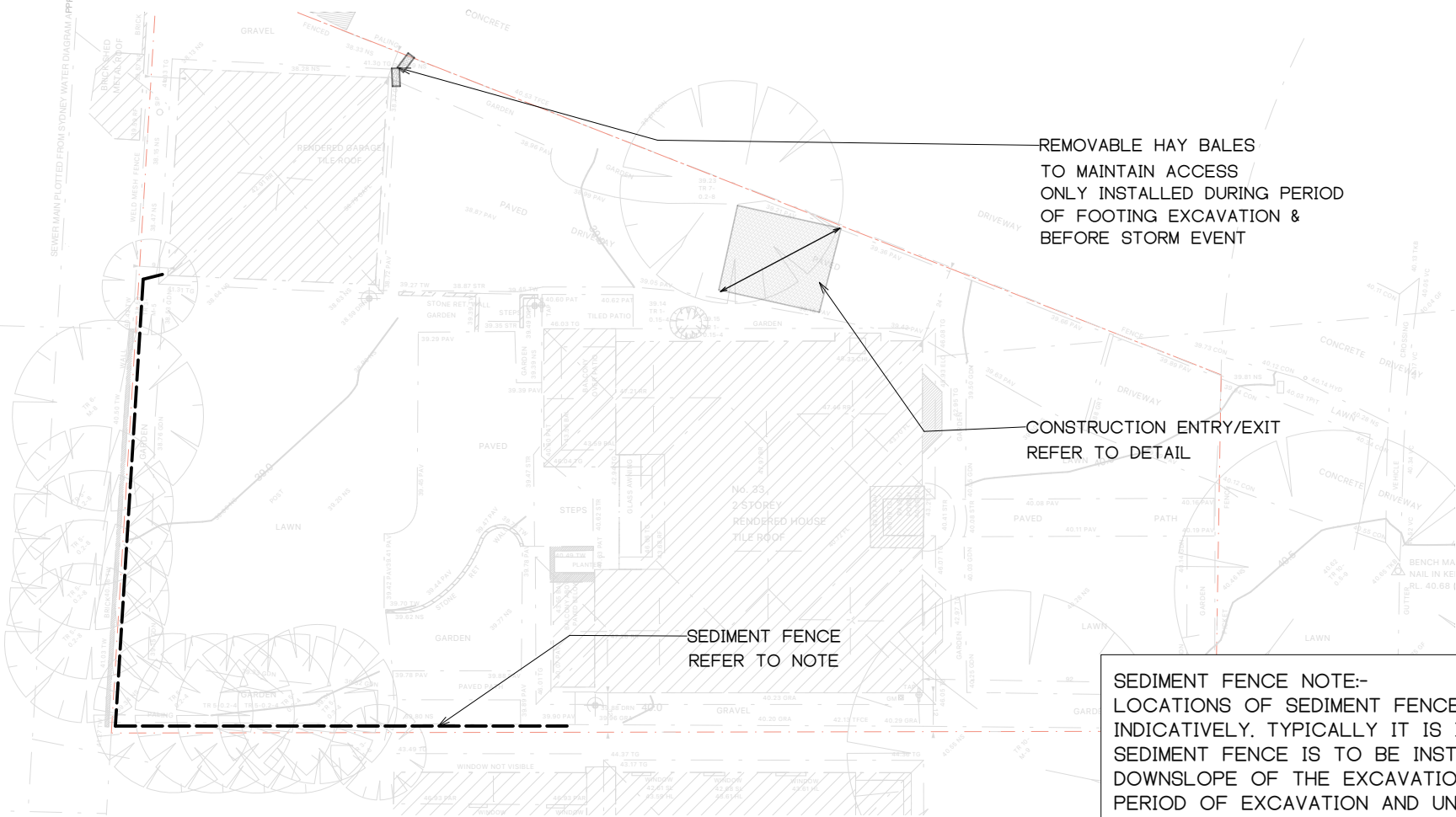

## SEDIMENT AND EROSION CONTROL PLAN

SCALE 1:200

SEDIMENT FENCE NOTE:-  
LOCATIONS OF SEDIMENT FENCES ARE SHOWN INDICATIVELY. TYPICALLY IT IS INTENDED A SEDIMENT FENCE IS TO BE INSTALLED DOWNSLOPE OF THE EXCAVATION WORK, FOR THE PERIOD OF EXCAVATION AND UNTIL SUCH TIME THAT THE GROUND AND ROOF DRAINAGE IS COMPLETED SUCH THAT RUNOFF CAN EXIT SITE IN A CONTROLLED MANNER

REV	ISSUE DATE	DESCRIPTION
A	31/1/2025	ISSUE FOR DA

### REVISIONS

Project/Builder/Designer	Scale 1:200	Drawing Size A3
Client Name	Job No.	Rev
GREGORY AND MELINDA WILL	244091	A
Sheet Title	Sheet	Rev
SEDIMENT & EROSION CONTR	SE11	A

### ALTERATIONS & ADDITIONS BY BEACHES

Project Address  
33 MARLBOROUGH ST, FRESHWATER

### SEDIMENT & EROSION CONTR

Building Designer  
BEACHES GROUP  
Building Designer Contact  
02 9940 2229

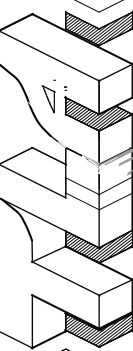

TJA Engineers

Address  
Killamey Heights NSW  
Phone Number  
0409446570

ACN

656 067 582

Email

lg@tjaengineers.com.au

Website

www.tjaengineers.com.au

Checked by

Approved by

Date

Date

LG

*Signature*

Authorisation Luke Gerkens (Engineer) BE(Civil) MIEAust NE

Job Ref/Sheet/ Rev

244091 SE11 A

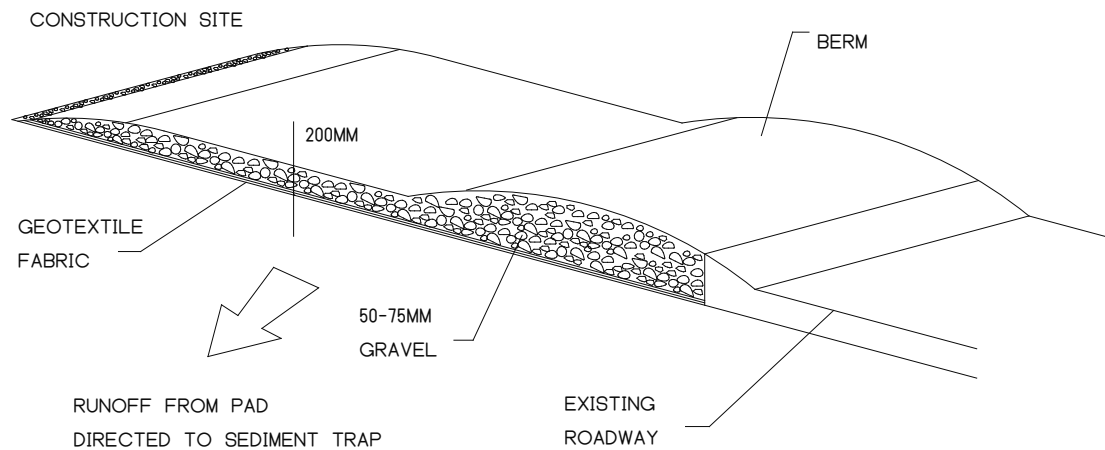

**TEMPORARY CONSTRUCTION EXIT**  
NOT TO SCALE

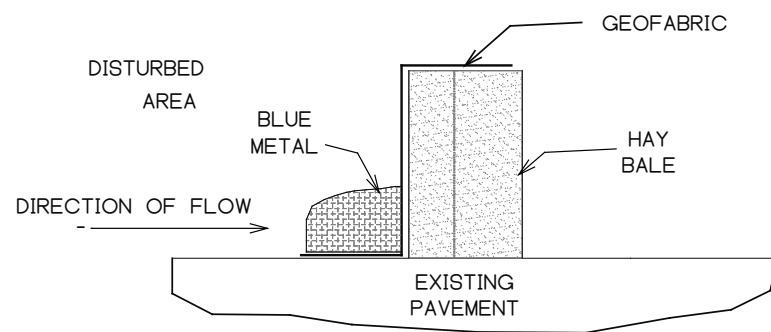

**STRAW BALE DETAIL  
ON EXISTING PAVEMENT**  
SCALE NTS

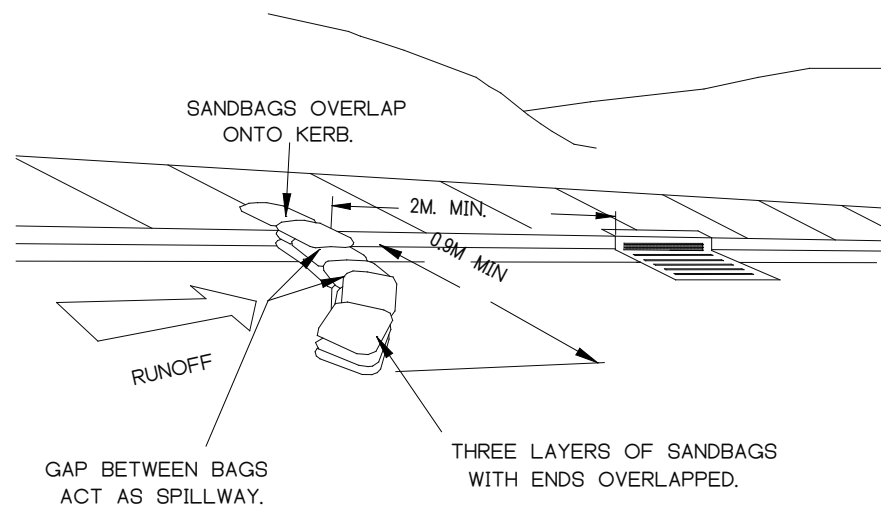

**SANDBAG KERB INLET SEDIMENT TRAP**  
SCALE NTS

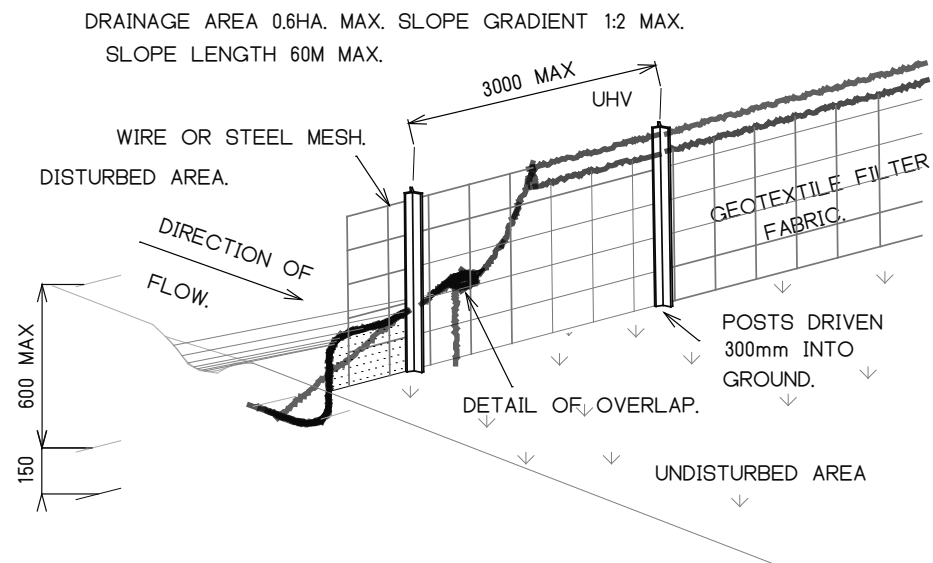

**SEDIMENT FENCE**

**CONSTRUCTION NOTES:**

1. CONSTRUCT SEDIMENT FENCE AS CLOSE AS POSSIBLE TO PARALLEL TO THE CONTOURS OF THE SITE.
2. DRIVE 1.2 METRE LONG STAR PICKETS INTO GROUND, 3 METRES APART.
3. DIG A 150mm DEEP TRENCH ALONG THE UPSLOPE LINE OF THE FENCE FOR THE BOTTOM OF THE FABRIC TO BE ENTRENCHED.
4. BACKFILL TRENCH OVER BASE OF FABRIC.
5. FIX SELF-SUPPORTING GEOTEXTILE TO UPSLOPE SIDE OF POSTS WITH WIRE TIES or AS RECOMMENDED BY GEOTEXTILE MANUFACTURER.
6. JOIN SECTIONS OF FABRIC AT A SUPPORT POST WITH A 150mm OVERLAP.

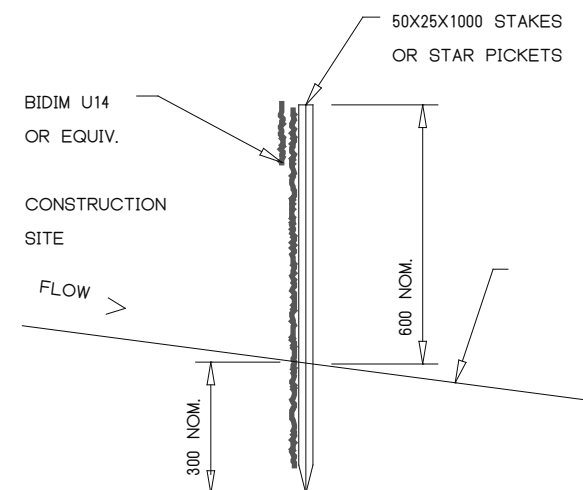

**SILT FENCE DETAIL**  
N.T.S.

- LAP BIDIM OVER 50MM & STITCH WITH TIE WIRE  
LOOPE AT 100MM CENTRES
- REMOVE SILT AFTER EACH MAJOR STORM

REV	ISSUE DATE	DESCRIPTION
A	31/1/2025	ISSUE FOR DA

Scale 1:1	Drawing Size A3
Job No. 244091	Rev A

ALTERATIONS & ADDITIONS BY BEACHES GROUP

GREGORY AND MELINDA WILL

SEDIMENT & EROSION CONTROL DETAILS

Project Address  
33 MARLBOROUGH ST, FRESHWATER

Client Name  
GREGORY AND MELINDA WILL

Sheet Title  
SEDIMENT & EROSION CONTROL DETAILS

Building Designer  
BEACHES GROUP

Building Designer Contact  
02 9940 2229

ACN 656 057 582

Email g@tlaengineers.com.au

Website www.tlaengineers.com.au

TLA Engineers

Address Killarney Heights NSW

Phone Number 0409446570

5	4	3	2	1
Checked by	Date	Approved by	Date	Rev
				A