Sent: 15/04/2020 12:31:54 PM
Subject: NBLPP meeting today - Item 3.4 - information for Panel
Attachments: SP 15042020.pdf;

Hi Carly,

Some more information for the Panel.

Recommended condition 19 seeks the submission of swept path diagrams prior to the release of the Construction Certificate. To assuage any concerns, those diagrams have now been prepared (see attached). Consequently, condition 19 is redundant and the concern has been addressed.

Regards,

Geoff Goodyer | Principal Town Planner | Symons Goodyer Pty Ltd
Town Planning and Development Consultants
T 02 9949 2130 | M 0413 361 483
67a Wanganella Street, Balgowlah
PO Box 673 Balgowlah NSW 2093

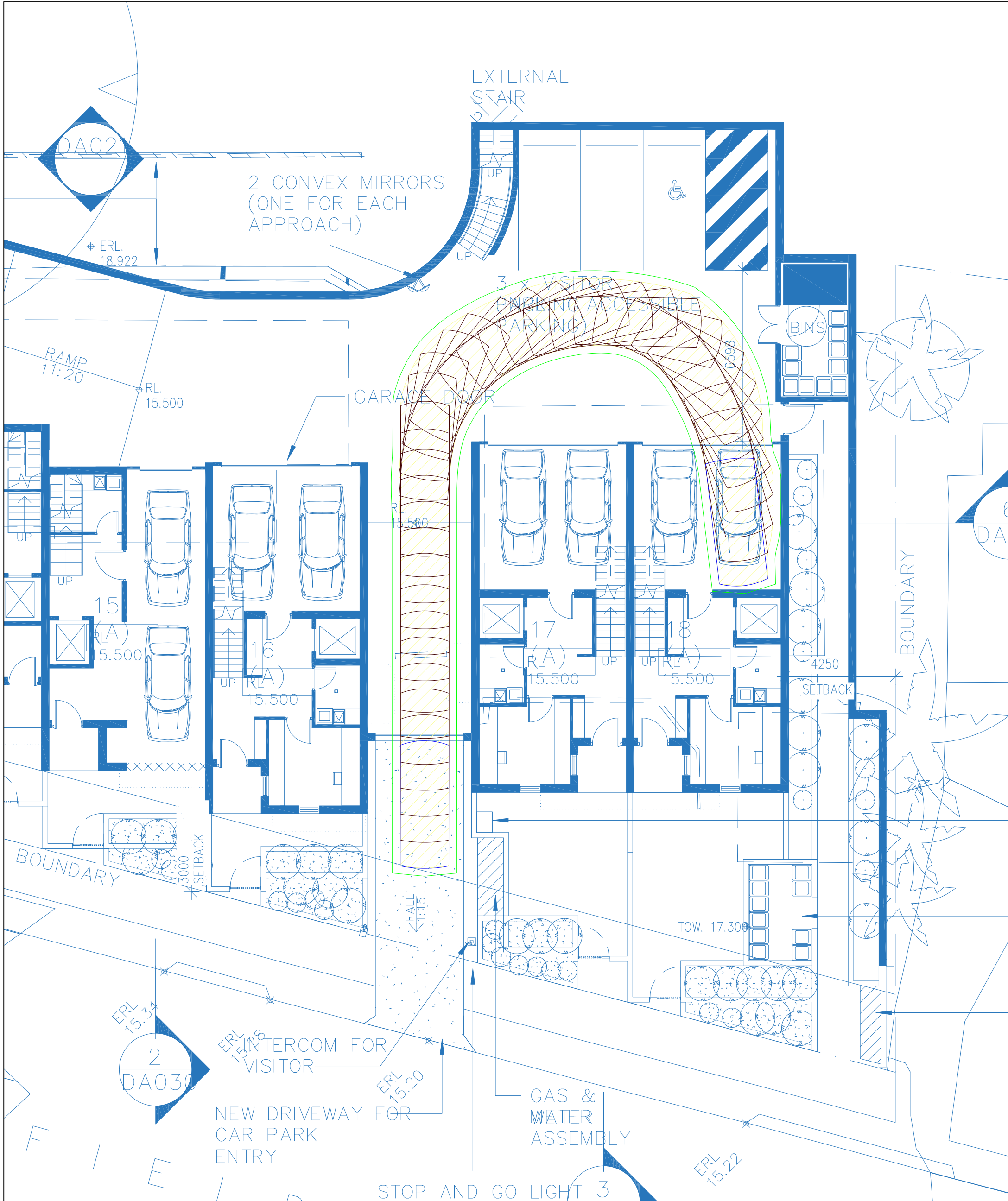

LEGEND

This drawing has been prepared using vehicle modelling computer software AutoTURN PRO10 in conjunction with AutoCAD 2018. The vehicle used is based upon vehicle data provided by Austroads and incorporates a reasonable degree of tolerance. However, it is not possible to account for all vehicle types/characteristics and/or driver ability.

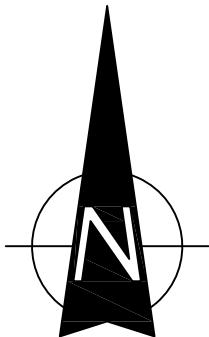

**SWEPT PATH ANALYSIS
OF AN 85th PERCENTILE
VEHICLE ENTERING THE SITE**

SP 1

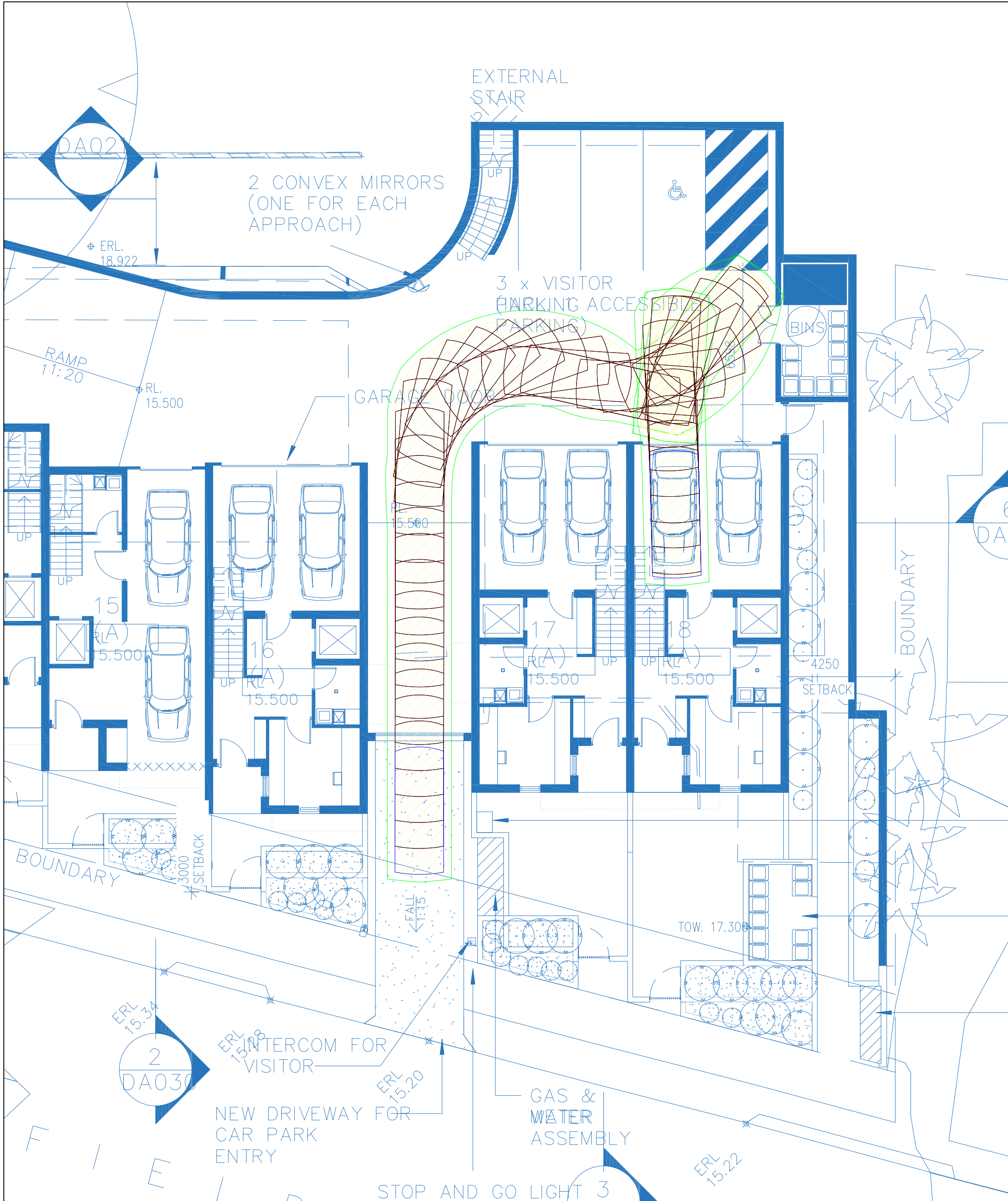

LEGEND

This drawing has been prepared using vehicle modelling computer software AutoTURN PRO10 in conjunction with AutoCAD 2018. The vehicle used is based upon vehicle data provided by Austroads and incorporates a reasonable degree of tolerance. However, it is not possible to account for all vehicle types/characteristics and/or driver ability.

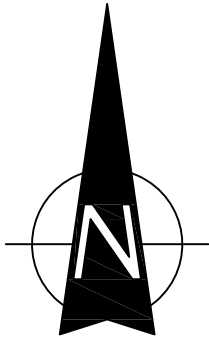

**SWEPT PATH ANALYSIS
OF AN 85th PERCENTILE
VEHICLE ENTERING THE SITE**

SP 3

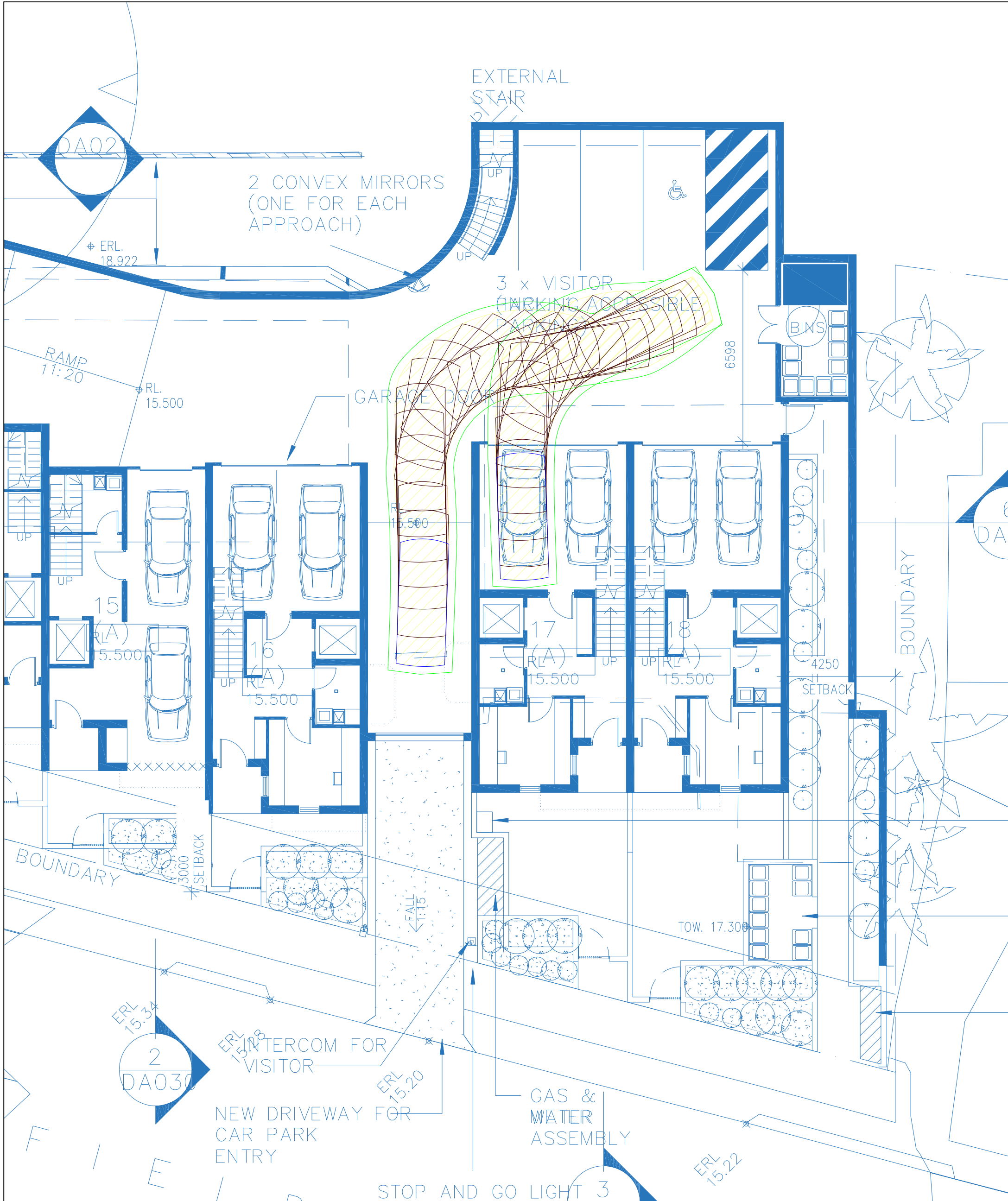

LEGEND

This drawing has been prepared using vehicle modelling computer software AutoTURN PRO10 in conjunction with AutoCAD 2018. The vehicle used is based upon vehicle data provided by Austroads and incorporates a reasonable degree of tolerance. However, it is not possible to account for all vehicle types/characteristics and/or driver ability.

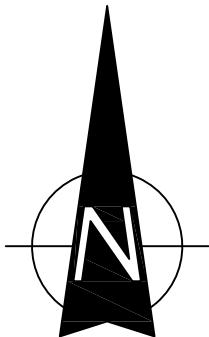

**SWEPT PATH ANALYSIS
OF AN 85th PERCENTILE
VEHICLE ENTERING THE SITE**

SP 5

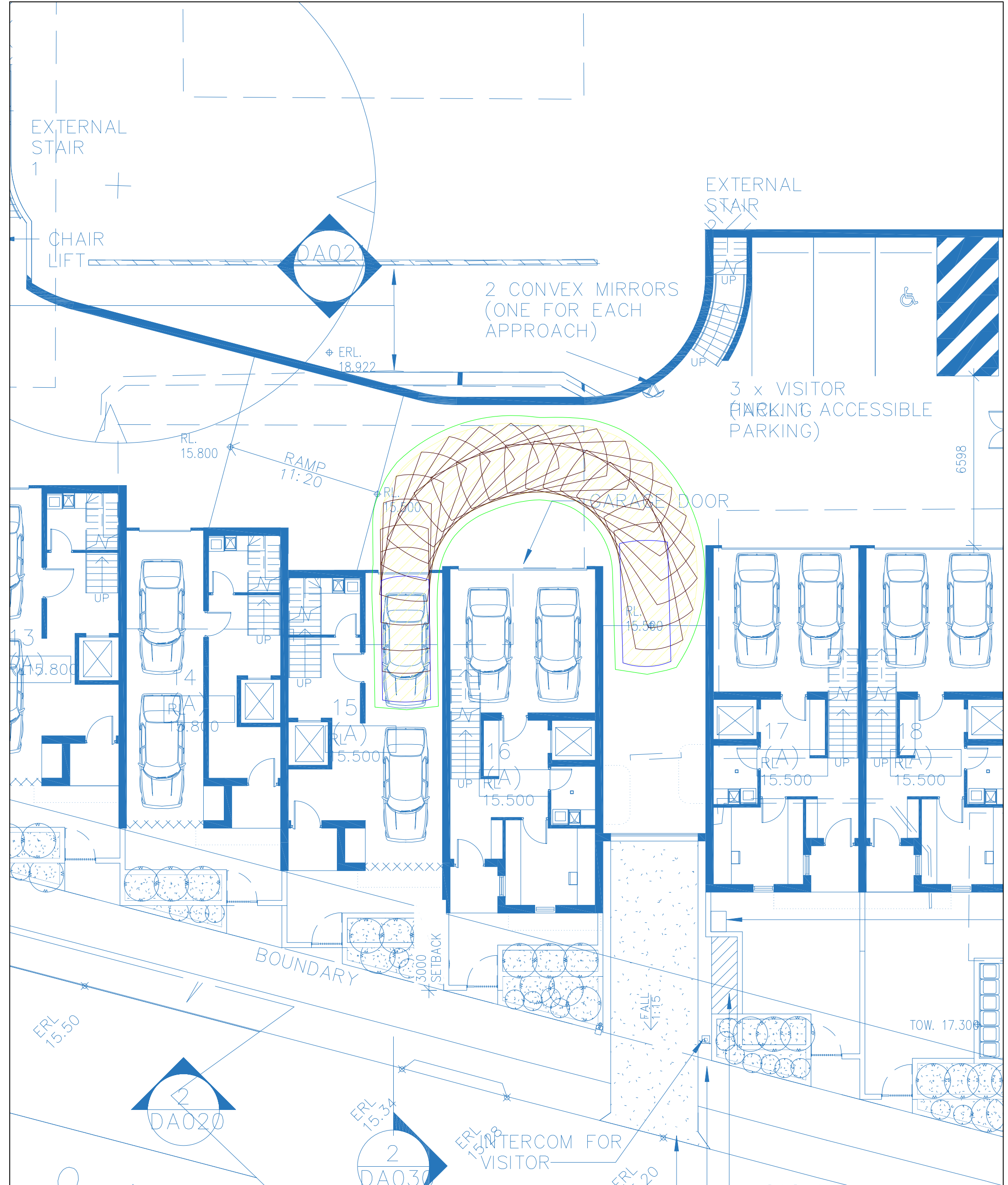

LEGEND

This drawing has been prepared using vehicle modelling computer software AutoTURN PRO10 in conjunction with AutoCAD 2018. The vehicle used is based upon vehicle data provided by Austroads and incorporates a reasonable degree of tolerance. However, it is not possible to account for all vehicle types/characteristics and/or driver ability.

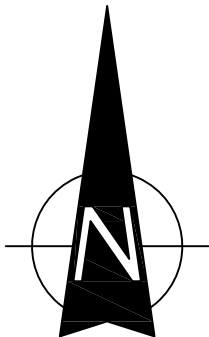

**SWEPT PATH ANALYSIS
OF AN 85th PERCENTILE
VEHICLE EXITING THE SITE**

SP 8



LEGEND

This drawing has been prepared using vehicle modelling computer software AutoTURN PRO10 in conjunction with AutoCAD 2018. The vehicle used is based upon vehicle data provided by Austroads and incorporates a reasonable degree of tolerance. However, it is not possible to account for all vehicle types/characteristics and/or driver ability.

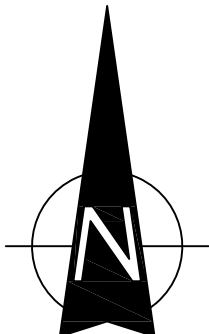

**SWEPT PATH ANALYSIS
OF AN 85th PERCENTILE
VEHICLE ENTERING THE SITE**

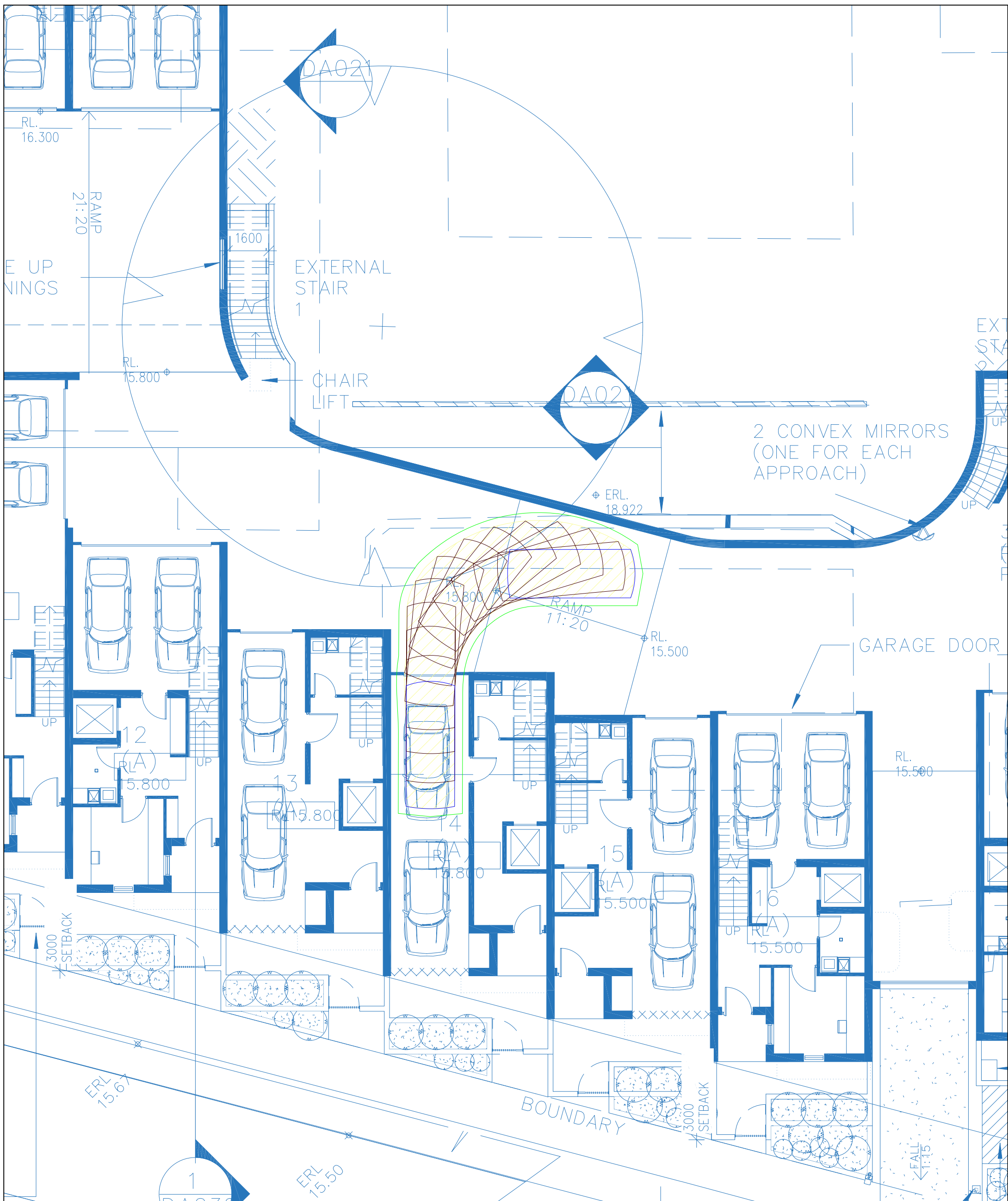

LEGEND

This drawing has been prepared using vehicle modelling computer software AutoTURN PRO10 in conjunction with AutoCAD 2018. The vehicle used is based upon vehicle data provided by Austroads and incorporates a reasonable degree of tolerance. However, it is not possible to account for all vehicle types/characteristics and/or driver ability.

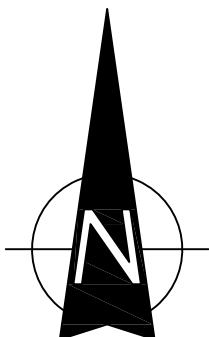

**SWEPT PATH ANALYSIS
OF AN 85th PERCENTILE
VEHICLE EXITING THE SITE**

SP 10

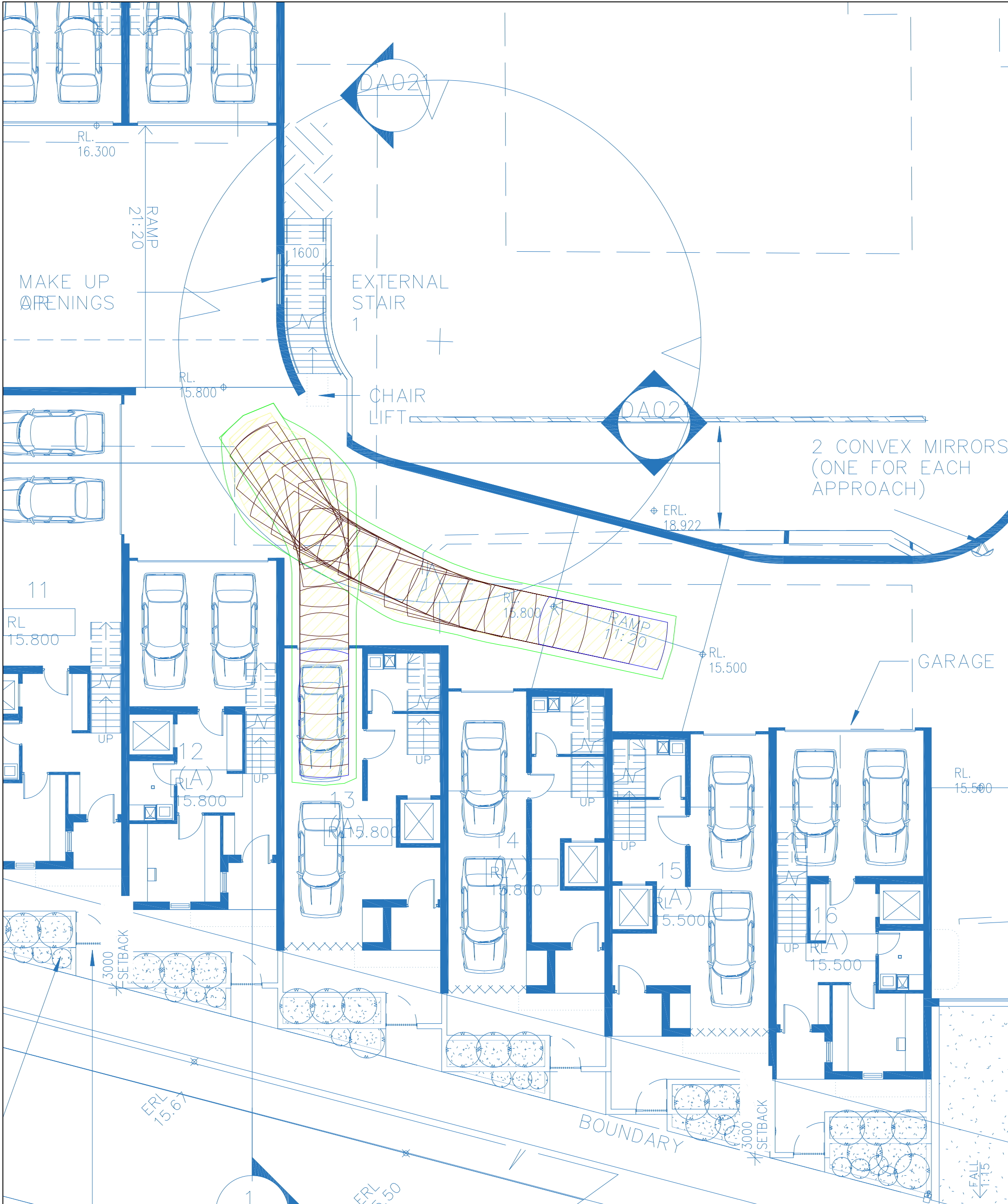

LEGEND

This drawing has been prepared using vehicle modelling computer software AutoTURN PRO10 in conjunction with AutoCAD 2018. The vehicle used is based upon vehicle data provided by Austroads and incorporates a reasonable degree of tolerance. However, it is not possible to account for all vehicle types/characteristics and/or driver ability.

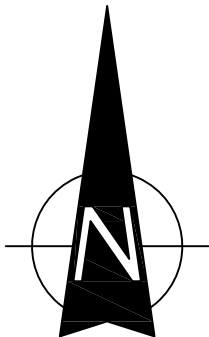

**SWEPT PATH ANALYSIS
OF AN 85th PERCENTILE
VEHICLE ENTERING THE SITE**

SP 11

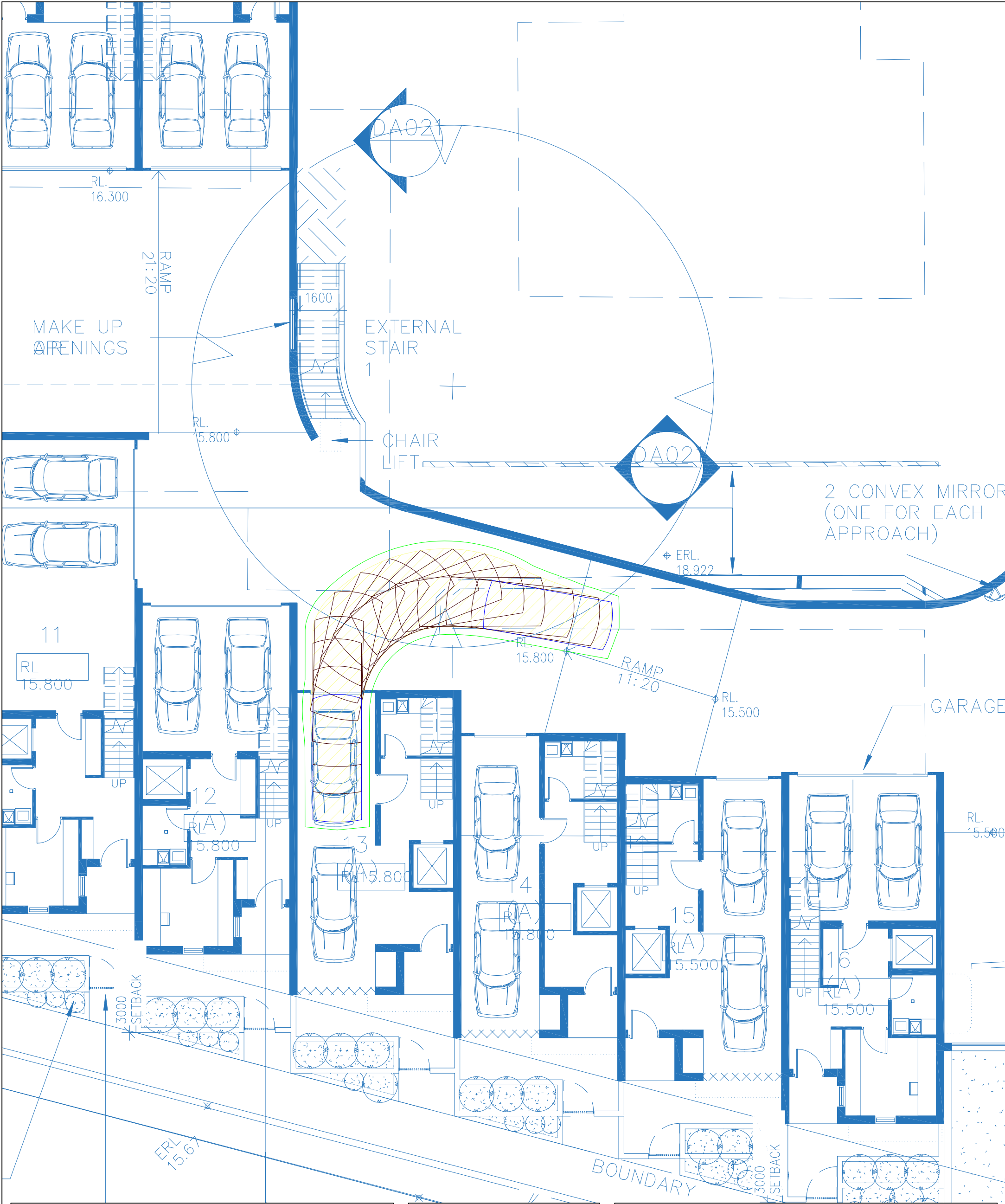

LEGEND

This drawing has been prepared using vehicle modelling computer software AutoTURN PRO10 in conjunction with AutoCAD 2018. The vehicle used is based upon vehicle data provided by Austroads and incorporates a reasonable degree of tolerance. However, it is not possible to account for all vehicle types/characteristics and/or driver ability.

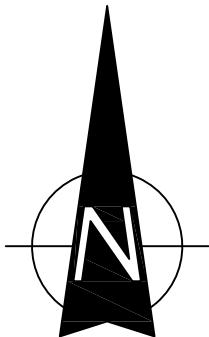

**SWEPT PATH ANALYSIS
OF AN 85th PERCENTILE
VEHICLE EXITING THE SITE**



LEGEND

This drawing has been prepared using vehicle modelling computer software AutoTURN PRO10 in conjunction with AutoCAD 2018. The vehicle used is based upon vehicle data provided by Austroads and incorporates a reasonable degree of tolerance. However, it is not possible to account for all vehicle types/characteristics and/or driver ability.

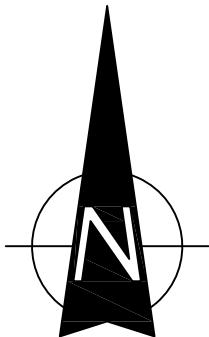

**SWEPT PATH ANALYSIS
OF AN 85th PERCENTILE
VEHICLE ENTERING THE SITE**

SP 15



LEGEND

This drawing has been prepared using vehicle modelling computer software AutoTURN PRO10 in conjunction with AutoCAD 2018. The vehicle used is based upon vehicle data provided by Austroads and incorporates a reasonable degree of tolerance. However, it is not possible to account for all vehicle types/characteristics and/or driver ability.

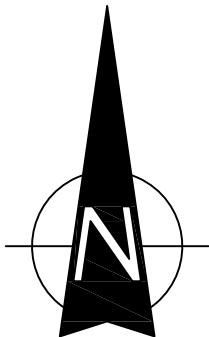

**SWEPT PATH ANALYSIS
OF AN 85th PERCENTILE
VEHICLE EXITING THE SITE**

SP 16

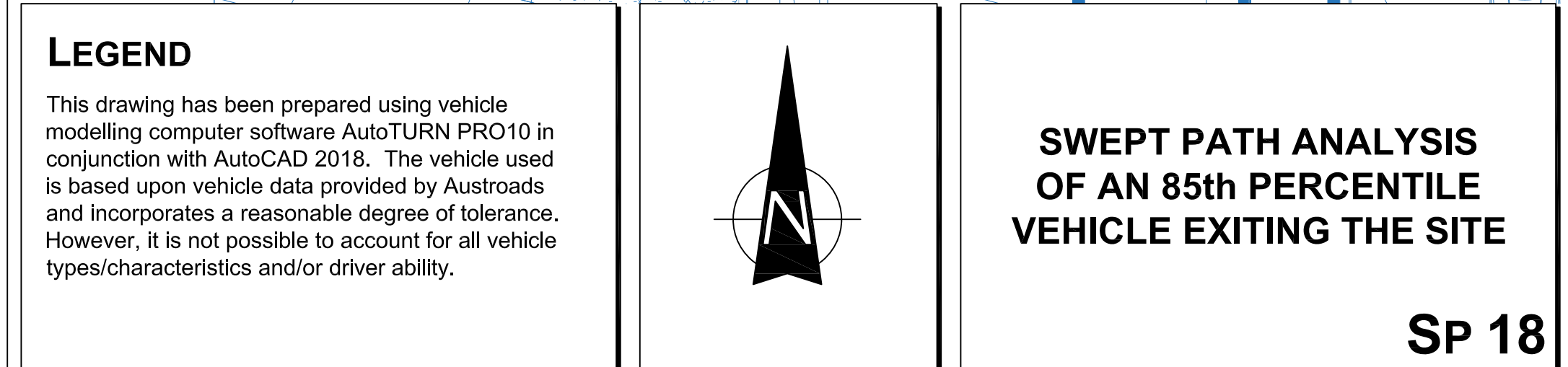

This drawing has been prepared using vehicle modelling computer software AutoTURN PRO10 in conjunction with AutoCAD 2018. The vehicle used is based upon vehicle data provided by Austroads and incorporates a reasonable degree of tolerance. However, it is not possible to account for all vehicle types/characteristics and/or driver ability.



SP 18

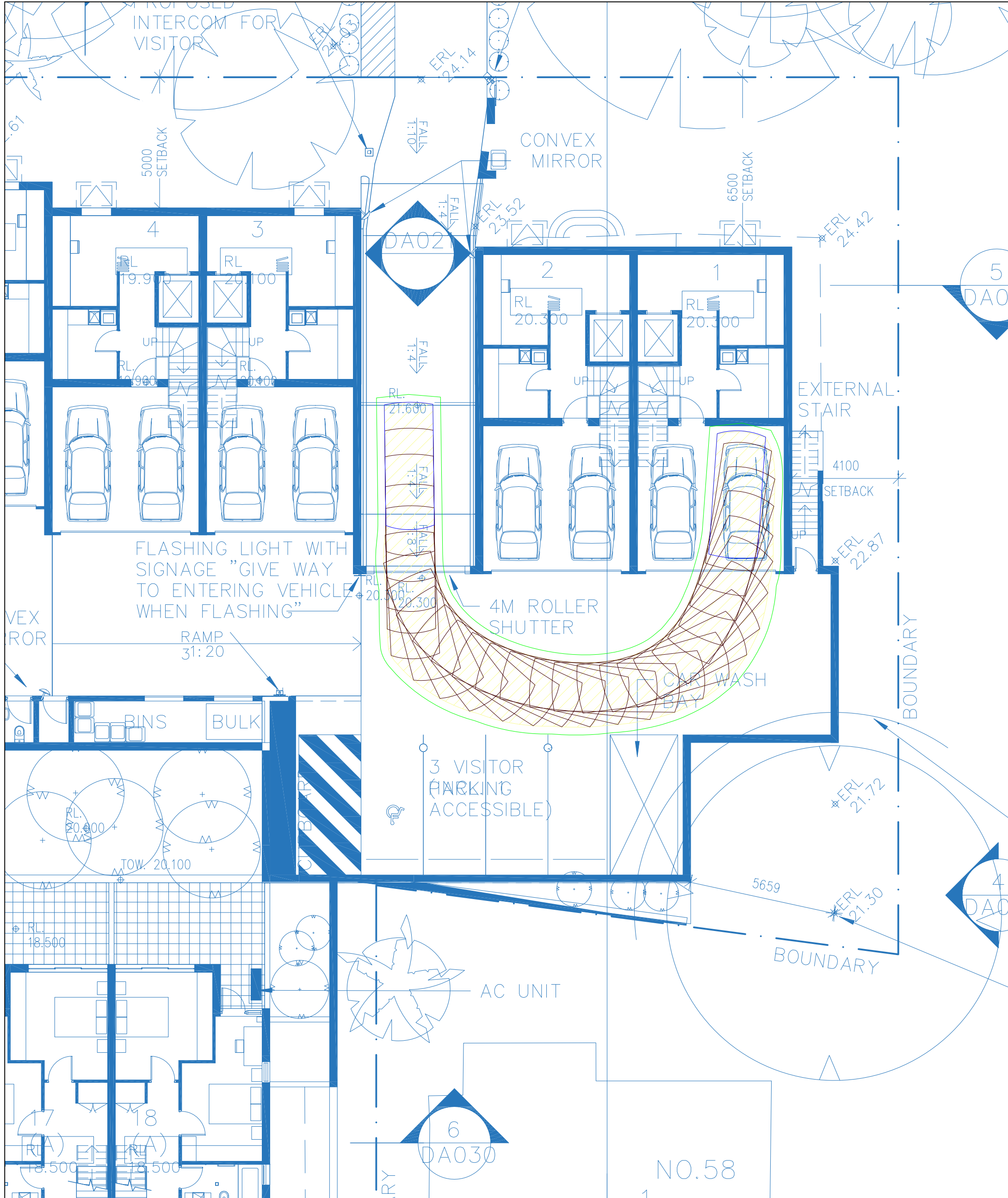

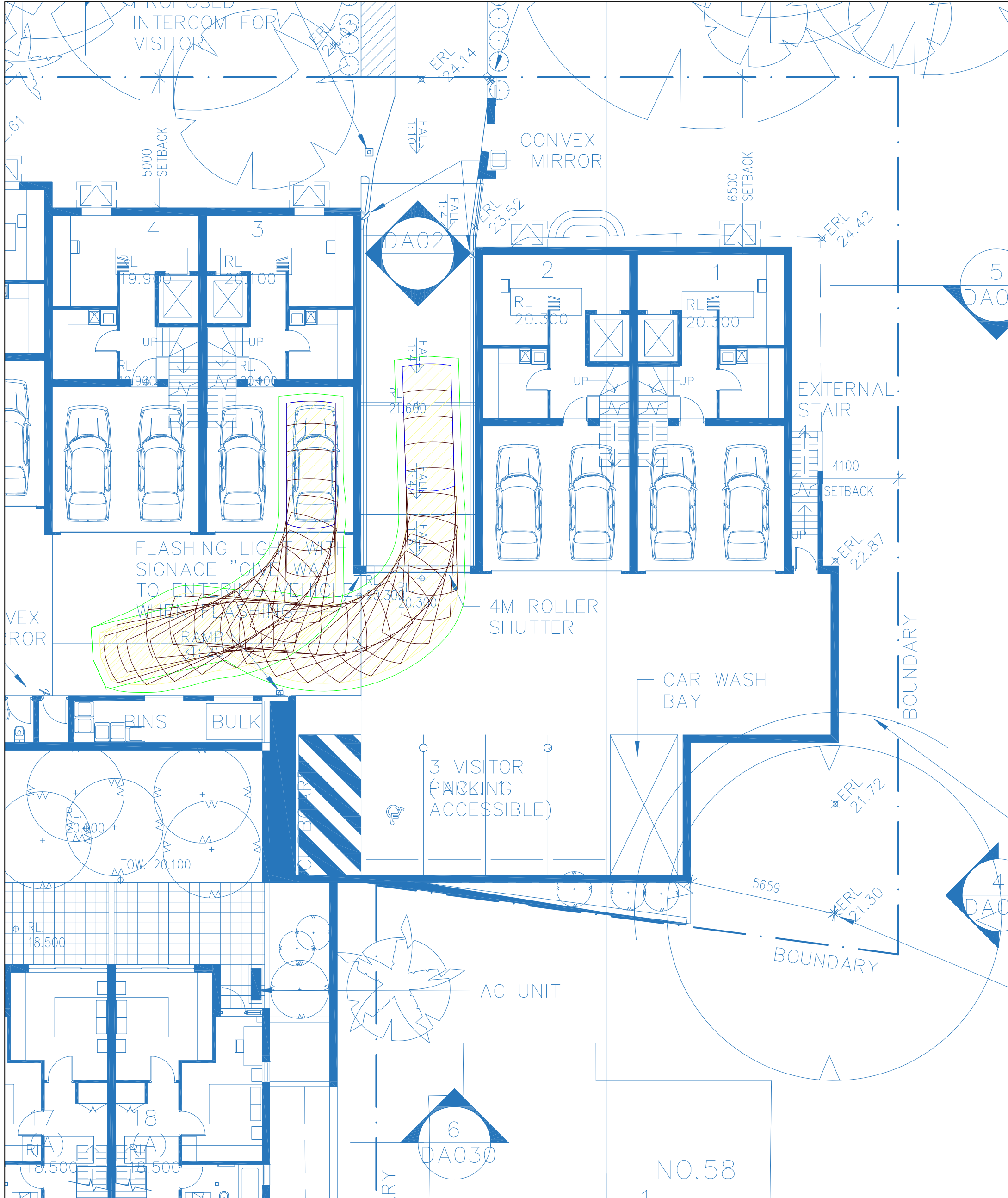

LEGEND

This drawing has been prepared using vehicle modelling computer software AutoTURN PRO10 in conjunction with AutoCAD 2018. The vehicle used is based upon vehicle data provided by Austroads and incorporates a reasonable degree of tolerance. However, it is not possible to account for all vehicle types/characteristics and/or driver ability.

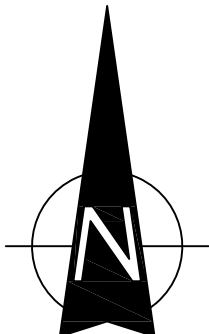

**SWEPT PATH ANALYSIS
OF AN 85th PERCENTILE
VEHICLE ENTERING THE SITE**

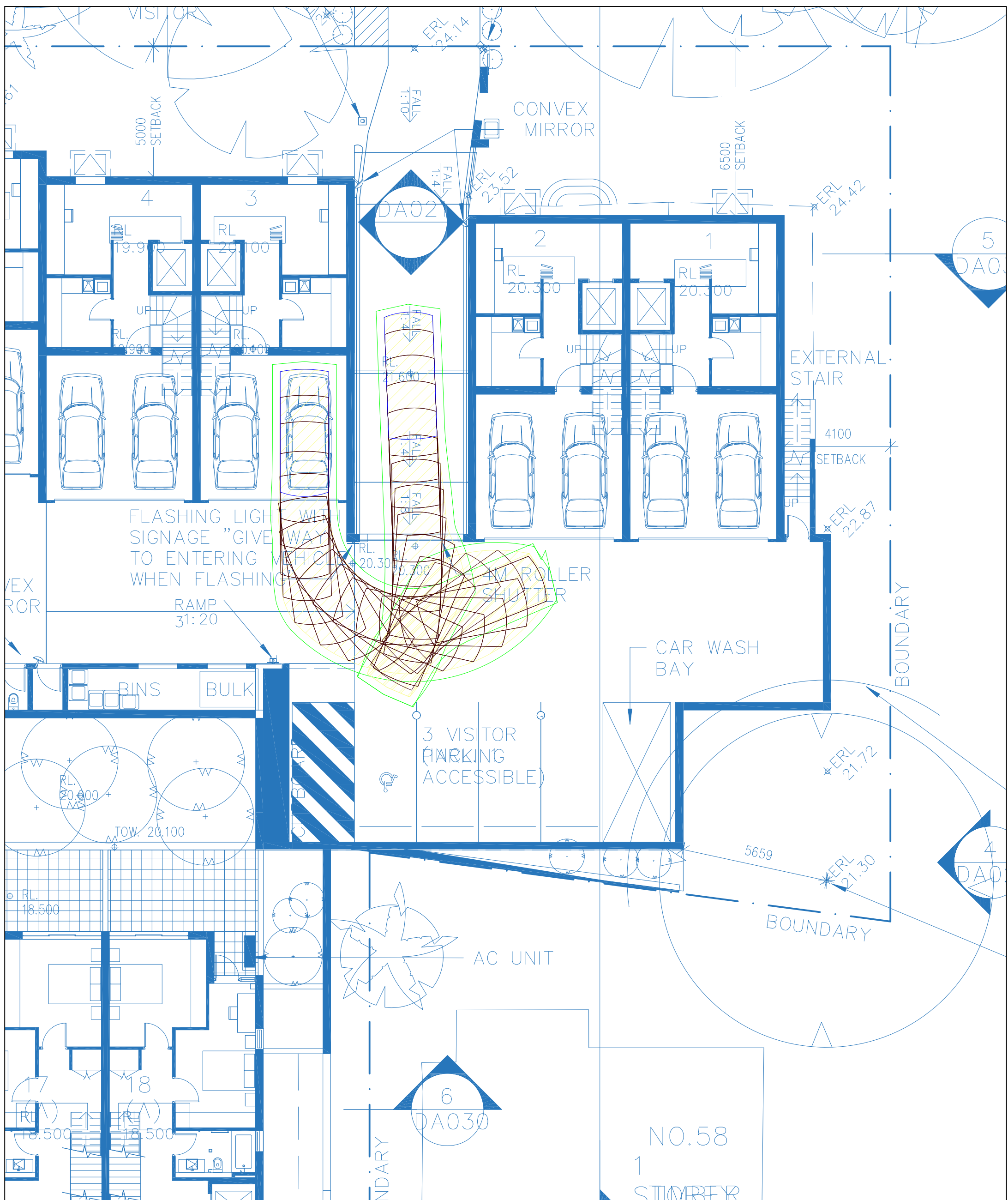

LEGEND

This drawing has been prepared using vehicle modelling computer software AutoTURN PRO10 in conjunction with AutoCAD 2018. The vehicle used is based upon vehicle data provided by Austroads and incorporates a reasonable degree of tolerance. However, it is not possible to account for all vehicle types/characteristics and/or driver ability.

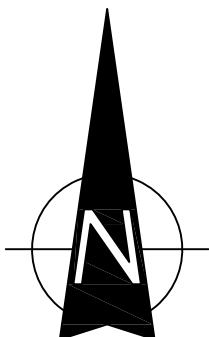

SWEPT PATH ANALYSIS OF AN 85th PERCENTILE VEHICLE EXITING THE SITE

SP 22

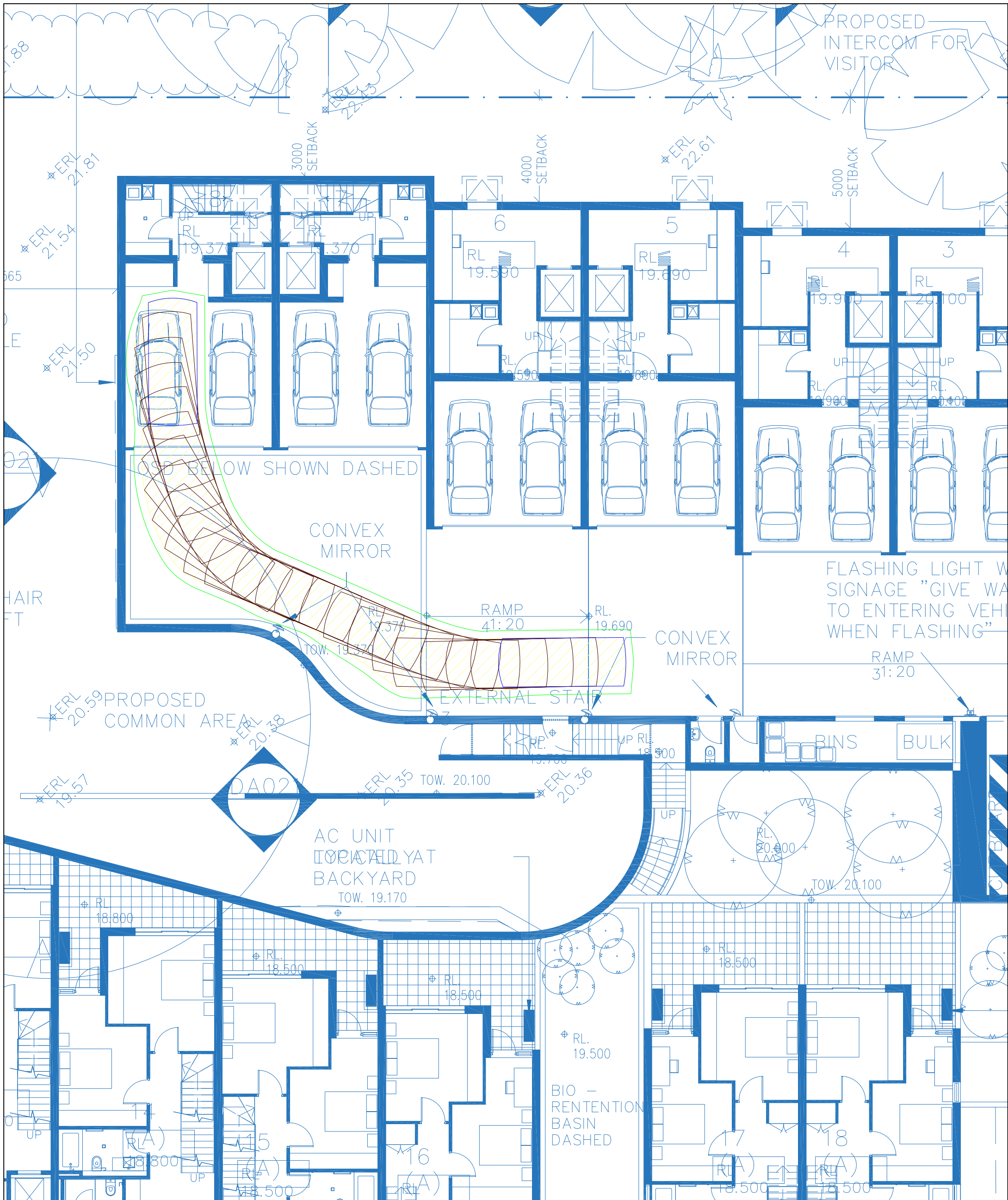

LEGEND

This drawing has been prepared using vehicle modelling computer software AutoTURN PRO10 in conjunction with AutoCAD 2018. The vehicle used is based upon vehicle data provided by Austroads and incorporates a reasonable degree of tolerance. However, it is not possible to account for all vehicle types/characteristics and/or driver ability.

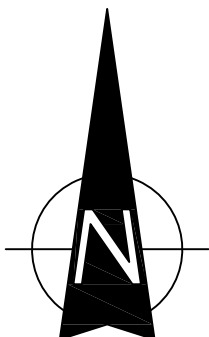

**SWEPT PATH ANALYSIS
OF AN 85th PERCENTILE
VEHICLE ENTERING THE SITE**

SP 23



LEGEND

This drawing has been prepared using vehicle modelling computer software AutoTURN PRO10 in conjunction with AutoCAD 2018. The vehicle used is based upon vehicle data provided by Austroads and incorporates a reasonable degree of tolerance. However, it is not possible to account for all vehicle types/characteristics and/or driver ability.

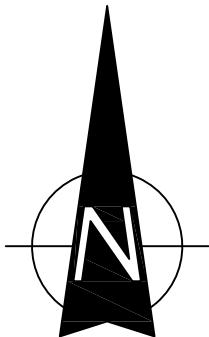

**SWEPT PATH ANALYSIS
OF AN 85th PERCENTILE
VEHICLE EXITING THE SITE**

SP 22