

A horizontal number line is shown with major tick marks labeled 0, 1, 2, 3, 4, 5, and 10. There are also minor tick marks between the major ones, representing intervals of 0.5 units. The segments between 1 and 2, and between 3 and 4, are shaded gray.

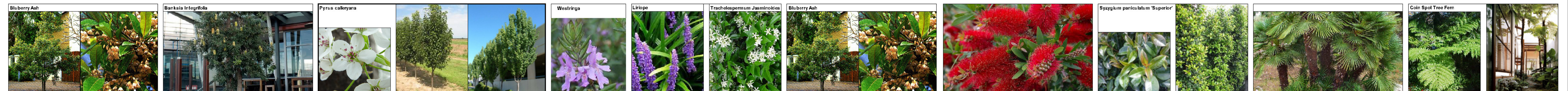

<p><i>Pyrus calleryana</i></p>	
--------------------------------	---



AMENDMENTS		
F	15.3.23	FOR DA COUNCIL RFI



DATE:	15.3.23	SCALE:	1:150 @A1
JOB REF:	22/2293		

BUILDER MUST VERIFY ALL DIMENSIONS OF THE SITE BEFORE WORK COMMENCES.

FIGURED DIMENSIONS SHOULD BE USED IN PREFERENCE TO THOSE SCALED OFF.

COPYRIGHT IS THE PROPERTY OF PAUL SCRIVER LANDSCAPE A.B.N. 16 949 100 279.

THE CONCEPTS, DESIGN, DETAILS AND INFORMATION DESCRIBED IN THE DRAWING ARE COPYRIGHT. OTHER THAN FOR THE PURPOSE PRESCRIBED UNDER THE COPYRIGHT ACT, NO PART OF IT MAY BE REPRODUCED OR BY ANY MANNER BE USED OR REPRODUCED WITHOUT WRITTEN PERMISSION AND DESIGN

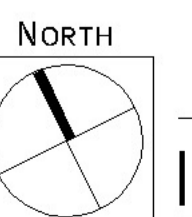

1 OF 6
DA
SSUE- F

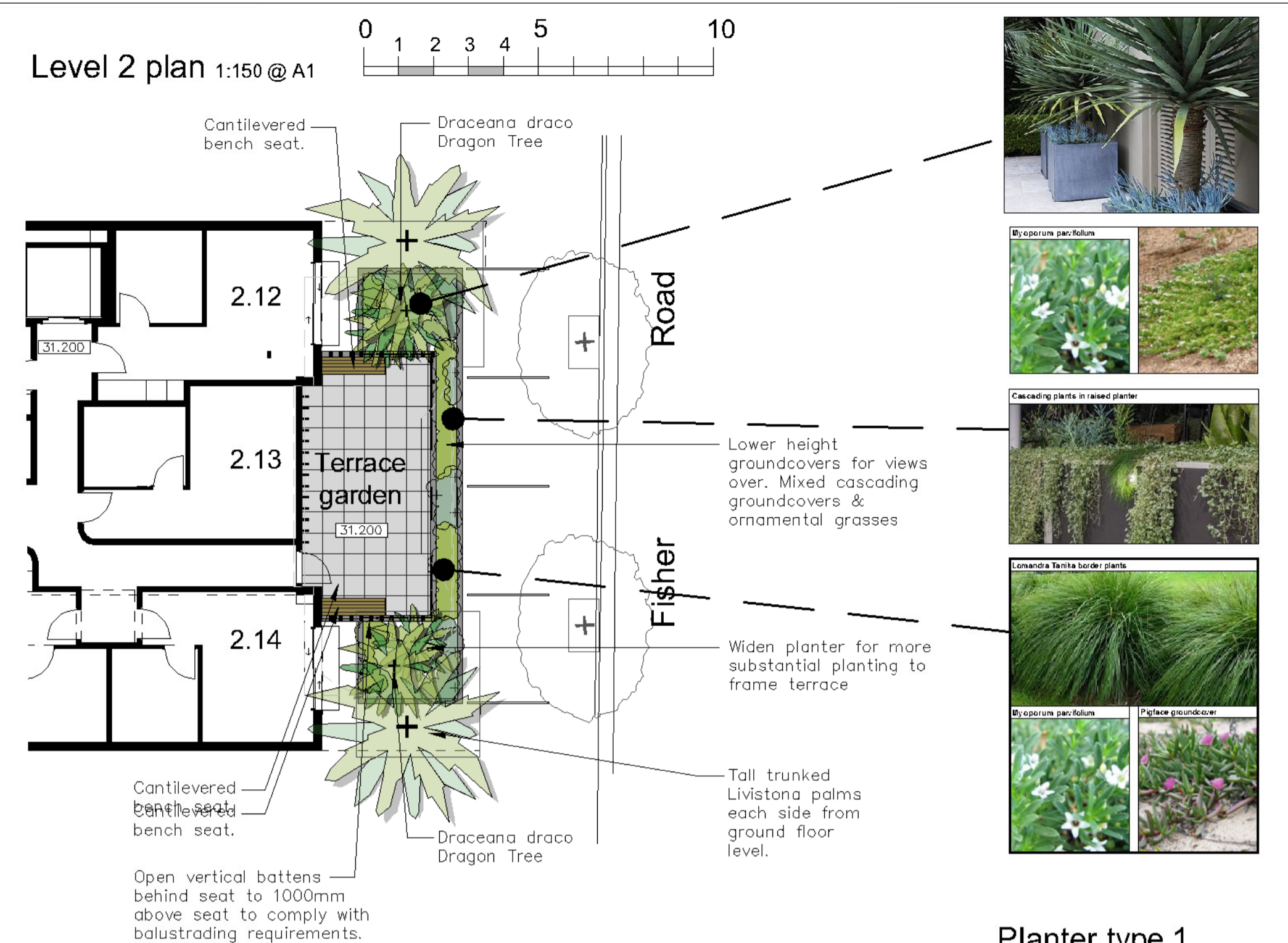

Planter type 1
Quatro GRC 2000x2000x1000(h)

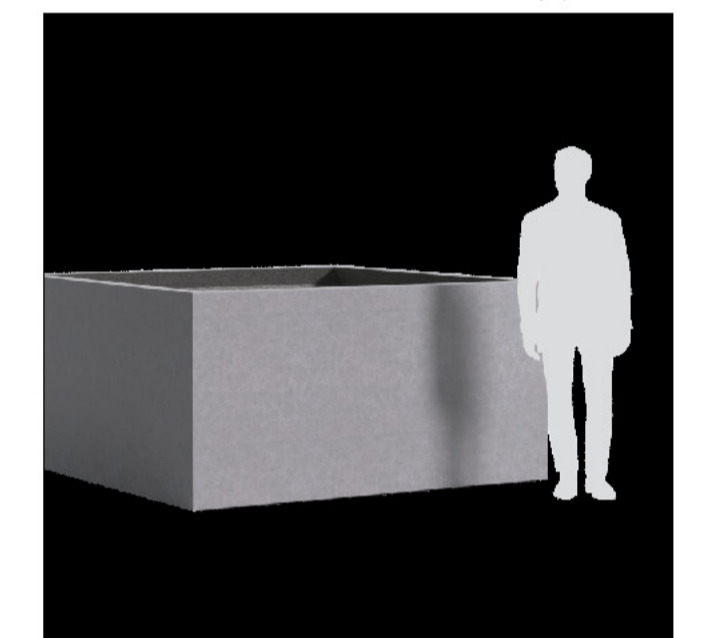

Planter type 2
Quatro GRC 1500x1500x1000(h)

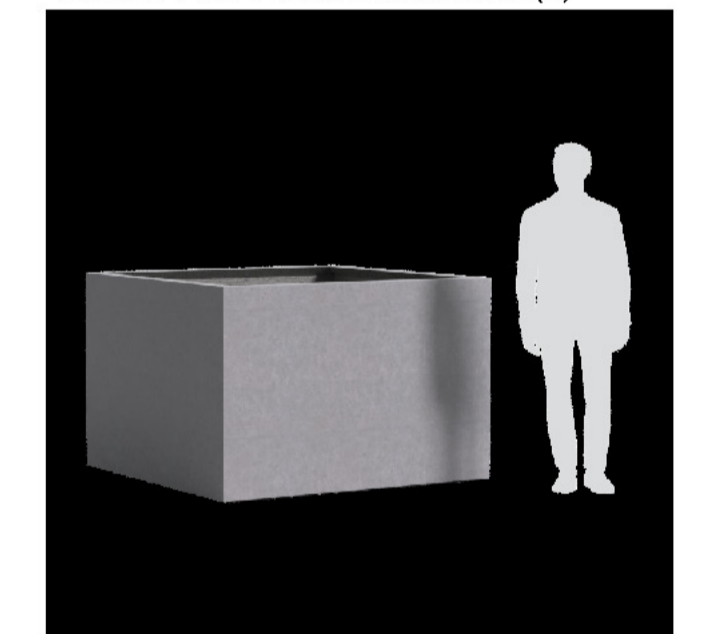

Planter type 3
Quatro GRC 800x1000x600(h)

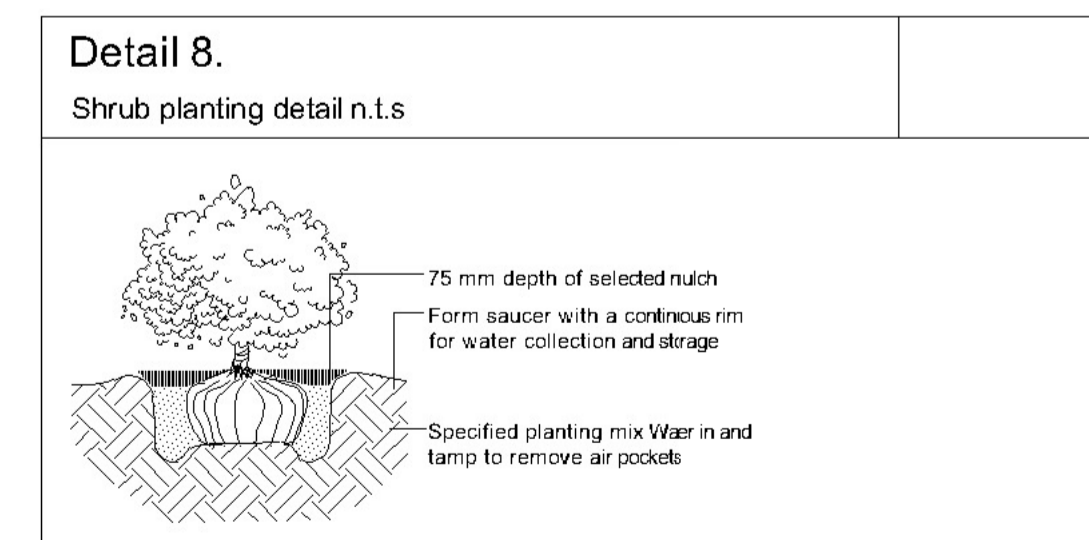
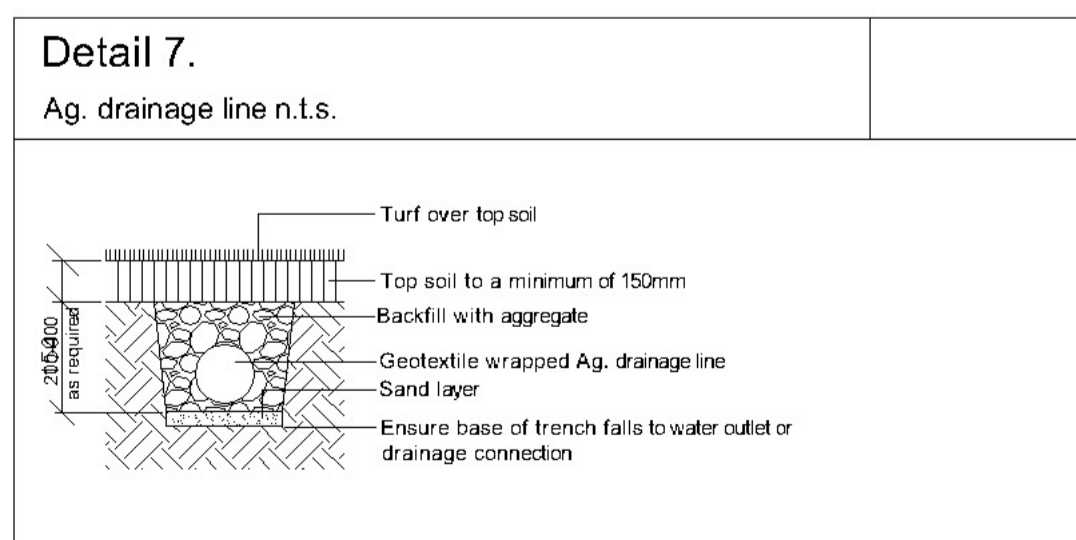
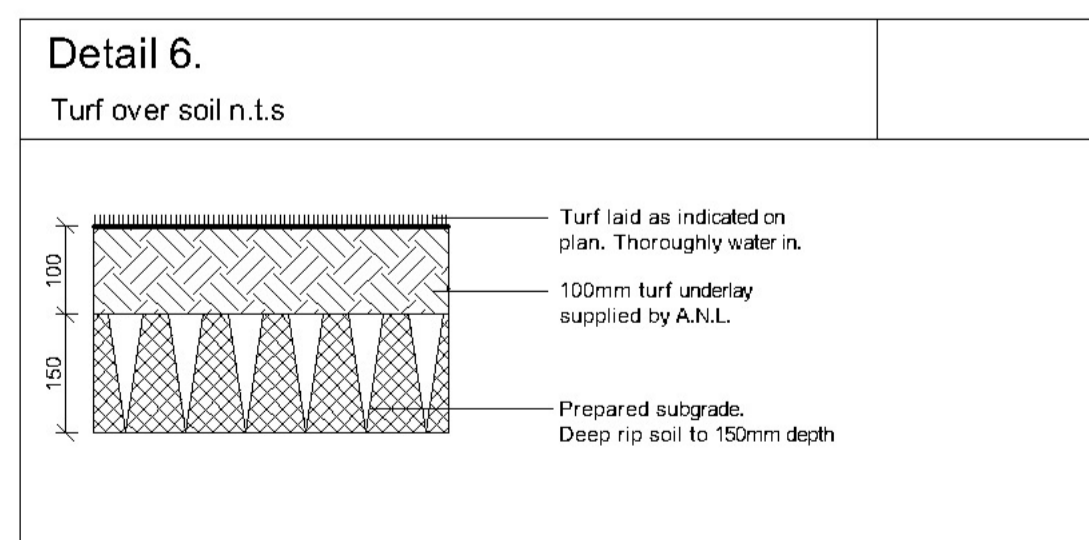
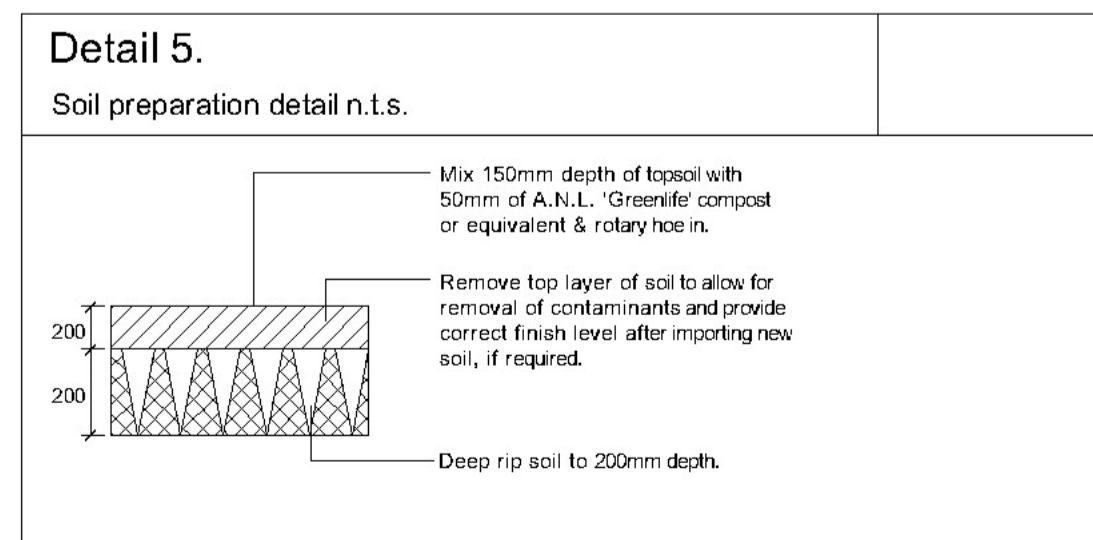
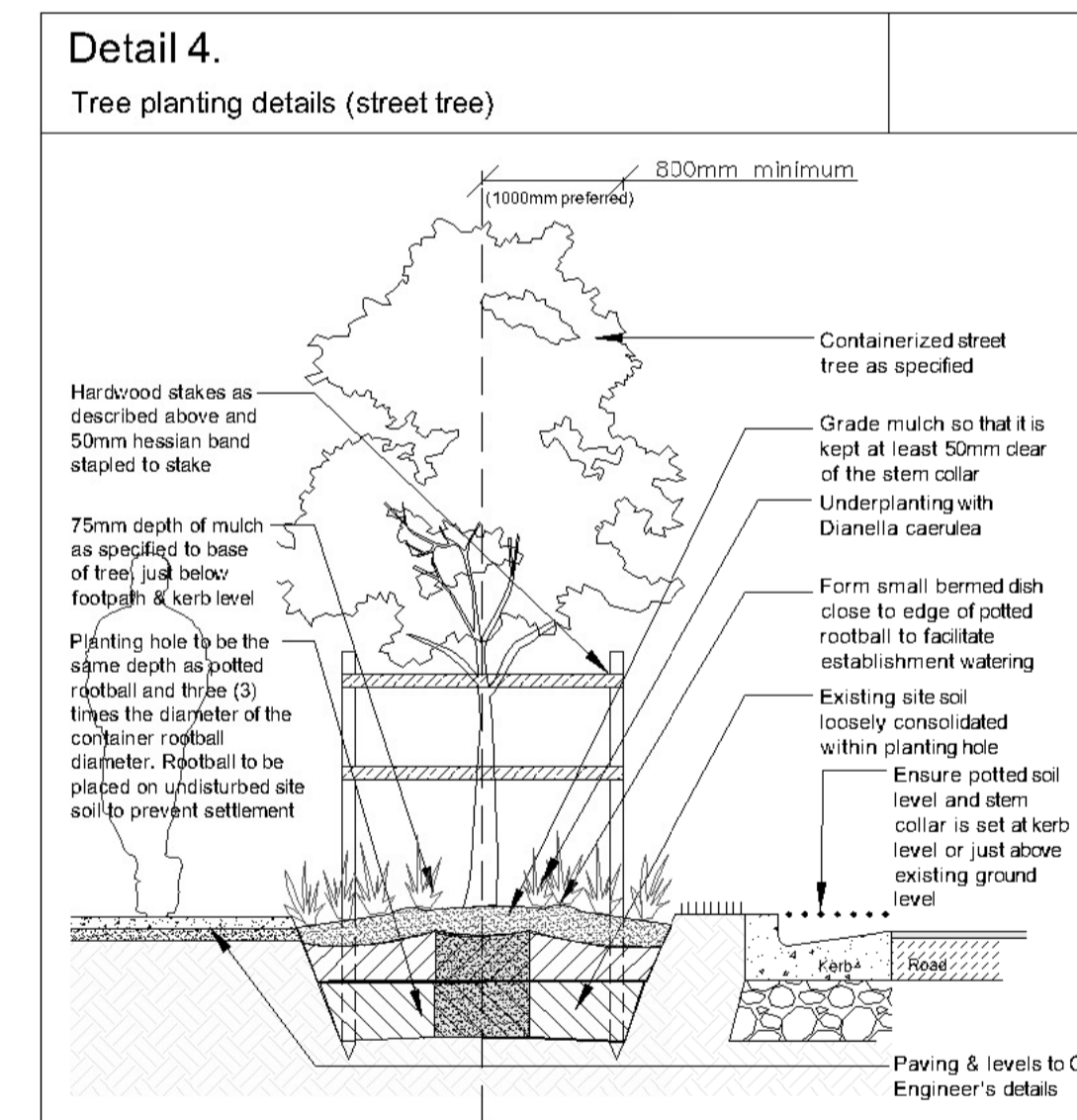
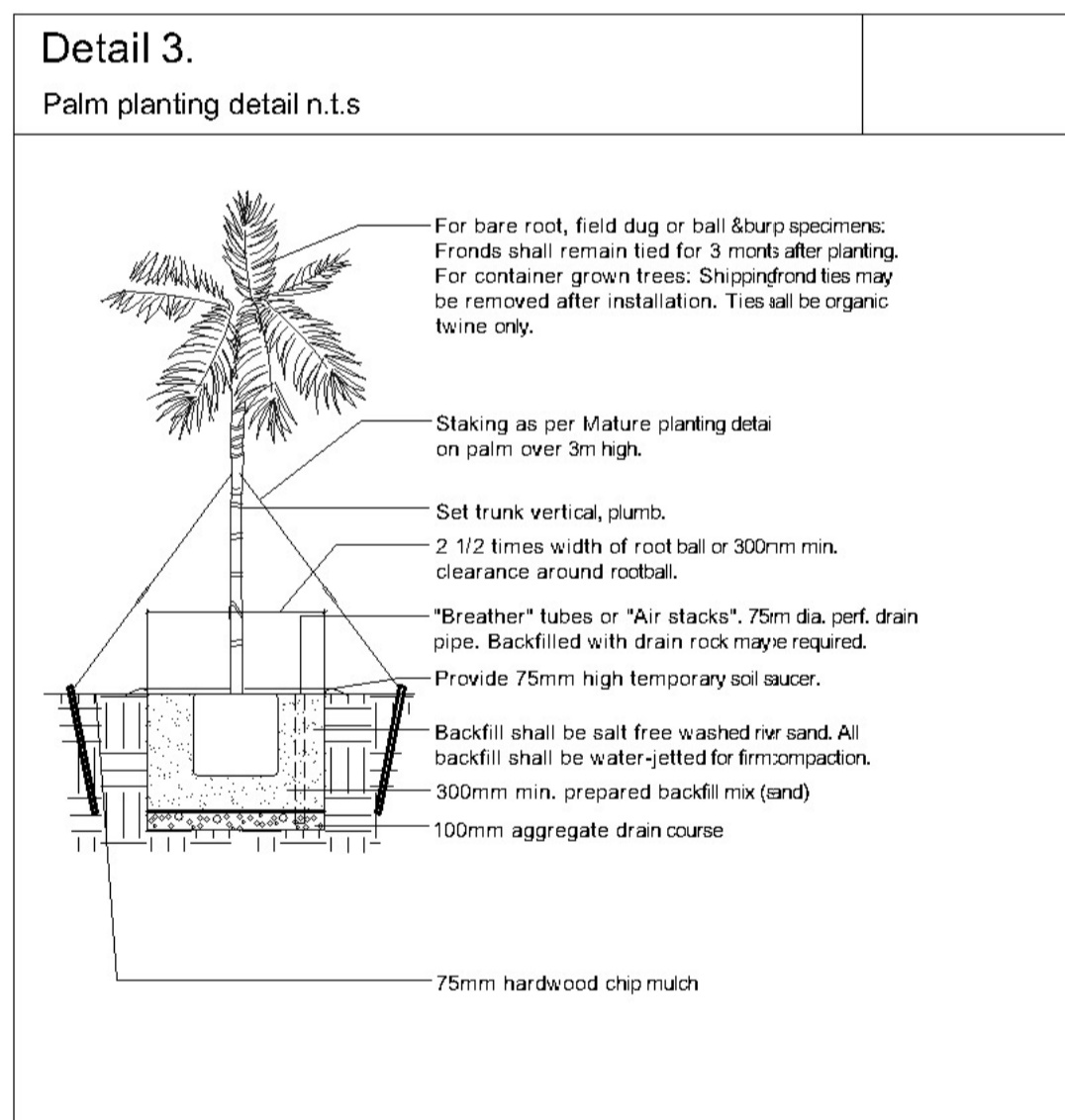
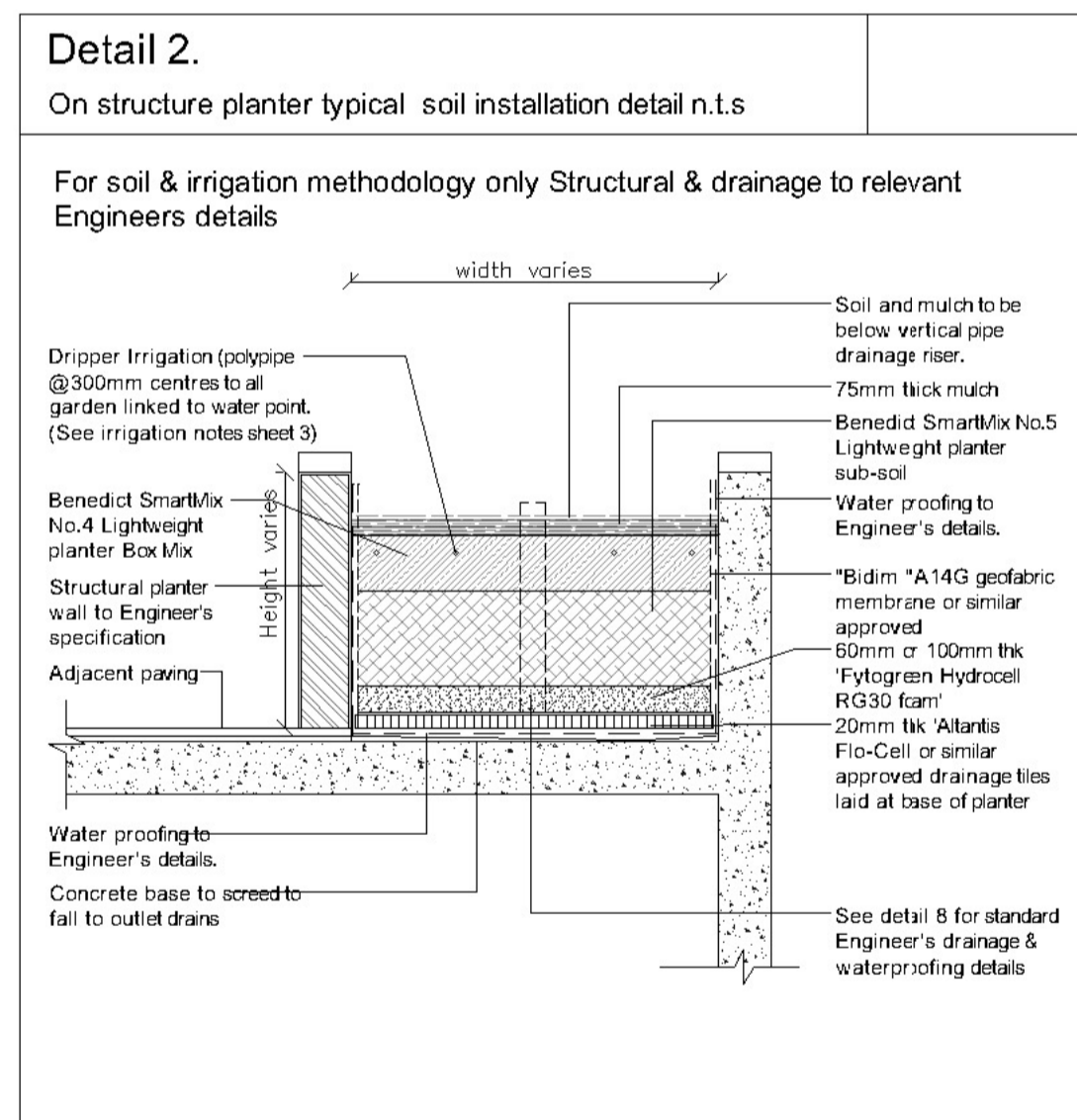
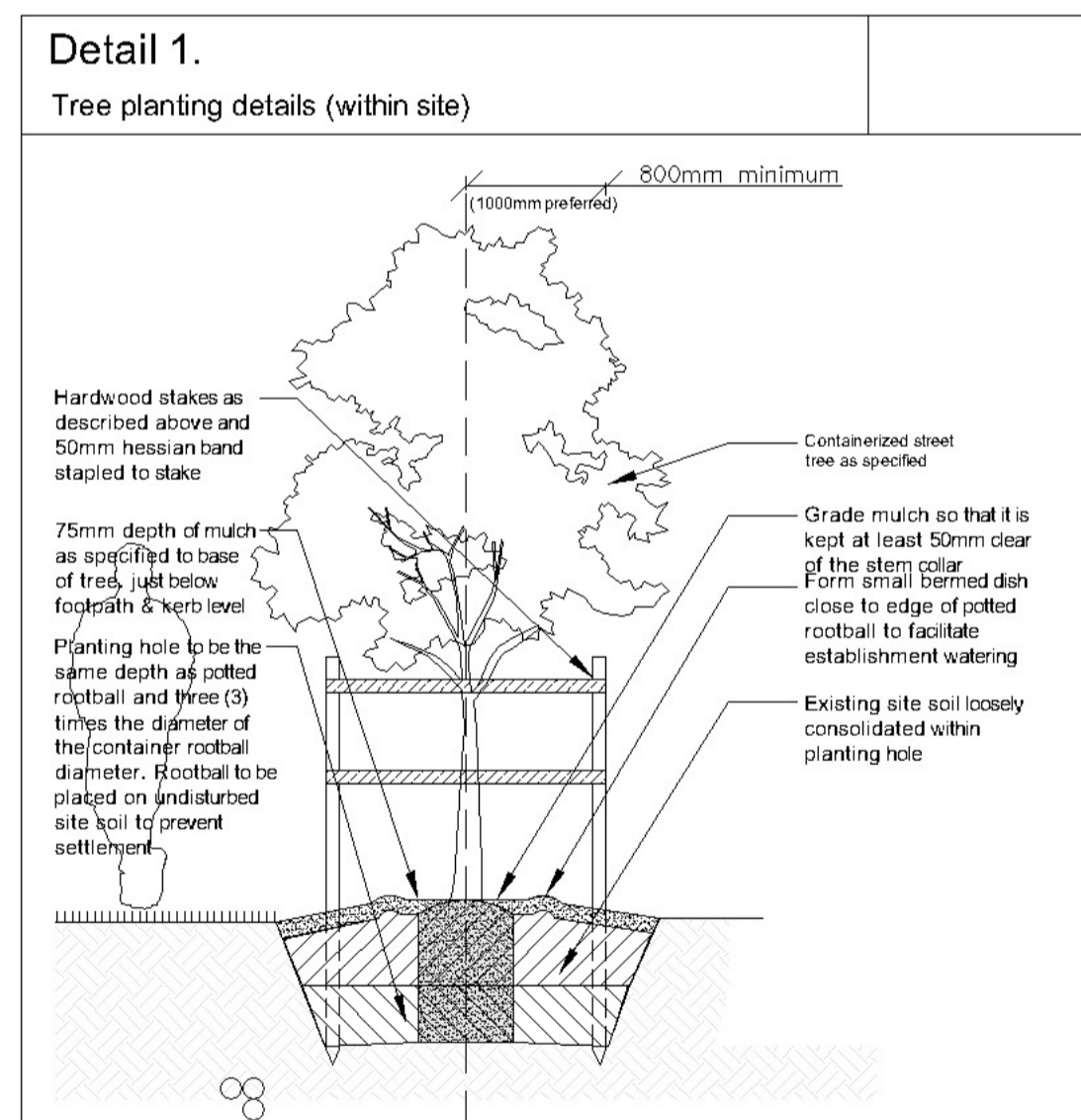
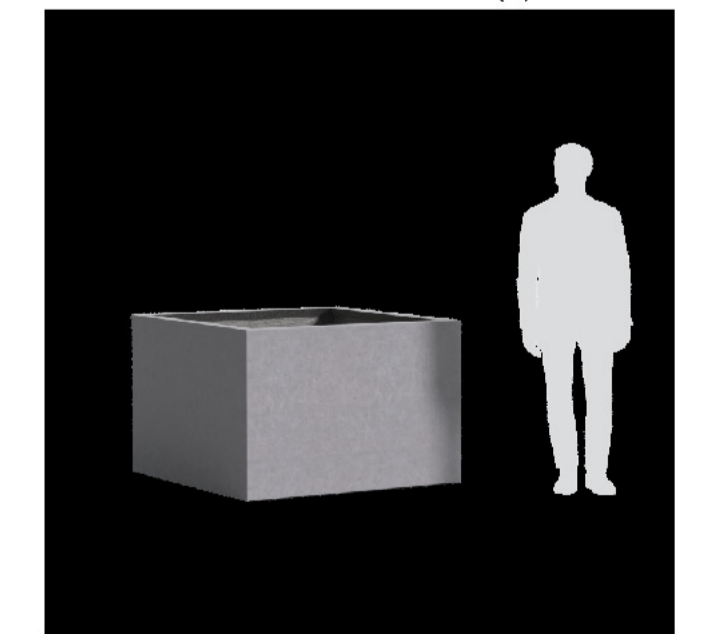

Not for construction

AMENDMENTS		
_____	_____	_____
_____	_____	_____
_____	_____	_____
_____	_____	_____
F	15.3.23	For DA council RFI

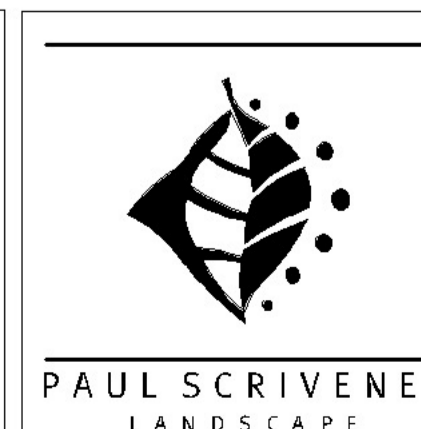

	PO Box 4050. ACT 2602 ABN: 16 949 100 279 PHONE: 02 9907 8011 WWW.SCRIVENER-DESIGN.COM EMAIL: PAUL@SCRIVENER-DESIGN.COM
PROJECT:	MIXED-USE COMMUNITY CENTRE 28 FISHER ROAD & 9 FRANCIS STREET, DEE WHY, NSW
DWG:	ROOF LEVEL & LEVEL 2 LANDSCAPE PLAN / WEST ELEVATION

DATE:	15.3.23	SCALE:	1:150 @A1
JOB REF:	22/2293		

BUILDER MUST VERIFY ALL DIMENSIONS OF THE SITE BEFORE WORK COMMENCES.
FIGURED DIMENSIONS SHOULD BE USED IN PREFERENCE TO THOSE SCALED OFF.

COPYRIGHT IS THE PROPERTY OF PAUL SCRIVENER LANDSCAPE, A.B.N. 16 949 100 279.
THE CONCEPTS, DESIGN, DETAILS AND INFORMATION DESCRIBED IN THE DRAWINGS ARE COPYRIGHT. OTHER THAN FOR THE PURPOSE PRESCRIBED UNDER THE COPYRIGHT ACT, NO PART OF IT MAY IN ANY FORM OR BY ANY MEANS BE USED OR REPRODUCED WITHOUT PRIOR WRITTEN PERMISSION.

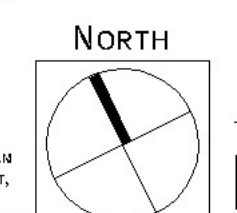

2 OF 6

DA
ISSUE- F

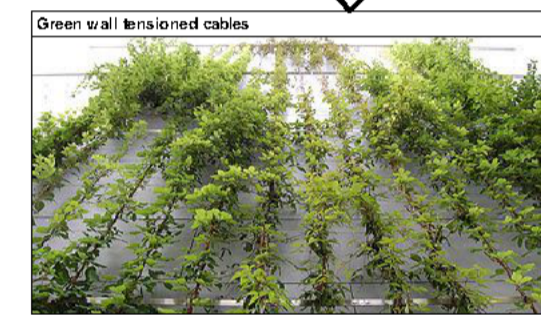
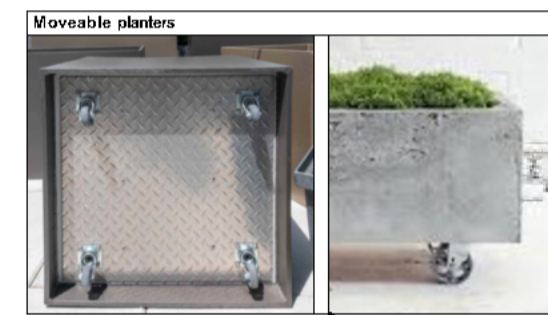
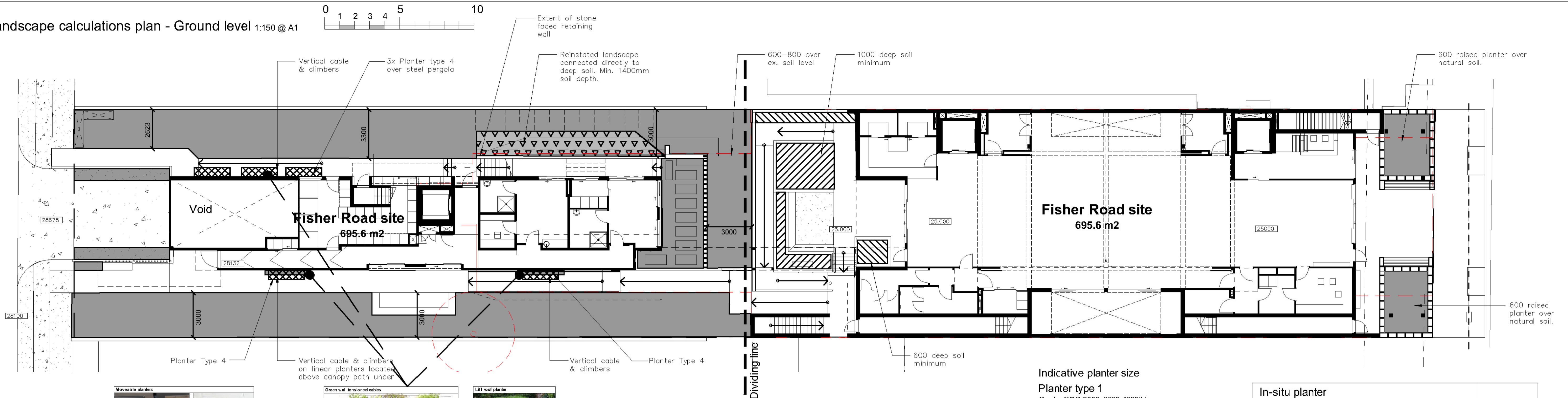
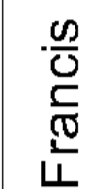

Fisher Road site

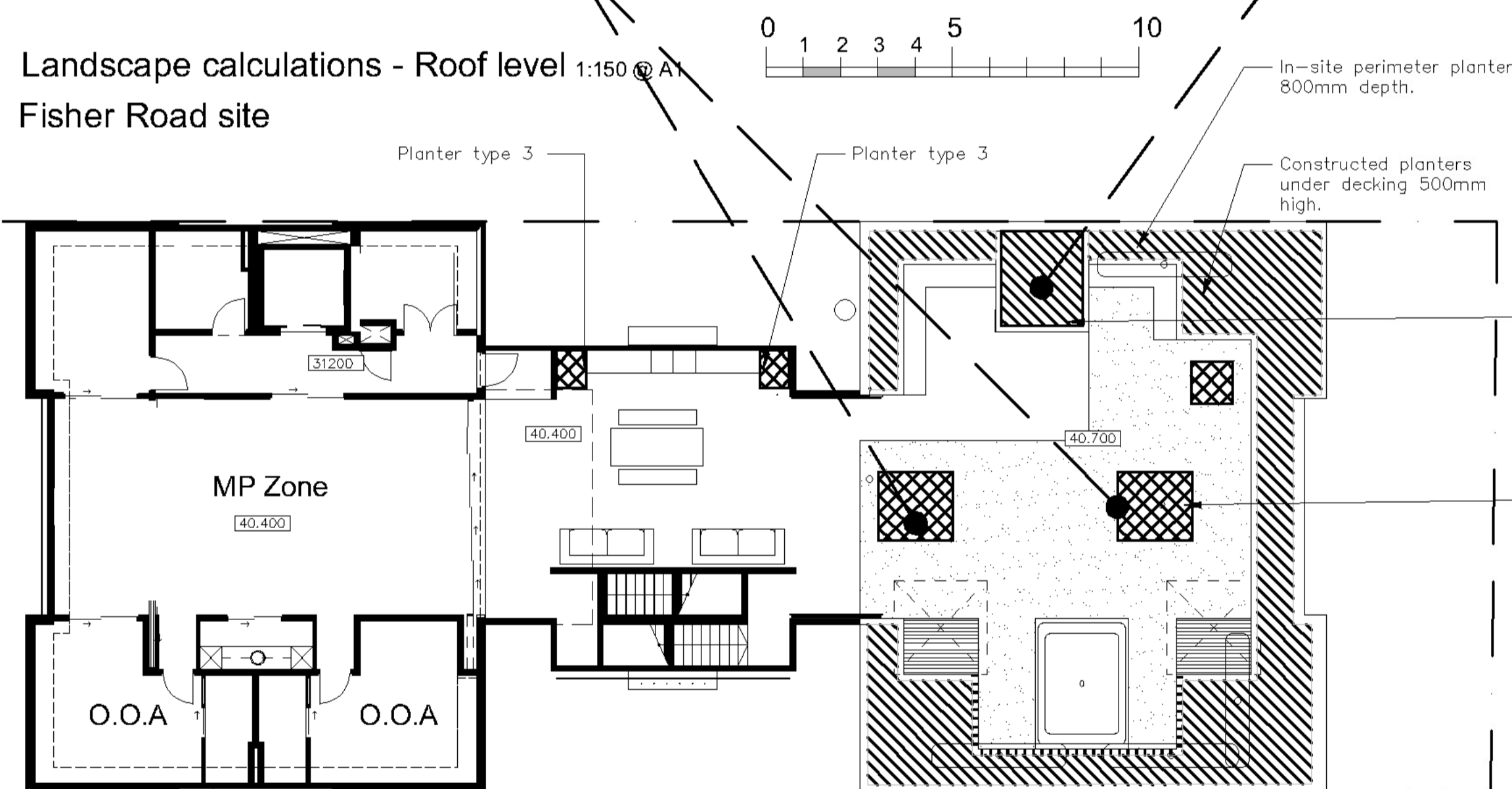

Site area	695.6 m ²	100%
Natural soil	298.9 m ²	
Raised / suspended planters (included wall mounted planters on levels 2 & 3)	33.8 m ²	

Total planted area	332.7 m ²	47.83%
--------------------	----------------------	--------

Site area	695.6 m ²	100%
Natural soil	32.8 m ²	
Raised / suspended planters (included 1.8 m ² on level 1 & 1.8 m ² on level 3)	110.5 m ²	

Total planted area	143.3 m ²	20.6%
--------------------	----------------------	-------

Fisher Road site

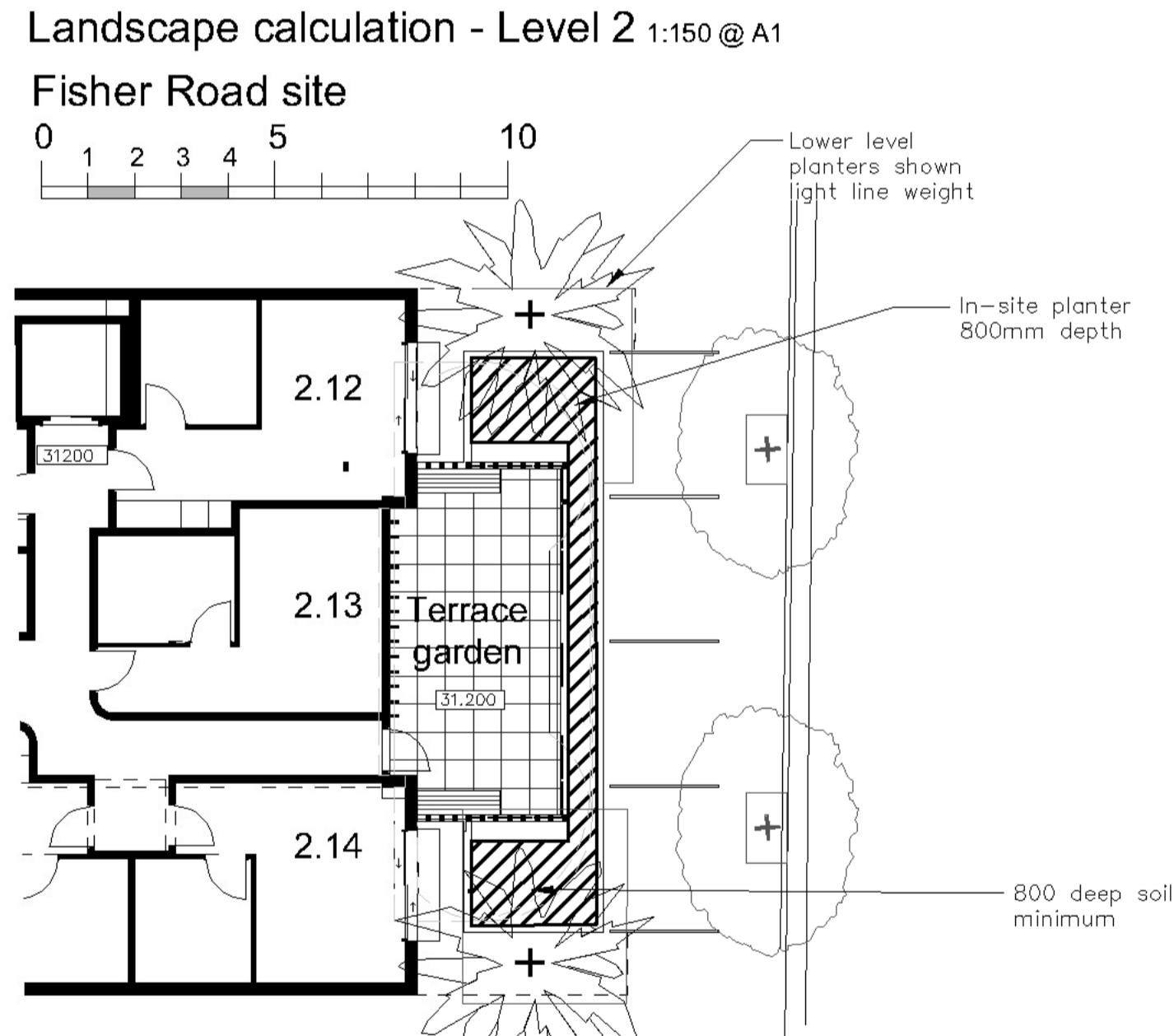

Planter type 1
Qualro GRC 2000x2000x1000(h)

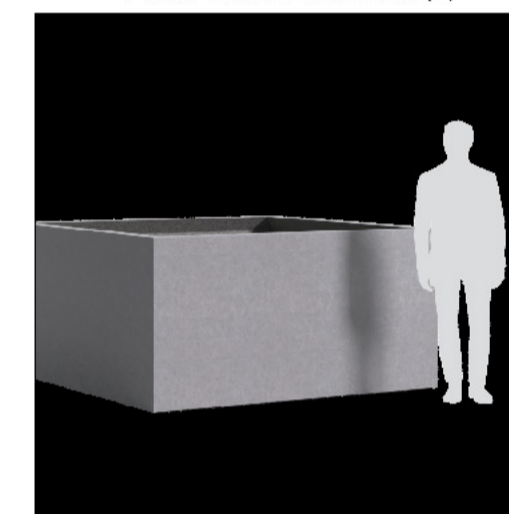

Quatro GRC 1500x1500x1000(h)

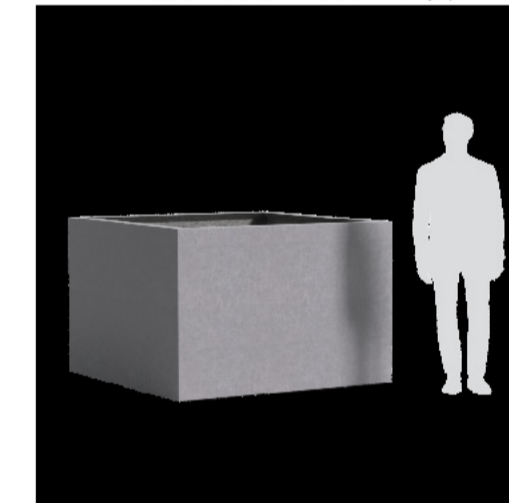

Quatro GRC 800x1000x600(h)

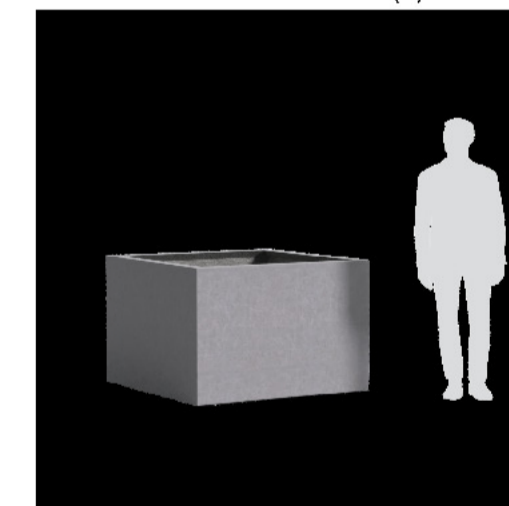

Quatro GRC 2400x600x600(h)

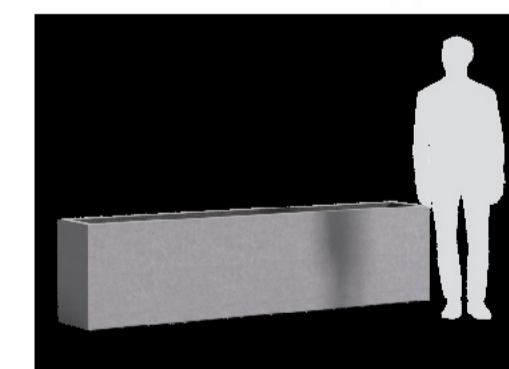

On structure planter typical soil installation detail n.t.s



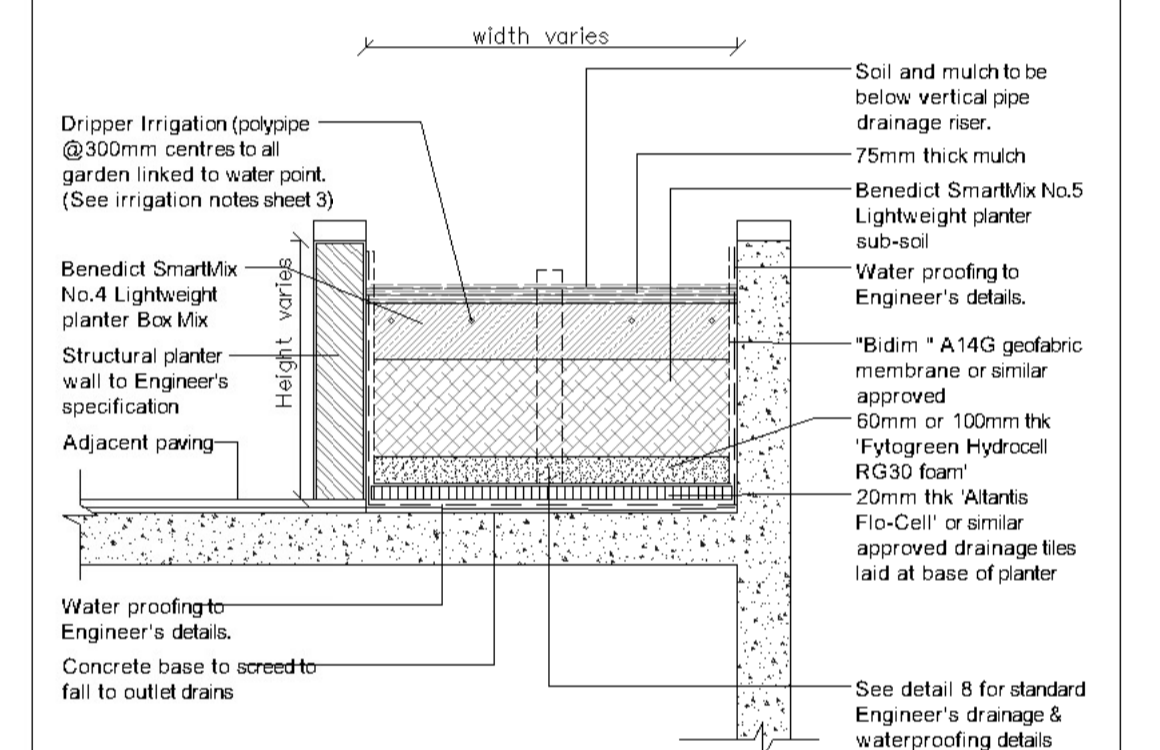

For soil & irrigation methodology only Structural & drainage to relevant Engineers details

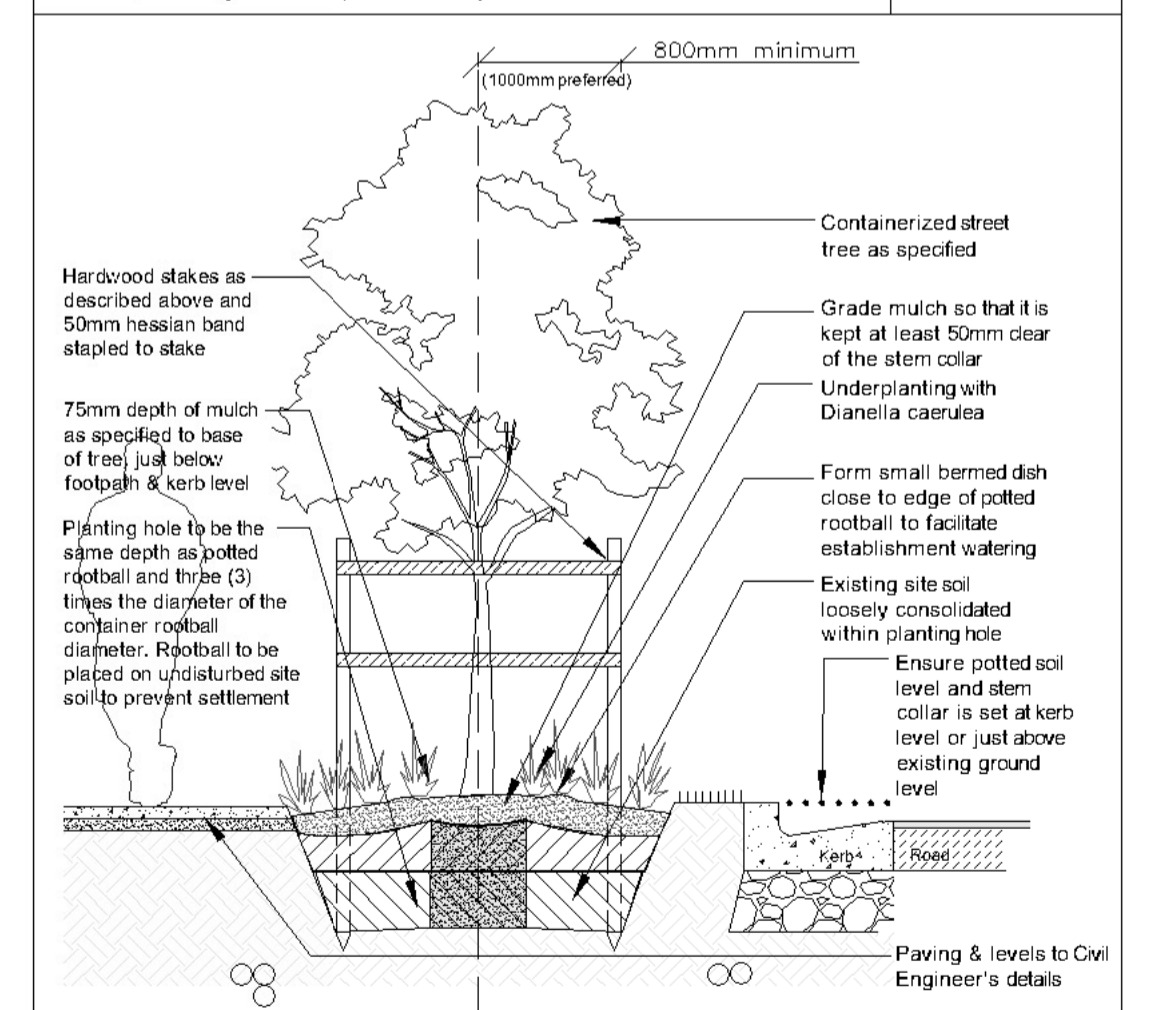

Tree planting details (street tree)



Not for construction

695.6 m²	Site area		Raised planters 1000 deep (Detail 2, sheet 2)	32.8 m²		Free standing planters or deck over planter (Set planters at right)	10.2 m²	
	Soil / garden areas (Detail 5, sheet 2)	328.2 m²		Raised planters up to 800mm deep In-situ planter (Detail 2, sheet 2)	64.2 m²		Reinstated landscape connected to deep soil	19.1 m²

AMENDMENTS

F	15.3.23	FOR DA COUNCIL RFI



	PO Box 4050. ACT 2602 ABN: 16 949 100 279 PHONE: 02 9907 8011 WWW.SCRIVENER-DESIGN.COM EMAIL: PAUL@SCRIVENER-DESIGN.COM
PROJECT:	MIXED-USE COMMUNITY CENTRE 28 FISHER ROAD & 9 FRANCIS STREET, DEE WHY, NSW
DWG:	Landscape CALCULATIONS PLAN

DATE: 15.3.23 SCALE: 1:150 @A1

JOB REF: 22/2293

BUILDER MUST VERIFY ALL DIMENSIONS OF THE SITE BEFORE WORK COMMENCES.
FIGURED DIMENSIONS SHOULD BE USED IN PREFERENCE TO THOSE SCALED OFF.

COPYRIGHT IS THE PROPERTY OF PAUL SCRIVENER LANDSCAPE, A.B.N. 16 949 100 279.

THE CONCEPTS, DESIGN, DETAILS AND INFORMATION DESCRIBED IN THE DRAWING ARE COPYRIGHT. OTHER THAN FOR THE PURPOSE PRESCRIBED UNDER THE COPYRIGHT ACT, NO PART OF IT MAY IN ANY FORM OR BY ANY MEANS BE USED OR REPRODUCED WITHOUT PRIOR WRITTEN PERMISSION.

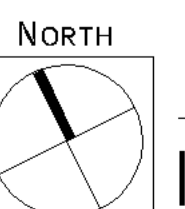

3 OF 6

DA
SSUE- F

Journal of Management Education 33(10)

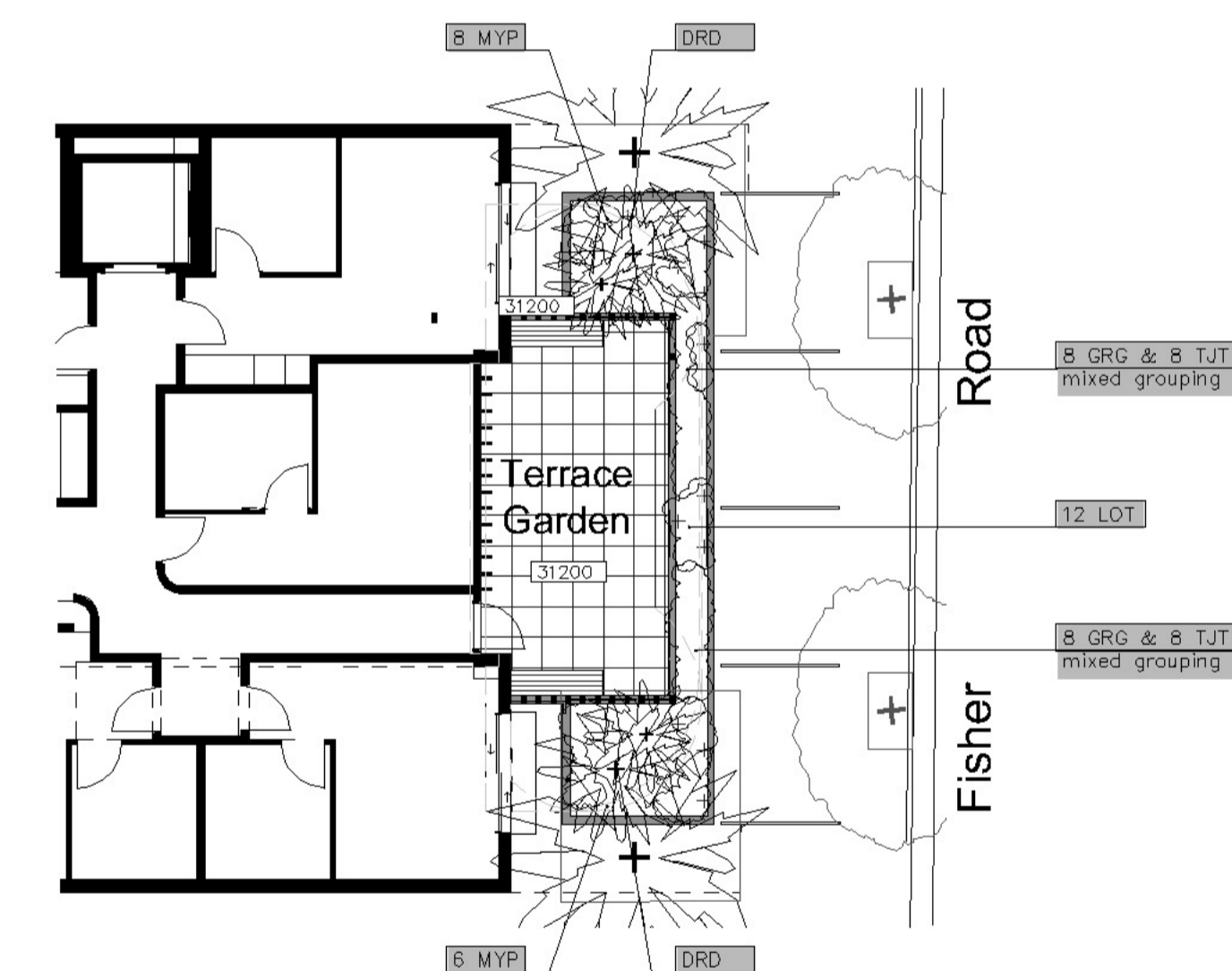
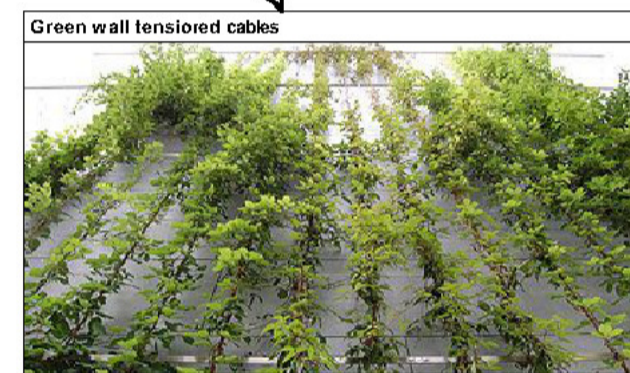
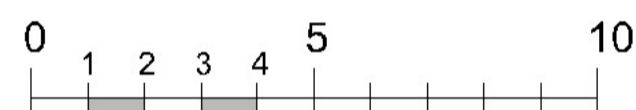

ER Planting Symbol

F	15.3.23	For DA COUNCIL RFI



BUILDER MUST VERIFY ALL DIMENSIONS OF THE SITE BEFORE WORK COMMENCES.
FIGURED DIMENSIONS SHOULD BE USED IN PREFERENCE TO THOSE SCALED OFF.

COPYRIGHT IS THE PROPERTY OF PAUL SCRIVENER LANDSCAPE, A.E.H. 16 949 100 279.

THE CONCEPTS, DESIGN, DETAILS AND INFORMATION DESCRIBED IN THE DRAWINGS ARE COPYRIGHT. OTHER THAN FOR THE PURPOSE PRESCRIBED UNDER THE COPYRIGHT ACT, NO PART OF IT MAY IN ANY FORM OR BY ANY MEANS BE USED OR REPRODUCED WITHOUT PRIOR WRITTEN PERMISSION.

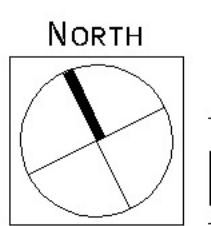

4 OF 6

DA

ISSUE- F

Planting schedule

Symbol	Botanical name	Common name	Cont. size	Staking	Mature height	No req.
Trees						
BIN	Bankisa integrifolia	Coast Banksia (medium indigenous tree)	75Lt	3x50x50x1800	12-15.0M	3
ER	Elaeocarpus reticulatus	Blueberry Ash (indigenous small tree)	75Lt	3x50x50x1800	6-8.0M	2
PIS	Pistachia chinensis	Chinese Pistachio (Hardy deciduous tree. Vertical habit)	100Lt	3x50x50x1800	7-10.0M	3
PYC	Pyrus calleryana ‘Capital’	Ornamental Pear (medium deciduous narrow vertical habit tree)	100Lt	2x50x50x1800	10-12.0M	1
SYF	Waterhousia floribunda ‘Sweeper’	Sweeper Waterhousia (Ozbreed ® ‘DOW20)	75Lt	3x38x38x1800	8-10.0M	3
TLL	Tristaniopsis laurina ‘Luscious’	Water Gum cultivar (indigenous small-med tree)	150Lt	3x50x50x1800	5-7.0M	2
Shrubs / small feature trees						
BMJ	Buxus microphylla ‘Japonica’	Japanese Box Hedge (formal low hedging lant)	200mm	nil	0.4-1.2M	62
CEV	Callistemon ‘Endeavour’	Callistemon	300mm	nil	2.5-3.0M	2
GRG	Grevillea ‘Robyn Gordon’	Robyn Gordon (native flowering screen plan. Can be hedged)	250mm	nil	3-5.0M	8
PLU	Plumeria acutifolia	Frangipani (small flowering deciduous tree)	45Lt	in large roof planter	3-4.0M	2
PTT	Pittosporum tobira ‘Miss Muffet’	Miss Muffet Pittosporum (bright green foliage hedge)	200mm	hedged	0.8-1.0M	9
SNN	Syzygium ‘Straight & Narrow’	Straight & Narrow Lilly Pilly (very narrow and vertical screen)	300mm	hedged to req.height	3-5.0M	10
SPI	Syzygium australe ‘Pinnacle’	Pinnacle Lily Pily (narrow vertical growing screening plant)	300mm	nil	3-5.0M	6
STR	Strelitzia reginea	Bird of Paradise (Strappy leaved flowering accent plant)	250mm	nil	1-1.2M	5
WFN	Westringia fruticosa ‘Naringa’	Ozbreed Grey Box® (hardy low screen can be hedged)	200mm	hedged	0.4-0.7M	14
WFB	Westringia fruticosa ‘Blue Gem’	Dwarf Blue Westringia (hardy low gorwing plant)	150mm	hedged	1.2-1.5M	10
Ferns / Palms / Succulents						
AGV	Agave attenuata	Century plant (striking spiky leaved succulent)	200mm	nil	0.5M	12
ALR	Alacantarea ‘Rubra’	Giant Bromeliade (Large succulent leaved ornamental plant)	300mm	nil	1.0M	2
BGU	Bambusa guangxiensis	Dwarf Chinese Bamboo (ornamental bamboo can be hedged)	200mm	nil	2-3.5M	1
BSW	Textilus gracilis	Slender Weavers (non-invasive ornamental Bamboo)	300mm	nil	6-8.0M	3
CHM	Chamaerops humilis	Europena Fan Palm (Hardy Small – med palm)	300mm	nil	3-5.0M	2
COB	Colocasia esculenta ‘	Elephants ears (Large leaved plant)	200mm	nil	1-1.5M	3
CYR	Cycas revolutum	Sago Palm (striking native low palm like)	300mm	nil	2-2.5M	11
DRD	Draceana draco	Dragon Tree (striking feature plant)	200Lt	nil	2.5-3.5M	4
HOF	Howea forsterana	Kentia Palm (tall palm)	semi-adv	wire guys	5-7.0M	2
RHA	Raphis excelsor	Lady Finger Palm	300mm	nil	2-2.5M	2
LAV	Livistona australis	Cabbage Palm (tall indigenous palm)	semi adv	wire guys	8-12.0M	2
Groundcovers/Climbers						
CIS	Cissus Antarctica	Kangaroo Vine (climbers on wall mounted vertical cables)	300mm	nil	0.2M	16
DIC	Dianella caerulea	Blue Flax Lily (native grass like plant)	140mm	nil	0.4M	40
DSF	Dichondra ‘Silver Falls	Silver Falls (cascading groundcover in roof garden)	200mm	nil	0.15M	6
CRG	Carpobrotus glaucescens	Pigface (very hardy salt wind tolerant trailing groundcover)	200mm	nil	0.2M	28
HIS	Hibbertia scandens	Guinea Flower (flowering climber / groundcover)	200mm	nil	0.3M	18
MYP	Myoprum parvifolium	Creeping Boobliala (native cascading groundcover)	140mm	nil	0.2M	24
PJ	Pandorea jasminoides	Bower Plant (native climbing/cascading groundcover)	200mm	wire supports on fence	2.5M	4
SED	Sedum spp.	Sedum groundcovers planted in crib wall	140mm	nil	0.2M	300
TJA	Trachelospermum asiaticum	Flatnat Star Jasmine (FT01 Ozbreed hyvid groundcover)	200mm	nil	0.2M	14
TJT	Trachelospermum tricolor	Variegated Star Jasmine (variegated colour groundcover)	200mm	nil	0.5M	36
VH	Viola hederacea	Native Violets (native low groundcover)	tubes	nil	0.1M	120
WIS	Wisteria sinensis	Chinese Wisteria (deciduous climber over pergola)	300mm	over pergola	5.0M	3
Ornamental grasses/strappy leaved plants						
AGW	Agapanthus orientalis ‘Blue’	Blue Lily of the Nile (Hardy strappy leaved groundcover)	200mm	nil	0.5M	6
CM	Clivea miniata	Kaffir Lily (shade tolerant groundcover)	200mm	nil	0.5M	39
CRP	Crinum pedunculatum	Swamp Lily (native mass planted groundcover)	200mm	nil	0.5-0.7	16
DIA	Dianella ‘Cassa Blue’	Hybrid Flax Lily (native grass like plant)	100mm	nil	0.4M	28
LOT	Lomandra ‘Tanika’	Dwarf Mat Rush (native mass planted groundcover)	140mm	nil	0.4M	143
SML	Spathyphyllum ‘Alo Moana’	Peace Lilly (shade tolerant flowering. Glossy leaves)	200mm	nil	0.4M	6

Planting schedule species to be sourced from local nurseries supplying plants of local provenance wherever possible. Landscape contractor is to check plant numbers on plan against the schedule prior to submitting tender price. Contact landscape architect if any number discrepancies are found. Council compliance controls require that any substitution of species variety or container size MUST be confirmed with landscape architect to ensure a compliance certificate can be issued that's meets the specific development consent conditions of the project.

General installation notes

1. Site preparation

Any existing trees and vegetation to be retained shall be preserved and protected from damage of any sort during the execution of landscape work. In particular, root systems of existing plants must not be disturbed if possible. Any nearby site works should be carried carefully using hand tools. To ensure the survival and growth of existing trees during landscaping works, protect by fencing or armoring where necessary. Trees shall not be removed or lopped unless specific written approval to do so is given or is indicated on plan. Storage of materials, mixing of materials, vehicle parking, disposal of liquids, machinery repairs and refueling, site office and sheds, and the lighting of fires shall not occur within three (3) metres of any existing trees. Do not stockpile soil, rubble or other debris cleared from the site, or building materials, within the dripline of existing trees. Vehicular access shall not be permitted within three (3) metres of any tree.

2. Soil preparation

All proposed planting areas to be deep ripped to 200mm (where possible) and clay soils to be treated with clay breaker.. Apply at least 200mm depth good quality garden soil mix to all garden planting areas. To comply with AS 4419 Turfed areas as noted to be laid over 100mm min. good quality turf underlay over existing soil which is to be deep ripped to 200mm depth prior to installation. To be worked in with rotary hoe except where tree root damage would otherwise occur. In such situations care to be taken to hand cultivate in any area where existing tree roots exist to preserve health of trees and to comply with the requirements of the Arborist's report. Where planting is to occur in existing soil profiles ensure soil conditioners and compost worked into the top 200mm profile. To comply with AS 454:1999 .

3. New plantings

Newly planted trees and large shrubs should be secured to stakes with hessian ties to prevent rocking by wind. Planting holes for plant material should be large enough in size to take root ball with additional space to take back filling of good quality planting mix. (Please note mature heights of planting as shown on planting schedule can vary due to site conditions, locations in constricted deep soil or over slab planters and so forth) Also shallow soils in certain locations may affect planting heights. Nominated heights for plantings in raised planters over slabs are nominated as less than their normal expected heights in acknowledgement of the contained soil environment. For other deep soil trees heights are subject to particular site conditions, and intended hedging or pruning for functional requirements such as available planting width, intended access under branches and solar access.

4. Planter wall waterproofing.

All slab areas to be waterproofed and 'Atlantis' drainage cell installed with geotextile fabric or similar approved. Refer Engineer's details for ALL structural, drainage and installation details whatsoever for wall construction. All raised gardens to have the following soils:

- Benedicts Smart Mix no. 4 Lightweight Planter Mix (or approved equivalent) to min. 400-500mm depth.. To comply with AS 4419 and AS 3743
- All planter boxes are to have automatic dripline irrigation system.
- Landscape contractor to install all planter box fill material and plant material after other site works are completed to ensure no deterioration of waterproof membrane behind external walls.

5. Mulching

All planting areas to be mulched with a minimum 75mm thick cover of recycled hard wood chip mulch and then all plant areas to be thoroughly soaked with water. To comply with AS 4454

6. Fertiliser

All planting areas to be fertilised with 9 month 'NPK' slow releas fertiliser.

7. Staking

To those plants indicated on the planting schedules provide: hardwood stakes as nominated and driven into ground to a depth able to achieve rigid support. No staking in raised planters to avoid damaging waterproofing installation

8. Turfing

Turfed areas to be to be laid over 100mm good quality turf underlay over existing soil which is to be deep ripped to 200mm depth prior to installation. See details sheet

9. Structural

All structural details whatsoever to Engineer's details.

Irrigation notes

Automatic drip line watering system to be selectec. To extend to ALL common area garden and landscape zones in the development including both the deep soil and raised planter wall areas and including all raised planter boxes over slab on all levels. (All lawn areas to be excluded.

Water supply tap hosecocks and water supply conduit to be coordinated by Hydraulic and Structural Engineer's details). Dripline supply system only to be incorporated.

Prior to approval by the project manager and prior to installation the Contractor responsible for the irrigation installation is to provide an irrigation desig to meet the following requirements.

Generally: Supply an automatic drip line irrigation system. To include all piping to solenoids either PVC lines and/or class 12 pressure pipe or low density, rubber modified polypropelyne reticulation as required to provide water supply to the nominated areas. To be coordinated with Hydraulic engineers plans. To include all bends, junctions, ends, ball valves, solenoids and all other ancillary equipment. Backwash valve: An approved backwash prevention valve is to be located at the primary water source for top up valves to rainwateranks (where applicable).

Ensure rain sensor is installed for common area gaden zones connected to timers

Root inhibiting system. Driplines to be 'Netafim Tecline AS XR' drip tubing or approved equivalent

Automatic Controller: For all common area landscape areas provide automatic 2 week timer with hourly multi-cycle operation for each zone as noted on the irrigation areas plan on sheet. Battery timers to isolated planter boxes to private terraces.

Performance: It shall be the Landscape Contractor's responsibility to ensure and guarantee satisfactory operation of the irrigation system. The system is to be fit for the purpose and should utilize sufficient solenoids to provide for the varying watering requirements of landscape areas to allow all plants and lawn areas to thrive and attain ing term viability.

Testing: After the system has been installed to the satisfaction of the project manager, the installation shall be tested under working conditions. Acceptance of the installed plant and equipment shall be subject to these being satisfactory.

Warranty: A twelve month warranty is to be provided in writing by the Landscape Contractor, which shall commit the Landscape Contractor to rectify the system (the items they have installed) to the satisfaction of the project manager or nominated representative. This will apply should any fault develop, or the capacity or efficiency fall below that guaranteed, or should the discharge or pressure be inadequate, or should defects develop in the filter unit or control heads, or any blockages that may develop in the system.

Approvals: The Landscape Contractor is to liaise as necessary, to ensure that the irrigation system conforms with all Water Board, Council and Austraan standards (AS)

Maintenance schedule

The Landscape Contractor shall maintain the contract areas by accepted horticultural practices as well as rectifying any defects that become apparent in the works under normal use. The Landscape Contractor shall maintain the works and make good all defects for a period of twenty six (26) weeks after the date of practical completion. Practical completion of the landscape works shall include but not be limited to the replacement of plants which have failed or been damaged or stolen during work under the contract. Landscape maintenance shall include but not be limited to the following: watering, rubbish removal, spraying and wiping leaf surfaces, replacing failed plants, maintaining mulch, pruning, insect and disease control, cleaning of surrounding areas. Mow the nature strip turf when it is established at regular intrvals to maintain an average height of 50mm.

After the completion of the defects period noted above the owners corporation of the residence are responsible for the ongoing maintenance and viability of the gardens and ongoing maintenance shall include the following:

- Regular hand watering of gardens if installed drip line irrigation system is turned off. Irrigation to be installed and maintained as per manufacturers specifications including regular checks for function of system, to check for leaks and to ensure general good working operation. Regular maintenance of the irrigation system battery timers (where required) for isolated planter beds in common areas. Battery timers for private terraces are the responsibility of the individual unit owners.
- Mulch is to be regularly topped up every 6 months to ensure an even 75mm coverage in all garden beds
- Regular pruning of plants is to be undertaken to ensure continued uniform growth of canopy and foliage of trees and shrubs. Removal of vegetation over the long term (if and when required) as the garden matures. Subject to the relevant counil applications
- Regular assessment of plants for evidence of insect attack or disease. Appropriate pest oil, white oil of industry standard safe to use pest spiy is to be employed if required
- Garden/lawn edging to be inspected regularly after practical completion to ensure it is maintained in good order. Replace where require if defective sections are discovered
- All garden refuse, rubbish and associated items that arise from the regular garden maintenance procedures are to be collected and stored in appropriate general waste or green waste containers as is appropriate. Excess waste unable to be stored in Council waste containers is to be removed from the site is a timely manner.

Not for construction

AMENDMENTS		
F	15.3.23	For DA COUNCIL RFI



PO Box 4050. ACT 2602
ABN: 16 949 100 279
PHONE: 02 9907 8011
WWW.SCRIVENER-DESIGN.COM
EMAIL: PAUL@SCRIVENER-DESIGN.COM

PROJECT: MIXED-USE COMMUNITY CENTRE
28 FISHER ROAD & 9 FRANCIS STREET,
DEE WHY, NSW

DWG: DETAILS & NOTES

DATE: 15.3.23
JOB REF: 22/2293

SCALE: 1:150 @A1

BUILDER MUST VERIFY ALL DIMENSIONS OF THE SITE BEFORE WORK COMMENCES.
FIGURED DIMENSIONS SHOULD BE USED IN PREFERENCE TO THOSE SCALED OFF.

COPYRIGHT IS THE PROPERTY OF PAUL SCRIVENER
LANDSCAPE, A.B.N. 16 949 100 279.
THE CONCEPTS, DESIGN, DETAILS AND INFORMATION DESCRIBED IN THE DRAWING ARE COPYRIGHT. OTHER THAN FOR THE PURPOSE PRESCRIBED UNDER THE COPYRIGHT ACT, NO PART OF IT MAY BE ANY FORM OR BY ANY MEANS BE USED OR REPRODUCED WITHOUT PRIOR WRITTEN PERMISSION.

NORTH

5 of 6

DA

ISSUE- F

16/09/2024 14:45:55 22/09/24

Elevation AA 1:100 @ A1



Elevation CC 1:100 @ A1

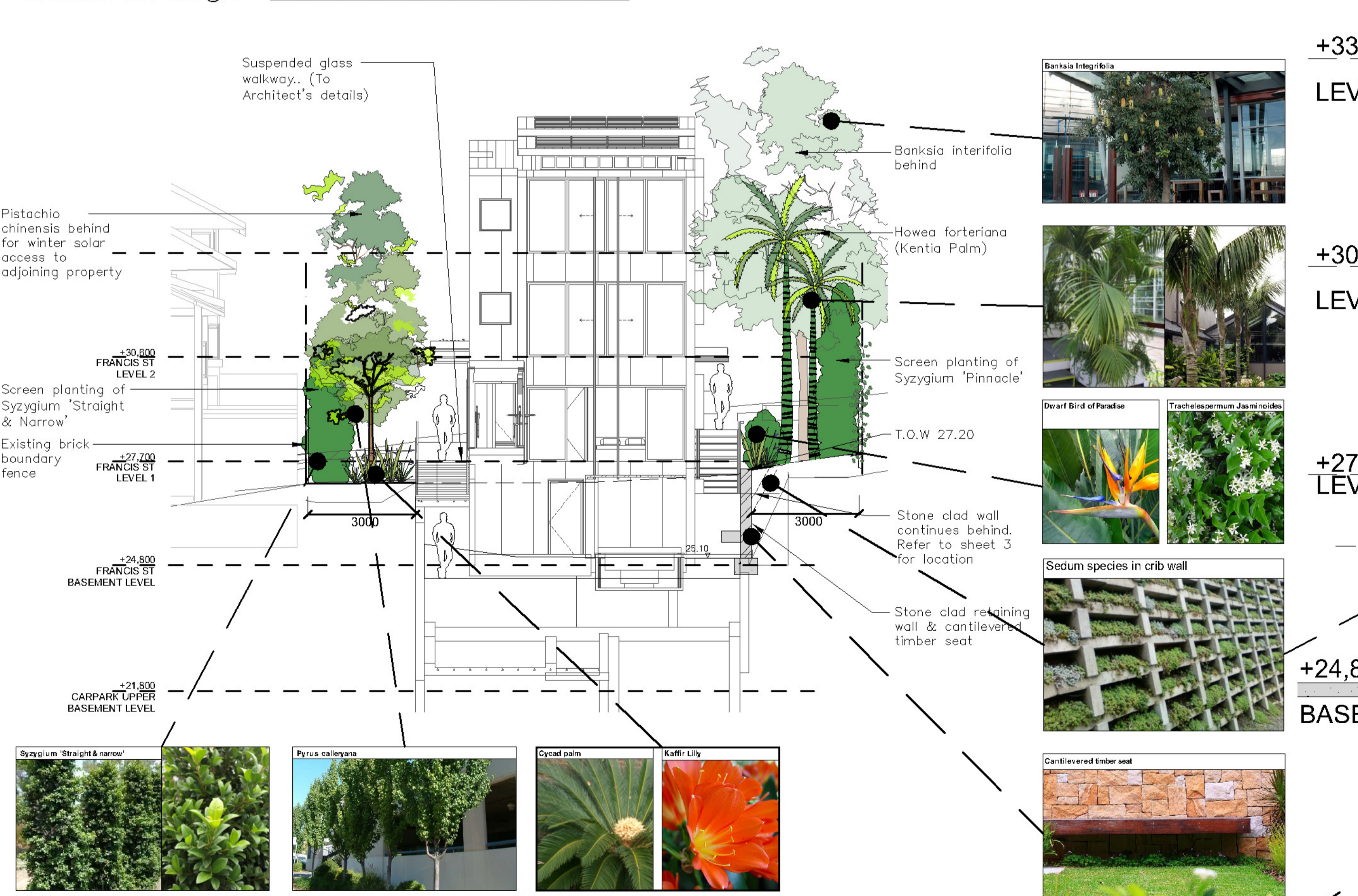

Elevation BB 1:100 @ A1



Sectional elevation DD 1:50 @ A1

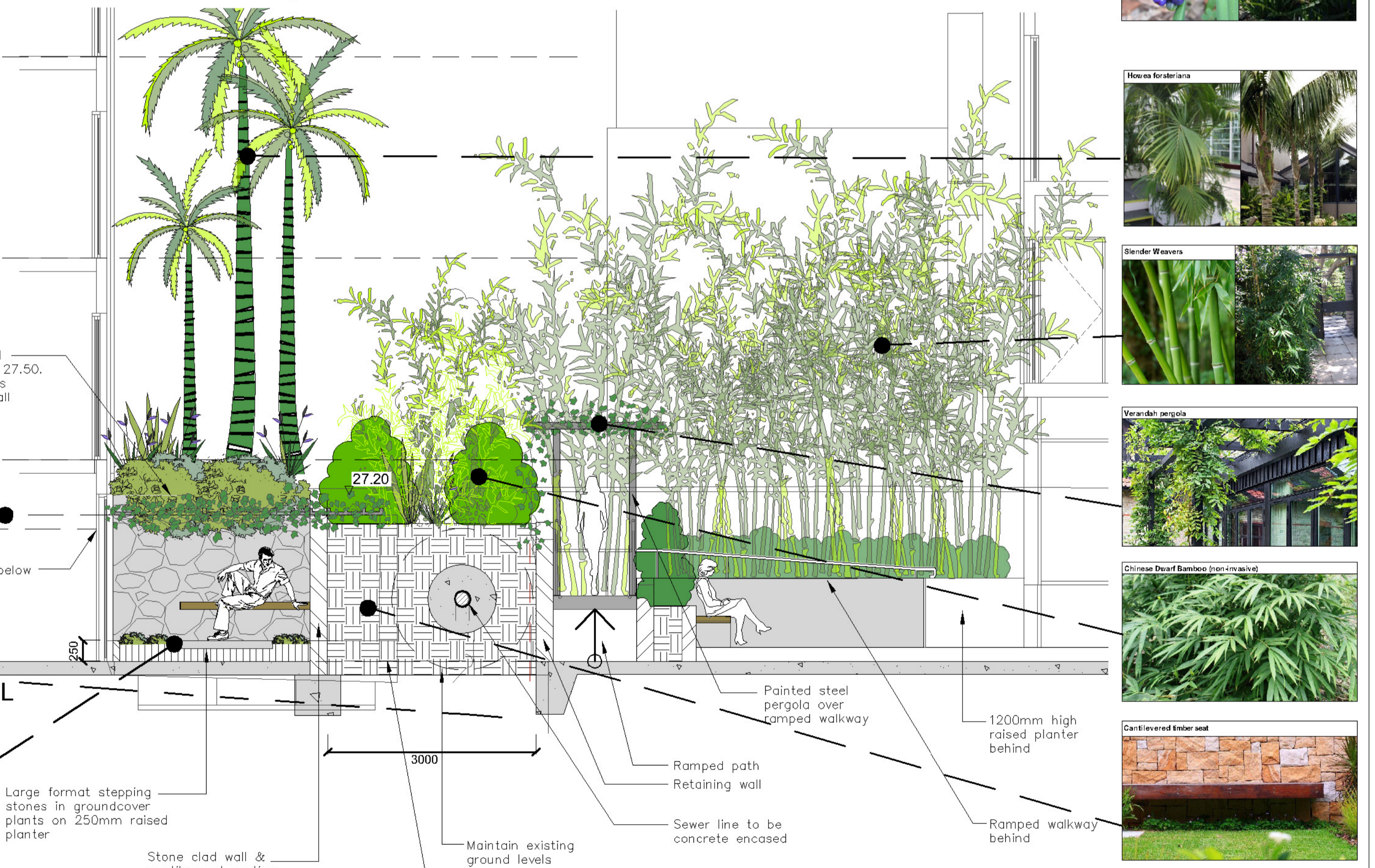

Not for construction

AMENDMENTS	
F 15.3.23	For DA COUNCIL RFI



PO Box 4050. ACT 2602
ABN: 16 949 100 279
PHONE: 02 9907 8011
WWW.SCRIVENER-DESIGN.COM
EMAIL: PAUL@SCRIVENER-DESIGN.COM

PROJECT: MIXED-USE COMMUNITY CENTRE
28 FISHER ROAD & 9 FRANCIS STREET,
DEE WHY, NSW

DWG: LANDSCAPE PLAN - GROUND LEVEL /
SECTION THROUGH SITE

DATE: 15.3.23 SCALE: 1:150 @A1

JOB REF: 22/2293

BUILDER MUST VERIFY ALL DIMENSIONS OF THE SITE BEFORE
WORK COMMENCES.
FIGURED DIMENSIONS SHOULD BE USED IN PREFERENCE TO
THOSE SCALED OFF.

COPYRIGHT IS THE PROPERTY OF PAUL SCRIVENER
LANDSCAPE. A.E.N. 16 949 100 279.
THE CONCEPTS, DESIGN, DETAILS AND INFORMATION
DESCRIBED IN THE DRAWING ARE COPYRIGHT. OTHER THAN
FOR THE PURPOSES PRESCRIBED UNDER THE COPYRIGHT ACT,
NO PART OF IT MAY BE REPRODUCED OR BY ANY MEANS BE
USED OR REPRODUCED WITHOUT PRIOR WRITTEN PERMISSION.

NORTH

6 of 6

DA

ISSUE- F