

STORM WATER DRAINAGE PLAN

SCALE: 1:100
NOTES:

- ALL WORKS TO BE CARRIED OUT IN ACCORDANCE WITH AS/NZS 3500.3:2019 AND COUNCIL SPECIFICATIONS
- LOCATION OF DOWN PIPES AND FLOOR WASTES ARE INDICATIVE ONLY. DOWN PIPE AND FLOOR WASTE SIZE, LOCATION AND QUANTITY TO BE DETERMINED BY CONTRACTOR IN ACCORDANCE WITH RELEVANT AUSTRALIAN STANDARDS
- ALL GUTTERS SHALL BE FITTED WITH LEAF GUARDS AND SHOULD BE INSPECTED AND CLEANED TO ENSURE LEAF LITTER CANNOT ENTER THE DOWN PIPES
- ALL PIPES TO BE 100ø MIN. AND ON 75mm SAND BED WITH THE BARRELS FULLY SUPPORTED. PIPES TO BE LAID ON MINIMUM GRADE 1%
- MINIMUM DEPTH OF COVER FOR PIPES NOT SUBJECT TO VEHICULAR LOADING TO BE 300mm
- ALL DRAINAGE PIPES LAID UNDER PAVEMENT SHALL BE REINFORCED CONCRETE WITH RUBBER RING JOINTS
- BACKFILL TRENCHES WITH COMPACTED SAND OR APPROVED AGGREGATE MATERIAL
- SILT ARRESTORS TO HAVE 900x900mm AND PITS TO HAVE 600x600 INTERNAL DIMENSIONS U.N.O
- HEAVY DUTY GRATES AND COVERS ARE TO BE PROVIDED IN TRAFFICABLE AREAS. SURFACE FLOW TO BE DIRECTED TO ALL GRATED SURFACE INLET PITS
- PIT GRATES TO BE TYPE WELDLOK OR APPROVED EQUIVALENT. ALL TRENCH GRATES SHALL HAVE A MIN. CLEAR WIDTH OF 200mm.
- ALL PITS SHALL BE PROVIDED WITH A LOCKING CLIP AND MAINTAINED REGULARLY
- DRAINAGE PLANS ARE TO BE READ IN CONJUNCTION WITH ARCHITECTURALS AND OTHER CONSULTANT DRAWINGS. ANY DISCREPANCIES ARE TO BE REFERRED TO TCSM ENGINEERING CONSULTANTS FOR REVIEW AND DECISION
- 100mm DIAMETER SUBSOIL DRAINAGE PIPE 3000mm LONG WRAPPED IN FABRIC SOCK TO BE PROVIDED ADJACENT TO INLET PIPES
- PROVIDE CLEANING EYES TO ALL DOWN PIPES NOT DIRECTLY CONNECTED TO PITS
- ISOLATION JOINTS TO BE PROVIDED TO ISOLATE CONCRETE PAVEMENTS FROM PITS
- STORM WATER DRAINAGE CONNECTIONS TO THE MAIN SYSTEM SHALL BE TO THE REQUIREMENTS AND SATISFACTION OF LOCAL COUNCIL
- SERVICES SHOWN ON PLAN ARE INDICATIVE ONLY, EXACT DEPTH AND LOCATION TO BE CONFIRMED ON SITE. THE CONTRACTOR SHALL CARRY OUT A "DIAL BEFORE YOU DIG" APPLICATION AND ENGAGE A REGISTERED SURVEYOR TO PEG OUT ALL EXISTING SERVICES PRIOR TO ANY WORK COMMENCING ON SITE
- ALL MILD STEEL FIXTURES INCLUDING GRATES, FRAMES, STEP IRONS, LADDERS AND ETC. SHALL BE HOT DIP GALVANIZED
- EXISTING STORM WATER PIPES AND DOWN PIPES TO BE RETAINED (IF ANY) SHALL HAVE THEIR CONDITION AND/OR STATE OF REPAIR ASSESSED BY A QUALIFIED PLUMBER, AND SHALL BE REPLACED WHERE DEEMED NECESSARY. CONNECTION MAY BE MADE INTO EXISTING SYSTEMS THAT ARE FOUND TO BE IN GOOD CONDITION.
- IF AN EXISTING STORM WATER SYSTEM IS CONNECTED TO THE SEWER, CONTRACTOR IS TO RECTIFY THE STORM WATER DESIGN AND CREATE A NEW CONNECTION AS PER COUNCIL AND AUSTRALIAN STANDARD SPECIFICATIONS. CONTRACTOR MUST CONTACT TCSM ENGINEERING CONSULTANTS PRIOR TO THE COMMENCEMENT OF ANY WORKS
- CONTRACTOR TO ENSURE LOCATION OF ANY NEW DWELLINGS/STRUCTURES DO NOT ADVERSELY IMPACT EXISTING STORM WATER SYSTEMS. ANY CLASHES/DISCREPANCIES ARE TO BE REFERRED TO TCSM ENGINEERING CONSULTANTS FOR REVIEW AND DECISION
- FINISHED GROUND LEVELS SHOULD BE IN ACCORDANCE WITH ARCHITECTURAL DRAWINGS. DISCREPANCIES BETWEEN THESE LEVELS AND THE SURFACE LEVELS SHOWN FOR DRAINAGE STRUCTURES SHOWN ON THESE DRAWINGS SHOULD BE REFERRED TO THE ENGINEER FOR ADVICE
- THE HEIGHT OF ANY SLAB-ON-GROUND ABOVE EXTERNAL FINISHED SURFACES SHALL BE IN ACCORDANCE WITH ARCHITECTURAL DOCUMENTATION, BUT MUST NOT BE LESS THAN 50mm ABOVE IMPERMEABLE (PAVED/CONCRETE) AREAS THAT SLOPE AWAY FROM THE BUILDING (50mm OVER THE FIRST 1m FROM THE BUILDING), 100mm ABOVE SANDY/WELL-DRAINED AREAS, OR 150mm IN ANY OTHER CASE. THE GROUND BENEATH SUSPENDED FLOORS MUST BE HIGHER THAN THE ADJACENT EXTERNAL FINISHED GROUND LEVEL, AND GRADED TO PREVENT PONDING UNDER THE BUILDING
- DOWNPIPE SPREADERS NOT TO BE USED OVER TILE ROOFS UNLESS SARKING IS PROVIDED UNDER TILES. IF REQUIRED, TILES SHOULD BE REMOVED AND ROOF SARKED AS REQUIRED BY BUILDER.

FOOTPATH REINSTATEMENT NOTES:

- REMOVE ALL SAND FILL WITHIN THE FOOTPATH AREA TO EXISTING SUBGRADE
- SUPPORT ALL AUTHORITY SERVICES TO STRUCTURAL ENGINEERS DETAILS DURING EXCAVATION
- REINSTATE FOOT PATH SUBGRADE
- THE CONTRACTOR SHALL PROVIDE CERTIFICATION OF COMPACTION FROM A NATA REGISTERED TESTING AUTHORITY, MINIMUM THREE TESTS PER LAYER AS FOLLOWS:
 - SELECT FILL 95% MODIFIED
 - SELECT FILL (+300mm BELOW BASE COURSE) 98% MODIFIED
 - BASE COURSE 100% MODIFIED

LEGEND

- | | | | |
|--------------------------|--------------------------|-----|-----------------------|
| SW | STORMWATER DRAINAGE PIPE | eDP | EXISTING DOWNPIPE |
| RWT | PIPE TO RAINWATER TANK | eKO | EXISTING KERB OUTLET |
| OF | OVERFLOW FROM RWT | RL | PIT SURFACE LEVEL |
| AG | ø100 SUBSOIL PIPE | IL | INVERT LEVEL |
| RM | RISING MAIN | TK | TOP OF KERB |
| ESL | EXISTING STORMWATER LINE | RT | RAINWATER TANK |
| DP | PROPOSED DOWN PIPE | FF | FIRST FLUSH DEVICE |
| KO | PROPOSED KERB OUTLET | VD | VERTICAL DROP |
| CO | CLEAN OUT | VR | VERTICAL RISER |
| CONC. COVER JUNCTION PIT | | DP | DOWNPIPE SPREADER |
| GRATED INLET PIT | | RWO | RAINWATER OUTLET 300ø |
| KERB INLET PIT | | GRD | GRATED DRAIN |

DESIGN NOTES:

- THE SITE IS GOVERNED BY NORTHERN BEACHES COUNCIL.
- THE PROPOSED DEVELOPMENT IS A SINGLE DWELLING.
- THE TOTAL SITE AREA IS 1328m² (BY DP)
- THE NET INCREASE IN IMPERVIOUS AREA IS 47.60m²
- IN ACCORDANCE WITH COUNCILS STORM WATER GUIDELINES, OSD IS NOT REQUIRED FOR SUBJECT DEVELOPMENT
- ENSURE THAT ALL STORMWATER PIPES ARE A MINIMUM OF 600mm AWAY FROM SYDNEY WATER ASSETS (TYP).
- ALL STORMWATER PIPES ARE TO BE A MINIMUM OF 600mm CLEAR FROM EXISTING SEWER LINE (TYP).
- INSTALL CLEAR CUTS FOR INSPECTION AND MAINTENANCE PURPOSES (TYP).



TCSM ENGINEERING CONSULTANTS

E: info@tcsconsultants.com
P: 0456 645 770
W: www.tcsconsultants.com

Rev.	Notes	Issued
A	ISSUED FOR APPROVAL	12.05.2023

Sheet Title
STORM WATER DRAINAGE PLAN
SHEET 1 OF 3

Sheet No. SW01 | Revision A | Drawing Status ISSUED FOR APPROVAL

Project No. 23160
Commencement Date 01.05.2023
Scale 1:100 | Size A1

Project
PROPOSED RESIDENTIAL DEVELOPMENT
Address
11B HILL STREET, WARRIEWOOD

Client
FJA DESIGNS

All information contained within this drawing is copyright of TCSM Engineering Consultants. Using or reproducing any part of this drawing without written permission infringes copyright.

STORM WATER DRAINAGE PLAN

SCALE: 1:100
NOTES:

- ALL WORKS TO BE CARRIED OUT IN ACCORDANCE WITH AS/NZS 3500.3:2019 AND COUNCIL SPECIFICATIONS
- LOCATION OF DOWN PIPES AND FLOOR WASTES ARE INDICATIVE ONLY. DOWN PIPE AND FLOOR WASTE SIZE, LOCATION AND QUANTITY TO BE DETERMINED BY CONTRACTOR IN ACCORDANCE WITH RELEVANT AUSTRALIAN STANDARDS
- ALL GUTTERS SHALL BE FITTED WITH LEAF GUARDS AND SHOULD BE INSPECTED AND CLEANED TO ENSURE LEAF LITTER CANNOT ENTER THE DOWN PIPES
- ALL PIPES TO BE 100ø MIN. AND ON 75mm SAND BED WITH THE BARRELS FULLY SUPPORTED. PIPES TO BE LAID ON MINIMUM GRADE 1%
- MINIMUM DEPTH OF COVER FOR PIPES NOT SUBJECT TO VEHICULAR LOADING TO BE 300mm
- ALL DRAINAGE PIPES LAID UNDER PAVEMENT SHALL BE REINFORCED CONCRETE WITH RUBBER RING JOINTS
- BACKFILL TRENCHES WITH COMPACTED SAND OR APPROVED AGGREGATE MATERIAL
- SILT ARRESTORS TO HAVE 900x900mm AND PITS TO HAVE 600x600 INTERNAL DIMENSIONS U.N.O
- HEAVY DUTY GRATES AND COVERS ARE TO BE PROVIDED IN TRAFFICABLE AREAS. SURFACE FLOW TO BE DIRECTED TO ALL GRATED SURFACE INLET PITS
- PIT GRATES TO BE TYPE WELDLOK OR APPROVED EQUIVALENT. ALL TRENCH GRATES SHALL HAVE A MIN. CLEAR WIDTH OF 200mm.
- ALL PITS SHALL BE PROVIDED WITH A LOCKING CLIP AND MAINTAINED REGULARLY
- DRAINAGE PLANS ARE TO BE READ IN CONJUNCTION WITH ARCHITECTURALS AND OTHER CONSULTANT DRAWINGS. ANY DISCREPANCIES ARE TO BE REFERRED TO TCSM ENGINEERING CONSULTANTS FOR REVIEW AND DECISION
- 100mm DIAMETER SUBSOIL DRAINAGE PIPE 3000mm LONG WRAPPED IN FABRIC SOCK TO BE PROVIDED ADJACENT TO INLET PIPES
- PROVIDE CLEANING EYES TO ALL DOWN PIPES NOT DIRECTLY CONNECTED TO PITS
- ISOLATION JOINTS TO BE PROVIDED TO ISOLATE CONCRETE PAVEMENTS FROM PITS
- STORM WATER DRAINAGE CONNECTIONS TO THE MAIN SYSTEM SHALL BE TO THE REQUIREMENTS AND SATISFACTION OF LOCAL COUNCIL
- SERVICES SHOWN ON PLAN ARE INDICATIVE ONLY, EXACT DEPTH AND LOCATION TO BE CONFIRMED ON SITE. THE CONTRACTOR SHALL CARRY OUT A "DIAL BEFORE YOU DIG" APPLICATION AND ENGAGE A REGISTERED SURVEYOR TO PEG OUT ALL EXISTING SERVICES PRIOR TO ANY WORK COMMENCING ON SITE
- ALL MILD STEEL FIXTURES INCLUDING GRATES, FRAMES, STEP IRONS, LADDERS AND ETC. SHALL BE HOT DIP GALVANIZED
- EXISTING STORM WATER PIPES AND DOWN PIPES TO BE RETAINED (IF ANY) SHALL HAVE THEIR CONDITION AND/OR STATE OF REPAIR ASSESSED BY A QUALIFIED PLUMBER, AND SHALL BE REPLACED WHERE DEEMED NECESSARY. CONNECTION MAY BE MADE INTO EXISTING SYSTEMS THAT ARE FOUND TO BE IN GOOD CONDITION.
- IF AN EXISTING STORM WATER SYSTEM IS CONNECTED TO THE SEWER, CONTRACTOR IS TO RECTIFY THE STORM WATER DESIGN AND CREATE A NEW CONNECTION AS PER COUNCIL AND AUSTRALIAN STANDARD SPECIFICATIONS. CONTRACTOR MUST CONTACT TCSM ENGINEERING CONSULTANTS PRIOR TO THE COMMENCEMENT OF ANY WORKS
- CONTRACTOR TO ENSURE LOCATION OF ANY NEW DWELLINGS/STRUCTURES DO NOT ADVERSELY IMPACT EXISTING STORM WATER SYSTEMS. ANY CLASHES/DISCREPANCIES ARE TO BE REFERRED TO TCSM ENGINEERING CONSULTANTS FOR REVIEW AND DECISION
- FINISHED GROUND LEVELS SHOULD BE IN ACCORDANCE WITH ARCHITECTURAL DRAWINGS. DISCREPANCIES BETWEEN THESE LEVELS AND THE SURFACE LEVELS SHOWN FOR DRAINAGE STRUCTURES SHOWN ON THESE DRAWINGS SHOULD BE REFERRED TO THE ENGINEER FOR ADVICE
- THE HEIGHT OF ANY SLAB-ON-GROUND ABOVE EXTERNAL FINISHED SURFACES SHALL BE IN ACCORDANCE WITH ARCHITECTURAL DOCUMENTATION, BUT MUST NOT BE LESS THAN 50mm ABOVE IMPERMEABLE (PAVED/CONCRETE) AREAS THAT SLOPE AWAY FROM THE BUILDING (50mm OVER THE FIRST 1m FROM THE BUILDING), 100mm ABOVE SANDY/WELL-DRAINED AREAS, OR 150mm IN ANY OTHER CASE. THE GROUND BENEATH SUSPENDED FLOORS MUST BE HIGHER THAN THE ADJACENT EXTERNAL FINISHED GROUND LEVEL, AND GRADED TO PREVENT PONDING UNDER THE BUILDING
- DOWNPIPE SPREADERS NOT TO BE USED OVER TILE ROOFS UNLESS SARKING IS PROVIDED UNDER TILES. IF REQUIRED, TILES SHOULD BE REMOVED AND ROOF SARKED AS REQUIRED BY BUILDER.

FOOTPATH REINSTATEMENT NOTES:

- REMOVE ALL SAND FILL WITHIN THE FOOTPATH AREA TO EXISTING SUBGRADE
- SUPPORT ALL AUTHORITY SERVICES TO STRUCTURAL ENGINEERS DETAILS DURING EXCAVATION
- REINSTATE FOOT PATH SUBGRADE
- THE CONTRACTOR SHALL PROVIDE CERTIFICATION OF COMPACTION FROM A NATA REGISTERED TESTING AUTHORITY, MINIMUM THREE TESTS PER LAYER AS FOLLOWS:
 - SELECT FILL 95% MODIFIED
 - SELECT FILL (+300mm BELOW BASE COURSE) 98% MODIFIED
 - BASE COURSE 100% MODIFIED

LEGEND

- SW

STORMWATER DRAINAGE PIPE
- RWT

PIPE TO RAINWATER TANK
- OF

OVERFLOW FROM RWT
- AG

ø100 SUBSOIL PIPE
- RM

RISING MAIN
- ESL

EXISTING STORMWATER LINE
- DP

PROPOSED DOWN PIPE
- KO

PROPOSED KERB OUTLET
- CO

CLEAN OUT
- CONC. COVER JUNCTION PIT
- GRATED INLET PIT
- KERB INLET PIT
- eDP

EXISTING DOWNPIPE
- eKO

EXISTING KERB OUTLET
- RL

PIT SURFACE LEVEL
- IL

INVERT LEVEL
- TK

TOP OF KERB
- RAINWATER TANK
- FF

FIRST FLUSH DEVICE
- VD

VERTICAL DROP
- VR

VERTICAL RISER
- DP

DOWNPIPE SPREADER
- RWO

RAINWATER OUTLET 300ø
- GRATED DRAIN

DESIGN NOTES:

- THE SITE IS GOVERNED BY NORTHERN BEACHES COUNCIL
- THE PROPOSED DEVELOPMENT IS A SINGLE DWELLING.
- THE TOTAL SITE AREA IS 1328m² (BY DP)
- THE NET INCREASE IN IMPERVIOUS AREA IS 47.60m²
- IN ACCORDANCE WITH COUNCILS STORM WATER GUIDELINES, OSD IS NOT REQUIRED FOR SUBJECT DEVELOPMENT
- ENSURE THAT ALL STORMWATER PIPES ARE A MINIMUM OF 600mm AWAY FROM SYDNEY WATER ASSETS (TYP.)
- ALL STORMWATER PIPES ARE TO BE A MINIMUM OF 600mm CLEAR FROM EXISTING SEWER LINE (TYP.)
- INSTALL CLEAR OUTS FOR INSPECTION AND MAINTENANCE PURPOSES (TYP.)



DIAL 1100
BEFORE YOU DIG

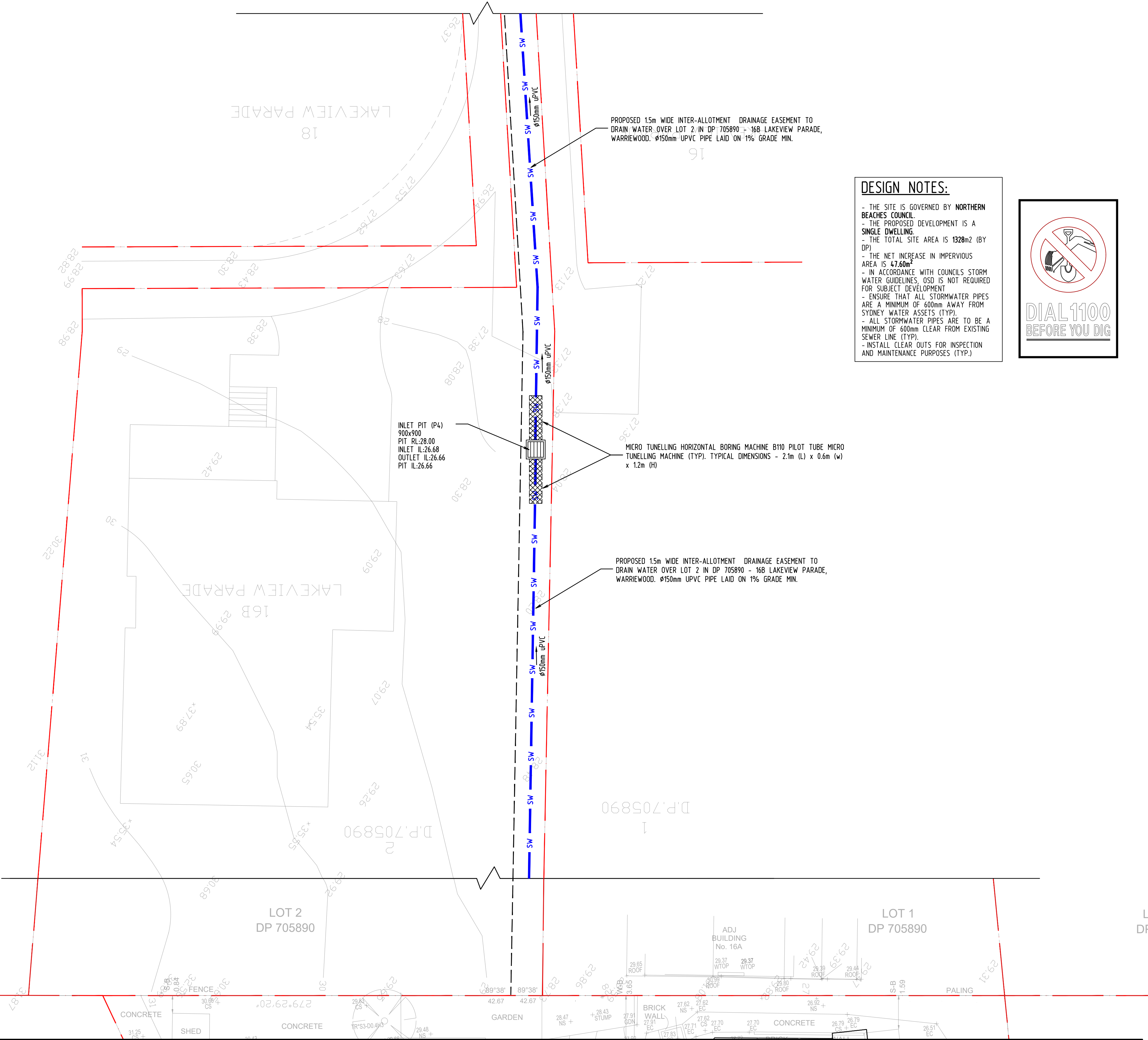

TCSM ENGINEERING CONSULTANTS

E: info@tcsconsultants.com
P: 0456 645 770
W: www.tcsconsultants.com

Rev.	Notes	Issued
A	ISSUED FOR APPROVAL	12.05.2023

Sheet Title	Project No.	Project	Client
STORM WATER DRAINAGE PLAN	23160	PROPOSED RESIDENTIAL DEVELOPMENT	FJA DESIGNS
SHEET 2 OF 3	Commencement Date	Address	
	01.05.2023	11B HILL STREET, WARRIEWOOD	
Sheet No.	Revision	Drawing Status	
SW02	A	ISSUED FOR APPROVAL	

Scale	Size
1:100	A1

All information contained within this drawing is copyright of TCSM Engineering Consultants. Using or reproducing any part of this drawing without written permission infringes copyright.

STORM WATER DRAINAGE PLAN

SCALE: 1:100
NOTES:

1. ALL WORKS TO BE CARRIED OUT IN ACCORDANCE WITH AS/NZS 3500.3:2019 AND COUNCIL SPECIFICATIONS
2. LOCATION OF DOWN PIPES AND FLOOR WASTES ARE INDICATIVE ONLY. DOWN PIPE AND FLOOR WASTE SIZE, LOCATION AND QUANTITY TO BE DETERMINED BY CONTRACTOR IN ACCORDANCE WITH RELEVANT AUSTRALIAN STANDARDS
3. ALL GUTTERS SHALL BE FITTED WITH LEAF GUARDS AND SHOULD BE INSPECTED AND CLEANED TO ENSURE LEAF LITTER CANNOT ENTER THE DOWN PIPES
4. ALL PIPES TO BE 100ø MIN. AND ON 75mm SAND BED WITH THE BARRELS FULLY SUPPORTED. PIPES TO BE LAID ON MINIMUM GRADE 1%
5. MINIMUM DEPTH OF COVER FOR PIPES NOT SUBJECT TO VEHICULAR LOADING TO BE 300mm
6. ALL DRAINAGE PIPES LAID UNDER PAVEMENT SHALL BE REINFORCED CONCRETE WITH RUBBER RING JOINTS
7. BACKFILL TRENCHES WITH COMPACTED SAND OR APPROVED AGGREGATE MATERIAL
8. SILT ARRESTORS TO HAVE 900x900mm AND PITS TO HAVE 600x600 INTERNAL DIMENSIONS U.N.O
9. HEAVY DUTY GRATES AND COVERS ARE TO BE PROVIDED IN TRAFFICABLE AREAS. SURFACE FLOW TO BE DIRECTED TO ALL GRATED SURFACE INLET PITS
10. PIT GRATES TO BE TYPE WELDLOK OR APPROVED EQUIVALENT. ALL TRENCH GRATES SHALL HAVE A MIN. CLEAR WIDTH OF 200mm.
11. ALL PITS SHALL BE PROVIDED WITH A LOCKING CLIP AND MAINTAINED REGULARLY
12. DRAINAGE PLANS ARE TO BE READ IN CONJUNCTION WITH ARCHITECTURALS AND OTHER CONSULTANT DRAWINGS. ANY DISCREPANCIES ARE TO BE REFERRED TO TCSM ENGINEERING CONSULTANTS FOR REVIEW AND DECISION
13. 100mm DIAMETER SUBSOIL DRAINAGE PIPE 3000mm LONG WRAPPED IN FABRIC SOCK TO BE PROVIDED ADJACENT TO INLET PIPES
14. PROVIDE CLEANING EYES TO ALL DOWN PIPES NOT DIRECTLY CONNECTED TO PITS
15. ISOLATION JOINTS TO BE PROVIDED TO ISOLATE CONCRETE PAVEMENTS FROM PITS
16. STORM WATER DRAINAGE CONNECTIONS TO THE MAIN SYSTEM SHALL BE TO THE REQUIREMENTS AND SATISFACTION OF LOCAL COUNCIL
17. SERVICES SHOWN ON PLAN ARE INDICATIVE ONLY, EXACT DEPTH AND LOCATION TO BE CONFIRMED ON SITE. THE CONTRACTOR SHALL CARRY OUT A "DIAL BEFORE YOU DIG" APPLICATION AND ENGAGE A REGISTERED SURVEYOR TO PEG OUT ALL EXISTING SERVICES PRIOR TO ANY WORK COMMENCING ON SITE
18. ALL MILD STEEL FIXTURES INCLUDING GRATES, FRAMES, STEP IRONS, LADDERS AND ETC. SHALL BE HOT DIP GALVANIZED
19. EXISTING STORM WATER PIPES AND DOWN PIPES TO BE RETAINED (IF ANY) SHALL HAVE THEIR CONDITION AND/OR STATE OF REPAIR ASSESSED BY A QUALIFIED PLUMBER, AND SHALL BE REPLACED WHERE DEEMED NECESSARY. CONNECTION MAY BE MADE INTO EXISTING SYSTEMS THAT ARE FOUND TO BE IN GOOD CONDITION.
20. IF AN EXISTING STORM WATER SYSTEM IS CONNECTED TO THE SEWER, CONTRACTOR IS TO RECTIFY THE STORM WATER DESIGN AND CREATE A NEW CONNECTION AS PER COUNCIL AND AUSTRALIAN STANDARD SPECIFICATIONS. CONTRACTOR MUST CONTACT TCSM ENGINEERING CONSULTANTS PRIOR TO THE COMMENCEMENT OF ANY WORKS
21. CONTRACTOR TO ENSURE LOCATION OF ANY NEW DWELLINGS/STRUCTURES DO NOT ADVERSELY IMPACT EXISTING STORM WATER SYSTEMS. ANY CLASHES/DISCREPANCIES ARE TO BE REFERRED TO TCSM ENGINEERING CONSULTANTS FOR REVIEW AND DECISION
22. FINISHED GROUND LEVELS SHOULD BE IN ACCORDANCE WITH ARCHITECTURAL DRAWINGS. DISCREPANCIES BETWEEN THESE LEVELS AND THE SURFACE LEVELS SHOWN FOR DRAINAGE STRUCTURES SHOWN ON THESE DRAWINGS SHOULD BE REFERRED TO THE ENGINEER FOR ADVICE
23. THE HEIGHT OF ANY SLAB-ON-GROUND ABOVE EXTERNAL FINISHED SURFACES SHALL BE IN ACCORDANCE WITH ARCHITECTURAL DOCUMENTATION, BUT MUST NOT BE LESS THAN 50mm ABOVE IMPERMEABLE (PAVED/CONCRETE) AREAS THAT SLOPE AWAY FROM THE BUILDING (50mm OVER THE FIRST 1m FROM THE BUILDING), 100mm ABOVE SANDY/WELL-DRAINED AREAS, OR 150mm IN ANY OTHER CASE. THE GROUND BENEATH SUSPENDED FLOORS MUST BE HIGHER THAN THE ADJACENT EXTERNAL FINISHED GROUND LEVEL, AND GRADED TO PREVENT PONDING UNDER THE BUILDING
24. DOWNPIPE SPREADERS NOT BE TO BE USED OVER TILE ROOFS UNLESS SARKING IS PROVIDED UNDER TILES. IF REQUIRED, TILES SHOULD BE REMOVED AND ROOF SARKED AS REQUIRED BY BUILDER.

FOOTPATH REINSTATEMENT NOTES:

1. REMOVE ALL SAND FILL WITHIN THE FOOTPATH AREA TO EXISTING SUBGRADE
2. SUPPORT ALL AUTHORITY SERVICES TO STRUCTURAL ENGINEERS DETAILS DURING EXCAVATION
3. REINSTATE FOOT PATH SUBGRADE
4. THE CONTRACTOR SHALL PROVIDE CERTIFICATION OF COMPACTION FROM A NATA REGISTERED TESTING AUTHORITY, MINIMUM THREE TESTS PER LAYER AS FOLLOWS:

- SELECT FILL

- SELECT FILL (+300mm BELOW BASE COURSE)

- BASE COURSE

95% MODIFIED

98% MODIFIED

100% MODIFIED

LEGEND

- SW

STORMWATER DRAINAGE PIPE

RWT

PIPE TO RAINWATER TANK

OF

OVERFLOW FROM RWT

AG

ø100 SUBSOIL PIPE

RM

RISING MAIN

ESL

EXISTING STORMWATER LINE

DP

PROPOSED DOWN PIPE

KO

PROPOSED KERB OUTLET

CO

CLEAN OUT

CONC. COVER JUNCTION PIT

GRATED INLET PIT

KERB INLET PIT

eDP

EXISTING DOWNPIPE

eKO

EXISTING KERB OUTLET

RL

PIT SURFACE LEVEL

IL

INVERT LEVEL

TK

TOP OF KERB

RAINWATER TANK

FF

FIRST FLUSH DEVICE

VD

VERTICAL DROP

VR

VERTICAL RISER

DP

DOWNPIPE SPREADER

RWO

RAINWATER OUTLET 300ø

GRATED DRAIN
-
- DESIGN NOTES:
- THE SITE IS GOVERNED BY NORTHERN BEACHES COUNCIL

- THE PROPOSED DEVELOPMENT IS A SINGLE DWELLING.

- THE TOTAL SITE AREA IS 1328m2 (BY DP)

- THE NET INCREASE IN IMPERVIOUS AREA IS 47.60m²

- IN ACCORDANCE WITH COUNCILS STORM WATER GUIDELINES, OSD IS NOT REQUIRED FOR SUBJECT DEVELOPMENT

- ENSURE THAT ALL STORMWATER PIPES ARE A MINIMUM OF 600mm AWAY FROM SYDNEY WATER ASSETS (TYP.)

- ALL STORMWATER PIPES ARE TO BE A MINIMUM OF 600mm CLEAR FROM EXISTING SEWER LINE (TYP.)

- INSTALL CLEAR OUTS FOR INSPECTION AND MAINTENANCE PURPOSES (TYP.)
-
- | | | | | | | | | | | | | | |
|--|------|-------|--------|---------------------------|---------------------|---------------------|--|----------------------------------|--|-------------|--|--|--|
| <div>TCSMENGINEERING CONSULTANTS</div> <div>E: info@tcsmconsultants.com</div> <div>P: 0456 645 770</div> <div>W: www.tcsmconsultants.com</div> | Rev. | Notes | Issued | Sheet Title | | Project No. | | Project | | Client | | | |
| | | | | STORM WATER DRAINAGE PLAN | | 23160 | | PROPOSED RESIDENTIAL DEVELOPMENT | | FJA DESIGNS | | | |
| | | | | SHEET 3 OF 3 | | Commencement Date | | Address | | | | | |
| | | | | | | 01.05.2023 | | 11B HILL STREET, WARRIEWOOD | | | | | |
| | | | | | | Scale | | Size | | | | | |
| | | | | | | 1:100 | | A1 | | | | | |
| | | | | Sheet No. | Revision | Drawing Status | | | | | | | |
| | | | | SW03 | A | ISSUED FOR APPROVAL | | | | | | | |
| | | | | A | ISSUED FOR APPROVAL | | | | | | | | |
| | | | | | | | | | | | | | |
| | | | | | | | | | | | | | |
| | | | | | | | | | | | | | |
| | | | | | | | | | | | | | |
| | | | | | | | | | | | | | |
| | | | | | | | | | | | | | |
| | | | | | | | | | | | | | |
| | | | | | | | | | | | | | |
| | | | | | | | | | | | | | |
| | | | | | | | | | | | | | |
| | | | | | | | | | | | | | |
| | | | | | | | | | | | | | |
| | | | | | | | | | | | | | |
| | | | | | | | | | | | | | |
| | | | | | | | | | | | | | |
| | | | | | | | | | | | | | |
| | | | | | | | | | | | | | |
| | | | | | | | | | | | | | |
| | | | | | | | | | | | | | |
| | | | | | | | | | | | | | |
| | | | | | | | | | | | | | |
| | | | | | | | | | | | | | |
| | | | | | | | | | | | | | |
| | | | | | | | | | | | | | |
| | | | | | | | | | | | | | |
| | | | | | | | | | | | | | |
| | | | | | | | | | | | | | |
| | | | | | | | | | | | | | |
| | | | | | | | | | | | | | |
| | | | | | | | | | | | | | |
| | | | | | | | | | | | | | |
| | | | | | | | | | | | | | |
| | | | | | | | | | | | | | |
| | | | | | | | | | | | | | |
| | | | | | | | | | | | | | |
| | | | | | | | | | | | | | |
| | | | | | | | | | | | | | |
| | | | | | | | | | | | | | |
| | | | | | | | | | | | | | |
| | | | | | | | | | | | | | |
| | | | | | | | | | | | | | |
| | | | | | | | | | | | | | |
| | | | | | | | | | | | | | |
| | | | | | | | | | | | | | |
| | | | | | | | | | | | | | |
| | | | | | | | | | | | | | |
| | | | | | | | | | | | | | |
| | | | | | | | | | | | | | |
| | | | | | | | | | | | | | |
| | | | | | | | | | | | | | |
| | | | | | | | | | | | | | |
| | | | | | | | | | | | | | |
| | | | | | | | | | | | | | |
| | | | | | | | | | | | | | |
| | | | | | | | | | | | | | |
| | | | | | | | | | | | | | |
| | | | | | | | | | | | | | |
| | | | | | | | | | | | | | |
| | | | | | | | | | | | | | |
| | | | | | | | | | | | | | |
| | | | | | | | | | | | | | |
| | | | | | | | | | | | | | |
| | | | | | | | | | | | | | |
| | | | | | | | | | | | | | |
| | | | | | | | | | | | | | |
| | | | | | | | | | | | | | |
| | | | | | | | | | | | | | |

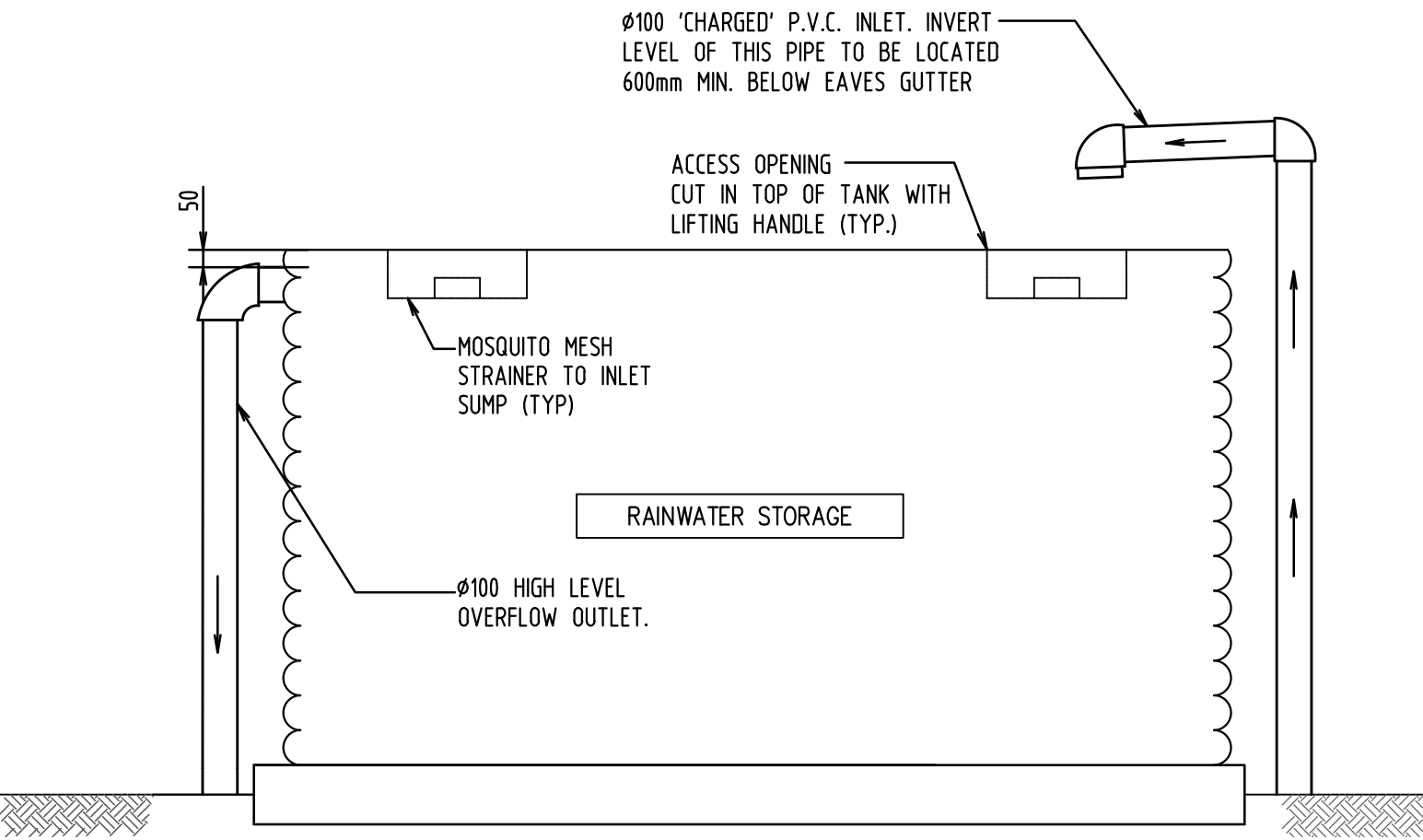

DETAIL
TYPICAL ABOVE GROUND
RAINWATER TANK
NOT TO SCALE



DETAIL
RAINWATER SIGN
SCALE 1:10

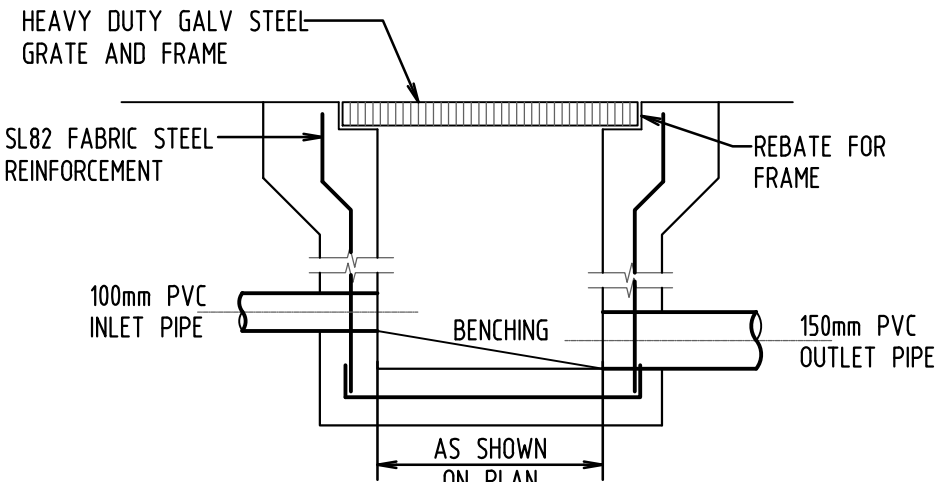

SECTION

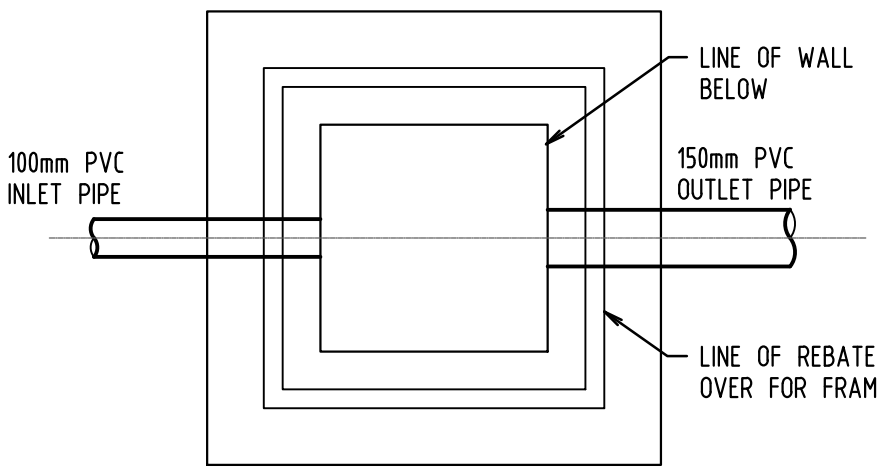

PLAN WITHOUT GRATE

DETAIL
STORMWATER PIT
SCALE 1:20

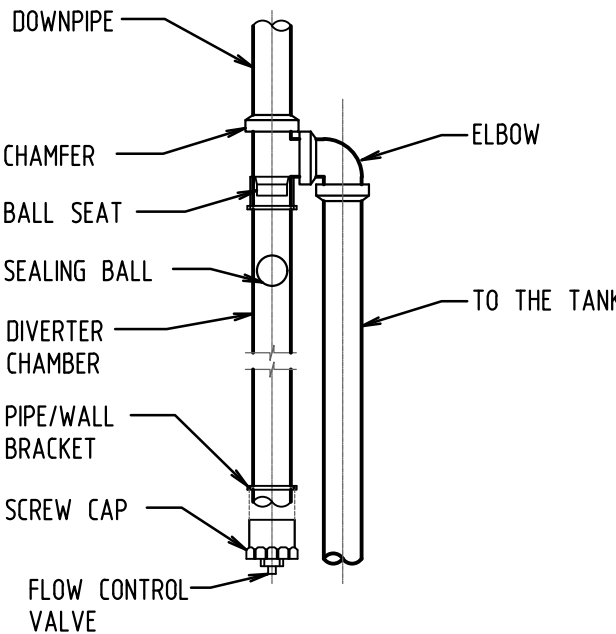

DETAIL
FIRST FLUSH DIVERTER
SCALE 1:20

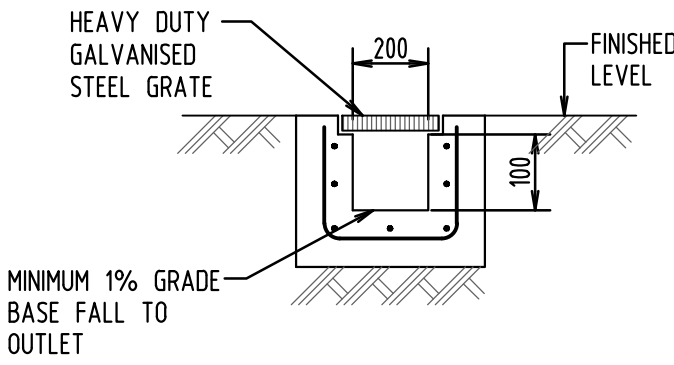

DETAIL
GRATED TRENCH DRAIN
SCALE 1:20

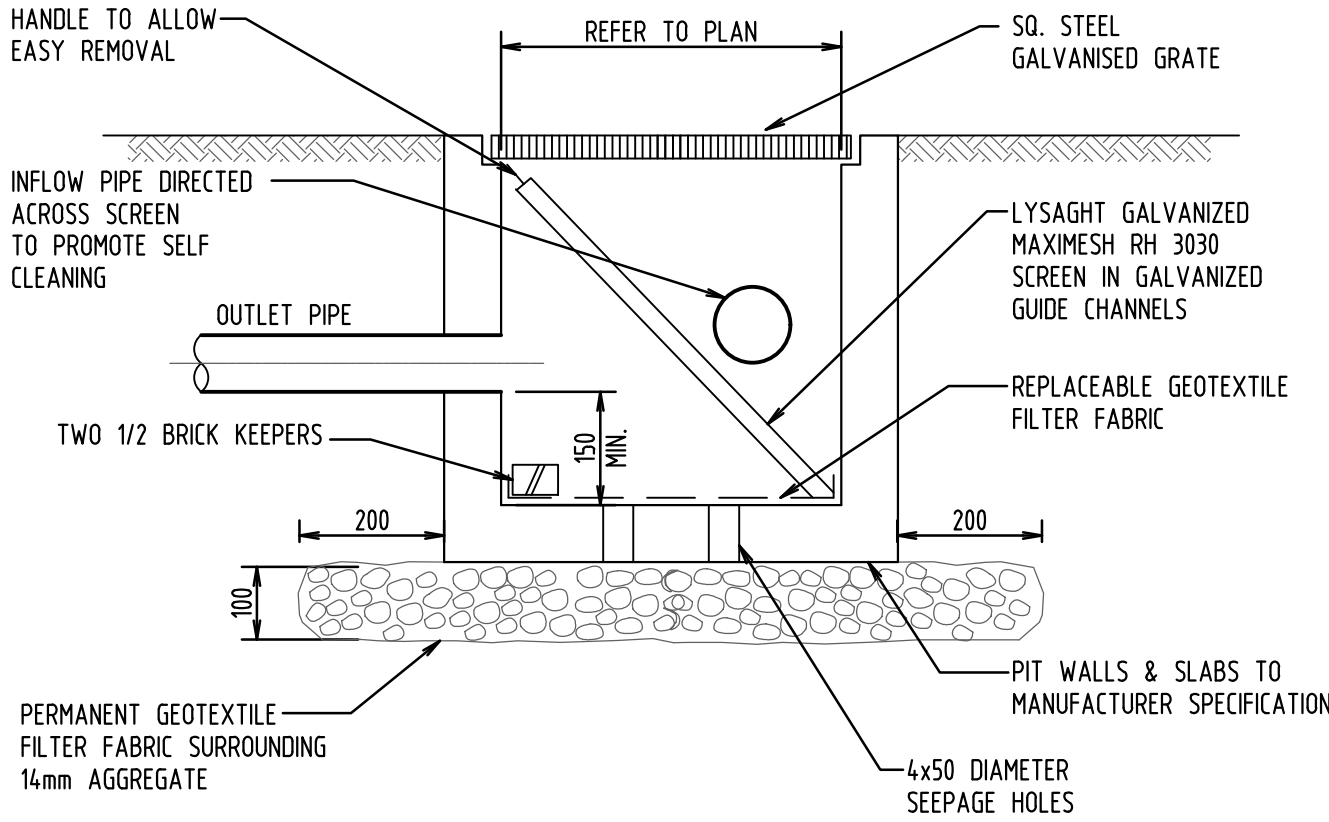

DETAIL
SEDIMENT CONTROL PIT
SCALE 1:20

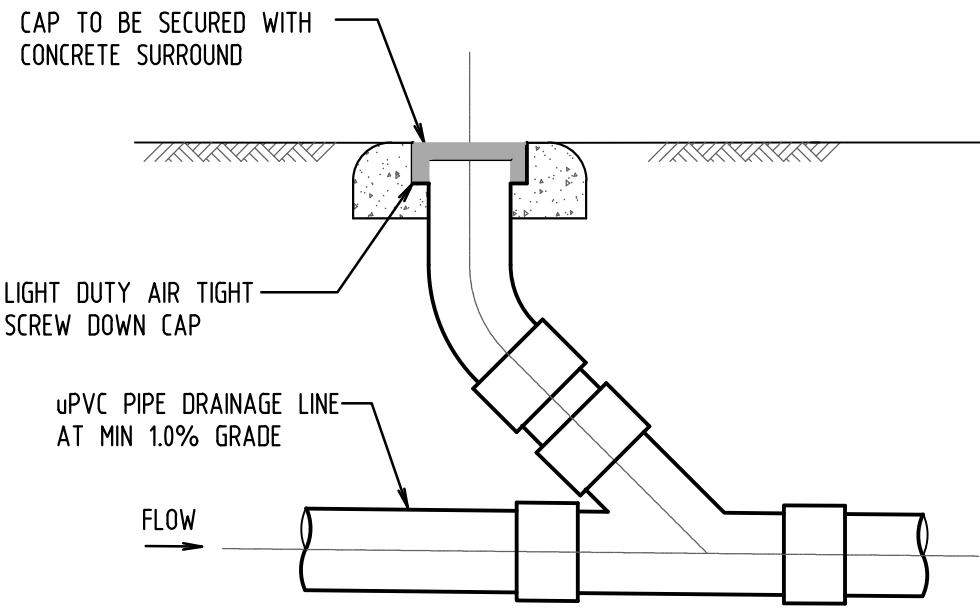

DETAIL
CLEANING EYE
SCALE 1:20

TCSM | ENGINEERING CONSULTANTS

E: info@tcsmconsultants.com
P: 0456 645 770
W: www.tcsmconsultants.com

Rev.	Notes	Issued
A	ISSUED FOR APPROVAL	12.05.2023

Sheet Title
STORM WATER DRAINAGE SECTIONS & DETAILS

Sheet No. SW04 | Revision A | Drawing Status ISSUED FOR APPROVAL

Project No. 23160
Commencement Date 01.05.2023
Scale 1:100 | Size A1

Project
PROPOSED RESIDENTIAL DEVELOPMENT
Address
11B HILL STREET, WARRIEWOOD

Client
FJA DESIGNS

All information contained within this drawing is copyright of TCSM Engineering Consultants. Using or reproducing any part of this drawing without written permission infringes copyright.