

LOCATION MAP



Dwg. No	Drawing Title	Scale	Size
<u>General</u>			
DA01-D11122	Cover Sheet	N/A	A3
DA02-D11122	Site Plan	1:150	A3
<u>Plans</u>			
DA03-D11122	Front Landscape Plan	1:100	A3
DA04-D11122	Rear Landscape Plan	1:100	A3

GENERAL NOTES

These drawings are for Development Application only, not to be used for pricing or construction purposes.

Please note that the plant graphics are indicative sizes only and not an accurate representation at time of purchase.

Do not scale from drawings. All dimensions in mm unless otherwise stated. Figure dimensions shall take precedence over scale.

Contractors must verify all dimensions on site before the commencement of any works.

Service locations on plans are indicative only. *Dangar Barin Smith* accepts no responsibility for the accuracy of service locations shown or for services not shown. It is the responsibility of the contractor to locate and protect all services on site and in adjacent public domain prior to the commencement of work, including contacting *Dial Before You Dig* and performing on site service locations. Any damages to services and associated damages remains the responsibility of the contractor and shall be rectified at no cost to the client or any other party.

Structural Details shall be subject to Engineer's Specifications.

Drainage & Water Feature Details shall be subject to Hydraulic Engineer's Specifications.

All work shall be carried out in accordance with ASA, BCA and Local Government Regulations.

All work shall be carried out in a professional manner by Qualified Tradesman according to Landscape Drawings and Engineer's Specifications.

No responsibility will be taken by *Dangar Barin Smith* for any variations in design, construction method, materials specified, and general specifications without permission from the Project Engineer or Landscape Architect.

This Drawing is copyright to *Dangar Barin Smith*.

GENERAL PLANTING NOTES

Plant Establishment Note
It is recommended that all plants used be subject to an establishment period. During this period maintenance work carried out will include; watering, mowing, weeding, fertilising, pest and disease control, reseeding, returfing, staking and tying, replanting, cultivating, pruning, hedge clipping, aerating, reinstatement of mulch, top dressing and keeping the site neat and tidy.

Plant Quality Note
Plants shall be vigorous, well established, of good form consistent with species or variety, not soft or forced, free from disease and insect pests, with large healthy root systems and no evidence of having been restricted in growth or damaged. Root system shall be well balanced in relation to the size of the plant.

Root Barrier Note
Install "root barrier" or equivalent to manufacturers specifications to protect nearby structures and services.

Temporary Irrigation to Existing Trees Note
Install temporary drip irrigation system under mulch in tree protection zones and water on allotted days.

Site Preparation
All existing plants marked for retention shall be protected for the duration of works. Remove from site all perennial weeds and rubbish before commencing landscape works.
All adjoining property elements including but not limited to buildings, walls, trees and paving to be protected. Damaged elements remain the responsibility of the contractor and shall be rectified at no cost to the client or any other party.
Existing trees to be retained are to be protected to Council and Project Arborist's requirements. No vehicular traffic, stockpiling or storage of materials within Tree Protection Zones (TPZs).

Soilworks
Thoroughly cultivate the subsoil to a depth of 200mm. Supply and install to a depth of 300mm quality garden soil mix to all planting beds and 150mm turf underlay to lawn areas.

Mulch
Supply and install a 75mm layer of hardwood horticultural grade mulch to all planting beds set down 25mm from adjacent paving or garden edge.

Maintenance
All failed or defective plant species to be replaced by landscaper for a 3 months period following completion of work. Further maintenance during and after this period should include watering, weeding, fertilising, pest and disease control, pruning and hedging, reinstatement of mulch and keeping the site neat and tidy.

Date	Notes	Rev.	Receipt
14.03.2025	Development Application	G	Wooster

Important Notes:
Do not scale from drawings. Figure dimensions shall take precedence over scale. All dimensions in mm unless otherwise stated. All discrepancies to be brought to the attention of the Project Landscape Architect.
Contractors must verify all dimensions on site before the commencement of any works.
Contractors shall locate and protect all services prior to construction.
All work shall be carried out in accordance with ASA, BCA and Local Government Regulations, and in a professional manner by Qualified Tradesman according to Landscape Drawings and Engineer's Specifications.
No responsibility will be taken by Dangar Barin Smith for any variations in design, construction method, materials specified, and general specifications without permission from the Project Engineer or Landscape Architect.
This Drawing is copyright to Dangar Barin Smith.



Client: Withers
Project Address: 24 Norma Road
Palm Beach, NSW 2108

Dwg no: DA01-D11122
Title: Cover Page
Stage: Development Application

Drawn by: CT
Checked by: NB
Revision: G
Date: 14.03.2025
Scale: N/A @ A3
Dangar Barin Smith
19 Rochester St, Botany
T (02) 9316 9044
W dangarbarinsmith.com.au
ABN 52 454 816 948

PLANTS SCHEDULE

Botanic Name	Common Name	Mature Height(m)	Pot Size	Qty
Agave attenuata	Foxtail Agave	1-1.2m	300mm	3
Aloe 'Bush Baby Yellow'	Bush Baby Yellow	0.5m	200mm	17
Alpinia nutans	Dwarf Cardamom	1-1.5m	200mm	16
Alpinia zerumbet	Shell Ginger	2-3m	300mm	9
Blechnum nudum	Fishbone Waterfern	0.4-1m	200mm	13
Buckinghamia celsissima	Ivory Curl Tree	5-8m	300L	1
Cissus antarctica	Kangaroo Vine	0.3m	140mm	21
Colocasia esculenta	Taro	1m	300mm	9
Crassula 'Gollum'	Gollum Jade	0.6-1m	200mm	23
Cycas revoluta	Cycad	3-5m	400mm	5
Dichondra repens	Kidneyweed	Groundcover	100mm	2500
Gardenia augusta 'Florida'	Fragrant Gardenia	1m	200mm	13
Heliconia 'Hot Rio Nights'	False Bird of Paradise	4m	45L	5
Howea forsteriana	Kentia Palm	8-12m	Adv.	1
Licuala ramsayi	Australian Fan Palm	3-6m	200mm	7
Ligularia reniformis	Tractor Seat Plant	1m	200mm	16
Lomandra 'Katrinus'	Mat Rush	0.6m	200mm	33
Lomandra 'Nyalla'	Fine Mat Rush	0.6m	200mm	15
Monstera deliciosa	Fruit Salad Plant	Climber	200mm	20

Botanic Name	Common Name	Mature Height(m)	Pot Size	Qty
Muehlenbeckia axillaris	Creeping Wire Vine	Climber	200mm	27
Nerium oleander	Oleander	3-6m	300mm	18
Neomarica gracilis	Brazilian Walking Iris	0.7m	200mm	15
Nymphaea alba	White Water Lily	0.1m	200mm	9
Ophiopogon jaburan	Giant Mondo	0.5m	200mm	15
Pandorea jasminoides	Bower Vine	Climber	200mm	35
Philodendron selloum	Philodendron	1-1.5m	300mm	13
Philodendron Xanadu	Xanadu	0.7m	200mm	15
Philodendron 'Rojo Congo'	Rojo Congo	0.7m	200mm	9
Raphiolepis indica	Indian Hawthorn	2-3m	300mm	11
Rhapis excelsa	Lady Palm	4-5m	400mm	6
Strelitzia nicholai	Giant Bird Of Paradise	5-7m	45L	17
Syzygium 'Resilience'	Resilient Lilly Pilly	3-4m	300mm	8
Syzygium 'Resilience'	Resilient Lilly Pilly	3-4m	45L	5
Trachelospermum asiaticum	Asiatic Jasmine	0.3m	140mm	15
Trachelospermum jasminoides	Star Jasmine	Climber	300mm	15
Viburnum 'Emerald Lustre'	Sweet Viburnum	3-4m	400mm	17
Viola hederacea	Native Violet	Groundcover	100mm	30
Zamia furfuracea	Cardboard Palm	1.5-2m	400mm	8

SITE PLAN

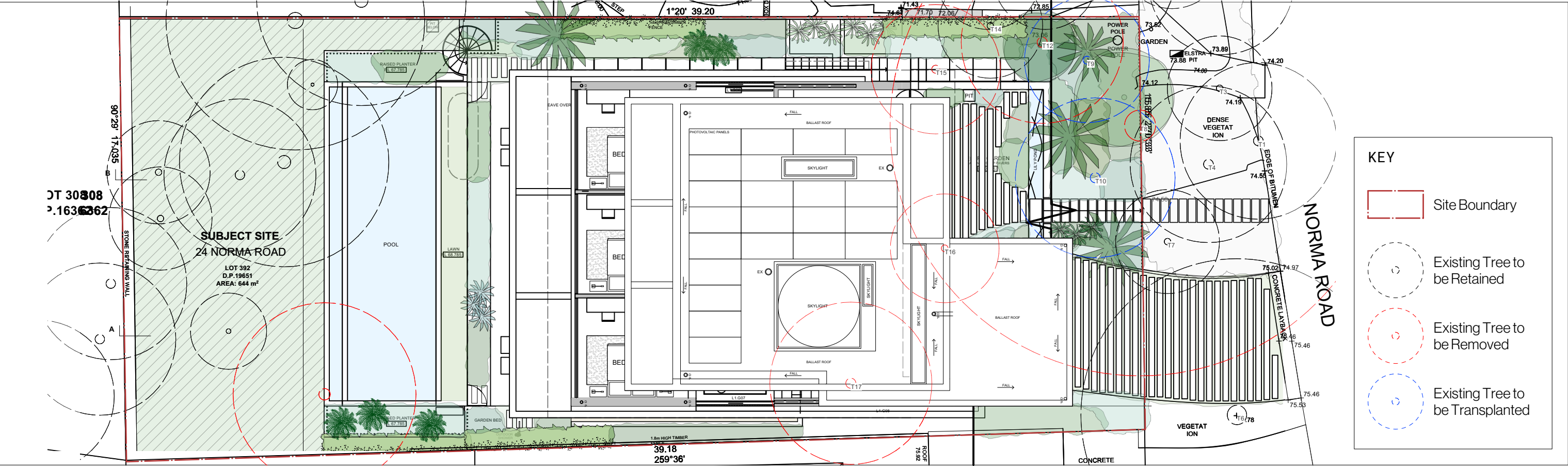

Date	Notes	Rev.	Receipt
14.03.2025	Development Application	G	Wooster

Important Notes:
Do not scale from drawings. Figure dimensions shall take precedence over scale. All dimensions in mm unless otherwise stated. All discrepancies to be brought to the attention of the Project Landscape Architect. Contractors must verify all dimensions on site before the commencement of any works. Contractors shall locate and protect all services prior to construction. All work shall be carried out in accordance with ASA, BCA and Local Government Regulations, and in a professional manner by Qualified Tradesman according to Landscape Drawings and Engineer's Specifications. No responsibility will be taken by Dangar Barin Smith for any variations in design, construction method, materials specified, and general specifications without permission from the Project Engineer or Landscape Architect. This Drawing is copyright to Dangar Barin Smith.



Client: Withers
Project Address: 24 Norma Road
Palm Beach, NSW 2108

Dwg no: DA02-D11122
Title: Site Plan
Stage: Development Application

Drawn by: CT
Checked by: NB
Revision: G
Date: 14.03.2025
Scale: 1:150 @ A3

Dangar Barin Smith
19 Rochester St, Botany
T (02) 9316 9044
W dangarbarin.smith.com.au
ABN 52 454 816 948

Important Notes:

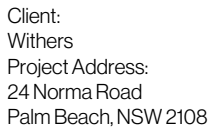

Dwg no: DA03-D11122
Title: Front Landscape Plan

Stage: Development
Application

Drawn by: CT
Checked by: NB
Revision: G
Date: 14.03.2025
Scale: 1:100 @ A3

Dangar Barin Smith
19 Rochester St, Botany
T (02) 9316 9044
W dangarbarinsmith.com.au
ABN 52 454 816 948

DANGAR BARIN SMITH

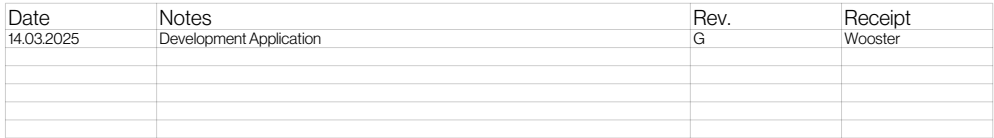

Important Notes:

Do not scale from drawings. Figure dimensions shall take precedence over scale. All dimensions in mm unless otherwise stated. All discrepancies to be brought to the attention of the Project Landscape Architect. Contractors must verify all dimensions on site before the commencement of any works.

All work shall be carried out in accordance with local laws and regulations, and in a professional manner by Qualified Tradesman according to Landscape Drawings and Engineer's Specifications.

No responsibility will be taken by Dangar Brian Smith for any variations in design, construction method, materials specified or general specifications without permission from the Project Engineer or Landscape Architect. This Drawing is copyright to Dangar Brian Smith.



Client:
Withers
Project Address:
24 Norma Road
Palm Beach, NSW 2108

Dwg no: DA04-D11122
Title: Rear Landscape Plan
Stage: Development Application

Drawn by: CT
Checked by: NB
Revision: G
Date: 14.03.2025
Scale: 1:100 @ A3

Dangar Barin Smith
19 Rochester St, Botany
T (02) 9316 9044
W dangarbarinsmith.com.au
ABN 52 454 816 948