

<p><b>GENERAL NOTES:</b></p> <p>1. THE PURPOSE OF THIS PLAN IS TO INDICATE THE CONCEPTUAL PROPOSED BOUNDARY LOCATION FOR A STRATUM SUBDIVISION OF THE SUBJECT LAND. ALL BOUNDARIES SHOWN ARE SUBJECT TO FINAL SURVEY OF THE ELEMENTS OF THE BUILDINGS.</p> <p>2. GLOBAL EASEMENTS FOR ACCESS, SERVICES, ETC ARE TO BE CREATED AS REQUIRED.</p> <p>3. A BUILDING MANAGEMENT STATEMENT IS TO BE REGISTERED WITH THIS SUBDIVISION.</p> <p>4. EXISTING EASEMENTS HAVE NOT BEEN SHOWN.</p>		<p>5. SEE JBW DRAWING "124821\PROPSUBD1" FOR DETAILS OF THE ROAD WIDENING ALONG PITTSWATER ROAD.</p>		<p><b>JBW Surveyors Pty Ltd.</b></p> <p>ACN 001149373</p> <p>Level 7, 376 Bay Street Brighton-Le-Sands NSW 2216</p> <p>Phone: (02) 9335 9700 Fax: (02) 9556 3100</p> <p>www.jbwsurveyors.com.au</p> <p>Liability limited by a scheme approved under Professional Standards Legislation.</p>		<p>CLIENT: MERITON GROUP</p> <p>TITLE: PLAN SHOWING THE CONCEPT OF THE PROPOSED STRATUM SUBDIVISION OF THE PROPOSED LOT 100 OF A SUBDIVISION OF LOTS A &amp; B DP371110, LOT A DP339410, LOTS 10 &amp; 11 DP231418, LOT 1 DP504212, LOT A DP416469, LOTS 1 &amp; 3 DP307937, LOT 7 SECTION 16 DP8172, LOT 1 DP209503 &amp; LOTS 1,2 &amp; 3 DP212382.</p> <p>LOCALITY: DEE WHY LGA: NORTHERN BEACHES</p>		<p>SHEET No 01 OF 07 SHEETS</p> <p>DRAFTED: JAC SCALE: 1:400 @ A2</p> <p>CHECKED: WDT DATE: 03/08/2017</p> <p>PLAN REF: 124821/DA-STRATUMSUBD</p> <p>PROJECT: DEE WHY - OAKS AVE</p>	
---	--	--	--	---	--	--	--	--	--











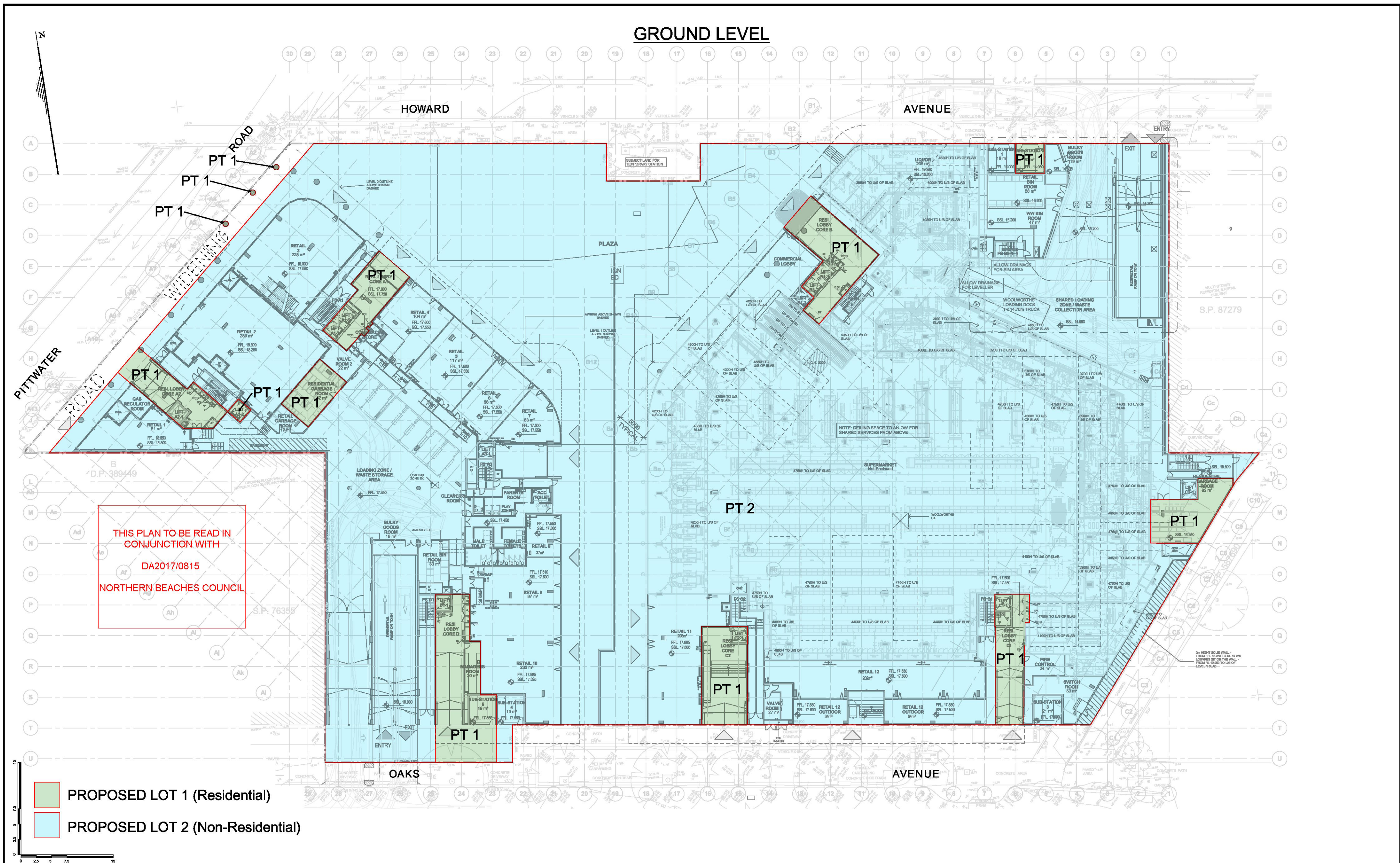

<b>GENERAL NOTES:</b> 1. THE PURPOSE OF THIS PLAN IS TO INDICATE THE CONCEPTUAL PROPOSED BOUNDARY LOCATION FOR A STRATUM SUBDIVISION OF THE SUBJECT LAND. ALL BOUNDARIES SHOWN ARE SUBJECT TO FINAL SURVEY OF THE ELEMENTS OF THE BUILDINGS. 2. GLOBAL EASEMENTS FOR ACCESS, SERVICES, ETC ARE TO BE CREATED AS REQUIRED. 3. A BUILDING MANAGEMENT STATEMENT IS TO BE REGISTERED WITH THIS SUBDIVISION. 4. EXISTING EASEMENTS HAVE NOT BEEN SHOWN.		<b>JBW Surveyors Pty Ltd.</b> ACN 001149373 Level 7, 376 Bay Street Brighton-Le-Sands NSW 2216 Phone: (02) 9335 9700 Fax: (02) 9556 3100 www.jbwsurveyors.com.au Liability limited by a scheme approved under Professional Standards Legislation.		<b>CLIENT: MERITON GROUP</b> <b>TITLE:</b> PLAN SHOWING THE CONCEPT OF THE PROPOSED STRATUM SUBDIVISION OF THE PROPOSED LOT 100 OF A SUBDIVISION OF LOTS A & B DP371110, LOT A DP339410, LOTS 10 & 11 DP231418, LOT 1 DP504212, LOT A DP416469, LOTS 1 & 3 DP307937, LOT 7 SECTION 16 DP8172, LOT 1 DP209503 & LOTS 1,2 & 3 DP2123821. <b>LOCALITY:</b> DEE WHY <b>LGA:</b> NORTHERN BEACHES		<b>SHEET No 04 OF 07 SHEETS</b> <b>DRAFTED:</b> JAC <b>SCALE:</b> 1:400 @ A2 <b>CHECKED:</b> WDT <b>DATE:</b> 03/08/2017 <b>PLAN REF:</b> 124821/DA-STRATUMSUBD <b>PROJECT:</b> DEE WHY - OAKS AVE	
--	--	--	--	--	--	--	--



## N

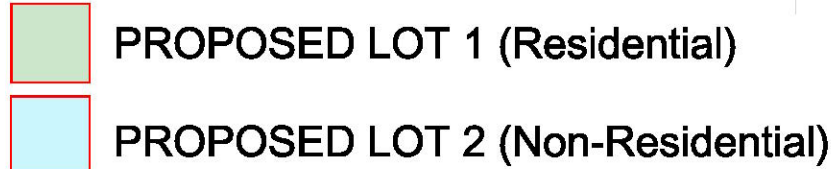

1. THE PURPOSE OF THIS PLAN IS TO INDICATE THE CONCEPTUAL PROPOSED BOUNDARY LOCATION FOR A STRATUM SUBDIVISION OF THE SUBJECT LAND. ALL BOUNDARIES SHOWN ARE SUBJECT TO FINAL SURVEY OF THE ELEMENTS OF THE BUILDINGS.
2. GLOBAL EASEMENTS FOR ACCESS, SERVICES, ETC ARE TO BE CREATED AS REQUIRED.
3. A BUILDING MANAGEMENT STATEMENT IS TO BE REGISTERED WITH THIS SUBDIVISION.
4. EXISTING EASEMENTS HAVE NOT BEEN SHOWN.

5. SEE JBW DRAWING "124821\PROPSUBD1" FOR DETAILS OF THE ROAD WIDENING ALONG PITTWATER ROAD.



ACN 001149373

Level 7, 376 Bay Street Brighton-Le-Sands NSW 2216  
Phone: (02) 9335 9700 Fax: (02) 9556 3100  
[www.jbwsurveyors.com.au](http://www.jbwsurveyors.com.au)

**Liability limited by a scheme approved under Professional Standards Legislation.**

CLIENT: MERITON GROUP

**TITLE:** PLAN SHOWING THE CONCEPT OF THE PROPOSED STRATUM SUBDIVISION OF THE PROPOSED LOT 100 OF A SUBDIVISION OF LOTS A & B DP371110, LOT A DP339410, LOTS 10 & 11 DP231418, LOT 1 DP504212, LOT A DP416469, LOTS 1 & 3 DP307937, LOT 7 SECTION 16 DP8172, LOT 1 DP209503 & LOTS 1,2 & 3 DP212382).

LOCALITY: DEE WHY

LGA: NORTHERN BEACHES

SHEET No 05 OF 07 SHEETS

<u>DRAFTED:</u>	JAC	<u>SCALE:</u>	1:400 @ A2
-----------------	-----	---------------	------------

<u>CHECKED:</u> WDT	<u>DATE:</u> 03/08/2017
---------------------	-------------------------

PLAN REF: 124821/DA-STRATUMSUBD

PROJECT: DEE WHY - OAKS AVE



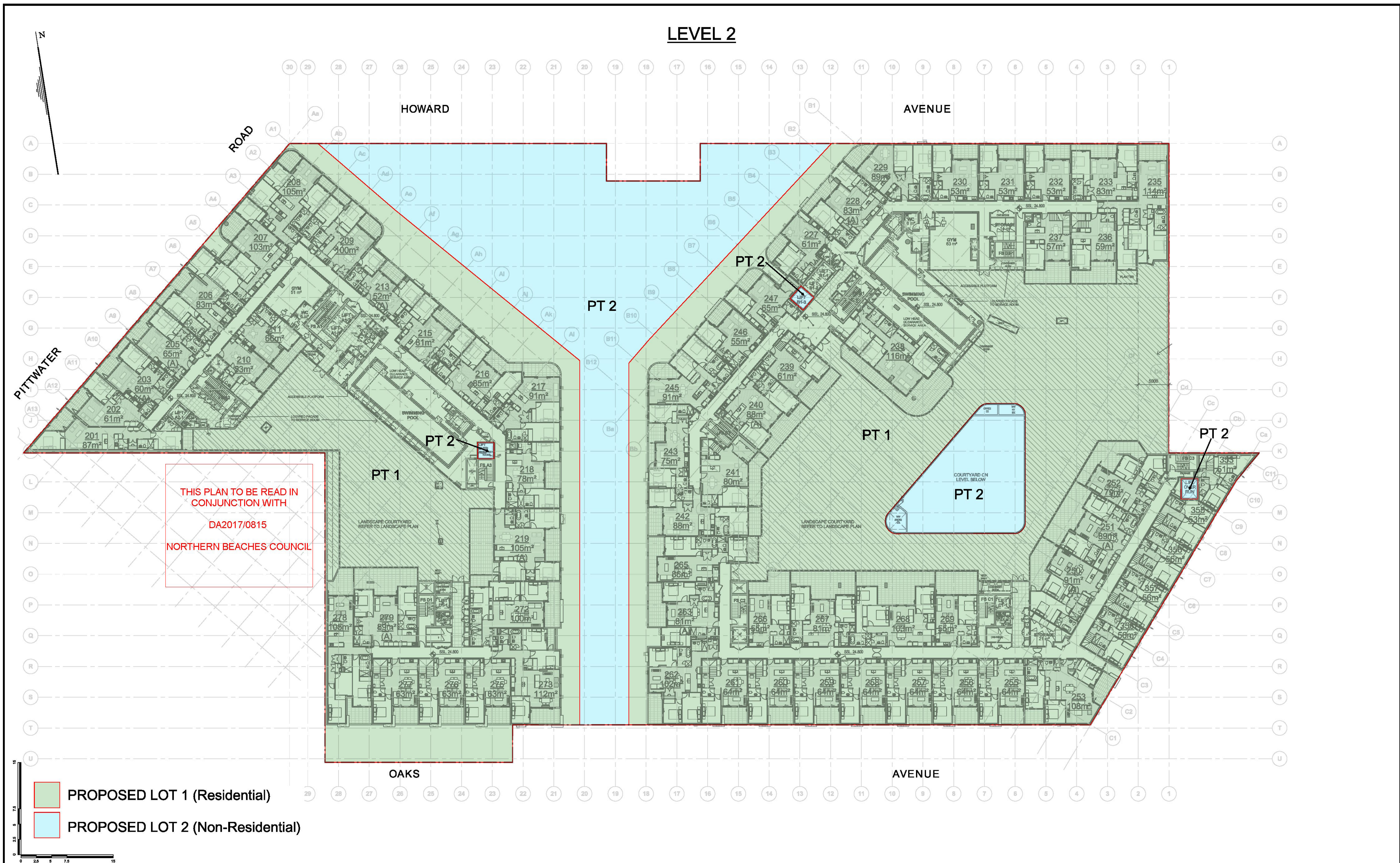

<b>GENERAL NOTES:</b> 1. THE PURPOSE OF THIS PLAN IS TO INDICATE THE CONCEPTUAL PROPOSED BOUNDARY LOCATION FOR A STRATUM SUBDIVISION OF THE SUBJECT LAND. ALL BOUNDARIES SHOWN ARE SUBJECT TO FINAL SURVEY OF THE ELEMENTS OF THE BUILDINGS. 2. GLOBAL EASEMENTS FOR ACCESS, SERVICES, ETC ARE TO BE CREATED AS REQUIRED. 3. A BUILDING MANAGEMENT STATEMENT IS TO BE REGISTERED WITH THIS SUBDIVISION. 4. EXISTING EASEMENTS HAVE NOT BEEN SHOWN.		 <b>JBW Surveyors Pty Ltd.</b> ACN 001149373 Level 7, 376 Bay Street Brighton-Le-Sands NSW 2216 Phone: (02) 9335 9700 Fax: (02) 9556 3100 <a href="http://www.jbwsurveyors.com.au">www.jbwsurveyors.com.au</a> Liability limited by a scheme approved under Professional Standards Legislation.		CLIENT: MERITON GROUP TITLE: PLAN SHOWING THE CONCEPT OF THE PROPOSED STRATUM SUBDIVISION OF THE PROPOSED LOT 100 OF A SUBDIVISION OF LOTS A & B DP371110, LOT A DP339410, LOTS 10 & 11 DP231418, LOT 1 DP504212, LOT A DP416469, LOTS 1 & 3 DP307937, LOT 7 SECTION 16 DP8172, LOT 1 DP209503 & LOTS 1,2 & 3 DP212382. LOCALITY: DEE WHY LGA: NORTHERN BEACHES		SHEET No 06 OF 07 SHEETS DRAFTED: JAC SCALE: 1:400 @ A2 CHECKED: WDT DATE: 03/08/2017 PLAN REF: 124821/DA-STRATUMSUBD PROJECT: DEE WHY - OAKS AVE	
--	--	---	--	---	--	---	--



LEVEL 3 & ABOVE

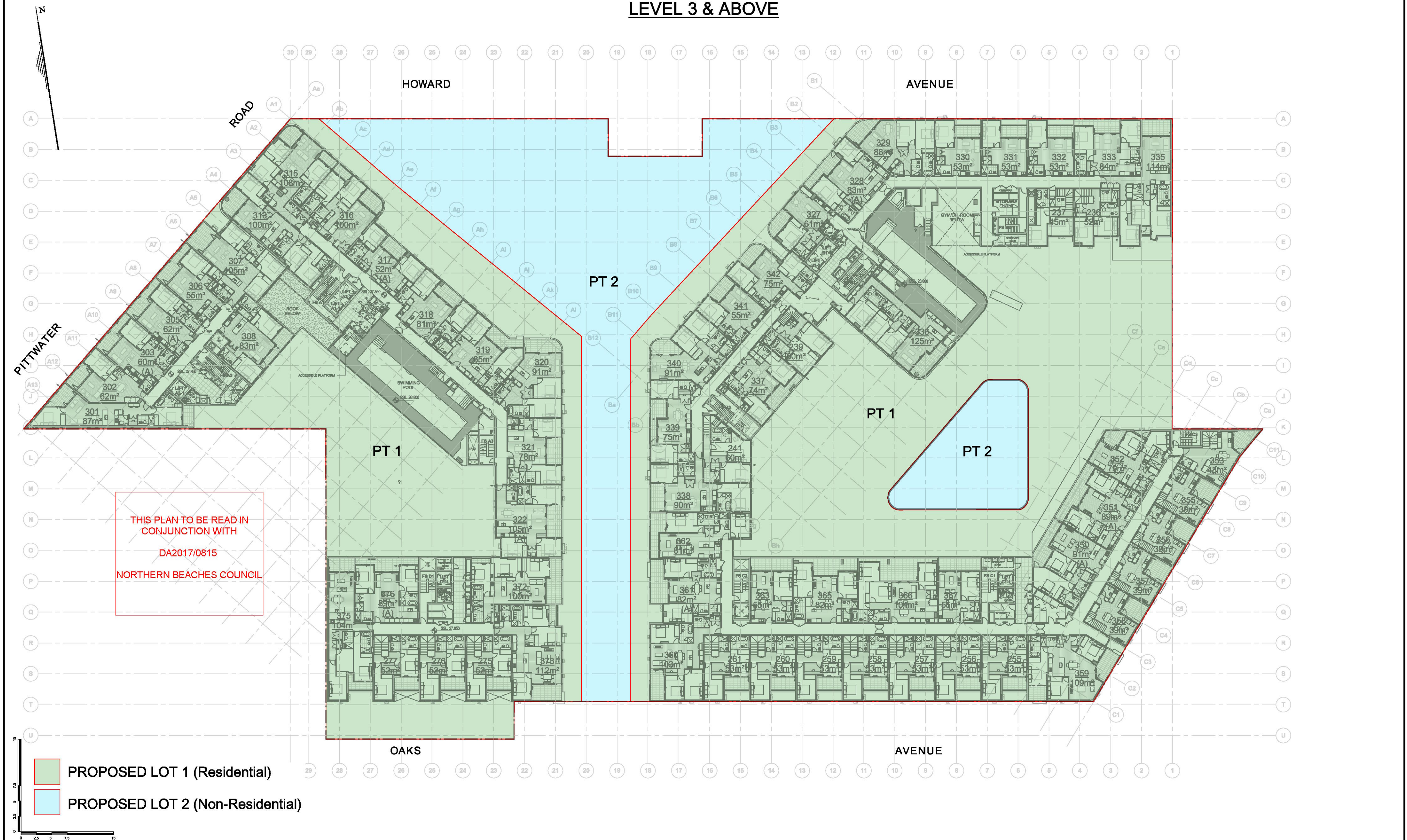

**GENERAL NOTES:**

1. THE PURPOSE OF THIS PLAN IS TO INDICATE THE CONCEPTUAL PROPOSED BOUNDARY LOCATION FOR A STRATUM SUBDIVISION OF THE SUBJECT LAND. ALL BOUNDARIES SHOWN ARE SUBJECT TO FINAL SURVEY OF THE ELEMENTS OF THE BUILDINGS.
2. GLOBAL EASEMENTS FOR ACCESS, SERVICES, ETC ARE TO BE CREATED AS REQUIRED.
3. A BUILDING MANAGEMENT STATEMENT IS TO BE REGISTERED WITH THIS SUBDIVISION.
4. EXISTING EASEMENTS HAVE NOT BEEN SHOWN.

**JBW Surveyors Pty Ltd.**  
ACN 001149373  
Level 7, 376 Bay Street Brighton-Le-Sands NSW 2216  
Phone: (02) 9335 9700 Fax: (02) 9556 3100  
[www.jbwsurveyors.com.au](http://www.jbwsurveyors.com.au)

Liability limited by a scheme approved under Professional Standards Legislation.

CLIENT: MERITON GROUP	
TITLE: PLAN SHOWING THE CONCEPT OF THE PROPOSED STRATUM SUBDIVISION OF THE PROPOSED LOT 100 OF A SUBDIVISION OF LOTS A & B DP371110, LOT A DP339410, LOTS 10 & 11 DP231418, LOT 1 DP504212, LOT A DP416469, LOTS 1 & 3 DP307937, LOT 7 SECTION 16 DP8172, LOT 1 DP209503 & LOTS 1,2 & 3 DP212382.	
LOCALITY: DEE WHY	LGA: NORTHERN BEACHES

SHEET No 07 OF 07 SHEETS	
DRAFTED: JAC	SCALE: 1:400 @ A2
CHECKED: WDT	DATE: 03/08/2017
PLAN REF: 124821/DA-STRATUMSUBD	
PROJECT: DEE WHY - OAKS AVE	