

thomsonkane

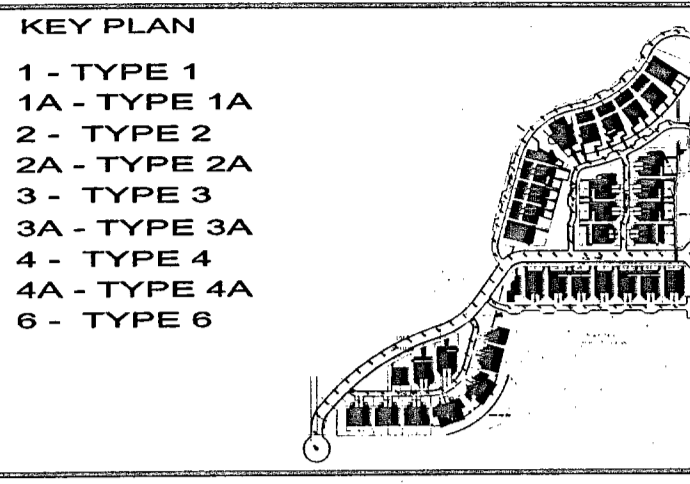
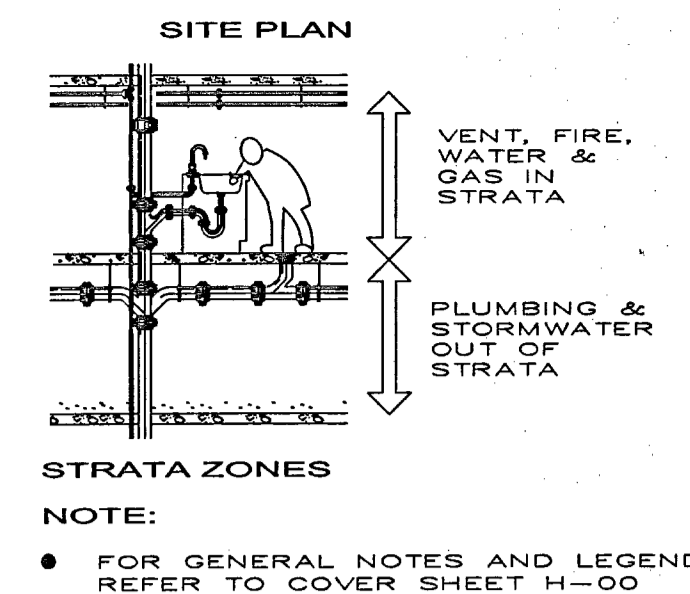

REV	ISSUE	BY	CHKD	DATE
A	PRELIMINARY ISSUE	AM	AT	07.06.06

DISCIPLINE	DRG NO.	REV	REASON FOR ISSUE
ARCHITECTURAL	21.04.05		PRELIMINARY AUTHORIZATION
STRUCTURAL			
LANDSCAPE			
ELECTRICAL			
CIVIL	26.05.06		VERIFICATION OF LATEST AMENDMENT

**HYDRAULIC ENGINEERS:**  
**thomsonkane**  
 Consulting Hydraulic and Fire Engineers  
 281 Pacific Highway, North Sydney NSW 2060  
 Phone: (02) 9955 0788 Fax: (02) 9954 5532  
 Email: h@thomsonkane.com.au  
 WWW.THOMSONKANE.COM.AU  
 ACH 109 903 849  
 THIS DRAWING IS COPYRIGHT ©

**ARCHITECTS:**  
**Denis Leech Associates P/L**  
 350 George Street, Sydney NSW 2000  
 Tel: (02) 9997 7288 Fax: (02) 9997 3164

**MASTER PLANNING:**  
**Wolski, Lycenko & Brechnock**  
 115 Military Road, Neutral Bay NSW 2089  
 Tel: (02) 9953 8477 Fax: (02) 9953 9557

**ELECTRICAL:**  
**WEBB AUSTRALIA**  
 37 Ryde Road, Pymble NSW 2073  
 Tel: (02) 9418 1444 Fax: (02) 9418 1191

**ENVIRONMENTAL:**  
**WP Brown & Partners Pty Ltd**  
 Level 2, 82 Waterloo Road  
 Macquarie Park NSW 2113  
 Tel: (02) 9900 1000 Fax: (02) 9900 1099

**LANDSCAPE:**  
**Place Planning & Design P/L**  
 Suite 10, Norberry Terrace, 177 Pacific Hwy  
 North Sydney NSW 2060  
 Tel: (02) 9959 5021 Fax: (02) 9959 5802

**PROJECT:**  
**PROPOSED RESIDENTIAL SUBDIVISION - 5 WARRIEWOOD VALLEY, WARRIEWOOD NSW**

**TITLE: HYDRAULIC SERVICES**  
**TYPICAL HOUSE TYPE 3, 3A, 4, 4A SEWER, WATER & GAS**

SCALE: 1:100	PROJECT No: 4733-2H	CAD REPT: T: TKNEW
DATE: MAY '06	DRAWING NUMBER: H-05	REVISION: A
DRAWN BY: AT		
CHKD BY: AT		

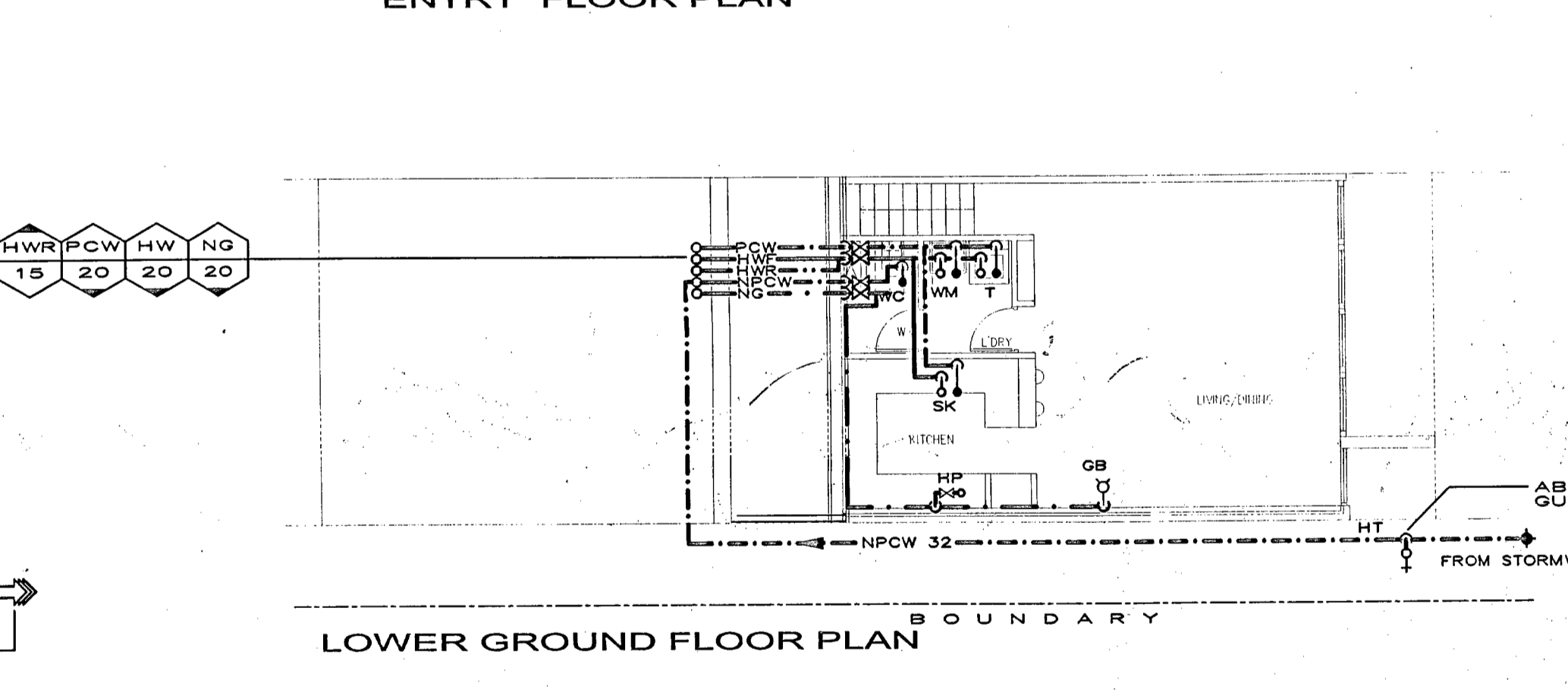
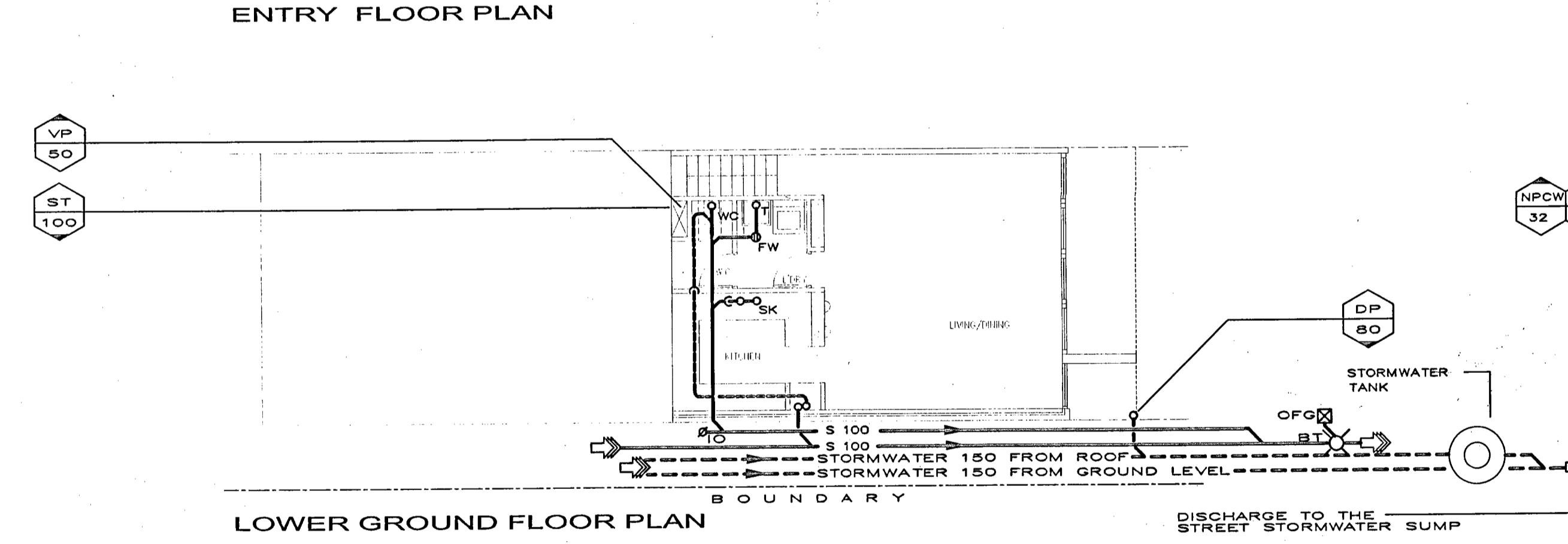
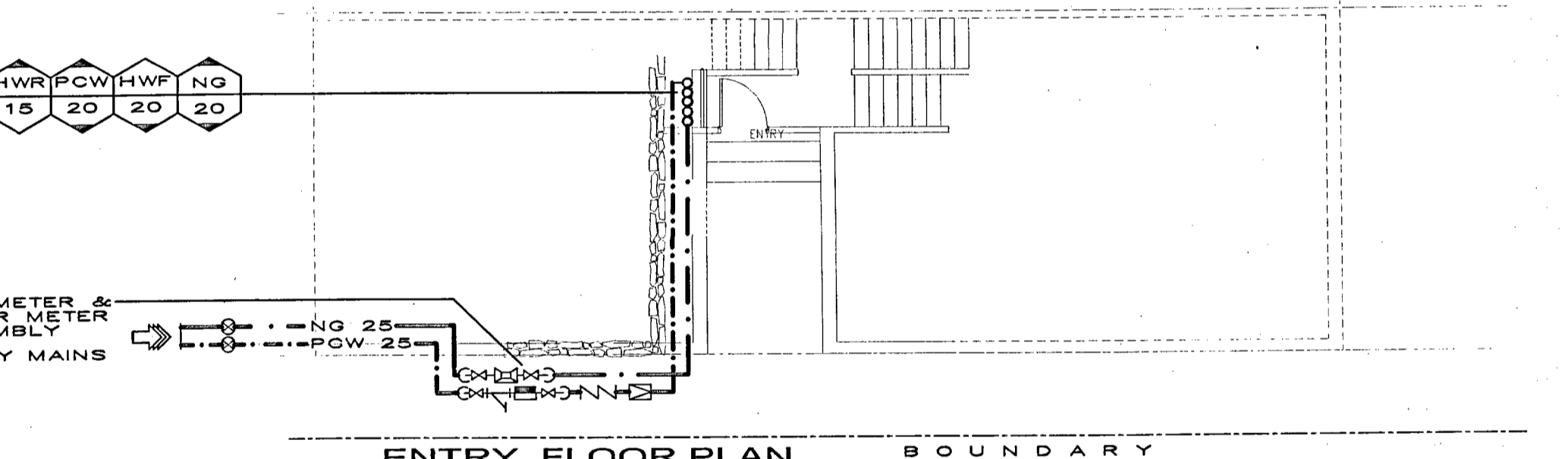
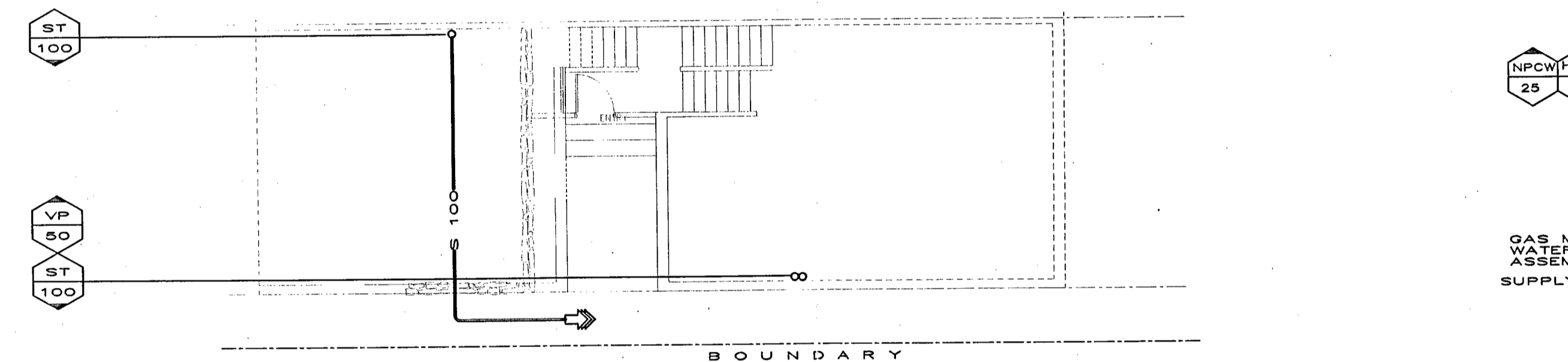
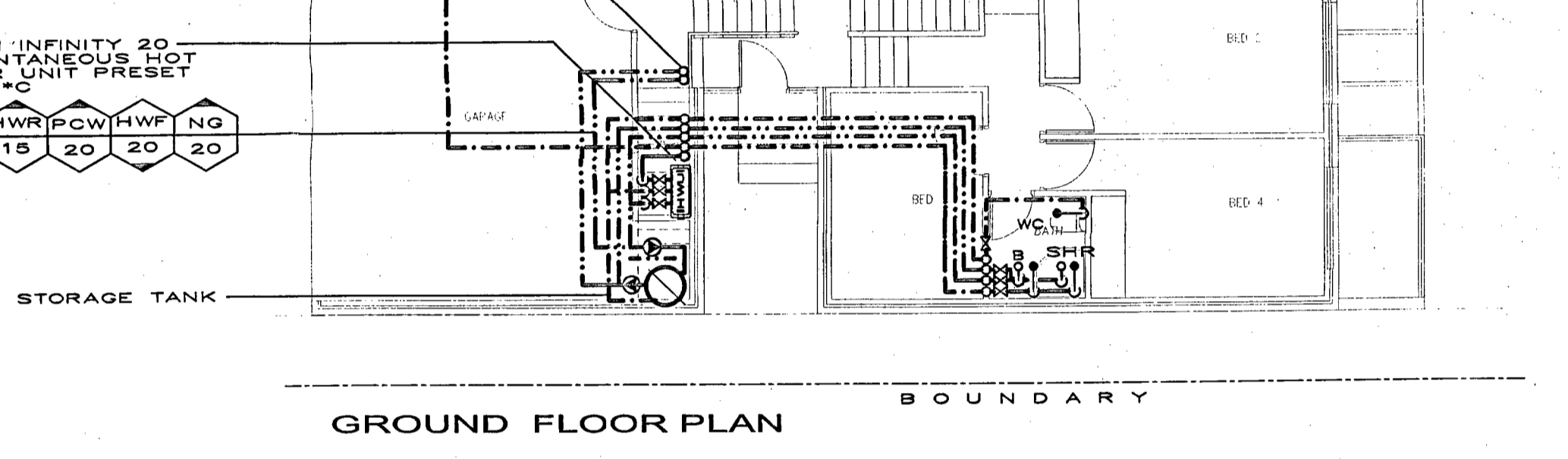
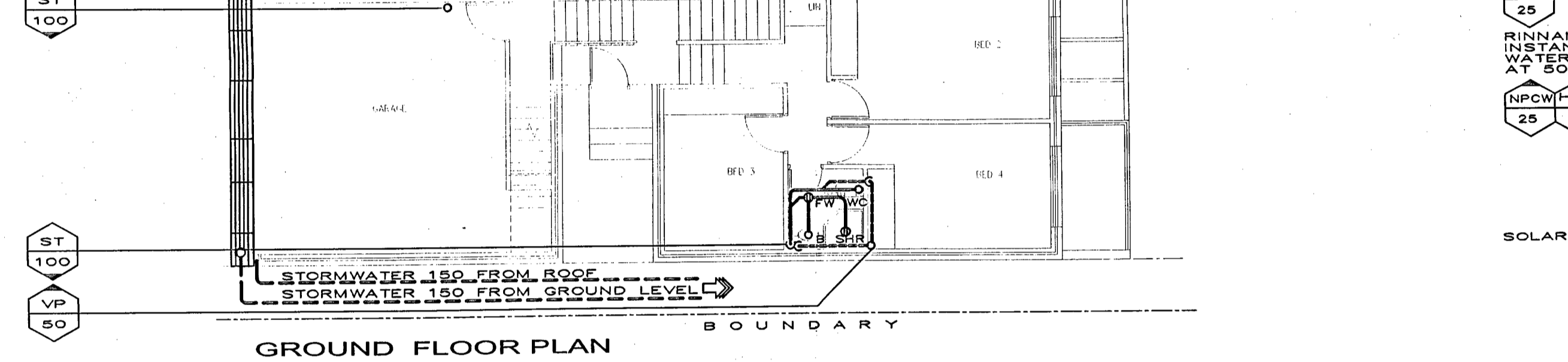
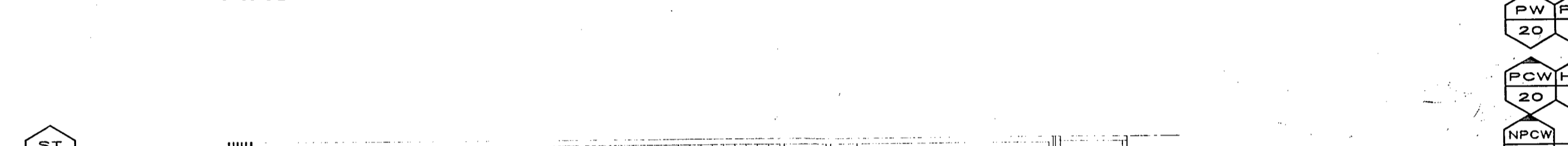
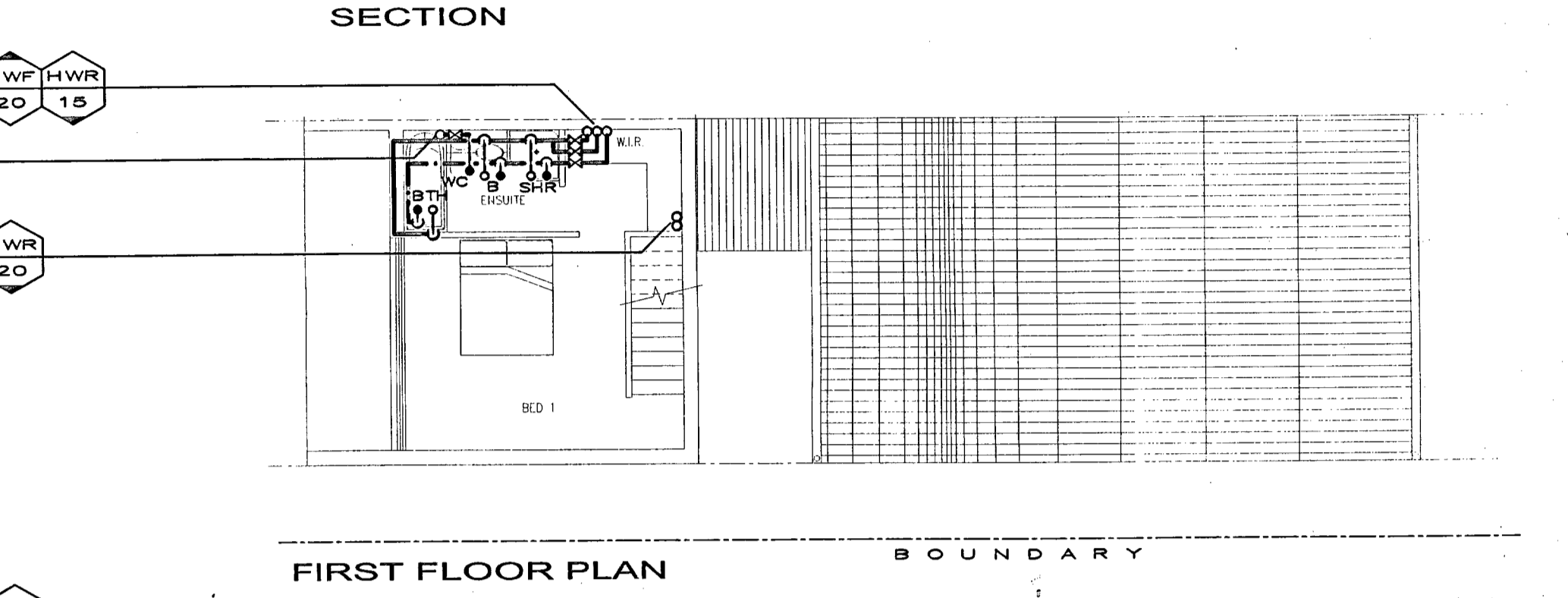
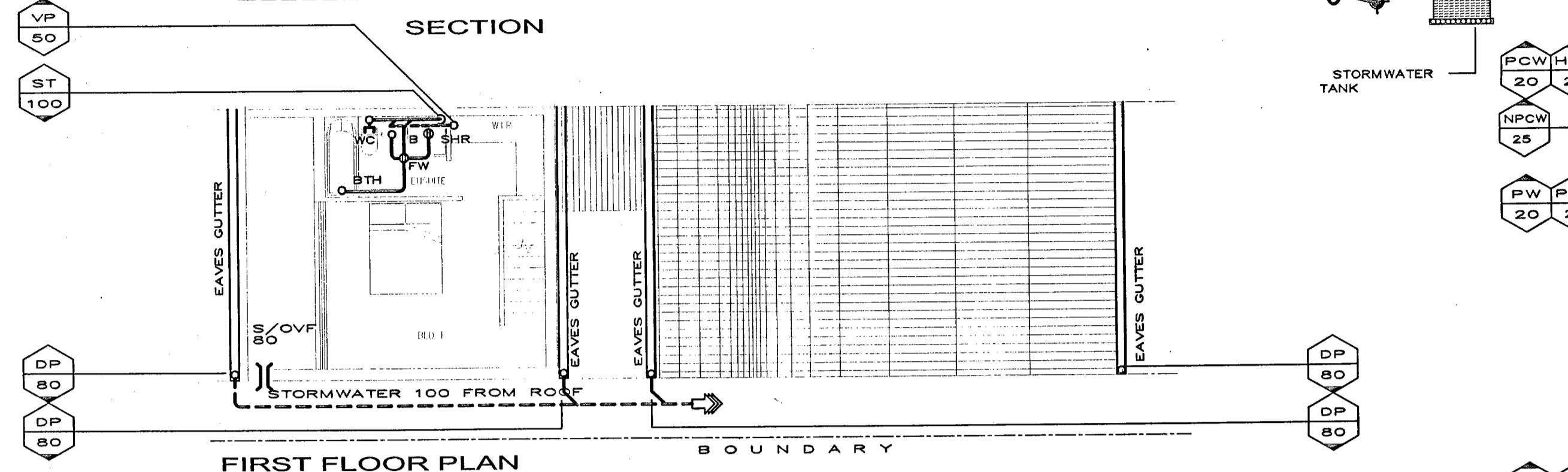
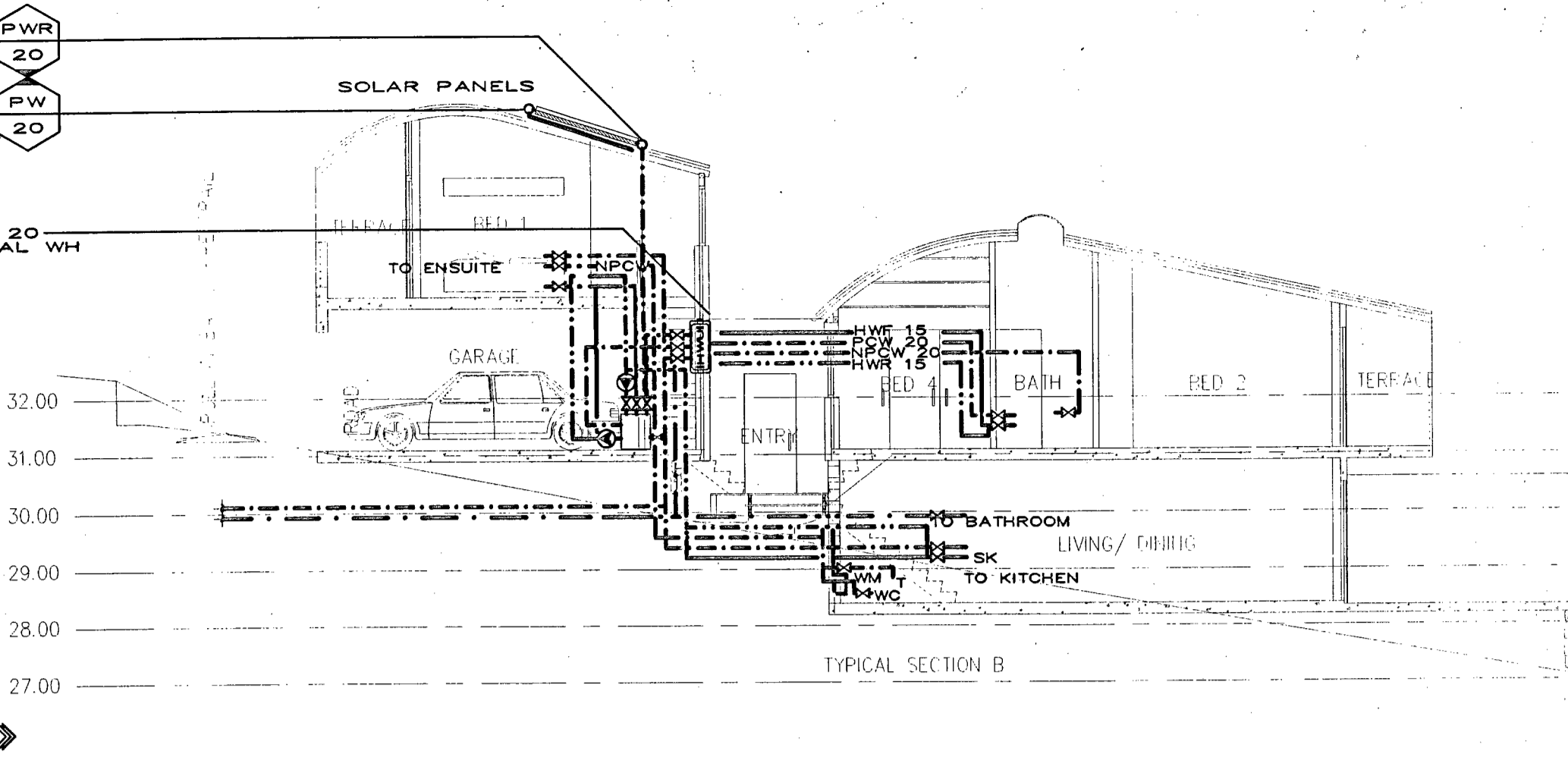
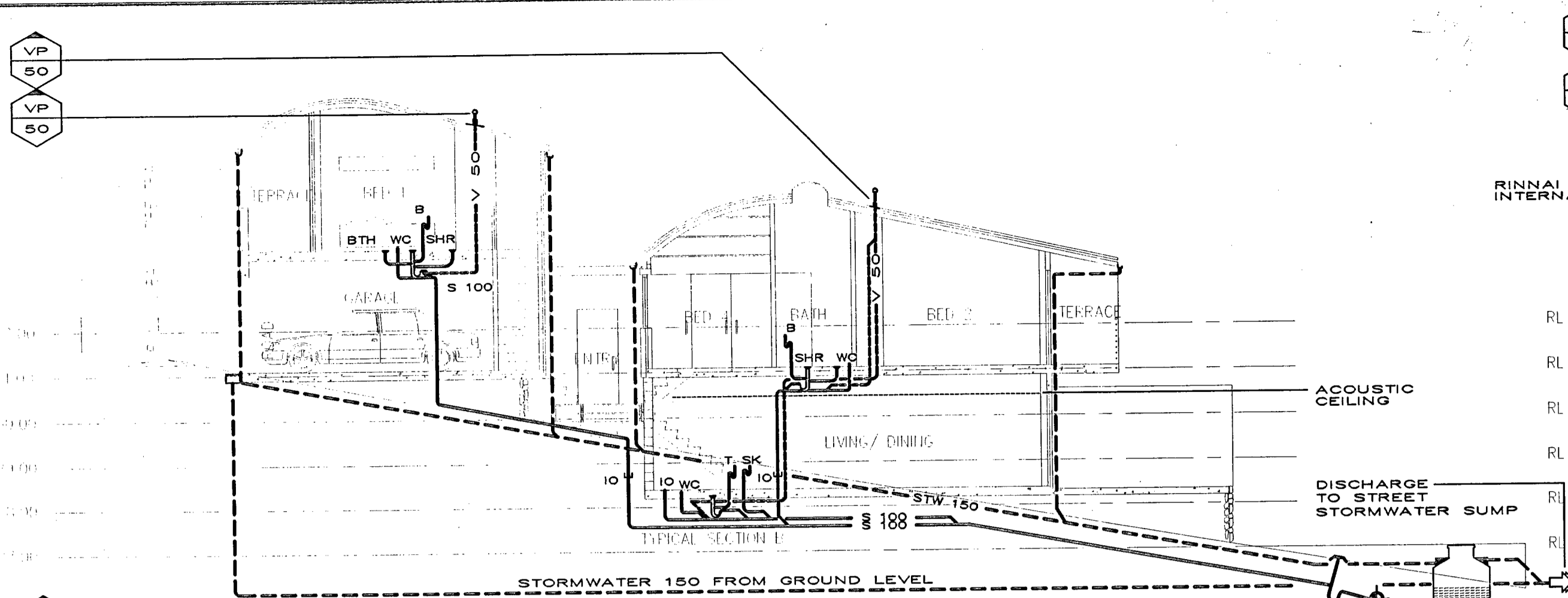

**SANITARY PLUMBING DRAINAGE**

**WATER & GAS SERVICES**