

CONCRETE QUALITY FOR POOLS	
LOCATION	f'c
STANDARD IN GROUND	25 MPa
IN GROUND - WITHIN ONE KILOMETRE OF SEA	32 MPa
MORE THAT 400mm OUT OF GROUND	32 MPa
MORE THAT 400mm OUT OF GROUND - Within 1km of sea	40 MPa
SALINE: LESS THAN 16 dS/M (ECe)	32 MPa
SALINE: MORE THAN 16 dS/M (ECe)	40 MPa

CONCRETE QUALITY FOR POOLS	
LOCATION	f'c
STANDARD IN GROUND	25 MPa
IN GROUND - WITHIN ONE KILOMETRE OF SEA	32 MPa
MORE THAT 400mm OUT OF GROUND	32 MPa
MORE THAT 400mm OUT OF GROUND - Within 1km of sea	40 MPa
SALINE: LESS THAN 16 dS/M (ECe)	32 MPa
SALINE: MORE THAN 16 dS/M (ECe)	40 MPa

NOTE:
PROVIDE 2N12 CROSS BARS
EACH WAY, TOP OVER EACH
BORED PIER FOR THE BASE
OF THE POOL

NOTE: ALL BASE OF POOL TO BE
FOUNDED ON SAME STRATA,
PROVIDE ADDITIONAL 450dia. PIERS
@ 1500 CTS IF REQUIRED.

450Ø REINFORCED CONCRETE
BORED PIERS AT MAXIMUM
1500mm CTS. 6N20 + R10-200
TIES. 40mm COVER TYPICAL
FOR ALL PIERS OUT OF
GROUND

POOL CAPACITY 46897 litres

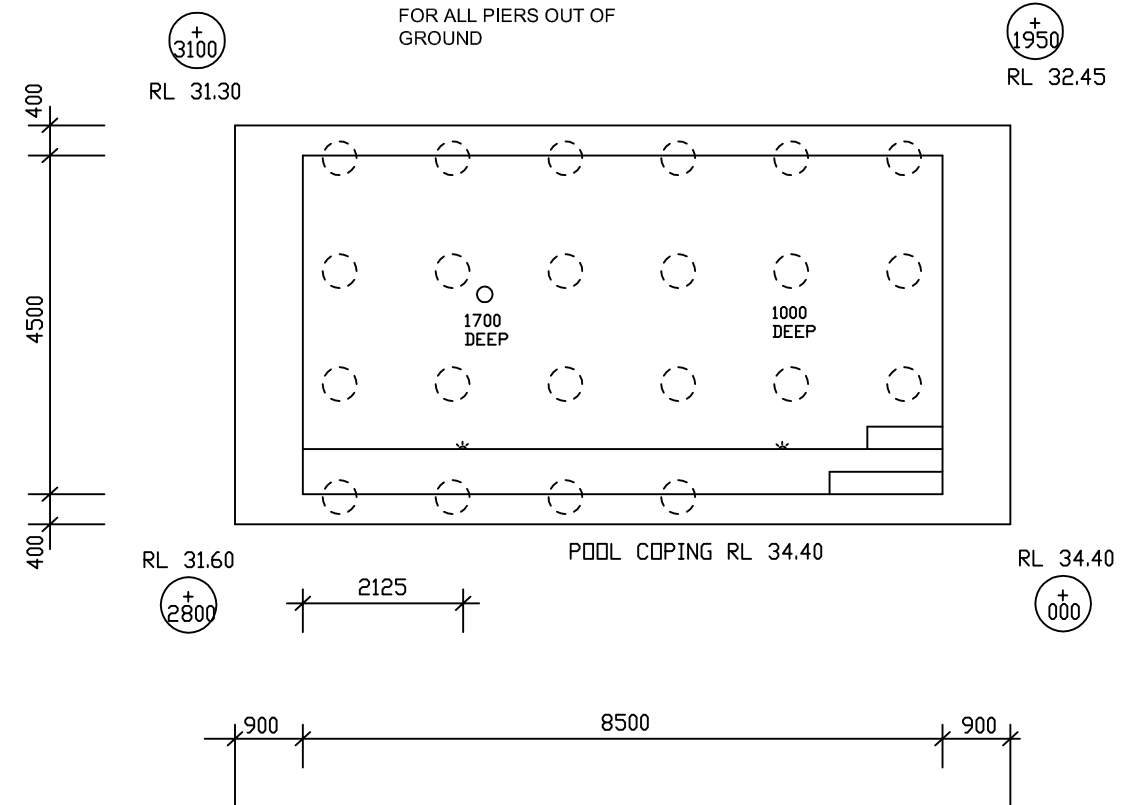

NOTE: FULL POOL S12 VERT BARS @ 200CTS each way vert and horiz, 2 LAYERS FOR ENTIRE POOL STRUCTURE
ALL BASE OF POOL IS TO BE FOUNDED ON ROCK STRATA, ANCHOR MIN 600 INTO ROCK
PROVIDE 450dia PIERS @ 1500 CTS TO COMPLETE BASE OF POOL.

NOTE: USE 32mpa CONCRETE

POOL PLAN

SCALE: 1:100

NOTES:

1. $f'_c = 32$ Mpa CONCRETE. DESIGN SUITABLE FOR CLASS M SITE CLASSIFIED UNDER AS2870-1996
2. SUPPORTING FOUNDATION MATERIAL TO BE STIFF CLAY OF UNIFORM MOISTURE CONTENT WITH SAFE BEARING CAPACITY OF 300 kPa. (POOL BASE TO BE FOUND INTO VIRGIN MATERIAL.)
3. IF POOL IS TO BE FOUND IN 'H' CLASS MATERIAL, DROPPERS ARE TO BE PROVIDED RIGHT AROUND POOL.
4. TYPICAL WALL & FLOOR REINFORCEMENT TO BE S12-300 IN EACH DIRECTION. WHERE POOL WALL EXTENDS MORE THAN 600mm ABOVE UNDISTURBED SUBSOIL (300kpa MATERIAL) AND/OR WHERE DEPTH OF EXCAVATION IN OTHER THAN ROCK EXCEEDS MORE THAN 1800mm, PROVIDE ADDITIONAL DROPPERS (S12-300 VERTICAL TO BE 450mm FROM TOP OF WALL & 1200mm INTO BASE OF POOL.)
5. PROVIDE AN EXPANSION JOINT BETWEEN THE SWIMMING POOL STRUCTURE AND ANY OTHER STRUCTURE SUCH AS CONCRETE WALKWAYS, FOOTING, ETC

NOTE; PROVIDE EXPANSION JOINT
BETWEEN POOL STRUCTURE AND ANY
OTHER STRUCTURE.

NOTE; PROVIDE S12 VERTS BARS @
150 CTS WHERE POOL WALL
ADJACENT TO ANY STRUCTURE.

NOTE; HOUSE BUILDER/ OWNER TO
ENSURE HOUSE FOOTINGS ARE
FOUNDED BELOW ZONE OF
INFLUENCE OF POOL EXCAVATION

NOTE: EXTENDED WALKWAYS GREATER THAN 1000 MUST BE FOUNDED ON SAME STRATA AS BASE OF POOL. PROVIDE ADDITIONAL 450dia PIERS @ 1800 CTS REQUIRED.

DIAL BEFORE YOU DIG

NOTES:
BUILDER TO ENSURE THE EXACT LOCATIONS
OF THE SERVICES PRIOR TO THE START OF
ANY CONSTRUCTION WORK. BUILDER MUST
CALL 'DIAL BEFORE YOU DIG' TO THE TO
CONFIRM THE THE LOCATIONS OF THE
EXISTING SERVICES.

IN THE EVENT THAT ANY SERVICES MAY BE AFFECTED WITH STRUCTURAL WORK, STRUCTURAL ENGINEER TO BE NOTIFIED AND CONSULTED IMMEDIATELY FOR REVIEWING THE STRUCTURAL DETAILS.

NOTE:
© Copyright. This plan and design is the property of HYTEN ENGINEERING, and must not be used, reproduced or copied wholly or in part without written permission from the company.
Do not scale drawings, use figured dimensions only.
WHEN IN DOUBT, ASK. It is your responsibility.
If HYTEN Engineering has not been engaged to carry out structural inspections, no certificate will be issued.

Rev.	Description	By.	App.	Date
B	Relocate pool 1325 to rear	JF	JF	12.02.2019
A	ISSUED FOR C.C.	JF	JF	5.12.2018



**AROONA POOLS
SPAS P/L**
2801/225 WALKER ST,
NORTH SYDNEY. NSW
Ph: 9460 0737 Lic 298081c

Client **JOHNSTON**

Project 4 PHYLLIS LANE,
NORTH CURL CURL, NSW

Title	IN-GROUND CONCRETE SWIMMING POOL SITE PLAN
-------	-----------------------------------------------

ISSUED FOR
CONSTRUCTION CERTIFICATE

Project Number
19H3007

Design	Drawn
M.A.	J.F.

Drawing Number
S02

Note- The pool pump must be housed in a soundproofed enclosure
Acoustic box is 900mm away from the top of the boundary fence.

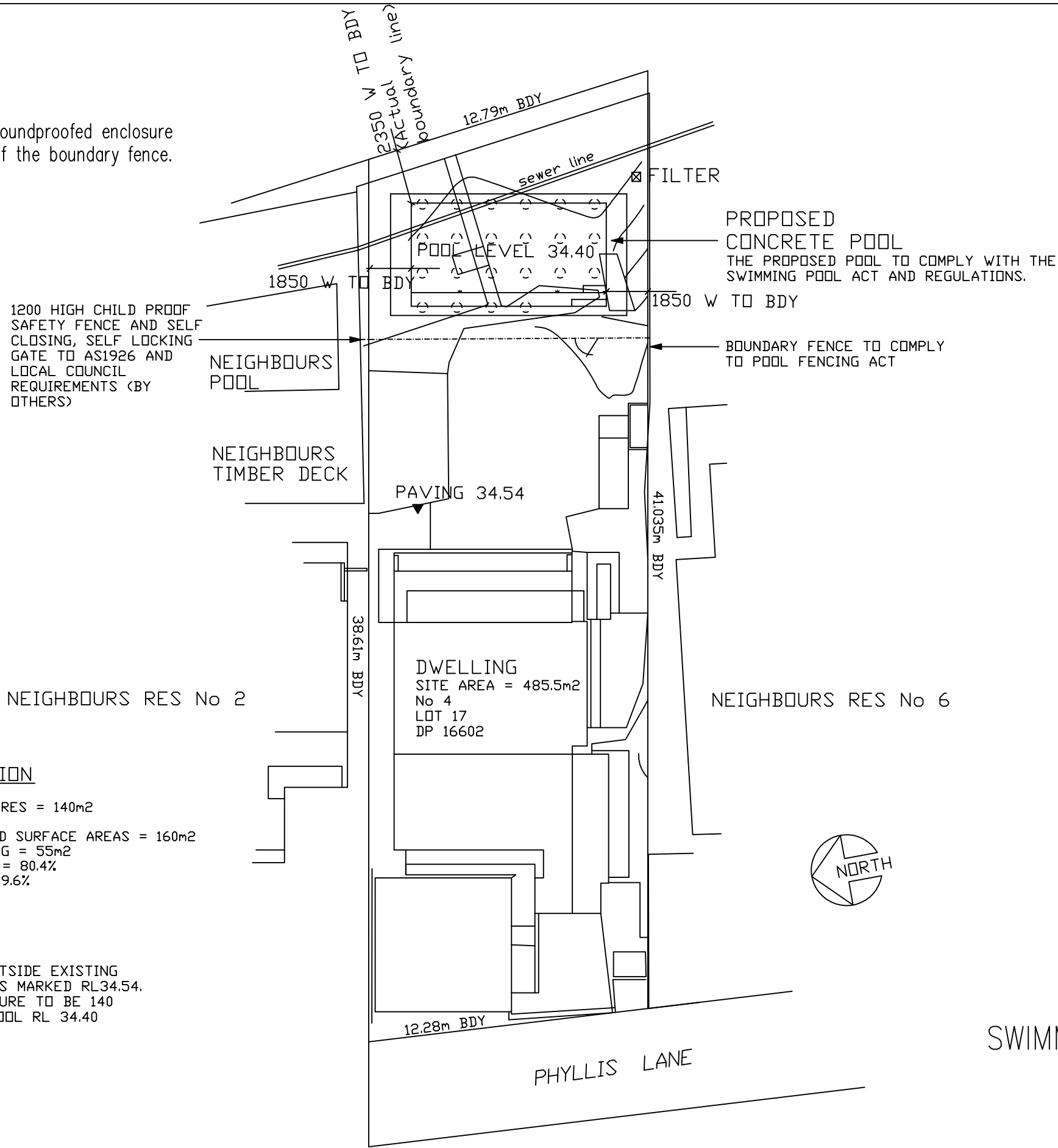

SITE CALCULATION
SITE AREA = 485.5m2
RESIDENCES/ STRUCTURES = 140m2
GARAGE = 35m2
PATHS/ PAVERS/ HARD SURFACE AREAS = 160m2
PROPOSED POOL/COPIING = 55m2
TOTAL B.U.A. = 390m2 = 80.4%
LANDSCAPED AREA = 19.6%

▼ DATUM - PAVING OUTSIDE EXISTING
DWELLING AT REAR AS MARKED RL34.54.
TOP OF POOL STRUCTURE TO BE 140
BELOW THE DATUM. POOL RL 34.40

SWIMMING POOL SITE
SCALE: 1:200

NOTE:
© Copyright. This plan and design is the property of HYTEN
ENGINEERING, and must not be used, reproduced or copied
wholly or in part without written permission from the company.
Do not scale drawings, use figured dimensions only.
WHEN IN DOUBT, ASK. It is your responsibility.
If HYTEN Engineering has not been engaged to carry out
structural inspections, no certificate will be issued.

Rev.	Description	By.	App.	Date
B	Relocate pool 1325 to rear	JF	JF	12.02.2019
A	ISSUED FOR C.C.	JF	JF	5.12.2018



HYTEN
ENGINEERING

STRUCTURAL | STORMWATER | GLASS ENGINEERING
0413 863 363 michael@hyten.com.au www.hyten.com.au

AROONA POOLS
SPAS P/L
2801/225 WALKER ST,
NORTH SYDNEY. NSW
Ph: 9460 0737 Lic 298081c

Client	JOHNSTON
Project	4 PHYLLIS LANE, NORTH CURL CURL. NSW

Title	IN-GROUND CONCRETE SWIMMING POOL SITE PLAN
ISSUED FOR	CONSTRUCTION CERTIFICATE
Project Number	19H3007

Design	Drawn
M.A.	J.F.
Drawing Number	S04

NORTHEAST SUMMER WINDS

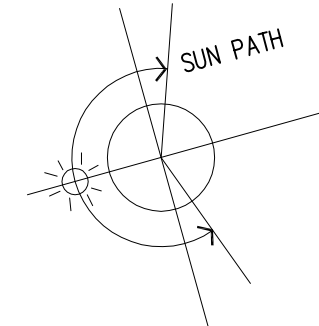

SOUTHWEST WINTER WINDS

SITE AREA = 485.5m²
RESIDENCES/ STRUCTURES = 140m²
GARAGE = 35m²
PATHS/ PAVERS/ HARD SURFACE AREAS = 160m²
PROPOSED POOL/COPIING = 55m²
TOTAL B.U.A. = 390m² = 80.4%
LANDSCAPED AREA = 19.6%

▼ DATUM - PAVING OUTSIDE EXISTING
DWELLING AT REAR AS MARKED RL34.54.
TOP OF POOL STRUCTURE TO BE 140
BELOW THE DATUM, POOL RL 34.40

SCALE: 1 : 1000

NOTE:
© Copyright. This plan and design is the property of HYTEN ENGINEERING, and must not be used, reproduced or copied wholly or in part without written permission from the company.
Do not scale drawings, use figured dimensions only.
WHEN IN DOUBT, ASK. It is your responsibility.
If HYTEN Engineering has not been engaged to carry out structural inspections, no certificate will be issued.

Rev.	Description	By.	App.	Date
B	Relocate pool 1325 to rear	JF	JF	12.02.2019
A	ISSUED FOR C.C.	JF	JF	5.12.2018



**AROONA POOLS
SPAS P/L**
2801/225 WALKER ST,
NORTH SYDNEY. NSW
Ph: 9460 0737 Lic 298081c

Project 4 PHYLLIS LANE,
NORTH CURL CURL, NSW

ISSUED FOR
CONSTRUCTION CERTIFICATE

Project Number
19H3007

Drawing Number
SA1

A3 0 10 20 30 40 50 60 70 80 90 100 110 120 130 140 150