

BUNGAN HEAD ROAD

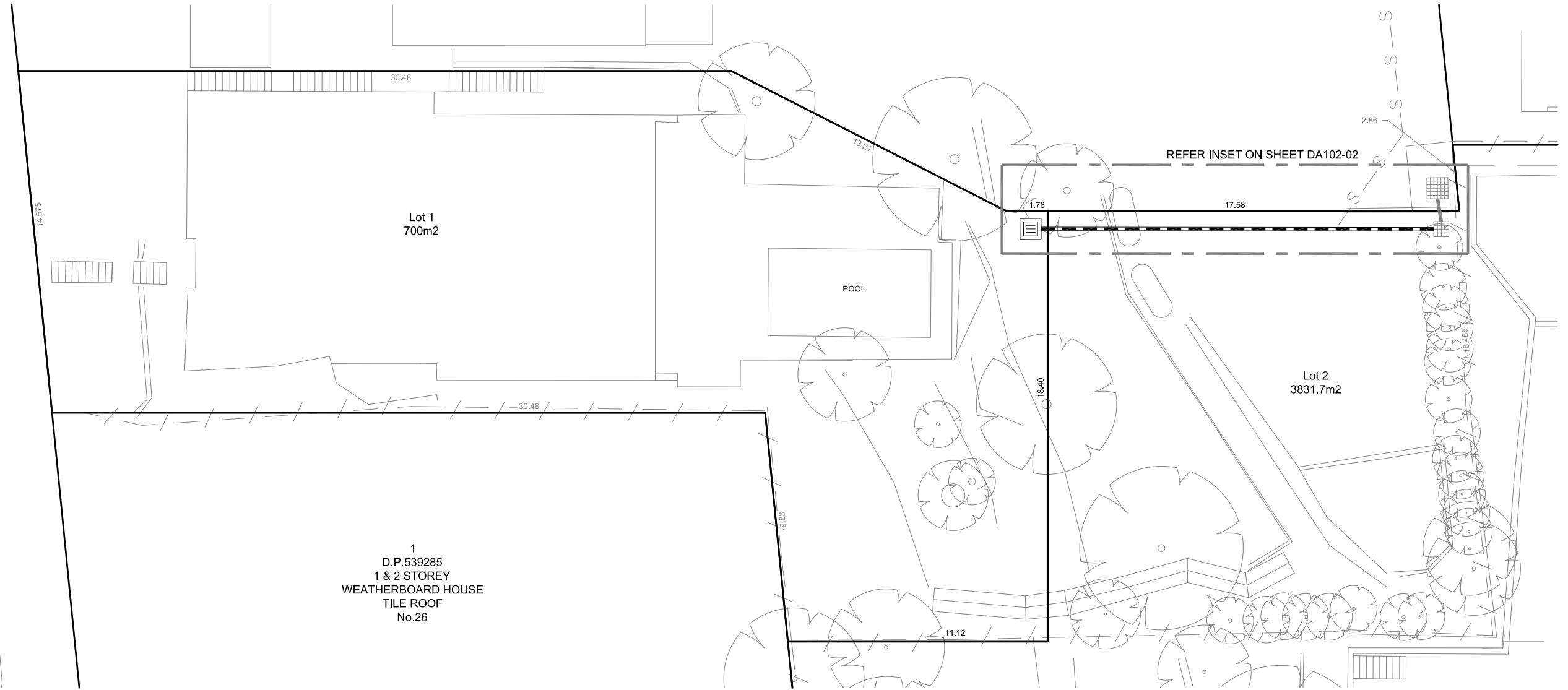

GENERAL SITE LAYOUT  
SCALE 1:100

DRAWING INDEX

DRAWING NO.	DRAWING TITLE
DA102-01	GENERAL LAYOUT & SITE PLAN
DA102-02	PLAN & SECTION ALONG PIPE
DA102-03	SEDIMENT AND EROSION CONTROL PLAN & DETAILS



SITE PLAN

SCALE 1:100 @ A1  
SCALE 1:200 @ A3



FOR DA APPROVAL

Issue	Description	Date	Drawn	Approved
A	FINAL DESIGN	17/01/20	AS	SN



**mepstead  
& ASSOCIATES**  
REGISTERED SURVEYORS AND  
DEVELOPMENT CONSULTANTS

**Sydney**  
9/4 Central Avenue, Thornleigh N.S.W. 2120  
**Phone** 02 9875 4500

**Postal**  
PO BOX 22, Thornleigh N.S.W. 2120  
**Internet**  
mepstead@mepstead.com.au  
www.mepstead.com.au

**Client:**  
- DAVID ROYLE  
7 BUSHRANGERS HILL  
NEWPORT NSW 2108

**Project:**  
PROPOSED SUBDIVISION  
OVER LOT 1 DP634714  
BUNGAN HEAD ROAD,  
NEWPORT

Designed:	AS	Scale:	AS SHOWN	A1
Drawn:	AS	Datum:	A.H.D	
Checked:	SN	Date:	JANUARY 2020	
L.G.A:	NORTHERN BEACHES			

**Drawing Title:**  
GENERAL LAYOUT & SITE PLAN  
:

<b>Issue:</b>	<b>A</b>
Org. No.	DA102-02
Our Ref:	5800
Sheet No.	- / 3

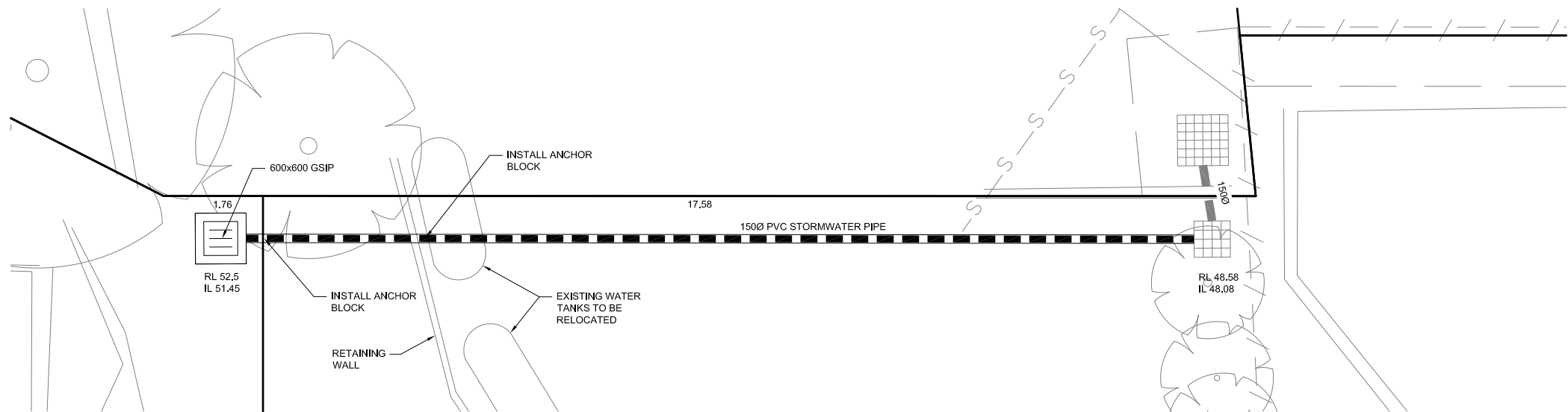
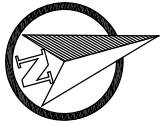

**NEW STORMWATER PIPE PLAN**  
SCALE 1: 50

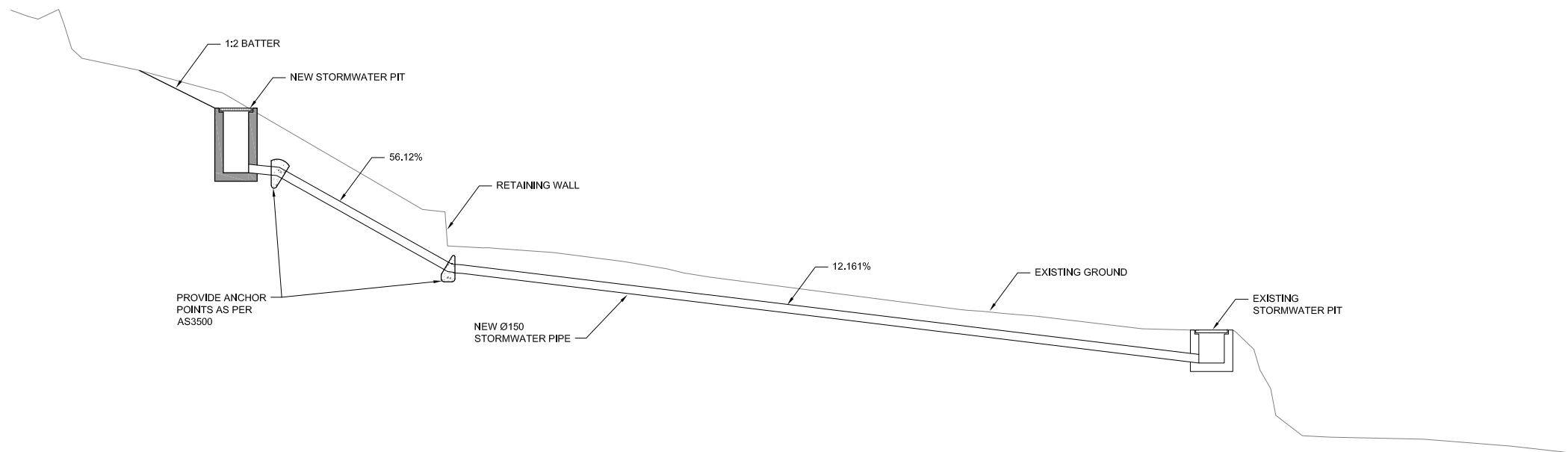

**LONGITUDINAL SECTION ALONG STORMWATER PIPE**  
SCALE 1: 50

SCALE 1:50 @ A1  
SCALE 1:100 @ A3



FOR DA APPROVAL

Issue	Description	Date	Drawn	Approved
A	FINAL DESIGN	17/01/20	AS	SN



**mepstead  
& ASSOCIATES**  
REGISTERED SURVEYORS AND  
DEVELOPMENT CONSULTANTS

**Sydney**  
9/4 Central Avenue, Thornleigh N.S.W. 2120  
**Phone** 02 9875 4500

**Postal**  
PO BOX 22, Thornleigh N.S.W. 2120  
**Internet**  
mepstead@mepstead.com.au  
www.mepstead.com.au

**Client**  
-  
DAVID ROYLE  
7 BUSHRANGERS HILL  
NEWPORT NSW 2108

**Project:**  
PROPOSED SUBDIVISION  
OVER LOT 1 DP634714  
BUNGAN HEAD ROAD,  
NEWPORT

Designed: AS	Scale: AS SHOWN	A1
Drawn: AS	Datum: A.H.D	
Checked: SN	Date: JANUARY 2020	
L.G.A:	NORTHERN BEACHES	

**Drawing Title:**  
PLAN & SECTION ALONG PIPE  
:

Issue: <b>A</b>	
Org. No. <b>DA102-02</b>	
Our Ref: <b>5800</b>	Sheet No. <b>2 / 3</b>

## GENERAL NOTES:

1. ALL EROSION AND SEDIMENT CONTROL MEASURES, INCLUDING REVEGETATION AND STORAGE OF SOIL AND TOPSOIL, SHALL BE IMPLEMENTED TO THE REQUIREMENTS OF THE "ENVIRONMENT PROTECTION AUTHORITY".AND "DEPT OF LAND AND WATER CONSERVATION". MEASURES OUTLINED IN THE SEDIMENT & EROSION CONTROL PLAN MUST BE IMPLEMENTED PRIOR TO AND MAINTAINED DURING AND AFTER THE CONSTRUCTION WORKS.
2. TOPSOIL FROM ALL AREAS TO BE DISTURBED SHALL BE STOCKPILED AND LATER RESPREAD TO AID REVEGETATION IN THOSE AREAS.
3. ALL DRAINAGE WORKS SHALL BE CONSTRUCTED AND STABILIZED AS EARLY AS POSSIBLE DURING DEVELOPMENT.
4. ALL TAIL-OUT DRAINS SHALL BE GRASSED AND TRAPEZOIDAL IN SECTION. STRAW BALES SHALL BE PLACED AS A SEDIMENT CONTROL DEVICE WHERE REQUIRED.
5. VEHICULAR TRAFFIC SHALL BE CONTROLLED DURING DEVELOPMENT CONFINING ACCESS WHERE POSSIBLE TO PROPOSED OR EXISTING ROAD ALIGNMENTS. AREAS TO BE LEFT UNDISTURBED SHALL BE MARKED OFF.
6. DISTURBANCE OF VEGETATION SHALL BE LIMITED TO FILL AREAS, ROADWAYS AND DRAINAGE LINES. NO LOT GRADING SHALL BE CARRIED OUT IN UNDISTURBED AREAS WITHOUT CONSULTATION WITH COUNCIL'S ENGINEER.
7. ALL DISTURBED AREAS SHALL BE REVEGETATED WITHIN 14 WORKING DAYS FROM THE CONCLUSION OF LAND SHAPING.
8. MINIMISE DUST BY WATERING WHEN REQUIRED.

## STOCKPILE NOTES:

9. SPOIL AND TOPSOIL STOCKPILES SHALL BE LOCATED AWAY FROM DRAINAGE LINES AND AREAS WHERE WATER MAY CONCENTRATE.
10. IF STOCKPILES ARE TO BE IN PLACE FOR LONGER THAN 14 DAYS THEN THEY SHALL BE STABILIZED BY COVERING WITH A MULCH OR WITH TEMPORARY VEGETATION.
11. FOLLOWING CONSTRUCTION, TOPSOIL SHALL BE RESPREAD TO A MINIMUM DEPTH OF 100MM ON THE BARE SOIL SURFACES

AND REVEGETATE.

12. ALL STOCKPILES TO BE (MAX) 2M HIGH AND PROTECTED WITH SILT FENCE.

## SPECIAL NOTES:

13. LOCATION AND EXTENT OF SOIL AND WATER MANAGEMENT DEVICES IS DIAGRAMMATIC ONLY AND THE ACTUAL REQUIREMENTS SHALL BE CONFIRMED ON SITE.
14. THIS PLAN IS TO BE READ IN CONJUNCTION WITH THE GUIDELINES SET OUT IN "MANAGING URBAN STORMWATER SOILS AND CONSTRUCTION " -4TH EDITION AND THE ACCOMPANYING ROAD AND DRAINAGE PLANS.
15. CONFORMITY WITH THIS PLAN SHALL IN NO WAY REDUCE THE RESPONSIBILITY OF THE CONTRACTOR TO PROTECT AGAINST WATER DAMAGE DURING THE COURSE OF THE CONTRACT.
16. MANAGEMENT DEVICES SHALL BE MAINTAINED ON A REGULAR BASIS. WHERE CLEANING IS REQUIRED, THE SEDIMENT SHALL BE REMOVED TO A POINT NOMINATED BY THE ENGINEER.
17. PRIOR TO THE COMMENCEMENT OF ANY EARTHWORKS, AND AFTER THE ROAD CENTERLINES HAVE BEEN PEGGED AND/OR PERMANENTLY MARKED, THE SITE MUST BE INSPECTED BY COUNCIL'S REPRESENTATIVE AND THE APPLICANT'S REPRESENTATIVE TO IDENTIFY AND APPROPRIATELY MARK:-  
A) THE TREES TO BE RETAINED. B) ALL TREES TO BE LEFT UNDISTURBED AND TO BE CORDONED OFF.
18. NO TREES SHALL BE REMOVED WITHOUT COUNCIL'S CLEARANCE.
19. MANAGEMENT DEVICES TO REMAIN UNTIL THE END OF THE MAINTENANCE PERIOD

## SEDIMENT CONTROL DEVICES:

20. ALL STRAW BALES SHALL BE BOUND WITH WIRE. STRAW BALES SHALL BE PLACED END TO END IN A SINGLE ROW AND EMBEDDED INTO THE SOIL TO A DEPTH OF 100MM. EACH BALE SHALL BE SECURELY ANCHORED WITH TWO STEEL STAKES DRIVEN 450MM INTO THE GROUND AND LOCATED ON THE BALE CENTRE LINE.
21. SILT FENCES SHALL BE CONSTRUCTED BY STRETCHING A FILTER FABRIC (PROPEX OR SIMILAR) BETWEEN POSTS AT 2M (3M MAX) CENTRES. FABRIC SHALL BE BURIED 150MM ALONG ITS LOWER EDGE.

## ADDITIONAL NOTES:

22. MINIMUM 300mm WIDE STRIP OF TURF IS REQUIRED BEHIND KERB
23. TURF AROUND ALL SURFACE INLET PITS AT 1m WIDE

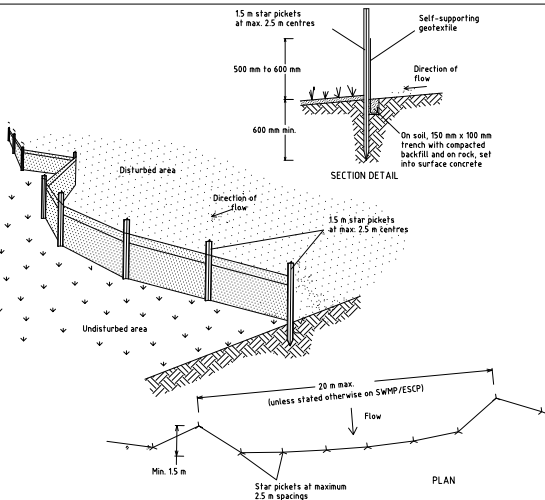

### Construction Notes

1. Construct sediment fences as close as possible to being parallel to the contours of the site, but with small returns as shown in the drawing to limit the catchment area of any one section. The catchment area should be small enough to limit water flow if concentrated at one point to 50 litres per second in the design storm event, usually the 10-year event.
2. Cut a 150-mm deep trench along the upslope line of the fence for the bottom of the fabric to be entrenched.
3. Drive 15 metre long star pickets into ground at 2.5 metre intervals (max) at the downslope edge of the trench. Ensure any star pickets are fitted with safety caps.
4. Fix self-supporting geotextile to the upslope side of the posts ensuring it goes to the base of the trench. Fix the geotextile with wire ties or as recommended by the manufacturer. Only use geotextile specifically produced for sediment fencing. The use of shade cloth for this purpose is not satisfactory.
5. Join sections of fabric at a support post with a 150-mm overlap.
6. Backfill the trench over the base of the fabric and compact it thoroughly over the geotextile.

SEDIMENT FENCE

SD 6-8

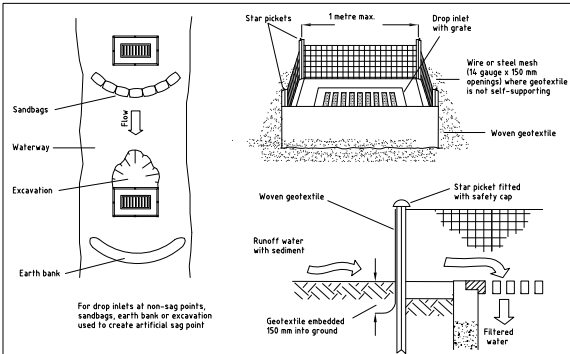

### Construction Notes

1. Fabricate a sediment barrier made from geotextile or straw bales.
2. Follow Standard Drawing 6-8 for installation procedures for geofabric. Reduce the picket spacing to 1 metre centres.
3. In waterways, artificial sag points can be created with sandbags or earth banks as shown in the drawing.
4. Do not cover the inlet with geotextile unless the design is adequate to allow for all waters to bypass it.

GEOTEXTILE INLET FILTER

SD 6-12

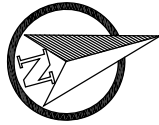

## EROSION AND SEDIMENT CONTROL LEGEND

ACCORDING TO: LANDCOM SOILS AND CONSTRUCTION Vol 1, 4th EDITION, MARCH 2004

— SF — SF — SEDIMENT FENCE TO SD 6-8

□ MESH AND GRAVEL INLET FILTER TO SD 6-11

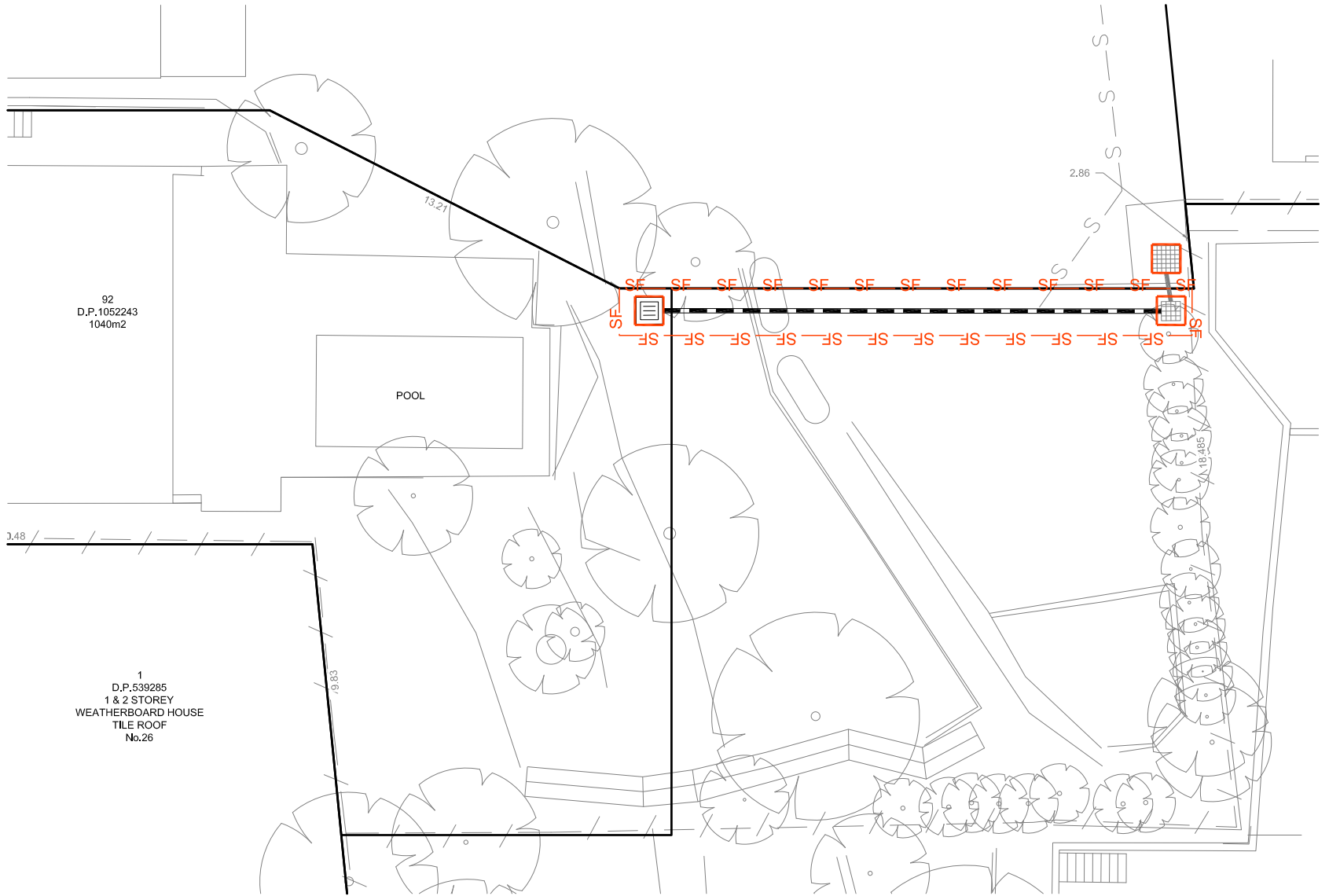

FOR DA APPROVAL

SCALE 1:100 @ A1  
SCALE 1:200 @ A3

Issue	Description	Date	Drawn	Approved
A	FINAL DESIGN	17/01/20	AS	SN



**mepstead**  
& ASSOCIATES  
REGISTERED SURVEYORS AND  
DEVELOPMENT CONSULTANTS

**Sydney**  
9/4 Central Avenue, Thornleigh N.S.W. 2120  
Phone 02 9875 4500

**Postal**  
PO BOX 22, Thornleigh N.S.W. 2120  
**Internet**  
mepstead@mepstead.com.au  
www.mepstead.com.au

**Client**  
-  
DAVID ROYLE  
7 BUSHRANGERS HILL  
NEWPORT NSW 2108

**Project:**  
PROPOSED SUBDIVISION  
OVER LOT 1 DP634714  
BUNGAN HEAD ROAD,  
NEWPORT

Designed:	AS	Scale:	AS SHOWN	A1
Drawn:	AS	Datum:	A.H.D	
Checked:	SN	Date:	JANUARY 2020	
L.G.A:	NORTHERN BEACHES			

**Drawing Title:**  
SEDIMENT AND EROSION CONTROL PLAN & DETAILS  
:

<b>Issue:</b> Org. No. DA102-03 Our Ref: 5800	<b>Sheet No.</b> 3 / 3
---	---------------------------