

Bearings on this plan relate to Grid North from D.P. 1199795 which approximates True North

SCHEDULE OF SHORT AND CURVED BOUNDARIES

NO.	BEARING	DISTANCE	ARC LENGTH	RADIUS
1	128° 14' 00"	10.94	11.2	14.89
2	110° 43' 10"	8.135		
3	118° 51' 10"	4.265	4.275	19.85
4	128° 45' 00"	5.61		
5	139° 52' 45"	7.845	7.89	20.565
6	267° 47' 50"	11.41	11.84	12.575

TREE TABLE

No.	Trunk	Spread	Height
1	0.4	6.0	15.0
2	0.3	2.0	8.0
3	0.3	5.0	18.0
4	0.3	5.0	18.0
5	0.3	4.0	15.0
6	0.3	4.0	8.0
7	0.3	5.0	18.0
8	1.2	15.0	18.0
9	0.3	2.0	8.0
10	0.3	5.0	15.0
11	0.3	5.0	18.0
12	0.2	3.0	8.0
12A	0.2	3.0	8.0
13	0.3	5.0	18.0
14	0.3	4.0	5.0
15	0.6	6.0	12.0
16	0.2	3.0	5.0
17	0.2	3.0	5.0
18	0.2	3.0	10.0
19	1.0	10.0	20.0
20	0.8	15.0	18.0
21	0.3	3.0	8.0
22	0.4	6.0	15.0
23	0.3	3.0	8.0
24	0.5	5.0	10.0
25	0.2	3.0	8.0
26	1.0	12.0	22.0
27	0.2	5.0	5.0
28	0.2	3.0	8.0
29	1.0	12.0	20.0
30	0.4	5.0	12.0
31	0.4	3.0	4.0
32	0.1	2.0	3.0
32A	0.2	3.0	5.0
33	0.2	5.0	8.0
34	0.2	3.0	8.0
35	0.4	6.0	5.0
36	5.0	8.0	12.0
37	0.2	2.0	5.0
38	0.2	2.0	5.0
39	0.2	2.0	5.0
40	0.2	2.0	5.0
41	0.2	4.0	10.0

42	0.2	4.0	10.0
43	0.3	5.0	10.0
44	0.5	6.0	18.0
45	0.2	4.0	10.0
46	0.3	4.0	13.0
47	0.3	4.0	5.0
48	0.3	5.0	15.0
49	0.3	4.0	18.0
50	0.3	3.0	10.0
51	0.2	3.0	6.0
52	0.2	3.0	6.0
53	0.4	5.0	15.0
54	0.4	6.0	15.0
55	0.6	8.0	15.0
56	0.3	3.0	5.0
57	0.3	5.0	5.0
58	0.2	4.0	8.0
59	0.4	6.0	15.0
60	0.4	6.0	18.0
61	0.4	5.0	18.0
62	0.4	5.0	15.0
63	0.3	7.0	8.0
64	0.4	10.0	12.0
65	0.3	5.0	7.0
66	0.5	8.0	18.0
67	0.3	5.0	15.0
68	0.8	15.0	18.0
69	1.0	12.0	12.0
70	0.5	10.0	12.0
71	1.0	10.0	12.0
72	0.1	2.0	3.0
73	0.1	2.0	4.0
74	0.1	2.0	4.0
75	0.1	2.0	4.0
76	0.1	2.0	4.0
77	0.1	2.0	7.0

- (R) - RESTRICTION(S) ON THE USE OF LAND (DP231044)
- LAND EXCLUDES MINERALS AND IS SUBJECT TO RESERVATIONS & CONDITIONS IN FAVOUR OF THE CROWN- SEE CROWN GRANT(S)
  - EXCEPTING LAND BELOW A DEPTH FROM THE SURFACE OF 15.24 METRES RESERVED BY THE CROWN GRANT

- NOTES:**
- ORIGIN OF LEVELS TAKEN FROM SSM 9129 (RL 158.773 A.H.D) CLASS LC
  - ALL AREAS AND DIMENSIONS HAVE BEEN COMPILED FROM PLANS MADE AVAILABLE AT THE LAND TITLES OFFICE AND ARE SUBJECT TO FINAL SURVEY.
  - NO BOUNDARY INVESTIGATION HAS BEEN CARRIED OUT, RELATIONSHIP OF IMPROVEMENTS AND DETAIL TO BOUNDARIES ARE DIAGRAMMATIC ONLY
  - ONLY SPOT LEVELS SHOULD BE USED FOR CALCULATIONS OF QUANTITIES WITH CAUTION.
  - NO INVESTIGATION OF UNDERGROUND SERVICES HAS BEEN MADE. ALL RELEVANT AUTHORITIES SHOULD BE NOTIFIED PRIOR TO ANY EXCAVATION ON OR NEAR THE SITE.
  - SERVICES THAT ARE NOT SHOWN ON THE PLAN WERE NOT VISIBLE AT THE TIME OF SURVEY.
  - WINDOW, RIDGE, & EAVE HEIGHTS HAVE BEEN OBTAINED BY AN INDIRECT METHOD AND ARE ACCURATE FOR PLANNING PURPOSES ONLY.



TM DIAL BEFORE YOU DIG SHOULD BE CONTACTED PRIOR TO ANY EXCAVATION ON SITE  
 TM: trade mark of Association of Australian Dial Before You Dig Services Ltd; used under licence.

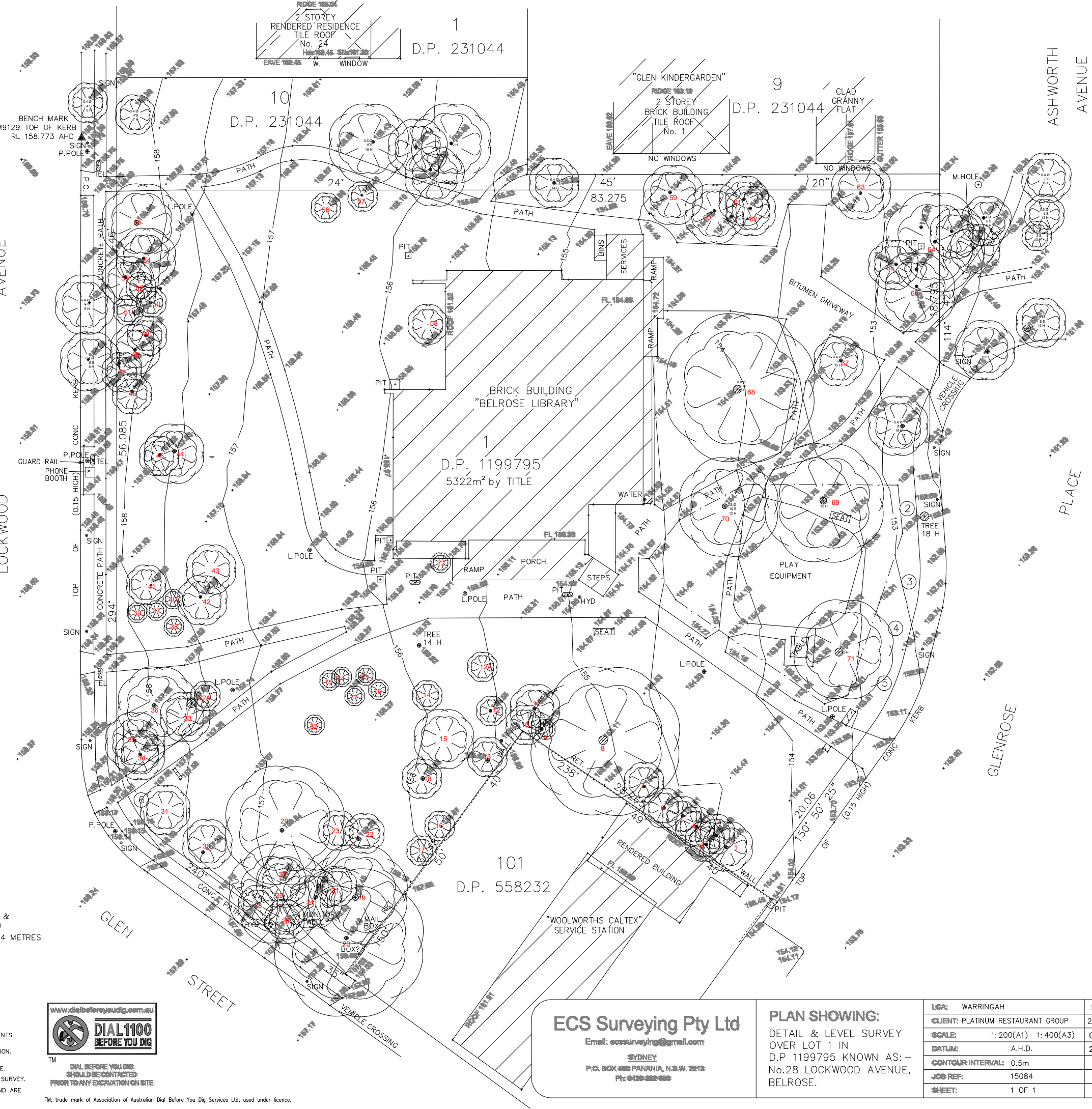

**ECS Surveying Pty Ltd**  
 Email: [ecssurveying@gmail.com](mailto:ecssurveying@gmail.com)  
 SYDNEY  
 P.O. BOX 582 PANANIA, N.S.W. 2213  
 Ph: 0120-322-988

**PLAN SHOWING:**  
 DETAIL & LEVEL SURVEY  
 OVER LOT 1 IN  
 D.P. 1199795 KNOWN AS:-  
 No.28 LOCKWOOD AVENUE,  
 BELROSE.

LGA:	WARRINGAH	DATE:	28/07/15	REV:	00	AMENDMENTS:	DETAIL & LEVEL SURVEY
CLIENT:	PLATINUM RESTAURANT GROUP	SCALE:	1:200(A1) 1:400(A3)	03/08/19	01	TREES UPDATED	
DATUM:	A.H.D.	25/08/19	02	TREES NO. UPDATED			
CONTOUR INTERVAL:	0.5m						
JOB REF:	15084						
SHEET:	1 OF 1						