

SITE DEVELOPMENT CALCULATIONS - R2 LOW DENSITY RESIDENTIAL - Warringah Locality

Site Area = 650.3 m2	Existing m2	Existing %	Proposed m2	Proposed %	Control	Compliance
Residence / Sheds	195.92		185.77			
Driveway	58.08		50.65			
Paving / Deck	60.52		134.95			
Site Coverage	314.52	48.37	371.37	57.11		
Total Landscaped Open Space - includes swimming pool water area (Excludes areas of less than 2.0m wide)	278.59	42.84	261.50	40.21	40% min.	YES
Total Pervious Site Area	335.78	51.63	278.93	42.89		

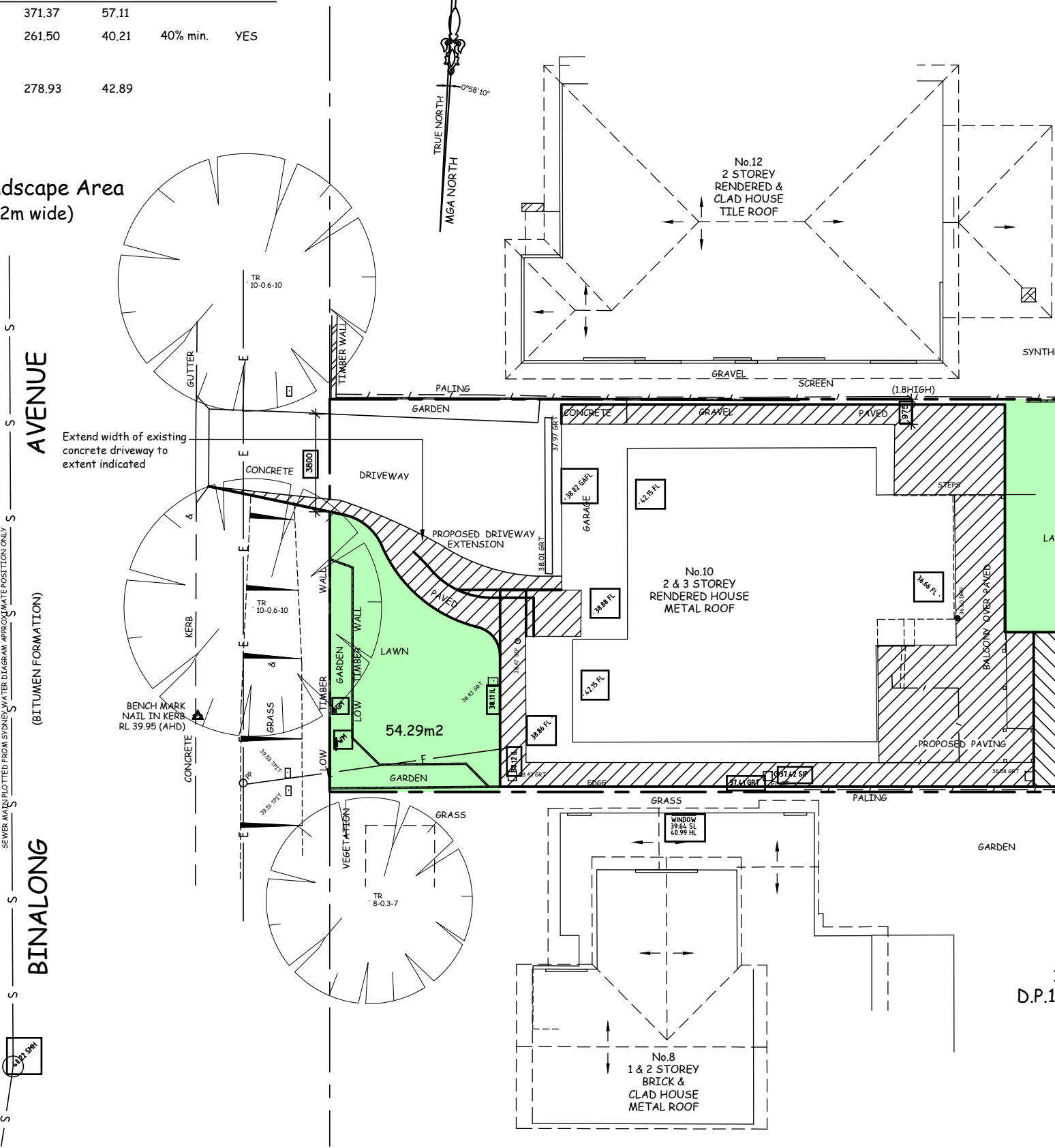

Denotes Proposed Landscape Area
(excludes areas less than 2m wide)



date	amendment



Accreditation Number 6255
0413 710 256
ABN 17 751 732 195

SALLY GARDNER DESIGN AND DRAFT
PLANS DRAWN FOR APPROVAL

SustainAbility Design™ Specialist

This drawing is the copyright of Sally Gardner Design & Draft and may not be altered, reproduced or transmitted in any form or by any means in part or in whole without permission of Sally Gardner Design & Draft. Do not scale dimensions from this drawing. Figured dimensions are to be used only.
The builder / contractor shall check and verify all levels and dimensions on the site prior to commencement of any work, creation of shop drawings or fabrication of components.
Any errors or omissions are to be verified by the builder / contractor and referred to the designer prior to the commencement of works.

Clients

Stephen KELLY

Project

Proposed Altera
10 Binalong Aven
Site Plan & Calcu

Drawing Title	Proposed Altera 10 Binalong Aven Site Plan & Calcu
---------------	--