

FILE: H:\1202\1200093 - SOUTHERN BUFFER WARRIEWOOD06 - MODEL AUTODRAW\DWG\21-000093_SOUTHERN_BUFFER_DA-101.DWG LAST SAVED BY: JHOOGESTEGER

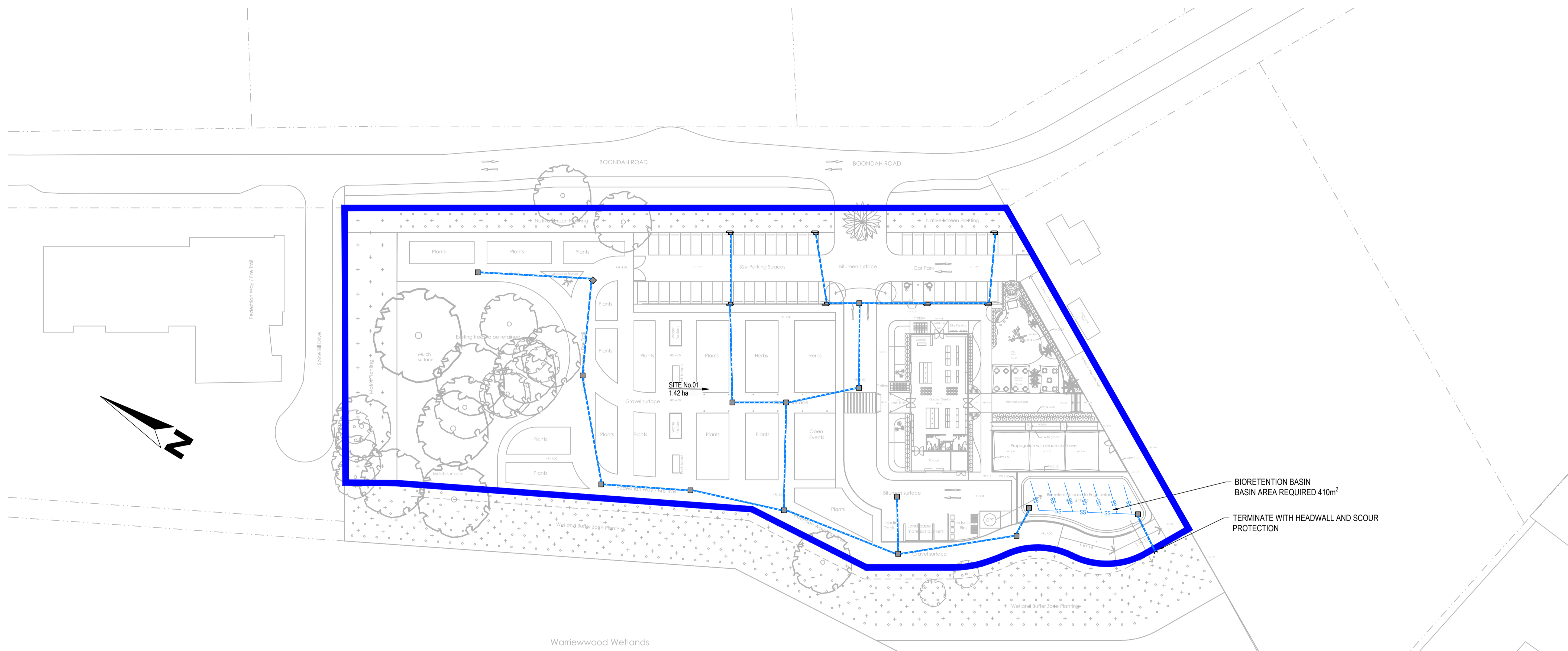

BIORETENTION BASIN
BASIN AREA REQUIRED 410m²
TERMINATE WITH HEADWALL AND SCOUR
PROTECTION

LEGEND

- PROPOSED STORMWATER PIPELINE & DRAINAGE PIT.
- TEMPORARY STORMWATER PIPELINE & DRAINAGE PIT
- FUTURE STORMWATER PIPELINE & DRAINAGE PIT.
- PROPOSED DRIVEWAY
- PROPOSED PLANTER BOX
- PROPOSED PARKING BAY
- PROPOSED THRESHOLD
- PROPOSED ROAD HUMP



FIRST ISSUE	DESIGN	DRAWN	CHECK	APPD.	DATE
1	DKH	DKH	TE	-	04/05/2024
	DKH	DKH	TE	-	04/05/2024

AMENDMENTS

NO.	DESCRIPTION	DATE

AMENDMENT DETAILS

ISSUED FOR DEVELOPMENT APPLICATION

STATUS

FOR DEVELOPMENT APPLICATION

AUTHORISED FOR ISSUE:

BY: ENRIQUE FRANCO SIGN: BE(Hons) MIEAust. CPEng NER

DATE: 24/11/2021

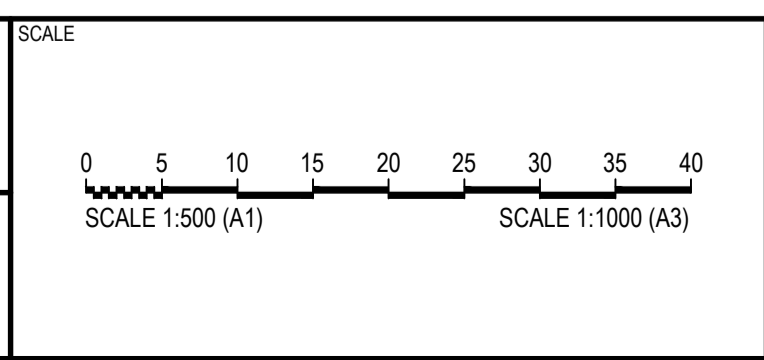

CLIENT



PROJECT

10-12 BOONDAH ROAD
WARRIEWOOD

DISCLAIMER
ALL DIMENSIONS TO BE CHECKED ON SITE BY CONTRACTOR
PRIOR TO CONSTRUCTION. USE WRITTEN DIMENSIONS ONLY, DO
NOT SCALE. NOT FOR CONSTRUCTION UNLESS STAMPED BY
CERTIFYING AUTHORITY

DRAWING TITLE

STORMWATER MANAGEMENT PLAN

PROJECT No.	DRAWING No.	STAGE	REVISION
21-000093	101	DA	1