

3 SECOND FLOOR PLANTER BOX
Scale: 1:100

VARIOUS EDIBLE HERBS, VEGETABLES
AND FRUIT SHALL BE PLANTED IN
EASILY ACCESSIBLE AREAS OF THE
SECOND FLOOR PLANTER BOX

THE FOLLOWING SPECIES SHOULD BE PLANTED
IN THE FIRST AND SECOND FLOOR PLANTER BOXES
PLANTER BOX SOIL DEPTH TO BE: 400MM
LEPTOSPERMUM LEMON BUN,
MESMERIA,
THRYPTOMENE SAXICOLA,
HAKEA SERICEA,
ACTINOTUS HELIANTHI

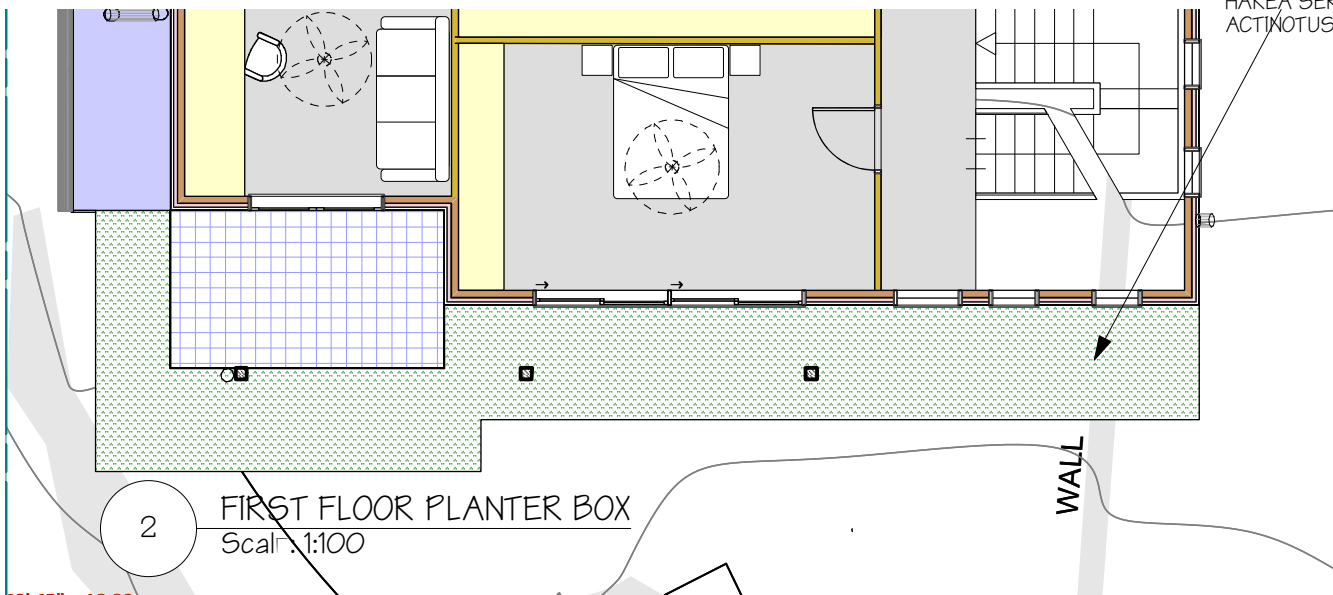

2 FIRST FLOOR PLANTER BOX
Scale: 1:100

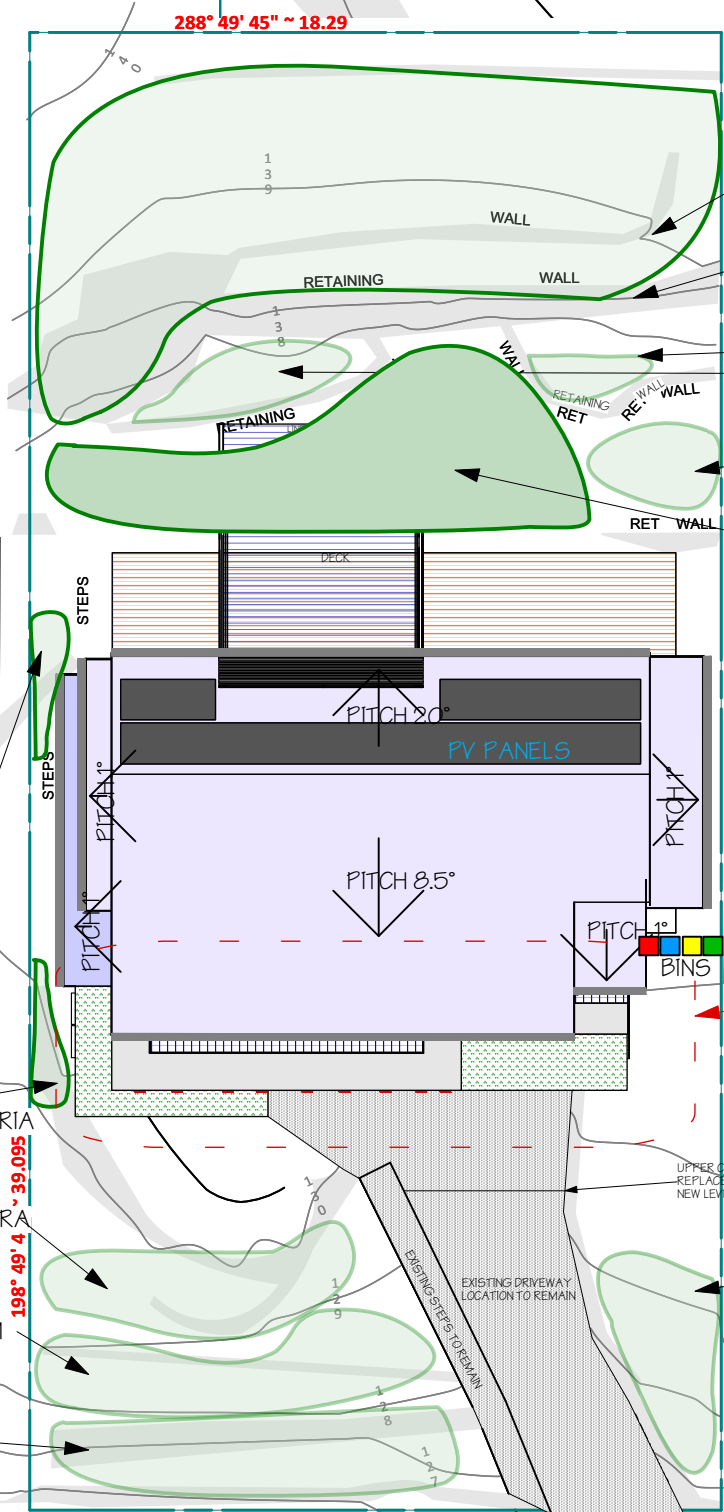

EXISTING GROUNDCOVERS AND SHRUBS

EXPOSED ROCK OUTCROP

EXISTING EDIBLE HERBS

EXISTING GROUNDCOVERS AND SHRUBS

REMOVE EXISTING PAVING UNDER NEW DECK
AND REPLACE WITH NATIVE GRASSES
(EG. WEEPING OR WALLABY GRASS)

FOR FIRST AND SECOND FLOOR
PLANTER BOXES SEE ABOVE

EXISTING NATIVE DAISY

EXISTING SANSEVIERIA

EXISTING LOMANDRA

EXISTING SYZIGIUM

EXISTING
GROUNDCOVERS
AND SHRUBS

108° 49' 45" ~ 18.29

198° 49' 45" ~ 39.095

288° 49' 45" ~ 18.29

LEGEND

- SOLAR PV
- EXTERNAL TILED FLOORING
- EXTERNAL DECK
- ROOF
- ROOFTOP GARDEN
- DRIVEWAY
- PLANTED AREAS/
SOFT LANDSCAPING
396M2

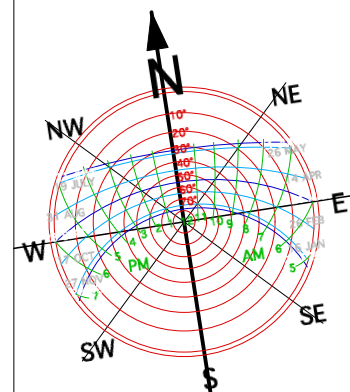

SIR

THOMAS

MITCHELL

1

OVERALL LANDSCAPE PLAN
Scale: 1:200

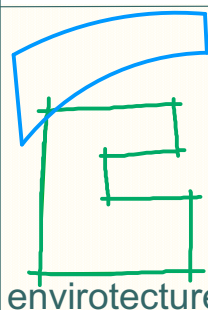

ISSUE	1	DATE	25/7/18	FOR INFORMATION	PROJECT #	
PROJECT					NEW DWELLING	
ADDRESS					24 SIR THOMAS MITCHELL DRIVE, DAVIDSON	
CLIENT				GERRY & STELA WILKINS	DATE #	2018-07-25
					SCALE	1:100@A3
DWG				PROPOSED LANDSCAPE PLAN	DRAWN	ML
					CHKD	DC
48 KALANG ROAD ELANORA HTS NSW 2101 OFFICE 02 9913 3997					bda ACCREDITED BUILDING DESIGNER DICK CLARKE #6029	
www.envirotexture.com.au					NOMINATED ARCHITECT: ANDY MARLOW ARB #9597	
envirotexture projects pty ltd ABN 49 078 853 577					SDS	