

NOTES:

1. ORIGIN OF LEVELS PM7774 RL113.156m (A.H.D. - CLASS LC, ORDER L3).
2. BEARINGS ARE ON MGA GRID NORTH. BOUNDARIES ARE APPROXIMATE ONLY WITH TITLE DIMENSIONS AND AREAS COMPILED FROM DP24360 & DP1246833.
3. THIS DETAIL SURVEY IS NOT A 'LAND SURVEY' AS DEFINED BY THE SURVEYING AND SPATIAL INFORMATION ACT 2002. ANY BUILDING, CONSTRUCTION OR FENCING WILL REQUIRE A FURTHER SURVEY TO BE UNDERTAKEN TO DETERMINE AND MARK THE BOUNDARIES. THIS PLAN IS TO BE USED FOR DETAIL PURPOSES ONLY AND BOUNDARIES SHOWN ON THIS PLAN ARE NOT TO BE USED FOR ANY BUILDING OR FENCING SET OUT.
4. RELATIONSHIP OF IMPROVEMENTS AND DETAIL TO BOUNDARIES IS DIAGRAMMATIC ONLY AND SPECIFIC DETAILS, IF CRITICAL, WILL REQUIRE FURTHER SURVEY.
5. NO SERVICES OR UNDERGROUND SERVICES SEARCH HAS BEEN UNDERTAKEN. SERVICES SHOWN ARE BASED ON VISIBLE SURFACE INDICATORS EVIDENT AT THE DATE OF SURVEY ONLY. DIAL BEFORE YOU DIG AND ALL SERVICE AUTHORITIES SHOULD BE CONTACTED PRIOR TO ANY DEVELOPMENT.
6. RIDGE AND EAVE & GUTTER HEIGHTS HAVE BEEN OBTAINED BY AN INDIRECT METHOD AND ARE ACCURATE FOR PLANNING PURPOSES ONLY.
7. ADJOINING BUILDINGS AND DWELLINGS HAVE BEEN PLOTTED FOR DIAGRAMMATIC PURPOSES ONLY AND SPECIFIC DETAILS, IF CRITICAL, WILL REQUIRE FURTHER SURVEY.

LEGEND

AWN - AWNING
BALC - EDGE OF BALCONY
BKFC - BRICK FENCE
BLDG - BUILDING CORNER
CL - ROAD CENTRELINE
CONC - CONCRETE SURFACE LEVEL
CPORT - TOP CARPORT LEVEL
FLR - FLOOR LEVEL
DH - DRILL HOLE
DHW - DRILL HOLE & WING
FCE - FENCE
GDN - GARDEN
GM - GAS METER
GPIT - GULLY PIT
GV - GAS VALVE
KI - KERB INVERT
HYD - WATER HYDRANT
PF - POOL FILTER
PP - POWER POLE
RIDGE - ROOF RIDGE
ROOF - TOP OF ROOF GUTTER
RWB - BOTTOM OF RETAINING WALL

WINDOW LEGEND

TD - TOP DOOR
BD - BOTTOM OF DOOR
TW - TOP WINDOW
BW - BOTTOM OF WINDOW

TR/O.2/6/5 - TREE (TRUNK Dia. 0.2m, CANOPY SPREAD 6m, HEIGHT 5m)

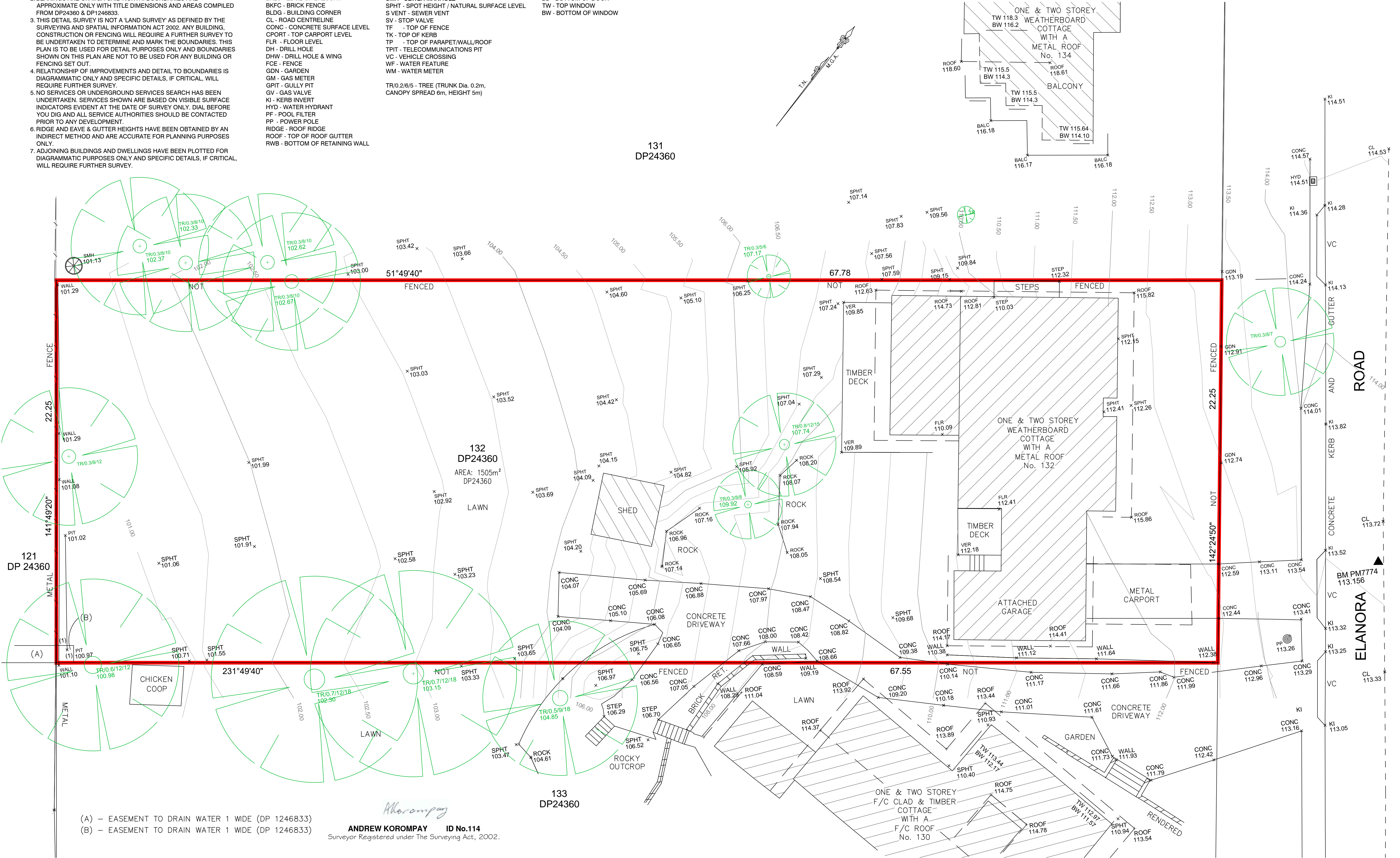

- (A) - EASEMENT TO DRAIN WATER 1 WIDE (DP 1246833)
(B) - EASEMENT TO DRAIN WATER 1 WIDE (DP 1246833)

ANDREW KOROMPAY ID No.114
Surveyor Registered under The Surveying Act, 2002.

REVISION	BY	REVISION DESCRIPTION	DATE
1	AK	TREES UPDATED	10/03/19
0	AK	INITIAL ISSUE	07/03/19

PLAN OF DETAIL OVER
No.132 ELANORA ROAD
ELANORA HEIGHTS NSW 2101



9 Ingleside Road NSW 2065
Ingleside NSW 2101
tel: 0412 353 784
email: info@northwestsurveys.com.au
web: www.northwestsurveys.com.au

SCALE: 1:100 @ A1 : 1:200 @ A3	DATE: 06/03/2019
CLIENT: - - -	DATUM: AHD
PROJECT No. 1473	
DRAWN	CHECKED
GH/BG	AK
APPROVED	AK
DRAWING No.	REVISION
1473_Elanora Rd_No132_DE	0