



0488 662 445

SECTION 4.55 APPLICATION

190 McCARRS CREEK RD CHURCH POINT

Lot 7 in DP 20097

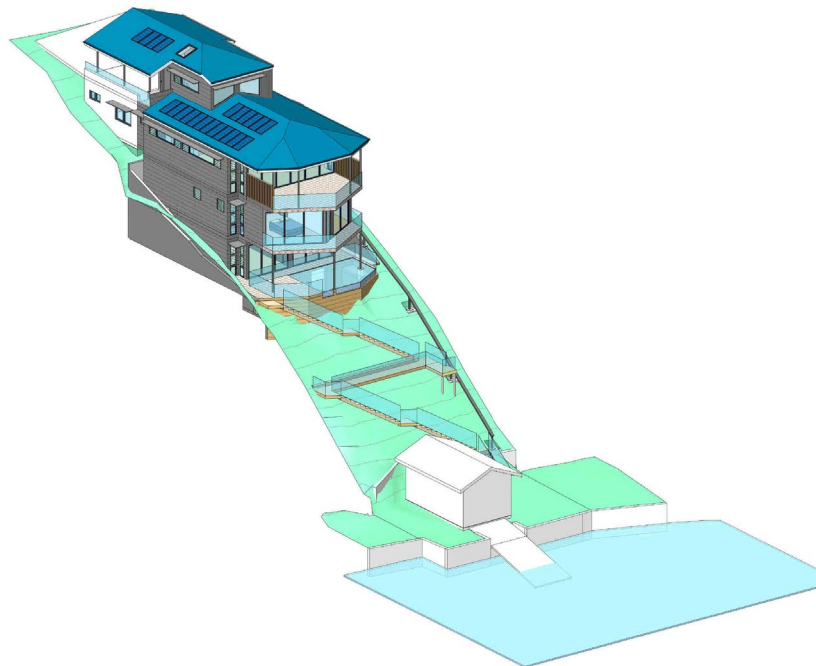

PROPOSED DEVELOPMENT

This Section 4.55 Application seeks approval for the following minor changes:

- Entrance to foyer and garage roof altered
- Some windows and doors altered
- Store and media rooms added to level 1
- Stairs to boatshed altered (previously these were shown only on the approved landscaping plan)
- Privacy screen added to the northern edge of the level 3 balcony – this was a condition of approval
- The incline lift rail has been shortened to above the high water mark, and the bottom landing moved uphill – also a condition of approval

REFERENCE DRAWINGS AND DOCUMENTS

Architectural drawings rev B by Peter Downes Designs including shadow diagrams

New BASIX Certificate by Victor Ling and Assoc

Geotech endorsement by Ascent Geotechnical Consulting

SUMMARY OF IMPACT OF THE PROPOSED CHANGES

These changes will have no impact as they are of a minor nature, will have a negligible effect on the shape and form of the approved building, and will not result in privacy, view loss, overshadowing or streetscape issues.

PETER DOWNES

Peter Downes – Chartered Building Designer
Dip of Arch Tech – Distinction
Dip of Building Design – Distinction