

No 13
PACIFIC PDE

No 11
PACIFIC PDE

No 9
PACIFIC PDE

No 7
PACIFIC PDE

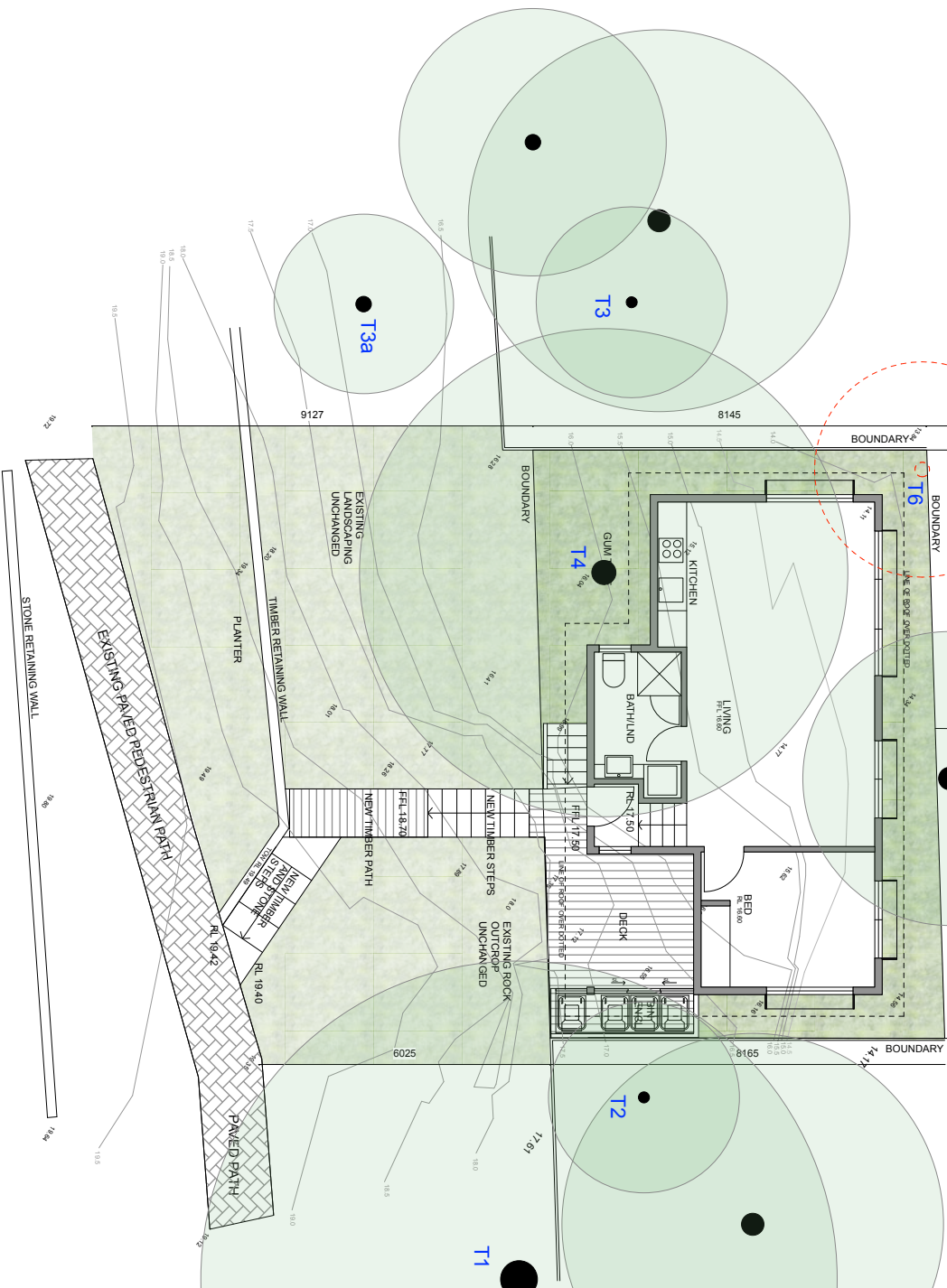

NOTES
REFER TO DETAIL SURVEY FOR SITE INFORMATION & LEVELS
ALL LEVELS AND DIMENSIONS TO BE CONFIRMED ON SITE. IF ANY DISCREPANCIES OCCUR PLEASE NOTIFY THE LANDSCAPE ARCHITECT

ISSUE
A
DRAFT
FOR DA SUBMISSION

DATE
24.11.21
26.11.21

SCALE: 1:100@A3
DRAWN: MW
CLIENT: JAMES BELL

DRAWING TITLE
LANDSCAPE PLAN | EXISTING TREES
PROJECT
40 PINE STREET, MANLY

DWG NO.

LS01

ISSUE

B

4.1 Tree Assessment Table									
Species	Trunk Diameter @ 1.4m	Height	Canopy Spread	Age Class	Health/ Vitality	Structural Condition	Estimated Life Expectancy	Landscape and Environmental Significance	Retention Value
1 Cheuse Tree, <i>Gleditsia ferruginea</i>	35cm, 28cm	7m	7m	Mature	Good	Good	Long (80+ yrs)	2	High
Comments: Locally native species. Likely to have self-sown.									
2 Cheuse Tree, <i>Gleditsia ferruginea</i>	10cm	3m	2m	Early	Good	Good	Long (80+ yrs)	3	Medium
Comments: Locally native species. Likely to have self-sown.									
3 Red Cedar, <i>Teucrium Chama</i>	35cm (approx)	8m	6m	Mature	Good	Good	Long (80+ yrs)	2	High
Comments: Located on the neighbouring property. The trunk diameter was estimated. Planted Australian native.									
4 Coast Banksia, <i>Banksia integrifolia</i>	8cm	3m	1m	Immature	Good	Good	Long (80+ yrs)	3	Medium
Comments: Planted locally native species. Located on the Council verge. Not planted on the survey.									
5 Sydney Blue Gum, <i>Eucalyptus saligna</i>	35cm	16m	8m	Mature	Good	Fair	Long (80+ yrs)	2	High
Comments: Planted (possibly self-sown) Australian native. This species is not found naturally in this locality. There is a surface and actual road width of the northern side up to 2.0m in the blue gum canopy. There is a single mature gum located on the western side of the trees at 2.5m height. This indicates that there is some natural gum canopy. Further testing was recommended and subsequently undertaken to determine the extent of decay and likely effect on trunk stability. Refer to section 4.2 for findings.									
6 Cheuse Island <i>Syzygium tamarindifolium</i>	25cm	5m	2m	Early	Good	Good	Long (80+ yrs)	4	Low
Comments: Vined species. Exempt from protection within the Northern Beaches LGA. Located on the neighbouring property.									

Tree schedule above is from the Aboriginal Impact Assessment and prepared by Bluegum Tree Care and Consultancy November 2021

TREES TO BE RETAINED OR REMOVED

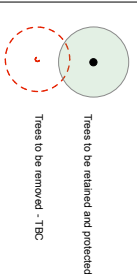

TREE PROTECTION

Any tree to be retained and protected is to be protected throughout the duration of the demolition and construction periods. All tree protection measures and enclosures are to be constructed in accordance with the guidelines of the Aboriginal Impact Assessment.

If damage does occur to a tree, the project/contractor is to attend prior to repairing damage and during repair work. If a tree is damaged and repair work is considered impractical, or is attempted and fails, give notice and obtain instructions.

No 13
PACIFIC PDE

No 11
PACIFIC PDE

No 9
PACIFIC PDE

No 7
PACIFIC PDE

Landscaping in front of
existing retaining wall as

INDICATIVE PLANT SCHEDULE

SPECIES	COMMON NAME	MATURE SIZE	QTY	POT SIZE	NATIVE
TREE + SCREENING + FEATURE PLANTS					
<i>Acmena smithii</i>	Lilly Pilly	3-5m	15	75L	YES*
<i>Banksia spinulosa</i>	Harpoon Banksia	3m	2	75L	YES*
<i>Ceratopetalum gummiifolium</i>	NSW Christmas Bush	5-6m	7	45L	YES*
<i>Greivelia moonlight</i>	Moonlight	3m	5	45L	YES*
<i>Macrozamia communis</i>	Burrowing Palm	1m	17	140mm pot	YES*
SHRUBS					
<i>Blechnum spp</i>	Water Fern	0.5m	10	140mm pot	YES*
<i>Eriostemon australis</i>	Wax Flower	1m	5	9L	YES*
GRASSES					
<i>Liberia paniculata</i>	Flag Grass	0.2m	15	140mm pot	YES*
<i>Lomandra 'Shara'</i>	Shara	0.6m	35	140mm pot	YES
GROUNDCOVERS + CLIMBERS					
<i>False Sarracenia</i>	False Sarracenia	-	5	9L	YES*
<i>Hardenbergia violacea</i>	Wire Vine	-	25	9L	YES*
<i>Muehlenbeckia complexa</i>	Sticks Bill	-	15	140mm pot	YES*
<i>Pelargonium australe</i>	Native Violet	-	50	140mm pot	YES*
<i>Viola hederacea</i>	Codanunda Wallie	2m	2	9L	YES*
COUNCIL PLANTING					
<i>Acacia baileyana</i>	White Correa	1m	3	9L	YES*
<i>Correa alba</i>	Common Correa	1m	3	9L	YES*
<i>Correa reflexa</i>	Blue Flax Lily	0.3m	12	140mm pot	YES*
<i>Dianella caerulea</i>	Purple Grass	0.6m	24	140mm pot	YES*
<i>Dicliptera ciliata</i>	Wax Flower	1m	6	9L	YES*
<i>Eriostemon australis</i>	Running Postman	-	10	140mm pot	YES*
<i>Kennedia rubicunda</i>	Sticks Bill	-	10	140mm pot	YES*
<i>Pelargonium australe</i>	Native Violet	-	10	140mm pot	YES*

NOTE: THE INDICATIVE PLANT SCHEDULE NOMINATES MINIMUM 80% LOCALLY NATIVE PLANT SPECIES. NATIVE SPECIES ARE MARKED YES AND LOCALLY NATIVE SPECIES ARE MARKED YES*

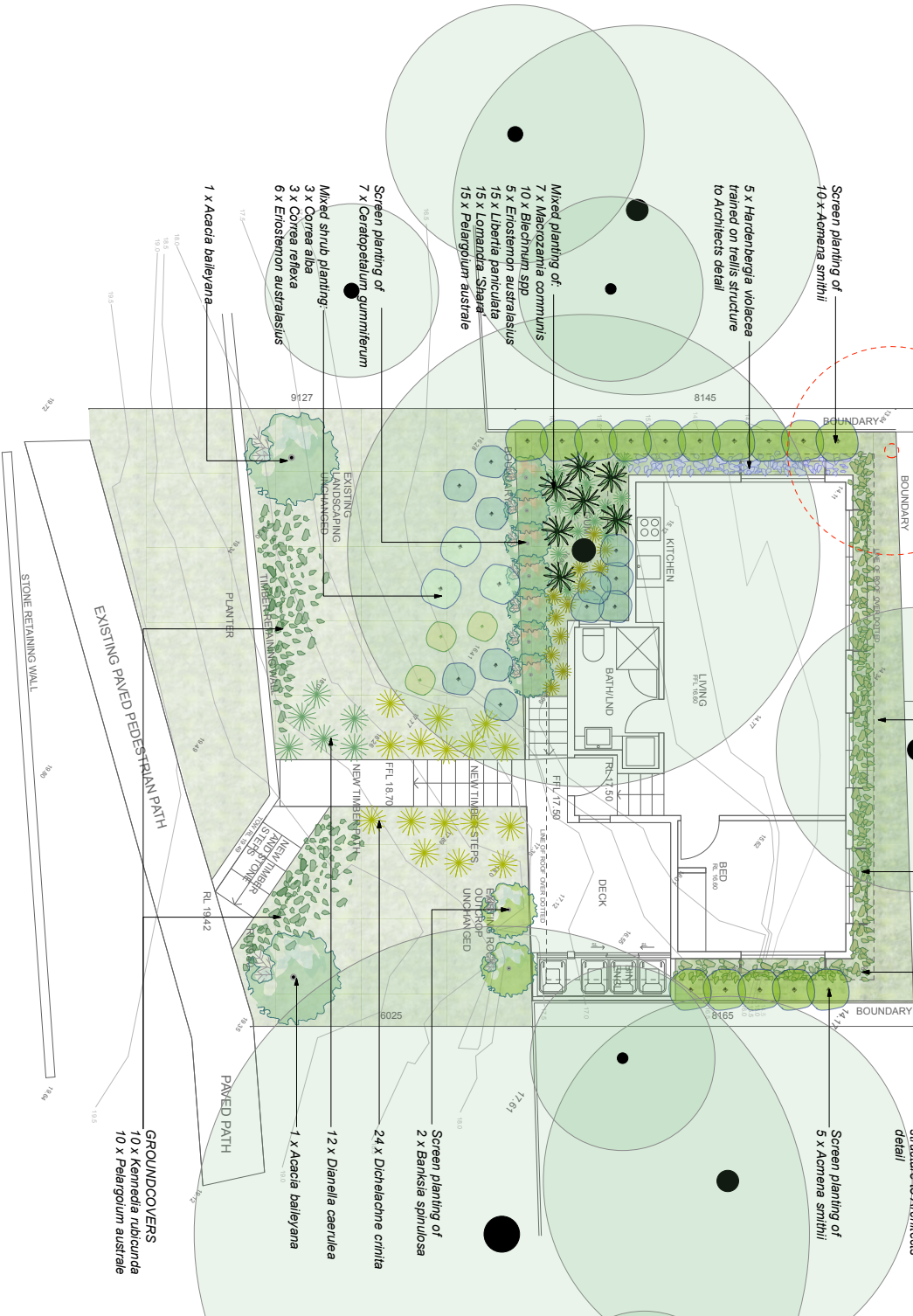

melissa wilson
landscape architects



NOTES
REFER TO DETAIL SURVEY FOR SITE
INFORMATION & LEVELS
ALL LEVELS AND DIMENSIONS TO BE
CONFIRMED ON SITE. IF ANY
DIFFERENCES OCCUR PLEASE
NOTIFY THE LANDSCAPE ARCHITECT

ISSUE
A
DRAFT
DA SUBMISSION

DATE
24.11.21
26.11.21

SCALE: 1:100@A3
DRAWN: MW
CLIENT: JAMES BELL

DRAWING TITLE

LANDSCAPE PLAN | PROPOSED PLANTING LAYOUT

PROJECT

40 PINE STREET, MANLY

DWG NO.

ISSUE

LS02
B





Correa reflexa



Eriostemon australasium

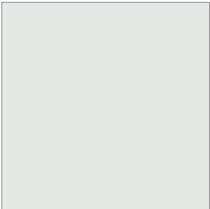
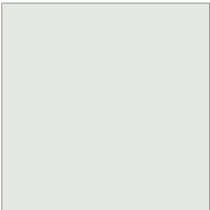

Acmena smithii



Banksia spinulosa

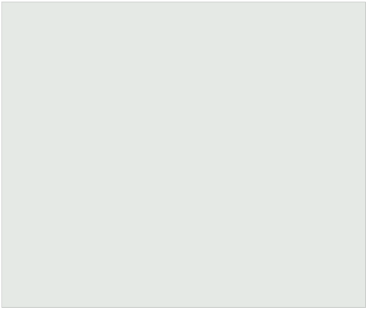

Dichelachne cirrha



Lomandra 'Shara'

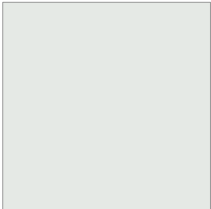
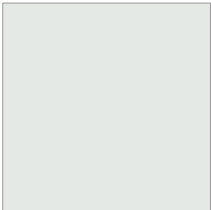

Beechum 'spp.



Dianella caerulea



Libertia paniculata



Viola hederacea



Ceratopetalum gummiferum



Grevillea 'Moonlight'

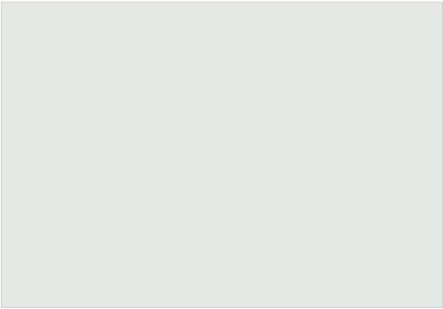

Kennedia rubicunda



Pelargonium australe

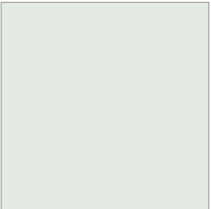
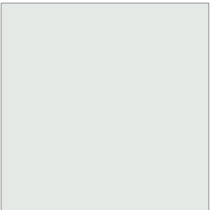

Hardenbergia violacea



Muellerbeckia complexa

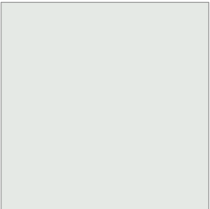
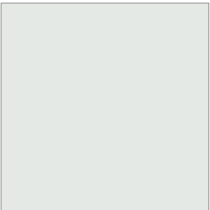

Macrozamia communis

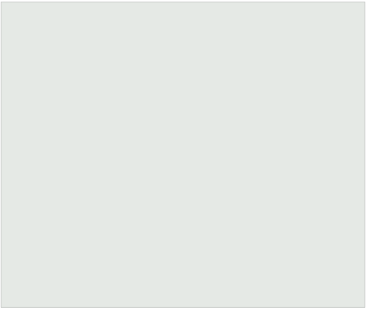

SHRUBS

GRASSES

SHADE TOLERANT
GROUNDCOVERS +
GRASSES + FERNS

GROUNDCOVERS

CLIMBERS

Correa reflexa

Eriostemon australasium

Dichelachne cirrha

Lomandra 'Shara'

Beechum 'spp.

Dianella caerulea

Libertia paniculata

Viola hederacea

Kennedia rubicunda

Pelargonium australe

Hardenbergia violacea

Muellerbeckia complexa

NOTES

REFER TO DETAIL SURVEY FOR SITE
INFORMATION & LEVELS
ALL LEVELS AND DIMENSIONS TO BE
CONFIRMED ON SITE. IF ANY
DISCREPANCIES OCCUR PLEASE
NOTIFY THE LANDSCAPE ARCHITECT

ISSUE

A DRAFT
FOR DA SUBMISSION

DATE

24.11.21
26.11.21

SCALE: NTS@A3

DRAWN: MW
CLIENT: JAMES BELL

DRAWING TITLE

LANDSCAPE PLAN | PROPOSED PLANT SPECIES
PROJECT
40 PINE STREET, MANLY

DWG NO.

ISSUE

LS03
B

