

Datum: Paved area at u/s of timber balcony Deck (●) R.L.133.80
Top of finished pool coping R.L.133.80 (or level with datum).

Proposed location of replacement tree as required under permit TA2019/0272.

Pool equipment to be located under timber balcony.
Equipment to be housed in soundproof enclosure.

Proposed 1800H. privacy screen, to be in accordance with A.S 1926.1 - 2012 & the Swimming Pools Act, 1992.

Proposed in-ground reinforced concrete swimming pool with integral walkway surrounds.

Proposed 1200H. childproof safety fence with sc/sl gate, to be in accordance with A.S 1926.1 - 2012 & the Swimming Pools Act, 1992.

Approx. line of boards sewer.

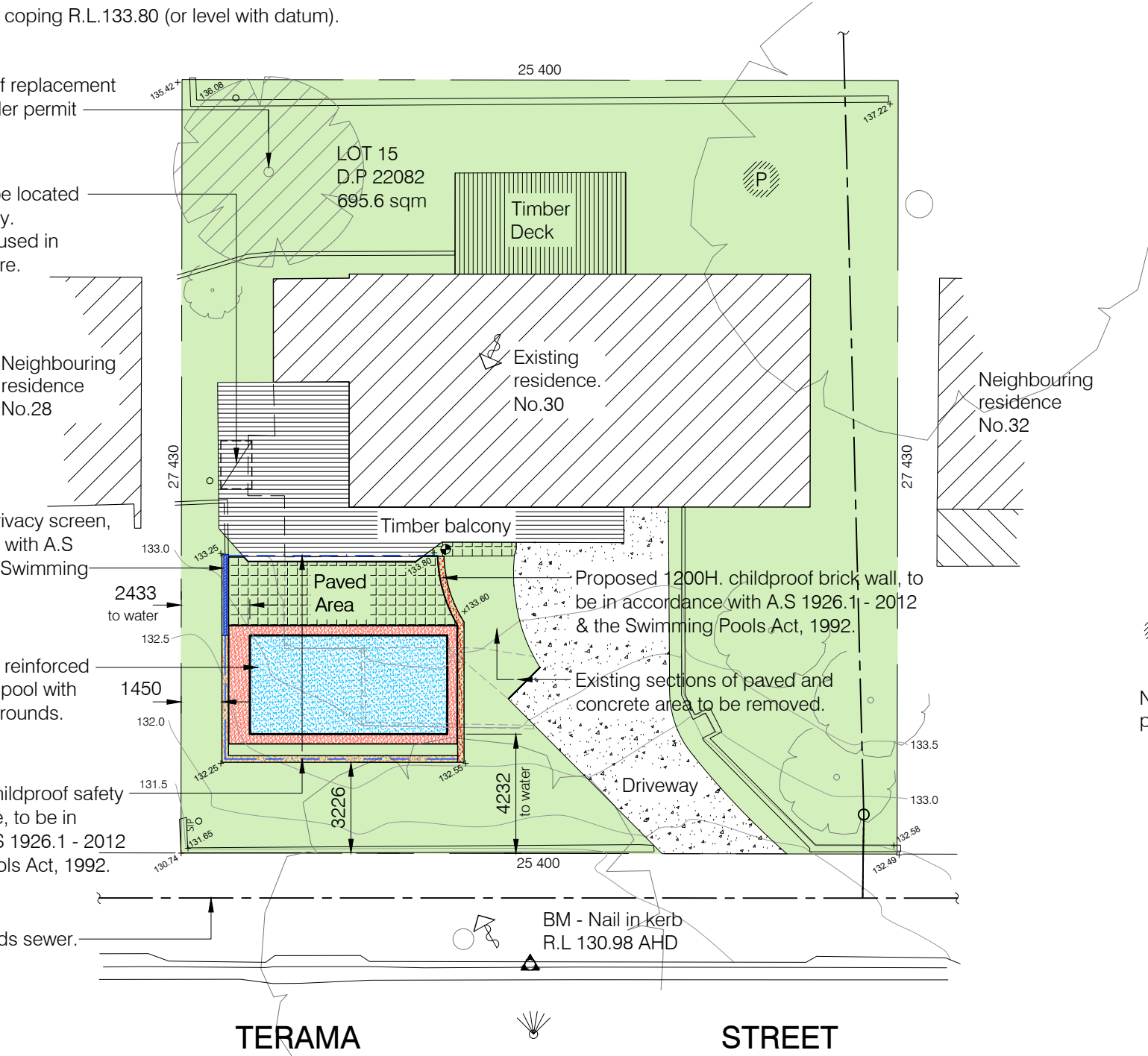

SITE PLAN / SITE ANALYSIS PLAN

SYMBOL LEGEND

- Private open space
- Prevailing winds
- Noise source
- Existing ground spot levels

LANDSCAPED AREA CALCULATIONS

SITE AREA
Total Site Area..... 695.6 sqm

EXISTING HARD SURFACE AREA
Residence..... 145.0 sqm
Timber balcony (>1.0m above n.g.l)..... 43.0 sqm
Driveway..... 56.5 sqm

PROPOSED HARD SURFACE AREA
Proposed pool & surrounds..... 34.0 sqm
Total hard surface area..... 278.5 sqm
% of hard surface area is 278.4 / 695.6..... 39.9%

EXISTING HARD SURFACE AREA - VARIATIONS
Timber deck (<1.0m above n.g.l)..... 21.8 sqm
Paved area..... 19.1 sqm
Total hard surface area variation..... 40.9 sqm
% of hard surface area variation is 40.9 / 695.6... 5.9%

PROPOSED LANDSCAPED AREA
Pervious / landscaped area..... 377.0 sqm
Hard surface area variations..... 40.9 sqm
Total landscaped area..... 417.9 sqm
% of landscaped area is 417.9 / 695.6..... 60.1%
Minimum required LANDSCAPED AREA = 60%

TOTAL POOL VOLUME = 27,000 LT
POOL VOLUME LESS THAN 40,000 LT THEREFORE
EXEMPT FROM BASIX REQUIREMENTS

Plan prepared by:
POOL PLANS BY DESIGN
A.B.N 86375033089 P.O Box 585, Ryde NSW 1680 PH:0405 255 779

| | | | | |
|--|-------------|------------|----------|---------|
| | | | | |
| REVISION | DESCRIPTION | DATE | | |
| SITE PLAN & SITE ANALYSIS PLAN | | | | |
| PROPOSED SWIMMING POOL WOODLINE CONSTRUCTIONS LOT 15 DP 222082 No.30 TERAMA STREET, BILGOLA PLATEAU | | | | |
| DRAWN BY | DATE | SCALE | DWG. No. | JOB No. |
| G.P | 25-07-19 | 1:200 @ A3 | DA-01 | P06-19 |

