

STORMWATER MANAGEMENT PLAN

PROPOSED SINGLE DWELLING DEVELOPMENT

Lot 3, No 73 LORIKEET GROVE, WARRIEWOOD

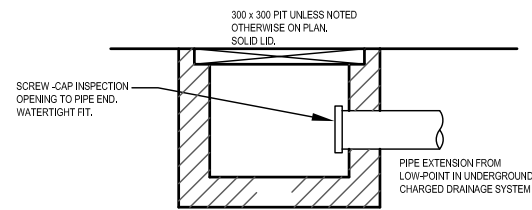

TYPICAL DETAIL - CHARGED SYSTEM CLEANOUT PIT

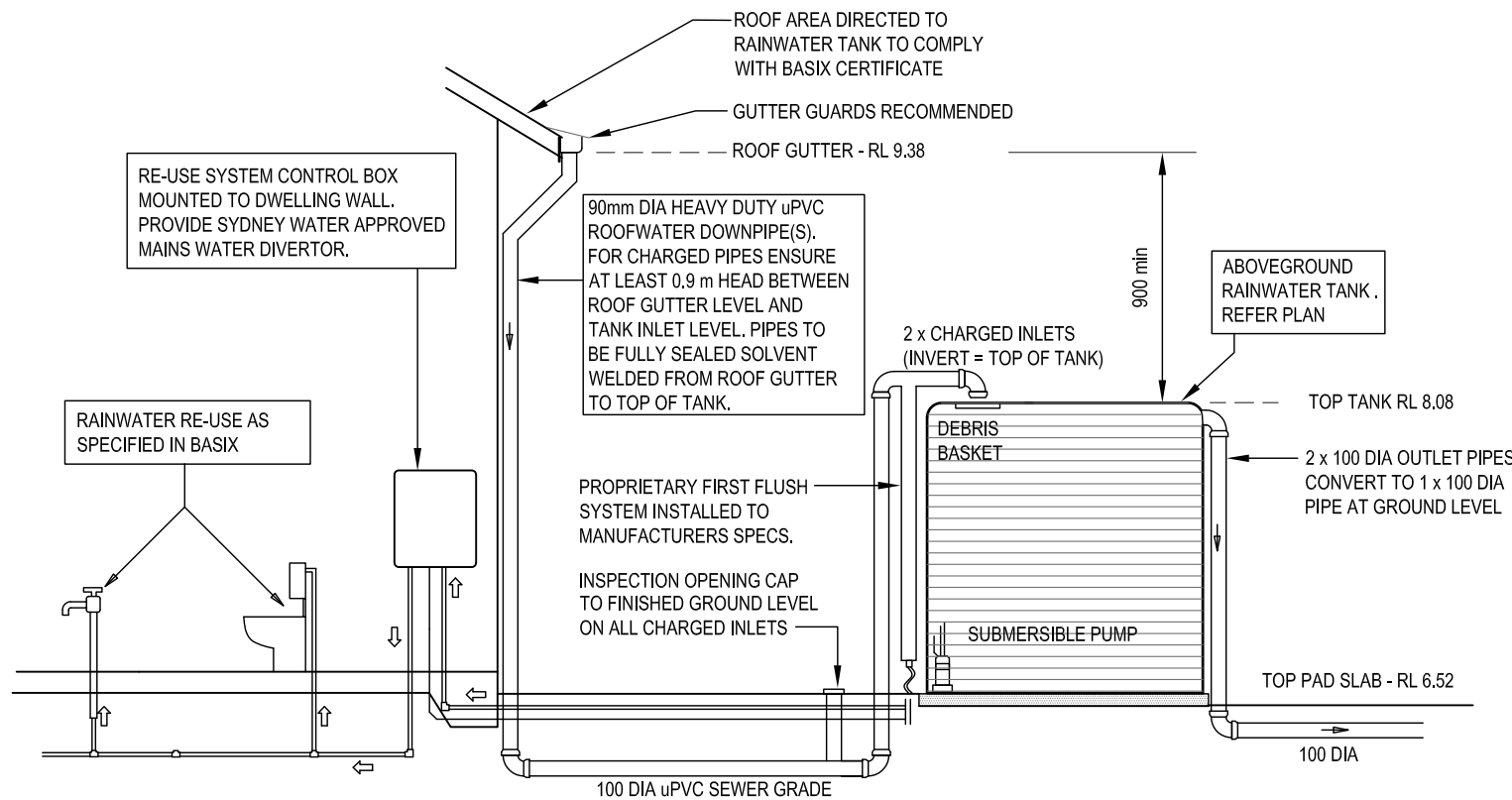

TYPICAL DETAIL - RAINWATER RE-USE TANK

LEGEND

	GRATED INLET PIT
450x450	450 SQUARE INTERNAL
GRT 75.54	GRATE LEVEL = 75.54
IL 75.12	INVERT LEVEL = RL 75.12
	PROPOSED DOWNPIPE No 5. 90mm dia. or 100mm x 50mm min.
	EXISTING TREE
	GRATED TRENCH DRAIN
	PROPOSED ROOF GUTTER FALL
	PROPOSED DOWNPIPE SPREADER
	STORMWATER PIPE 100mm dia min UNO
	SUBSOIL PIPE
	INSPECTION OPENING
	CONNECTION No 02, REFER SHEET D3 FOR CONTINUATION
	RAINWATER HEAD
	SUBSOIL CLEANOUT
	BALCONY OUTLET

GENERAL NOTES

- FINAL LOCATION OF NEW DOWNPIPES TO BE DETERMINED BY BUILDER/ARCHITECT AT TIME OF CONSTRUCTION.
- THESE DRAWINGS TO BE READ IN CONJUNCTION WITH ARCHITECTS AND OTHER CONSULTANTS DRAWINGS. ANY DISCREPANCIES TO BE REFERRED TO THE ENGINEER BEFORE PROCEEDING WITH WORK.
- ALL MATERIALS AND WORKMANSHIP TO BE IN ACCORDANCE WITH AS/NZS 3500.3:2003 STORMWATER DRAINAGE, BCA AND LOCAL COUNCIL POLICY/CONSENT/REQUIREMENTS.
- ALL DIMENSIONS AND LEVELS TO BE VERIFIED BY BUILDER ON-SITE PRIOR TO COMMENCEMENT OF WORKS. THESE DRAWINGS ARE NOT TO BE SCALED FOR DIMENSIONS NOR TO BE USED FOR SETOUT PURPOSES.
- ALL SURVEY INFORMATION AND PROPOSED BUILDING AND FINISHED SURFACE LEVELS SHOWN IN THESE DRAWINGS ARE BASED ON LEVELS OBTAINED FROM DRAWINGS BY OTHERS.
- THESE DRAWINGS DEPICT THE DESIGN OF SURFACE STORMWATER RUNOFF DRAINAGE SYSTEMS ONLY AND DO NOT DEPICT ROOF DRAINAGE OR SUBSOIL DRAINAGE SYSTEMS UNLESS NOTED OTHERWISE. THE DESIGN OF ROOF AND SUBSOIL DRAINAGE SYSTEMS IS THE RESPONSIBILITY OF OTHERS.
- ALL STORMWATER DRAINAGE PIPES ARE TO BE 100mm DIAMETER uPVC AT MINIMUM 1% GRADE UNLESS NOTED OTHERWISE.
- IT IS THE CONTRACTORS RESPONSIBILITY TO LOCATE AND LEVEL ALL EXISTING SERVICES OR OTHER STRUCTURES WHICH MAY AFFECT/BE AFFECTED BY THIS DESIGN PRIOR TO COMMENCEMENT OF WORKS.
- ALL PITS WITHIN DRIVEWAYS TO BE 150mm THICK CONCRETE OR EQUAL.
- THIS PLAN IS THE PROPERTY OF STORMCIVIL AND MAY NOT BE USED OR REPRODUCED WITHOUT WRITTEN PERMISSION FROM STORMCIVIL.

LOCATION	MINIMUM PIPE COVER (mm) (FROM FINISHED SURFACE TO TOP OF PIPE)	
	CAST/DUCTILE IRON GAL STEEL	OTHER AUTHORISED PRODUCTS (*)
1. NOT SUBJECT TO VEHICULAR LOADING:		
A. WITHOUT PAVEMENT:		
I. FOR SINGLE DWELLINGS -	0	100
II. OTHER THAN SINGLE DWELLINGS -	0	300
B. WITH PAVEMENT OF BRICK/UNREINFORCED CONCRETE -	0 (**)	50 (**)
2. SUBJECT TO VEHICULAR LOADING:		
A. OTHER THAN ROADS:		
I. WITHOUT PAVEMENT -	300	450
II. WITH PAVEMENT OF:		
- REINF. CONC. FOR HEAVY VEHICLES -	0 (** #)	100 (** #)
- BRICK/UNREINF. CONC LIGHT VEHICLES -	0 (** #)	75 (** #)
B. ROADS		
I. SEALED	300	500 (#)
II. UNSEALED	300	500 (#)
3. SUBJECT TO CONSTRUCTION VEHICLES OR IN EMBANKMENT CONDITIONS	300	500 (#)

(*) INCLUDES OVERLAY ABOVE THE TOP OF THE PIPE OF NOT LESS THAN 50mm THICK
 (**) BELOW THE UNDERSIDE OF THE PAVEMENT
 (#) SUBJECT TO COMPLIANCE WITH AS1762, AS2033, AS2968.1, AS3725 OR AS 4080

ISS	DATE	AMENDMENT
C	11.02.2020	DPS - DA ISSUE
B	10.02.2020	DPS and ADDITIONAL DRAINAGE POINT - DA ISSUE
A	11.12.2019	DA ISSUE

ARCHITECT/BUILDER	ARCH. REF : 29913970
CLARENDON HOMES	
OWNER	CARRAGHER
LGA	NORTHERN BEACHES (ex PITTWATER)

StormCivil

Consulting Engineers
Civil & Environmental,
Stormwater Management.

3 Gresham Street,
Cowan NSW 2250
ph/fax (02) 9456 7233
mobile : 0424023047
mark@stormcivil.com.au

Pty Ltd. ABN 71 612 151 461

DWG TITLE	LEGEND, NOTES, DETAILS, CALCULATIONS
PROJECT TITLE	PROPOSED SINGLE DWELLING DEVELOPMENT Lot 3, No 73 LORIKEET GROVE, WARRIEWOOD

APPROVED ON BEHALF OF
STORMCIVIL PTY LTD

StormCivil

Mark Taylor
MIE Aust CP Eng NER 173333

JOB No	DWG No	No IN SET	ISSUE
304137	D1	2	C

NORTH

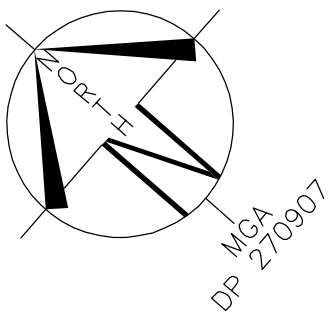

- (B) EASEMENT TO DRAIN WATER 2.5 WIDE (VIDE DP1206507)
- (BB) EASEMENT TO DRAIN WATER 2.5 WIDE
- (CC) EASEMENT TO DRAIN WATER 2 WIDE
- (EE) EASEMENT FOR ACCESS, MAINTENANCE AND SUPPORT 0.9 WIDE
- (HH) EASEMENT TO DRAIN WATER 1.5 WIDE
- (O) EASEMENT FOR ACCESS, CONSTRUCTION AND MAINTENANCE 0.9 WIDE

LOT 3
D.P: 270907
L.G.A: NORTHERN BEACHES

SITING HAS BEEN COMPLETED
IN ACCORDANCE WITH
PITTWATER DCP 21 - D16

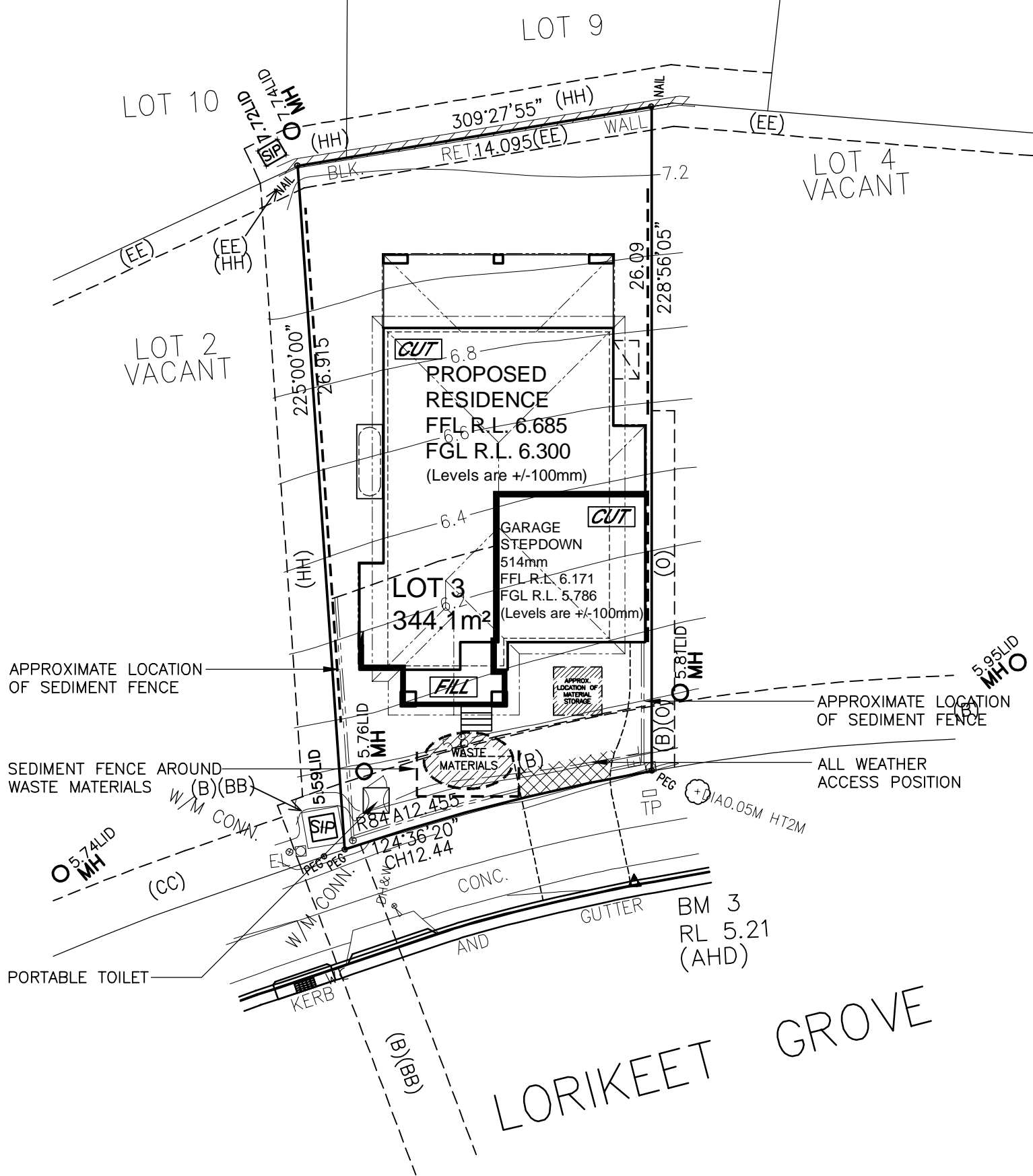

CONSTRUCTION MANAGEMENT PLAN EROSION AND SEDIMENT CONTROL PLAN

NOTE:
 TEMPORARY SECURITY FENCING TO THE PERIMETER OF THE BOUNDARY WHERE REQUIRED TO PREVENT PUBLIC ACCESS ONTO THE SITE

NOTE:
 GROUND LINES ARE APPROXIMATE. EXTENT OF CUT AND FILL BATTERS WILL BE DETERMINED ON SITE. SEDIMENT BARRIERS ARE CUSTOMISED TO SITE CONDITIONS

SEDIMENT CONTROL NOTES

- ALL EROSION AND SEDIMENTATION CONTROL MEASURES, INCLUDING REVEGETATION AND STORAGE OF SOIL AND TOPSOIL, SHALL BE IMPLEMENTED TO THE STANDARDS OF THE SOIL CONSERVATION OF NSW AND INSPECTED DAILY BY THE SITE MANAGER.
- ALL DRAINAGE WORKS SHALL BE CONSTRUCTED AND STABILIZED AS EARLY AS POSSIBLE DURING DEVELOPMENT.
- SEDIMENT TRAPS SHALL BE CONSTRUCTED AROUND ALL INLET PITS, CONSISTING OF 300mm WIDE x 300mm DEEP TRENCH.
- ALL SEDIMENT BAGS AND TRAPS SHALL BE CLEANED WHEN THE STRUCTURES ARE A MAXIMUM OF 80% FULL OF SOIL MATERIALS, INCLUDING THE MAINTENANCE PERIOD.
- ALL DISTURBED AREAS SHALL BE REVEGETATED AS SOON AS THE RELEVANT WORKS ARE COMPLETED.
- SOIL AND TOPSOIL STOCKPILES SHALL BE LOCATED AWAY FROM DRAINAGE LINES AND AREA WHERE WATER MAY CONCENTRATE. ALL ROADS AND FOOTPATHS TO BE SWEEPED DAILY.
- FILTER SHALL BE CONSTRUCTED BY STRETCHING A FILTER FABRIC (PROPEX OR APPROVED EQUIVALENT BETWEEN POST AT 3.0m CENTRES. FABRIC SHALL BE BURIED 150mm ALONG ITS LOWER EDGE.
- DUST PREVENTION MEASURES TO BE MAINTAINED AT ALL TIMES.

SEDIMENT FENCE
 NOT TO SCALE

CLIENT'S SIGNATURE: _____ DATE: _____

ClarendonHomes
 BL No. 2298C
 ABN 18 003 892 706
 Clarendon Homes (NSW) P/L
 21 Solent Circuit, Baulkham Hills NSW 2153
 T: (02) 8851 5300

© ALL RIGHTS RESERVED
 This plan is the property of CLARENDON HOMES (NSW) P/L
 Any copying or altering of the drawing shall not be undertaken without written permission from CLARENDON HOMES (NSW) P/L
 # ALL DIMENSIONS TO STRUCTURAL ELEMENTS. DIMENSIONS TO BE READ IN PREFERENCE TO SCALING.

PRODUCT:
BRONTE 26
 Hamptons
 R/H Garage
 Sapphire Specification

CLIENT:
 Mr. CARRAGHER
 Mrs. CARRAGHER
 SITE ADDRESS:
 Lot 3 No.73, D.P: 270907
 Lorikeet Grove
 WARRIEWOOD 2102

DA DRAWINGS			
DRAWN: PG.	DATE: 26.11.19	Rev: G	
RATIO @ A3: 1:200	CHECKED: J.S		
SHEET: 2.1	JOB No: 29913970	NSW	