

notes

To be read in conjunction with hydraulic engineer drawings.

Legend

**Roof:**  
 rs corrugated copper sheeting, cappings, etc  
 g copper gutters  
 dp round copper down pipes

**Softit:**  
 fc set fibre cement  
 sl plywood softit lining

**Solar Panels:**

ta Type A: Solar hot water panels with remote storage  
 tb Type B: Photovoltaic cells

**Walls:**

**External:**

fer(c) Fine cement render to concrete (Colour: Porters' mineral or similar)  
 s Coursed sandstone

**Internal:**

rm Rendered masonry  
 tm Tiles on masonry

**Floors:**

st Stone tiling  
 sp Stone paving  
 hd Hardwood decking

**Ceilings:**

pb Set plaster board

**Windows:**

stw Sliding timber windows  
 fg fixed glass

**Doors:**

std Sliding timber framed doors  
 gd panel lift garage door

**Louvers/Screens:**

hss Hardwood timber slatted screen  
 fml Fixed metal louvers

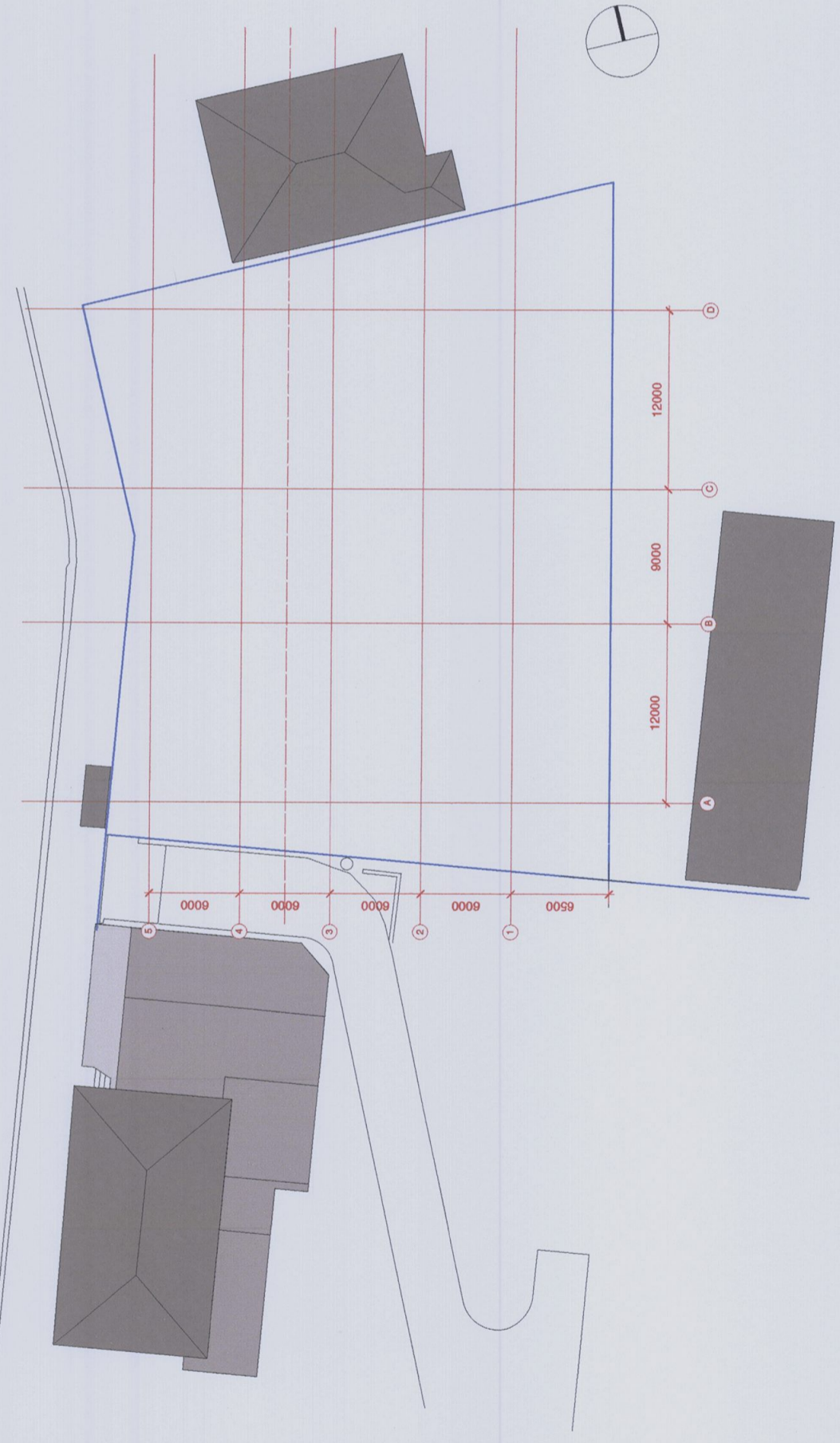

OCT 09 A DEVELOPMENT APP.

date issue

amendments

drawing : site grid

dwg no. : DA 03

scale : 1:200@A1 / 1:400@A3

date : OCT 09

drawn :

checked :

1112-1118 Barrenjoey Road  
 Palm Beach

LESJUK ARCHITECTS PTY LTD  
 the studio, 1118 barrenjoey road palm beach nsw  
 po box 30 palm beach nsw 2108  
 telephone 612 9974 1010 faxsimile 612 9974 6502  
 email lesjukarchitects@bigpond.com