

Landscape Referral Response

Application Number:	DA2025/0265
Date:	10/04/2025
Proposed Development:	Demolition works and construction of a dwelling house including a swimming pool
Responsible Officer:	Kye Miles
Land to be developed (Address):	Lot 15 DP 14433 , 231 Alfred Street CROMER NSW 2099

Reasons for referral

This application seeks consent for the following:

- Construction / development works within 5 metres of a tree or
- New residential works with three or more dwellings. (RFB's, townhouses, seniors living, guesthouses, etc). or
- Mixed use developments containing three or more residential dwellings.
- New Dwellings or

Officer comments

The application seeks consent for: Demolition works and construction of a dwelling house including a swimming pool.

The Survey Plan indicates that a rock outcrop runs along the south western boundary in the rear yard. The outcrop is noted on the Site Analysis Plan.



P4



P5

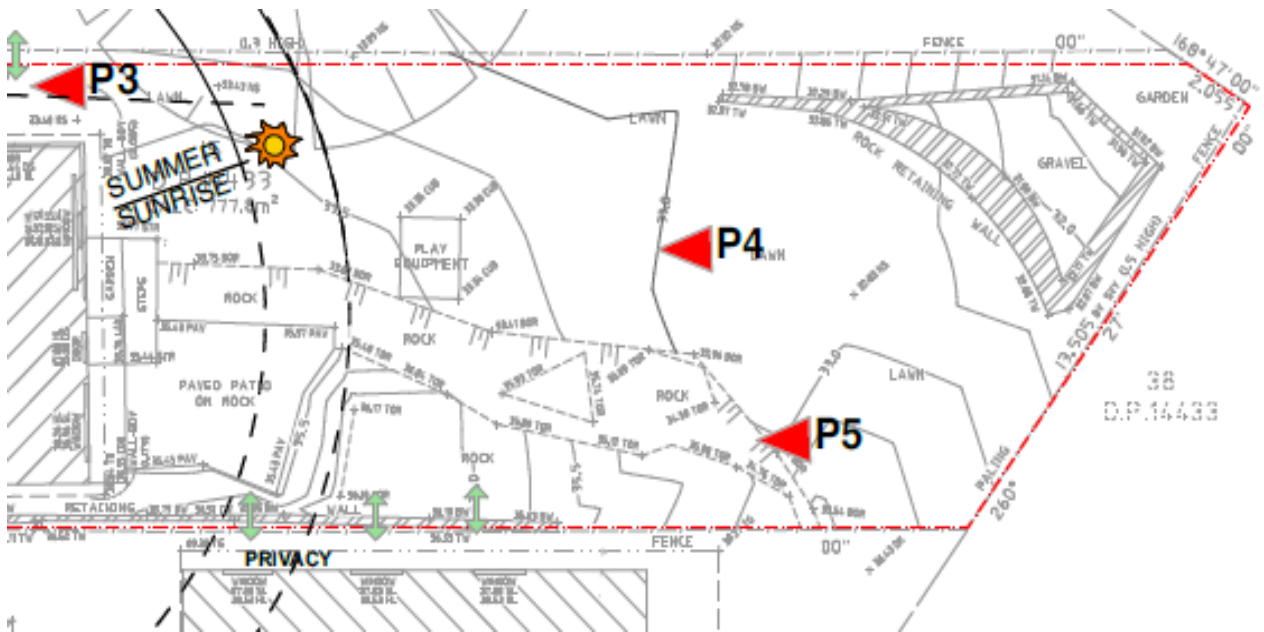

The Architectural Plans indicate that the new dwelling is located largely above the rock outcrop, with a small section only requiring removal.

Review of the Survey Plan levels and Ground Floor level indicates that some localised levelling at the top the rock will likely be required.

It is apparent that the intent is to retain the majority of the rock outcrop in the rear yard.

Given the size of the outcrop, it may be advisable to seek comment from the AHO regarding potential for sites of significance.

From a landscape perspective, the retention of the majority of the rock is supported.

No trees are indicated for removal on the site.

No objections are raised regarding landscape issues subject to conditions as recommended.

The proposal is therefore supported.

Note: Should you have any concerns with the referral comments above, please discuss these with the Responsible Officer.

Recommended Landscape Conditions:

CONDITIONS TO BE COMPLIED WITH DURING DEMOLITION AND BUILDING WORK

Protection of Rock and Sites of Significance

All rock outcrops outside of and below the area of approved works (i.e below the new dwelling) are to be preserved and protected at all times during demolition excavation and construction works. Minor levelling at the top of the rock may be undertaken to achieve approved ground floor levels if required.

Should any Aboriginal Cultural Heritage items be uncovered during earthworks, works should cease in the area and the Aboriginal Heritage Office contacted to assess the finds.

Under Section 89a of the NPW Act should the objects be found to be Aboriginal, NSW Biodiversity and Conservation Division, Heritage NSW and the Metropolitan Local Aboriginal Land Council (MLALC) should be contacted.

Reason: Preservation of significant environmental features.

Tree and Vegetation Protection

- a) Existing trees and vegetation shall be retained and protected, including:
 - i) all trees within the site not indicated for removal on the approved Plans,
 - ii) all trees and vegetation located on adjoining properties,
 - iii) all trees and vegetation within the road reserve.
- b) Tree protection shall be undertaken as follows:
 - i) tree protection shall be in accordance with AS4970-2009 Protection of trees on development sites,
 - ii) existing ground levels shall be maintained within the tree protection zone of trees to be retained, unless authorised by an Arborist/Project Arborist with minimum AQF Level 5 in arboriculture,
 - iii) removal of existing tree roots at or >25mm (Ø) diameter is not permitted without consultation with an Arborist/Project Arborist with minimum AQF Level 5 in arboriculture,
 - iv) no excavated material, building material storage, site facilities, nor landscape materials are to be placed within the canopy dripline of trees and other vegetation required to be retained,
 - v) structures are to bridge tree roots at or >25mm (Ø) diameter unless directed by an Arborist/Project Arborist with minimum AQF Level 5 in arboriculture on site,
 - vi) excavation for stormwater lines and all other utility services is not permitted within the tree protection zone, without consultation with an Arborist/Project Arborist with minimum AQF Level 5 in arboriculture including advice on root protection measures,
 - vii) should either or all of v) or vi) occur during site establishment and construction works, an Arborist/Project Arborist with minimum AQF Level 5 in arboriculture shall provide recommendations for tree protection measures. Details including photographic evidence of works undertaken shall be submitted by the Arborist/Project Arborist to the Principal Certifier,
 - viii) any temporary access to, or location of scaffolding within the tree protection zone of a protected tree or any other tree to be retained during the construction works is to be undertaken using the protection measures specified in sections 4.5.3 and 4.5.6 of AS4970-2009 Protection of trees on development sites,
 - ix) the activities listed in section 4.2 of AS4970-2009 Protection of trees on development sites, shall not occur within the tree protection zone of any tree on the lot or any tree on an adjoining site,
 - x) tree pruning from within the site to enable approved works shall not exceed 10% of any tree canopy, and shall be in accordance with AS4373-2007 Pruning of amenity trees,

- xi) the tree protection measures specified in this clause must: i) be in place before work commences on the site, and ii) be maintained in good condition during the construction period, and iii) remain in place for the duration of the construction works.

The Principal Certifier must ensure that:

- c) The arboricultural works listed in a) and b) are undertaken and with AS4970-2009 Protection of trees on development sites.

Reason: Tree and vegetation protection.

Condition of Trees

During the construction period the applicant is responsible for ensuring all existing trees required to be retained are maintained in a healthy and vigorous condition. This is to be done by ensuring that all identified tree protection measures are adhered to or by seeking arboricultural advice from an Arborist with minimum AQF Level 5 in arboriculture during the works.

In this regard all protected trees shall not exhibit:

- i) a general decline in health and vigour,
- ii) damaged, crushed or dying roots due to poor pruning techniques,
- iii) more than 10% loss or dieback of roots, branches and foliage,
- iv) mechanical damage or bruising of bark and timber of roots, trunk and branches,
- v) yellowing of foliage or a thinning of the canopy untypical of its species,
- vi) an increase in the amount of deadwood not associated with normal growth,
- vii) an increase in kino or gum exudation,
- viii) inappropriate increases in epicormic growth that may indicate that the plants are in a stressed condition,
- ix) branch drop, torn branches and stripped bark not associated with natural climatic conditions.

Any mitigating measures and recommendations required by the Arborist are to be implemented.

The owner of the adjoining allotment of land is not liable for the cost of work carried out for the purpose of this clause.

Reason: Protection of trees.

CONDITIONS WHICH MUST BE COMPLIED WITH PRIOR TO THE ISSUE OF THE OCCUPATION CERTIFICATE

Landscape Completion

Landscape works are to be implemented in accordance with Landscape Plan Dwg No. DA-2.7 Rev A dated 3/3/2025 prepared by GAEA Architects, and inclusive of the following conditions:

- a) landscape works are to be contained within the legal property boundaries,
- b) all tree planting shall be a minimum pre-ordered planting size of 75 litres or as otherwise scheduled if greater in size; meet the requirements of Natspec - Specifying Trees; planted into a prepared planting hole 1m x 1m x 600mm depth, backfilled with a sandy loam mix or approved similar, mulched to 75mm depth minimum and maintained, and watered until established; and located either within garden bed or within a prepared bed within lawn,

- c) tree, shrub and groundcover planting shall be installed as indicated on the approved Landscape Plan,
- d) all proposed tree planting shall be positioned in locations to minimise significant impacts on neighbours in terms of blocking winter sunlight to living rooms, private open space and where the proposed location of trees may otherwise be positioned to minimise any significant loss of views from neighbouring and nearby dwellings and from public spaces,
- e) where swimming pools are part of the development works, selected planting shall comply with the planting and care requirements of AS1926.1 for a non-climbable zone,

Prior to the issue of an Occupation Certificate, details (from a qualified landscape architect, landscape designer or horticulturalist) shall be submitted to the Principal Certifier, certifying that the landscape works have been completed in accordance with any conditions of consent.

Reason: Environmental amenity.