

DIMENSIONS REFLECTED IN THIS PLAN MAY NEED TO BE CONFIRMED BY EXCAVATION EXPOSING THE SYDNEY WATER ASSET PRIOR TO CONSTRUCTION COMMENCING ON SITE

LEGEND:

| | | | | | |
|--|----------------------------------|-----|---------------------------|------|---------------------------|
| | SEWER MAIN AND DIRECTION OF FLOW | | POTABLE WATER MAIN | VC | VITRIFIED CLAY |
| | SYDNEY WATER SEWER MAN-HOLE | | HYDRANT | S.O. | SQUARE OFF |
| | MAINTENANCE SHAFT | | STOP VALVE | PEG | PEG IN GROUND |
| | RODDING POINT | | DUCTILE IRON CEMENT LINED | NAIL | NAIL IN GROUND OR ON WALL |
| | VENTSHAFT (INDUCT OR EDUCT) | EW | EARTHENWARE | BDY | BOUNDARY |
| | VERTICAL RISER | RC | REINFORCED CONCRETE | EX. | EXISTING |
| | P.C.P. OR JUNCTION | SGW | SALT GLAZED WARE | DN | DIAMETER PEG |
| | | C/L | CENTRE LINE | | |

NOTES:

- CONTRACTOR TO LOCATE LINE, LEVEL AND SIZE OF ALL THE EXISTING SERVICES (AS PER NOTE ON PLAN) WITHIN THE VICINITY OF ANY NEW WORKS AND REPORT ANY CONFLICT TO SITE SUPERINTENDENT PRIOR TO ANY CONSTRUCTION COMMENCING
- Ausflow PTY LTD
Ph: (02) 9555 7979
Email: info@ausflowsydney.com.au
Web: www.ausflowsydney.com.au
ALLOCATED AS PEG-OUT / ASSET LOCATORS FOR SYDNEY WATER
- THE LOCATION OF THE ASSETS SPECIFIED ON THIS PLAN ARE REFLECTED IN ACCORDANCE WITH SURVEYORS MARKINGS OR PEGS. MEASUREMENTS MAY HAVE ALSO BEEN TAKEN FROM EX. FENCES AND HYDRA
- THIS PLAN IS NOT TO SCALE, DO NOT SCALE FROM THIS PLAN REFER DIMENSIONS SHOWN
- SYDNEY WATER WORK AS EXECUTED (WAE) RECORDS AND HYDRA MAY HAVE BEEN USED TO ASSIST IN DETERMINING THE LOCATIONS AND DEPTHS OF THE ASSETS SPECIFIED IN THIS PLAN

FENCE LINES AND STRUCTURES MAY NOT BE TRUE BOUNDARY MARKS ON SITE.

SEWER LOCATED VIA PROBING ON SITE.
PEGS AND PAINT USED TO MARK OUT SEWER ON SITE.

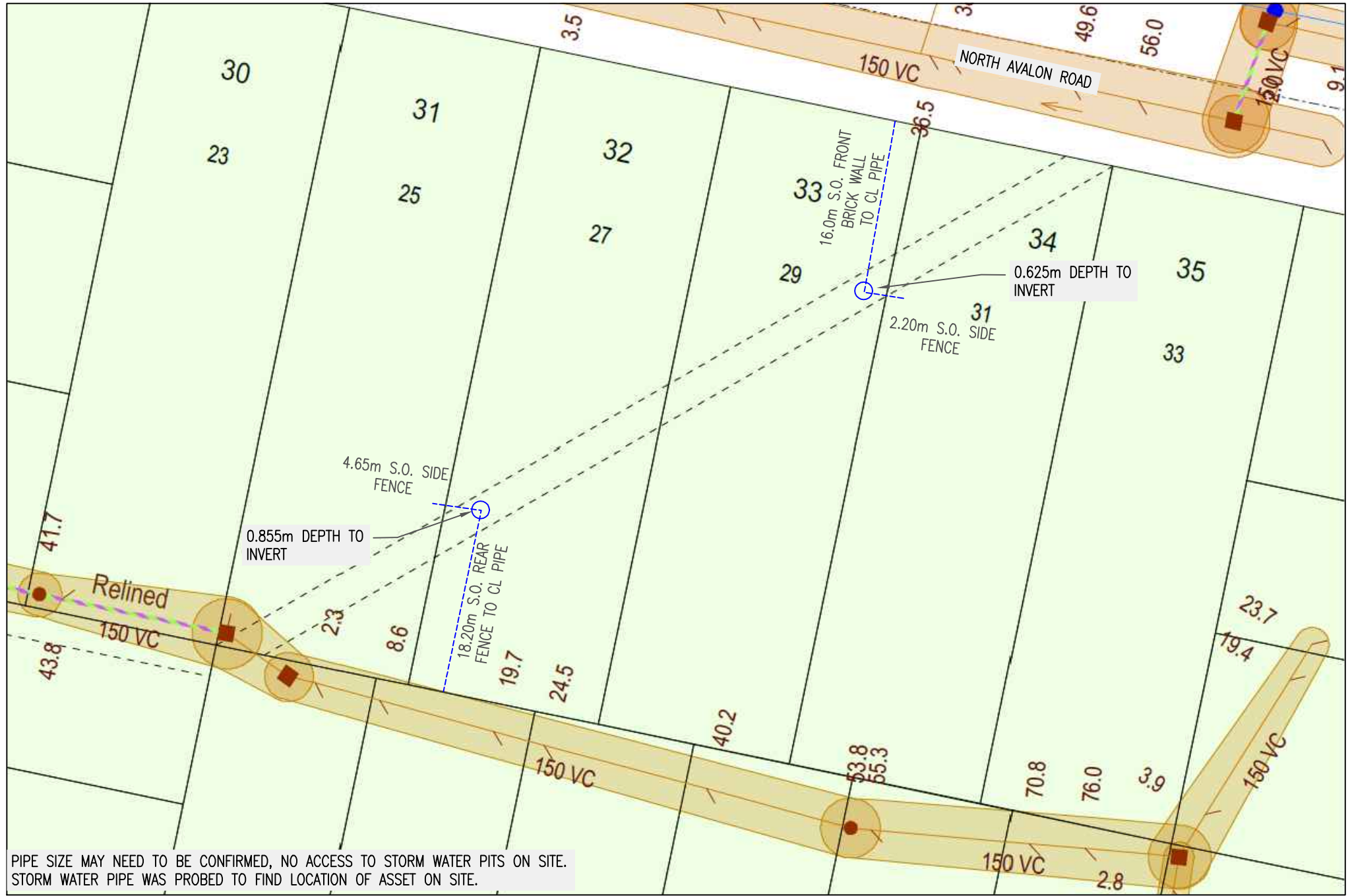

PLAN TO BE READ IN CONJUNCTION WITH CURRENT SURVEY PLAN

PRIOR TO COMMENCEMENT OF EXCAVATION FOR PROPOSED AND / OR EXISTING SERVICES CONTACT:

DIAL BEFORE YOU DIG Ph. 1100
ELECTRICITY AUSGRID Ph. 4951 4555
GAS AGILITY Ph. 132 909
TELECOMM TELSTRA Ph. 9204 0880

GIVE AT LEAST 48 HOURS NOTICE

| UTILITIES LOCATED: | | | | |
|--------------------------|----------|-----------|------|--|
| SERVICE | DATE | SIZE (mm) | TYPE | |
| EXISTING SEWER: | | | | |
| EXISTING SEWER: | | | | |
| STORMWATER: SWD | | | | |
| COUNCIL STORM WATER PIPE | 11/04/19 | 525 | CONC | |
| POTABLE WATER: | | | | |

| SITE STRATA (CIRCLE APPLICABLE) | | | | | | | | | |
|---------------------------------|-------------------------------------|-------------|-------------------------------------|-------|--------|--------------|-----------------|--|--|
| CLAY | ROCK | ROCK TRENCH | SAND | SHALE | TUNNEL | RUBBISH FILL | OTHER (SPECIFY) | | |
| | <input checked="" type="checkbox"/> | | <input checked="" type="checkbox"/> | | | | | | |

I Gabriel Austin, of Ausflow Pty Ltd, being accredited to carry out a Service Protection Report / Peg-Out for Sydney Water, certify that the information shown on this plan has been prepared in accordance with the relevant instructions and standards

LOCATOR SIGNATURE: *Gabriel Austin* Date: 11/04/2019

| PROPERTY ADDRESS: | |
|--------------------------------------|----------------|
| 27-29 North Avalon Road North Avalon | |
| SHEET 1 OF 1 | REVISION No. 1 |

PLAN SUPPLIED BY:

DRAFTED BY: PG PLAN DRAWN DATE: 11/04/2019