

# PROPOSED ALTERATIONS AND ADDITIONS

## 981 BARRENJOEY ROAD, PALM BEACH

### STORMWATER MANAGEMENT DESIGN

#### GENERAL DRAINAGE NOTES



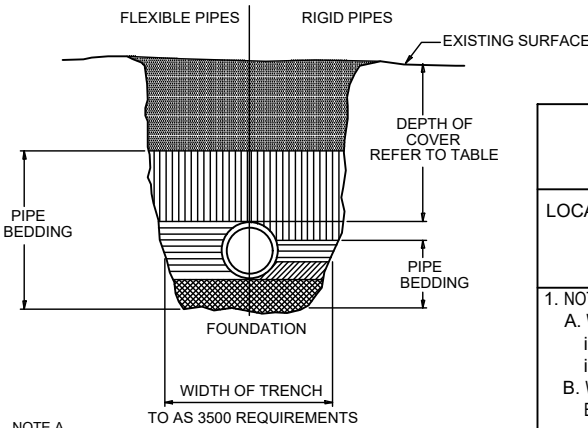

1. ALL WORK SHALL BE CARRIED OUT IN ACCORDANCE WITH THE LOCAL COUNCIL'S RELEVANT SPECIFICATIONS AND/OR STORMWATER CODE. ANY DISCREPANCY VARIATION OR ADDITIONAL WORK SHALL BE APPROVED BY THE PRINCIPAL CERTIFIER.
2. ALL SERVICES SHALL BE VERIFIED ON SITE PRIOR TO COMMENCEMENT OF WORK.
3. DIAL BEFORE YOU DIG SHALL BE CONTACTED PRIOR TO COMMENCEMENT.
4. ALL DRAINAGE PIPEWORK AND PLUMBING SHALL BE INSTALLED BY A CERTIFIED PLUMBER IN ACCORDANCE WITH THE AUSTRALIAN STANDARDS AS3500 AND COUNCIL REQUIREMENTS.
5. ALL DRAINAGE PIPES ARE TO BE SEWER GRADE UNLESS NOTED OTHERWISE.
6. ALL COVERS, GRATES AND FRAMES ARE TO BE CLASS C HEAVY DUTY WHERE SUBJECT TO VEHICULAR TRAFFIC.
7. ALL COVERS, GRATES AND FRAMES ARE TO BE CLASS A MEDIUM DUTY WHERE SUBJECT TO PEDESTRIAN TRAFFIC OR IN LANDSCAPE AREAS.
8. COUNCIL PERMIT/APPROVAL SHALL BE OBTAINED PRIOR TO WORKS ON COUNCIL LAND AND CONNECTION TO COUNCIL SYSTEM.
9. ALL PIPE BENDS TO BE FITTED WITH AN INSPECTION OPENING.

#### RAINWATER TANK NOTES

1. THE TANK SHALL NOT BE LOCATED OVER A WATER OR SEWER MAIN UNLESS IT IS INSTALLED IN ACCORDANCE WITH THE REGULATORY AUTHORITY REQUIREMENTS
2. ABOVE GROUND TANKS SHALL BE LOCATED AT LEAST 100 MM FROM ANY POTABLE WATER SUPPLY PIPE AND AT LEAST 300 MM FOR BELOW GROUND TANKS.
3. ALL PLUMBING WORK SHALL BE CARRIED OUT BY A LICENSED PLUMBER IN ACCORDANCE WITH SYDNEY WATER REQUIREMENTS AND COUNCIL REGULATIONS.
4. ALL INLETS SHALL BE SCREENED OR FILTERED TO PREVENT THE ENTRY OF FOREIGN MATTER OR CREATURES.
5. REUSE PUMP TO BE INSTALLED BY A LICENSED PLUMBER AND ELECTRICIAN TO SYDNEY WATER REQUIREMENTS
6. A SIGN SHALL BE AFFIXED TO THE RAINWATER TANK AND ALL APERTURES CLEARLY STATING THAT THE WATER IN THE TANK IS RAINWATER
7. NOISE EMISSIONS FROM ANY PUMP SHALL MEET COUNCIL'S REQUIREMENTS.
8. WATER RETAINED FOR INDOOR HOUSEHOLD USE SHALL BE AUGMENTED BY MAINS WATER SUPPLY AND APPROVAL OBTAINED BY SYDNEY WATER.
9. WHERE RETAINED WATER IS AUGMENTED BY MAINS WATER SUPPLY A BACKFLOW PREVENTION DEVICE AND FLOW RESTRICTOR SHALL BE INSTALLED IN ACCORDANCE WITH AS 3500 AND SYDNEY WATER REQUIREMENTS.
10. ALL INLETS SHALL BE FITTED WITH A FIRST FLUSH DEVICE PRIOR TO DISCHARGING TO THE RAINWATER TANK.
11. THE INDIRECT CONNECTION TO MAINS WATER SUPPLY SHALL HAVE A VISIBLE AIR GAP IN ACCORDANCE WITH AS 3500.



NOTE A  
STORMWATER DRAINS CONSTRUCTED OF OTHER THAN CAST IRON, DUCTILE IRON OR GALVANISED STEEL HAVING COVER LESS THAN THAT SPECIFIED IN TABLE SHALL BE COVERED WITH AT LEAST 50mm OVERLAY AND SHALL BE PAVED WITH AT LEAST 100mm THICKNESS OF REINFORCED CONCRETE WHERE SUBJECT TO HEAVY VEHICULAR LOADING

LEGEND - TRENCH BACKFILL		
SYMBOL	FLEXIBLE PIPES	RIGID PIPES
		BACKFILL
		PIPE OVERLAY
	PIPE SIDE SUPPORT	SIDE ZONE
	—	HAUNCH ZONE
	PIPE UNDERLAY	BED ZONE

#### MINIMUM PIPE COVER (FROM FINISHED SURFACE TO TOP OF PIPE)

LOCATION	MINIMUM COVER (mm)	
	CAST / DUCTILE IRON OR GALV STEEL	AUTHORISED PRODUCTS (*)
1. NOT SUBJECT TO VEHICULAR LOADING: A. WITHOUT PAVEMENT: i. FOR SINGLE DWELLINGS - ii. OTHER THAN SINGLE DWELLINGS -	0 0	100 300
B. WITH PAVEMENT OF BRICK/UNREINFORCED CONCRETE -	0 (**)	50 (**)
2. SUBJECT TO VEHICULAR LOADING: A. OTHER THAN ROADS: i. WITHOUT PAVEMENT - ii. WITH PAVEMENT OF: - REINF. CONC. FOR HEAVY VEHICLES - - BRICK/UNREINF. CONC LIGHT VEHICLES -	300 0 (** #) 0 (** #)	450 100 (** #) 75 (** #)
B. ROADS i. SEALED ii. UNSEALED	300 300	500 (#) 500 (#)
3. SUBJECT TO CONSTRUCTION VEHICLES OR IN EMBANKMENT CONDITIONS	300	500 (#)

(\*) INCLUDES OVERLAY ABOVE THE TOP OF THE PIPE OF NOT LESS THAN 50mm THICK  
(\*\*) BELOW THE UNDERSIDE OF THE PAVEMENT  
(#) SUBJECT TO COMPLIANCE WITH AS1762, AS2033, AS/NZS 2566.1, AS3725 OR AS 4060

#### NORTHERN BEACHES COUNCIL REQUIREMENTS

THE STORMWATER DRAINAGE SYSTEM HAS BEEN DESIGNED IN ACCORDANCE NORTHERN BEACHES (PITTWATER COUNCIL DCP21 AND AUSTRALIAN STANDARDS AS 3500.3.

DESIGN PARAMETERS:- 20 year ARI storm

SITE AREA (m2) ..... 1,075

#### ON-SITE DETENTION REQUIREMENTS

THE PROPOSED DEVELOPMENT IS LOCATED ON WATERFRONT LAND AND IN ACCORDANCE WITH PART B5.13 OF PITTWATER DCP21 IS **NOT** REQUIRED FOR THIS DEVELOPMENT.

#### LEGEND

- STORMTECH STAINLESS STEEL GRATED TRENCH DRAIN
- STORMWATER INLET PIT UNLESS NOTED OTHERWISE
- DOWNPIPE NUMBER 1000
- DOWNPIPE NUMBER 1000 DOWNPIPE SPREADER
- STORMWATER DRAINAGE PIPE

#### SHEET INDEX

COVER SHEET AND NOTES ..... SHEET SW1  
STORMWATER MANAGEMENT PLAN ..... SHEET SW2

**WATERDESIGN**  
**CIVIL ENGINEERS**

1 FLAME TREE PLACE  
CHERRYBROOK NSW 2126  
MOBILE: 0417 671646  
EMAIL: waterdes@bigpond.net.au  
ABN: 77 928 166 729

CLIENT NAME:  
**MORRIS SYMONDS AND  
IRENE DEUTSCH**

PROJECT TITLE:  
**ALTERATIONS AND ADDITIONS  
981 BARRENJOEY ROAD  
PALM BEACH NSW 2108**

DRAWING TITLE:  
**COVER SHEET AND NOTES**

DRAWN: A.L.  
DATE: 08.01.2020  
JOB No: 2019-071

APPROVED BY:  
  
ANDREW LAM  
MIEAust B.E. Civil (Hons)

DWG NO: SW1  
no. IN SET: 2

A  
INCLINATOR RELOCATED  
REVISION / ISSUE DESCRIPTION  
DATE

© All design and drawings are the property of Waterdesign Civil Engineers. This drawing must not be used, reproduced or copied without the written approval of Waterdesign Civil Engineers.

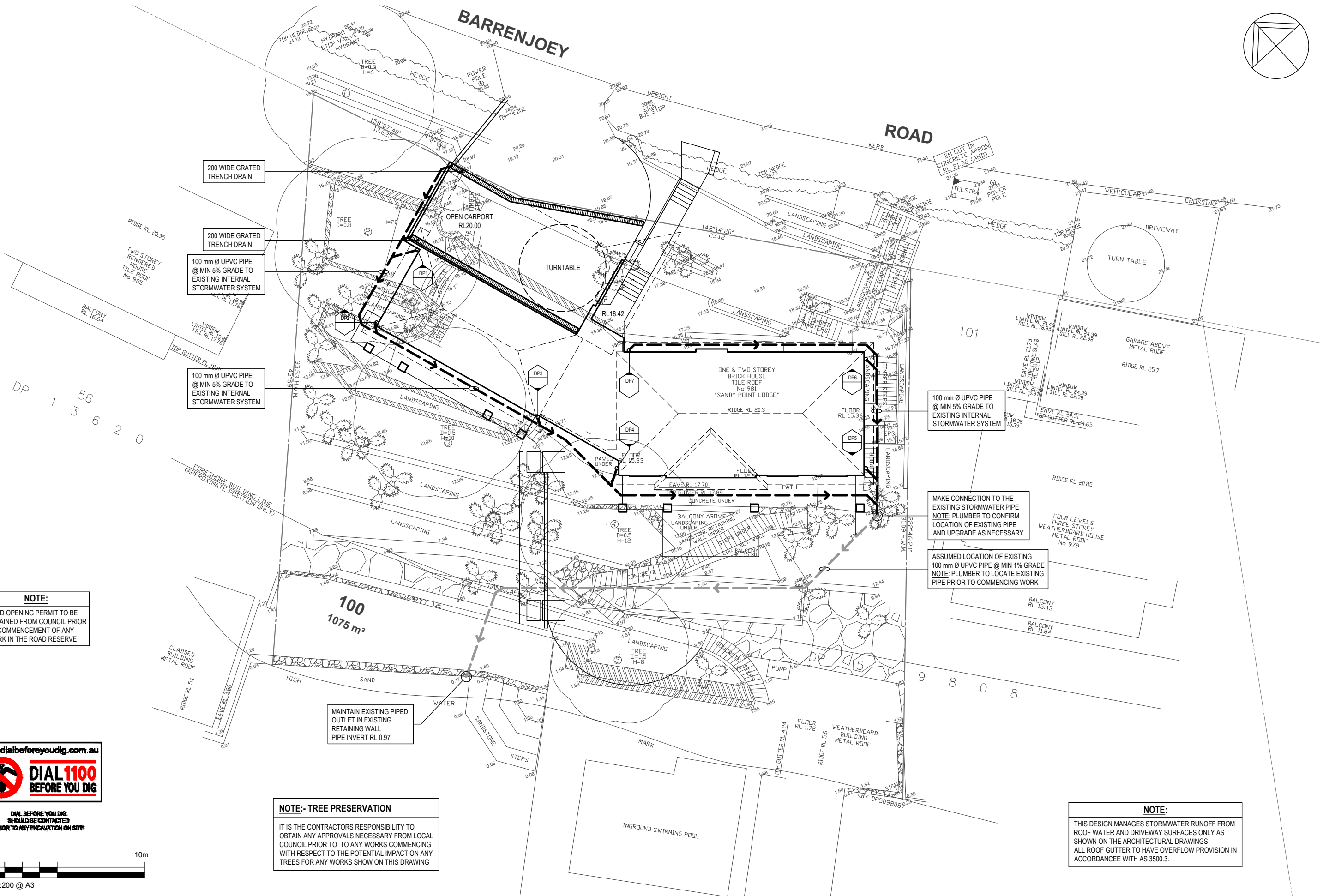
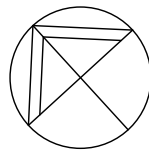

**NOTE:**  
ROAD OPENING PERMIT TO BE OBTAINED FROM COUNCIL PRIOR TO COMMENCEMENT OF ANY WORK IN THE ROAD RESERVE



DIAL BEFORE YOU DIG  
SHOULD BE CONTACTED  
PRIOR TO ANY EXCAVATION ON SITE

**NOTE:- TREE PRESERVATION**  
IT IS THE CONTRACTORS RESPONSIBILITY TO OBTAIN ANY APPROVALS NECESSARY FROM LOCAL COUNCIL PRIOR TO ANY WORKS COMMENCING WITH RESPECT TO THE POTENTIAL IMPACT ON ANY TREES FOR ANY WORKS SHOW ON THIS DRAWING

MAKE CONNECTION TO THE EXISTING STORMWATER PIPE  
NOTE: PLUMBER TO CONFIRM LOCATION OF EXISTING PIPE AND UPGRADE AS NECESSARY

ASSUMED LOCATION OF EXISTING 100 mm Ø UPVC PIPE @ MIN 1% GRADE  
NOTE: PLUMBER TO LOCATE EXISTING PIPE PRIOR TO COMMENCING WORK

**NOTE:**  
THIS DESIGN MANAGES STORMWATER RUNOFF FROM ROOF WATER AND DRIVEWAY SURFACES ONLY AS SHOWN ON THE ARCHITECTURAL DRAWINGS  
ALL ROOF GUTTER TO HAVE OVERFLOW PROVISION IN ACCORDANCE WITH AS 3500.3.

**WATERDESIGN CIVIL ENGINEERS**

1 FLAME TREE PLACE  
CHERRYBROOK NSW 2126  
MOBILE: 0417 671646  
EMAIL: waterdes@bigpond.net.au  
ABN: 77 928 166 729

CLIENT NAME:  
**MORRIS SYMONDS AND IRENE DEUTSCH**

PROJECT TITLE:  
**ALTERATIONS AND ADDITIONS  
981 BARRENJOEY ROAD  
PALM BEACH NSW 2108**

DRAWING TITLE:  
**STORMWATER  
MANAGEMENT PLAN**

DRAWN: A.L.  
DATE: 08.01.2020  
JOB No: 2019-071

APPROVED BY:  
ANDREW LAM  
MIEAust B.E. Civil (Hons)  
DWG NO: SW2  
no. IN SET: 2

No.	INCLINATOR RELOCATED	09.01.20
No.	REVISION / ISSUE DESCRIPTION	DATE