

Our Ref: 21307compliance 1

Page: 1 of 2

Date: 11/04/2022

Mr Paul Barrett  
135 Seaforth Crescent  
SEAFORTH NSW 2092

Dear Sir,

**Re: Building Compliance Survey – Swimming Pool  
Property: 135 Seaforth Crescent, Seaforth 2092**

In accordance with your instructions, we have made a survey of part of the land comprised in Folio Identifier 2/236331, being Lot 2 in Deposited Plan 236331 in the Local Government Area of Northern Beaches, Parish of Manly Cove, County of Cumberland having a frontage to Seaforth Crescent and shown edged red on the attached sketch.

The survey is for Building Compliance purposes only. This report must not be used for any other matter, purpose or construction set out.

The date of the survey 08/04/2022 and this report is based upon Folio Identifier search issued by the NSW LRS, dated 06/04/2022.

We have attended the above-mentioned site and located the newly constructed Swimming Pool and Deck located on the subject land.

The position of the above-mentioned structures in relation to the boundaries is shown on the accompanying sketch.

Pool and Deck levels as surveyed relative to Australian Height Datum are shown on the accompanying sketch.

For the purpose of this survey, fencing and other improvements located on or adjacent to the subject land have not been surveyed. It should be noted that no attempt has been made to locate below ground improvements of any nature.

Title restrictions (if any) on the Title have not been investigated as part of this survey.

This report has been prepared for the exclusive use of Mr Paul Barrett only for this particular transaction. No liability for loss howsoever arising can be accepted from other persons seeking to rely upon the information contained herein.

Yours faithfully,

**CMS Surveyors Pty Limited**



**Murray Learmont**  
Registered Land Surveyor

A3

102  
D.P.882515

1  
D.P.387759

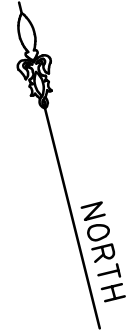

1  
D.P.236331

1  
D.P.236331

2  
D.P.236331

3  
D.P.236331

4  
D.P.236331

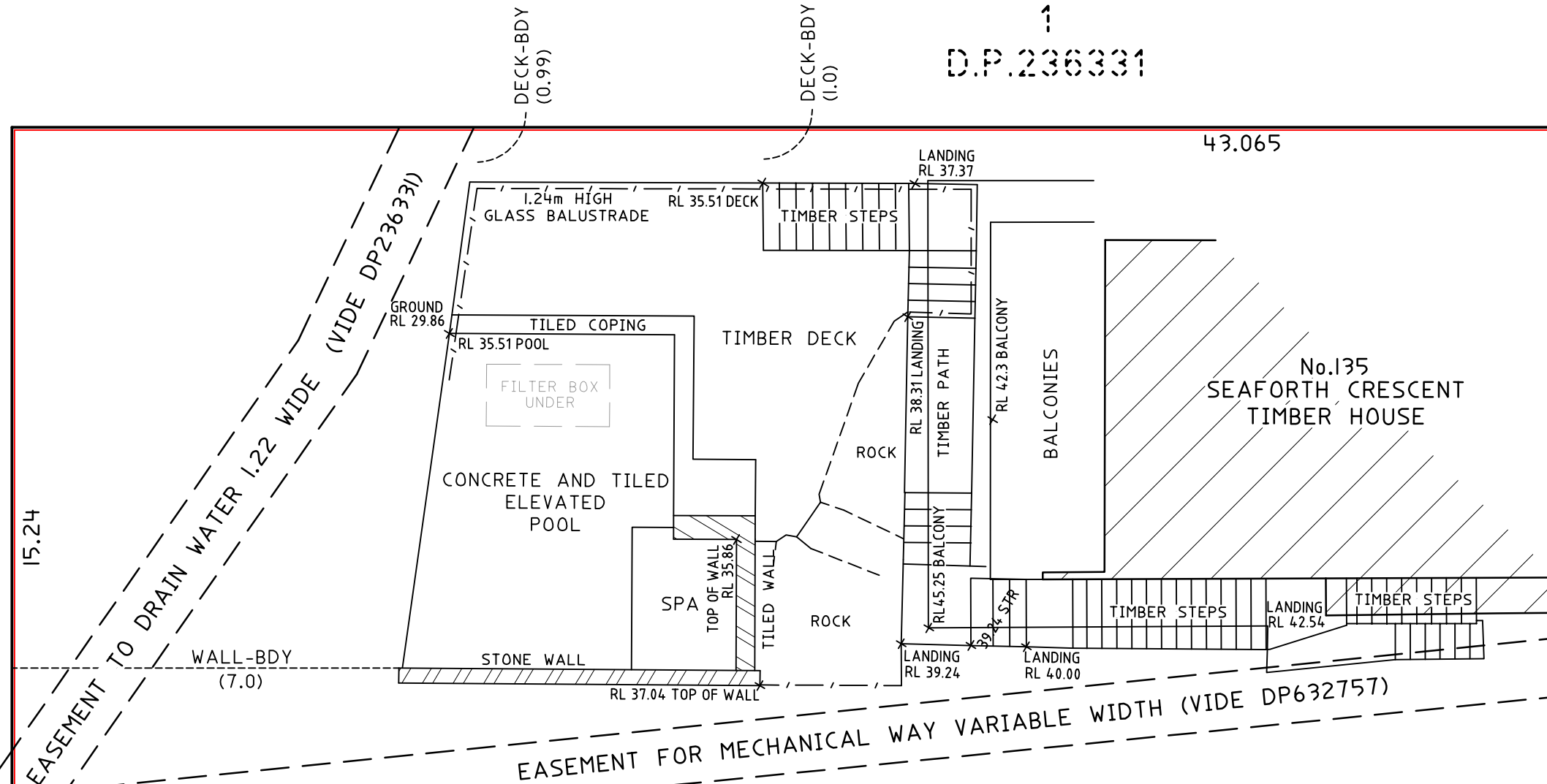

EASEMENT TO DRAIN WATER  
1.83 WIDE (VIDE DP236331)

3  
D.P.236331

EASEMENT TO DRAIN WATER  
1.22 WIDE (VIDE DP236331)

ORIGIN OF LEVELS:  
DATUM: AUSTRALIAN HEIGHT  
DATUM (AHD)  
BM ADOPTED: PM 1207  
RL. 61.834 (CLASS LB)  
SOURCE: S.C.I.M.S. (6/04/2022)

SURVEY SKETCH

REGISTERED SURVEYOR



C.M.S. Surveyors Pty. Ltd.

A.C.N 096 240 201

PO Box 463 Dee Why NSW 2099

2/99A South Creek Road, Dee Why NSW 2099

Phone: (02) 9971 4802 Fax: (02) 9971 4822

E-mail: info@cmssurveyors.com.au

THIS IS PAGE 2 OF MY REPORT DATED 11/04/2022

SURVEY INSTRUCTION  
21307

NOT TO  
SCALE

DATE OF SURVEY  
8/04/2022

DRAWING NAME  
**21307compliance**

CAD FILE  
21307comp 1.dwg

ISSUE

1

FIRST ISSUE

11/04/2022