

A1

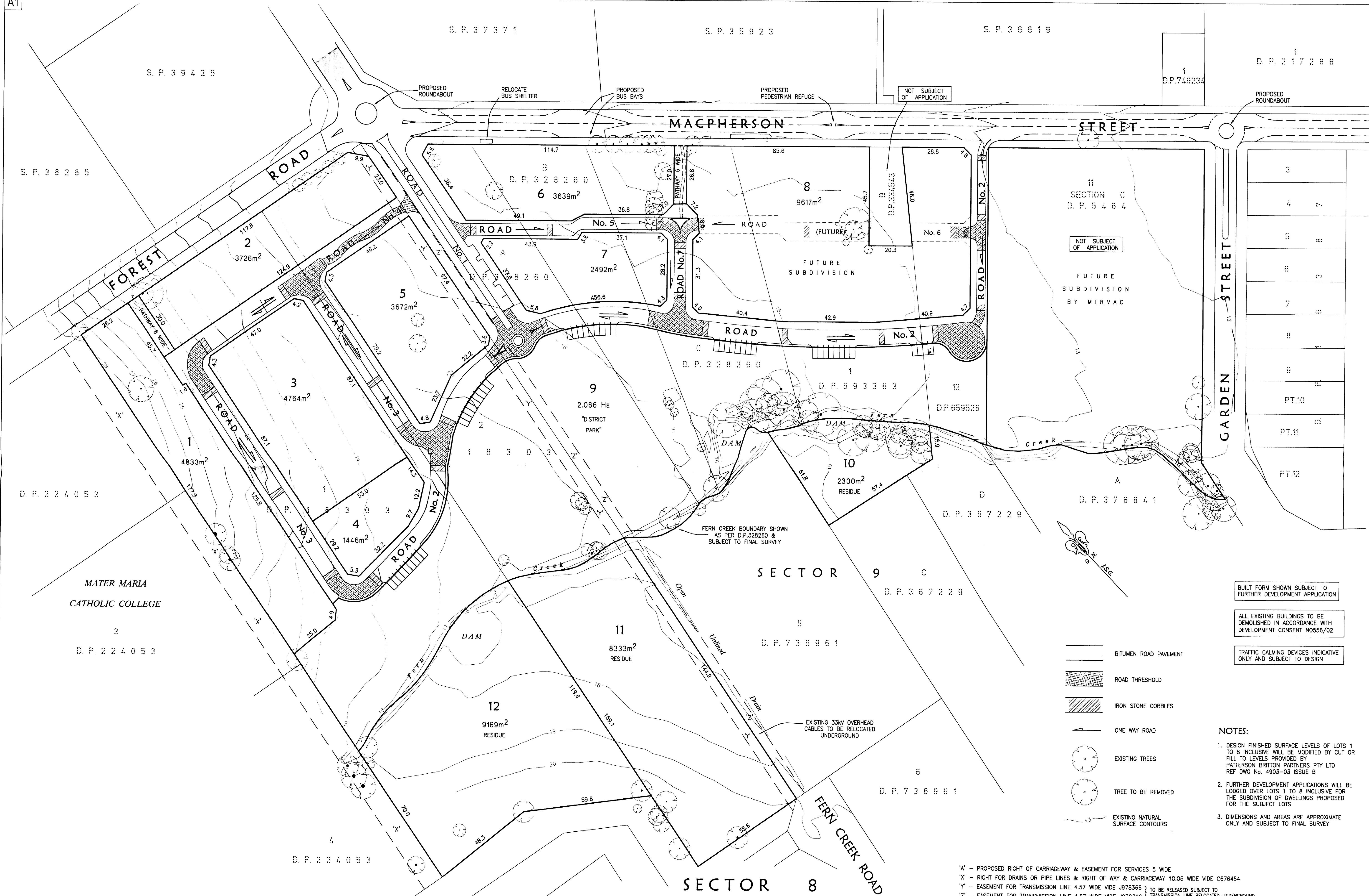

" SUPER LOT " STAGE 0 SUBDIVISION PLAN

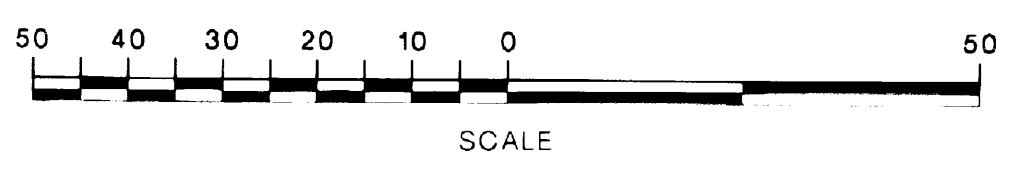

- BUILT FORM SHOWN SUBJECT TO FURTHER DEVELOPMENT APPLICATION
- ALL EXISTING BUILDINGS TO BE DEMOLISHED IN ACCORDANCE WITH DEVELOPMENT CONSENT N0556/02
- TRAFFIC CALMING DEVICES INDICATE ONLY AND SUBJECT TO DESIGN

- BITUMEN ROAD PAVEMENT
- ROAD THRESHOLD
- IRON STONE COBBLES
- ONE WAY ROAD
- EXISTING TREES
- TREE TO BE REMOVED
- EXISTING NATURAL SURFACE CONTOURS

- NOTES:**
1. DESIGN FINISHED SURFACE LEVELS OF LOTS 1 TO 8 INCLUSIVE WILL BE MODIFIED BY CUT OR FILL TO LEVELS PROVIDED BY PATTERSON BRITTON PARTNERS PTY LTD REF DWG No. 4903-03 ISSUE B
 2. FURTHER DEVELOPMENT APPLICATIONS WILL BE LODGED OVER LOTS 1 TO 8 INCLUSIVE FOR THE SUBDIVISION OF DWELLINGS PROPOSED FOR THE SUBJECT LOTS
 3. DIMENSIONS AND AREAS ARE APPROXIMATE ONLY AND SUBJECT TO FINAL SURVEY

'A' - PROPOSED RIGHT OF CARRIAGEWAY & EASEMENT FOR SERVICES 5 WIDE
 'X' - RIGHT FOR DRAINS OR PIPE LINES & RIGHT OF WAY & CARRIAGEWAY 10.06 WIDE VIDE C676454
 'Y' - EASEMENT FOR TRANSMISSION LINE 4.57 WIDE VIDE J978366 } TO BE RELEASED SUBJECT TO
 'Z' - EASEMENT FOR TRANSMISSION LINE 4.57 WIDE VIDE J978366 } TRANSMISSION LINE RELOCATED UNDERGROUND

AMENDMENTS		
No.	Date	Description

Project: PROPOSED SUBDIVISION SECTOR 8
 LOT 1 & 2 D.P. 18303,
 LOT A, B & C D.P. 328260,
 LOT 1 D.P. 593363 & LOT 12 D.P. 659528
 MACPHERSON STREET, WARRIEWOOD

Principal: AUSTRALAND HOLDINGS LIMITED
 Scale 1:800 Date 13.2.04 Council Ref.
 Datum A.M.D. L.G.A. PITTSWATER
 Designed A.H. Drawn C.G.H. Checked A.H.

CRAIG & RHODES
 SURVEYORS ENGINEERS PLANNERS

11 BRIDGE ST, EPPING
 Mail P.O. BOX 233
 EPPING 1710
 DX 4408, EPPING
 Ph. (02) 9869-1855
 A.C.N. 050 209 991

Directory	Dwg. File
ZAI710	1710L19
Sheet No. 1	Our Ref.
of 1 Sheets	1710