

Note- The pool pump must be housed in a soundproofed enclosure  
Acoustic box is 900mm away from the top of the boundary fence.

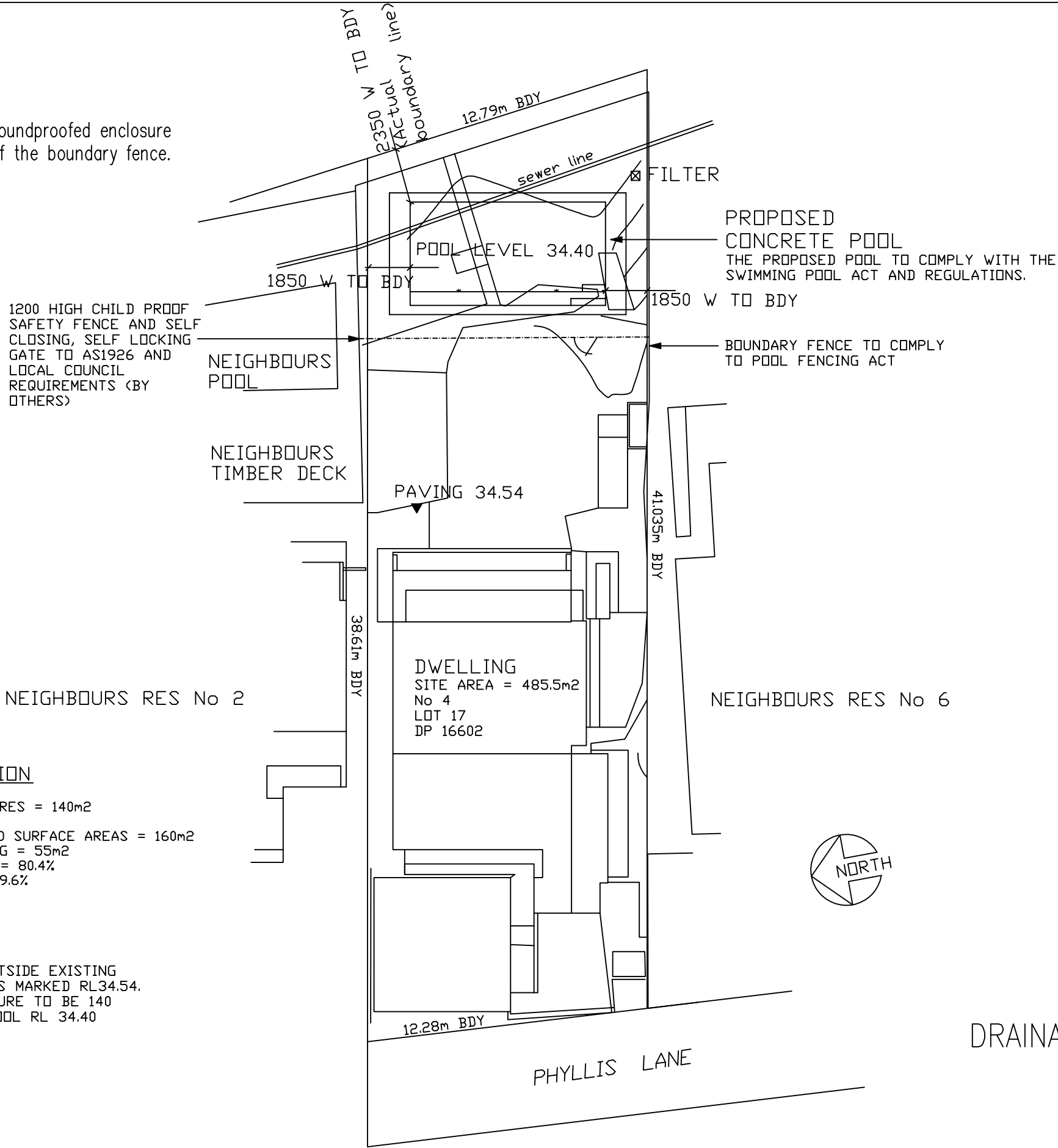

SITE CALCULATION  
SITE AREA = 485.5m2  
RESIDENCES/ STRUCTURES = 140m2  
GARAGE = 35m2  
PATHS/ PAVERS/ HARD SURFACE AREAS = 160m2  
PROPOSED POOL/ COPING = 55m2  
TOTAL B.U.A. = 390m2 = 80.4%  
LANDSCAPED AREA = 19.6%

▼ DATUM - PAVING OUTSIDE EXISTING  
DWELLING AT REAR AS MARKED RL34.54.  
TOP OF POOL STRUCTURE TO BE 140  
BELOW THE DATUM. POOL RL 34.40

DRAINAGE CONCEPT PLAN  
SCALE: 1 : 1000

NOTE:  
© Copyright. This plan and design is the property of HYTEN  
ENGINEERING, and must not be used, reproduced or copied  
wholly or in part without written permission from the company.  
Do not scale drawings, use figured dimensions only.  
WHEN IN DOUBT, ASK. It is your responsibility.  
If HYTEN Engineering has not been engaged to carry out  
structural inspections, no certificate will be issued.

Rev.	Description	By.	App.	Date
B	Relocate pool 1325 to rear	JF	JF	12.02.2019
A	ISSUED FOR C.C.	JF	JF	5.12.2018

**HYTEN**  
ENGINEERING  
STRUCTURAL | STORMWATER | GLASS ENGINEERING  
0413 863 363 michael@hyten.com.au www.hyten.com.au

AROONA POOLS  
SPAS P/L  
2801/225 WALKER ST,  
NORTH SYDNEY. NSW  
Ph: 9460 0737 Lic 298081c

Client	JOHNSTON
Project	4 PHYLLIS LANE, NORTH CURL CURL. NSW

Title	IN-GROUND CONCRETE SWIMMING POOL SITE PLAN
ISSUED FOR	CONSTRUCTION CERTIFICATE
Project Number	19H3007

Design	Drawn
M.A.	J.F.
Drawing Number	DC1

Note- The pool pump must be housed in a soundproofed enclosure  
Acoustic box is 900mm away from the top of the boundary fence.

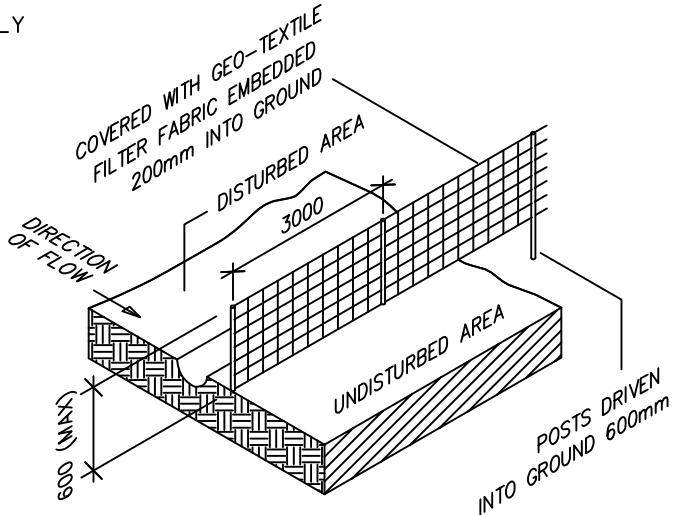
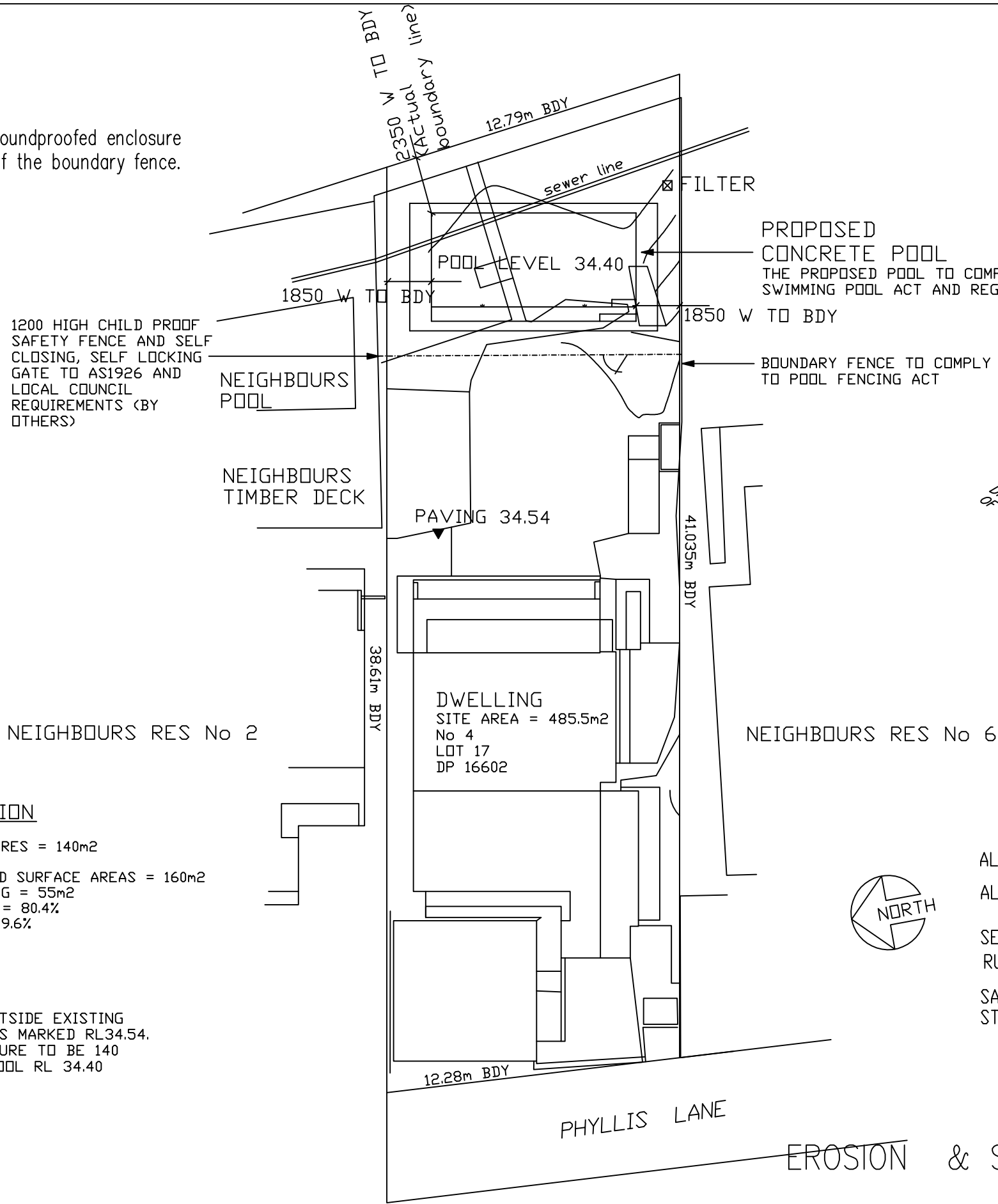

SEDIMENT FENCE DETAIL  
NOT TO SCALE

WASTE MANAGEMENT PLAN

- ALL EXCAVATED MATERIAL TO BE REMOVED FROM SITE
- ALL CONSTRUCTION MATERIAL TO BE REMOVED FROM SITE
- SEDIMENTATION BARRIER TO BE ERECTED TO PREVENT RUN -OFF INTO ADJOINING NEIGHBOURS PROPERTY
- SANDBAGS TO BE USED TO PREVENT RUN-OFF INTO STORMWATER SYSTEM

EROSTON & SEDIMENTATION CONTROL PLAN

SCALE: 1 : 1000

NOTE:  
© Copyright. This plan and design is the property of HYTEN ENGINEERING, and must not be used, reproduced or copied wholly or in part without written permission from the company.  
Do not scale drawings, use figured dimensions only.  
WHEN IN DOUBT, ASK. It is your responsibility.  
If HYTEN Engineering has not been engaged to carry out structural inspections, no certificate will be issued.

Rev.	Description	By.	App.	Date
B	Relocate pool 1325 to rear	JF	JF	12.02.2019
A	ISSUED FOR C.C.	JF	JF	5.12.2018



**HYTEN**  
ENGINEERING

STRUCTURAL | STORMWATER | GLASS ENGINEERING  
0413 863 363 michael@hyten.com.au www.hyten.com.au

AROONA POOLS  
SPAS P/L  
2801/225 WALKER ST,  
NORTH SYDNEY. NSW  
Ph: 9460 0737 Lic 298081c

Client	JOHNSTON
Project	4 PHYLLIS LANE, NORTH CURL CURL. NSW

Title	IN-GROUND CONCRETE SWIMMING POOL SITE PLAN
ISSUED FOR	CONSTRUCTION CERTIFICATE
Project Number	19H3007

Design	Drawn
M.A.	J.F.
Drawing Number	ES1