

NOTES:

- CAUTION: SHOULD ANY DEVELOPMENT OR CONSTRUCTION BE PLANNED ON OR NEAR THE BOUNDARIES, THE BOUNDARIES SHOULD BE CLEARLY MARKED ON SITE.
- ALL AREAS AND DIMENSIONS HAVE BEEN COMPILED FROM PLANS MADE AVAILABLE AT THE LAND TITLES OFFICE.
- ORIGIN OF LEVELS ON A.H.D. IS TAKEN FROM P.M. 50984 RL 72.5 APPROXIMATE A.H.D.
- CONTOUR INTERVAL 0.25 METRE
- CONTOURS ARE INDICATIVE OF GROUND FORM ONLY. ONLY SPOT LEVELS SHOULD BE USED FOR CALCULATIONS OF QUANTITIES WITH CAUTION
- TREE SPREADS ARE DIAGRAMMATIC ONLY AND ARE NOT SYMMETRICAL.
- SPOT LEVELS ARE ACCURATE.
- BEARINGS SHOWN ARE ON M.G.A.-(MAP GRID OF AUSTRALIA.)

INVESTIGATION OF 'DIAL BEFORE YOU DIG' UNDERGROUND SERVICES HAS BEEN MADE. DETECTION OF UNDERGROUND SERVICES IS NOT AN INTEGRAL PART OF THIS SURVEY. ALL RELEVANT AUTHORITIES SHOULD BE NOTIFIED PRIOR TO ANY EXCAVATION ON OR NEAR THE SITE

DEVELOPERS & EXCAVATORS MAY BE HELD FINANCIALLY RESPONSIBLE BY THE ASSET OWNER SHOULD THEY DAMAGE UNDERGROUND NETWORKS.

CARELESS DIGGING CAN:
- CAUSE DEATH OR SERIOUS INJURY TO WORKERS AND THE GENERAL PUBLIC
- INCONVENIENCE USERS OF ELECTRICITY, GAS, WATER AND COMMUNICATIONS
- LEAD TO CRIMINAL PROSECUTION AND DAMAGES CLAIMS
- CAUSE EXPENSIVE FINANCIAL LOSSES TO BUSINESS
- CUT OFF EMERGENCY SERVICES
- DELAY PROJECT COMPLETION TIMES WHILE THE DAMAGE IS REPAIRED

MINIMISE YOUR RISK AND DIAL BEFORE YOU DIG.
TEL. 1100



WORK AS EXECUTED

LEVELS AND MEASUREMENTS SHOWN HEREON IN RED ARE "WORK AS EXECUTED" AND HAVE BEEN DETERMINED FROM FIELD SURVEY MEASUREMENTS AT COMPLETION OF CONSTRUCTION

COPLAND C. LETHBRIDGE
REGISTERED SURVEYOR UNDER
THE SURVEYING AND SPATIAL INFORMATION ACT 2002
DATED 16/01/2015

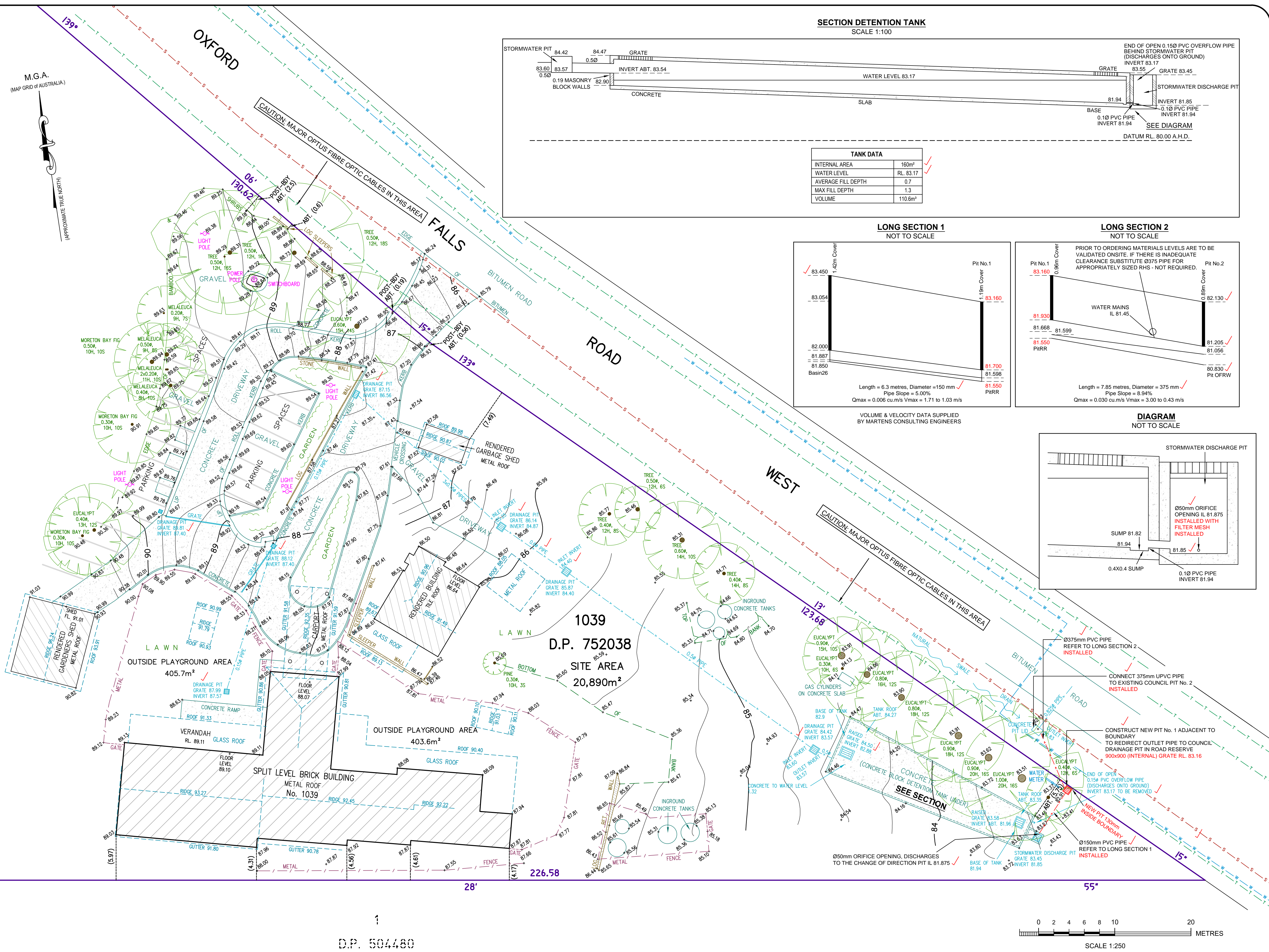
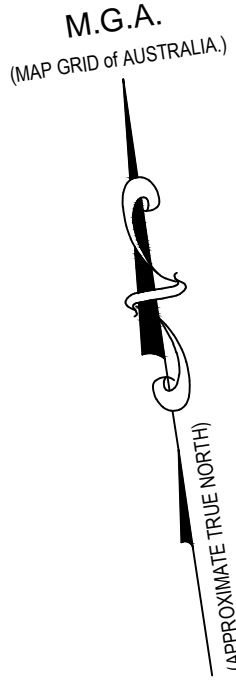

SECTION DETENTION TANK
SCALE 1:100

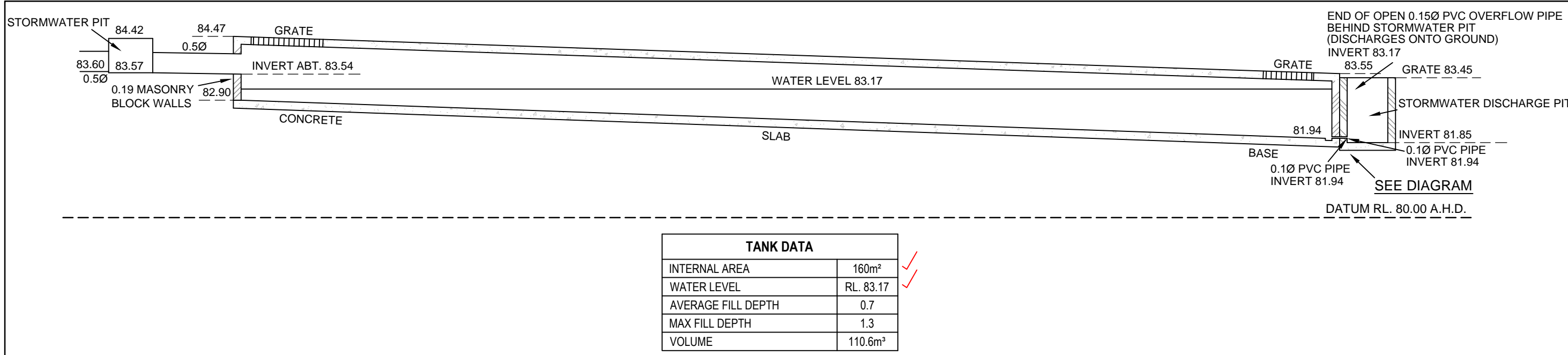

TANK DATA	
INTERNAL AREA	180m²
WATER LEVEL	RL. 83.17
AVERAGE FILL DEPTH	0.7
MAX FILL DEPTH	1.3
VOLUME	110.6m³

LONG SECTION 1
NOT TO SCALE

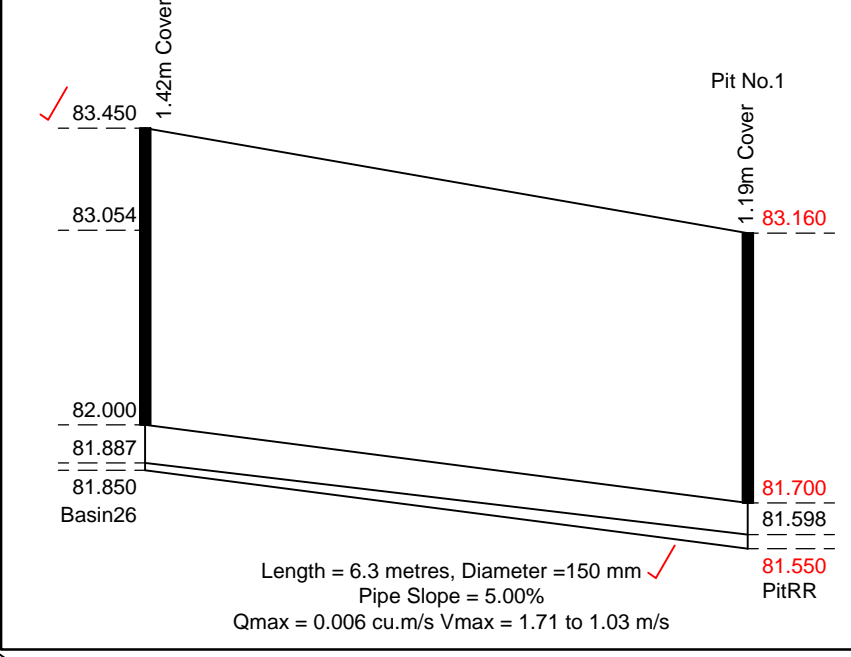

LONG SECTION 2
NOT TO SCALE

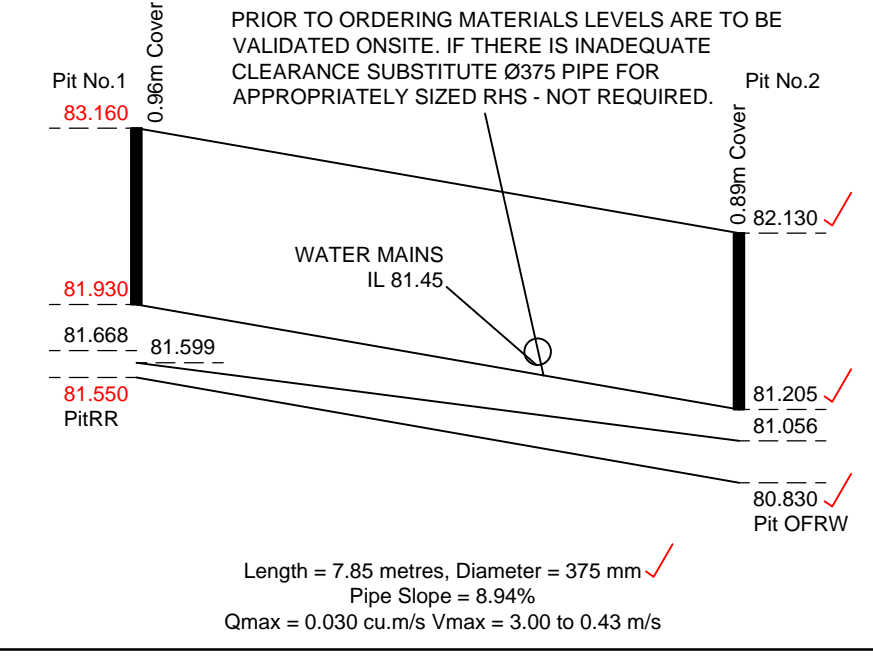
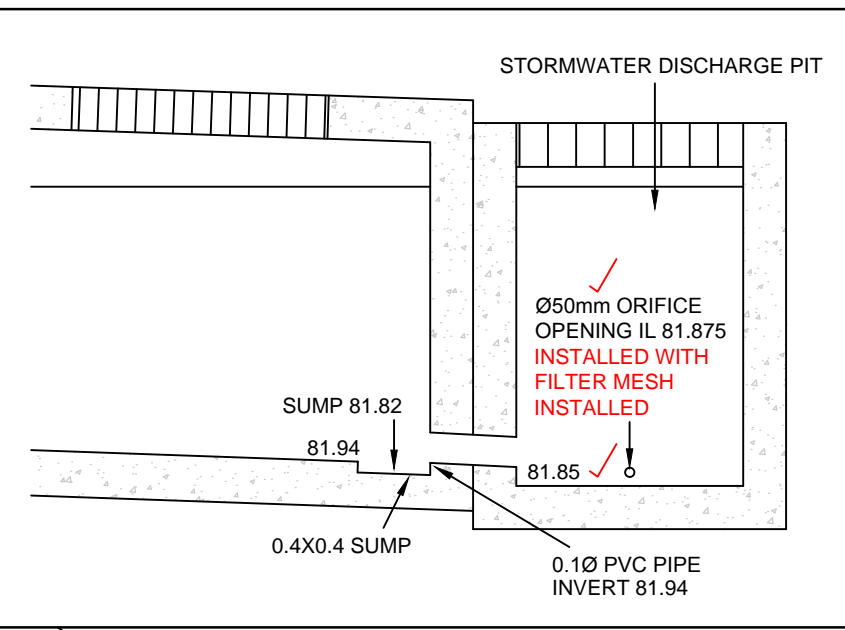

DIAGRAM
NOT TO SCALE



278°

28'

1

D.P. 504480

SCALE 1:250

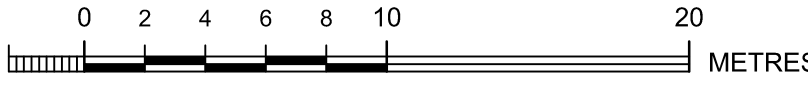

Bee & Lethbridge
Quality Surveying & Development Solutions

Bee & Lethbridge Pty Ltd
Suite 2, 14 Starkey Street,
PO Box 330, Forestville, NSW 2087
Phone: 9451 6757 Fax: 9975 3535
Email: survey@beeleth.com.au
ABN: 13 003 194 447
www.beeleth.com.au

LEGEND



TREE
0.10m
5m, 45
DENOTES APPROX 0.10m DIAMETER OF TREE
DENOTES APPROX. 5m HEIGHT OF TREE
DENOTES APPROX. 4m SPREAD OF TREE
TOW
GUTTER
DENOTES CENTRE LINE OF ROAD
DENOTES TOP OF WALL
DENOTES TOP OF GUTTER

BOARDS SEWER
MAJOR OPTUS FIBRE OPTIC
WATER LINES
W

PLAN SHOWING BOUNDARIES, RELATIVE HEIGHTS & SELECTED PHYSICAL FEATURES & WORK AS EXECUTED DETAILS ON THE STORMWATER/HYDRAULIC SYSTEM OVER PART OF LOT 1039 IN D.P. 752038 KNOWN AS No. 1039 OXFORD FALLS ROAD WEST, OXFORD FALLS. L.G.A.: WARRINGAH

CLIENT	Mr R. LOEL			REF No.	18069
PROPERTY	No. 1039 OXFORD FALLS ROAD WEST, OXFORD FALLS			SHEET No.	1 of 1
DATUM	APPROX. A.H.D.	SCALE	1:250 @ A1	DATE	16/01/2015
SURVEYED	G.C.	DRAWN	J.M.	DWG No.	18069B
				REV No.	00