

Northern Beaches Council
Attn: Manager – Development Assessments
Northern Beaches Council
725 Pittwater Road
Dee Why NSW 2099

David Lamb
194A Darby Street
COOKS HILL NSW 2300

2 June 2020

Dear Sir/Madam,

**RE: Certification of Shadow Diagrams – Secondary Dwelling
790A Barrenjoey Road Palm Beach**

This document confirms that the shadow diagrams provided for the secondary dwelling (DL, Sheet 10, Revision B, dated 25/05/2020) at the abovementioned address have been prepared accurately to the slope of the land and the proposed development.

The shadow diagrams have been prepared for 12pm and 3pm on 21 June, have been modelled in a registered Autodesk Product (Revit 2020) and prepared in accordance with Northern Beaches Council '*Development Application & Modification Lodgement Requirements 19/20*'.

I hereby certify that the shadow diagrams submitted with this proposal are:

- in accordance with the Survey (prepared by a registered Surveyor) which is required to be submitted with the proposal;
- drawn to true – north
- to indicate shadow cast by the proposal at 9am (refer to plan for details), noon, 3pm and 21 June
- to indicate the shadow cast by existing buildings and structures on the site and in the surrounding area

Please contact me if you have any questions regarding this development.

Regards,



David Lamb
B. Design (Arch.)(Dist), Adv. Dip Building Surveying
A2 (unconditional) Building Certifier, Development Planner
E: davelamb82@gmail.com
M: 0423 087 874

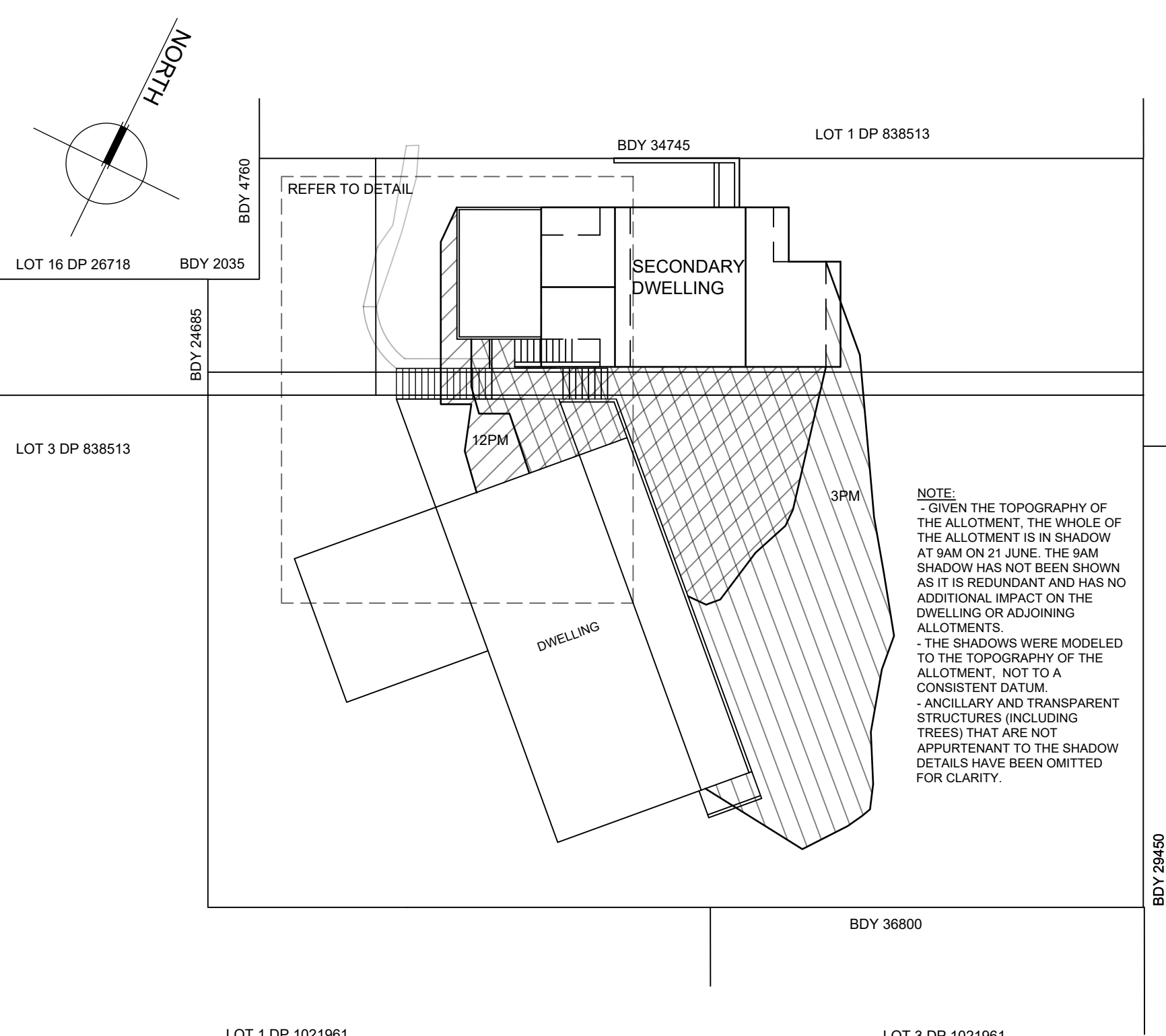

SHADOW DIAGRAMS
- 21 JUNE
SCALE 1:200

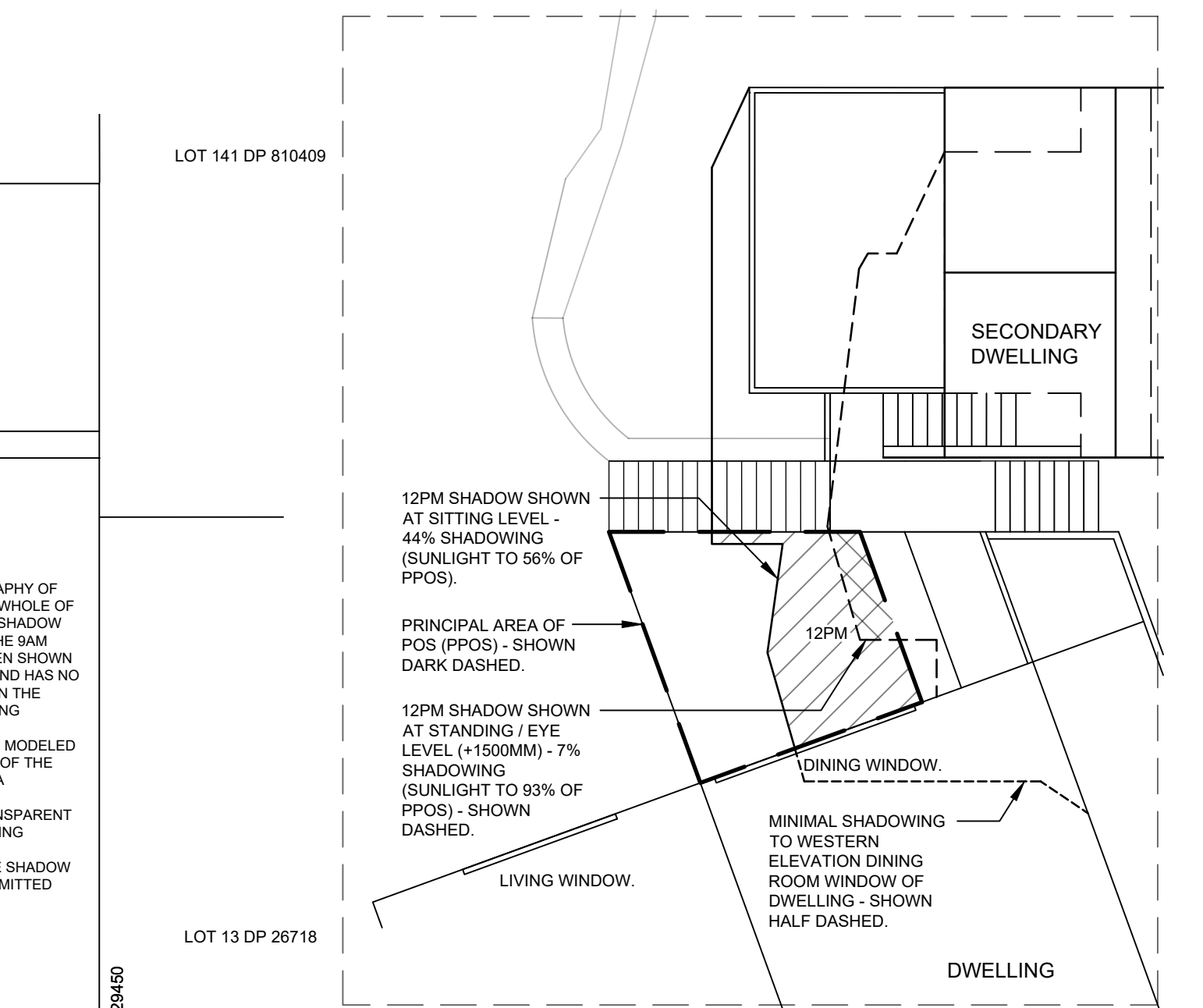

DETAIL
SCALE 1:100

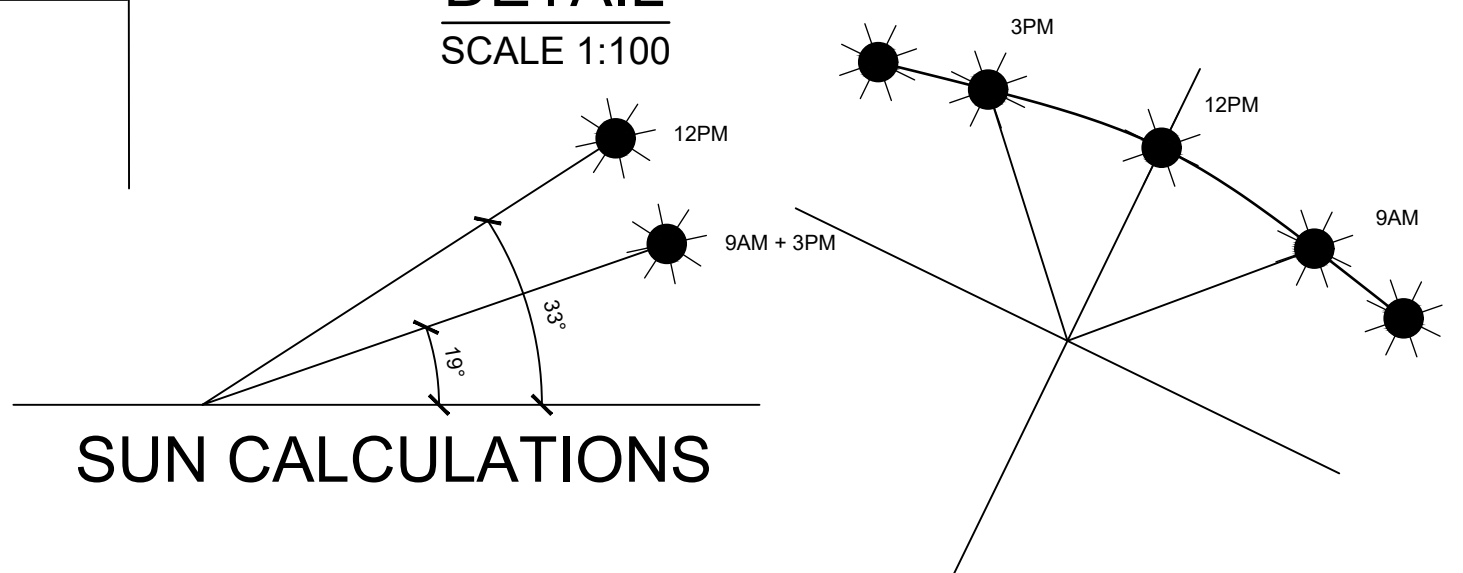

SUN CALCULATIONS

Project: J + B RITCHIE SECONDARY DWELLING	Details: LOT 2 DP 838513 790A BARRENJOEY ROAD PALM BEACH NSW 2108	SHADOW DETAILS	REVISION	AMENDMENT	DATE
			A	CONSULTANTS ISSUE	27/03/20
		ARCHITECTURALS: DL	B	DA ISSUE	25/05/20
		ENGINEERING: ANA CIVIL	DWG NO: 10 NOVEMBER 2019		