

OCEAN STREET (20.115 MIDE) STREET

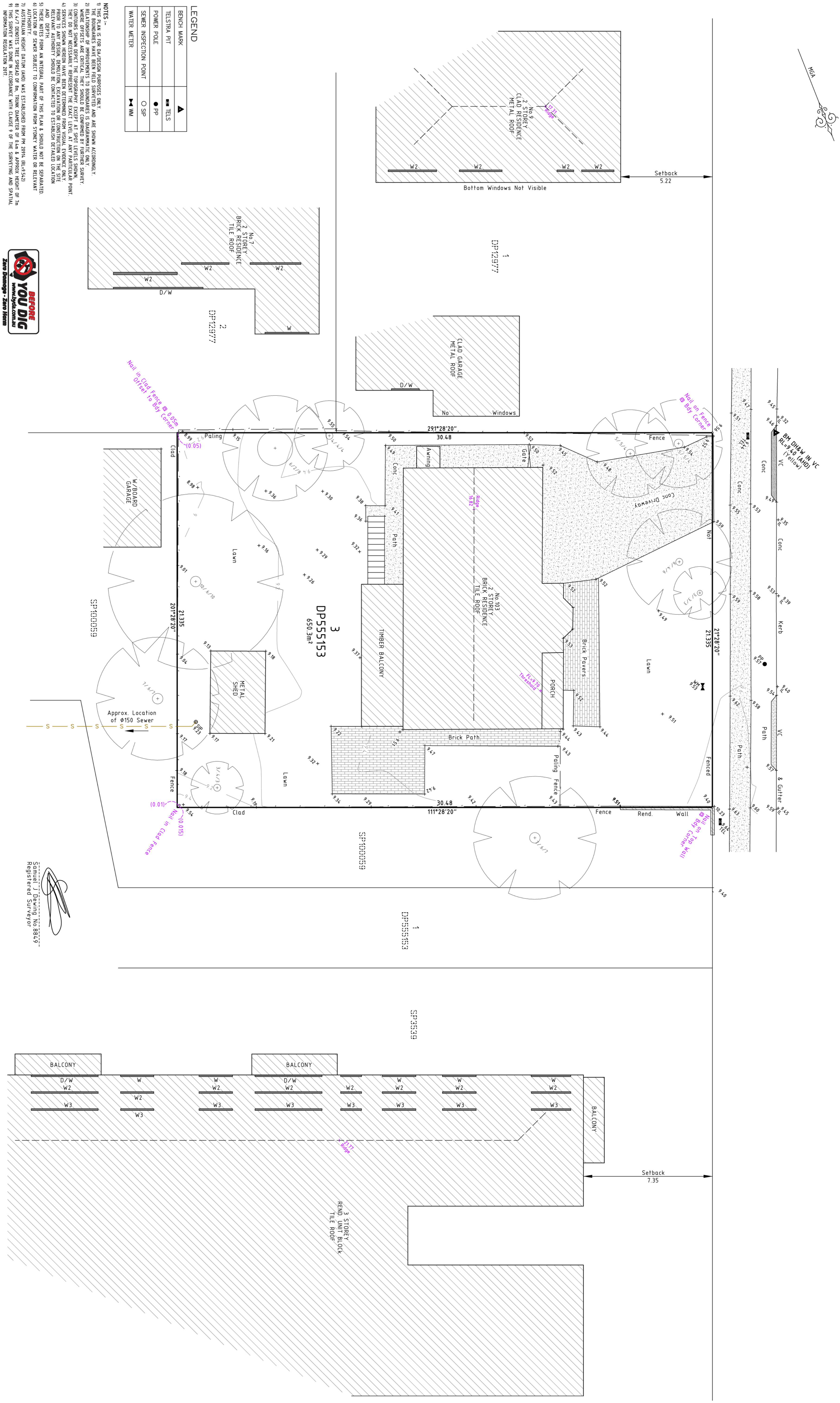

LEGEND

BENCH MARK	▲
TELSTRA PIT	■ TELS
POWER POLE	● PIP
SEWER INSPECTION POINT	○ SIP
WATER METER	◀ WM

- NOTES:-**
- THIS PLAN IS FOR DAY/PERSON PURPOSES ONLY AND ARE SHOWN ACCORDINGLY.
 - RELATIONS OF IMPROVEMENTS TO BOUNDARIES IS DETERMINED BY SURVEY.
 - WHERE OFFSETS ARE CRITICAL THEY SHOULD BE CONFIRMED BY FURTHER SURVEY.
 - CONTOURS SHOWN DEPICT THE TOPOGRAPHY EXCEPT AT SPOT LEVELS SHOWN.
 - SERVICES SHOWN HEREON HAVE BEEN DETERMINED FROM VISUAL EVIDENCE ONLY PRIOR TO ANY DESIGN, DEMOLITION, EXCAVATION OR CONSTRUCTION ON THE SITE AND THE SURVEYOR ACCEPTS NO LIABILITY FOR THE ACCURACY OF THESE SERVICES.
 - RELEVANT AUTHORITIES SHOULD BE CONTACTED TO ESTABLISH DETAILED LOCATION.
 - THESE NOTES FORM AN INTEGRAL PART OF THIS PLAN & SHOULD NOT BE SEPARATED.
 - LOCATION OF SEWER SUBJECT TO CORROBORATION FROM STONEY WATER OR RELEVANT AUTHORITY.
 - AUTOMATIC HEIGHT DATUM (AHD) HAS ESTABLISHED FROM PM 7091 (84.542).
 - 8/4/17 SERVICES THE SPREAD OF 60, TRUNK DIAMETER OF 0.4m & APPROX HEIGHT OF THE INFORMATION REGULATION 2017.
 - THIS SURVEY WAS DONE IN ACCORDANCE WITH CLAUSE 9 OF THE SURVEYING AND SPATIAL INFORMATION REGULATION 2017.



All Correspondence to:

BURTON & FIELD
 surveying & land development

Suite 202, 2 Pembroke Street Epping 2171
 P.O. Box 1150, Epping 1710
 Tel: (02) 9888-4660
 Email: epping@burtonandfield.com.au
 34/3 Hume Highway, Liverpool 2170
 P.O. Box 242 Liverpool BC 1871
 Tel: (02) 9662-1199
 Email: survey@burtonandfield.com.au
 Web: www.burtonandfield.com.au

REVISION

DATE	REF.	SURVEYED BY	DRAWN BY	CHECKED BY
20/11/2024	ET142-87394	JR	RR	BD

CLIENT: PGL SCOTT CONSTRUCTIONS

PROJECT: **PLAN SHOWING DETAIL & LEVELS OVER LOT 3 IN DP555153**
 No.103 OCEAN STREET, NARRABEEN, 2101

LG: NORTHERN BEACHES
 COMP REF: J187394_C

ISSUE: **A**
 SHEET: **1**
 OF 1 SHEETS

DATUM: AHD
 SCALE: 1:100

Samuel J Dewing No 8849
 Registered Surveyor