

# ALTERATIONS AND ADDITIONS - WOOLWORTHS NARRABEEN, 12 LAGOON STREET, NARRABEEN, NSW CIVIL ENGINEERING WORKS

## GENERAL NOTES:

- ALL WORK TO BE CARRIED OUT IN ACCORDANCE WITH NORTHERN BEACHES COUNCIL COURSE OF THE WORKS.
- ALL NEW WORKS ARE TO MAKE A SMOOTH JUNCTION WITH EXISTING CONDITIONS AND MARRY IN A 'WORKMANLIKE' MANNER.
- THE CONTRACTOR IS TO VERIFY THE LOCATION OF ALL SERVICES WITH EACH RELEVANT AUTHORITY. ANY DAMAGE TO SERVICES SHALL BE RECTIFIED BY THE CONTRACTOR OR THE RELEVANT AUTHORITY AT THE CONTRACTOR'S EXPENSE. SERVICES SHOWN ON THESE PLANS ARE ONLY THOSE EVIDENT AT THE TIME OF SURVEY OR AS DETERMINED FROM SERVICE DIAGRAMS. H & H CONSULTING ENGINEERS PTY. LTD CANNOT GUARANTEE THE INFORMATION SHOWN NOR ACCEPT ANY RESPONSIBILITY FOR INACCURACIES OR INCOMPLETE DATA.
- SERVICES & ACCESSES TO THE EXISTING PROPERTIES ARE TO BE MAINTAINED IN WORKING ORDER AT ALL TIMES DURING CONSTRUCTION.
- ADJUST EXISTING SERVICE COVERS TO SUIT NEW FINISHED LEVELS TO RELEVANT AUTHORITY REQUIREMENTS WHERE NECESSARY.
- REINSTATE AND STABILISE ALL DISTURBED LANDSCAPED AREAS.
- MINIMUM GRADE OF SUBSOIL SHALL BE 0.5% (1:200) FALL TO OUTLETS.
- ALL TEMPORARY SEDIMENT AND EROSION CONTROL DEVICES ARE TO BE CONSTRUCTED, PLACED AND MAINTAINED IN ACCORDANCE WITH THE TECHNICAL SPECIFICATIONS. EROSION AND SEDIMENTATION CONTROL PLAN AND NORTHERN BEACHES COUNCIL REQUIREMENTS WHERE APPLICABLE.
- CONTRACTOR TO CHECK AND CONFIRM SITE DRAINAGE CONNECTIONS ACROSS THE VERGE PRIOR TO COMMENCEMENT OF SITE DRAINAGE WORKS.
- PROPERTIES AFFECTED BY THE WORKS ARE TO BE NOTIFIED IN ADVANCE WHERE DISRUPTION TO EXISTING ACCESS IS LIKELY.

## EXISTING SERVICES & FEATURES

- THE CONTRACTOR SHALL ALLOW FOR THE CAPPING OFF, EXCAVATION AND REMOVAL (IF REQUIRED) OF ALL EXISTING SERVICES IN AREAS AFFECTED BY WORKS WITHIN THE CONTRACT AREA OR AS SHOWN ON THE DRAWINGS UNLESS DIRECTED OTHERWISE BY THE SUPERINTENDENT.
- THE CONTRACTOR SHALL ENSURE THAT AT ALL TIMES SERVICES TO ALL BUILDINGS NOT AFFECTED BY THE WORKS ARE NOT DISRUPTED.
- PRIOR TO COMMENCEMENT OF ANY WORKS THE CONTRACTOR SHALL GAIN APPROVAL OF HIS PROGRAM FOR THE RELOCATION/ CONSTRUCTION OF TEMPORARY SERVICES.
- CONTRACTOR SHALL CONSTRUCT TEMPORARY SERVICES TO MAINTAIN SUPPLY TO EXISTING BUILDING REMAINING IN OPERATION DURING WORKS TO THE SATISFACTION AND APPROVAL OF THE SUPERINTENDENT. ONCE DIVERSION IS COMPLETE AND COMMISSIONED, THE CONTRACTOR SHALL REMOVE ALL SUCH TEMPORARY SERVICES AND MAKE GOOD TO THE SATISFACTION OF THE SUPERINTENDENT.
- INTERRUPTION TO SUPPLY OF EXISTING SERVICES SHALL BE DONE SO AS NOT TO CAUSE ANY INCONVENIENCE TO THE PRINCIPAL. CONTRACTOR TO GAIN APPROVAL FROM THE SUPERINTENDENT FOR TIME OF INTERRUPTION.
- EXISTING SERVICES, BUILDINGS, EXTERNAL STRUCTURES AND TREES SHOWN ON THESE DRAWINGS ARE EXISTING FEATURES PRIOR TO ANY DEMOLITION WORKS.
- EXISTING SERVICES UNLESS SHOWN ON SURVEY PLAN HAVE BEEN PLOTTED FROM SERVICES SEARCH PLANS AND AS SUCH THEIR ACCURACY CANNOT BE GUARANTEED. IT IS THE RESPONSIBILITY OF THE CONTRACTOR TO COMPLETE A 'DIAL BEFORE YOU DIG' SEARCH AND TO ESTABLISH THE LOCATION AND LEVEL OF ALL EXISTING SERVICES PRIOR TO THE COMMENCEMENT OF ANY WORK. ANY DISCREPANCIES SHALL BE REPORTED TO THE SUPERINTENDENT. CLEARANCES SHALL BE OBTAINED FROM THE RELEVANT SERVICE AUTHORITY.
- ALL BRANCH GAS AND WATER SERVICES UNDER DRIVEWAYS AND BRICK PAVING SHALL BE LOCATED IN Ø80 uPVC SEWER GRADE CONDUITS EXTENDING A MINIMUM OF 500mm BEYOND EDGE OF PAVING.



LOCALITY SKETCH

SCALE: NTS

## DRAWING SCHEDULE

ID	Description
21Q72_DA_C000	COVER SHEET, DRAWING SCHEDULE, NOTES AND LOCALITY SKETCH
21Q72_DA_C101	DETAIL PLAN
21Q72_DA_C110	KERBING AND KERB RAMP DETAILS
21Q72_DA_C400	FLOOD CONTROLS DETAIL PLAN & SECTIONS
21Q72_DA_SE01	SEDIMENT AND EROSION CONTROL PLAN
21Q72_DA_SE02	SEDIMENT AND EROSION CONTROL DETAILS

## SITWORKS NOTES

- DATUM : A.H.D.
- ORIGIN OF LEVELS : REFER TO BENCH OR STATE SURVEY MARKS WHERE SHOWN ON PLAN.
- CONTRACTOR MUST VERIFY ALL DIMENSIONS AND EXISTING LEVELS ON SITE PRIOR TO THE COMMENCEMENT OF WORK.
- ALL WORKS TO BE UNDERTAKEN IN ACCORDANCE WITH THE DETAILS SHOWN ON THE DRAWINGS & THE DIRECTIONS OF THE SUPERINTENDENT.
- EXISTING SERVICES UNLESS SHOWN ON THE SURVEY PLAN HAVE BEEN PLOTTED FROM SERVICES SEARCH PLANS AND AS SUCH THEIR ACCURACY CANNOT BE GUARANTEED. IT IS THE RESPONSIBILITY OF THE CONTRACTOR TO ESTABLISH THE LOCATION AND LEVEL OF ALL EXISTING SERVICES PRIOR TO THE COMMENCEMENT OF ANY WORK. ANY DISCREPANCIES SHALL BE REPORTED TO THE SUPERINTENDENT. CLEARANCES SHALL BE OBTAINED FROM THE RELEVANT SERVICE AUTHORITY.
- WHERE NEW WORKS ABUT EXISTING THE CONTRACTOR SHALL ENSURE THAT A SMOOTH EVEN PROFILE, FREE FROM ABRUPT CHANGES IS ACHIEVED.
- THE CONTRACTOR SHALL ARRANGE ALL SURVEY SETOUT TO BE CARRIED OUT BY A REGISTERED SURVEYOR.
- CARE IS TO BE TAKEN WHEN EXCAVATING NEAR EXISTING SERVICES. NO MECHANICAL EXCAVATION IS TO BE UNDERTAKEN OVER TELSTRA OR ELECTRICAL SERVICES. HAND EXCAVATE IN THESE AREAS.
- CONTRACTOR TO OBTAIN AUTHORITY APPROVALS WHERE APPLICABLE.
- MAKE SMOOTH TRANSITION TO EXISTING SURFACES AND MAKE GOOD.
- THESE PLANS SHALL BE READ IN CONJUNCTION WITH APPROVED LANDSCAPE, ARCHITECTURAL, STRUCTURAL, HYDRAULIC AND MECHANICAL DRAWINGS AND SPECIFICATIONS OR WRITTEN INSTRUCTIONS THAT MAY BE ISSUED RELATING TO DEVELOPMENT AT THE SITE.
- TRENCHES THROUGH EXISTING ROAD AND CONCRETE PAVEMENTS SHALL BE SAWCUT TO FULL DEPTH OF CONCRETE AND A MINIMUM OF 50mm IN BITUMINOUS PAVING.
- ALL BRANCH GAS AND WATER SERVICES UNDER DRIVEWAYS AND BRICK PAVING SHALL BE LOCATED IN Ø80 uPVC SEWER GRADE CONDUITS EXTENDING A MINIMUM OF 500mm BEYOND EDGE OF PAVING.
- GRADES TO PAVEMENTS TO BE AS IMPLIED BY RL'S ON PLAN. GRADE EVENLY BETWEEN NOMINATED RL'S. AREAS EXHIBITING PONDING GREATER THAN 5mm DEPTH WILL NOT BE ACCEPTED UNLESS IN A DESIGNATED SAG POINT.
- ALL COVERS AND GRATES ETC TO EXISTING SERVICE UTILITIES ARE TO BE ADJUSTED TO SUIT NEW FINISHED SURFACE LEVELS WHERE APPLICABLE.

## SURVEY NOTES

THE EXISTING SITE CONDITIONS SHOWN ON THE FOLLOWING DRAWINGS HAVE BEEN INVESTIGATED BY THE SURVEYOR SPECIFIED IN THE TITLE BLOCK.  
THE INFORMATION IS SHOWN TO PROVIDE A BASIS FOR DESIGN. HENRY AND HYMAS PTY. LTD. DOES NOT GUARANTEE THE ACCURACY OR COMPLETENESS OF THE SURVEY BASE OR ITS SUITABILITY AS A BASIS FOR CONSTRUCTION DRAWINGS.  
SHOULD DISCREPANCIES BE ENCOUNTERED DURING CONSTRUCTION BETWEEN THE SURVEY DATA AND ACTUAL FIELD DATA, CONTACT HENRY AND HYMAS PTY. LTD. THE FOLLOWING NOTES HAVE BEEN TAKEN DIRECTLY FROM ORIGINAL SURVEY DOCUMENTS.

**FOR DA ONLY**

SURVEY INFORMATION				Client				Project				Drawn		Designed		Date	
SURVEYED BY REALSERVE				Woolworths				ALTERATIONS AND ADDITIONS - WOOLWORTHS NARRABEEN 12 LAGOON STREET, NARRABEEN, NSW				M.Pereira		N.Wetzlar		DEC 2021	
DATUM: AHD ORIGIN OF LEVELS: PM 20913				MCHP				Suite 2.01 826 Pacific Highway Gordon NSW 2072				A.Francis		A.Francis		Scale: 0/1 NTS	
02 ISSUED FOR DEVELOPMENT APPLICATION				This drawing and design remains the property of Henry & Hymas and may not be copied in whole or in part without the prior written approval of Henry & Hymas.				Telephone +61 2 9417 8400 Facsimile +61 2 9417 8337 Email email@hhconsult.com.au Web www.henryandhymas.com.au				Drawing number		Revision			
01 ISSUED FOR DEVELOPMENT APPLICATION								henry&hymas				21Q72_DA_C000		02			
REVISION	AMENDMENT	DRAWN	DESIGNED	DATE	REVISION	AMENDMENT	DRAWN	DESIGNED	DATE								

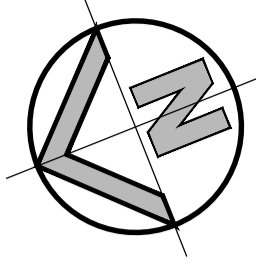

**LEGEND**

- EXISTING BOUNDARY
- RL 4.520 PROPOSED SPOT LEVEL
- ex.RL 4.520 EXISTING SPOT LEVEL
- IK PROPOSED INTEGRAL KERB
- BOL PROPOSED BOLLARD
- PR PROPOSED KERB RAMP
- PROPOSED STORMWATER PIPE
- PROPOSED SURFACE INLET PITS

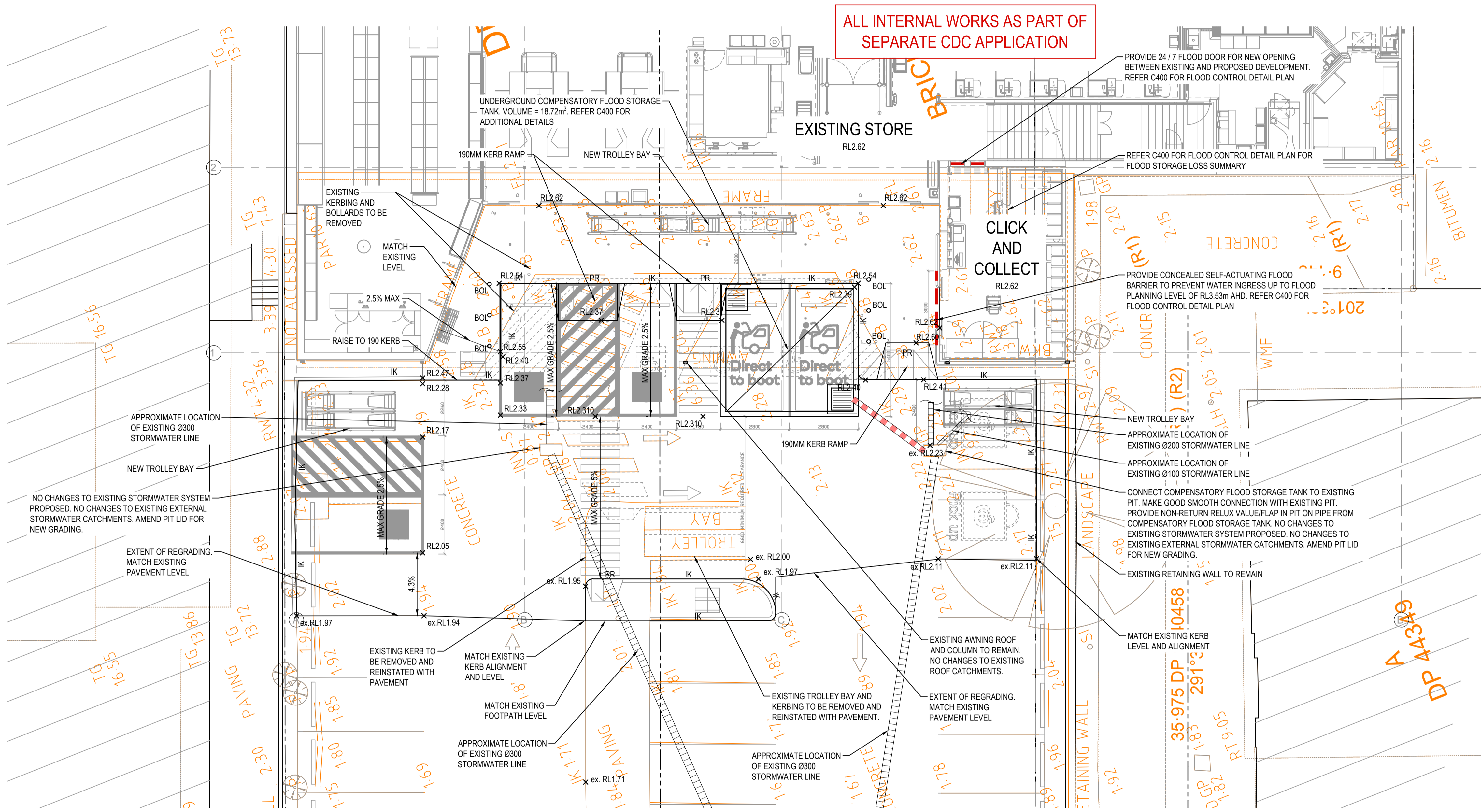

ALL INTERNAL WORKS AS PART OF SEPARATE CDC APPLICATION

**DETAIL PLAN**  
SCALE: 1:100

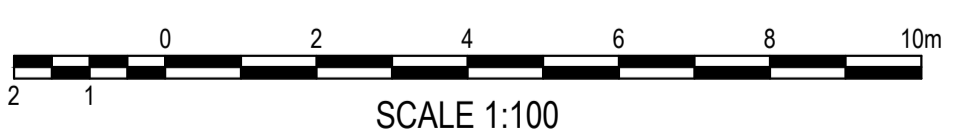

FOR DA ONLY

<p><b>SURVEY INFORMATION</b> SURVEYED BY REALSERVE DATUM: AHD ORIGIN OF LEVELS: PM 20913</p>																																																																																																																							
	<table border="1" style="width: 100%; border-collapse: collapse;"> <tr> <td style="width: 5%;">04</td> <td style="width: 75%;">ISSUED FOR DEVELOPMENT APPLICATION</td> <td style="width: 5%;">MP</td> <td style="width: 5%;">NW</td> <td style="width: 10%;">30.06.2022</td> </tr> <tr> <td>03</td> <td>ISSUED FOR DEVELOPMENT APPLICATION</td> <td>MP</td> <td>NW</td> <td>11.05.2022</td> </tr> <tr> <td>02</td> <td>ISSUED FOR DEVELOPMENT APPLICATION</td> <td>MP</td> <td>NW</td> <td>20.12.2021</td> </tr> <tr> <td>01</td> <td>ISSUED FOR DEVELOPMENT APPLICATION</td> <td>MP</td> <td>NW</td> <td>07.12.2021</td> </tr> </table>	04	ISSUED FOR DEVELOPMENT APPLICATION	MP	NW	30.06.2022	03	ISSUED FOR DEVELOPMENT APPLICATION	MP	NW	11.05.2022	02	ISSUED FOR DEVELOPMENT APPLICATION	MP	NW	20.12.2021	01	ISSUED FOR DEVELOPMENT APPLICATION	MP	NW	07.12.2021																																																																																																		
	04	ISSUED FOR DEVELOPMENT APPLICATION	MP	NW	30.06.2022																																																																																																																		
03	ISSUED FOR DEVELOPMENT APPLICATION	MP	NW	11.05.2022																																																																																																																			
02	ISSUED FOR DEVELOPMENT APPLICATION	MP	NW	20.12.2021																																																																																																																			
01	ISSUED FOR DEVELOPMENT APPLICATION	MP	NW	07.12.2021																																																																																																																			
<table border="0" style="width: 100%;"> <tr> <td style="width: 10%;">Client</td> <td style="width: 10%;">Woolworths</td> <td style="width: 10%;"></td> <td style="width: 10%;"></td> <td style="width: 10%;"></td> <td style="width: 10%;"></td> <td style="width: 10%;"></td> <td style="width: 10%;"></td> <td style="width: 10%;"></td> <td style="width: 10%;"></td> <td style="width: 10%;"></td> <td style="width: 10%;"></td> <td style="width: 10%;"></td> <td style="width: 10%;"></td> <td style="width: 10%;"></td> <td style="width: 10%;"></td> <td style="width: 10%;"></td> <td style="width: 10%;"></td> <td style="width: 10%;"></td> <td style="width: 10%;"></td> </tr> <tr> <td>Architect</td> <td>MCHP</td> <td></td> <td></td> <td></td> <td></td> <td></td> <td></td> <td></td> <td></td> <td></td> <td></td> <td></td> <td></td> <td></td> <td></td> <td></td> <td></td> <td></td> <td></td> <td></td> </tr> <tr> <td colspan="20">                 This drawing and design remains the property of Henry &amp; Hymas and may not be copied in whole or in part without the prior written approval of Henry &amp; Hymas.             </td> </tr> </table>																				Client	Woolworths																			Architect	MCHP																				This drawing and design remains the property of Henry & Hymas and may not be copied in whole or in part without the prior written approval of Henry & Hymas.																																																										
Client	Woolworths																																																																																																																						
Architect	MCHP																																																																																																																						
This drawing and design remains the property of Henry & Hymas and may not be copied in whole or in part without the prior written approval of Henry & Hymas.																																																																																																																							
<table border="0" style="width: 100%;"> <tr> <td style="width: 10%;"></td> <td style="width: 10%;"></td> <td style="width: 10%;"></td> <td style="width: 10%;"></td> <td style="width: 10%;"></td> <td style="width: 10%;"></td> <td style="width: 10%;"></td> <td style="width: 10%;"></td> <td style="width: 10%;"></td> <td style="width: 10%;"></td> <td style="width: 10%;"></td> <td style="width: 10%;"></td> <td style="width: 10%;"></td> <td style="width: 10%;"></td> <td style="width: 10%;"></td> <td style="width: 10%;"></td> <td style="width: 10%;"></td> <td style="width: 10%;"></td> <td style="width: 10%;"></td> <td style="width: 10%;"></td> </tr> <tr> <td colspan="20">                 Project: ALTERATIONS AND ADDITIONS - WOOLWORTHS NARRABEEN                  12 LAGOON STREET, NARRABEEN, NSW             </td> </tr> <tr> <td colspan="20">                 Title: <b>DETAIL PLAN</b> </td> </tr> <tr> <td colspan="15">                 Drawn: M.Pereira                  Checked: A.Francis             </td> <td colspan="5">                 Designed: N.Wetzlar                  Approved: A.Francis             </td> </tr> <tr> <td colspan="15">                 Drawing number: <b>21Q72_DA_C101</b> </td> <td colspan="5">                 Revision: <b>04</b> </td> </tr> </table>																																								Project: ALTERATIONS AND ADDITIONS - WOOLWORTHS NARRABEEN 12 LAGOON STREET, NARRABEEN, NSW																				Title: <b>DETAIL PLAN</b>																				Drawn: M.Pereira Checked: A.Francis															Designed: N.Wetzlar Approved: A.Francis					Drawing number: <b>21Q72_DA_C101</b>															Revision: <b>04</b>				
Project: ALTERATIONS AND ADDITIONS - WOOLWORTHS NARRABEEN 12 LAGOON STREET, NARRABEEN, NSW																																																																																																																							
Title: <b>DETAIL PLAN</b>																																																																																																																							
Drawn: M.Pereira Checked: A.Francis															Designed: N.Wetzlar Approved: A.Francis																																																																																																								
Drawing number: <b>21Q72_DA_C101</b>															Revision: <b>04</b>																																																																																																								

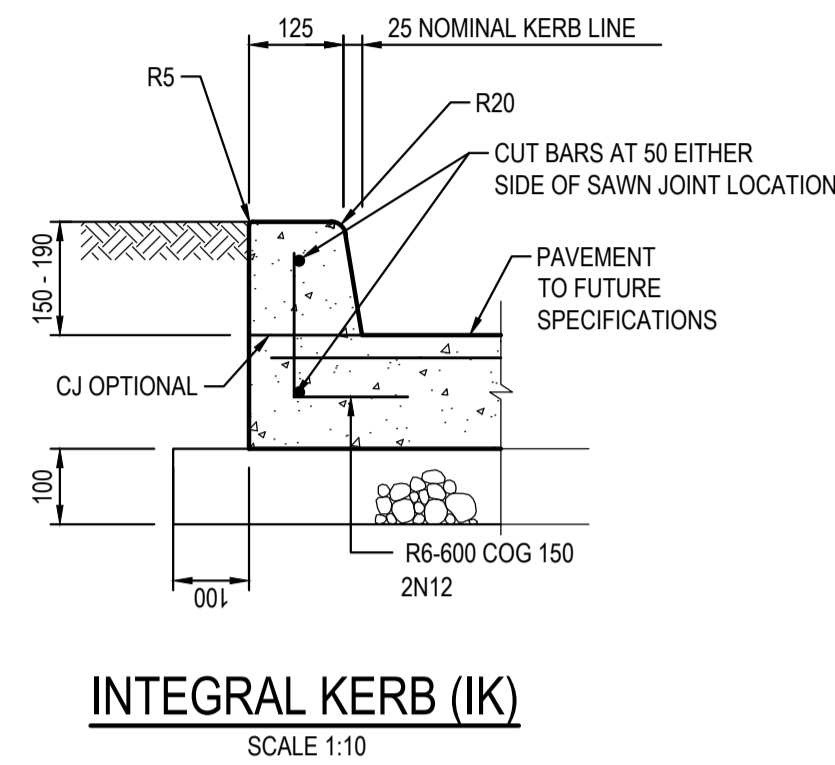

**INTEGRAL KERB (IK)**  
SCALE 1:10

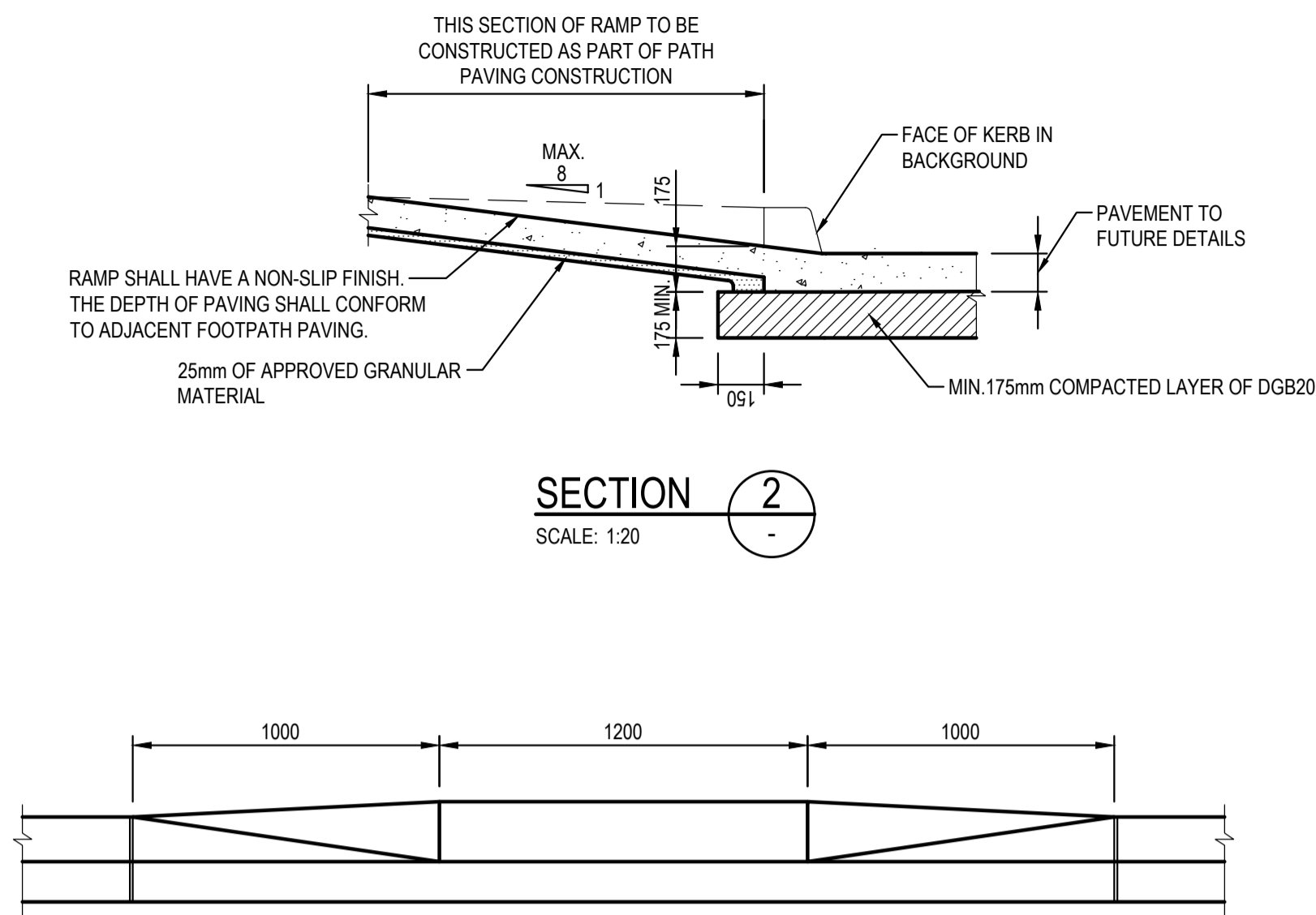

**SECTION 2**  
SCALE: 1:20

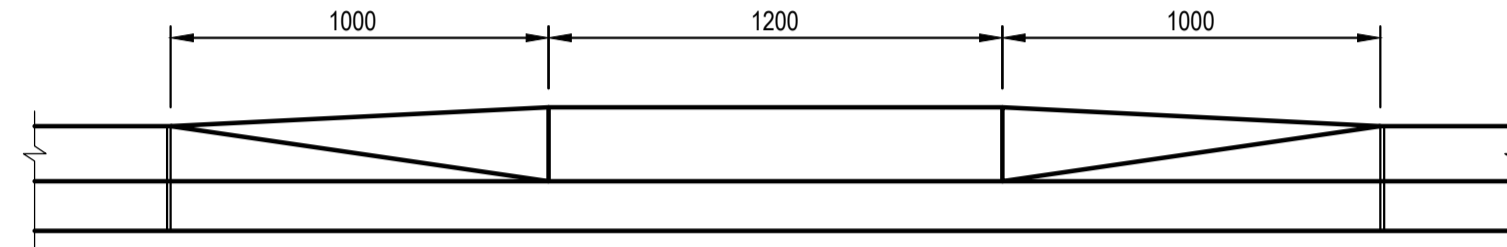

**SECTION 1**  
SCALE: 1:20

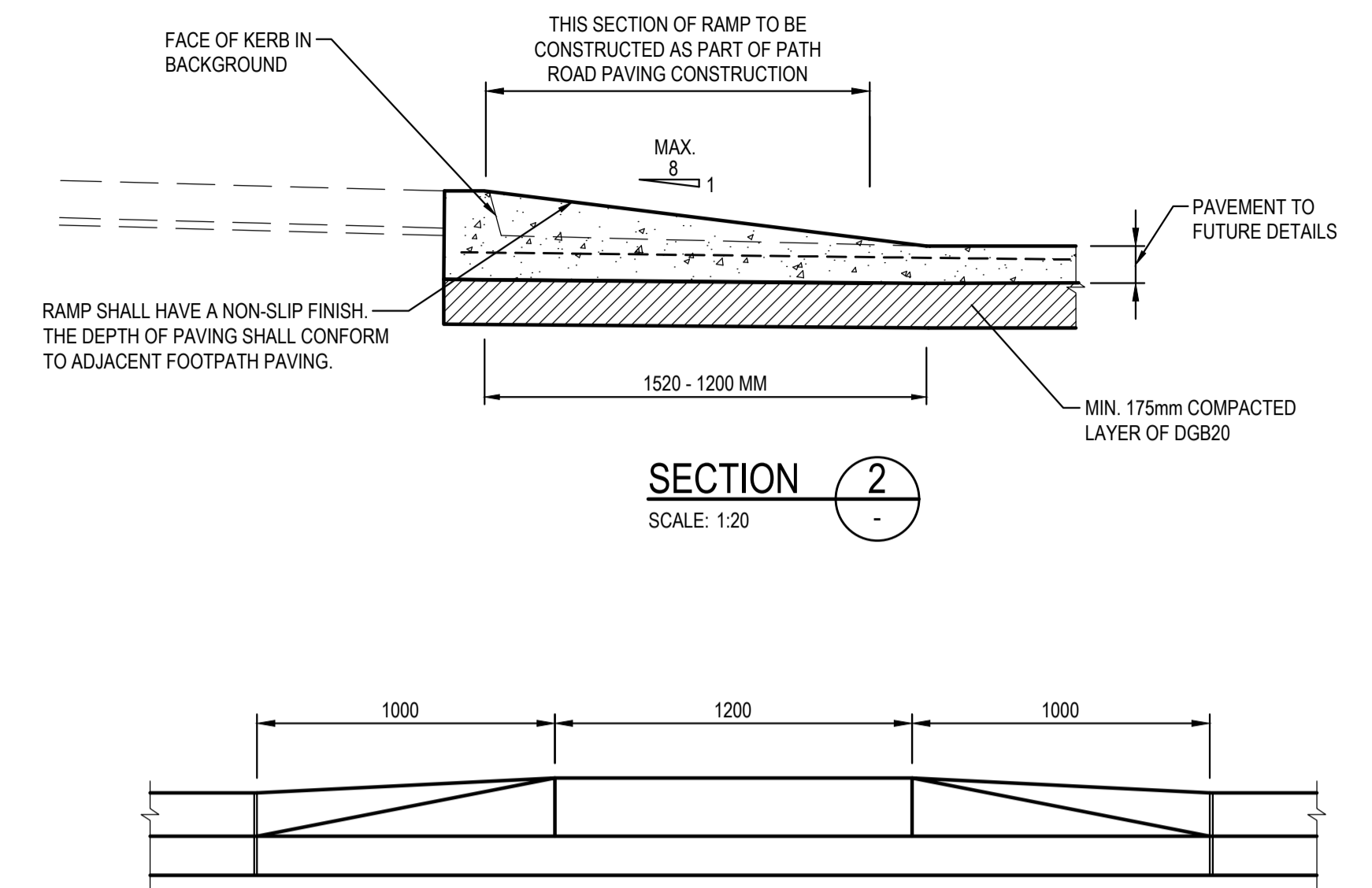

**SECTION 2**  
SCALE: 1:20

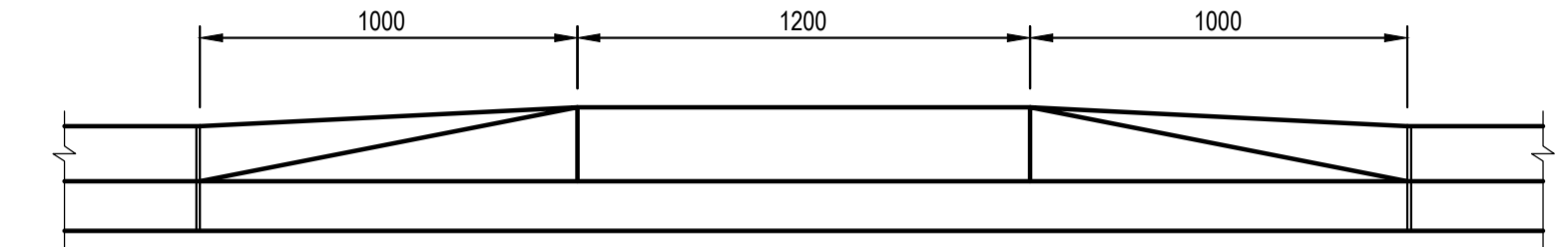

**SECTION 1**  
SCALE: 1:20

**KERBING NOTES:**

INCLUDES ALL KERBS, GUTTERS, DISH DRAINS, CROSSING AND EDGES.

- ALL KERBS, GUTTERS, DISH DRAINS AND CROSSING TO BE CONSTRUCTED ON MINIMUM 75mm GRANULAR BASE COURSE COMPACTED TO MINIMUM 98% MODIFIED MAXIMUM DRY DENSITY IN ACCORDANCE WITH AS 1289 5.2.1.
- EXPANSION JOINTS (EJ) TO BE FORMED FROM 10mm COMPRESSIBLE CORK FILTER BOARD FOR THE FULL DEPTH OF THE SECTION AND CUT TO PROFILE. EXPANSION JOINTS TO BE LOCATED AT DRAINAGE PITS, ON TANGENT POINTS OF CURVES AND ELSEWHERE AT 12m CENTRES EXCEPT FOR INTEGRAL KERBS WHERE THE EXPANSION JOINTS ARE TO MATCH THE JOINT LOCATION IN KERBS.
- WEAKENED PLANE JOINTS TO BE MIN 3mm WIDE AND LOCATED AT 3m CENTRES EXCEPT FOR INTEGRAL KERBS WHERE WEAKENED PLANE JOINTS ARE TO MATCH THE JOINT LOCATIONS IN SLABS.
- BROAMED FINISHED TO ALL RAMPED AND VEHICULAR CROSSINGS, ALL OTHER KERBING OR DISH DRAINS TO BE STEEL FLOAT FINISHED.
- IN THE REPLACEMENT OF KERBS EXISTING ROAD PAVEMENT IS TO BE SAWCUT 900mm FROM LIP OF GUTTER. UPON COMPLETION OF NEW KERBS, NEW BASE COURSE AND SURFACE IS TO BE LAID 900mm WIDE TO MATCH EXISTING MATERIALS AND THICKNESS. EXISTING ALLOTMENT DRAINAGE PIPE ARE TO BE BUILT INTO NEW KERB WITH A 100mm DIA HOLE. EXISTING KERBS ARE TO BE COMPLETELY REMOVED WHERE NEW KERBS ARE SHOWN.

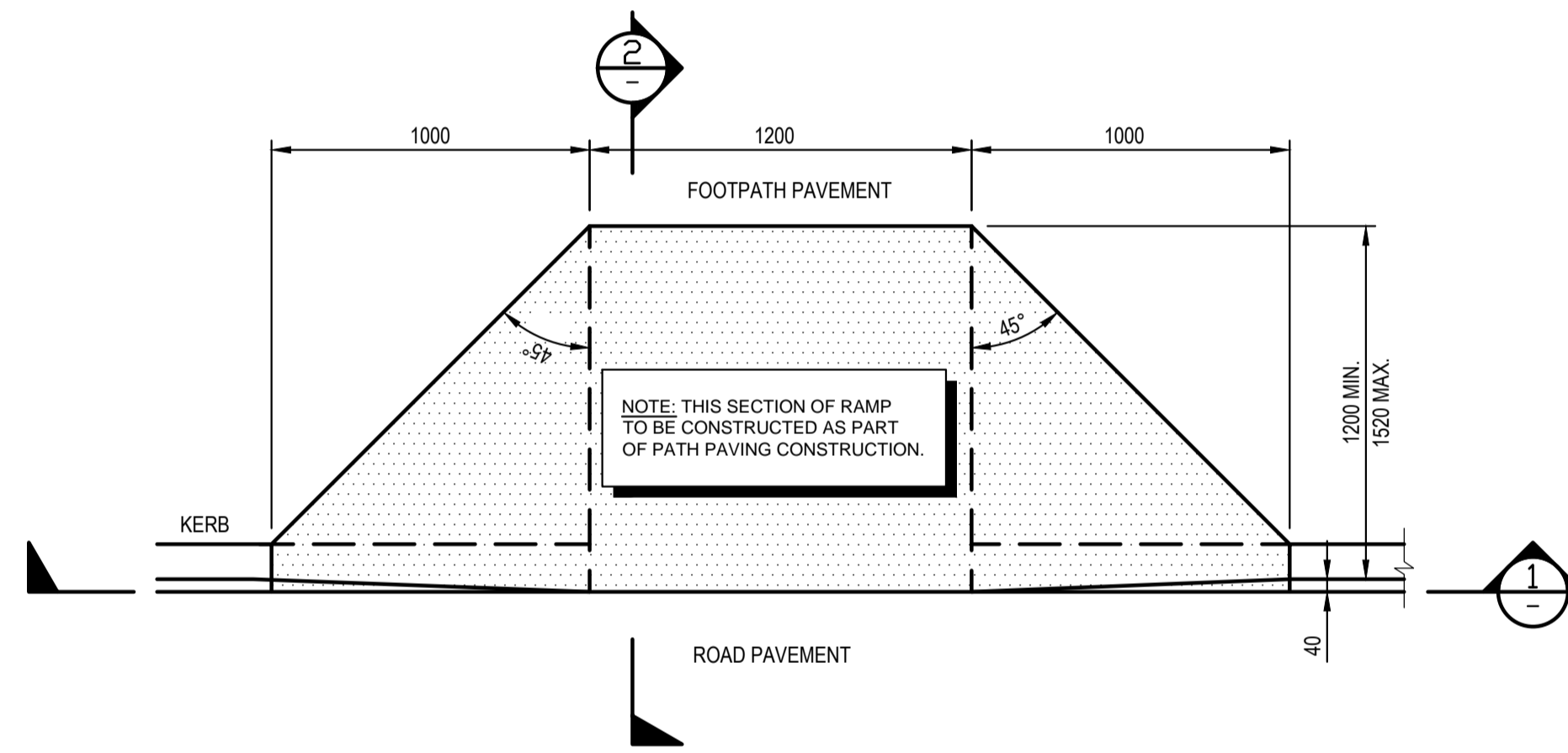

**INTERNAL - KERB RAMP DETAIL**  
SCALE 1:20

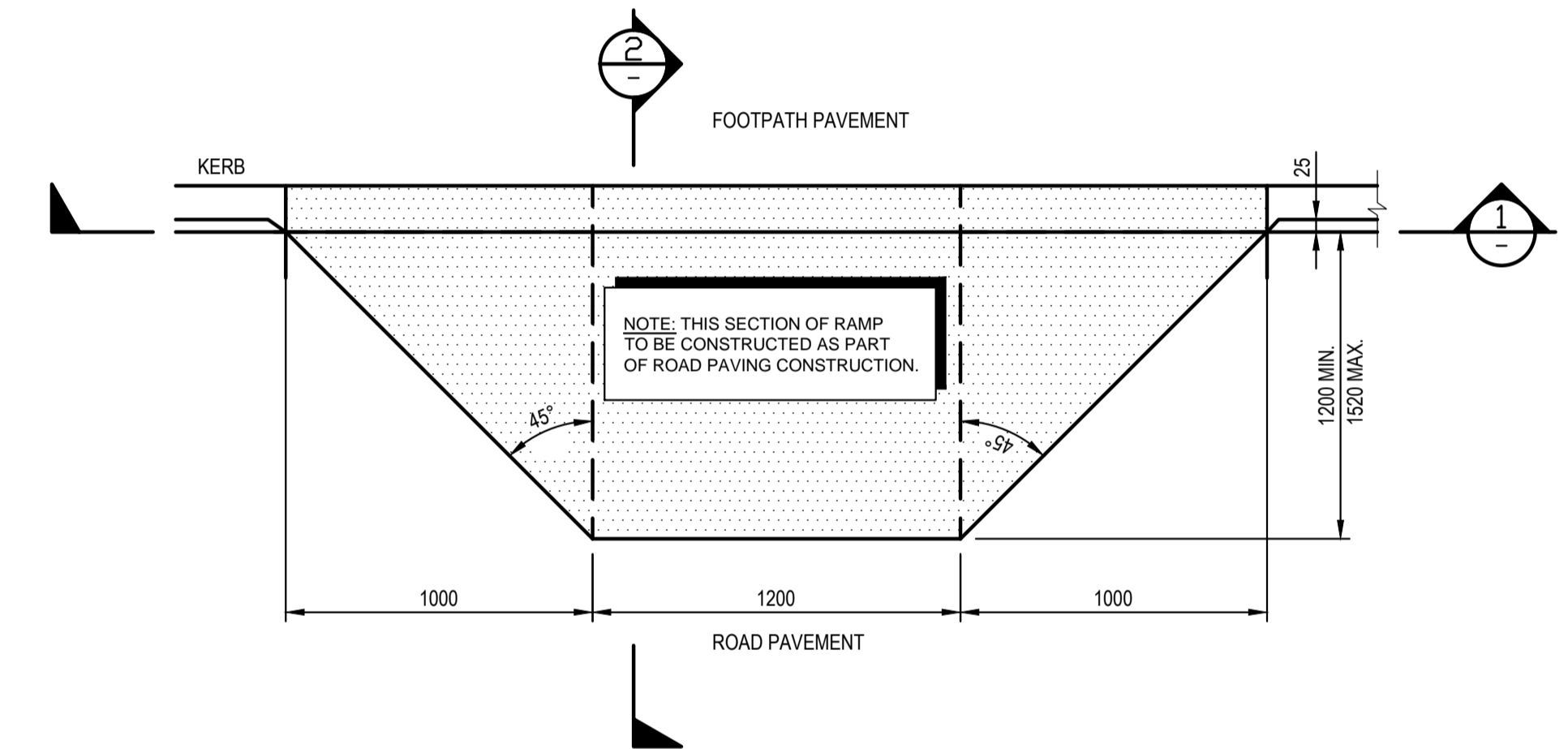

**EXTERNAL - KERB RAMP DETAIL**  
SCALE 1:20



**FOR DA ONLY**

<b>SURVEY INFORMATION</b> SURVEYED BY REALSERVE DATUM: AHD ORIGIN OF LEVELS: PM 20913					Client <b>Woolworths</b>	Suite 2.01 826 Pacific Highway Gordon NSW 2072 Telephone +61 2 9417 8400 Facsimile +61 2 9417 8337 Email email@hhconsult.com.au Web www.henryandhymas.com.au		Project <b>ALTERATIONS AND ADDITIONS - WOOLWORTHS NARRABEEN 12 LAGOON STREET, NARRABEEN, NSW</b>	Drawn M.Pereira	Designed N.Wetzlar	Date NOV 2021
					Architect <b>MCHP</b>			Checked A.Francis	Approved A.Francis	Scale @A1	AS NOTED
	02	ISSUED FOR DEVELOPMENT APPLICATION	MP	NW	11.05.2022			Drawing number <b>21Q72_DA_C110</b>			
01	ISSUED FOR DEVELOPMENT APPLICATION	MP	NW	07.12.2021	Revision <b>02</b>						
REVISION	AMENDMENT	DRAWN	DESIGNED	DATE	REVISION	AMENDMENT	DRAWN	DESIGNED	DATE	This drawing and design remains the property of Henry & Hymas and may not be copied in whole or in part without the prior written approval of Henry & Hymas.	

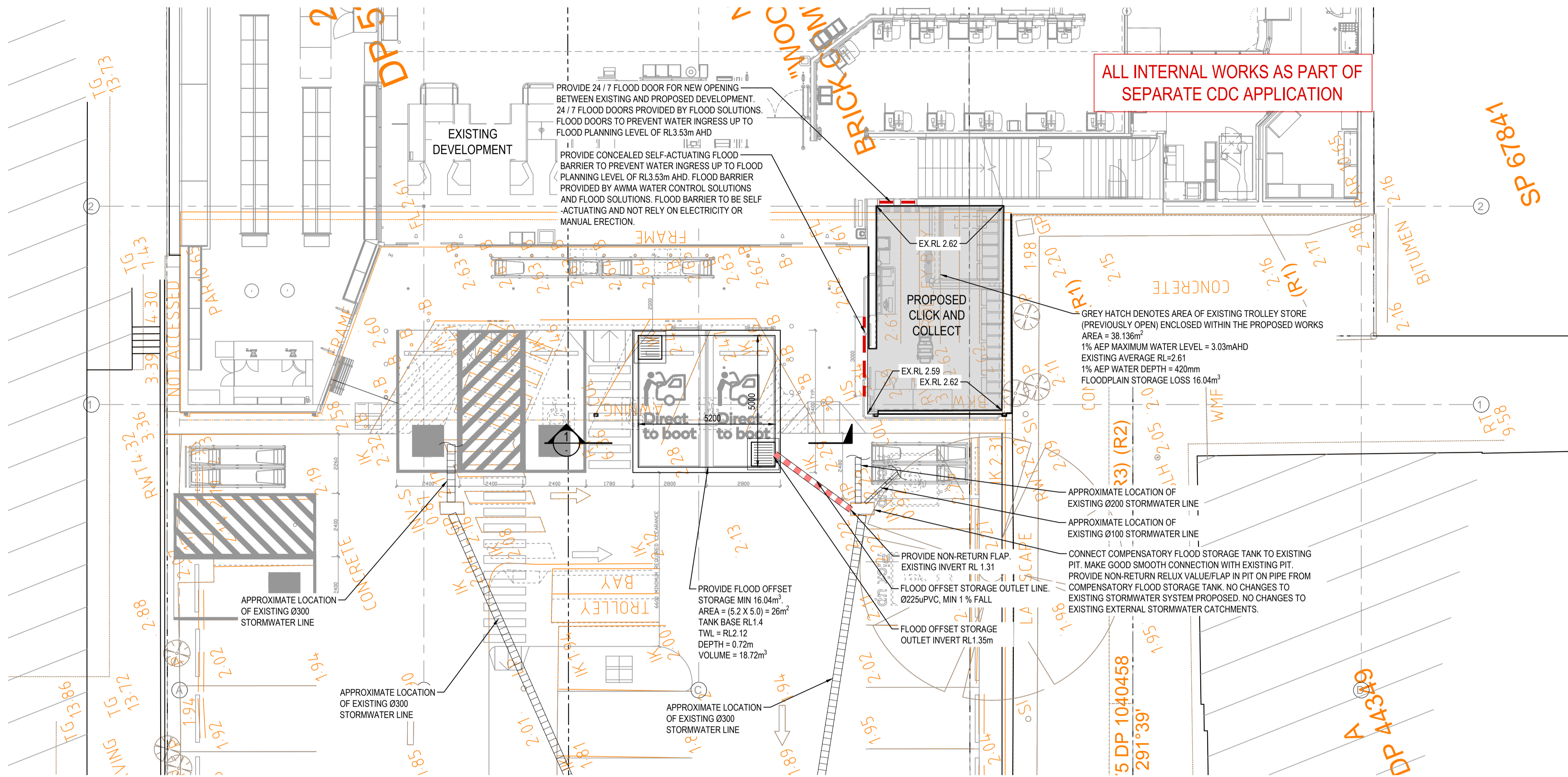
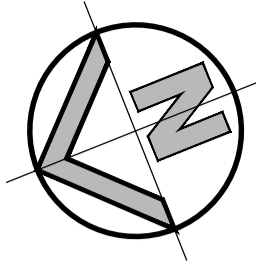

FLOOD CONTROLS - DETAIL PLAN

SCALE: 1:100

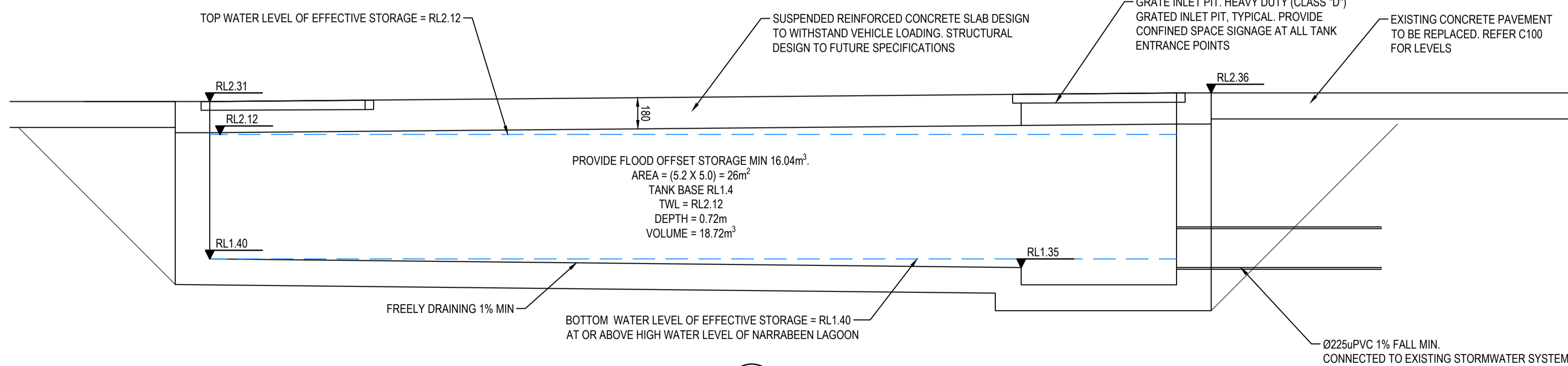

SECTION 1

SCALE: 1:20

CONFINED SPACE DANGER SIGN



COLOURS: DANGER AND BACKGROUND WHITE  
 ELLIPTICAL AREA RED  
 RECTANGLE CONTAINING ELLIPSE BLACK  
 OTHER LETTERING AND BORDER BLACK

CONFINED SPACE DANGER SIGN NOTES

- A) A CONFINED SPACE DANGER SIGN SHALL BE POSITIONED IN A LOCATION SUCH THAT IT IS CLEARLY VISIBLE TO PERSONS PROPOSING TO ENTER THE BELOW GROUND TANKS/ CONFINED SPACE AT ALL ACCESS POINTS OF THE TANK/ CONFINED SPACE.
- B) SIGN TO BE MINIMUM DIMENSIONS:- 300mm x 450mm (LARGE ENTRIES SUCH AS DOORS) 250mm x 180mm (SMALL ENTRIES I.E., GRATES, MANHOLES)
- C) SIGN SHALL BE MANUFACTURED FROM COLOUR BONDED METAL OR POLYPROPYLENE
- D) SIGN SHALL BE AFFIXED TO A SURFACE WITH SCREWS AT EACH CORNER.

**FOR DA ONLY**

**SURVEY INFORMATION**  
 SURVEYED BY REALSERVE  
 DATUM: AHD  
 ORIGIN OF LEVELS: PM 20913

REVISION	AMENDMENT	DRAWN	DESIGNED	DATE	REVISION	AMENDMENT	DRAWN	DESIGNED	DATE
02	ISSUED FOR DEVELOPMENT APPLICATION	MP	NW	20.06.2022					
01	ISSUED FOR DEVELOPMENT APPLICATION	MP	NW	11.05.2022					

Client: **Woolworths**  
 Architect: **MCHP**  
 Suite 2.01  
 826 Pacific Highway  
 Gordon NSW 2072  
 Telephone: +61 2 9417 8400  
 Facsimile: +61 2 9417 8337  
 Email: email@hhconsult.com.au  
 Web: www.henryandhymas.com.au

Project: **ALTERATIONS AND ADDITIONS - WOOLWORTHS NARRABEEN 12 LAGOON STREET, NARRABEEN, NSW**  
 Title: **FLOOD CONTROLS - DETAIL PLAN AND SECTION**



Drawn: M.Pereira  
 Designed: N.Wetzlar  
 Checked: A.Francis  
 Approved: A.Francis  
 Drawing number: **21Q72\_DA\_C400**  
 Revision: **02**

Date: NOV 2021  
 Scale: @A1  
 AS NOTED

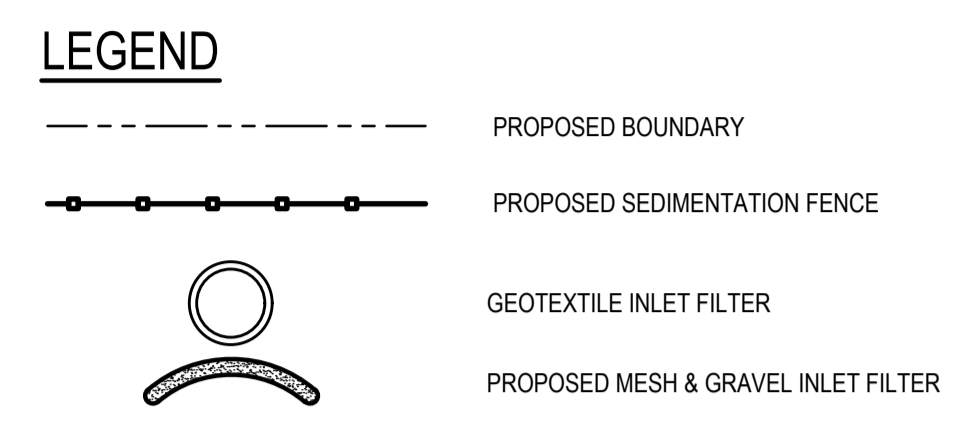
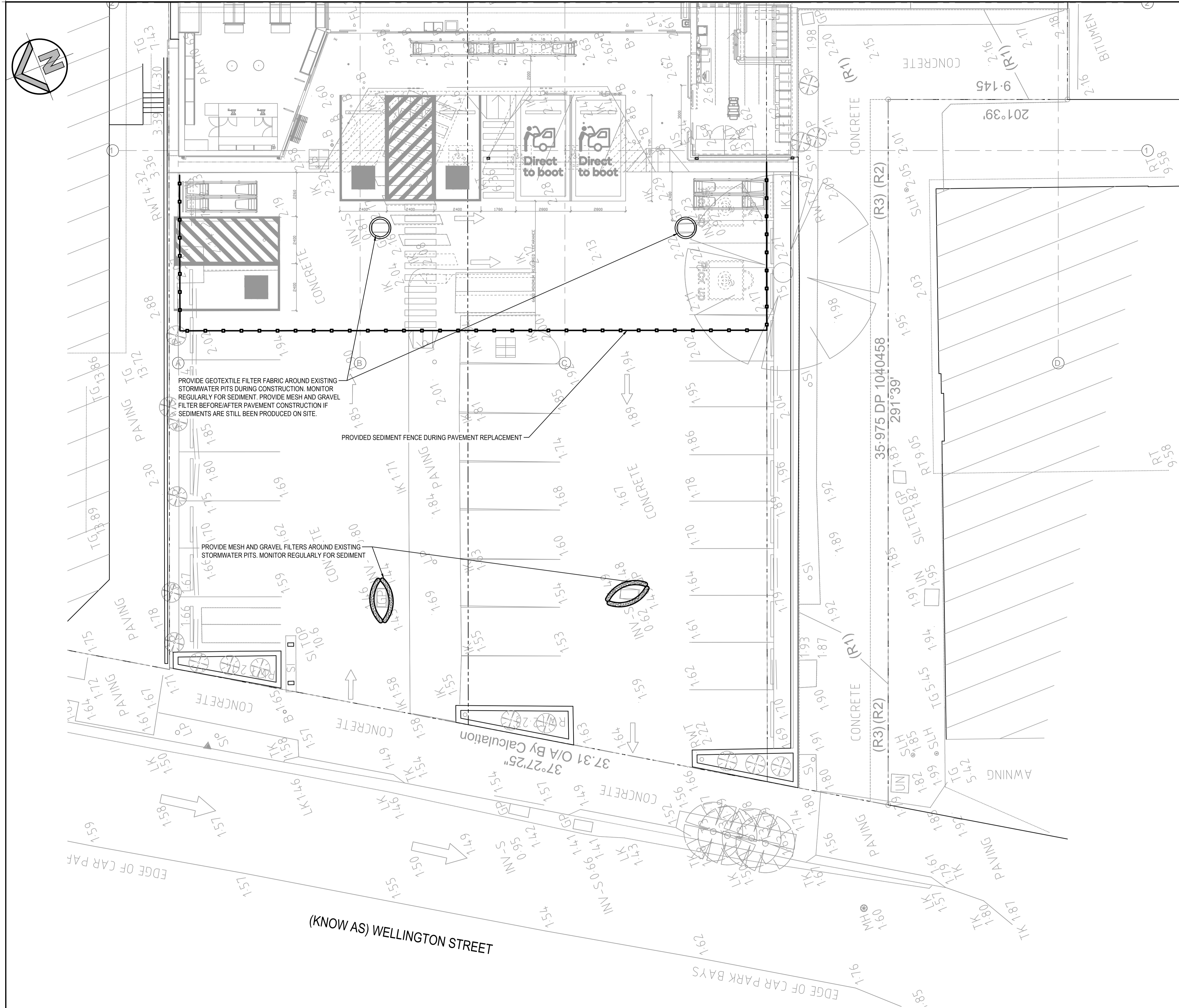

**SEDIMENT & EROSION CONTROL NOTES**

- ALL SEDIMENT CONTROL DEVICES ARE TO BE CONSTRUCTED, PLACED AND MAINTAINED IN ACCORDANCE WITH NORTHERN BEACHES COUNCIL SPECIFICATIONS AND LANDCOM'S "SOIL AND CONSTRUCTION" MANUAL.
- ALL PERIMETER & SILTATION CONTROL MEASURES ARE TO BE PLACED PRIOR TO, OR AS THE FIRST STEP IN EARTH WORKS AND/OR CLEARING.
- THE SEDIMENT & EROSION CONTROL PLAN MAY REQUIRE FUTURE ADJUSTMENT TO REFLECT CONSTRUCTION STAGING. IT IS ALSO THE CONTRACTORS RESPONSIBILITY TO PREPARE THEIR OWN SEDIMENT AND EROSION CONTROL PLAN WHICH SUITS THE DESIGNED CONSTRUCTION STAGING.
- FILTRATION BUFFER ZONES ARE TO BE FENCED OFF AND ACCESS PROHIBITED TO ALL PLANT AND MACHINERY.
- ALL TEMPORARY EARTH BERMS, DIVERSIONS & SILT DAM EMBANKMENTS ARE TO BE MACHINE COMPACTED, SEEDED & MULCHED FOR TEMPORARY VEGETATION COVER AS SOON AS THEY HAVE BEEN FORMED.
- ALL SEDIMENT TRAPPING STRUCTURES AND DEVICES ARE TO BE INSPECTED AFTER STORMS FOR STRUCTURAL DAMAGE OR CLOGGING. TRAPPED MATERIAL IS TO BE REMOVED TO A SAFE LOCATION.
- ALL TOPSOIL IS TO BE STOCKPILED ON SITE FOR REUSE (AWAY FROM TREES AND DRAINAGE LINES). MEASURES SHALL BE APPLIED TO PREVENT EROSION OF THE STOCKPILES.
- ALL EARTHWORK AREAS SHALL BE ROLLED EACH EVENING TO SEAL THE EARTHWORKS.
- ALL FILLS ARE TO BE LEFT WITH A LIP AT THE TOP OF THE SLOPE AT THE END. ALL CUT AND FILL SLOPES ARE TO BE SEEDED AND STRAW MULCHED WITHIN 14 DAYS OF COMPLETION OF FORMATION U.N.O. BY LANDSCAPE ARCHITECTS.
- UPON COMPLETION OF ALL EARTHWORKS OR AS DIRECTED BY COUNCIL SOIL CONSERVATION TREATMENTS SHALL BE APPLIED SO AS TO RENDER AREAS THAT HAVE BEEN DISTURBED, EROSION PROOF WITHIN 14 DAYS.
- EROSION AND SILT PROTECTION MEASURES ARE TO BE MAINTAINED AT ALL TIMES.

PROVIDE GEOTEXTILE FILTER FABRIC AROUND EXISTING STORMWATER PITS DURING CONSTRUCTION. MONITOR REGULARLY FOR SEDIMENT. PROVIDE MESH AND GRAVEL FILTER BEFORE/AFTER PAVEMENT CONSTRUCTION IF SEDIMENTS ARE STILL BEEN PRODUCED ON SITE.

PROVIDED SEDIMENT FENCE DURING PAVEMENT REPLACEMENT

PROVIDE MESH AND GRAVEL FILTERS AROUND EXISTING STORMWATER PITS. MONITOR REGULARLY FOR SEDIMENT

**SEDIMENT AND EROSION CONTROL PLAN**

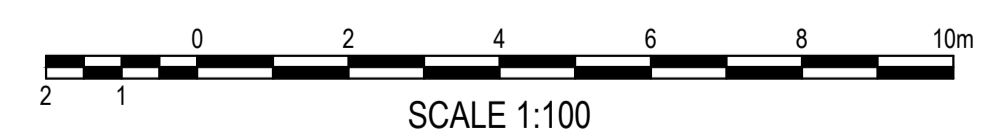

**FOR DA ONLY**

<p><b>SURVEY INFORMATION</b> SURVEYED BY REALSERVE DATUM: AHD ORIGIN OF LEVELS: PM 20913</p>	03	ISSUED FOR DEVELOPMENT APPLICATION	MP	NW	11.05.2022					<p>Client <b>Woolworths</b></p> <p>Architect <b>MCHP</b></p> <p>This drawing and design remains the property of Henry &amp; Hymas and may not be copied in whole or in part without the prior written approval of Henry &amp; Hymas.</p>	<p>Suite 2.01 826 Pacific Highway Gordon NSW 2072</p> <p>Telephone +61 2 9417 8400 Facsimile +61 2 9417 8337 Email email@hhconsult.com.au Web www.henryandhymas.com.au</p>		<p>Drawn M.Pereira</p>	<p>Designed N.Wetzlar</p>	<p>Date NOV 2021</p>
	02	ISSUED FOR DEVELOPMENT APPLICATION	MP	NW	20.12.2021								<p>Checked A.Francis</p>	<p>Approved A.Francis</p>	<p>Scale @A1 1:100</p>
	01	ISSUED FOR DEVELOPMENT APPLICATION	MP	NW	07.12.2021								<p>Drawing number <b>21Q72_DA_SE01</b></p>	<p>Revision <b>03</b></p>	
REVISION	AMENDMENT	DRAWN	DESIGNED	DATE	REVISION	AMENDMENT	DRAWN	DESIGNED	DATE						

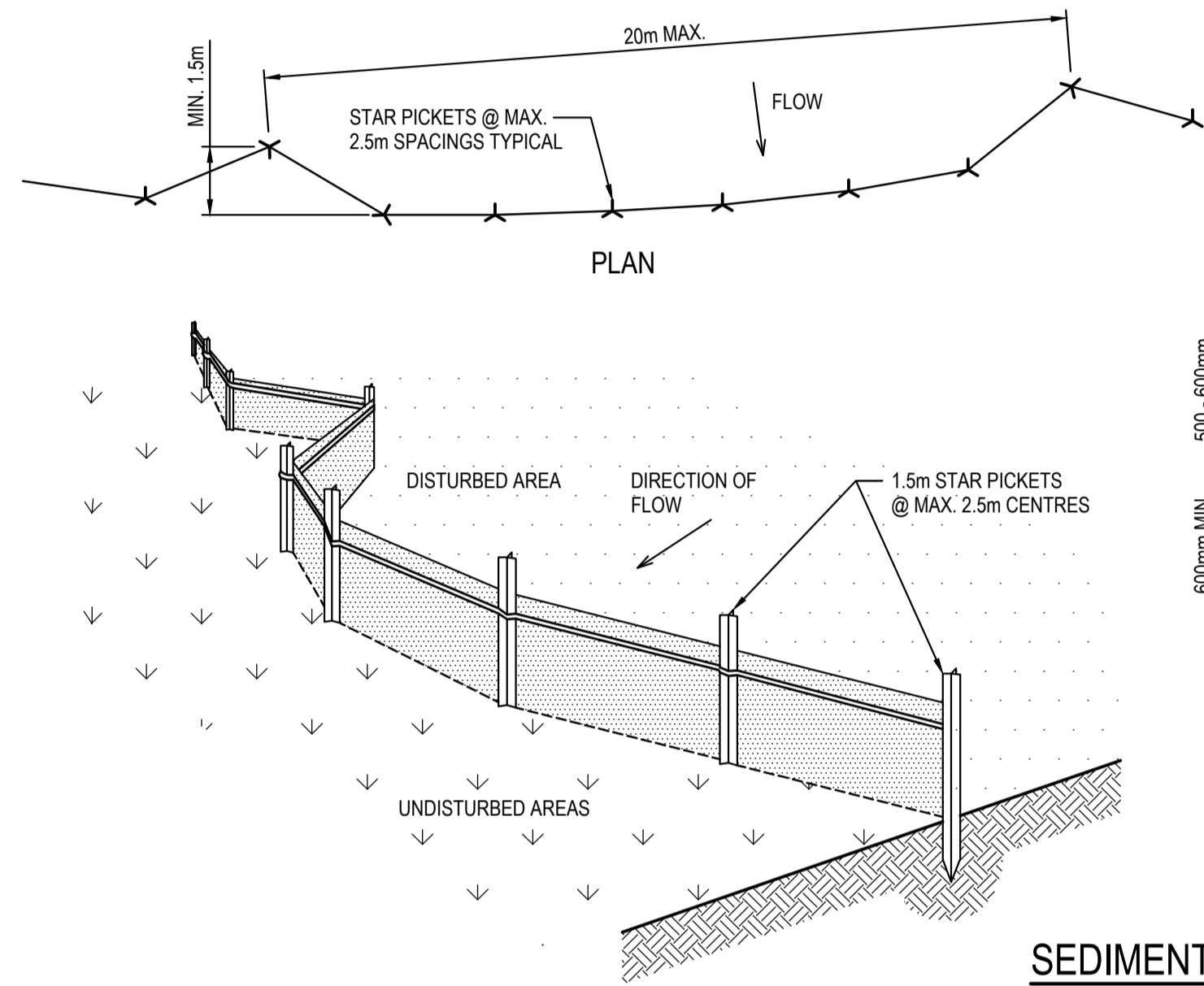

**SEDIMENT FENCE**  
SCALE N.T.S.

- SEDIMENT FENCE CONSTRUCTION NOTES:**
- CONSTRUCT SEDIMENT FENCES AS CLOSE AS POSSIBLE TO BEING PARALLEL TO THE CONTOURS OF THE SITE, BUT WITH SMALL RETURNS AS SHOWN IN THE DRAWING TO LIMIT THE CATCHMENT AREA OF ANY ONE SECTION. THE CATCHMENT AREA SHOULD BE SMALL ENOUGH TO LIMIT WATER FLOW IF CONCENTRATED AT ONE POINT TO 50 LITRES PER SECOND IN THE DESIGN STORM EVENT, USUALLY THE 10-YEAR EVENT.
  - CUT A 150mm DEEP TRENCH ALONG THE UPSLOPE LINE OF THE FENCE FOR THE BOTTOM OF THE FABRIC TO BE ENTRENCHED.
  - DRIVE 1.5m LONG STAR PICKETS INTO GROUND @ 2.5m INTERVALS (MAX.) AT THE DOWNSLOPE EDGE OF THE TRENCH. ENSURE ANY STAR PICKETS ARE FITTED WITH SAFETY CAPS.
  - FIX SELF-SUPPORTING GEOTEXTILE TO THE UPSLOPE SIDE OF THE POSTS ENSURING IT GOES TO THE BASE OF THE TRENCH. FIX THE GEOTEXTILE WITH WIRE TIES OR AS RECOMMENDED BY THE MANUFACTURER. ONLY USE GEOTEXTILE SPECIFICALLY PRODUCED FOR SEDIMENT FENCING. THE USE OF SHADE CLOTH FOR THIS PURPOSE IS NOT SATISFACTORY.
  - JOIN SECTIONS OF FABRIC AT A SUPPORT POST WITH A 150mm OVERLAP. BACKFILL THE TRENCH OVER THE BASE OF THE FABRIC AND COMPACT IT THOROUGHLY OVER THE GEOTEXTILE.

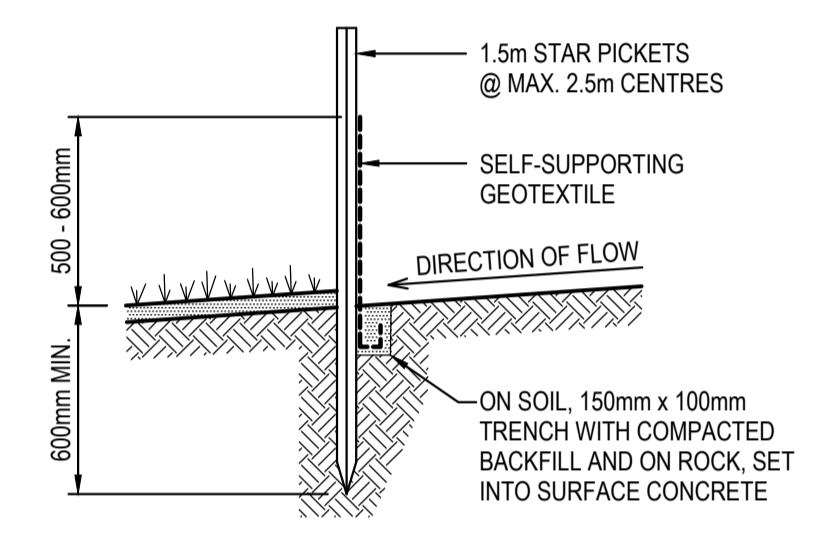

SECTION DETAIL

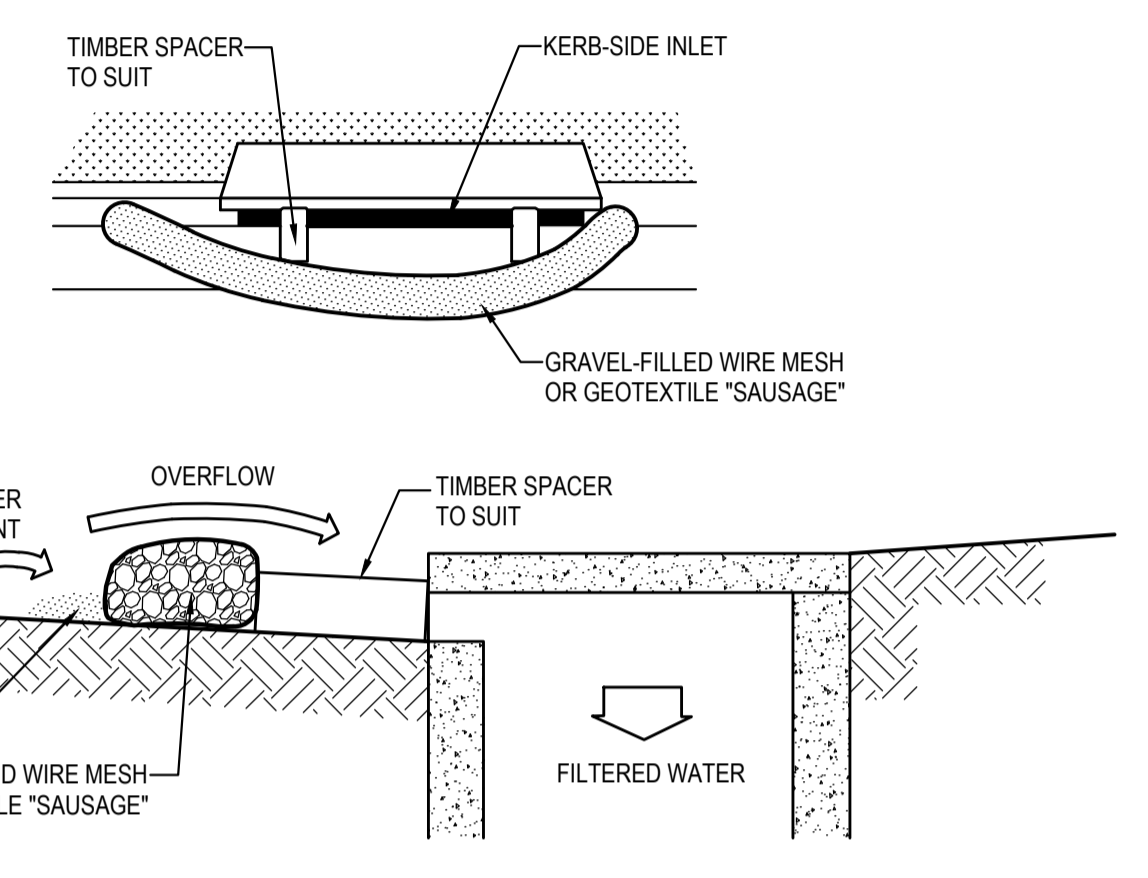

- MESH & GRAVEL INLET FILTER CONSTRUCTION NOTES:**
- FABRICATE A SLEEVE MADE FROM GEOTEXTILE OR WIRE MESH LONGER THAN THE LENGTH OF THE INLET PIT AND FILL IT WITH 25mm TO 50mm GRAVEL.
  - FORM AN ELLIPTICAL CROSS-SECTION ABOUT 150mm HIGH x 400mm WIDE.
  - PLACE THE FILTER AT THE OPENING LEAVING AT LEAST A 100mm SPACE BETWEEN IT AND THE KERB INLET. MAINTAIN THE OPENING WITH SPACER BLOCKS.
  - FORM A SEAL WITH THE KERB TO PREVENT SEDIMENT BYPASSING THE FILTER.
  - SANDBAGS FILLED WITH GRAVEL CAN SUBSTITUTE FOR THE MESH OR GEOTEXTILE PROVIDING THEY ARE PLACED SO THAT THEY CAN FIRMLY ABUT EACH OTHER AND SEDIMENT / LADEN WATERS CANNOT PASS BETWEEN.

**MESH & GRAVEL INLET FILTER**  
SCALE N.T.S.

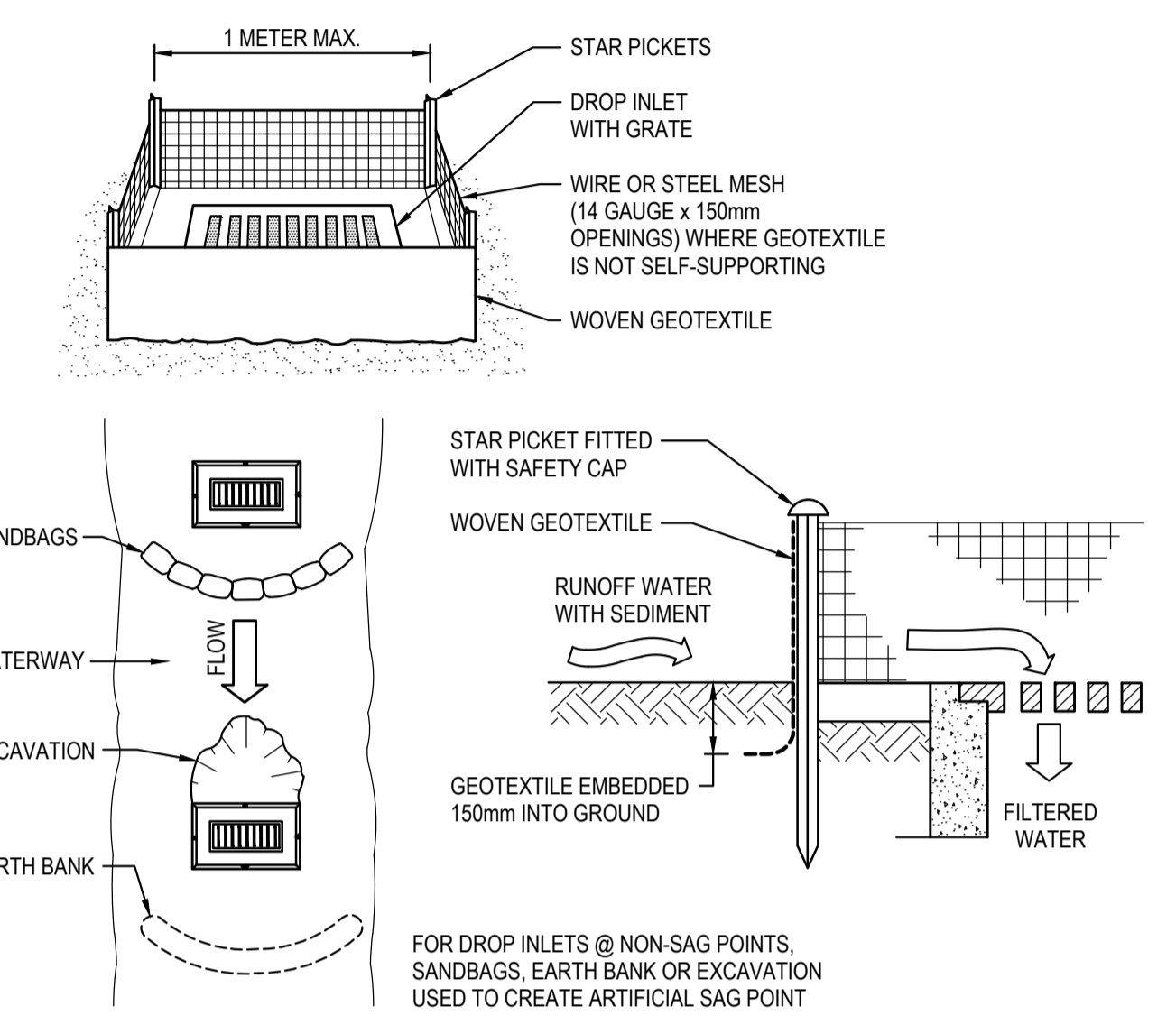

- GEOTEXTILE INLET FILTER CONSTRUCTION NOTES:**
- FABRICATE A SEDIMENT BARRIER MADE FROM GEOTEXTILE.
  - PICKET SPACING TO BE MAXIMUM 1.0m.
  - IN WATERWAYS, ARTIFICIAL SAG POINTS CAN BE CREATED WITH SANDBAGS OR EARTH BANKS AS SHOWN IN THE DRAWING.
  - DO NOT COVER THE INLET WITH GEOTEXTILES UNLESS THE DESIGN IS ADEQUATE TO ALLOW FOR ALL WATERS TO BYPASS IT.

**GEOTEXTILE INLET FILTER**  
SCALE N.T.S.

**FOR DA ONLY**

<p><b>SURVEY INFORMATION</b> SURVEYED BY REALSERVE</p> <p>DATUM: AHJ ORIGIN OF LEVELS: PM 20913</p>											Client	Woolworths	<p>Suite 2.01 826 Pacific Highway Gordon NSW 2072</p> <p>Telephone +61 2 9417 8400 Facsimile +61 2 9417 8337 Email email@hhconsult.com.au Web www.henryandhymas.com.au</p>		Project	ALTERATIONS AND ADDITIONS - WOOLWORTHS NARRABEEN 12 LAGOON STREET, NARRABEEN, NSW				
	02	ISSUED FOR DEVELOPMENT APPLICATION	MP	NW	11.05.2022						Architect	MCHP			Drawn	M.Pereira	Designed	N.Wetzlar	Date	NOV 2021
	01	ISSUED FOR DEVELOPMENT APPLICATION	MP	NW	07.12.2021										Checked	A.Francis	Approved	A.Francis	Scale	0A1
	REVISION	AMENDMENT	DRAWN	DESIGNED	DATE	REVISION	AMENDMENT	DRAWN	DESIGNED	DATE	<p>This drawing and design remains the property of Henry &amp; Hymas and may not be copied in whole or in part without the prior written approval of Henry &amp; Hymas.</p>			<p>Drawing number</p> <p><b>21Q72_DA_SE02</b></p>		<p>Revision</p> <p><b>02</b></p>				