

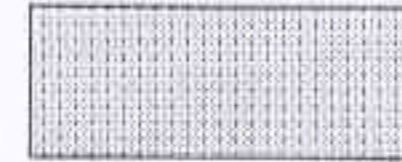

open forest bushland



disturbed vegetation



cleared market garden area



riparian habitats



existing site habitats units

tree schedule

Tree No	Genus Species	Common Name	Height (m)	Canopy Spread (m)	DBH (mm)
1	<i>Araucaria heterophylla</i>	Norfolk Pine	16	5	460
2	<i>Dendrocalamus giganteus</i>	Giant Bamboo	15	17	>40, 70-100
3	<i>Ceratopetalum apetalum</i>	Coachwood Tree	13	6	2*300
4	<i>Ceratopetalum apetalum</i>	Coachwood Tree	9	5	300
5	<i>Ceratopetalum apetalum</i>	Coachwood Tree	10	8	4*200, 2*100
6	<i>Syncarpia glomulifera</i>	Turpentine	10	8	450
7	<i>Syncarpia glomulifera</i>	Turpentine	13	6	300
8	<i>Ceratopetalum apetalum</i>	Coachwood Tree	10	7	280
9	<i>Livistona australis</i>	Cabbage Palm	9	4	340
10	<i>Ceratopetalum apetalum</i>	Coachwood Tree	10	9	200
11	<i>Livistona australis</i>	Cabbage Palm	11	4	300
12	<i>Livistona australis</i>	Cabbage Palm	11	4	300
13	<i>Allocasuarina torulosa</i>	Forest Oak	10	2	300
14	<i>Ceratopetalum apetalum</i>	Coachwood Tree	11	8	300
15	<i>Ceratopetalum apetalum</i>	Coachwood Tree	10	6	300
16	<i>Ceratopetalum gummiferum</i>	Christmas Bush	8	6	200
17	<i>Cardiospermum grandiflorum</i>	Balloon Vibe	7	6	400
18	<i>Ceratopetalum apetalum</i>	Coachwood Tree	5	6	600
19	<i>Livistona australis</i>	Cabbage Palm	10	8	700
20	<i>Eucalyptus robusta</i>	Swamp Mahogany	18	6	300
21	<i>Ceratopetalum apetalum</i>	Coachwood Tree	8	13	6*200
22	<i>Syncarpia glomulifera</i>	Turpentine	12	6	300
23	<i>Livistona australis</i>	Cabbage Palm	5	8	280
24	<i>Livistona australis</i>	Cabbage Palm	8	5	300
25	<i>Livistona australis</i>	Cabbage Palm	11	9	400
26	<i>Livistona australis</i>	Cabbage Palm	8	5	400
27	<i>Ceratopetalum apetalum</i>	Coachwood Tree	5	3	300
28	<i>Ceratopetalum apetalum</i>	Coachwood Tree	6	4	400
29	<i>Livistona australis</i>	Cabbage Palm	11	7	300
30	<i>Eucalyptus robusta</i>	Swamp Mahogany	22	20	850
31	<i>Arecastrum romanzoffianum</i>	Cocos Palm	11	4	300
32	<i>Arecastrum romanzoffianum</i>	Cocos Palm	10	4	300
33	<i>Arecastrum romanzoffianum</i>	Cocos Palm	9	4	200
34	<i>Araucaria heterophylla</i>	Norfolk Pine	9	2	160
35	<i>Arecastrum romanzoffianum</i>	Cocos Palm	14	5	300
36	<i>Arecastrum romanzoffianum</i>	Cocos Palm	14	5	300
37	<i>Arecastrum romanzoffianum</i>	Cocos Palm	14	5	300
38	<i>Arecastrum romanzoffianum</i>	Cocos Palm	14	5	300
39	<i>Corymbia gummifera</i>	Red Bloodwood	20	10	500
40	<i>Corymbia gummifera</i>	Red Bloodwood	20	13	1*300, 1*450
41	<i>Corymbia gummifera</i>	Red Bloodwood	20	11	550
42	<i>Syncarpia glomulifera</i>	Turpentine	10	6	2*300
43	<i>Angophora floribunda</i>	Rough-Barked Apple	20	14	2*240, 1*400, 1*300
44	<i>Angophora floribunda</i>	Rough-Barked Apple	17	7	1*200, 2*280
45	<i>Angophora floribunda</i>	Rough-Barked Apple	12	7	400
46	<i>Syncarpia glomulifera</i>	Turpentine	8	3	3*110
47	<i>Allocasuarina torulosa</i>	Forest Oak	8	4	150
48	<i>Angophora floribunda</i>	Rough-Barked Apple	12	6	1*100, 1*200
49	<i>Eucalyptus botryoides</i>	Bangalay	22	15	1*600, 1*220
50	<i>Eucalyptus botryoides</i>	Bangalay	10	6	2200
51	<i>Eucalyptus botryoides</i>	Bangalay	22	15	*1*600, 1*300,
52	<i>Eucalyptus botryoides</i>	Bangalay	15	8	1*200, 1*300
53	<i>Angophora floribunda</i>	Rough-Barked Apple	12	7	1*200, 1*350
53.A	<i>Angophora floribunda</i>	Rough-Barked Apple	16	7	440
53.B	<i>Corymbia gummifera</i>	Red Bloodwood	15	8	2*300
53.C	<i>Eucalyptus botryoides</i>	Bangalay	15	10	340
54	<i>Eucalyptus piperita</i>	Sydney Peppermint	25	20	1120
55	<i>Corymbia gummifera</i>	Red Bloodwood	22	11	650
55.A	<i>Eucalyptus botryoides</i>	Bangalay	25	14	700
55.B	<i>Eucalyptus botryoides</i>	Bangalay	22	14	750
55.C	<i>Corymbia gummifera</i>	Red Bloodwood	28	20	900
56	<i>Corymbia gummifera</i>	Red Bloodwood	28	18	900
57	<i>Eucalyptus piperita</i>	Sydney Peppermint	20	14	600
58	<i>Livistona australis</i>	Cabbage Palm	18	5	350
59	<i>Livistona australis</i>	Cabbage Palm	17	5	300
60	<i>Corymbia gummifera</i>	Red Bloodwood	18	5	200
61	<i>Corymbia gummifera</i>	Red Bloodwood	30	17	650
62	<i>Eucalyptus piperita</i>	Sydney Peppermint	20	16	600
63	<i>Eucalyptus piperita</i>	Sydney Peppermint	18	15	400
64	<i>Eucalyptus piperita</i>	Sydney Peppermint	16	12	400
65	<i>Eucalyptus piperita</i>	Sydney Peppermint	9	6	300
66	<i>Angophora costata</i>	Sydney Red Gum	9	5	1*200, 1*260
67	<i>Eucalyptus piperita</i>	Sydney Peppermint	20	14	800
68	<i>Angophora costata</i>	Sydney Red Gum	22	14	550
69	<i>Eucalyptus botryoides</i>	Bangalay	10	8	1*350, 1*250, 1*150, 4*80
70	<i>Angophora floribunda</i>	Rough-Barked Apple	14	7	350
71	<i>Angophora floribunda</i>	Rough-Barked Apple	23	14	500

note: no attempt was made to identify all trees within the open forest bushland. Prominent trees have been numbered and are shown on the plan and described in the above schedules. The locations of other substantial trees, not numbered, shown on this plan have been surveyed and tagged on site but are not described in the above schedule.

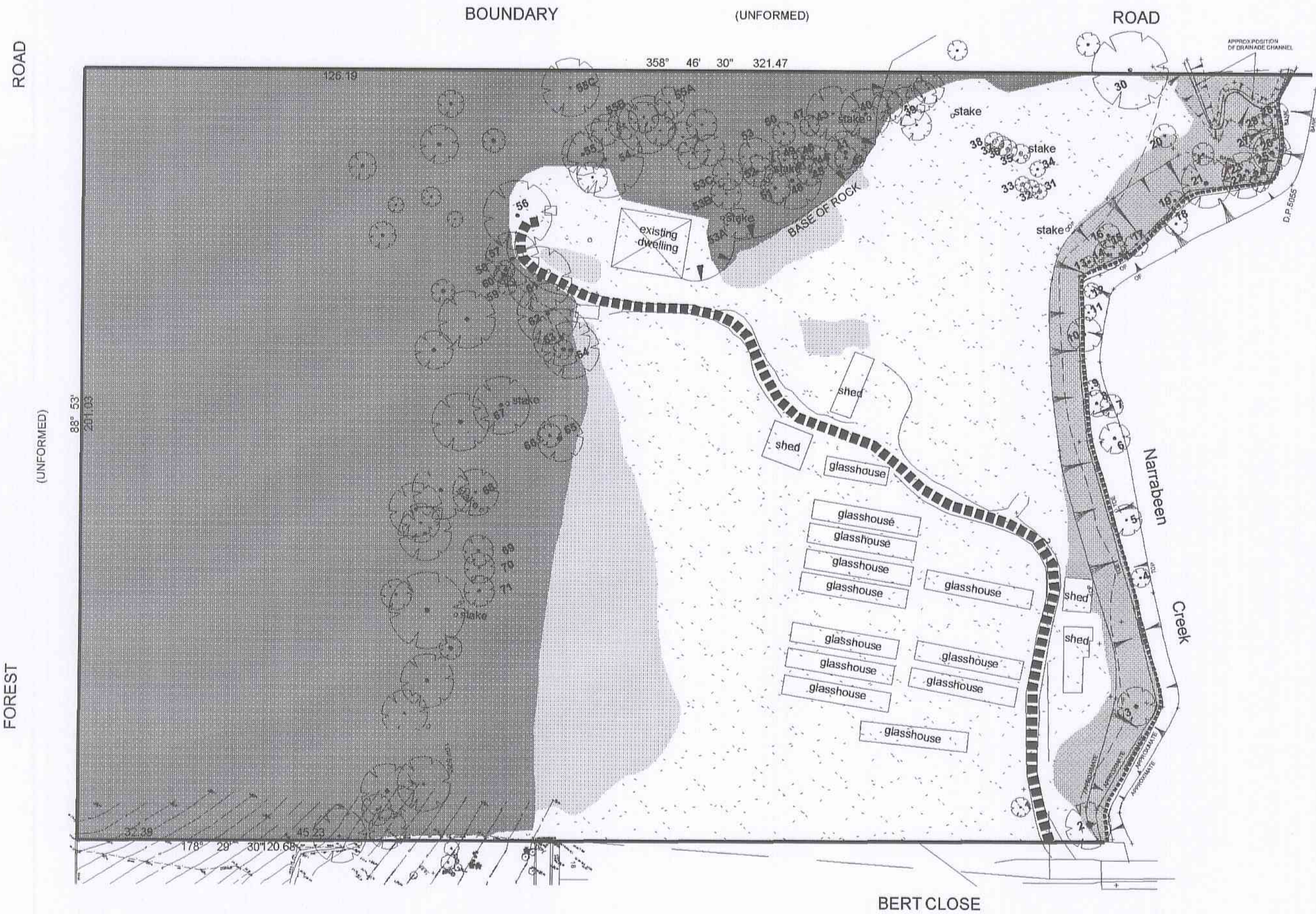

legend

- centre line of creek
- existing vehicle access track
- existing trees within the vicinity of proposed works