

Applicant and Project Details

Complete this page and the relevant Sections that apply to your proposed development.

Applicants' Details

Name: (must be the same as the DA form)	Campbell Architecture
Address: (must be the same as the DA form)	75 Renwick Street Alexandria NSW 2015
Phone Number:	02 7903 5266
Email Address:	info@campbellarchitecture.com.au

Property Details

Lot No: Deposited Plan (DP) No: or Strata Plan (SP) No:	LOT3 DP1194872 LOT4 DP1194872
Unit No: House No: Street: Suburb: Postcode:	6 & 7 Kara Crescent Bayview 2104

Project Details

Description of proposed development:	Alterations & additions to existing dwelling, new pool & associated landscaping
Structures to be demolished:	Existing metal roof & dormer windows, various external & internal brick walls

Applicant Declaration

I declare that:

1. This plan has been completed in accordance with the Waste Management Guidelines
2. To the best of my knowledge, the details on this form are accurate and correct

I understand that:

1. All records demonstrating lawful disposal of waste will be retained and kept readily accessible for inspection by regulatory authorities such as Council, NSW Environment Protection Authority or WorkCover NSW.
2. A bond in accordance with Council's fees and charges may apply to this development and must be paid to Council prior to any works commencing.
3. The bond will only be refunded when Council is satisfied that all waste outlined in this plan has been managed as per the plan, and evidence such as photos, receipts and statutory declarations must be supplied where appropriate.

Signature of Applicant: _____

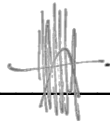

Date: 24/05/2023

Section 1 – Demolition

This section must be completed in accordance with ‘Chapter 1 – Demolition’ of the Waste Management Guidelines

MATERIALS ON SITE	DESTINATION <i>Evidence such as weighbridge dockets and invoices for waste disposal or recycling must be retained on site for inspection</i>					
	REUSE AND RECYCLING (MOST FAVOURABLE)				DISPOSAL (LEAST FAVOURABLE)	
Types of Waste Material	Estimated Volume (m ³) or Weight (t)	ONSITE RE-USE ✓ Specify how material will be reused on site	OFFSITE RECYCLING ✓ Recycling Outlet (RO) ✓ Waste Transport Contractor (WTC)		OFFSITE DISPOSAL ✓ Specify landfill site (LS) ✓ Specify Waste Transport Contractor (WTC)	
			WTC	RO	WTC	LS
Excavated Material	10t	re-use for filling or levelling				
Garden Organics						
Bricks					OPTION NOT AVAILABLE: These materials must be re-used or separated on or off site and sent for recycling.	
Tiles						
Concrete	1.0 t	re-use for filling or levelling				
Timber	4.0 t	re-use as formwork, recycle waste	by builder	Kimbriki		
Plasterboard	1.5 t		by builder	Kimbriki		
Metals	1.4 t		by builder	Kimbriki		
Asbestos						
Other waste (please specify)						
Estimated Total % Recovered						

Refer to the estimation tables in ‘Chapter 1 – Demolition’ of the Guidelines for assistance in completing this table.

The applicant must submit a Site Plan showing the structures to be demolished and storage areas for waste and construction materials (if the development also includes construction).

WMP Checklist

Have you included the following:	Applicant Tick
A site plan showing: <ul style="list-style-type: none"> • The structures to be demolished. • Storage areas for waste to be reused, recycled, or disposed of. • Materials storage (if the development also includes construction) 	<input checked="" type="checkbox"/>
The table on the previous page, completed in accordance with 'Chapter 1 – Demolition' in the guidelines.	<input checked="" type="checkbox"/>

Section 2 – Construction

This section must be completed in accordance with 'Chapter 2 – Construction' of the Waste Management Guidelines

MATERIALS ON SITE	DESTINATION <i>Evidence such as weighbridge dockets and invoices for waste disposal or recycling must be retained on site for inspection</i>					
	REUSE AND RECYCLING (MOST FAVOURABLE)				DISPOSAL (LEAST FAVOURABLE)	
Types of Waste Material	Estimated Volume (m ³) or Weight (t)	ONSITE RE-USE ✓ Specify how material will be reused on site	OFFSITE RECYCLING ✓ Specify recycling outlet (RO) ✓ Specify Waste Transport Contractor (WTC)		OFFSITE DISPOSAL ✓ Specify landfill site (LS) ✓ Specify Waste Transport Contractor (WTC)	
* Please specify			WTC	RO	WTC	LS
Excavated Material						
Garden Organics						
Bricks	5.0 t	reuse for filling, leveling			OPTION NOT AVAILABLE: These materials must be re-used or separated on or off site and sent for recycling.	
Tiles						
Concrete	2.0 t	reuse for filling, leveling	by builder	Kimbriki		
Timber*	1.5t treated & untreated	re-use as formwork. recycle waste	by builder	Kimbriki		
Plasterboard	1.0 t		by builder	Kimbriki		
Metals*	1.0 t		by builder	Kimbriki		
Asbestos						
Other waste*						
Estimated Total % Recovered						

Refer to the estimation tables in 'Chapter 2 – Construction' of the Guidelines for assistance in completing this table.

The applicant must submit a Site Plan showing the structures to be demolished and storage areas for waste and construction materials (if the development also includes construction).

WMP Checklist

Have you included the following:	Applicant Tick
A site plan showing: <ul style="list-style-type: none"> The structures to be demolished. Potential storage areas for waste to be reused, recycled, or disposed of. Materials storage 	<input checked="" type="checkbox"/>
The table on the previous page, completed in accordance with 'Chapter 2 – Construction' in the guidelines.	<input checked="" type="checkbox"/>

Section 3 – On-going waste management for one or two dwellings

This section is to be completed in accordance with 'Chapter 3 – On-going waste management for one or two dwellings' of the Waste Management Guidelines.

Type of development: residential dwelling

Number of dwellings: 1

WMP Checklist

Do your architectural and landscape plans include the following:	Applicant Tick
Waste Storage Area design requirements (Chapter 3.2.)	<input checked="" type="checkbox"/>
Waste Storage Area location requirements (Chapter 3.3.)	<input checked="" type="checkbox"/>

- proposed paved area
- proposed addition to building footprint
- existing building footprint kept
- existing driveway

STORAGE AREA FOR WASTE TO BE REUSED, RECYCLED OR DISPOSED OF & MATERIALS STORE DURING CONSTRUCTION

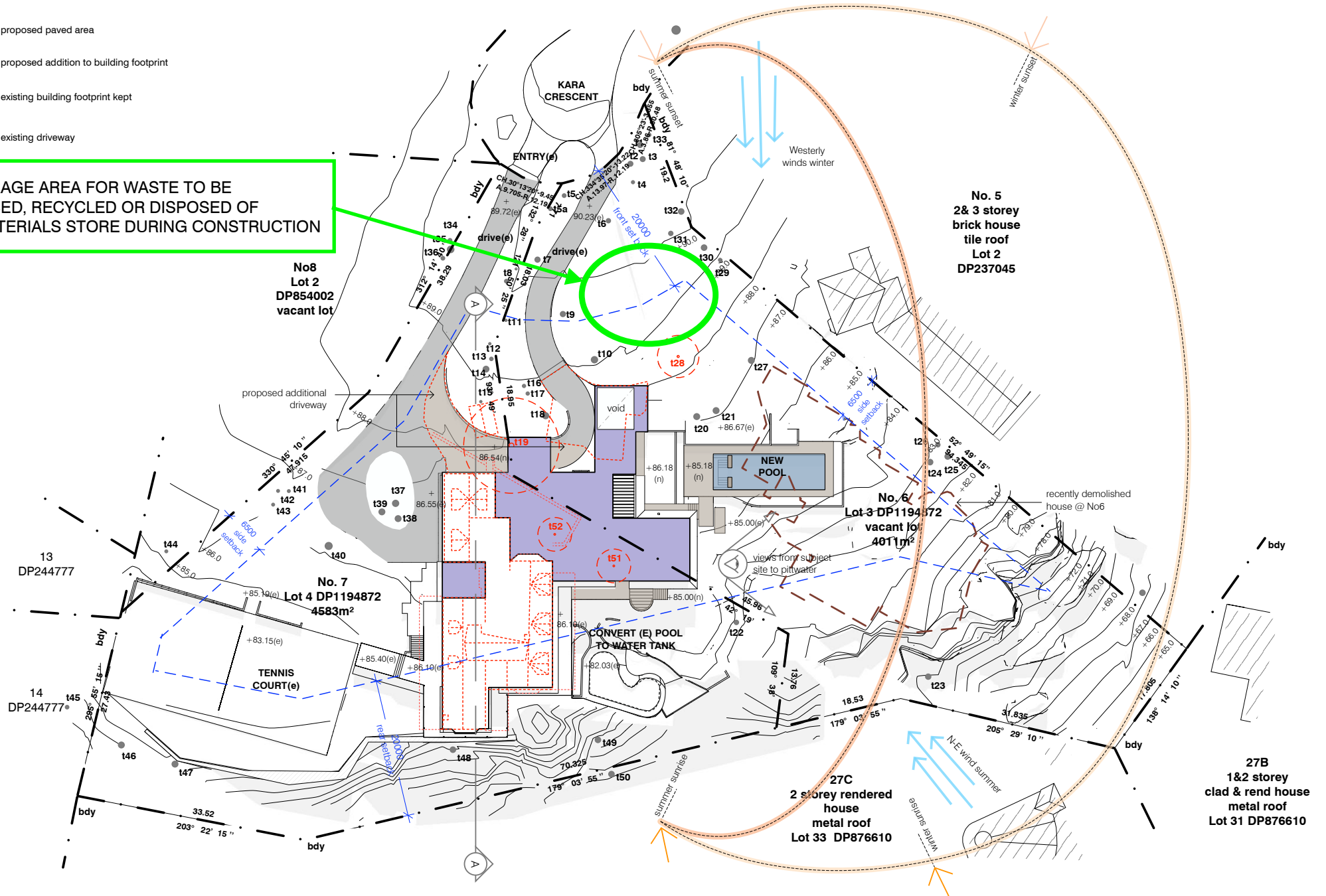

issue	date	description
A	12/05/2023	DA submission

The Contractor shall verify all dimensions & levels on the site.
Written dimensions to take preference over scaled dimensions.
Documents & design remain the copyright of the Architect & cannot be reproduced without written consent.

campbell architecture
75 Renwick Street Alexandria NSW 2015
t/ +61 02 7903 5266
e/ info@campbellarchitecture.com.au
ABN 48 616 525 449
NOM REG NO. 8324

site plan & site analysis
6 & 7 kara crescent
bayview

DA 01
1:500
last modified : 23.05.15
filename : 2111_20_230512_DA_pl
2111

issue A

campbell architecture

