

- AFW Aluminium Framed Window
- BA Frameless Glass Balustrade
- BS Steel Balustrade
- CW Concrete Wall
- DR Driveway
- FE Paling Fence
- FY Fire Hydrant
- LT Lift
- MW Masonry Wall
- SP Stone Paving
- ST Stair
- SW Stone Wall

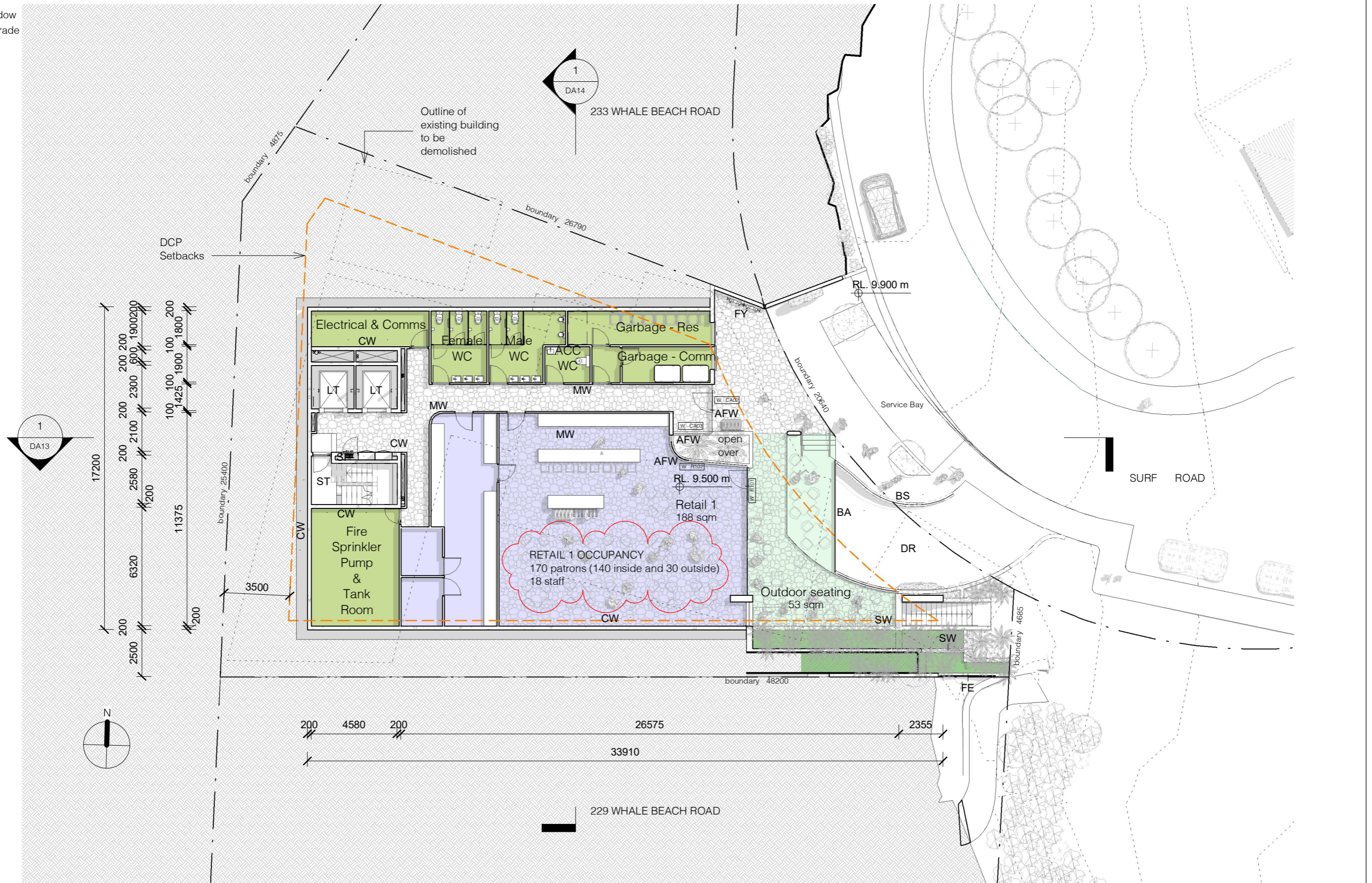

1 DA Ground Floor Plan
1 : 200

0 2.0m 4.0m 6.0m 8.0m 10.0m
1:200

139 PALMGROVE ROAD, AVALON BEACH NSW 2107
 t 02 9918 3843
 m 0418 627 024
 e mailto:richard@richardcolearchitecture.com.au
 w www.richardcolearchitecture.com.au

acn:093 598 415 abn:58 093 598 415
 nominated architect : Richard Cole B.Sc.(Arch) (Hons 1) B.Arch.(Hons1) Reg. No: 6538

No.	Revision Description	Date
Q	Revised Development Application	22/04/2021
R	Revised Development Application	27/05/2021
S	Revised Development Application for Review	7/06/20201
T	Revised DA for Review	27/07/2021
U	Section 8.2 Review	06/08/2021
V	Section 8.2 Review with modified driveway	29/10/2021
X	Section 4.55 Application	7/12/2021

WHALE BEACH NEIGHBOURHOOD CENTRE
 DEVELOPMENT APPLICATION
 231 Whale Beach Road, Whale Beach
 for
 Leslie Cassar

Ground Floor Plan			
Project number	1609	Checked by	RC
Date	AUGUST 2021	Scale	1 : 200
Drawn by	KW		DA04