

**GENERAL NOTES**

- G1 THESE DRAWINGS SHALL BE READ IN CONJUNCTION WITH ALL OTHER CONSULTANTS DRAWINGS AND SPECIFICATIONS.
- G2 ANY DISCREPANCIES SHALL BE REFERRED TO THE PROJECT MANAGER/ CONTRACT ADMINISTRATOR FOR DECISION BEFORE PROCEEDING WITH THE WORK.
- G3 DIMENSIONS SHALL NOT BE OBTAINED BY SCALING THE DRAWINGS.
- G4 ANY SETTING OUT DIMENSIONS SHOWN ON THE DRAWING SHALL BE VERIFIED BY THE BUILDER.
- G5 DURING CONSTRUCTION THE CONTRACTOR SHALL MAINTAIN STRUCTURES IN A STABLE CONDITION.
- G6 ALL WORK SHALL COMPLY WITH THE BUILDING CODE OF AUSTRALIA AND RELEVANT AUSTRALIAN STANDARD CODES.

- G7 THE DESIGN AND DETAILS SHOWN ON THESE DRAWINGS ARE APPLICABLE TO THIS PROJECT ONLY AND MAY NOT BE REPRODUCED IN WHOLE OR IN PART, OR BE USED FOR ANY OTHER PROJECT OR PURPOSE, WITHOUT THE WRITTEN PERMISSION OF WOOLACOTTS WITH WHOM COPYRIGHT RESIDES.
- G8 THE CONTRACTOR SHALL MAKE GOOD ADJACENT TO NEW WORKS, ENSURING A SMOOTH TRANSITION WITH EXISTING INFRASTRUCTURE.
- G9 LIMIT OF WORKS TO MATCH LANDSCAPE ARCHITECT'S DRAWINGS.
- G10 PROVIDE SILT PROTECTION AT STORMWATER PITS AS REQUIRED DURING CONSTRUCTION.

**DRAINAGE NOTES**

- D1 ALL WORKS SHALL BE IN ACCORDANCE WITH AS 3500.3
- D2 FOR PIPE DIAMETERS NOT EXCEEDING 225mm USE SEWER GRADE UPVC TO AS 1260
- D3 FOR PIPE DIAMETERS EXCEEDING 225mm, USE:
  - CLASS 2 REINFORCED CONCRETE PIPE TO AS 4058 OR
  - CLASS 2 FIBRE REINFORCED CONCRETE TO AS 4139
- D4 PVC PIPES SHALL BE SOLVENT WELDED. ALL OTHER PIPES SHALL BE RUBBER RING JOINTED UNLESS NOTED OTHERWISE.
- D5 UNLESS SPECIFIED OTHERWISE, BED & BACKFILL SHALL BE COMPACTED SAND TO 100mm AROUND THE PIPE AND 100mm THICK LAYER OF 5mm AGGREGATE AROUND THE PIPE IF UNDER CONCRETE. REMAINDER OF BACKFILL SHALL BE COMPACTED EXCAVATED MATERIAL. WHEN UNDER VEHICULAR PAVEMENT, REMAINDER OF BACKFILL SHALL BE COMPACTED BASECOURSE.
- D6 LOADS ON PIPES DURING CONSTRUCTION SHALL NOT EXCEED THE REQUIREMENT OF AS 3725, OR THE RECOMMENDATIONS OF THE PIPE MANUFACTURER.
- D7 TRENCH WIDTHS SHALL BE IN ACCORDANCE WITH AS 3500, BUT NOMINALLY THE GREATER OF 1.5 PIPE DIAMETER OR PIPE DIAMETER PLUS 300.
- D8 IN LOCATIONS WHERE NEW STORMWATER PIPES CONNECT TO EXISTING STORMWATER PITS, CONFIRM THE INVERT LEVEL OF ALL EXISTING STORMWATER PITS AT THE START OF THE WORKS.

**ON SITE DETENTION SUMMARY:**

- 1. STORMWATER MANAGEMENT DESIGN IN ACCORDANCE WITH NORTHERN BEACH COUNCIL - WATER MANAGEMENT FOR DEVELOPMENT POLICY (AUGUST 2020).
  - SECTION 9.0 - ON SITE STORMWATER MANAGEMENT
  - SITE LOCATED IN "REGION 1 - NORTHERN CATCHMENT".
  - OSD SYSTEM SIZED TO THE STORAGE & DISCHARGE REQUIREMENTS DETAILED IN TABLE 7.0.
  - SIZING BASED ON ADDITIONAL IMPERVIOUS AREA.
- 2. SITE INFORMATION:
  - ADDITIONAL IMPERVIOUS AREA = 173.50m<sup>2</sup>
  - OSD REQUIREMENTS:
    - DETENTION TANK STORAGE = 12m<sup>3</sup>
    - DISCHARGE RATE = 6 L/S

**LEGEND**

- OSD STORAGE UNDER TERRACE
- BOUNDARY LINE
- NEW GRATED PIT
- NEW COVER PIT
- NEW DOWN PIPE
- EXISTING SPOT LEVEL
- PROPOSED SPOT LEVEL
- NEW GRATED DRAIN
- NEW CLEAR OUT OPENING
- NEW RAINWATER OUTLET EQUAL TO SPS DRAINS TIA100F

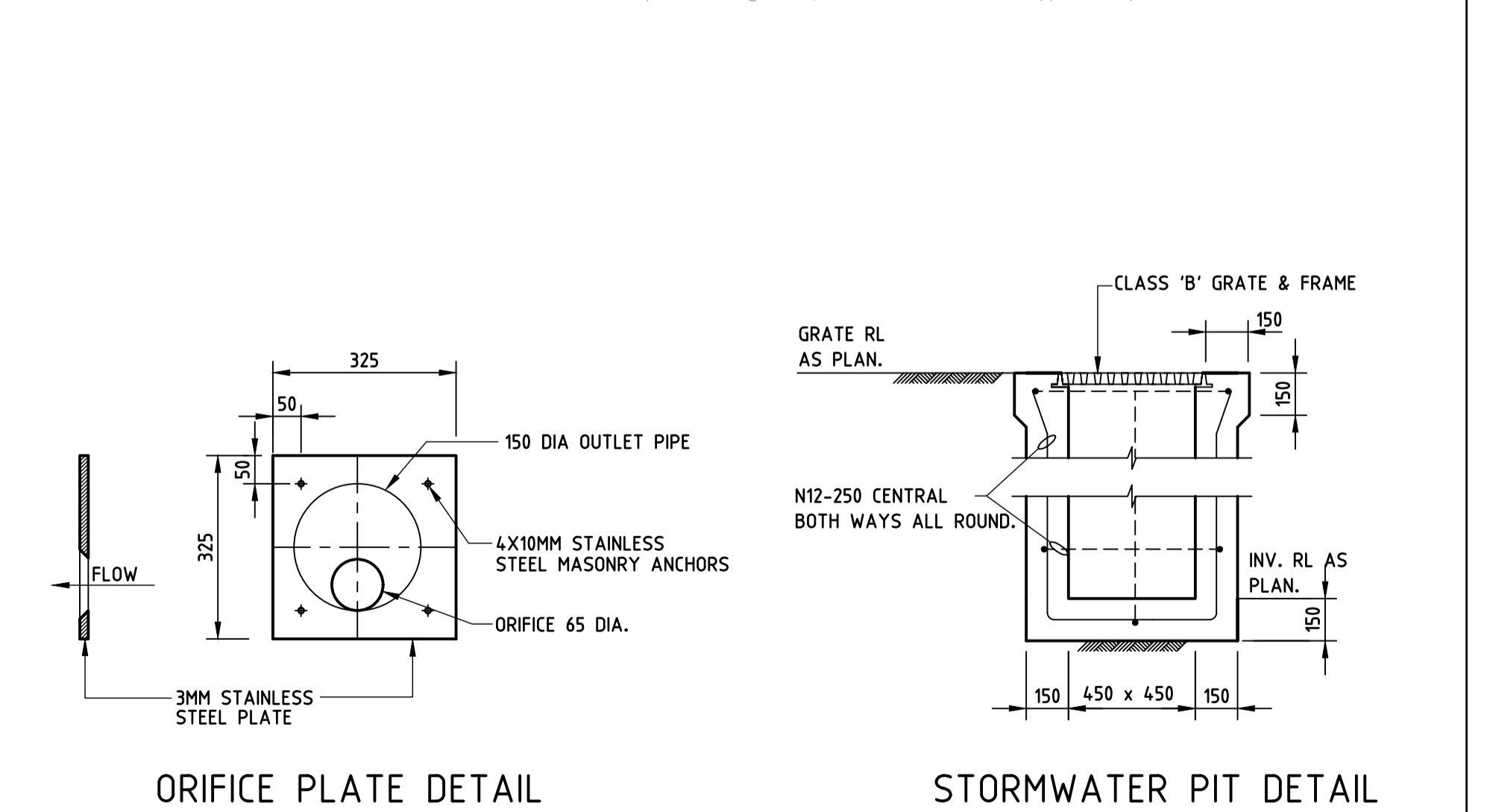
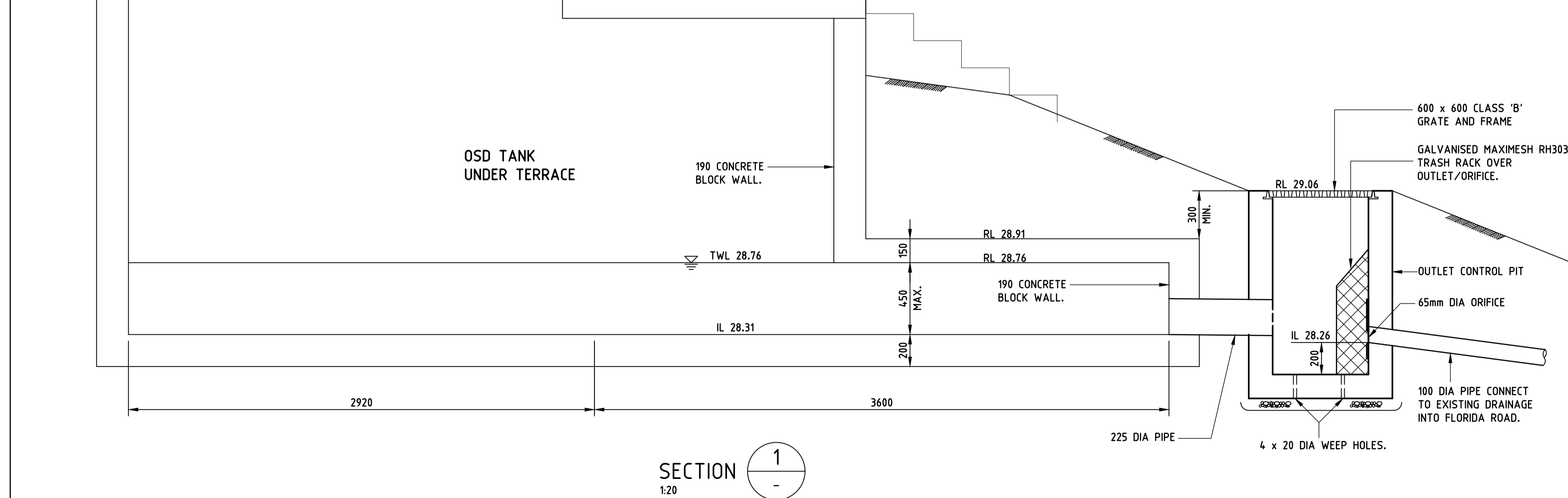
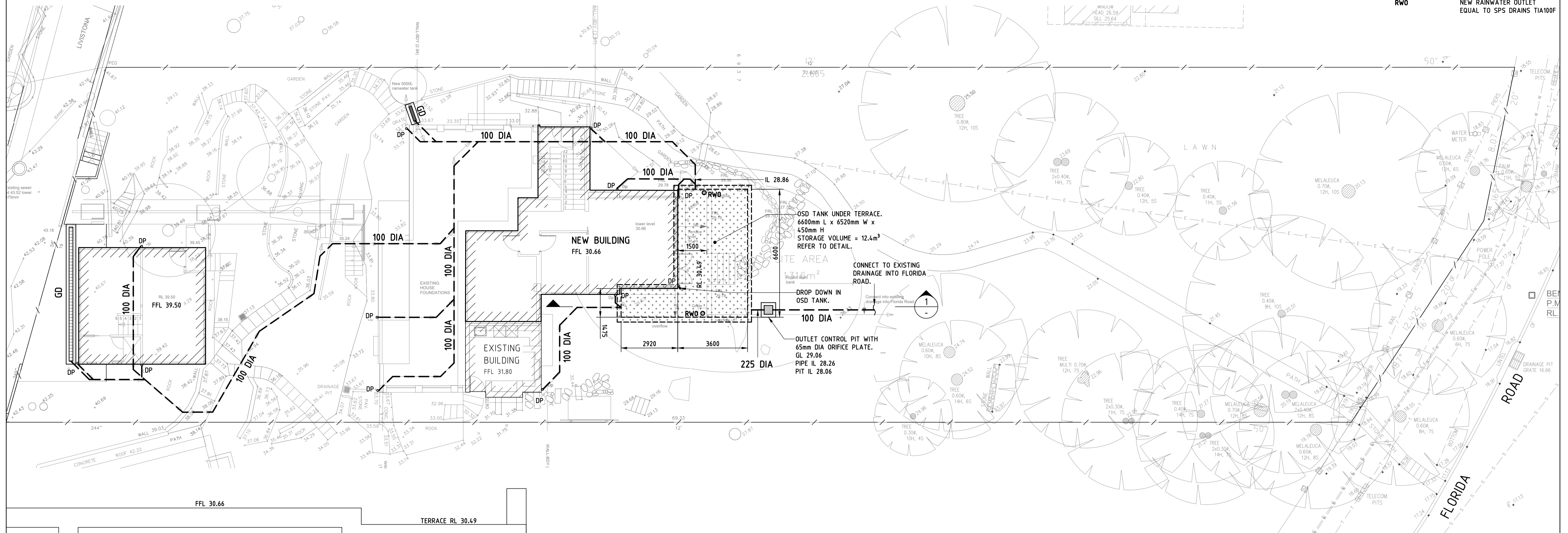

No.	Date	Description	Ver.	Appr.
A	26.11.20	APPROVED ISSUE	JG	SETB
B	20.01.21	REVISED ARCHITECT BASE	JG	SETB
C	26.11.21	REVISED ARCHITECT BASE. OSD TANK UPDATED.		

Architect  
**ROBERTJONES ARCHITECTS**  
 57 AVALON PARADE, AVALON BEACH  
 NSW, 2107

**Woolacotts**  
 CONSULTING ENGINEERS  
 T +61 2 8203 1500 | www.woolacotts.com.au  
 Ground Floor, 12a Brown Street, Chatswood, NSW 2067

**ALTERATION AND ADDITION TO EXISTING HOUSE**  
 91 FLORIDA ROAD, PALM BEACH

**STORMWATER MANAGMENT PLAN (LOWER LEVEL) & DETAILS**

Date	Approved	Verified	Prepared
NOVEMBER 2020	SETB	JG	SC
Scale @ A1	26.11.20	13.11.20	11.11.20
Job number	Drawing number	Amendment	
20-233	SW01	C	



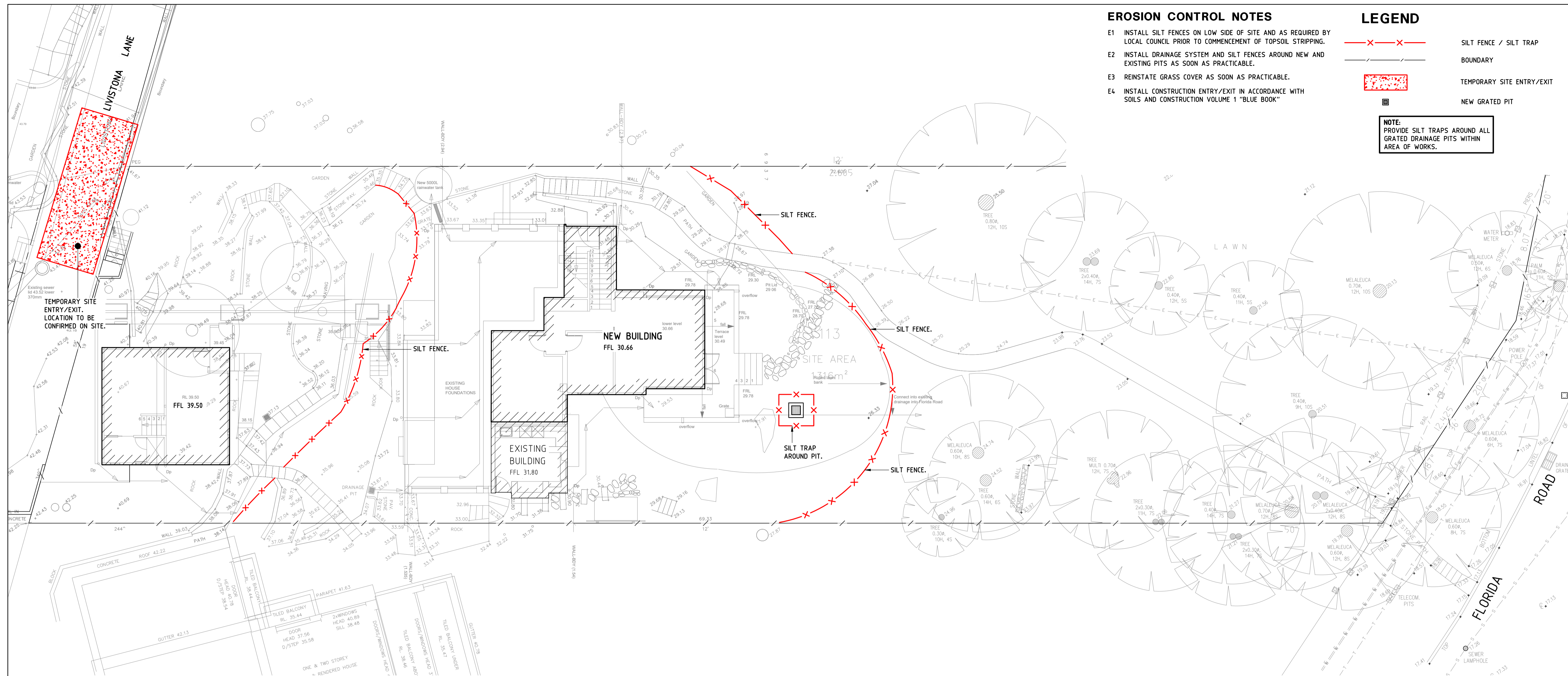

**EROSION CONTROL NOTES**

- E1 INSTALL SILT FENCES ON LOW SIDE OF SITE AND AS REQUIRED BY LOCAL COUNCIL PRIOR TO COMMENCEMENT OF TOPSOIL STRIPPING.
- E2 INSTALL DRAINAGE SYSTEM AND SILT FENCES AROUND NEW AND EXISTING PITS AS SOON AS PRACTICABLE.
- E3 REINSTATE GRASS COVER AS SOON AS PRACTICABLE.
- E4 INSTALL CONSTRUCTION ENTRY/EXIT IN ACCORDANCE WITH SOILS AND CONSTRUCTION VOLUME 1 "BLUE BOOK"

**LEGEND**

- SILT FENCE / SILT TRAP
- BOUNDARY
- TEMPORARY SITE ENTRY/EXIT
- NEW GRATED PIT

**NOTE:** PROVIDE SILT TRAPS AROUND ALL GRATED DRAINAGE PITS WITHIN AREA OF WORKS.

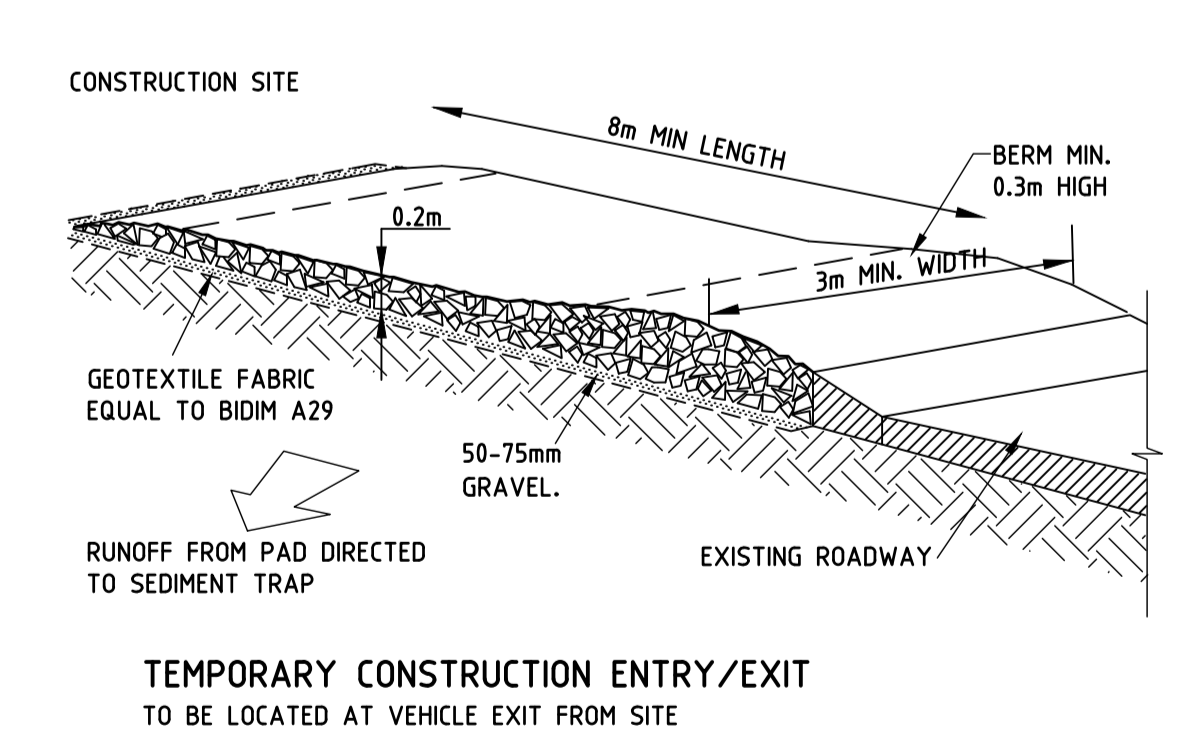
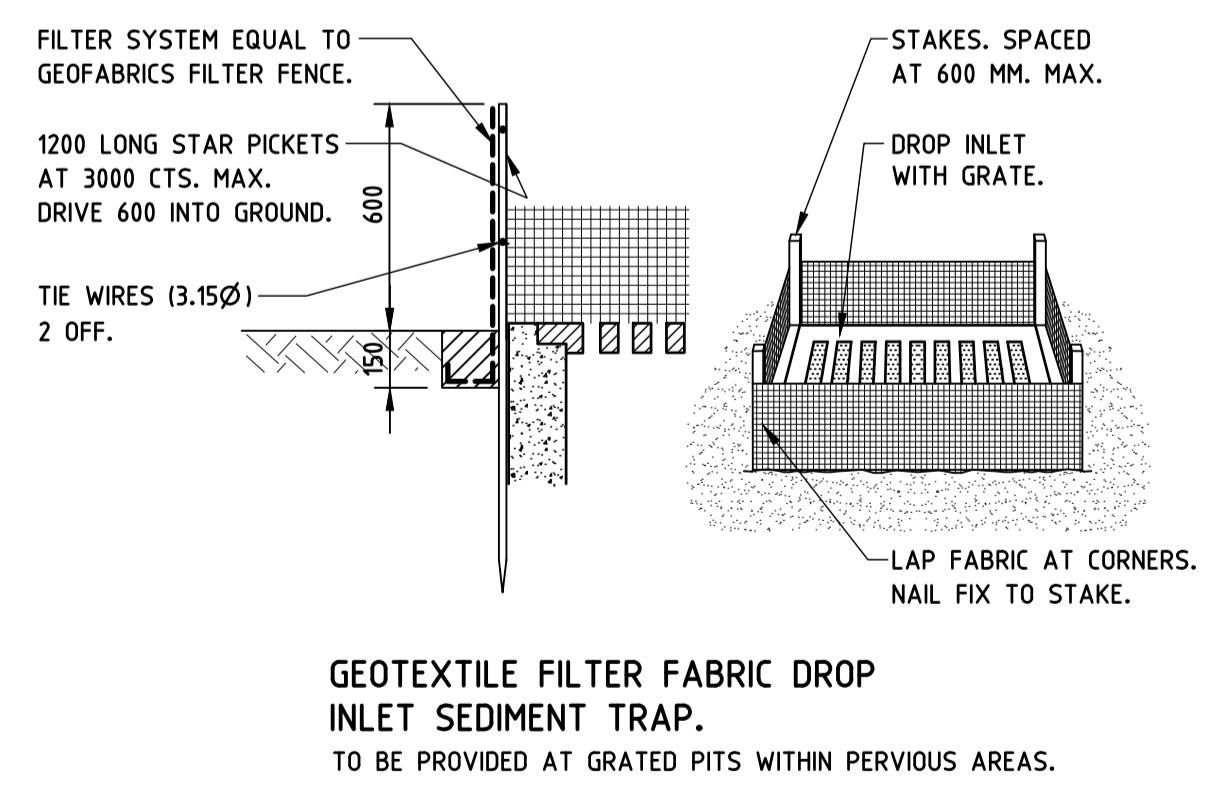
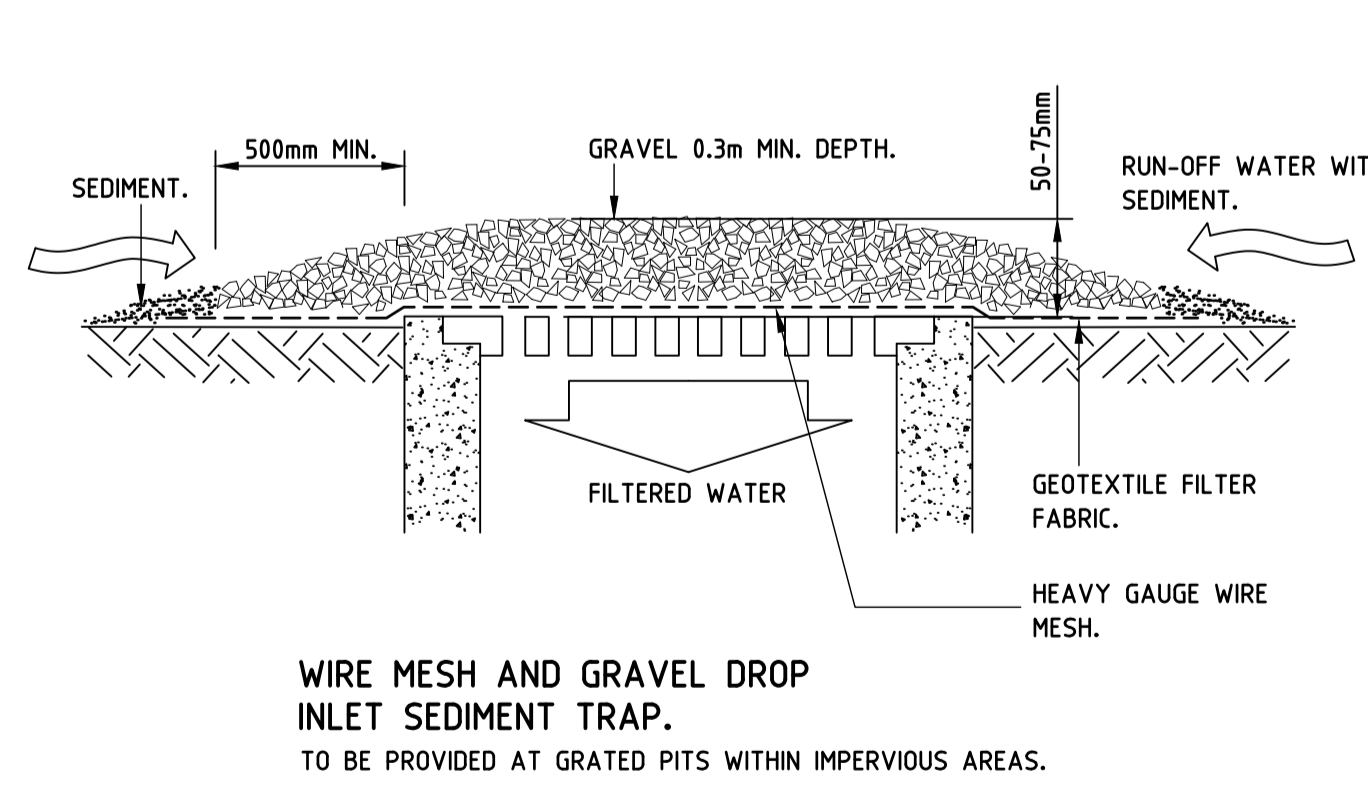
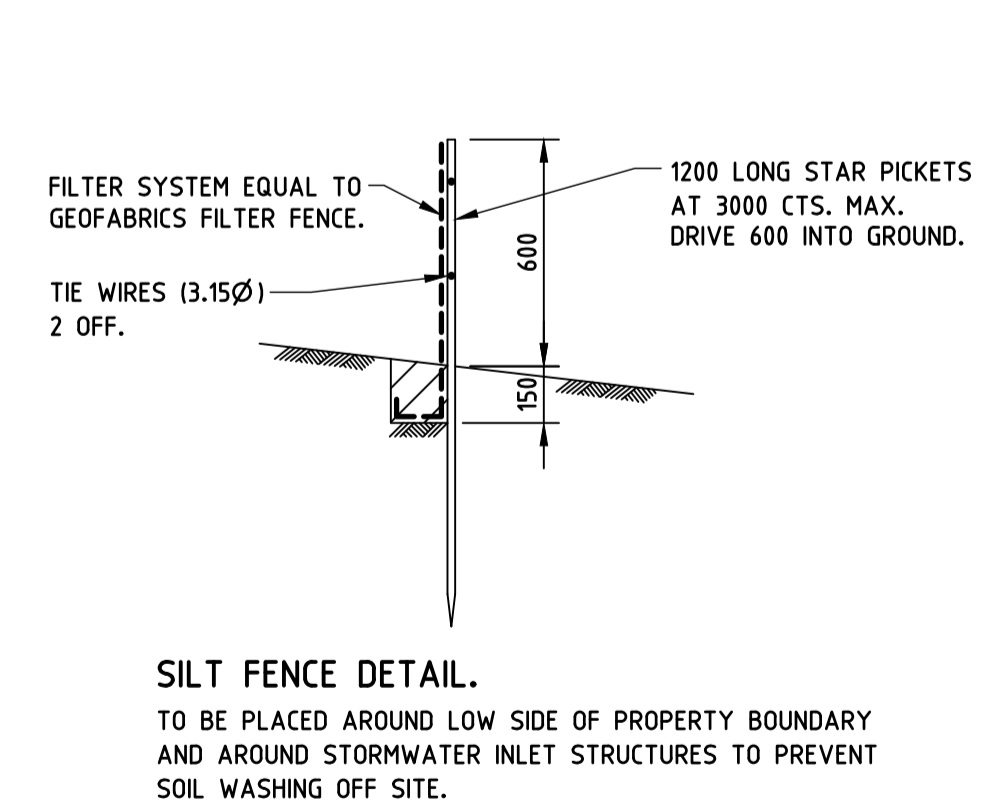

**EROSION AND SEDIMENT CONTROL DETAILS**

No.	Date	Description	Ver.	Appr.
A	26.11.20	APPROVED ISSUE	JG	SETB
B	20.01.21	REVISED ARCHITECT BASE	JG	SETB
C	26.11.21	REVISED ARCHITECT BASE. OSD TANK UPDATED.		

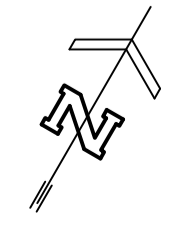

Architect  
**ROBERTJONES ARCHITECTS**  
57 AVALON PARADE, AVALON BEACH  
NSW, 2107



**ALTERATION AND ADDITION TO EXISTING HOUSE**  
91 FLORIDA ROAD, PALM BEACH

**EROSION AND SEDIMENT CONTROL PLAN & DETAILS**

Date	Approved	Verified	Prepared
NOVEMBER 2020	SETB	JG	SC
Scale @ A1	1:100, 1:20	26.11.20	13.11.20
Job number	Drawing number	Amendment	
20-233	SW02	C	