

LEGEND

- SHADOW OF EXISTING BUILDINGS + STRUCTURES.
- SHADOW OF PROPOSED ADDITION.

21ST JUNE - 9AM

SUN DIAGRAM HAS BEEN PREPARED BY COMPUTER PROGRAM AND HAS BEEN COMPLETED ACCORDING TO THE FOLLOWING INFORMATION:
SUN ANGLE AZIMUTH = 43°47'34"
 ALTITUDE = 16°51'41"
(NOTE: REDUCE THIS OVERSHADOWING BY 307.8mm PER 100mm OF RISE IN GROUND FROM BOUNDARY LINE.)
INFORMATION HAS BEEN SUPPLIED FROM THE BUREAU OF METEOROLOGY.

SHADOW DIAGRAM - 9AM
SCALE 1:200

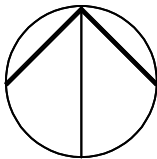

ALL DIMENSIONS TO BE VERIFIED ON SITE. DIMENSIONS TO BE TAKEN IN PREFERENCE TO SCALED DIMENSIONS. ANY DISCREPANCIES TO BE REFERRED TO ARCHITECT BEFORE PROCEEDING.	Project:	Drawing Title:	Consultant:	Issue	Amendment	Date	By	Job No:	Dwg No:	Rev:
	ALTERATIONS + ADDITIONS 95 WIMBLEDON AVE NARRABEEN NSW Client: BROOK WORTHINGTON	SHADOW DIAGRAM - 9AM	HOSKING MUNRO HOSKING MUNRO PTY. LTD. ARCHITECTS INTERIORS & LANDSCAPE DESIGNERS 3.09 / 55 MILLER STREET, PYRMONT 2009 ph 9660 1055 fax 9692 9290 email hm@hoskingmunro.com.au	A B	DA ISSUE DA ISSUE 2	12.11.19 13.01.20	JC JC	HM1478 DA900 'B'	Scale: 1:200 Date: JAN 2020	

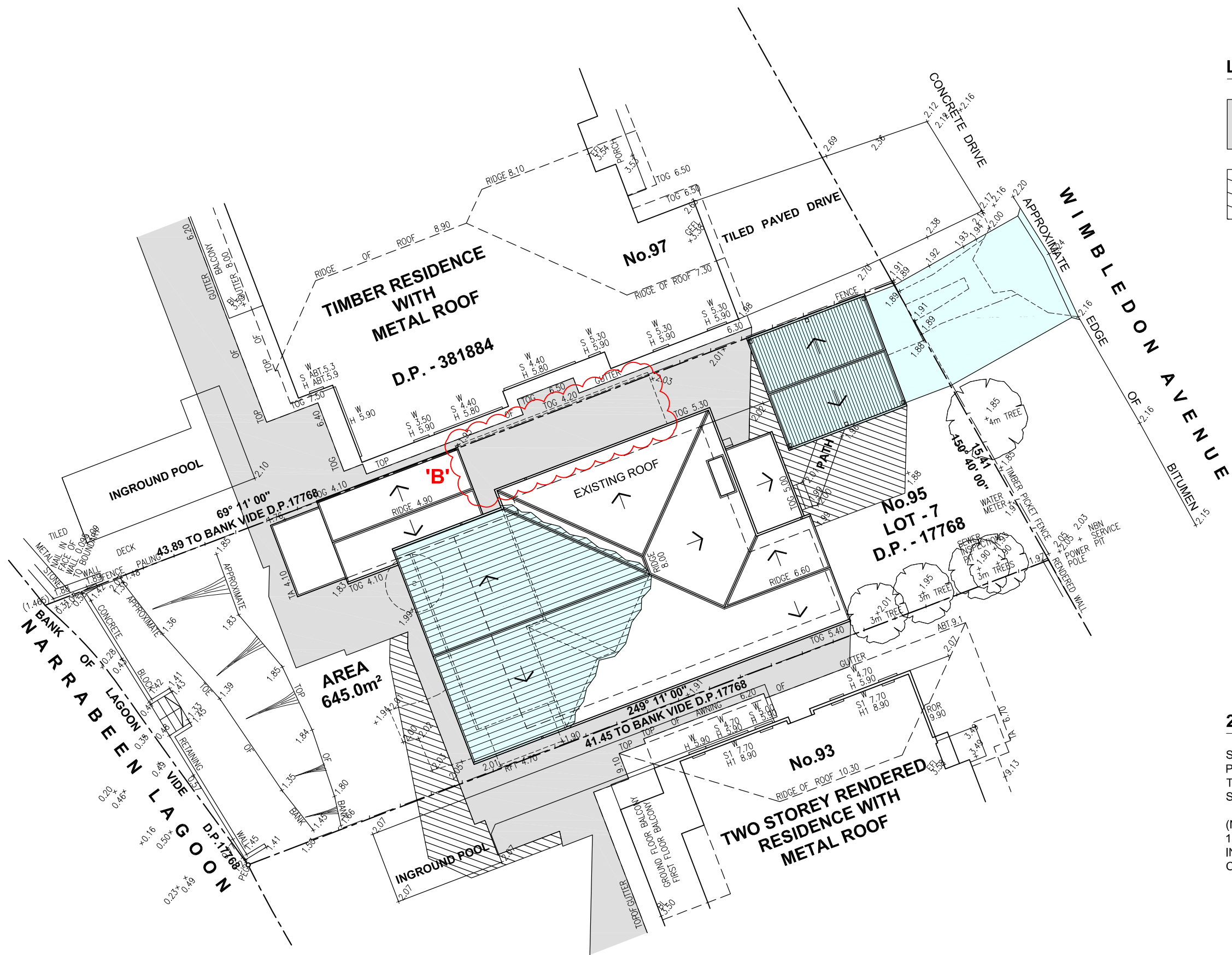

LEGEND



- SHADOW OF EXISTING BUILDINGS + STRUCTURES.

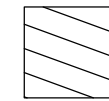

- SHADOW OF PROPOSED ADDITION.

21ST JUNE - 12PM MIDDAY

SUN DIAGRAM HAS BEEN PREPARED BY COMPUTER PROGRAM AND HAS BEEN COMPLETED ACCORDING TO THE FOLLOWING INFORMATION:

SUN ANGLE AZIMUTH = 1°19'22"
 ALTITUDE = 31°21'27"

(NOTE: REDUCE THIS OVERSHADOWING BY 307.8mm PER 100mm OF RISE IN GROUND FROM BOUNDARY LINE.)
INFORMATION HAS BEEN SUPPLIED FROM THE BUREAU OF METEOROLOGY.



SHADOW DIAGRAM - 12PM NOON

SCALE 1:200

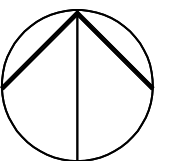

ALL DIMENSIONS TO BE VERIFIED ON SITE. DIMENSIONS TO BE TAKEN IN PREFERENCE TO SCALED DIMENSIONS. ANY DISCREPANCIES TO BE REFERRED TO ARCHITECT BEFORE PROCEEDING.	Project:	Drawing Title:	Consultant:	Issue	Amendment	Date	By	Job No:	Dwg No:	Rev:
	ALTERATIONS + ADDITIONS 95 WIMBLEDON AVE NARRABEEN NSW Client: BROOK WORTHINGTON	SHADOW DIAGRAM 12PM NOON	HOSKING MUNRO HOSKING MUNRO PTY. LTD. ARCHITECTS INTERIORS & LANDSCAPE DESIGNERS 3.09 / 55 MILLER STREET, PYRMONT 2009 ph 9660 1055 fax 9692 9290 email hm@hoskingmunro.com.au	A B	DA ISSUE DA ISSUE 2	12.11.19 13.01.20	JC JC	HM1478 DA901 'B' Scale: 1:200 Date: JAN 2020		

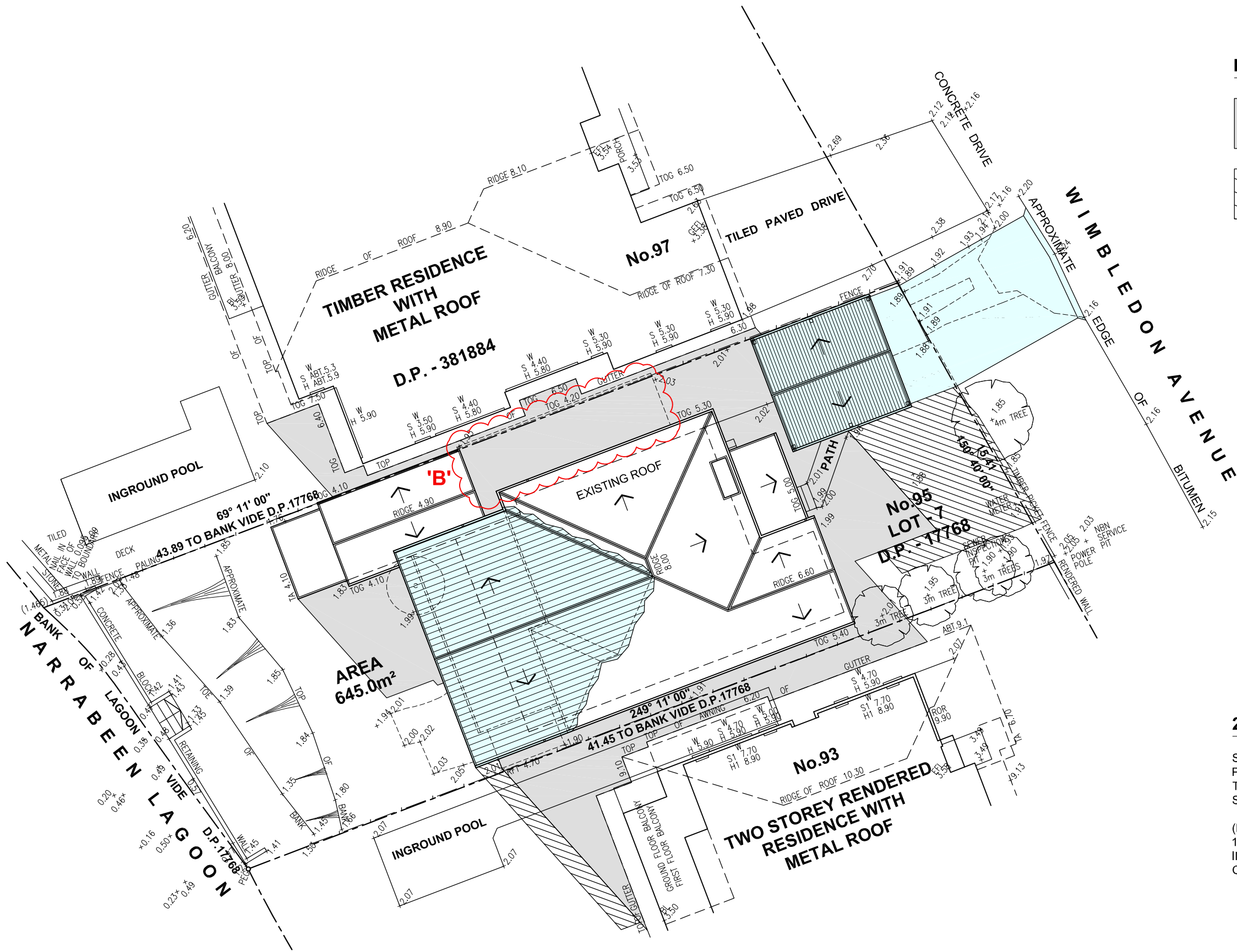

LEGEND

- SHADOW OF EXISTING BUILDINGS + STRUCTURES.
- SHADOW OF PROPOSED ADDITION.

21ST JUNE - 3PM

SUN DIAGRAM HAS BEEN PREPARED BY COMPUTER PROGRAM AND HAS BEEN COMPLETED ACCORDING TO THE FOLLOWING INFORMATION:

SUN ANGLE AZIMUTH = 318°05'35"
ALTITUDE = 18°13'29"

(NOTE: REDUCE THIS OVERSHADOWING BY 307.8mm PER 100mm OF RISE IN GROUND FROM BOUNDARY LINE.)
INFORMATION HAS BEEN SUPPLIED FROM THE BUREAU OF METEOROLOGY.

SHADOW DIAGRAM - 3PM
SCALE 1:200

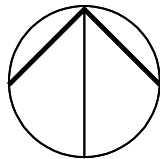

ALL DIMENSIONS TO BE VERIFIED ON SITE. DIMENSIONS TO BE TAKEN IN PREFERENCE TO SCALED DIMENSIONS. ANY DISCREPANCIES TO BE REFERRED TO ARCHITECT BEFORE PROCEEDING.	Project:	Drawing Title:	Consultant:	Issue	Amendment	Date	By	Job No:	Dwg No:	Rev:
	ALTERATIONS + ADDITIONS 95 WIMBLEDON AVE NARRABEEN NSW	SHADOW DIAGRAM - 3PM	HOSKING MUNRO HOSKING MUNRO PTY. LTD. ARCHITECTS INTERIORS & LANDSCAPE DESIGNERS 3.09 / 55 MILLER STREET, PYRMONT 2009 ph 9660 1055 fax 9692 9290 email hm@hoskingmunro.com.au	A B	DA ISSUE DA ISSUE 2	12.11.19 13.01.20	JC JC	HM1478	DA902	'B'
	Client: BROOK WORTHINGTON							Scale: 1:200	Date: JAN 2020	