

WYADRA AVE

1 JUNE 21 9AM  
1:500 @ A3

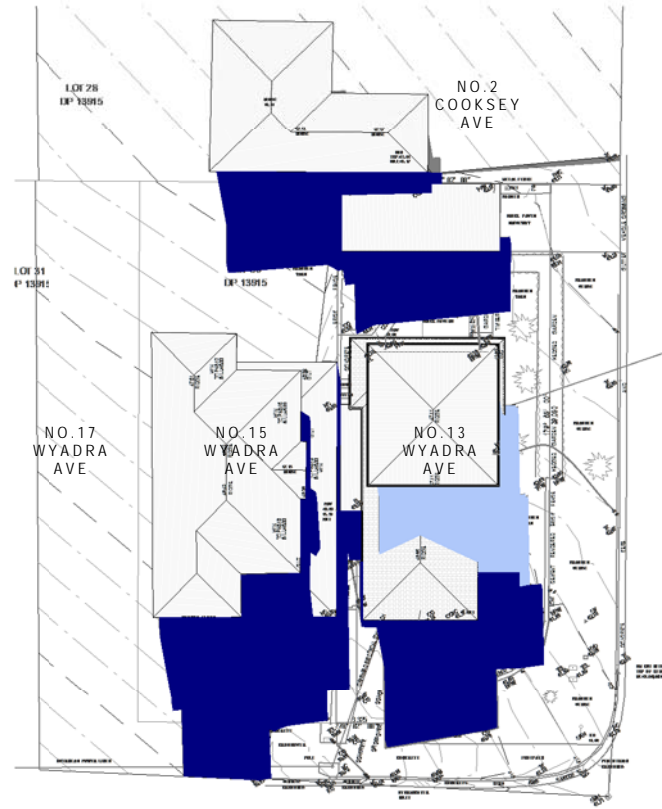

WYADRA AVE

2 JUNE 21 12PM  
1:500 @ A3

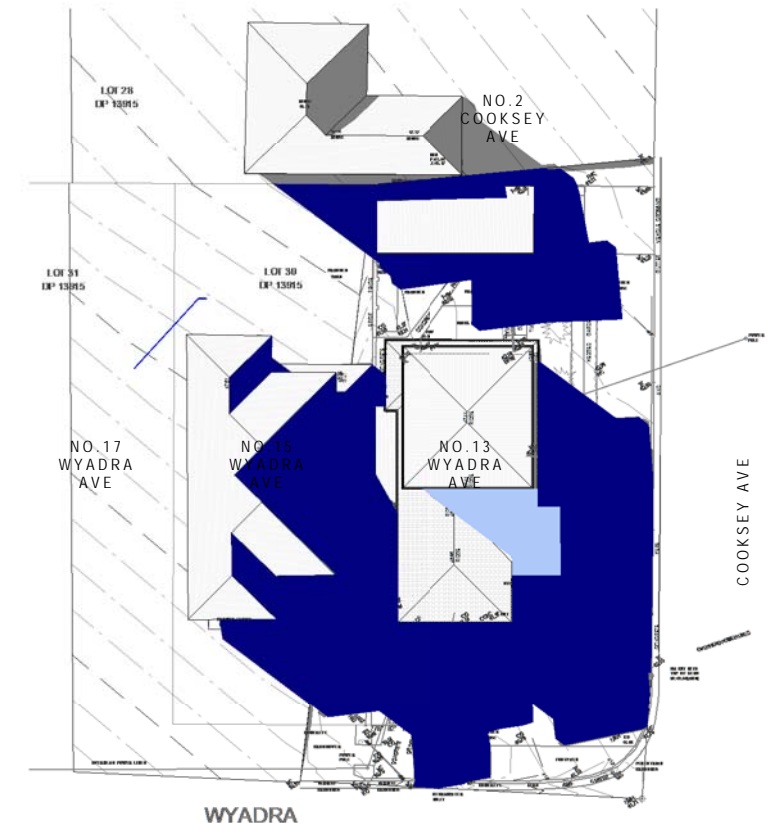

WYADRA AVE

3 JUNE 21 3PM  
1:500 @ A3

Notes

This drawing is copyright and is not to be replicated or used for any purpose without the written consent of Alex Bryden Architecture.

Use figured dimensions only - do not scale from this drawing. All dimensions to structure - confirm all dimensions on site.

This drawing is to be read in conjunction with all relevant consultant documentation, schedules and specifications.

BASIX

Hot water: Gas instantaneous.  
Lighting: Min. 40% fluro or LED lights  
Showerheads, toilets and taps to be min. 3-star water rating.  
R1.3 insulation external framed walls.  
R0.4 ins. (up) to ceiling & 100mm foil-backed ins. to roof.  
Roof to be medium colour.  
Alum. framed windows to be min. U-value 7.63, SHGC 0.75.

legend

SHADOWS CAST BY EXISTIN  
ADDITIONAL SHADOWS CAS



ALEX BRYDEN  
ARCHITECTURE

ALEXANDER BRYDEN, NSW ARB 9693, Curl Curl NSW  
M: 0409 954 675, E: studio@alexbyryden.com.au  
ABN: 76 631 848 345

PROJECT

ALTERATIONS & ADDITIONS  
13 WYADRA AVENUE NSW 2096

CLIENT

NETWORKED URBAN  
SOLUTIONS PTY LTD

DRAWING

SHADOW DIAGRAMS

project no. 19002  
scale As@ A3  
drawn indicated AB  
date 28.01.20

drawing no.

DA400  
/ A

A 28.01.20 FOR DEVELOPMENT APPLICATION  
issue date revision