

SITE PLAN & CONSTRUCTION
SCALE 1 : 200

SITE PLAN & DEMOLITION SCALE 1:200

- SCHEDULE OF AMENDMENTS TO APPROVED APPLICATION AUG 2015 S96 NO282/14/595/1
1. RELOCATION OF THE SPA TO THE WEST SIDE OF THE POOL FROM THE NORTH SIDE.
 2. RELOCATION OF ACCESS TO THE LOWER SITE LEVELS TO THE NORTH SIDE OF THE POOL FROM THE SOUTH SIDE AND ASSOCIATED LANDSCAPE WORKS.
 3. REDUCTION OF GLASS EDGES TO THE POOL: NOW EAST SIDE ONLY.

PLAN SCALE 1:100
MODIFICATIONS SECTION 96
JULY 2016

AREA CALCULATIONS
MODIFICATIONS SECTION 96, JULY 2016

TOTAL AREA	1090 M2	100 %
EXISTING HARD & BUILT UPON	328 M2	30.94 %
EXISTING SOFT LANDSCAPE	732 M2	69.06 %
PROPOSED HARD & BUILT UPON	374 M2	35.28 %
PROPOSED SOFT LANDSCAPE	686 M2	64.72 %

LEGEND:

- BENCHMARK R. L. 43.08
- EXISTING SPOT LEVEL / PROPOSED SPOT LEVEL
- PROPOSED SPOT LEVEL TOP OF GLASS & TOP OF BALUSTRADE
- EXISTING TREE TO BE RETAINED
- LINE OF ROOF OVER
- LINE OF WALL UNDER
- EXISTING WALLING TO BE RETAINED (TW+TOP OF WALL)
- PROPOSED MASONRY WALLING (TW+TOP OF WALL)
- SPLATTER RENDERED + PAINT 200 BLOCK WALL (TGW+ TOP OF WALL)
- PROPOSED RANDOM SANDSTONE PAVED AREA
- TIMBER DECKING ON STEEL SUPPORT FRAME
- GARDEN AREA
- MULCHED PATHWAY
- POOL FENCING
- PROPOSED SAFETY BALUSTRADE (NOM. 1000MM HIGH)
- WATER
- REMOVED PARTS OF DA
- EXTENT OF PROPOSED WORKS (FOREGROUND)
- EXTENT OF PROPOSED WORKS (BACKGROUND)
- NEW ACCESS PATHWAY TO PALM BEACH
- GREYSCALE = NO CHANGES FROM APPROVED APPLICATION AUG 2015 S96 NO282/14/595/1

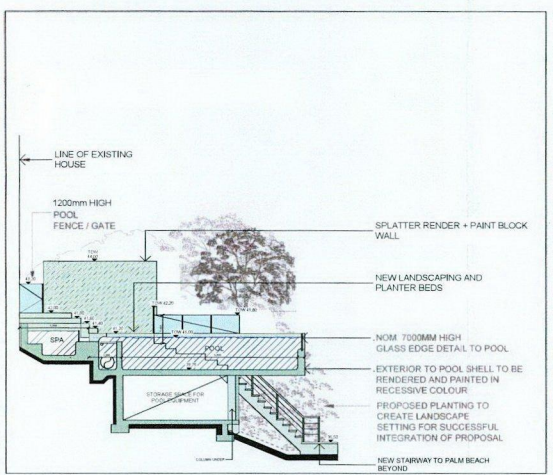

SECTION A-A SCALE 1 : 100
(DIAGRAMATIC ONLY)

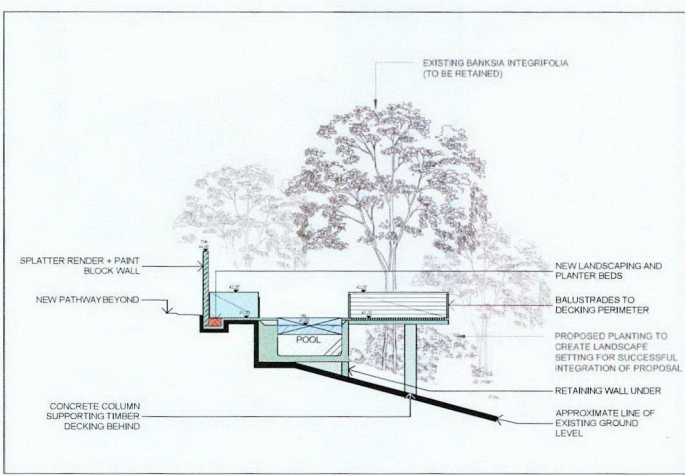

SECTION B-B SCALE 1 : 100
(DIAGRAMATIC ONLY)

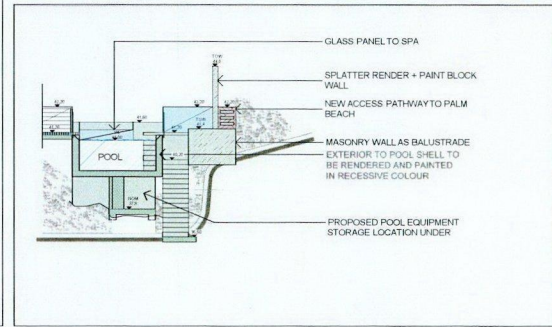

SECTION C-C SCALE 1 : 100
(DIAGRAMATIC ONLY)

REV	DESCRIPTION OF CHANGE	DRAWN	CHECKED	DATE	REV	DESCRIPTION OF CHANGE	DRAWN	CHECKED	DATE
A	CONSTRUCTION DOCUMENTATION SET	JK	JP	06/07/16					
B	15% REVISIONS AND COMMENTS	JK	JP	06/07/16					
C	30% REVISIONS AND COMMENTS	JK	JP	06/07/16					

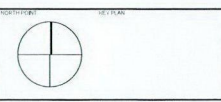

CLIENT
MR JOHN AND MRS JENNIFER DAUBNEY

PROJECT
HDR RICE DAUBNEY

ADDRESS
Lot 1, 260 Sunrise Road, North Sydney NSW 2060, Australia
11/2, 260A, 260B, 260C, 260D, 260E, 260F, 260G, 260H, 260I, 260J, 260K, 260L, 260M, 260N, 260O, 260P, 260Q, 260R, 260S, 260T, 260U, 260V, 260W, 260X, 260Y, 260Z, 260AA, 260AB, 260AC, 260AD, 260AE, 260AF, 260AG, 260AH, 260AI, 260AJ, 260AK, 260AL, 260AM, 260AN, 260AO, 260AP, 260AQ, 260AR, 260AS, 260AT, 260AU, 260AV, 260AW, 260AX, 260AY, 260AZ, 260BA, 260BB, 260BC, 260BD, 260BE, 260BF, 260BG, 260BH, 260BI, 260BJ, 260BK, 260BL, 260BM, 260BN, 260BO, 260BP, 260BQ, 260BR, 260BS, 260BT, 260BU, 260BV, 260BW, 260BX, 260BY, 260BZ, 260CA, 260CB, 260CC, 260CD, 260CE, 260CF, 260CG, 260CH, 260CI, 260CJ, 260CK, 260CL, 260CM, 260CN, 260CO, 260CP, 260CQ, 260CR, 260CS, 260CT, 260CU, 260CV, 260CW, 260CX, 260CY, 260CZ, 260DA, 260DB, 260DC, 260DD, 260DE, 260DF, 260DG, 260DH, 260DI, 260DJ, 260DK, 260DL, 260DM, 260DN, 260DO, 260DP, 260DQ, 260DR, 260DS, 260DT, 260DU, 260DV, 260DW, 260DX, 260DY, 260DZ, 260EA, 260EB, 260EC, 260ED, 260EE, 260EF, 260EG, 260EH, 260EI, 260EJ, 260EK, 260EL, 260EM, 260EN, 260EO, 260EP, 260EQ, 260ER, 260ES, 260ET, 260EU, 260EV, 260EW, 260EX, 260EY, 260EZ, 260FA, 260FB, 260FC, 260FD, 260FE, 260FF, 260FG, 260FH, 260FI, 260FJ, 260FK, 260FL, 260FM, 260FN, 260FO, 260FP, 260FQ, 260FR, 260FS, 260FT, 260FU, 260FV, 260FW, 260FX, 260FY, 260FZ, 260GA, 260GB, 260GC, 260GD, 260GE, 260GF, 260GG, 260GH, 260GI, 260GJ, 260GK, 260GL, 260GM, 260GN, 260GO, 260GP, 260GQ, 260GR, 260GS, 260GT, 260GU, 260GV, 260GW, 260GX, 260GY, 260GZ, 260HA, 260HB, 260HC, 260HD, 260HE, 260HF, 260HG, 260HH, 260HI, 260HJ, 260HK, 260HL, 260HM, 260HN, 260HO, 260HP, 260HQ, 260HR, 260HS, 260HT, 260HU, 260HV, 260HW, 260HX, 260HY, 260HZ, 260IA, 260IB, 260IC, 260ID, 260IE, 260IF, 260IG, 260IH, 260II, 260IJ, 260IK, 260IL, 260IM, 260IN, 260IO, 260IP, 260IQ, 260IR, 260IS, 260IT, 260IU, 260IV, 260IW, 260IX, 260IY, 260IZ, 260JA, 260JB, 260JC, 260JD, 260JE, 260JF, 260JG, 260JH, 260JI, 260JJ, 260JK, 260JL, 260JM, 260JN, 260JO, 260JP, 260JQ, 260JR, 260JS, 260JT, 260JU, 260JV, 260JW, 260JX, 260JY, 260JZ, 260KA, 260KB, 260KC, 260KD, 260KE, 260KF, 260KG, 260KH, 260KI, 260KJ, 260KK, 260KL, 260KM, 260KN, 260KO, 260KP, 260KQ, 260KR, 260KS, 260KT, 260KU, 260KV, 260KW, 260KX, 260KY, 260KZ, 260LA, 260LB, 260LC, 260LD, 260LE, 260LF, 260LG, 260LH, 260LI, 260LJ, 260LK, 260LL, 260LM, 260LN, 260LO, 260LP, 260LQ, 260LR, 260LS, 260LT, 260LU, 260LV, 260LW, 260LX, 260LY, 260LZ, 260MA, 260MB, 260MC, 260MD, 260ME, 260MF, 260MG, 260MH, 260MI, 260MJ, 260MK, 260ML, 260MM, 260MN, 260MO, 260MP, 260MQ, 260MR, 260MS, 260MT, 260MU, 260MV, 260MW, 260MX, 260MY, 260MZ, 260NA, 260NB, 260NC, 260ND, 260NE, 260NF, 260NG, 260NH, 260NI, 260NJ, 260NK, 260NL, 260NM, 260NN, 260NO, 260NP, 260NQ, 260NR, 260NS, 260NT, 260NU, 260NV, 260NW, 260NX, 260NY, 260NZ, 260OA, 260OB, 260OC, 260OD, 260OE, 260OF, 260OG, 260OH, 260OI, 260OJ, 260OK, 260OL, 260OM, 260ON, 260OO, 260OP, 260OQ, 260OR, 260OS, 260OT, 260OU, 260OV, 260OW, 260OX, 260OY, 260OZ, 260PA, 260PB, 260PC, 260PD, 260PE, 260PF, 260PG, 260PH, 260PI, 260PJ, 260PK, 260PL, 260PM, 260PN, 260PO, 260PP, 260PQ, 260PR, 260PS, 260PT, 260PU, 260PV, 260PW, 260PX, 260PY, 260PZ, 260QA, 260QB, 260QC, 260QD, 260QE, 260QF, 260QG, 260QH, 260QI, 260QJ, 260QK, 260QL, 260QM, 260QN, 260QO, 260QP, 260QQ, 260QR, 260QS, 260QT, 260QU, 260QV, 260QW, 260QX, 260QY, 260QZ, 260RA, 260RB, 260RC, 260RD, 260RE, 260RF, 260RG, 260RH, 260RI, 260RJ, 260RK, 260RL, 260RM, 260RN, 260RO, 260RP, 260RQ, 260RR, 260RS, 260RT, 260RU, 260RV, 260RW, 260RX, 260RY, 260RZ, 260SA, 260SB, 260SC, 260SD, 260SE, 260SF, 260SG, 260SH, 260SI, 260SJ, 260SK, 260SL, 260SM, 260SN, 260SO, 260SP, 260SQ, 260SR, 260SS, 260ST, 260SU, 260SV, 260SW, 260SX, 260SY, 260SZ, 260TA, 260TB, 260TC, 260TD, 260TE, 260TF, 260TG, 260TH, 260TI, 260TJ, 260TK, 260TL, 260TM, 260TN, 260TO, 260TP, 260TQ, 260TR, 260TS, 260TT, 260TU, 260TV, 260TW, 260TX, 260TY, 260TZ, 260UA, 260UB, 260UC, 260UD, 260UE, 260UF, 260UG, 260UH, 260UI, 260UJ, 260UK, 260UL, 260UM, 260UN, 260UO, 260UP, 260UQ, 260UR, 260US, 260UT, 260UU, 260UV, 260UW, 260UX, 260UY, 260UZ, 260VA, 260VB, 260VC, 260VD, 260VE, 260VF, 260VG, 260VH, 260VI, 260VJ, 260VK, 260VL, 260VM, 260VN, 260VO, 260VP, 260VQ, 260VR, 260VS, 260VT, 260VU, 260VV, 260VW, 260VX, 260VY, 260VZ, 260WA, 260WB, 260WC, 260WD, 260WE, 260WF, 260WG, 260WH, 260WI, 260WJ, 260WK, 260WL, 260WM, 260WN, 260WO, 260WP, 260WQ, 260WR, 260WS, 260WT, 260WU, 260WV, 260WW, 260WX, 260WY, 260WZ, 260XA, 260XB, 260XC, 260XD, 260XE, 260XF, 260XG, 260XH, 260XI, 260XJ, 260XK, 260XL, 260XM, 260XN, 260XO, 260XP, 260XQ, 260XR, 260XS, 260XT, 260XU, 260XV, 260XW, 260XX, 260XY, 260XZ, 260YA, 260YB, 260YC, 260YD, 260YE, 260YF, 260YG, 260YH, 260YI, 260YJ, 260YK, 260YL, 260YM, 260YN, 260YO, 260YP, 260YQ, 260YR, 260YS, 260YT, 260YU, 260YV, 260YW, 260YX, 260YY, 260YZ, 260ZA, 260ZB, 260ZC, 260ZD, 260ZE, 260ZF, 260ZG, 260ZH, 260ZI, 260ZJ, 260ZK, 260ZL, 260ZM, 260ZN, 260ZO, 260ZP, 260ZQ, 260ZR, 260ZS, 260ZT, 260ZU, 260ZV, 260ZW, 260ZX, 260ZY, 260ZZ

PROJECT
POOL AND SPA CONSTRUCTION DOCUMENTATION

ADDRESS
20 SUNRISE ROAD
PALM BEACH, NSW, 2108

PROJECT TITLE
MASTERPLAN

DATE	ISSUED	CHECKED
AS SHOWN	JK	JP
PROJECT MANAGER	CREATING MANAGER	ISSUE
N/A	S-96 05	C