

316 Hudson Parade, Clareville

Natural Ground Surface to Establish Height Limit.

We have reviewed the assumed natural ground line shown by a dashed line on the plan by Baster and Jacobson, drawing number DA 30.05, issue 3, and dated 3/3/21. In our opinion the interpreted natural ground line shown on the plans is a very close approximation of where the natural ground surface was and is suitable as a base to measure the "8.5 meter building height limit" from.

White Geotechnical Group Pty Ltd.



Ben White M.Sc. Geol.,
AusIMM., CP GEOL.
No. 222757
Engineering Geologist.

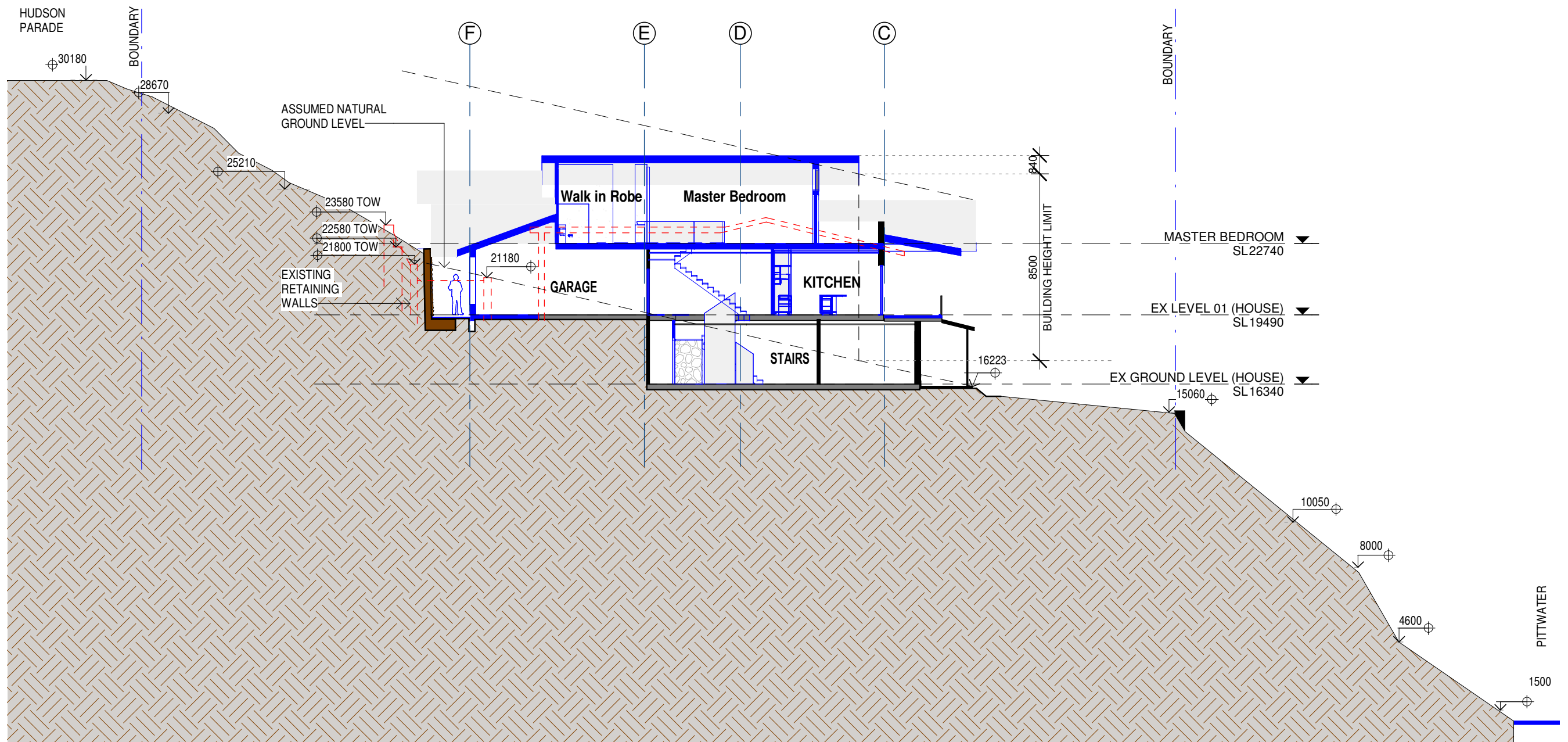

Long Site section

1 : 200 @ A3

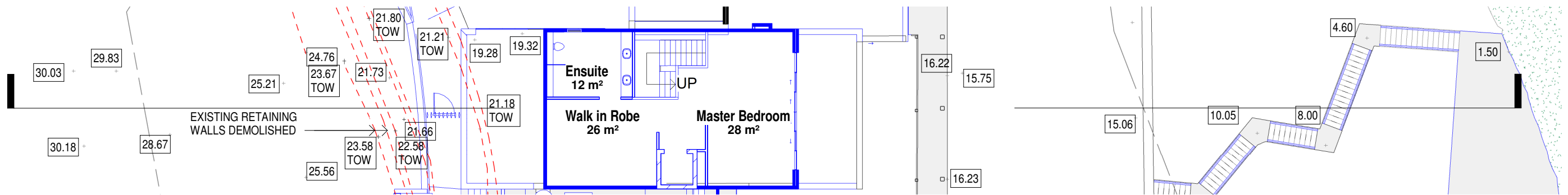

Long Site Section Survey Points

1 : 200 @ A3

General Notes:

- *Any discrepancies to be brought to Architects attention
- *Use figure dimensions in preference to scaling
- *Only scale under direction from architect
- *Builder to examine site and verify conditions and dimensions
- *This drawing remains the property of the Architect
- *Client is granted conditional license to use the drawings
- *Transfer of the License is prohibited
- *Architect reserves the right to terminate the license
- *Electronic data transfer should be scanned for viruses before use
- *Any loss or damage (including consequential damage) caused to the recipient of electronic data, by its direct or indirect use, is not the liability of the Architect
- *Refer to hard copies for accuracy of electronic data
- *Copyright reserved by the Architect

3
2
1
Issue

3/03/21
2/03/21
26/02/21
Date

DA ADDITIONAL INFORMATION
AMENDMENTS
AMENDMENTS
Amendment



BAXTER &
JACOBSON
ARCHITECTS

SYDNEY MANLY, NSW AUSTRALIA
BYRON BAY NSW AUSTRALIA
Nominated Architects
D Jacobson #4259 & M Baxter #4831

PHONE +612 9977 7648
EMAIL mark@bja.net.au
WEB www.bja.net.au

Project 316 Hudson Parade
Client TONY WALLS
Address 316 Hudson Parade
Lot 1 DP827733

Design Stage DEVELOPMENT APPLICATION
Title LONG SITE SECTION

Job No 346-02
Drawn gv
Checked MFB
Scale 1 : 200
Drawing no. DA 30.05
Issue 3