

RAINWATER TANK NOTES:

CAPACITY:  
RAINWATER TANK HAS A CAPACITY AS MARKED IN THE PLAN.

RAINWATER CONNECTION:  
TANK WATER WILL BE PLUMBED TO ALL TOILETS,AN OUTLET IN THE LAUNDRY FOR WASHING MACHINES AND ALL OUTDOOR WATERING AS PER BASIX REQUIREMENT.

FIRST FLUSH:  
'FIRST FLUSH' DEVICE WILL BE FITTED TO REMOVE SURFACE CONTAMINATION.

NON DRINKING:  
TANK WATER WILL NOT BE CONNECTED TO DRINKING OR BATHING WATER OUTLETS.

FULLY ENCLOSED:  
TANKS WILL BE FULLY ENCLOSED AND SEALED TO PREVENT ACCESS BY MOSQUITOES.

NON REFLECTIVE FINISH:  
TANKS SURFACES WILL HAVE NON REFLECTIVE FINISH.

WARNING LABELS:  
A LABEL WILL BE AFFIXED TO THE TANKS WARNING THAT WATER IS NOT TO BE CONSUMED AND RAINWATER SIGNAGE WILL BE PLACED ABOVE ALL TANK WATER OUTLETS.

ROOFING MATERIALS:  
THE ROOF SURFACE FROM WHICH RAINWATER IS BEING DRAWN WILL NOT CONTAIN LEAD,TAR,ASBESTOS OR PAINTS

BASE:  
TANKS WILL BE BUILT ON A SELF SUPPORTING BASE (ABOVE TANKS GROUND ONLY)

WATER PRESSURE:  
TANKS WILL BE FITTED WITH SMALL MOTORISED PUMP TO PROVIDE ACCEPTABLE WATER PRESSURE.

PUMP NOISE:  
PUMP WILL BE DESIGNED AND LOCATED NOT TO CAUSE A NOISE DISTURBANCE TO NEIGHBOURS (GENERALLY NOT 5 dBA ABOVE BACKGROUND NOISE)

INSTALLATION:  
WILL BE INSTALLED BY A LICENSED PLUMBER IN ACCORDANCE WITH SYDNEY WATER REQUIREMENTS AND THE "NSW CODE OF PRACTICE PLUMBING AND DRAINAGE

BACK FLOW PREVENTION:  
A BACK FLOW PREVENTION DEVICE WILL BE PROVIDED AT THE MAINS WATER METER

DUAL SUPPLY:  
A TRICKLE TOP-UP SYSTEM WILL BE PROVIDED AT THE MAINS WATER.

BACK UP SUPPLY:  
A BACK UP SUPPLY OF MAINS WATER WILL BE PROVIDED IN EVENT OF FAILURE OR MAINTENANCE.

ANAEROBIC ZONE:  
WATER WILL BE DRAWN FROM ABOVE THE ANAEROBIC ZONE OF TANKS.

TANK CONSTRUCTION:  
TANKS WILL BE STRUCTURALLY SOUND AND CONSTRUCTED IN ACCORDANCE WITH AS/NZ3500.1,2-1998 NATIONAL PLUMBING AND DRAINAGE-WATER SUPPLY-ACCEPTABLE SOLUTIONS.

AIR GAP:  
TANKS WILL BE PROVIDED WITH AN AIR GAP IN ACCORDANCE WITH AS/NZ 3500.1,2 AND AS2845.2

ON GOING MAINTENANCE:  
TANKS WILL BE WELL KEPT AND MAINTAINED.

NOTES:

- ALL WORKS TO BE CONSTRUCTED TO THE REQUIREMENTS AND SATISFACTION OF NORTHERN BEACHES COUNCIL.
- PRIOR TO COMMENCEMENT OF ANY SITE WORKS,THE BUILDING CONTRACTOR/PLUMBER HAS TO EXPOSE ALL SERVICES IN THE FULL WIDTH OF THE FOOTPATH TO ENSURE THERE ARE NO OBSTRUCTIONS IN THE LINE OF THE DRAINAGE DISCHARGE PIPE.
- THE DRAINAGE CONTRACTOR IS TO LOCATE AND RELOCATE AS NECESSARY ALL SERVICES ON SITE.
- THE BUILDER IS TO VERIFY ALL LEVELS ON THE SITE PRIOR TO COMMENCING CONSTRUCTION.
- SILT FENCE IS TO BE ERECTED PRIOR TO COMMENCING WORK. FENCE TO BE MAINTAINED IN WORKING ORDER DURING THE TIME OF CONSTRUCTION.
- W.A.E. DRAWING BY A REGISTERED SURVEYOR IS REQUIRED PRIOR TO CERTIFICATION OF DRAINAGE.
- U.N.O. ALL DOWN PIPES ARE TO BE 100Ø.
- U.N.O. ALL PIPES TO BE 100Ø CLASS 'SH' WITH 1% MIN SLOPE.
- ALL THE RETAINING WALLS TO STRUCTURAL ENGINEERS DETAIL AND SHOULD BE WITHIN THE SITE BOUNDARY.
- ALL THE DOWN PIPES FROM THE ROOF GUTTER TO RAINWATER TANK SHALL BE CHARGED LINES AND SOLVENT WELD JOINTED.

LEGEND

DRAINAGE LINE	-----	SURFACE INLET PIT	■
AG. LINE	— a — a —	JUNCTION PIT	■
SILT FENCE	— X —	DOWN PIPE	●
EXISTING LEVEL	x	DESIGN LEVEL	x
SILT BARRIER AROUND PIT	□	SPREADER PIPE	I SP
CLEANING EYE (OR INSPECTION EYE)	⊕	PLANTER GRATE	PG
SURFACE LEVEL	SL 45.50	FLOOR GRATE	FG
INVERT LEVEL	IL 45.00	DROPPER	DR
REMOVED TREE	○	STEP IN THE RETAINING WALL	○

NOTE:  
PROVIDE FLOOR GRATES (100Ø) FOR THE FIRST FLOOR BALCONIES. DO NOT CONNECT IT TO THE RAIN WATER TANK

NOTE:  
THE SURFACE INLET PITS SHALL BE HEAVY DUTY PLASTIC PITS

CAUTION:  
ALL THE LEVELS AND DIMENSIONS ARE CRITICAL. PLEASE FOLLOW THE SW PLAN FOR CONSTRUCTION TO AVOID FINAL CERTIFICATION DELAY. IF YOU SEE SOMETHING NOT CORRECT OR NOT SUITED FOR SITE PLEASE CONTACT THE STORMWATER ENGINEER FOR CLARIFICATION AND FURTHER DIRECTIONS.

NOTE:  
PLEASE FOLLOW THE RAINWATER TANK LEVELS AT SITE

NOTE:  
THE PIT SURFACE LEVELS AND THE TOP OF RETAINING WALLS SHALL BE RE-CONFIRMED AT SITE

NOTE:  
PRIOR TO CONSTRUCTION THE BUILDER IS TO COORDINATE ALL THE PLANS (ARCHITECTURE PLAN, LANDSCAPE PLAN, STRUCTURAL ENGINEER'S PLAN AND THE STORMWATER PLAN) TO MAKE SURE ALL THE DESIGN LEVELS, DOWNPIPE LOCATIONS AND THE FLOOR LEVELS ARE SAME IN ALL THE PLANS.

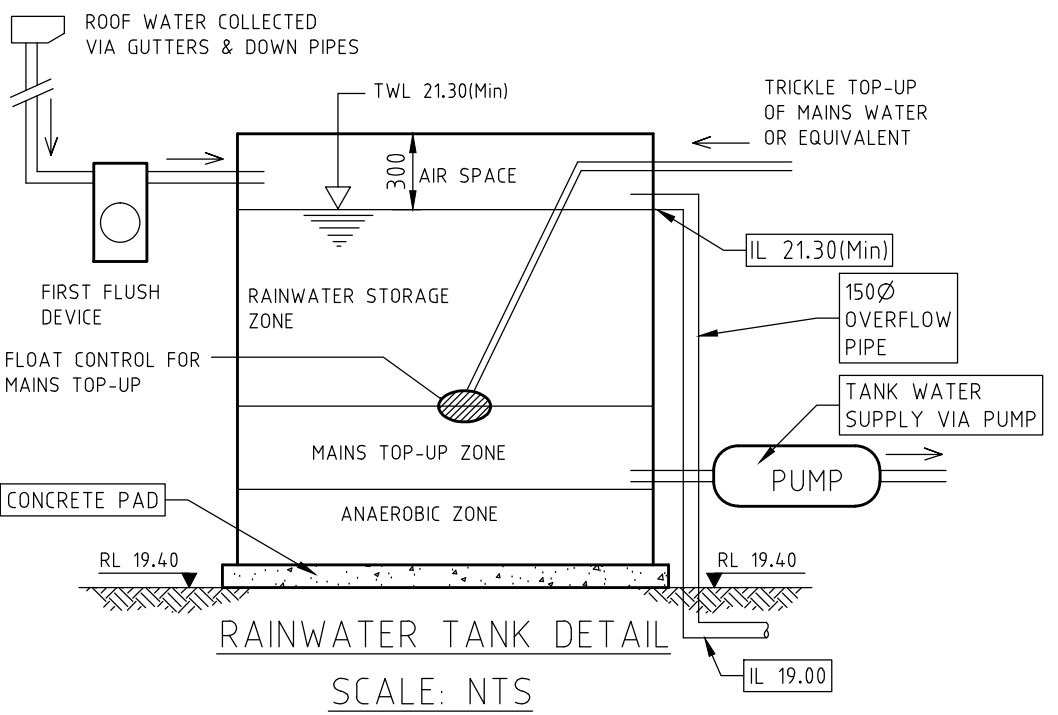

NOTE:  
CLEAN OUT LINES FROM THE CHARGED LINES TO BE CONNECTED TO THE NEAREST PITS WITH END CAP AT THE PIT END

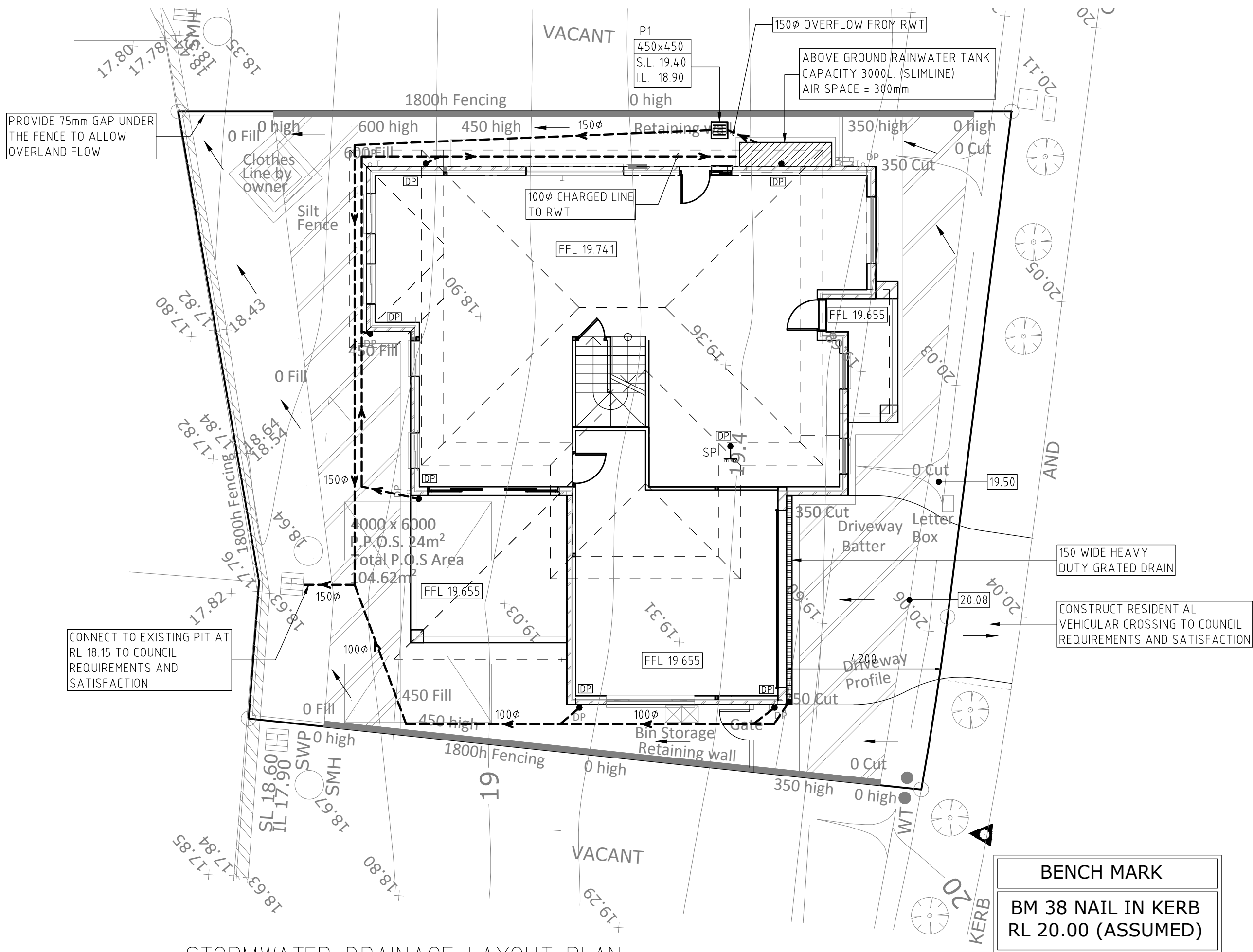

STORMWATER DRAINAGE LAYOUT PLAN

SCALE: - 1:100 @ A1

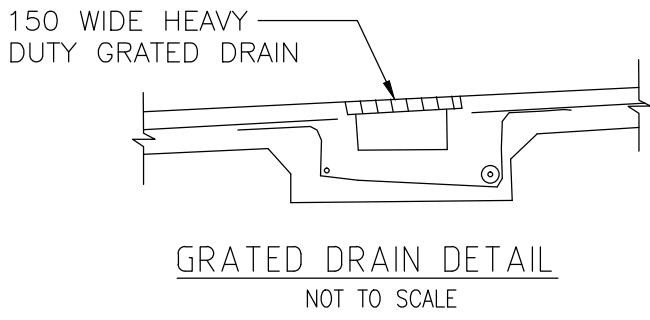

GRATED DRAIN DETAIL  
NOT TO SCALE

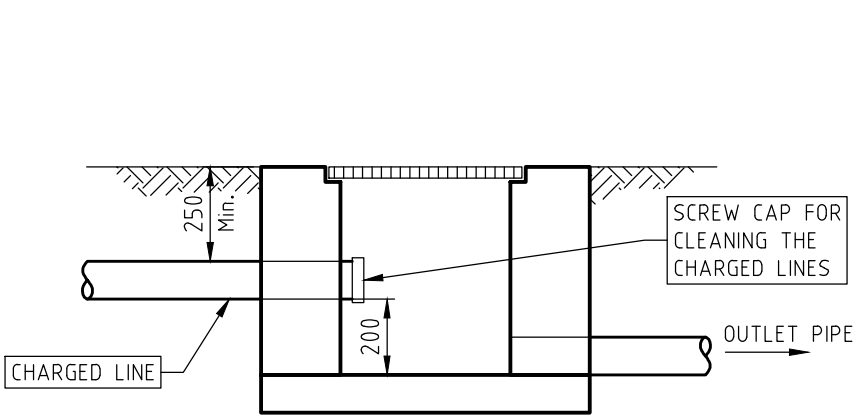

TYPICAL CHARGED LINE  
CLEAN OUT CONNECTION TO A PIT  
NOT TO SCALE

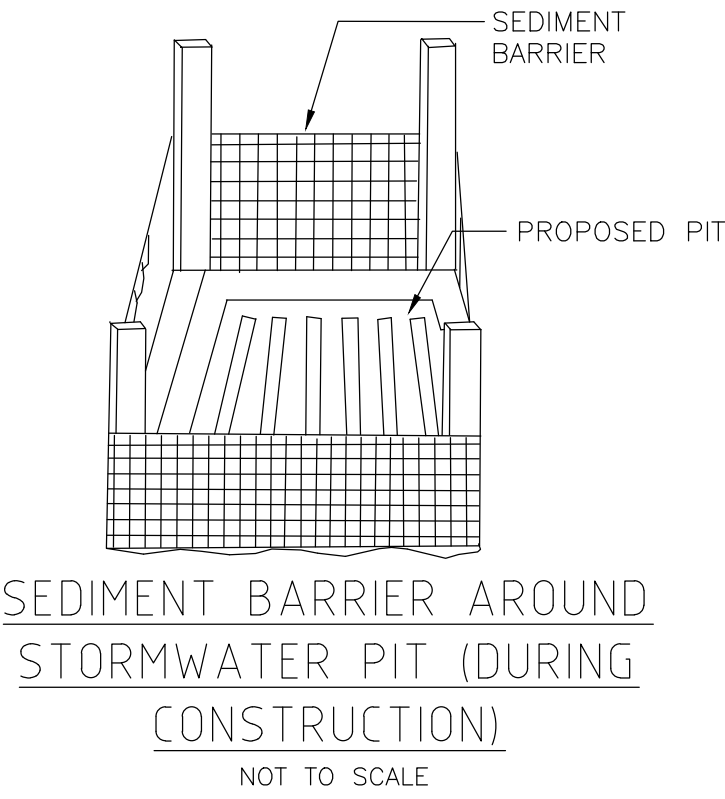

SEDIMENT BARRIER AROUND  
STORMWATER PIT (DURING  
CONSTRUCTION)  
NOT TO SCALE

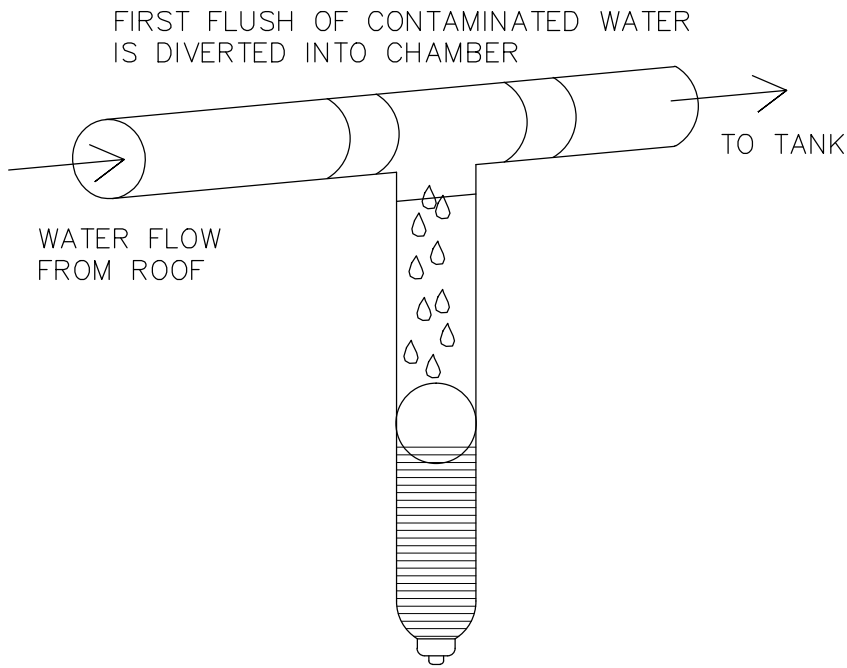

FIRST FLUSH WATER DIVERTER DETAIL  
NOT TO SCALE

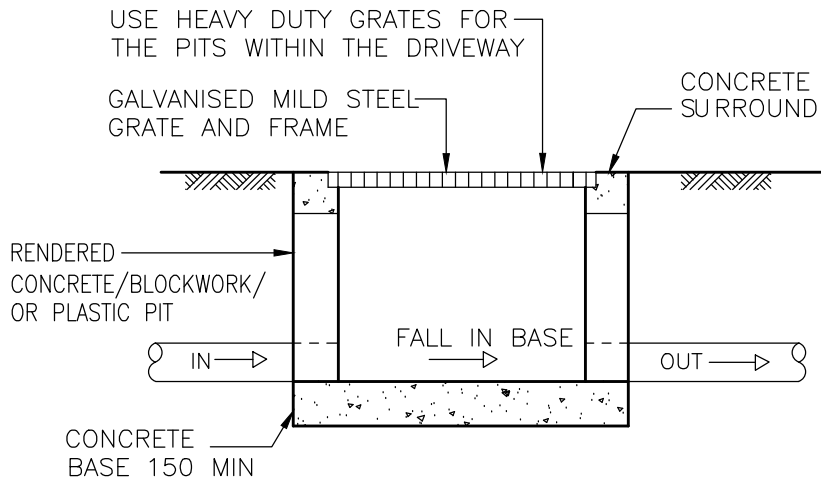

STANDARD PIT DETAIL  
(PROVIDE STEP IRONS @ 300  
CENTRES FOR PITS WHERE THE  
DEPTH EXCEEDS 900mm)  
NOT TO SCALE

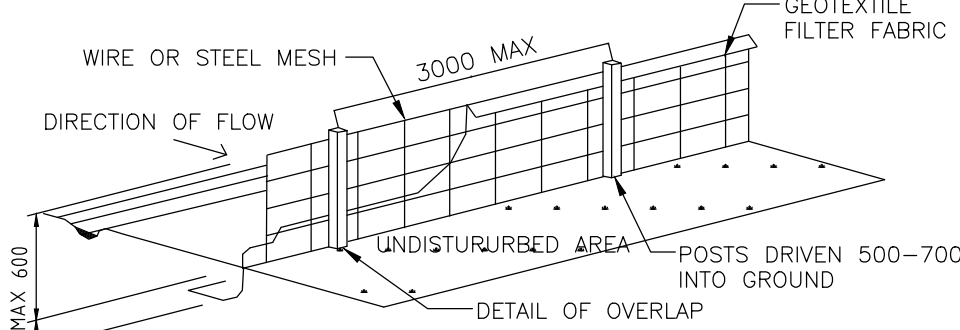

SILT FENCE DETAIL (TO BE WITHIN  
THE PROPERTY BOUNDARY-DURING  
CONSTRUCTION ONLY)  
NOT TO SCALE

			DESIGN BY:	VNK CONSULTING Pty Ltd PO BOX 9118 Harris Park NSW 2150 Mobile: 0401 132 386 Email: VNKCONSULTING@GMAIL.COM	Drawing Title:		DESIGNED	NL	Project:	Ref No.
			PRINCIPAL ENGINEER:	LOGAN N LOGESWARAN	STORMWATER DRAINAGE LAYOUT PLAN		DRAWN	AJ	PROPOSED DWELLING LOT 9 KARINYA ESTATE WARRIEWOOD NSW 2102	111218-01
			QUALIFICATIONS:	BscEng, MEng, MEngStud, MASCE, MIEAust, CPEng, NER			DATUM	ASSUMED		Issue:
							DATE	11.12.18		B
B	13.12.18	RE-ISSUED FOR DA APPROVAL	AJ							
A	11.12.18	ISSUED FOR DA APPROVAL	AJ							
Issue	Date	Description	BY							SHEET 1 of 1