



WALLACE DESIGN GROUP

WALLACE PLUMBING & FIRE DESIGN PTY LTD

A PART OF WALLACE DESIGN GROUP PTY LTD

A.B.N: 96 154 894 952

PO Box 850. WARNERS BAY, NSW 2282

PH: (02) 4929 4109

EMAIL: mail@wdegroupp.com.au

WEB: www.wdegroupp.com.au

Ref: WML19181

13 September 2019

CYLCO CONSTRUCTION + FITOUT

22 Industrial Road,
UNANDERRA, NSW 2526

ATTENTION: JEROME GAGE

RE: PROPOSED VETERINARY CLINIC – SEWER WASTE TREATMENT LETTER

We, Wallace Plumbing & Fire Design Pty Ltd, have been requested to review the sewer waste treatment system currently in operation at 16 Myoora Road, Terry Hills and the affect if any of discharge from the proposed Veterinary clinic at this address. We have confirmed that at present there is not a sewer connection to the subject site, but there is a new pressure sewer that is a pump out sewer system where pumps are installed in a tank on site and sewer pumped into a Sydney Water Corporation (SWC) rising main in Myoora Road. (refer to Appendix A – Sydney Water Corporation (SWC) Dial Before You Dig Diagram)

Until such time as the sewer connection is made, any discharge will be to the existing septic tank system. Under the clinic waste management policy all animal waste from the clinic will be bagged or placed in containers for disposal by a registered waste disposal firm. Any blood spills will be mopped up and disposed into a container for removal from the site. Having said that, there will be some floor wastes installed in areas where wash down will be carried out from time to time. These floor wastes will be fitted with removable baskets, with a fixed grate below the basket (refer to Appendix B – Basket Trap Floor Waste) to the requirements of the Sydney Water Corporations (SWC) trade waste departments guidelines so that when connected to the Sydney Water Corporation (SWC) sewer it will comply with their requirements.

It is recognised that blood in sufficient quantities can disrupt the operation of the septic tank, however in our opinion given the measures in place in the waste management policy noted above the amount of any blood would not be of sufficient quantity to do any harm to the septic system. We note that any floor wastes will need to be charged via a fixture or a hose cock, such items being supplied with water via a RPZD valve for backflow protection.

Trusting the above meets your approval.

Yours Faithfully,
Wallace Plumbing & Fire Design Pty Ltd

SHAUN WALLACE – Director

Appendix A – Sydney Water Corporation (SWC) Dial Before You Dig Diagrams

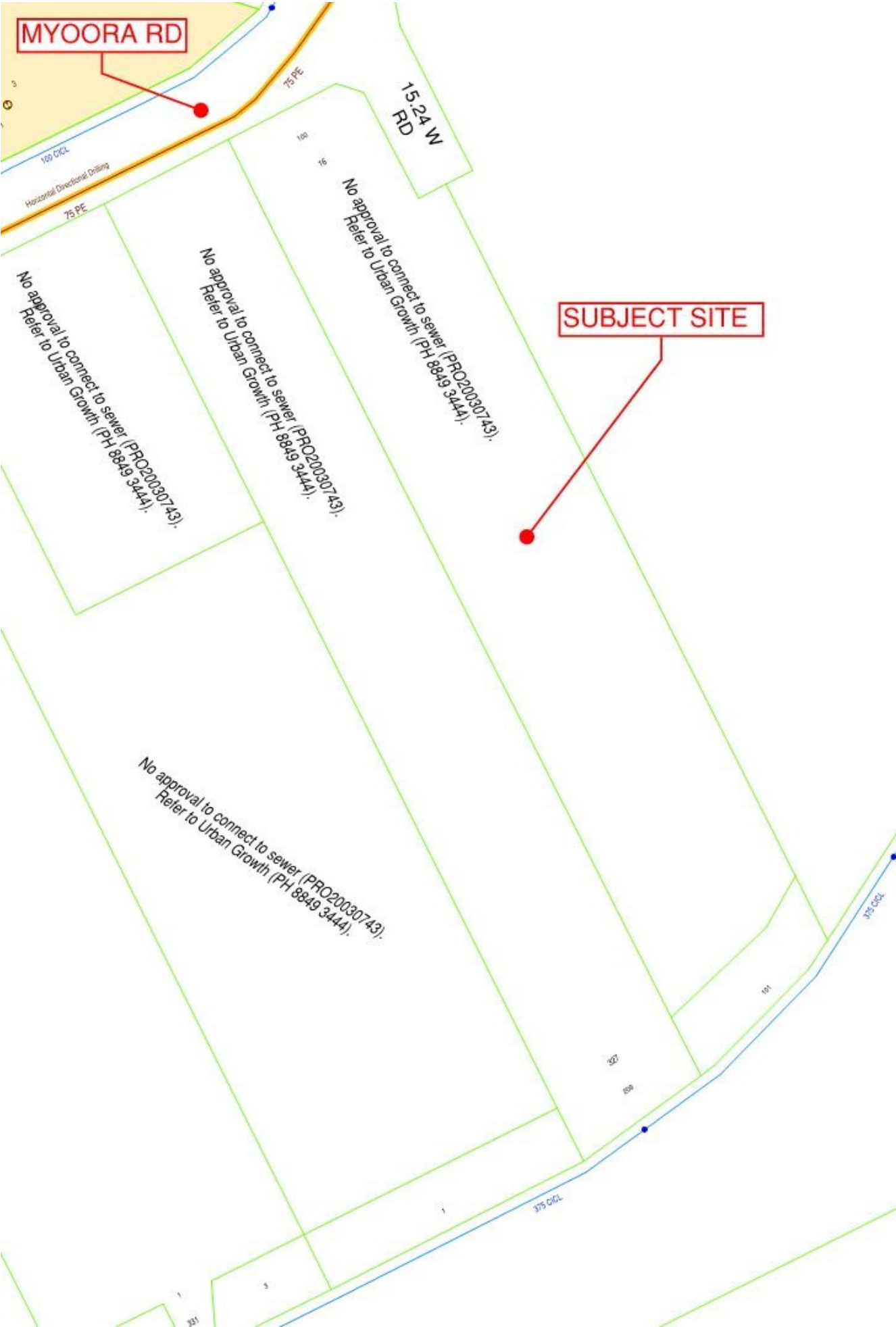

SPS 150mm Round Push-in Bucket Trap

Specification code:
R150SR-BT (304 stainless steel grate)

150mm
Round



- Round grate in cast 304 stainless steel. Basket and strainer in 304 stainless steel sheet.
- Spigot fits inside 100mm PVC, copper, CI and HDPE.
- Includes stainless steel sediment basket and secondary strainer disk.
- Compatible with PVC leak control flanges for membraned applications.

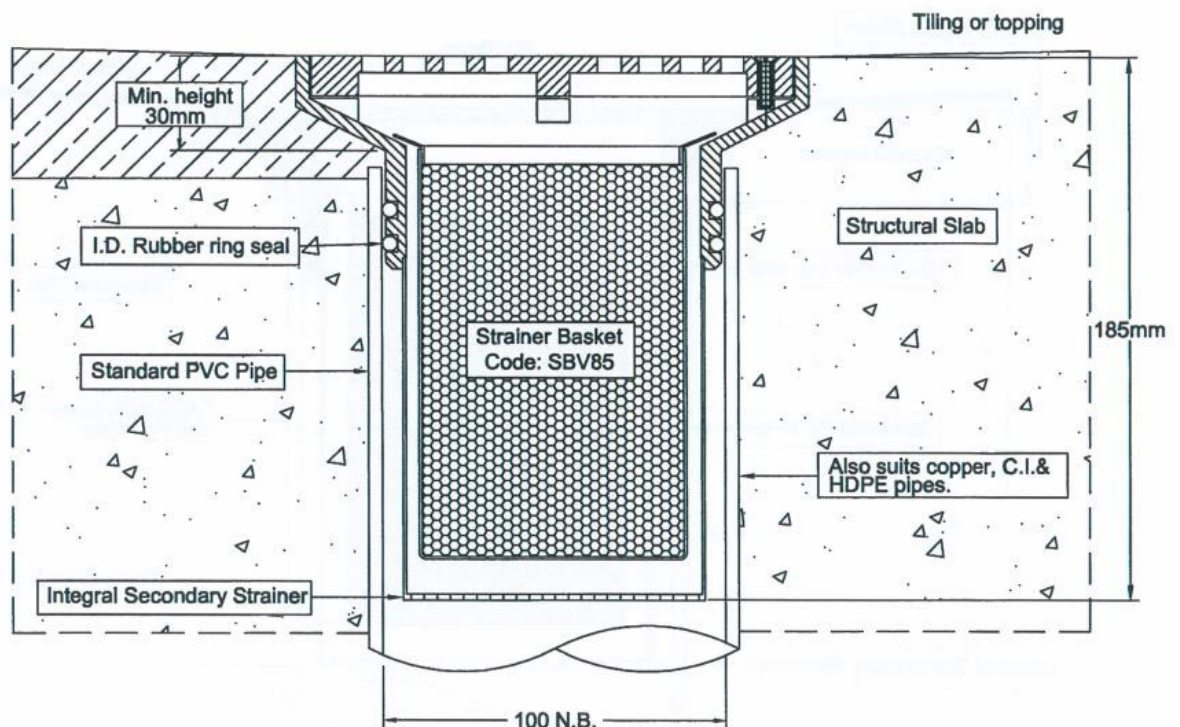

Speciality Plumbing Supplies Pty Ltd

Tel: (02) 9416 8031 Fax: (02) 9416 7614 E-mail: sps@bigpond.net.au

6.04