

**VEHICULAR CROSSING CIVIL WORKS PLAN**  
SCALE 1:100

NOTE : TO MEET NCC / BCA / AS AND NORTHERN BEACHES COUNCIL SPECIFICATIONS FOR DRIVEWAY. THE GARAGE RL IS TO BE 66.19 TO 66.73

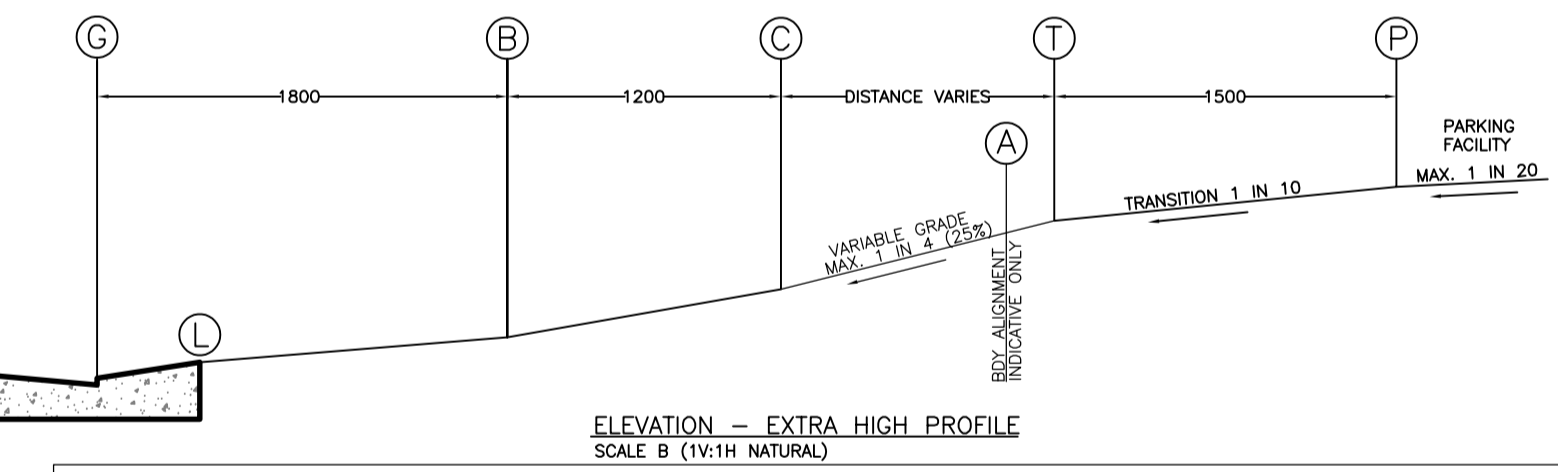

POINT	REMARK	LEVELS
G	GUTTER INVERT	DRIVEWAY CROSSING SET-OUT POINT
L	REAR OF LAYBACK	100mm ABOVE GUTTER INVERT (MAY BE ALTERED AT COUNCIL'S DISCRETION)
B	1500mm FROM GUTTER INVERT	210mm ABOVE GUTTER INVERT
C	3000mm FROM GUTTER INVERT	420mm ABOVE GUTTER INVERT
T	BOUNDARY ALIGNMENT	PLACE 10mm EXPANSION JOINT. CONTINUE CROSSING GRADIENT BETWEEN POINTS C AND T
A	1500mm BEFORE PARKING FACILITY	PROVIDE TRANSITIONAL SLOPE 1V:10H OVER 1500mm WHICH MAY BE PARTIALLY OR WHOLLY ON ROAD RESERVE
P	PARKING FACILITY	MAXIMUM GRADE PARALLEL TO ANGLE OF PARKING 1V:20H. FOR ANY OTHER DIRECTION 1V:18H

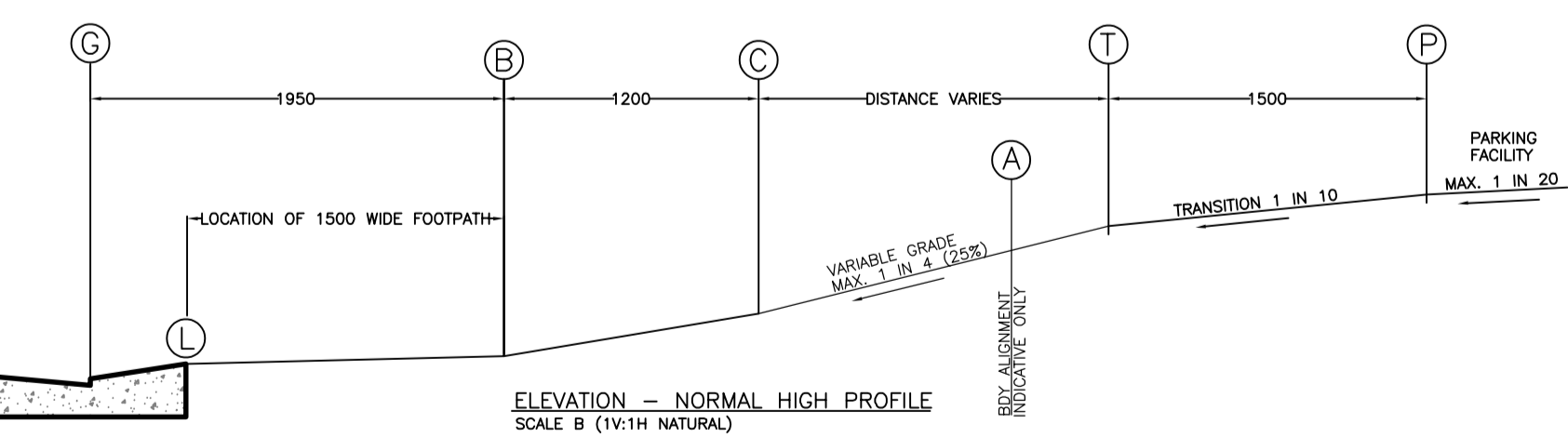

POINT	REMARK	LEVELS
G	GUTTER INVERT	DRIVEWAY CROSSING SET-OUT POINT
L	REAR OF LAYBACK	100mm ABOVE GUTTER INVERT (MAY BE ALTERED AT COUNCIL'S DISCRETION)
B	1500mm FROM GUTTER INVERT	138mm ABOVE GUTTER INVERT
C	3000mm FROM GUTTER INVERT	276mm ABOVE GUTTER INVERT
T	BOUNDARY ALIGNMENT	PLACE 10mm EXPANSION JOINT. CONTINUE CROSSING GRADIENT BETWEEN POINTS G AND T
A	1500mm BEFORE PARKING FACILITY	PROVIDE TRANSITIONAL SLOPE 1V:10H OVER 1500mm WHICH MAY BE PARTIALLY OR WHOLLY ON ROAD RESERVE
P	PARKING FACILITY	MAXIMUM GRADE PARALLEL TO ANGLE OF PARKING 1V:20H. FOR ANY OTHER DIRECTION 1V:18H

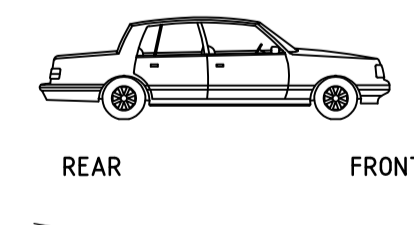
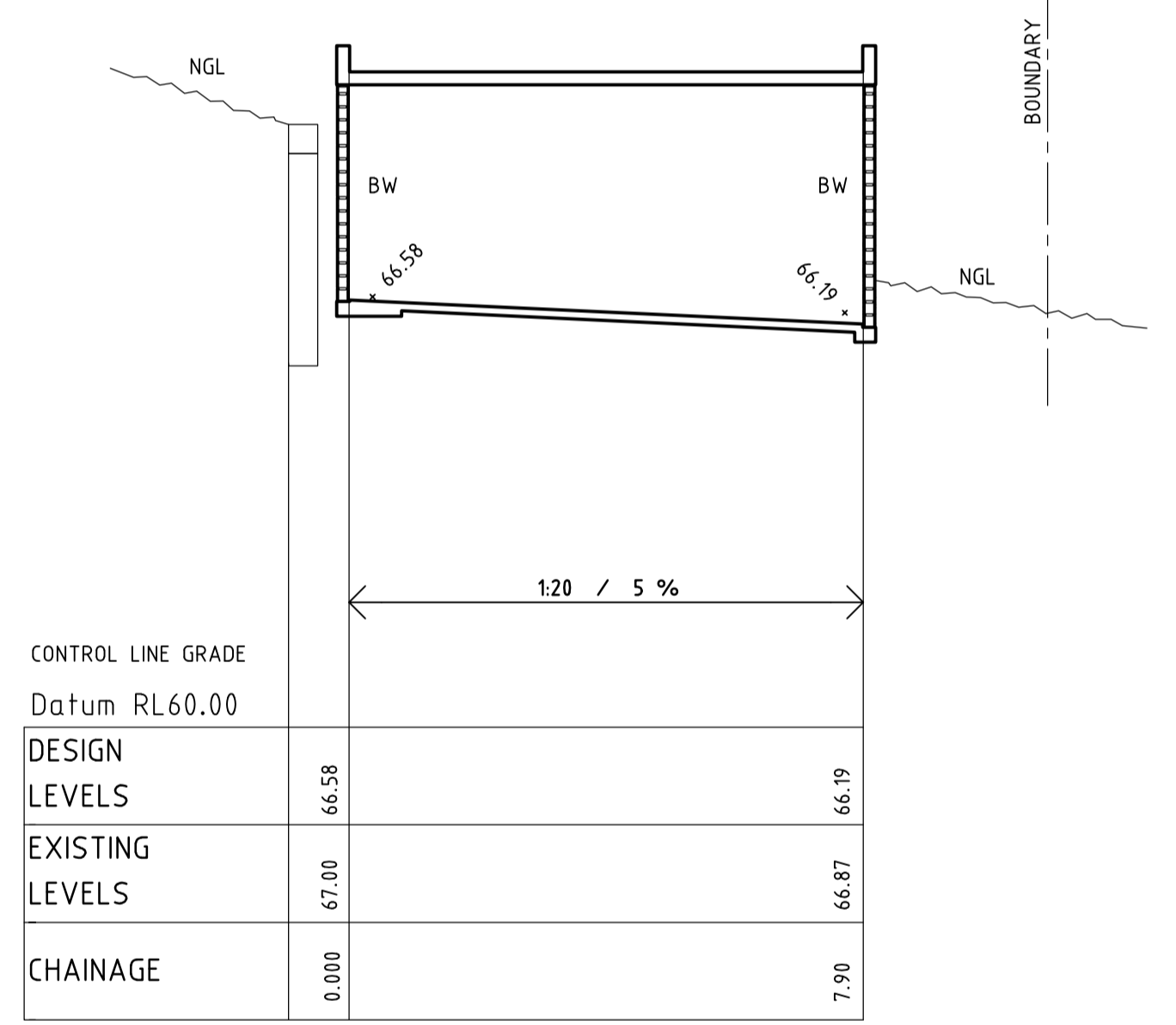
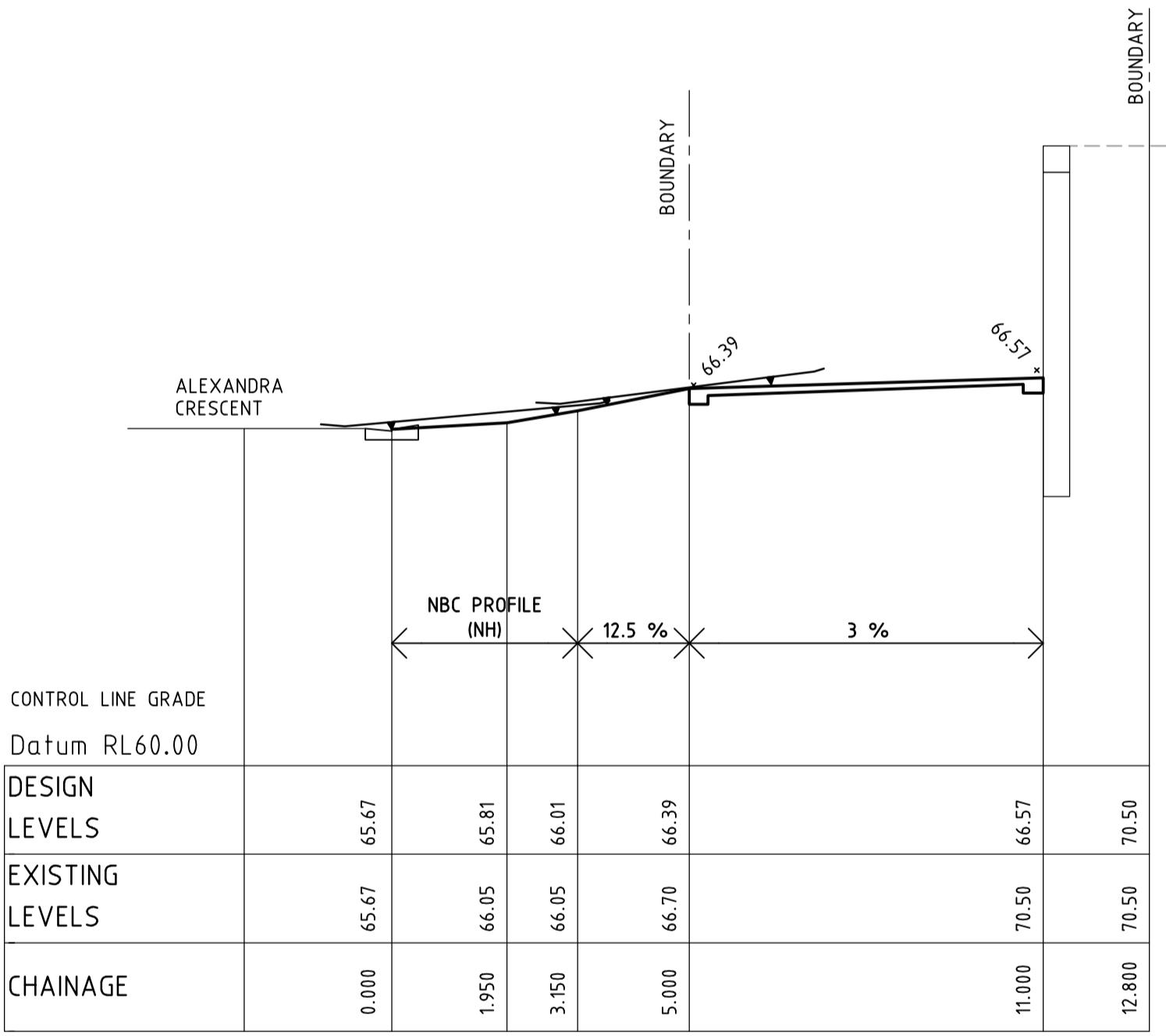
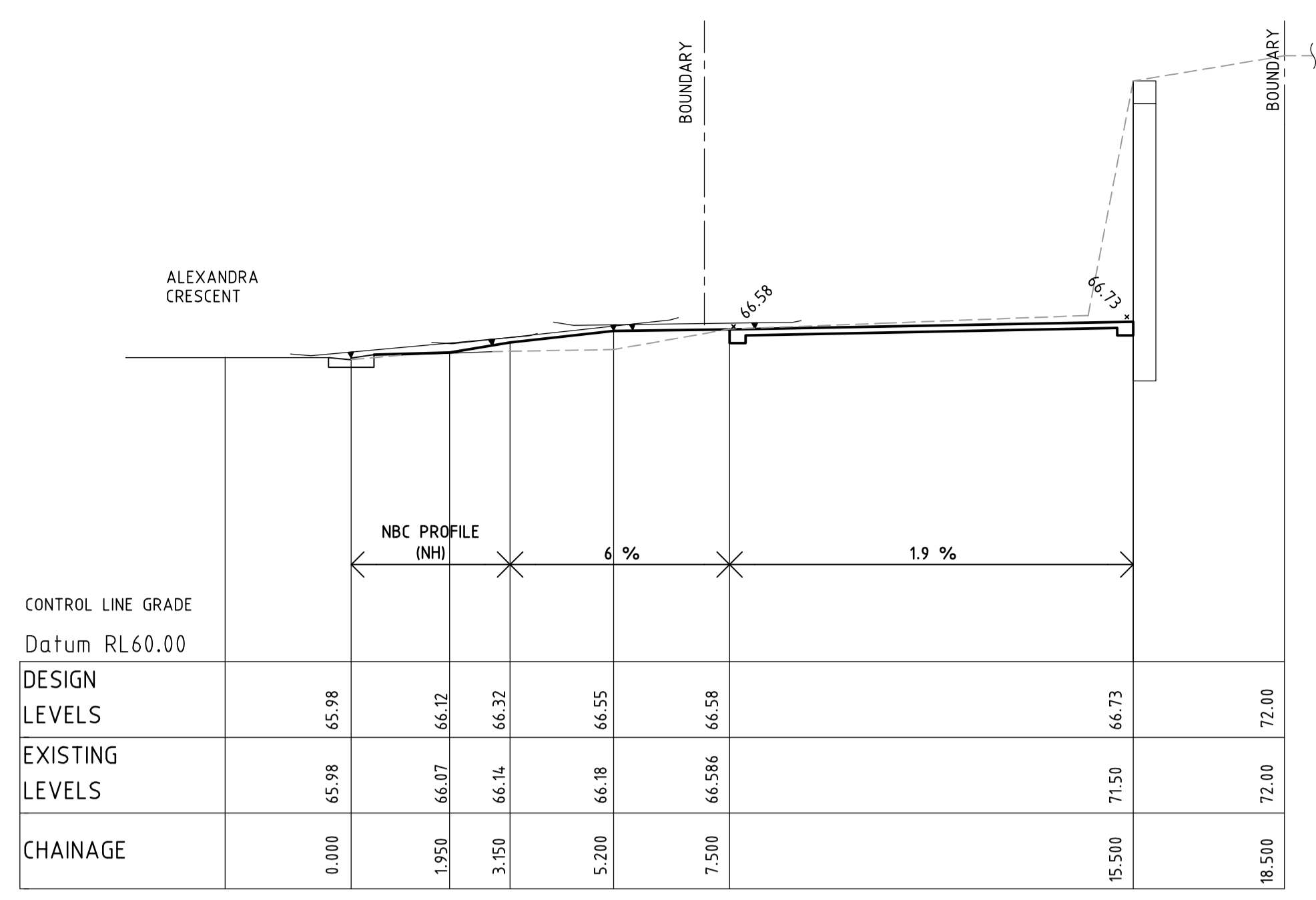
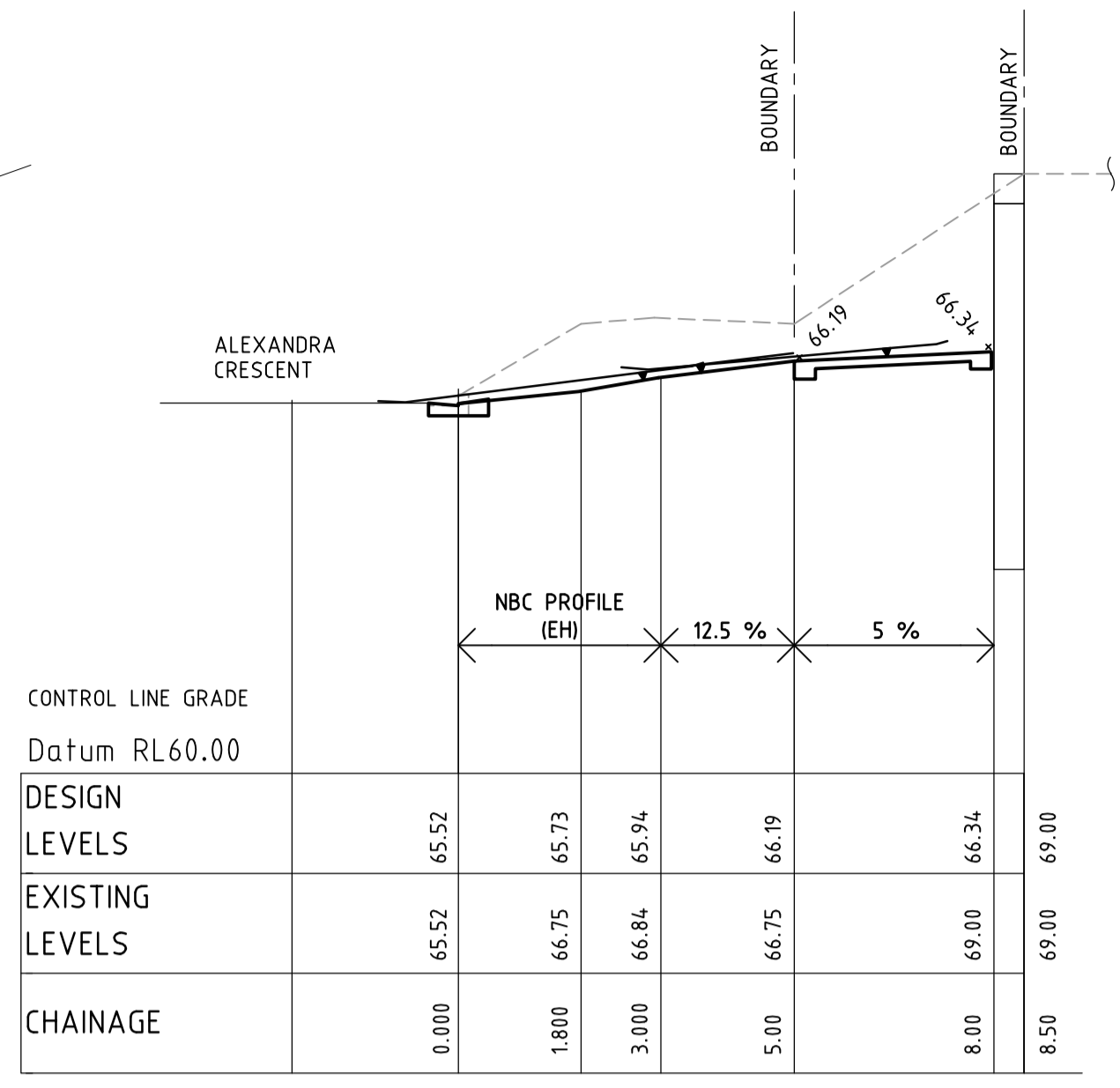

B85 VEHICLE

**ISSUED FOR COUNCIL REVIEW**

	C RE-ISSUED FOR COUNCIL REVIEW B RE-ISSUED FOR COUNCIL REVIEW A ISSUED FOR COUNCIL REVIEW	A.W. A.W. A.W.	L.M. L.M. L.M.	08.04.24 04.04.24 22.03.24	Project : <b>ALTERATIONS AND ADDITIONS          87 ALEXANDRA CRES.          BAYVIEW N.S.W.          for Mr A &amp; Mrs J DIEMONT</b>	Drawing : <b>VEHICULAR CROSSING CIVIL WORKS          PLAN AND LONG SECTIONS</b>	Job No : <b>230204</b>	Drawing No : <b>C1.00 C</b>
	Barrenjoey Consulting Engineers Pty Ltd Stormwater Structural Civil PO Box 672 Avalon NSW 2107 M : 0418 620 330 E : lucasboe@bigpond.com ABN : 13 124 694 917 ACN : 124 694 917					Document certification Barrenjoey Consulting Engineers Pty Ltd PER Lucas Molloy MIEA CPEng NPER Director		

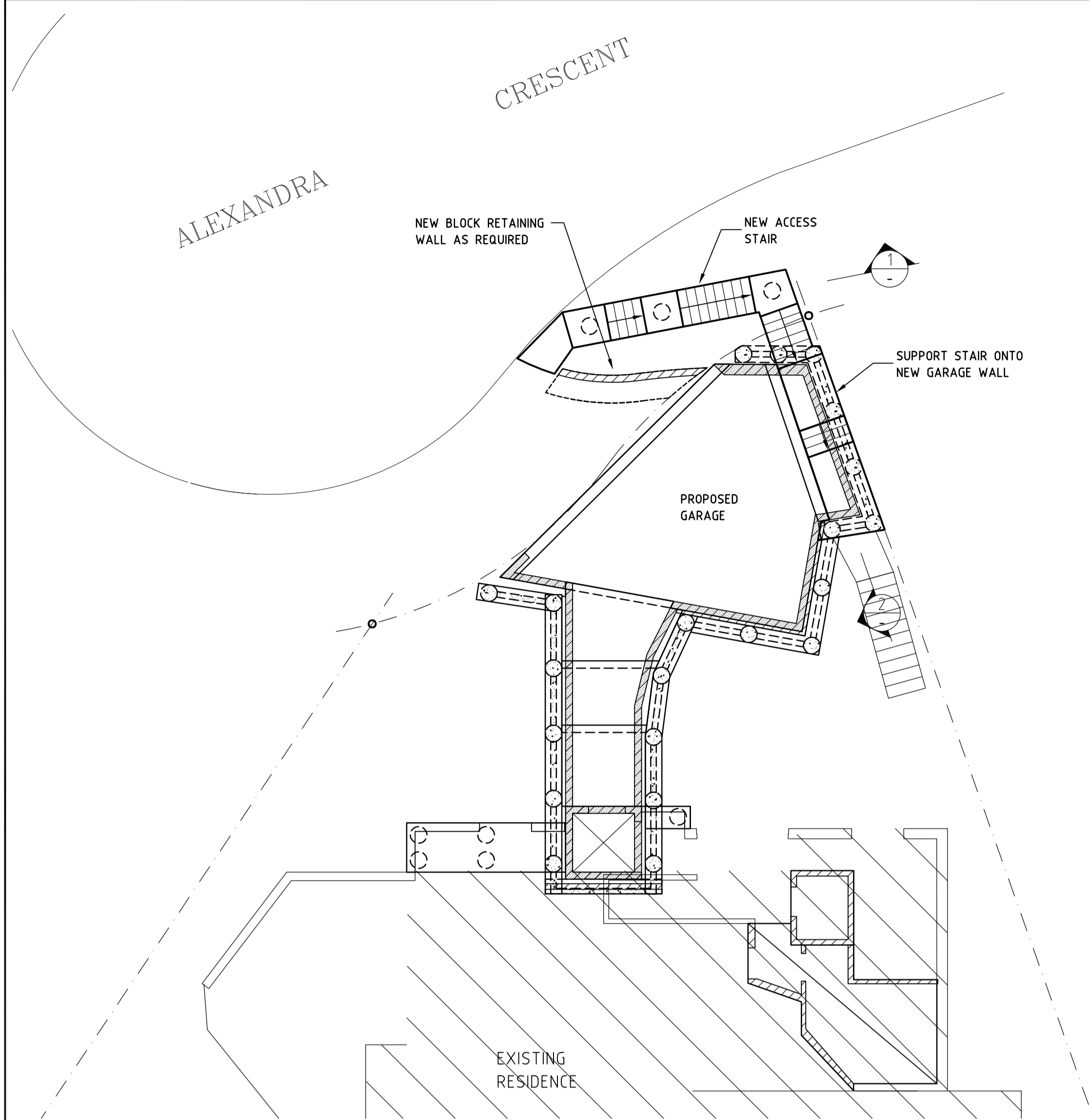

**EXTERNAL WORKS ACCESS STAIR PLAN**  
SCALE 1:100

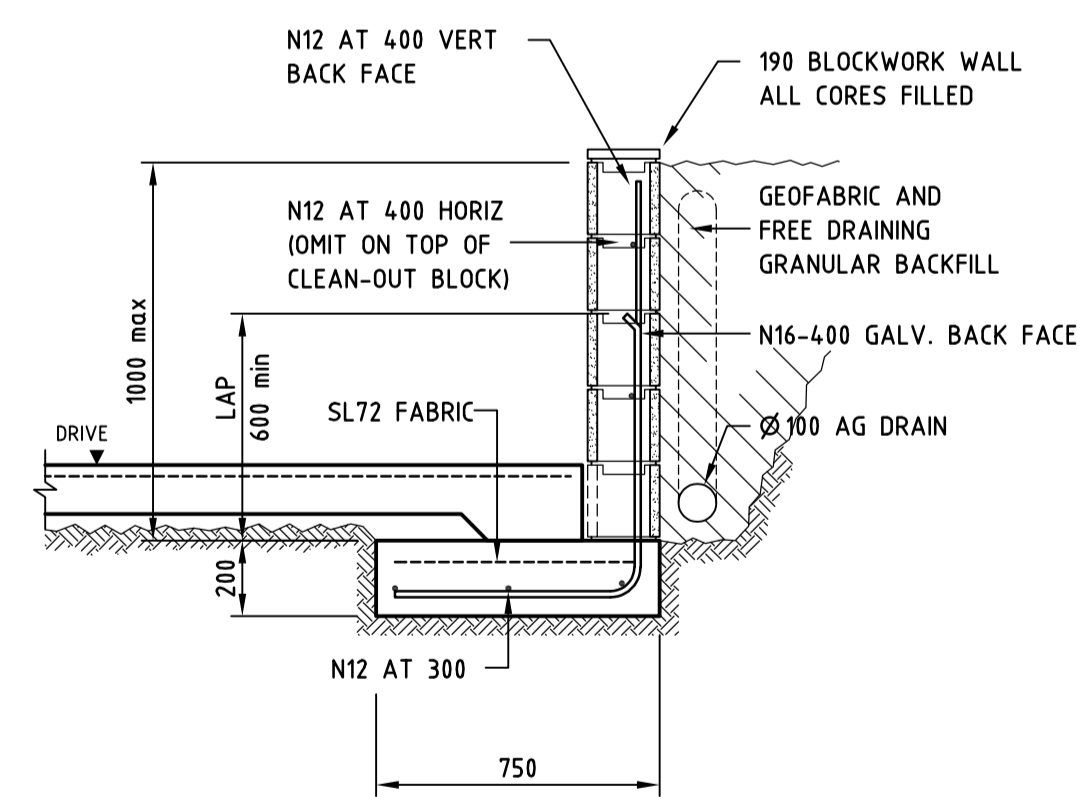

**RETAINING WALL DETAIL**

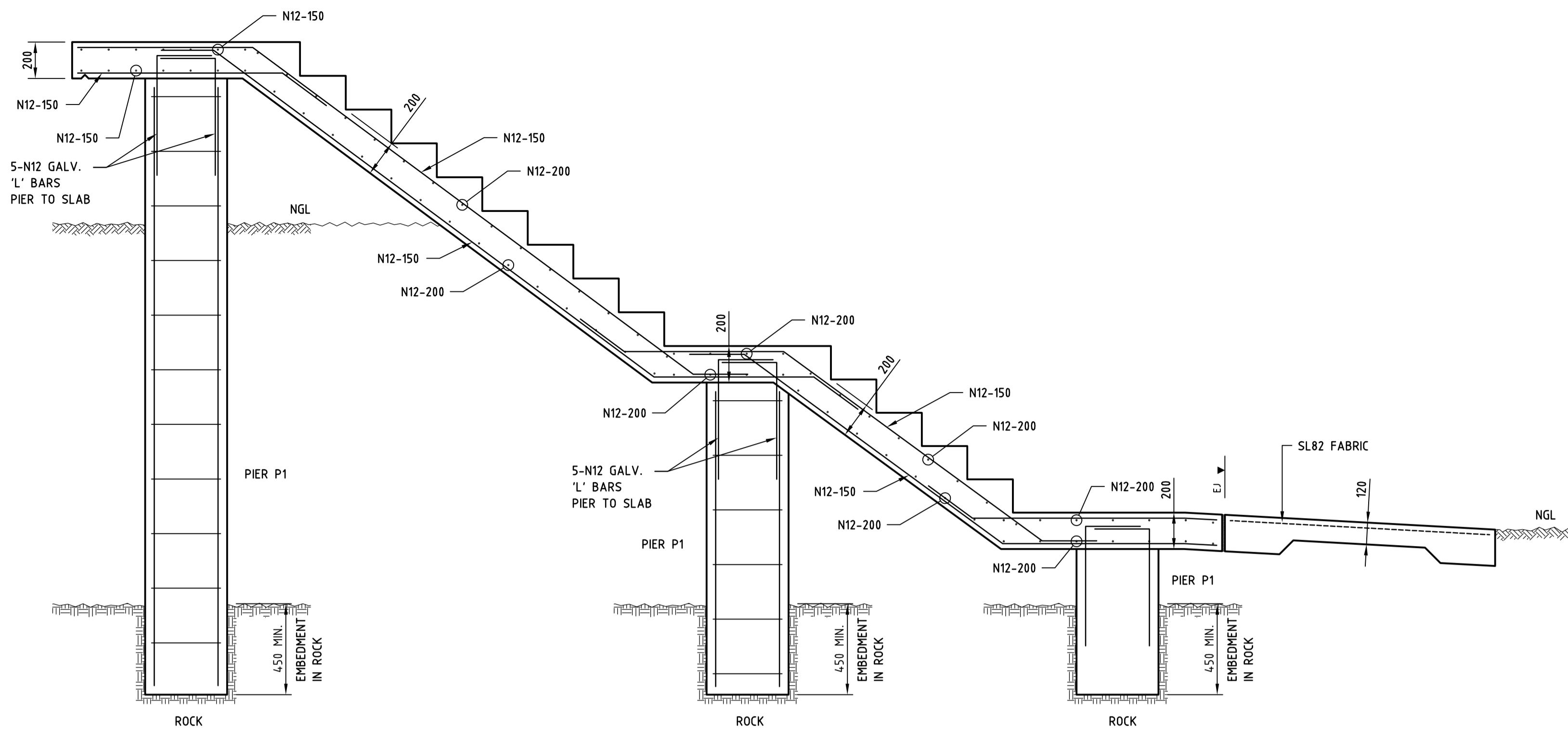

**SECTION 1**  
1:20

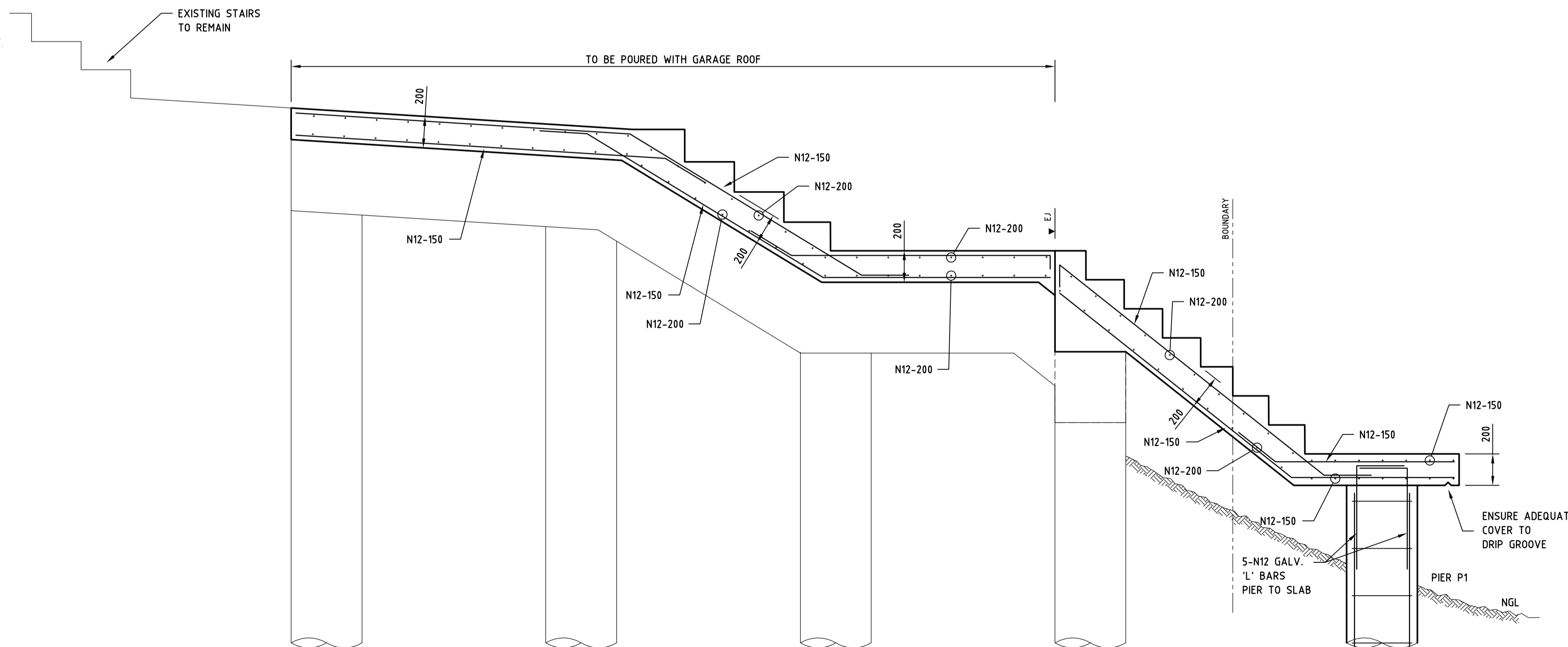

**SECTION 2**  
1:20

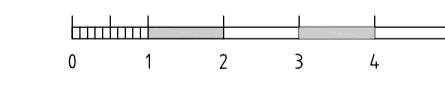

**ISSUED FOR COUNCIL REVIEW**

	REVISION	AMENDMENT	DRAWN	DESIGNED	DATE
	B	RE-ISSUED FOR COUNCIL REVIEW	A.W.	L.M.	08.04.24
	A	ISSUED FOR COUNCIL REVIEW	A.W.	L.M.	22.03.24

Barrenjoey Consulting Engineers Pty Ltd  
Stormwater Structural Civil  
PO Box 672  
Avalon NSW 2107

M : 0418 620 330  
E : lucasboe@bigpond.com  
ABN : 13 124 694 917  
ACN : 124 694 917

Project :  
**ALTERATIONS AND ADDITIONS  
87 ALEXANDRA CRES.  
BAYVIEW N.S.W.  
for Mr A & Mrs J DIEMONT**

Drawing :  
**EXTERNAL WORKS  
ACCESS STAIR  
PLAN AND SECTIONS**

Job No :  
**230204**

Drawing No :  
**C2.00 B**

Document certification  
Barrenjoey Consulting Engineers Pty Ltd

PER  
Lucas Molloy MIEA CPEng NPER Director

*Handwritten signature and date: 4/24*