

MANLY CORSO APARTMENTS REFURBISHMENT & ADDITIONS

NOT TO BE USED FOR CONSTRUCTION
 No DATE DESCRIPTION BY
 1 15.04.19 ISSUED FOR DA ELR

S.P. 12989
 19-21 THE CORSO, MANLY
 Job No. 19010126

ENVIRONMENTAL SITE MANAGEMENT LEGEND

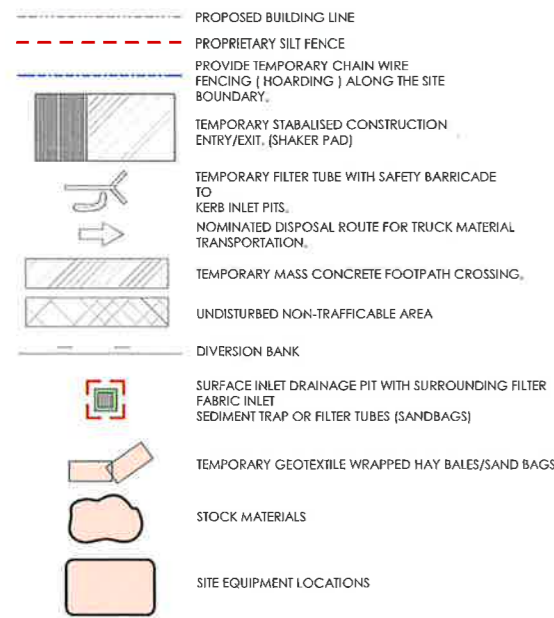

SAFETY IN DESIGN

THERE ARE INHERENT RISKS WITH CONSTRUCTING, MAINTAINING, OPERATING, DEMOLISHING, DISMANTLING AND DISPOSING THIS DESIGN THAT ARE TYPICAL OF SIMILAR DESIGNS. AS FAR AS IS REASONABLY PRACTICABLE RISKS HAVE BEEN ELIMINATED OR MINIMISED THROUGH THE DESIGN PROCESS. HAZARD CONTROLS MUST STILL BE IMPLEMENTED BY THE CONTRACTOR, OWNER OR OPERATOR TO ENSURE THE SAFETY OF WORKERS.

* JN DO NOT CONSIDER THAT THERE ARE ANY UNIQUE RISKS ASSOCIATED WITH THE DESIGN OF THIS PROJECT.

ESM DRAWING LIST	
No.	SHEET NAME
ESM1	NOTES, LEGEND & DETAILS
ESM2	ESM PLAN

ENVIRONMENTAL SITE MANAGEMENT

- EROSION & SEDIMENT CONTROLS TO BE INSTALLED IN ACCORDANCE WITH COUNCIL'S SPECIFICATION & THE NSW DEPARTMENT OF HOUSING "BLUE BOOK" - SOILS AND CONSTRUCTION - MANAGING URBAN STORMWATER, 2004. REFER TO THE BLUE BOOK FOR STANDARD DRAWINGS "SD"
- SEDIMENT & EROSION CONTROLS MUST BE IN PLACE PRIOR TO THE COMMENCEMENT OF ANY EARTHWORKS OR DEMOLITION ACTIVITY. THE LOCATION OF SUCH DEVICES IS INDICATIVE ONLY AND FINAL POSITION SHOULD BE DETERMINED ON SITE.
- IT IS THE RESPONSIBILITY OF THE CONTRACTOR TO ENSURE THAT ALL MEASURES ARE TAKEN DURING THE COURSE OF CONSTRUCTION TO PREVENT SEDIMENT EROSION AND POLLUTION OF THE DOWNSTREAM SYSTEM. SUPERVISING ENGINEER SHOULD BE CONTACTED IF IN DOUBT. ALL SEDIMENT CONTROL STRUCTURES TO BE INSPECTED AFTER EACH RAINFALL EVENT FOR STRUCTURAL DAMAGE AND ALL TRAPPED SEDIMENT TO BE REMOVED TO A NOMINATED SOIL STOCKPILE SITE.
- RETAIN ALL EXISTING GRASS COVER WHEREVER POSSIBLE. TOPSOIL FROM ALL AREAS THAT WILL BE DISTURBED TO BE STRIPPED AND STOCKPILED AT THE NOMINATED SITE. A SEDIMENT FENCE TO BE PLACED DOWNHILL OF STOCKPILE.
- AREAS OF SITE REGRADING ARE TO BE COMPLETED PROGRESSIVELY DURING THE WORKS AND STABILISED AS EARLY AS POSSIBLE. THE SUPERVISING ENGINEER MAY DIRECT THE CONTRACTOR TO HAVE AREAS OF DISTURBANCE COMPLETED AND STABILISED DURING THE COURSE OF THE WORKS.
- ALL DISTURBED AREAS ARE TO BE SEEDED & FERTILISED WITHIN 14 DAYS OF EXPOSURE.
- ALL EXISTING TREES TO BE RETAINED UNLESS SHOWN OTHERWISE ON APPROVED DRAWINGS. TREES RETAINED ARE TO BE PROTECTED WITH A HIGH VISIBILITY FENCE, PLUS FLAGGING TO INDIVIDUAL TREES AS NECESSARY.
- INSTALL TEMPORARY SEDIMENT BARRIERS TO ALL INLET PITS LIKELY TO COLLECT SILT LADEN WATER, UNTIL SURROUNDING AREAS ARE PAVED OR REGRASSED. GRAVEL OR GEOTEXTILE INLET FILTERS TO SD6-11 & SD6-12.
- ALL SILT FENCES & BARRIERS ARE TO BE MAINTAINED IN GOOD ORDER & REGULARLY DESILTED DURING THE CONSTRUCTION PERIOD. SILT FENCES TO SD6-8 OR SD6-9.
- STOCKPILES OF LOOSE MATERIALS SUCH AS SAND, SOIL, GRAVEL MUST BE COVERED WITH GEOTEXTILE SILT FENCE MATERIAL, PLASTIC SHEETING OR MEMBRANE MUST NOT BE USED. SAFETY BARRICADING SHOULD BE USED TO ISOLATE STOCKPILES OF SOLID MATERIALS SUCH AS STEEL REINFORCING, FORMWORK AND SCAFFOLDING.
- WASTE MATERIALS ARE TO BE STOCKPILED OR LOADED INTO SKIP-BINS LOCATED ON SITE AS SHOWN ON PLAN.
- NO MORE THAN 150m OF TRENCHING TO BE OPEN AT ANY ONE TIME. IMMEDIATELY AFTER TRENCH BACKFILLING, PROVIDE SANDBAGS OR SAUSAGE FILTERS ACROSS EACH TRENCH AT MAXIMUM 20m SPACINGS. FILTERS TO REMAIN IN PLACE UNTIL REVEGETATION HAS OCCURRED.
- ALL VEHICLES LEAVING THE SITE MUST PASS OVER THE STABILISED SITE ACCESS BALLAST AREA (SIMILAR TO SD6-14) TO SHAKE OFF SITE CLAY AND SOIL. IF NECESSARY WHEELS AND AXLES ARE TO BE HOSED DOWN. BALLAST IS TO BE MAINTAINED & REPLACED AS NECESSARY DURING THE CONSTRUCTION PERIOD.
- THE HEAD CONTRACTOR IS TO INFORM ALL SITE STAFF AND SUB-CONTRACTORS OF THEIR OBLIGATIONS UNDER THE EROSION AND SEDIMENT CONTROL PLAN.
- ANY SEDIMENT DEPOSITED ON THE PUBLIC WAY, INCLUDING FOOTPATH RESERVE AND ROAD SURFACE, IS TO BE REMOVED IMMEDIATELY.
- PROVIDE BARRIERS AROUND ALL CONSTRUCTION WORKS WITHIN THE FOOTPATH AREA TO PROVIDE SAFE ACCESS FOR PEDESTRIANS.
- CONCRETE PUMPS AND CRANES ARE TO OPERATE FROM WITHIN THE BALLAST ENTRY DRIVEWAY AREA AND ARE NOT TO OPERATE FROM THE PUBLIC ROADWAY UNLESS SPECIFIC COUNCIL PERMISSION IS OBTAINED.
- TRUCKS REMOVING EXCAVATED / DEMOLISHED MATERIAL SHOULD TRAVEL ON STABILISED CONSTRUCTION PATHS. MATERIAL TO BE TAKEN TO THE TRUCK TO REDUCE TRUCK MOVEMENT ON SITE. TRUCKS TO BE LIMITED TO SINGLE UNIT HEAVY RIGID VEHICLES. (NO SEMITRAILERS)
- ANY EXCAVATION WORK ADJACENT TO ADJOINING PROPERTIES OR THE PUBLIC ROADWAY IS NOT TO BE COMMENCED UNTIL THE STRUCTURAL ENGINEER IS CONSULTED AND SPECIFIC INSTRUCTIONS RECEIVED FROM THE ENGINEER.
- TOILET FACILITIES MUST BE EITHER A FLUSHING TYPE OR APPROVED PORTABLE CHEMICAL CLOSET. CHEMICAL CLOSETS ARE TO BE MAINTAINED & SERVICED ON A REGULAR BASIS SO THAT OFFENSIVE ODOUR IS NOT EMITTED.
- DURING TRENCH EXCAVATION ALL SOIL SHALL BE MOUNDING ON THE UPHILL SIDE OF TRENCHES AND PLACEMENT IS TO COMPLY WITH THE SUPERINTENDENTS REQUIREMENT.
- DIVERSION BANKS SHOULD BE CONSTRUCTED BY MOUNDING STRIPPED TOPSOIL (MIN HEIGHT 600mm) WHERE DIRECTED. MATERIAL TO BE RESPREAD ON FOOTWAYS AFTER FINAL TRIMMING.
- UNDISTURBED BUFFER ZONE AREAS ARE CLOSED TO ALL TRAFFIC MOVEMENTS UNLESS OTHERWISE NOTED BY THE SUPERINTENDENT AND ACCESS TO THE SEWER OR C.D.L. TRENCHING WILL BE AS SHOWN, OR HEAVY PENALTIES MAY BE IMPOSED.
- TRAFFIC MANAGEMENT MEASURES ARE REQUIRED TO BE IMPLEMENTED AND MAINTAINED DURING CONSTRUCTION IN ACCORDANCE WITH R.T.A. TRAFFIC CONTROL AT WORK SITES - CURRENT EDITION AND AS 1742 'MANUAL OF UNIFORM TRAFFIC CONTROL DEVICES.'
- PEDESTRIAN CONTROL MEASURES ARE REQUIRED TO BE IMPLEMENTED AND MAINTAINED DURING CONSTRUCTION. IN ACCORDANCE WITH AS 1742 'MANUAL OF UNIFORM TRAFFIC CONTROL DEVICES.'

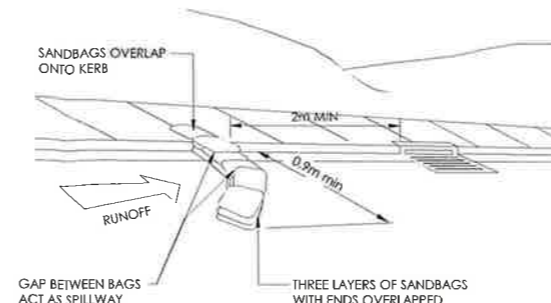

KERB SANDBAG SEDIMENT TRAP DETAIL

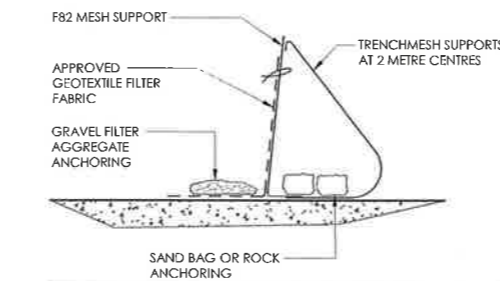

- GENERAL CONSTRUCTION NOTES:**
- CONSTRUCT SEDIMENT FENCE AS CLOSE AS POSSIBLE TO PARALLEL TO THE CONTOURS OF THE SITE.
 - FIX SELF-SUPPORTING GEOTEXTILE TO UPSLOPE SIDE OF POSTS WITH WIRE TIES OR AS RECOMMENDED BY GEOTEXTILE MANUFACTURER.
 - JOIN SECTIONS OF FABRIC AT A SUPPORT WITH A 150mm OVERLAP.
 - REFER TO DETAIL SD 6-9 'BLUE BOOK'

SILT FENCE DETAIL

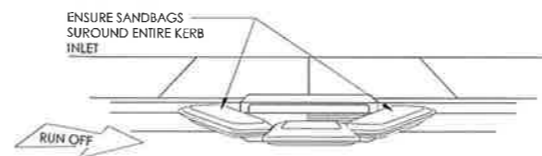

- NOTES:**
- FABRICATE A SLEEVE MADE FROM GEOTEXTILE OR WIRE MESH LONGER THAN THE LENGTH OF THE INLET PIT.
 - FILL THE SLEEVE WITH 25mm TO 50mm GRAVEL.
 - FORM AN ELLIPTICAL CROSS SECTION ABOUT 150mm HIGH X 400mm WIDE.
 - PLACE THE FILTER AT THE OPENING OF THE KERB INLET LEAVING A 100mm GAP AT THE TOP TO ACT AS AN EMERGENCY SPILL WAY.
 - MAINTAIN A CLEAR DISTANCE AWAY FROM THE PIT WITH SPACER BLOCKS.
 - FORM A SEAL WITH THE KERBING AND PREVENT SEDIMENT BYPASSING THE FILTER.
 - FIT TO ALL KERB INLETS AS SHOWN.

KERB INLET SANDBAG SEDIMENT TRAP DETAIL



CLIENT
 NBR8

STATUS
 PRELIMINARY

THIS DOCUMENT IS ISSUED BY JONES NICHOLSON Pty. Ltd (AS/NZS 1901:2011) AND IS SUBJECT TO THE RELEVANT CONTRACT BETWEEN JONES NICHOLSON Pty. Ltd AND ITS CLIENT. THE SCOPE AND INFORMATION CONTAINED IN THIS DOCUMENT ARE THE SOLE PROPERTY OF JONES NICHOLSON Pty. Ltd. USE OR COPYING OF THIS DOCUMENT WITHOUT WRITTEN PERMISSION OF JONES NICHOLSON Pty. Ltd. CONSTITUTES AN INFRINGEMENT OF COPYRIGHT.

DISCIPLINE
 CIVIL DESIGN

DRAWING TITLE
 NOTES, LEGEND & DETAILS

PROJECT
 MANLY CORSO APARTMENTS
 REFURBISHMENT & ADDITIONS

ADDRESS
 S.P. 12989
 19-21 THE CORSO, MANLY

PROJECT DETAILS
 DESIGN DRAWN 19010126
 DATE
 DRG SIZE A1
 SCALE As indicated
 PROJECT
 MGR
 WWW.JN.CO.NZ
ESM1 1

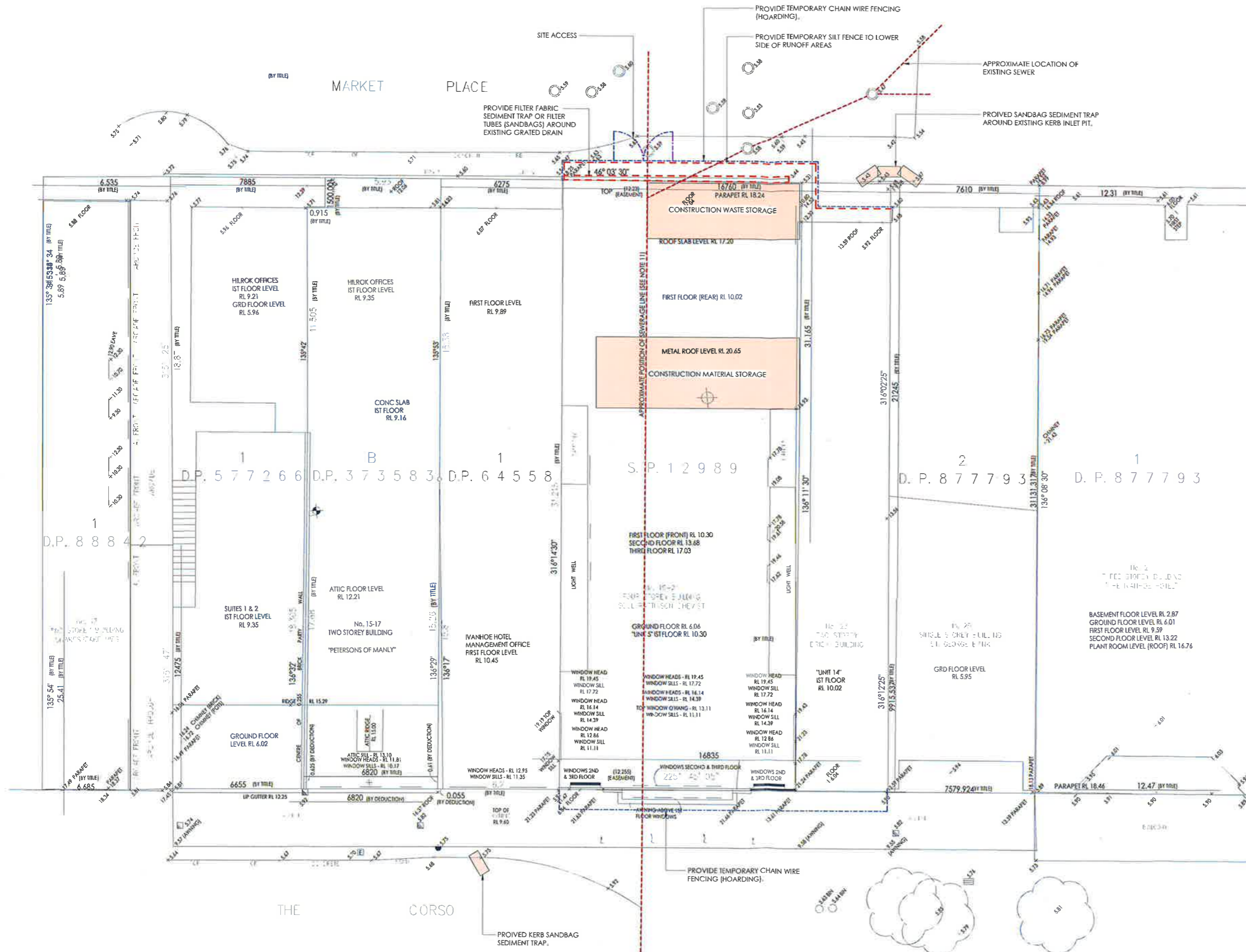

CLIENT
NBR8

STATUS
PRELIMINARY

DISCIPLINE
CIVIL DESIGN

DRAWING TITLE
ESM PLAN

PROJECT
**MANLY CORSO APARTMENTS
 REFURBISHMENT & ADDITIONS**

ADDRESS
**S.P. 12989
 19-21 THE CORSO, MANLY**

PROJECT DETAILS
 DESIGN
 DRAWN
 DATE
 DRG SIZE A1
 SCALE 1 : 100
 PROJECT
 MGR
 WWW.JN.COM.AU

**19010126
 ESM2 1**

