

DEVELOPMENT APPLICATION ASSESSMENT REPORT

Application Number:	DA2021/0133
----------------------------	-------------

Responsible Officer:	Thomas Prosser
Land to be developed (Address):	Lot 102 DP 605991, 62 Hudson Parade CLAREVILLE NSW 2107
Proposed Development:	Alterations and additions to a Dwelling House
Zoning:	E4 Environmental Living
Development Permissible:	Yes
Existing Use Rights:	No
Consent Authority:	Northern Beaches Council
Delegation Level:	DDP
Land and Environment Court Action:	No
Owner:	Michael Anthony Still
Applicant:	Catherine Finlay

Application Lodged:	25/02/2021
Integrated Development:	No
Designated Development:	No
State Reporting Category:	Residential - Alterations and additions
Notified:	09/03/2021 to 23/03/2021
Advertised:	Not Advertised
Submissions Received:	1
Clause 4.6 Variation:	4.3 Height of buildings: 10.6%
Recommendation:	Approval

Estimated Cost of Works:	\$ 642,000.00
---------------------------------	---------------

EXECUTIVE SUMMARY

Development Application (DA2021/0133) proposes alterations and additions to the existing dwelling. The additions involve a first floor extension which does not comply with the development standard for building height.

The application is referred to the Development Determination Panel as the proposal has a variation to the development standard for building height of greater than 10%. In this regard the variation is 10.6% (being 9.4m).

Public exhibition of the development resulted in one objection to the proposal. The objection raised a privacy concerns, particularly in regard to overlooking between the neighbouring properties.

Conditions have been imposed to provide opaque windows (W9, W10 and W11), and to provide a privacy screen to the south western side elevation of the balcony.

Accordingly, the application is referred to the DDP with a recommendation for approval subject to conditions.

PROPOSED DEVELOPMENT IN DETAIL

The proposal is for alterations and additions to the existing dwelling. In detail, this involves:

Lower Ground Floor

- Move wall of bedroom 4 to provide to a built-in robe

Ground Floor

- Reconfigure existing entry
- Remove bedroom 3
- New robe to bedroom 2
- New door provided from entry in to kitchen
- New cupboard
- Extension of dining area and new storage area
- Alteration to existing stair

Proposed First Floor Level

- New master bedroom with ensuite and robe
- A new study
- A balcony
- New chimney

Garage

- Reclad the roof of the garage

ASSESSMENT INTRODUCTION

The application has been assessed in accordance with the requirements of the Environmental Planning and Assessment Act 1979 and the associated Regulations. In this regard:

- An assessment report and recommendation has been prepared (the subject of this report) taking into account all relevant provisions of the Environmental Planning and Assessment Act 1979, and the associated regulations;

- A site inspection was conducted and consideration has been given to the impacts of the development upon the subject site and adjoining, surrounding and nearby properties;
- Notification to adjoining and surrounding properties, advertisement (where required) and referral to relevant internal and external bodies in accordance with the Act, Regulations and relevant Development Control Plan;
- A review and consideration of all submissions made by the public and community interest groups in relation to the application;
- A review and consideration of all documentation provided with the application (up to the time of determination);
- A review and consideration of all referral comments provided by the relevant Council Officers, State Government Authorities/Agencies and Federal Government Authorities/Agencies on the proposal.

SUMMARY OF ASSESSMENT ISSUES

Pittwater Local Environmental Plan 2014 - 4.6 Exceptions to development standards

Pittwater 21 Development Control Plan - C1.5 Visual Privacy

SITE DESCRIPTION

Property Description:	Lot 102 DP 605991 , 62 Hudson Parade CLAREVILLE NSW 2107
Detailed Site Description:	<p>The subject site consists of an allotment located on the western side of Hudson Parade.</p> <p>The site is irregular in shape with an approximate frontage of 44m along Hudson Parade and a depth of 81m. The site has a surveyed area of 1143m².</p> <p>The site is located within the E4 Environmental Living zone and accommodates a dwelling house on site.</p> <p>The site slopes down to the Pittwater and contains vegetation across the site.</p> <p>Detailed Description of Adjoining/Surrounding Development</p> <p>Adjoining and surrounding development is characterised by <describe the built form of the surrounding area>.</p>

Map:



SITE HISTORY

The land has been used for residential purposes for an extended period of time. A search of Council's records has revealed the following relevant history:

- A one and two storey sole occupancy weatherboard dwelling with a metal roof together with a detached timber garage. NOTE: First floor rear deck balustrades do not comply with Part 3.9.2 of the Building Code of Australia and are excluded from this certificate. This was approved on 15 April 2008.

As a part of the above BC report, cooking facilities were to be removed from the bottom ground floor area to ensure the building could not be used as a dual occupancy. To further confirm this, and as a result of the further works in this area, a condition is imposed to restrict the use of the area to be a single dwelling only.

ENVIRONMENTAL PLANNING AND ASSESSMENT ACT, 1979 (EPAA)

The relevant matters for consideration under the Environmental Planning and Assessment Act, 1979, are:

Section 4.15 Matters for Consideration'	Comments
Section 4.15 (1) (a)(i) – Provisions of any environmental planning instrument	See discussion on "Environmental Planning Instruments" in this report.
Section 4.15 (1) (a)(ii) – Provisions of any draft environmental planning instrument	Draft State Environmental Planning Policy (Remediation of Land) seeks to replace the existing SEPP No. 55 (Remediation of Land). Public consultation on the draft policy was completed on 13 April 2018. The subject site has been used for residential purposes for an extended period of time. The proposed development retains the residential use of the site, and is not considered a contamination

Section 4.15 Matters for Consideration'	Comments
	risk.
Section 4.15 (1) (a)(iii) – Provisions of any development control plan	Pittwater Development Control Plan applies to this proposal.
Section 4.15 (1) (a)(iiia) – Provisions of any planning agreement	None applicable.
Section 4.15 (1) (a)(iv) – Provisions of the Environmental Planning and Assessment Regulation 2000 (EP&A Regulation 2000)	<p><u>Division 8A</u> of the EP&A Regulation 2000 requires the consent authority to consider "Prescribed conditions" of development consent. These matters have been addressed via a condition of consent.</p> <p><u>Clause 92</u> of the EP&A Regulation 2000 requires the consent authority to consider AS 2601 - 1991: The Demolition of Structures. This matter has been addressed via a condition of consent.</p> <p><u>Clauses 93 and/or 94</u> of the EP&A Regulation 2000 requires the consent authority to consider the upgrading of a building (including fire safety upgrade of development). This clause is not relevant to this application.</p> <p><u>Clause 98</u> of the EP&A Regulation 2000 requires the consent authority to consider insurance requirements under the Home Building Act 1989. This clause is not relevant to this application.</p> <p><u>Clause 98</u> of the EP&A Regulation 2000 requires the consent authority to consider the provisions of the Building Code of Australia (BCA). This matter has been addressed via a condition of consent.</p>
Section 4.15 (1) (b) – the likely impacts of the development, including environmental impacts on the natural and built environment and social and economic impacts in the locality	<p>(i) Environmental Impact The environmental impacts of the proposed development on the natural and built environment are addressed under the Pittwater Development Control Plan section in this report.</p> <p>(ii) Social Impact The proposed development will not have a detrimental social impact in the locality considering the character of the proposal.</p> <p>(iii) Economic Impact The proposed development will not have a detrimental economic impact on the locality considering the nature of the existing and proposed land use.</p>
Section 4.15 (1) (c) – the suitability of the site for the development	The site is considered suitable for the proposed development.
Section 4.15 (1) (d) – any submissions made in accordance with the EPA Act or EPA Regs	See discussion on "Notification & Submissions Received" in this report.
Section 4.15 (1) (e) – the public	No matters have arisen in this assessment that would justify the

Section 4.15 Matters for Consideration'	Comments
interest	refusal of the application in the public interest.

EXISTING USE RIGHTS

Existing Use Rights are not applicable to this application.

BUSHFIRE PRONE LAND

The site is not classified as bush fire prone land.

NOTIFICATION & SUBMISSIONS RECEIVED

The subject development application has been publicly exhibited from 09/03/2021 to 23/03/2021 in accordance with the Environmental Planning and Assessment Act 1979, Environmental Planning and Assessment Regulation 2000 and the Community Participation Plan.

As a result of the public exhibition process council is in receipt of 1 submission/s from:

Name:	Address:
Ochoa Pty Ltd Rodney Higgins Patricia Higgins	66 Lucretia Avenue LONGUEVILLE NSW 2066

The matters raised within the submissions are addressed as follows:

- Concern regarding large balcony for a master bedroom causing privacy impact
Comment:
The proposed balcony complies with the controls for setback and side boundary envelope. A condition is also recommended for a privacy screen to be provided along the south-western side elevation of the balcony. This provides an outcome in which the privacy impact will be minimise so that the the design, size, and location of the balcony is reasonable.
- Privacy concerns with windows, W8, W9, W10 and W11.
Comment:
A condition is imposed for W9, W10, and W11 to be opaque. As W8 does not directly face a side boundary, there is no requirement for a design change this window. This provides a reasonable balance between protecting privacy and providing view sharing.

REFERRALS

Internal Referral Body	Comments
Environmental Health (Solid Fuel/Oil Heater)	General Comments Environmental Health has been requested to provide comment on this proposal for "Alterations and additions to a Dwelling House",

Internal Referral Body	Comments
	<p>specifically in relation to the installation of a solid fuel heating appliance.</p> <p>The plans supplied with the proposal documentation note the inclusion of a fireplace (FP) and the extension of the chimney to comply with Australian Standards.</p> <p>No other details of the make, model or specification of the heater to be installed have been supplied.</p> <p>Accordingly, Environmental Health does not support the application at this time.</p> <p><u>Assessing officer comment</u></p> <p>The applicant has provided that the fire place is existing. As such, a condition is imposed that this application does not involve any new fireplace (and this is subject to a separate consent).</p>
Landscape Officer	<p>This application is for the minor alterations and additions to an existing residential dwelling. Proposed alterations include minor internal layout changes to create a more open entry, with additional robe and storage space to other rooms, with additions inclusive on a new level which is to accommodate a new master bedroom, robe, en-suite, study and new balcony.</p> <p>Councils Landscape Referral section has considered the application against the Pittwater Local Environment Plan, and the following Pittwater 21 DCP controls:</p> <ul style="list-style-type: none"> • B4.22 Preservation of Trees and Bushland Vegetation • C1.1 Landscaping • D1.14 Landscaped Area - Environmentally Sensitive Land <p>The Statement of Environmental Effects provided with the application notes that no existing trees or vegetation are to be removed as a result of the proposed works. This is confirmed in the Architectural Plans as no trees have been noted or indicated as removed. This is mostly a result of the proposed alterations and additions be largely located within the existing footprint of the dwelling. Any additions proposed outside of the original footprint are within existing paved areas, and therefore will not impede into existing landscape areas. Although the proposed works are limited to the building footprint, care and consideration should still be made to ensure the protection of existing trees within the site and road reserve. This is particularly important during the transportation of materials to and from site.</p> <p>The retention of existing trees on site is necessary to satisfy controls B4.22 and D1.14, as key objectives of these controls include "to protect and enhance the scenic value and character that trees and/or bushland vegetation provide", and "to preserve and enhance the rural and bushland character of the area".</p> <p>The Architectural Plans indicate that an additional four trees or plants</p>

Internal Referral Body	Comments
	<p>are proposed within the front yard as part of new landscaping. All new trees, and at least 50% of other proposed vegetation shall be locally native species in order to satisfy control C1.1.</p> <p>The landscape component of the proposal is therefore accepted subject to the protection of existing trees, and the use of locally native species for all proposed vegetation.</p>
NECC (Bushland and Biodiversity)	<p>Council's biodiversity referrals team have assessed the Development Application for compliance against the following applicable biodiversity provisions:</p> <ul style="list-style-type: none"> • Pittwater LEP cl. 7.6 Biodiversity Protection • Pittwater 21 DCP cl. B4.7 Pittwater Spotted Gum Forest - Endangered Ecological Community • Coastal Management SEPP (2018) cl. 13 Development on land within the coastal environment area <p>The Statement of Environmental Effects submitted with the Development Application states that as all alterations and additions are to be confined within the footprint of the existing building and no branches overhang the roof of the house, the proposal will not impact on existing vegetation. As such, there will be no impacts to Pittwater Spotted Gum Forest EEC within the site.</p> <p>The site analysis and landscape plan identifies that an additional four (4) trees will be planted within the site. All trees and at least 80% of any new planting must incorporate native vegetation as per species listed in Pittwater Spotted Gum Endangered Ecological Community in order to comply with P21DCP cl. B4.7.</p> <p>Subject to these conditions of consent, Council's biodiversity referrals team are satisfied that the proposed development complies with the above listed provisions.</p>
NECC (Coast and Catchments)	<p>The application has been assessed in consideration of the Coastal Management Act 2016, State Environmental Planning Policy (Coastal Management) 2018 and has also been assessed against requirements of the Pittwater LEP 2014 and Pittwater 21 DCP.</p> <p>Coastal Management Act 2016 The subject site has been identified as being within the coastal zone and therefore <i>Coastal Management Act 2016</i> is applicable to the proposed development.</p> <p>The proposed development is in line with the objects, as set out under Clause 3 of the <i>Coastal Management Act 2016</i>.</p> <p>State Environmental Planning Policy (Coastal Management) 2018</p>

Internal Referral Body	Comments
	<p>The subject land has been included on the 'Coastal Environment Area' and 'Coastal Use Area' maps under the State Environmental Planning Policy (Coastal Management) 2018 (CM SEPP). Hence, Clauses 13, 14 and 15 of the CM SEPP apply for this DA.</p> <p>Comment:</p> <p>On internal assessment and as assessed in the submitted Statement of Environmental Effects (SEE) report prepared by DCBF Pty. Ltd. dated February 2021, the DA satisfies requirements under clauses 13, 14 and 15 of the CM SEPP.</p> <p>As such, it is considered that the application does comply with the requirements of the State Environmental Planning Policy (Coastal Management) 2018.</p> <p>Pittwater LEP 2014 and Pittwater 21 DCP</p> <p>Estuarine Risk Management</p> <p>The subject property has also been identified as affected by estuarine wave action and tidal inundation on Council's Estuarine Hazard Mapping. As such, the Estuarine Risk Management Policy for Development in Pittwater (Appendix 7, Pittwater 21 DCP) and the relevant B3.7 Estuarine Hazard Controls will apply to any proposed development of the site.</p> <p>On internal assessment and as justified in the submitted Statement of Environmental Effects (SEE) report prepared by DCBF Pty. Ltd. dated February 2021, the proposed additions and alterations is above the applicable EPL for the site. The proposed development is therefore not required to satisfy the relevant estuarine risk management requirements of P21 DCP.</p> <p>Development on Foreshore Area</p> <p>A large section of the subject property is within the foreshore building line. Part 7, Clause 7.8 –Limited development on foreshore area of the Pittwater LEP 2014 applies for any development within the foreshore area.</p>

Internal Referral Body	Comments
	The DA proposes no works on the foreshores area and hence, the DA does not require to satisfy the objectives and requirements of Part 7, Clause 7.8 of the Pittwater LEP 2014.

External Referral Body	Comments
Ausgrid: (SEPP Infra.)	The proposal was referred to Ausgrid who provided a response stating that the proposal is acceptable subject to compliance with the relevant Ausgrid Network Standards and SafeWork NSW Codes of Practice. These recommendations will be included as a condition of consent.

ENVIRONMENTAL PLANNING INSTRUMENTS (EPIs)*

All, Environmental Planning Instruments (SEPPs, REPs and LEPs), Development Controls Plans and Council Policies have been considered in the merit assessment of this application.

In this regard, whilst all provisions of each Environmental Planning Instruments (SEPPs, REPs and LEPs), Development Controls Plans and Council Policies have been considered in the assessment, many provisions contained within the document are not relevant or are enacting, definitions and operational provisions which the proposal is considered to be acceptable against.

As such, an assessment is provided against the controls relevant to the merit consideration of the application hereunder.

State Environmental Planning Policies (SEPPs) and State Regional Environmental Plans (SREPs)

SEPP 55 - Remediation of Land

Clause 7 (1) (a) of SEPP 55 requires the Consent Authority to consider whether land is contaminated. Council records indicate that the subject site has been used for residential purposes for a significant period of time with no prior land uses. In this regard it is considered that the site poses no risk of contamination and therefore, no further consideration is required under Clause 7 (1) (b) and (c) of SEPP 55 and the land is considered to be suitable for the residential land use.

SEPP (Building Sustainability Index: BASIX) 2004

A BASIX certificate has been submitted with the application (see Certificate No. A405883).

A condition has been included in the recommendation of this report requiring compliance with the commitments indicated in the BASIX Certificate.

SEPP (Infrastructure) 2007

Ausgrid

Clause 45 of the SEPP requires the Consent Authority to consider any development application (or an application for modification of consent) for any development carried out:

- within or immediately adjacent to an easement for electricity purposes (whether or not the electricity infrastructure exists).
- immediately adjacent to an electricity substation.
- within 5.0m of an overhead power line.
- includes installation of a swimming pool any part of which is: within 30m of a structure supporting an overhead electricity transmission line and/or within 5.0m of an overhead electricity power line.

Comment:

The proposal was referred to Ausgrid who provided a response stating that the proposal is acceptable subject to compliance with the relevant Ausgrid Network Standards and SafeWork NSW Codes of Practice. These recommendations will be included as a condition of consent.

SEPP (Coastal Management) 2018

11 Development on land in proximity to coastal wetlands or littoral rainforest

(1) Development consent must not be granted to development on land identified as “proximity area for coastal wetlands” or “proximity area for littoral rainforest” on the Coastal Wetlands and Littoral Rainforests Area Map unless the consent authority is satisfied that the proposed development will not significantly impact on:

(a) the biophysical, hydrological or ecological integrity of the adjacent coastal wetland or littoral rainforest, or

(b) the quantity and quality of surface and ground water flows to and from the adjacent coastal wetland or littoral rainforest.

Comment:

The alterations and additions have a relatively large setback to Pittwater. This physical separation ensures there would be no significant impact.

12 Development on land within the coastal vulnerability area

Development consent must not be granted to development on land that is within the area identified as “coastal vulnerability area” on the Coastal Vulnerability Area Map unless the consent authority is satisfied that:

(a) if the proposed development comprises the erection of a building or works—the building or works are engineered to withstand current and projected coastal hazards for the design life of the building or works, and

(b) the proposed development:

(i) is not likely to alter coastal processes to the detriment of the natural environment or other land, and
(ii) is not likely to reduce the public amenity, access to and use of any beach, foreshore, rock platform or headland adjacent to the proposed development, and

(iii) incorporates appropriate measures to manage risk to life and public safety from coastal hazards, and

(c) measures are in place to ensure that there are appropriate responses to, and management of, anticipated coastal processes and current and future coastal hazards.

Comment:

The proposal will not have a detrimental impact on the above and is not likely to alter coastal processes. This is a result of the lack of additional bulk proposed and the physical separation of the site from the coast.

13 Development on land within the coastal environment area

(1) Development consent must not be granted to development on land that is within the coastal environment area unless the consent authority has considered whether the proposed development is likely to cause an adverse impact on the following:

- (a) the integrity and resilience of the biophysical, hydrological (surface and groundwater) and ecological environment,*
- (b) coastal environmental values and natural coastal processes,*
- (c) the water quality of the marine estate (within the meaning of the Marine Estate Management Act 2014), in particular, the cumulative impacts of the proposed development on any of the sensitive coastal lakes identified in Schedule 1,*
- (d) marine vegetation, native vegetation and fauna and their habitats, undeveloped headlands and rock platforms,*
- (e) existing public open space and safe access to and along the foreshore, beach, headland or rock platform for members of the public, including persons with a disability,*
- (f) Aboriginal cultural heritage, practices and places,*
- (g) the use of the surf zone.*

Comment:

The proposal will not have an adverse impact on the above as the proposed works do not involve excavation, substantial addition of bulk, or any other change to the natural environment which could cause an unreasonable impact on the coastal environment area.

(2) Development consent must not be granted to development on land to which this clause applies unless the consent authority is satisfied that:

- (a) the development is designed, sited and will be managed to avoid an adverse impact referred to in subclause (1), or*
- (b) if that impact cannot be reasonably avoided—the development is designed, sited and will be managed to minimise that impact, or*
- (c) if that impact cannot be minimised—the development will be managed to mitigate that impact.*

Comment:

The proposal retains the siting of the existing dwelling which is well separated from the coast. This physical separation from the coastline along with the proposed works being maintained within the existing siting, provides a circumstance in which potential impact is sufficiently minimised.

As such, it is considered that the application complies with the requirements of the State Environmental Planning Policy (Coastal Management) 2018.

Pittwater Local Environmental Plan 2014

Is the development permissible?	Yes
After consideration of the merits of the proposal, is the development consistent with:	
aims of the LEP?	Yes
zone objectives of the LEP?	Yes

Principal Development Standards

Standard	Requirement	Proposed	% Variation	Complies
Height of Buildings:	8.5m	9.4m	10.6	No (see comments)

Compliance Assessment

Clause	Compliance with Requirements
1.9A Suspension of covenants, agreements and instruments	Yes
4.3 Height of buildings	No
4.6 Exceptions to development standards	Yes
5.10 Heritage conservation	Yes
7.1 Acid sulfate soils	Yes
7.2 Earthworks	Yes
7.6 Biodiversity protection	Yes
7.7 Geotechnical hazards	Yes
7.8 Limited development on foreshore area	Yes
7.10 Essential services	Yes

Detailed Assessment

4.6 Exceptions to development standards

Description of non-compliance:

Development standard:	Height of buildings
Requirement:	8.5m
Proposed:	9.4m
Percentage variation to requirement:	10.6%

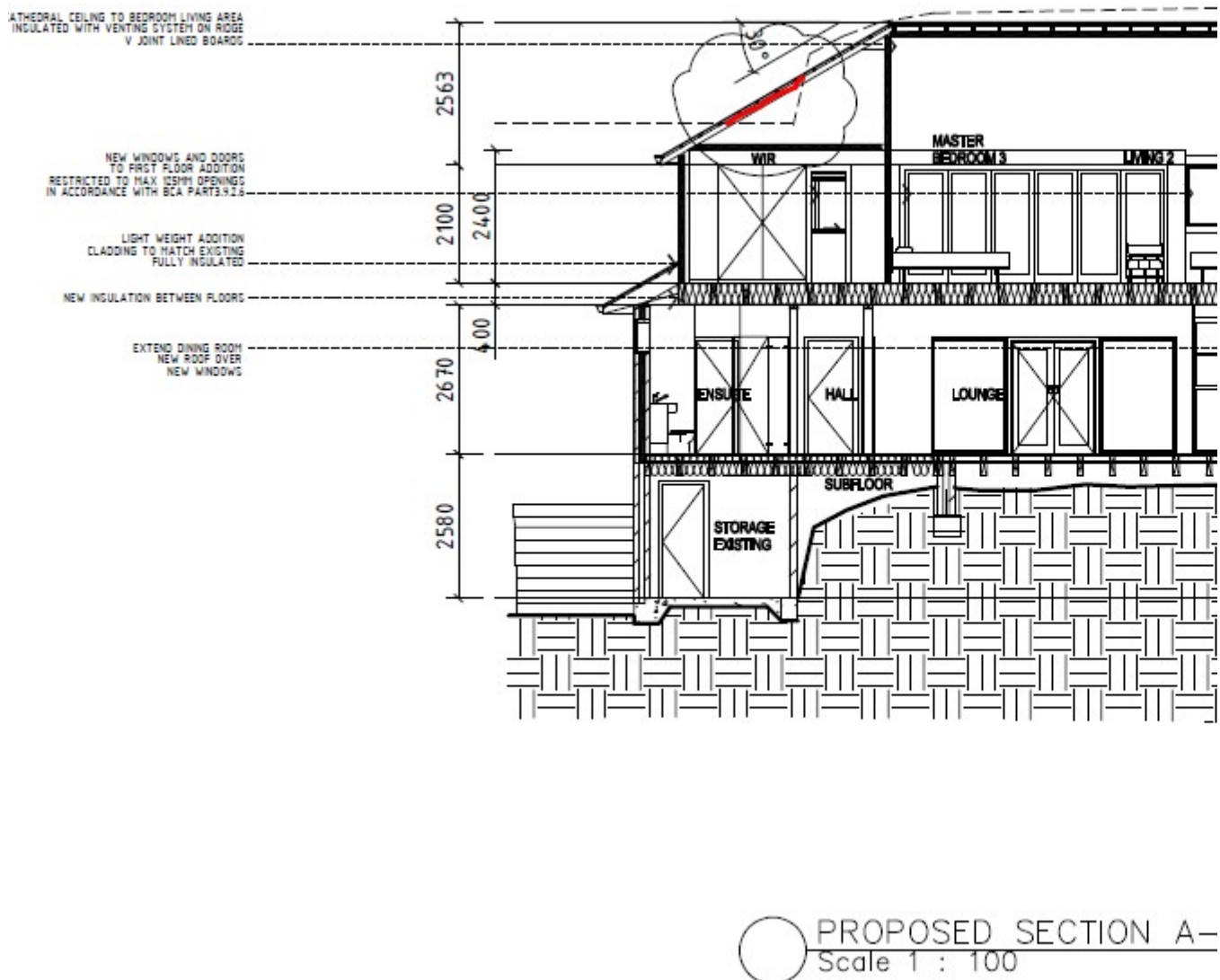

Figure 1: Line highlighted in red for section of height non-compliance

Assessment of request to vary a development standard:

The following assessment of the variation to Clause 4.3 - Height of Buildings development standard, has taken into consideration the recent judgement contained within *Initial Action Pty Ltd v Woollahra Municipal Council* [2018] NSWLEC 118, *Baron Corporation Pty Limited v Council of the City of Sydney* [2019] NSWLEC 61, and *RebelMH Neutral Bay Pty Limited v North Sydney Council* [2019] NSWCA 130.

Clause 4.6 Exceptions to development standards:

(1) *The objectives of this clause are as follows:*

- (a) *to provide an appropriate degree of flexibility in applying certain development standards to particular development,*
- (b) *to achieve better outcomes for and from development by allowing flexibility in particular circumstances.*

(2) Development consent may, subject to this clause, be granted for development even though the development would contravene a development standard imposed by this or any other environmental planning instrument. However, this clause does not apply to a development standard that is expressly excluded from the operation of this clause.

Comment:

Clause 4.3 - Height of Buildings development standard is not expressly excluded from the operation of this clause.

(3) Development consent must not be granted for development that contravenes a development standard unless the consent authority has considered a written request from the applicant that seeks to justify the contravention of the development standard by demonstrating:

(a) that compliance with the development standard is unreasonable or unnecessary in the circumstances of the case, and

(b) that there are sufficient environmental planning grounds to justify contravening the development standard.

(4) Development consent must not be granted for development that contravenes a development standard unless:

(a) the consent authority is satisfied that:

(i) the applicant's written request has adequately addressed the matters required to be demonstrated by subclause (3), and

(ii) the proposed development will be in the public interest because it is consistent with the objectives of the particular standard and the objectives for development within the zone in which the development is proposed to be carried out, and

(b) the concurrence of the Secretary has been obtained.

Clause 4.6 (4)(a)(i) (Justification) assessment:

Clause 4.6 (4)(a)(i) requires the consent authority to be satisfied that the applicant's written request, seeking to justify the contravention of the development standard, has adequately addressed the matters required to be demonstrated by cl 4.6(3). There are two separate matters for consideration contained within cl 4.6(3) and these are addressed as follows:

(a) that compliance with the development standard is unreasonable or unnecessary in the circumstances of the case, and

Comment:

The Applicant's written request (attached to this report as an Appendix) has demonstrated that the objectives of the development standard are achieved, notwithstanding the non-compliance with the development standard.

In doing so, the Applicant's written request has adequately demonstrated that compliance with the development standard is unreasonable or unnecessary in the circumstances of this case as required by cl 4.6(3)(a).

(b) that there are sufficient environmental planning grounds to justify contravening the development standard.

Comment:

In the matter of Initial Action Pty Ltd v Woollahra Municipal Council [2018] NSWLEC 118, Preston CJ provides the following guidance (para 23) to inform the consent authority's finding that the applicant's written request has adequately demonstrated that there are sufficient environmental planning grounds to justify contravening the development standard:

'As to the second matter required by cl 4.6(3)(b), the grounds relied on by the applicant in the written request under cl 4.6 must be "environmental planning grounds" by their nature: see Four2Five Pty Ltd v Ashfield Council [2015] NSWLEC 90 at [26]. The adjectival phrase "environmental planning" is not defined, but would refer to grounds that relate to the subject matter, scope and purpose of the EPA Act, including the objects in s 1.3 of the EPA Act.'

s 1.3 of the EPA Act reads as follows:

1.3 Objects of Act(cf previous s 5)

The objects of this Act are as follows:

- (a) to promote the social and economic welfare of the community and a better environment by the proper management, development and conservation of the State's natural and other resources,*
- (b) to facilitate ecologically sustainable development by integrating relevant economic, environmental and social considerations in decision-making about environmental planning and assessment,*
- (c) to promote the orderly and economic use and development of land,*
- (d) to promote the delivery and maintenance of affordable housing,*
- (e) to protect the environment, including the conservation of threatened and other species of native animals and plants, ecological communities and their habitats,*
- (f) to promote the sustainable management of built and cultural heritage (including Aboriginal cultural heritage),*
- (g) to promote good design and amenity of the built environment,*
- (h) to promote the proper construction and maintenance of buildings, including the protection of the health and safety of their occupants,*
- (i) to promote the sharing of the responsibility for environmental planning and assessment between the different levels of government in the State,*
- (j) to provide increased opportunity for community participation in environmental planning and assessment.*

The applicants written request argues, in part:

The area of non-compliance is minor and occurs at a section of the site that is down slope. Further, the pitched roof style would complement the existing form of the dwelling so as to provide a better visual presentation than a flat roof.

It is agreed that the non-compliance is caused partly by the slope of the site, and that the design of a sloped roof provides visual presentation that complements with the existing built form.

In this regard, the applicant's written request has demonstrated that the proposed development is an orderly and economic use and development of the land, and that the structure is of a good design that will reasonably protect and improve the amenity of the surrounding built environment, therefore satisfying cls 1.3 (c) and (g) of the EPA Act.

Therefore, the applicant's written request has adequately demonstrated that there are sufficient environmental planning grounds to justify contravening the development standard as required by cl 4.6 (3)(b).

Therefore, Council is satisfied that the applicant's written request has adequately addressed the

matters required to be demonstrated by cl 4.6(3).

Clause 4.6 (4)(a)(ii) (Public Interest) assessment:

cl 4.6 (4)(a)(ii) requires the consent authority to be satisfied that:

(ii) the proposed development will be in the public interest because it is consistent with the objectives of the particular standard and the objectives for development within the zone in which the development is proposed to be carried out

Comment:

In considering whether or not the proposed development will be in the public interest, consideration must be given to the underlying objectives of the Height of Buildings development standard and the objectives of the R2 Low Density Residential zone. An assessment against these objectives is provided below.

Objectives of development standard

The underlying objectives of the standard, pursuant to Clause 4.3 – ‘Height of buildings’ of the PLEP 2014 are:

(1) The objectives of this clause are as follows:

a) to ensure that any building, by virtue of its height and scale, is consistent with the desired character of the locality,

Comment:

The proposal involves a dwelling that steps down with the topography of the site, and has a proposed top level that is well articulated and stepped back from the lower levels. This provides a situation in which the proposed building would be consistent with the desired character of the locality.

b) to ensure that buildings are compatible with the height and scale of surrounding and nearby development,

Comment:

The proposed dwelling steps down with the topography of the site so that the bulk at the rear of the site would complement nearby development, and also be compatible so as to have no unreasonable impact on surrounding amenity.

c) to minimise any overshadowing of neighbouring properties,

Comment:

The dwelling provides sufficient setbacks to the upper level to ensure that the development complies with the requirements under C1.4 Solar Access of the Pittwater DCP.

d) to allow for the reasonable sharing of views,

Comment:

The proposal has compliant rear setback and sufficient setting back of the top level to ensure there would be no unreasonable impact on views.

e) to encourage buildings that are designed to respond sensitively to the natural topography,

Comment:

The proposal involves a roof design at the rear that generally corresponds in angle with the slope of the land. Along with the lack of significant excavation, This provides a situation in which the development responds appropriately to the topography of the land.

f) to minimise the adverse visual impact of development on the natural environment, heritage conservation areas and heritage items,

Comment:

The proposed additions are well setback from Pittwater, and the proposal maintains a total landscaped area that complies with the numerical control under the DCP. As such, the alterations and additions will not provide any adverse visual impact on the environment or surroundings.

Zone objectives

The underlying objectives of the E4 Environmental Living zone are:

- *To provide for low-impact residential development in areas with special ecological, scientific or aesthetic values.*
To ensure that residential development does not have an adverse effect on those values.
To provide for the continuance of a limited range of existing small-scale water-related business and leisure uses.
To ensure that development, by way of its character, design, location and materials of construction, is integrated into the site and natural surroundings, complements and enhances the natural environment and has minimal visual impact.
To protect and enhance the natural landscape by conserving remnant bushland and rock outcrops and by encouraging the spread of an indigenous tree canopy.

Comment:

The proposal provides alterations and additions to a residential development that will not have any unreasonable impact on the environmental values, uses or character of the area. This is due to the compliant landscaping maintained, and the sufficient minimisation of building bulk (through articulation and stepping).

Conclusion:

For the reasons detailed above, the proposal is considered to be consistent with the objectives of the E4 Environmental Living zone.

Clause 4.6 (4)(b) (Concurrence of the Secretary) assessment:

cl. 4.6(4)(b) requires the concurrence of the Secretary to be obtained in order for development consent

to be granted.

Planning Circular PS 18-003 dated 21 February 2018, as issued by the NSW Department of Planning, advises that the concurrence of the Secretary may be assumed for exceptions to development standards under environmental planning instruments that adopt Clause 4.6 of the Standard Instrument. In this regard, given the consistency of the variation to the objectives of the zone, and in accordance with correspondence from the Deputy Secretary on 24 May 2019, Council staff under the delegation of the Development Determination Panel, may assume the concurrence of the Secretary for variations to the Height of building Development Standard associated with a single dwelling house (Class 1 building).

Pittwater 21 Development Control Plan

Built Form Controls

Built Form Control	Requirement	Proposed	% Variation*	Complies
Front building line	6.5m	6.5m (lower floor) 12.6m-15.6m (first floor)	N/A	Yes
Side building line	2.5m	2.5m	N/A	Yes
	1m	5m	N/A	Yes
Building envelope	3.5m	East: Within	N/A	Yes
	3.5m	West: Within	N/A	Yes
Landscaped area	60%	60%	N/A	Yes

Compliance Assessment

Clause	Compliance with Requirements	Consistency Aims/Objectives
A1.7 Considerations before consent is granted	Yes	Yes
A4.1 Avalon Beach Locality	Yes	Yes
B1.3 Heritage Conservation - General	Yes	Yes
B1.4 Aboriginal Heritage Significance	Yes	Yes
B3.1 Landslip Hazard	Yes	Yes
B3.6 Contaminated Land and Potentially Contaminated Land	Yes	Yes
B3.7 Estuarine Hazard - Low density residential	Yes	Yes
B3.8 Estuarine Hazard - Medium Density Residential	Yes	Yes
B4.7 Pittwater Spotted Gum Forest - Endangered Ecological Community	Yes	Yes
B4.15 Saltmarsh Endangered Ecological Community	Yes	Yes
B4.16 Seagrass Conservation	Yes	Yes
B4.19 Estuarine Habitat	Yes	Yes
B5.13 Development on Waterfront Land	Yes	Yes
B5.15 Stormwater	Yes	Yes
B6.1 Access driveways and Works on the Public Road Reserve	Yes	Yes
B6.2 Internal Driveways	Yes	Yes
B6.3 Off-Street Vehicle Parking Requirements	Yes	Yes

Clause	Compliance with Requirements	Consistency Aims/Objectives
B6.7 Transport and Traffic Management	Yes	Yes
B8.1 Construction and Demolition - Excavation and Landfill	Yes	Yes
B8.3 Construction and Demolition - Waste Minimisation	Yes	Yes
B8.4 Construction and Demolition - Site Fencing and Security	Yes	Yes
B8.5 Construction and Demolition - Works in the Public Domain	Yes	Yes
B8.6 Construction and Demolition - Traffic Management Plan	Yes	Yes
C1.1 Landscaping	Yes	Yes
C1.2 Safety and Security	Yes	Yes
C1.3 View Sharing	Yes	Yes
C1.4 Solar Access	Yes	Yes
C1.5 Visual Privacy	Yes	Yes
C1.6 Acoustic Privacy	Yes	Yes
C1.7 Private Open Space	Yes	Yes
C1.9 Adaptable Housing and Accessibility	Yes	Yes
C1.12 Waste and Recycling Facilities	Yes	Yes
C1.13 Pollution Control	Yes	Yes
C1.19 Incline Passenger Lifts and Stairways	Yes	Yes
C1.23 Eaves	Yes	Yes
C1.24 Public Road Reserve - Landscaping and Infrastructure	Yes	Yes
D1.1 Character as viewed from a public place	Yes	Yes
D1.5 Building colours and materials	Yes	Yes
D1.8 Front building line	Yes	Yes
D1.9 Side and rear building line	Yes	Yes
D1.11 Building envelope	Yes	Yes
D1.14 Landscaped Area - Environmentally Sensitive Land	Yes	Yes
D1.16 Fences - Flora and Fauna Conservation Areas	Yes	Yes
D1.17 Construction, Retaining walls, terracing and undercroft areas	Yes	Yes
D1.20 Scenic Protection Category One Areas	Yes	Yes

Detailed Assessment

C1.5 Visual Privacy

The following conditions are imposed to minimise potential for overlooking:

"Privacy Screen"

A privacy screen 1.7m in height is to be provided along the extent of the south-western side elevation of the balcony.

Details are to be provided prior to the issue of a Construction Certificate.

Reason: To minimise privacy impact caused by overlooking."

"Opaque Windows

Windows W9, W10 and W11 are to be wholly opaque and fixed.

Details are to be provided prior to the issue of a Construction Certificate.

Reason: To minimise privacy impact caused by overlooking."

THREATENED SPECIES, POPULATIONS OR ECOLOGICAL COMMUNITIES

The proposal will not significantly affect threatened species, populations or ecological communities, or their habitats.

CRIME PREVENTION THROUGH ENVIRONMENTAL DESIGN

The proposal is consistent with the principles of Crime Prevention Through Environmental Design.

POLICY CONTROLS

Northern Beaches Section 7.12 Contributions Plan 2019

The proposal is subject to the application of Northern Beaches Section 7.12 Contributions Plan 2019.

A monetary contribution of \$6,420 is required for the provision of new and augmented public infrastructure. The contribution is calculated as 1% of the total development cost of \$642,000.

CONCLUSION

The site has been inspected and the application assessed having regard to all documentation submitted by the applicant and the provisions of:

- Environmental Planning and Assessment Act 1979;
- Environmental Planning and Assessment Regulation 2000;
- All relevant and draft Environmental Planning Instruments;
- Pittwater Local Environment Plan;
- Pittwater Development Control Plan; and
- Codes and Policies of Council.

This assessment has taken into consideration the submitted plans, Statement of Environmental Effects, all other documentation supporting the application and public submissions, and does not result in any unreasonable impacts on surrounding, adjoining, adjacent and nearby properties subject to the conditions contained within the recommendation.

In consideration of the proposal and the merit consideration of the development, the proposal is considered to be:

- Consistent with the objectives of the DCP
- Consistent with the zone objectives of the LEP
- Consistent with the aims of the LEP
- Consistent with the objectives of the relevant EPIs

- Consistent with the objects of the Environmental Planning and Assessment Act 1979

Council is satisfied that:

1) The Applicant's written request under Clause 4.6 of the Pittwater Local Environmental Plan 2014 seeking to justify a contravention of Clause 4.3 Height of Buildings has adequately addressed and demonstrated that:

a) Compliance with the standard is unreasonable or unnecessary in the circumstances of the case; and

b) There are sufficient environmental planning grounds to justify the contravention.

2) The proposed development will be in the public interest because it is consistent with the objectives of the standard and the objectives for development within the zone in which the development is proposed to be carried out.

Conclusion

Development Application (DA2021/0133) has proposed alterations and additions to the existing dwelling.

The site has been inspected and the application assessed having regard to the provisions of Section 4.15 of the EP&A Act, 1979, the provisions of relevant EPIs, the relevant codes and policies of Council, the relevant provisions of the Warringah DCP.

Public Exhibition

The public exhibition of the DA resulted in one objection. These objections raised issues particularly in regard to privacy.

The issues raised in the submissions have been addressed in the 'Public Exhibition & Submissions' section of this report.

Conditions have been imposed to reduce amenity impact to a reasonable level.

It is recommended that the Development Determination Panel approve the application subject to conditions.

It is considered that the proposed development satisfies the appropriate controls and that all processes and assessments have been satisfactorily addressed.

RECOMMENDATION

That Northern Beaches Council as the consent authority vary clause 4.3 Height of Building development standard pursuant to clause 4.6 of the PLEP 2014 as the applicant's written request has adequately addressed the merits required to be demonstrated by subclause (3) and the proposed development will be in the public interest and is consistent with the objectives of the standard and the objectives for development within the zone in which the development is proposed to be carried out.

Accordingly Council as the consent authority grant Development Consent to DA2021/0133 for Alterations and additions to a Dwelling House on land at Lot 102 DP 605991, 62 Hudson Parade, CLAREVILLE, subject to the conditions printed below:

DEVELOPMENT CONSENT OPERATIONAL CONDITIONS

1. **Approved Plans and Supporting Documentation**

The development must be carried out in compliance (except as amended by any other condition of consent) with the following:

a) Approved Plans

Architectural Plans - Endorsed with Council's stamp		
Drawing No.	Dated	Prepared By
DWG 105- Proposed Ground Floor	1.10.20	DBCF Pty Ltd
DWG 106- Proposed First Floor Plan	1.10.20	DBCF Pty Ltd
DWG 107- Proposed Roof Plan	1.10.20	DBCF Pty Ltd
DWG 108- Elevation North	1.10.20	DBCF Pty Ltd
DWG 109- Elevation South	1.10.20	DBCF Pty Ltd
DWG 110- Elevation East	1.10.20	DBCF Pty Ltd
DWG 110- Elevation West	1.10.20	DBCF Pty Ltd
DWG 112-Section A-A	1.10.20	DBCF Pty Ltd
DWG 116- Carport Roof	1.10.20	DBCF Pty Ltd

Reports / Documentation – All recommendations and requirements contained within:		
Report No. / Page No. / Section No.	Dated	Prepared By
Report on Geotechnical Assessment	November 2020	Crozier Geotechnical Consultants

b) Any plans and / or documentation submitted to satisfy the Conditions of this consent.

c) The development is to be undertaken generally in accordance with the following:

Landscape Plans		
Drawing No.	Dated	Prepared By
Site Analysis Plan and Landscape Plan	1.10.2020	DBCF Pty Ltd

Waste Management Plan		
Drawing No/Title.	Dated	Prepared By
Environmental Site Management Plan and Waste Management Plan	1.10.2020	DBCF Pty Ltd

In the event of any inconsistency between conditions of this consent and the drawings/documents referred to above, the conditions of this consent will prevail.

Reason: To ensure the work is carried out in accordance with the determination of Council and approved plans.

2. **Compliance with Other Department, Authority or Service Requirements**

The development must be carried out in compliance with all recommendations and requirements, excluding general advice, within the following:

Other Department, Authority or Service	EDMS Reference	Dated
Ausgrid	Response Ausgrid Referral	11/03/2021

(NOTE: For a copy of the above referenced document, please see Application Tracking on Council's website www.northernbeaches.nsw.gov.au)

Reason: To ensure the work is carried out in accordance with the determination and the statutory requirements of other departments, authorities or bodies.

3. **Approved Land Use**

Nothing in this consent shall authorise the use of site/onsite structures/units/tenancies as detailed on the approved plans for any land use of the site beyond the definition of a dwelling house.

Any variation to the approved land use and/occupancy of any unit beyond the scope of the above definition will require the submission to Council of a new development application.

Reason: To ensure compliance with the terms of this consent.

4. **Prescribed Conditions**

- (a) All building works must be carried out in accordance with the requirements of the Building Code of Australia (BCA).
- (b) BASIX affected development must comply with the schedule of BASIX commitments specified within the submitted BASIX Certificate (demonstrated compliance upon plans/specifications is required prior to the issue of the Construction Certificate);
- (c) A sign must be erected in a prominent position on any site on which building work, subdivision work or demolition work is being carried out:
 - (i) showing the name, address and telephone number of the Principal Certifying Authority for the work, and
 - (ii) showing the name of the principal contractor (if any) for any building work and a telephone number on which that person may be contacted outside working hours, and
 - (iii) stating that unauthorised entry to the work site is prohibited.

Any such sign is to be maintained while the building work, subdivision work or demolition work is being carried out, but must be removed when the work has been completed.
- (d) Residential building work within the meaning of the Home Building Act 1989 must not be carried out unless the Principal Certifying Authority for the development to which the work relates (not being the Council) has given the Council written notice of the following information:
 - (i) in the case of work for which a principal contractor is required to be appointed:
 - A. the name and licence number of the principal contractor, and
 - B. the name of the insurer by which the work is insured under Part 6 of that Act,

- (ii) in the case of work to be done by an owner-builder:
 - A. the name of the owner-builder, and
 - B. if the owner-builder is required to hold an owner-builder permit under that Act, the number of the owner-builder permit.

If arrangements for doing the residential building work are changed while the work is in progress so that the information notified under becomes out of date, further work must not be carried out unless the Principal Certifying Authority for the development to which the work relates (not being the Council) has given the Council written notice of the updated information.

- (e) Development that involves an excavation that extends below the level of the base of the footings of a building on adjoining land, the person having the benefit of the development consent must, at the person's own expense:
 - (i) protect and support the adjoining premises from possible damage from the excavation, and
 - (ii) where necessary, underpin the adjoining premises to prevent any such damage.
 - (iii) must, at least 7 days before excavating below the level of the base of the footings of a building on an adjoining allotment of land, give notice of intention to do so to the owner of the adjoining allotment of land and furnish particulars of the excavation to the owner of the building being erected or demolished.
 - (iv) the owner of the adjoining allotment of land is not liable for any part of the cost of work carried out for the purposes of this clause, whether carried out on the allotment of land being excavated or on the adjoining allotment of land.

In this clause, allotment of land includes a public road and any other public place.

Reason: Legislative requirement.

5. General Requirements

- (a) Unless authorised by Council:
Building construction and delivery of material hours are restricted to:

- 7.00 am to 5.00 pm inclusive Monday to Friday,
- 8.00 am to 1.00 pm inclusive on Saturday,
- No work on Sundays and Public Holidays.

Demolition and excavation works are restricted to:

- 8.00 am to 5.00 pm Monday to Friday only.

(Excavation work includes the use of any excavation machinery and the use of jackhammers, rock breakers, excavators, loaders and the like, regardless of whether the activities disturb or alter the natural state of the existing ground stratum or are breaking up/removing materials from the site).

- (b) Should any asbestos be uncovered on site, its demolition and removal must be carried out in accordance with WorkCover requirements and the relevant Australian Standards.
- (c) At all times after the submission the Notice of Commencement to Council, a copy of the Development Consent and Construction Certificate is to remain onsite at all times until

the issue of a final Occupation Certificate. The consent shall be available for perusal of any Authorised Officer.

- (d) Where demolition works have been completed and new construction works have not commenced within 4 weeks of the completion of the demolition works that area affected by the demolition works shall be fully stabilised and the site must be maintained in a safe and clean state until such time as new construction works commence.
- (e) Onsite toilet facilities (being either connected to the sewer or an accredited sewer management facility) for workers are to be provided for construction sites at a rate of 1 per 20 persons.
- (f) Prior to the release of the Construction Certificate, payment of the Long Service Levy is required. This payment can be made at Council or to the Long Services Payments Corporation. Payment is not required where the value of the works is less than \$25,000. The Long Service Levy is calculated on 0.35% of the building and construction work. The levy rate and level in which it applies is subject to legislative change. The applicable fee at the time of payment of the Long Service Levy will apply.
- (g) The applicant shall bear the cost of all works associated with the development that occurs on Council's property.
- (h) No skip bins, building materials, demolition or excavation waste of any nature, and no hoist, plant or machinery (crane, concrete pump or lift) shall be placed on Council's footpaths, roadways, parks or grass verges without Council Approval.
- (i) Demolition materials and builders' wastes are to be removed to approved waste/recycling centres.
- (j) No trees or native shrubs or understorey vegetation on public property (footpaths, roads, reserves, etc.) or on the land to be developed shall be removed or damaged during construction unless specifically approved in this consent including for the erection of any fences, hoardings or other temporary works.
- (k) Prior to the commencement of any development onsite for:
 - i) Building/s that are to be erected
 - ii) Building/s that are situated in the immediate vicinity of a public place and is dangerous to persons or property on or in the public place
 - iii) Building/s that are to be demolished
 - iv) For any work/s that is to be carried out
 - v) For any work/s that is to be demolished

The person responsible for the development site is to erect or install on or around the development area such temporary structures or appliances (wholly within the development site) as are necessary to protect persons or property and to prevent unauthorised access to the site in order for the land or premises to be maintained in a safe or healthy condition. Upon completion of the development, such temporary structures or appliances are to be removed within 7 days.

- (l) A "Road Opening Permit" must be obtained from Council, and all appropriate charges paid, prior to commencement of any work on Council property. The owner/applicant shall be responsible for all public utilities and services in the area of the work, shall notify all relevant Authorities, and bear all costs associated with any repairs and/or adjustments as those Authorities may deem necessary.
- (m) The works must comply with the relevant Ausgrid Network Standards and SafeWork NSW Codes of Practice.
- (n) Requirements for new swimming pools/spas or existing swimming pools/spas affected by building works.

- (1) Child resistant fencing is to be provided to any swimming pool or lockable cover to any spa containing water and is to be consistent with the following;
- Relevant legislative requirements and relevant Australian Standards (including but not limited) to:
- (i) Swimming Pools Act 1992
 - (ii) Swimming Pools Amendment Act 2009
 - (iii) Swimming Pools Regulation 2018
 - (iv) Australian Standard AS1926 Swimming Pool Safety
 - (v) Australian Standard AS1926.1 Part 1: Safety barriers for swimming pools
 - (vi) Australian Standard AS1926.2 Part 2: Location of safety barriers for swimming pools.
- (2) A 'KEEP WATCH' pool safety and aquatic based emergency sign, issued by Royal Life Saving is to be displayed in a prominent position within the pool/spa area.
- (3) Filter backwash waters shall be conveyed to the Sydney Water sewerage system in sewered areas or managed on-site in unsewered areas in a manner that does not cause pollution, erosion or run off, is separate from the irrigation area for any wastewater system and is separate from any onsite stormwater management system.
- (4) Swimming pools and spas must be registered with the Division of Local Government.

Reason: To ensure that works do not interfere with reasonable amenity expectations of residents and the community.

FEES / CHARGES / CONTRIBUTIONS

6. Policy Controls

Northern Beaches 7.12 Contributions Plan 2019

A monetary contribution of \$6,420.00 is payable to Northern Beaches Council for the provision of local infrastructure and services pursuant to section 7.12 of the Environmental Planning & Assessment Act 1979 and the Northern Beaches Section 7.12 Contributions Plan 2019. The monetary contribution is based on a development cost of \$642,000.00.

The monetary contribution is to be paid prior to the issue of the first Construction Certificate or Subdivision Certificate whichever occurs first, or prior to the issue of the Subdivision Certificate where no Construction Certificate is required. If the monetary contribution (total or in part) remains unpaid after the financial quarter that the development consent is issued, the amount unpaid (whether it be the full cash contribution or part thereof) will be adjusted on a quarterly basis in accordance with the applicable Consumer Price Index. If this situation applies, the cash contribution payable for this development will be the total unpaid monetary contribution as adjusted.

The proponent shall provide to the Certifying Authority written evidence (receipt/s) from Council that the total monetary contribution has been paid.

The Northern Beaches Section 7.12 Contributions Plan 2019 may be inspected at 725 Pittwater

Rd, Dee Why and at Council's Customer Service Centres or alternatively, on Council's website at www.northernbeaches.nsw.gov.au

This fee must be paid prior to the issue of the Construction Certificate. Details demonstrating compliance are to be submitted to the Principal Certifying Authority.

Reason: To provide for contributions in accordance with the Contribution Plan to fund the provision of new or augmented local infrastructure and services.

7. Security Bond

A bond (determined from cost of works) of \$2,000 and an inspection fee in accordance with Council's Fees and Charges paid as security are required to ensure the rectification of any damage that may occur to the Council infrastructure contained within the road reserve adjoining the site as a result of construction or the transportation of materials and equipment to and from the development site.

An inspection fee in accordance with Council adopted fees and charges (at the time of payment) is payable for each kerb inspection as determined by Council (minimum (1) one inspection).

All bonds and fees shall be deposited with Council prior to Construction Certificate or demolition work commencing, and details demonstrating payment are to be submitted to the Certifying Authority prior to the issue of the Construction Certificate.

To process the inspection fee and bond payment a Bond Lodgement Form must be completed with the payments (a copy of the form is attached to this consent and alternatively a copy is located on Council's website at www.northernbeaches.nsw.gov.au).

Reason: To ensure adequate protection of Council's infrastructure.

CONDITIONS TO BE SATISFIED PRIOR TO THE ISSUE OF THE CONSTRUCTION CERTIFICATE

8. No Clearing of Vegetation

Unless otherwise exempt, no vegetation is to be cleared prior to issue of a Construction Certificate.

Details demonstrating compliance are to be submitted to the Certifying Authority prior to issue of Construction Certificate.

Reason: To protect native vegetation.

9. External Finishes to Roof

The external finish to the roof shall have a medium to dark range (BCA classification M and D) in order to minimise solar reflections to neighbouring properties. Any roof with a metallic steel finish is not permitted.

Details demonstrating compliance are to be submitted to the Certifying Authority prior to the issue of the Construction Certificate.

Reason: To ensure that excessive glare or reflectivity nuisance does not occur as a result of the development. (DACPLC03)

10. **Privacy Screen**

A privacy screen 1.7m in height is to be provided along the extent of the south-western side elevation of the balcony.

Details are to be provided prior to the issue of a Construction Certificate.

Reason: To minimise privacy impact caused by overlooking.

11. **Opaque Windows**

Windows W9, W10 and W11 are to be wholly opaque and fixed.

Details are to be provided prior to the issue of a Construction Certificate.

Reason: To minimise privacy impact caused by overlooking.

CONDITIONS THAT MUST BE ADDRESSED PRIOR TO ANY COMMENCEMENT

12. **Dead or Injured Wildlife**

If construction activity associated with this development results in injury or death of a native mammal, bird, reptile or amphibian, a registered wildlife rescue and rehabilitation organisation must be contacted for advice.

Reason: To protect native wildlife.

CONDITIONS TO BE COMPLIED WITH DURING DEMOLITION AND BUILDING WORK

13. **Protection of Existing Street Trees**

All existing street trees in the vicinity of the works shall be retained during all construction stages, and the street trees fronting the development site shall be protected by tree protection fencing in accordance with Australian Standard 4687-2007 Temporary Fencing and Hoardings, and in accordance with Section 4 of Australian Standard 4970-2009 Protection of Trees on Development Sites.

As a minimum the tree protection fencing for street tree(s) fronting the development site shall consist of standard 2.4m panel length to four sides, unless otherwise directed by an Arborist with minimum AQF Level 5 in arboriculture.

All fencing shall be located to allow for unrestricted and safe pedestrian access upon the road verge.

Should any problems arise with regard to the existing or proposed trees on public land during construction, Council's Tree Services section is to be contacted immediately to resolve the matter to Council's satisfaction and at the cost of the applicant.

Reason: Tree protection.

14. **Tree and Vegetation Protection**

a) Existing trees and vegetation shall be retained and protected, including:

- i) all trees and vegetation within the site not approved for removal, excluding exempt trees and vegetation under the relevant planning instruments of legislation,
- ii) all trees and vegetation located on adjoining properties,

iii) all road reserve trees and vegetation.

b) Tree protection shall be undertaken as follows:

i) tree protection shall be in accordance with Australian Standard 4970-2009 Protection of Trees on Development Sites, including the provision of temporary fencing to protect existing trees within 5 metres of development,

ii) existing ground levels shall be maintained within the tree protection zone of trees to be retained, unless authorised by an Arborist with minimum AQF Level 5 in arboriculture,

iii) removal of existing tree roots at or >25mm (Ø) diameter is not permitted without consultation with an Arborist with minimum AQF Level 5 in arboriculture,

iv) no excavated material, building material storage, site facilities, nor landscape materials are to be placed within the canopy dripline of trees and other vegetation required to be retained,

v) structures are to bridge tree roots at or >25mm (Ø) diameter unless directed by an Arborist with minimum AQF Level 5 in arboriculture on site,

vi) excavation for stormwater lines and all other utility services is not permitted within the tree protection zone, without consultation with an Arborist with minimum AQF Level 5 in arboriculture including advice on root protection measures,

vii) should either or all of v), vi) and vii) occur during site establishment and construction works, an Arborist with minimum AQF Level 5 in arboriculture shall provide recommendations for tree protection measures. Details including photographic evidence of works undertaken shall be submitted by the Arborist to the Certifying Authority,

viii) any temporary access to, or location of scaffolding within the tree protection zone of a protected tree or any other tree to be retained during the construction works is to be undertaken using the protection measures specified in sections 4.5.3 and 4.5.6 of Australian Standard 4970-2009 Protection of Trees on Development Sites,

ix) the activities listed in section 4.2 of Australian Standard 4970-2009 Protection of Trees on Development Sites shall not occur within the tree protection zone of any tree on the lot or any tree on an adjoining site,

x) tree pruning from within the site to enable approved works shall not exceed 10% of any tree canopy, and shall be in accordance with Australian Standard 4373-2007 Pruning of Amenity Trees,

xi) the tree protection measures specified in this clause must: i) be in place before work commences on the site, and ii) be maintained in good condition during the construction period, and iii) remain in place for the duration of the construction works.

The Certifying Authority must ensure that:

c) The activities listed in section 4.2 of Australian Standard 4970-2009 Protection of Trees on Development Sites, do not occur within the tree protection zone of any tree, and any temporary access to, or location of scaffolding within the tree protection zone of a protected tree, or any other tree to be retained on the site during the construction, is undertaken using the protection measures specified in sections 4.5.3 and 4.5.6 of that standard.

Note: All street trees within the road verge and trees within private property are protected under Northern Beaches Council development control plans, except where Council's written consent for removal has been obtained. The felling, lopping, topping, ringbarking, or removal of any tree (s) is prohibited.

Reason: Tree and vegetation protection.

15. **Condition of Trees**

During the construction period the applicant is responsible for ensuring all existing trees required to be retained are maintained in a healthy and vigorous condition. This is to be done by ensuring that all identified tree protection measures are adhered to, or by seeking arboricultural

advice from an Arborist with minimum AQF Level 5 in arboriculture during the works. In this regard all protected trees shall not exhibit:

- i) a general decline in health and vigour,
- ii) damaged, crushed or dying roots due to poor pruning techniques,
- iii) more than 10% loss or dieback of roots, branches and foliage,
- iv) mechanical damage or bruising of bark and timber of roots, trunk and branches,
- v) yellowing of foliage or a thinning of the canopy untypical of its species,
- vi) an increase in the amount of deadwood not associated with normal growth,
- vii) an increase in kino or gum exudation,
- viii) inappropriate increases in epicormic growth that may indicate that the plants are in a stressed condition,
- ix) branch drop, torn branches and stripped bark not associated with natural climatic conditions.

Any mitigating measures and recommendations required by the Arborist are to be implemented.

The owner of the adjoining allotment of land is not liable for the cost of work carried out for the purpose of this clause.

Reason: Protection of trees.

CONDITIONS WHICH MUST BE COMPLIED WITH PRIOR TO THE ISSUE OF THE OCCUPATION CERTIFICATE

16. **Landscape Completion**

Landscaping is to be implemented in accordance with the approved Landscape Plan, inclusive of the following conditions:

- i) all canopy trees, and at minimum 50% of other vegetation proposed shall be locally native species.

Tree planting shall be located within a 9m² deep soil area wholly within the site and be located a minimum of 3 metres from existing and proposed buildings, and other trees. Minimum pot size for proposed trees shall be 75L.

Tree planting shall be located to minimise significant impacts on neighbours in terms of blocking winter sunlight, or where the proposed tree location may impact upon significant views.

Shrub plants are to be installed at minimum 1 metre intervals and be of a minimum container size of 200mm at planting in a garden bed prepared, with a suitable free draining soil mix and minimum 50mm depth of mulch.

Native planting species shall be selected from Council's list, specifically the *Native Plant Species Guide - Pittwater Ward*: www.northernbeaches.nsw.gov.au/environment/native-plants/native-plant-species-guide.

Prior to the issue of an Occupation Certificate, details (from a landscape architect or landscape designer) shall be submitted to the Certifying Authority, certifying that the landscape works have been completed in accordance with any conditions of consent.

Reason: Environmental amenity.

17. **New Vegetation Planting**

Landscaping is to incorporate a minimum 80% locally native vegetation species as a proportion of the total number of plants. Locally native species are to be consistent with the species listed

in Pittwater Spotted Gum Endangered Ecological Community).

Details demonstrating compliance are to be provided to the Principal Certifying Authority prior to issue of the Occupation Certificate.

Reason: To ensure compliance with the requirement to retain and protect native planting on the site.

18. No Weeds Imported On To The Site

No Priority or environmental weeds (as specified on the NSW WeedWise website) are to be imported on to the site prior to or during construction works.

Details demonstrating compliance are to be submitted to the Principal Certifying Authority prior to issue of any Occupation Certificate.

Reason: To reduce the risk of site works contributing to spread of Priority and environmental weeds.

ON-GOING CONDITIONS THAT MUST BE COMPLIED WITH AT ALL TIMES

19. Landscape Maintenance

If any landscape materials/components or planting under this consent fails, they are to be replaced with similar materials/components. Trees, shrubs and groundcovers required to be planted under this consent are to be mulched, watered and fertilised as required at the time of planting.

If any tree, shrub or groundcover required to be planted under this consent fails, they are to be replaced with similar species to maintain the landscape theme and be generally in accordance with the approved Landscape Plan and any conditions of consent.

All weeds are to be removed and controlled in accordance with the NSW Biosecurity Act 2015.

Reason: To maintain local environmental amenity.

20. Undesirable Trees

Leighton Green Cypress *Cupressocyparis leylandii* or any of its cultivars, or any other Undesirable Trees identified by Council, must not be planted on the site for the life of the development.

In the event of any inconsistency between this condition and the development application documents, this condition will prevail to the extent of the inconsistency.

Reason: To reduce the potential for adverse amenity effects such as overshadowing, loss of views and loss of plant diversity.

21. Solid fuel heater

This application does not give consent for any new solid fuel heater.

Reason: To ensure a new solid fuel heater is not installed without appropriate and acceptable information being submitted.

